

STA CATEGORY

| | |
|--|---------|
| BT / STA SYNCHRONIZED TAPPING HOLDER | Q-2~5 |
| CAT / STA SYNCHRONIZED TAPPING HOLDER | Q-6~8 |
| DAT / STA SYNCHRONIZED TAPPING HOLDER | Q-9~11 |
| SBT / STA SYNCHRONIZED TAPPING HOLDER | Q-12~15 |
| SCAT / STA SYNCHRONIZED TAPPING HOLDER | Q-16~18 |
| SDAT / STA SYNCHRONIZED TAPPING HOLDER | Q-19~21 |
| HSK / STA SYNCHRONIZED TAPPING HOLDER | Q-22~25 |
| PSC / STA SYNCHRONIZED TAPPING HOLDER | Q-26~29 |
| STRAIGHT SHANK STA SYNCHRONIZED TAPPING HOLDER | Q-30~33 |
| STA SYNCHRONIZED TAPPING HOLDER BODY | Q-34~36 |
| TAP ADAPTER FOR STA | Q-37~39 |

BT / STA SYNCHRONIZED TAPPING HOLDER



BT / STA 同步補償攻牙刀桿

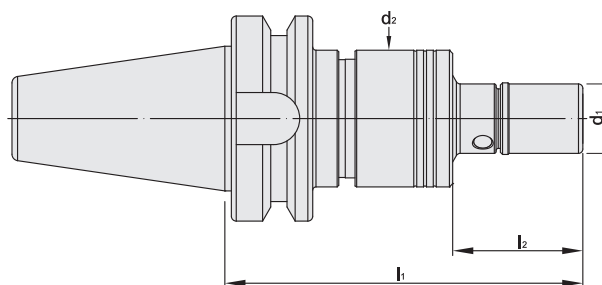

T W PAT NO. M520427
J P PAT NO. 3203456
D E PAT NO. Nr.202016100106

| MODEL NO. | TYPE | l ₁ | l ₂ | d ₁ | d ₂ | COMBINATION | | WEIGHT (KGS) |
|----------------|---------------------|----------------|----------------|----------------|----------------|-------------|---------------------|--------------|
| | | | | | | BODY | TAP ADAPTER | |
| 10.795.08T.090 | BT30 x STA8T - 90 | 90 | 30 | 12 | 42 | BT30 x STA1 | STA1 - PTER8 - 30 | 0.68 |
| 10.795.08T.130 | BT30 x STA8T - 130 | 130 | 70 | 12 | 42 | BT30 x STA1 | STA1 - PTER8 - 70 | 0.74 |
| 10.795.08T.160 | BT30 x STA8T - 160 | 160 | 100 | 12 | 42 | BT30 x STA1 | STA1 - PTER8 - 100 | 0.79 |
| 10.795.11T.090 | BT30 x STA11T - 90 | 90 | 30 | 16 | 42 | BT30 x STA1 | STA1 - PTER11 - 30 | 1.13 |
| 10.795.11T.130 | BT30 x STA11T - 130 | 130 | 70 | 16 | 42 | BT30 x STA1 | STA1 - PTER11 - 70 | 1.19 |
| 10.795.11T.160 | BT30 x STA11T - 160 | 160 | 100 | 16 | 42 | BT30 x STA1 | STA1 - PTER11 - 100 | 1.23 |
| 10.795.16T.090 | BT30 x STA16T - 90 | 90 | 30 | 22 | 42 | BT30 x STA1 | STA1 - PTER16 - 30 | 1.14 |
| 10.795.16T.130 | BT30 x STA16T - 130 | 130 | 70 | 22 | 42 | BT30 x STA1 | STA1 - PTER16 - 70 | 1.20 |
| 10.795.16T.160 | BT30 x STA16T - 160 | 160 | 100 | 22 | 42 | BT30 x STA1 | STA1 - PTER16 - 100 | 1.24 |
| 10.795.20T.090 | BT30 x STA20T - 90 | 90 | 30 | 28 | 42 | BT30 x STA1 | STA1 - PTER20 - 30 | 1.11 |
| 10.795.20T.130 | BT30 x STA20T - 130 | 130 | 70 | 28 | 42 | BT30 x STA1 | STA1 - PTER20 - 70 | 1.38 |
| 10.795.20T.160 | BT30 x STA20T - 160 | 160 | 100 | 28 | 42 | BT30 x STA1 | STA1 - PTER20 - 100 | 1.54 |
| 11.795.08T.100 | BT40 x STA8T - 100 | 100 | 30 | 12 | 42 | BT40 x STA1 | STA1 - PTER8 - 30 | 1.30 |
| 11.795.08T.140 | BT40 x STA8T - 140 | 140 | 70 | 12 | 42 | BT40 x STA1 | STA1 - PTER8 - 70 | 1.36 |
| 11.795.08T.170 | BT40 x STA8T - 170 | 170 | 100 | 12 | 42 | BT40 x STA1 | STA1 - PTER8 - 100 | 1.41 |
| 11.795.11T.100 | BT40 x STA11T - 100 | 100 | 30 | 16 | 42 | BT40 x STA1 | STA1 - PTER11 - 30 | 1.75 |
| 11.795.11T.140 | BT40 x STA11T - 140 | 140 | 70 | 16 | 42 | BT40 x STA1 | STA1 - PTER11 - 70 | 1.81 |
| 11.795.11T.170 | BT40 x STA11T - 170 | 170 | 100 | 16 | 42 | BT40 x STA1 | STA1 - PTER11 - 100 | 1.85 |
| 11.795.16T.100 | BT40 x STA16T - 100 | 100 | 30 | 22 | 42 | BT40 x STA1 | STA1 - PTER16 - 30 | 1.76 |
| 11.795.16T.140 | BT40 x STA16T - 140 | 140 | 70 | 22 | 42 | BT40 x STA1 | STA1 - PTER16 - 70 | 1.82 |
| 11.795.16T.170 | BT40 x STA16T - 170 | 170 | 100 | 22 | 42 | BT40 x STA1 | STA1 - PTER16 - 100 | 1.86 |
| 11.795.20T.100 | BT40 x STA20T - 100 | 100 | 30 | 28 | 42 | BT40 x STA1 | STA1 - PTER20 - 30 | 1.73 |
| 11.795.20T.140 | BT40 x STA20T - 140 | 140 | 70 | 28 | 42 | BT40 x STA1 | STA1 - PTER20 - 70 | 2.00 |
| 11.795.20T.170 | BT40 x STA20T - 170 | 170 | 100 | 28 | 42 | BT40 x STA1 | STA1 - PTER20 - 100 | 2.16 |
| 11.795.25T.115 | BT40 x STA25T - 115 | 115 | 30 | 35 | 58 | BT40 x STA2 | STA2 - PTER25 - 30 | 2.03 |
| 11.795.25T.155 | BT40 x STA25T - 155 | 155 | 70 | 35 | 58 | BT40 x STA2 | STA2 - PTER25 - 70 | 2.30 |
| 11.795.25T.185 | BT40 x STA25T - 185 | 185 | 100 | 35 | 58 | BT40 x STA2 | STA2 - PTER25 - 100 | 2.46 |

Product information:

- ▶ AD+B type is available, please inform us when making an order.
- ▶ MAS/BT30 tool holders are without coolant supply over collars.

Standard Accessory: • NUT

| Collet | Nut | Pull Stud | Spanner |
|--------|--------|-----------|-----------|
| | | | |
| P.W-5 | P.W-47 | P.W-60~61 | P.W-68~73 |

BT / STA SYNCHRONIZED TAPPING HOLDER



BT / STA 同步補償攻牙刀桿

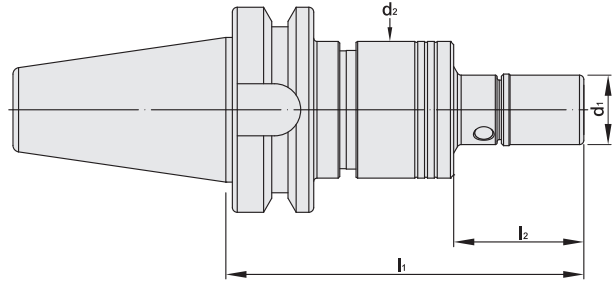

T W PAT NO. M520427
 J P PAT NO. 3203456
 D E PAT NO. Nr.202016100106

| MODEL NO. | TYPE | l ₁ | l ₂ | d ₁ | d ₂ | COMBINATION | | WEIGHT (KGS) |
|----------------|---------------------|----------------|----------------|----------------|----------------|-------------|---------------------|--------------|
| | | | | | | BODY | TAP ADAPTER | |
| 12.795.08T.090 | BT50 x STA8T - 90 | 90 | 30 | 12 | 42 | BT50 x STA1 | STA1 - PTER8 - 30 | 3.80 |
| 12.795.08T.130 | BT50 x STA8T - 130 | 130 | 70 | 12 | 42 | BT50 x STA1 | STA1 - PTER8 - 70 | 3.86 |
| 12.795.08T.160 | BT50 x STA8T - 160 | 160 | 100 | 12 | 42 | BT50 x STA1 | STA1 - PTER8 - 100 | 3.91 |
| 12.795.11T.090 | BT50 x STA11T - 90 | 90 | 30 | 16 | 42 | BT50 x STA1 | STA1 - PTER11 - 30 | 4.25 |
| 12.795.11T.130 | BT50 x STA11T - 130 | 130 | 70 | 16 | 42 | BT50 x STA1 | STA1 - PTER11 - 70 | 4.31 |
| 12.795.11T.160 | BT50 x STA11T - 160 | 160 | 100 | 16 | 42 | BT50 x STA1 | STA1 - PTER11 - 100 | 4.35 |
| 12.795.16T.090 | BT50 x STA16T - 90 | 90 | 30 | 22 | 42 | BT50 x STA1 | STA1 - PTER16 - 30 | 4.26 |
| 12.795.16T.130 | BT50 x STA16T - 130 | 130 | 70 | 22 | 42 | BT50 x STA1 | STA1 - PTER16 - 70 | 4.32 |
| 12.795.16T.160 | BT50 x STA16T - 160 | 160 | 100 | 22 | 42 | BT50 x STA1 | STA1 - PTER16 - 100 | 4.36 |
| 12.795.20T.090 | BT50 x STA20T - 90 | 90 | 30 | 28 | 42 | BT50 x STA1 | STA1 - PTER20 - 30 | 4.23 |
| 12.795.20T.130 | BT50 x STA20T - 130 | 130 | 70 | 28 | 42 | BT50 x STA1 | STA1 - PTER20 - 70 | 4.50 |
| 12.795.20T.160 | BT50 x STA20T - 160 | 160 | 100 | 28 | 42 | BT50 x STA1 | STA1 - PTER20 - 100 | 4.66 |
| 12.795.25T.125 | BT50 x STA25T - 125 | 125 | 30 | 35 | 58 | BT50 x STA2 | STA2 - PTER25 - 30 | 4.53 |
| 12.795.25T.165 | BT50 x STA25T - 165 | 165 | 70 | 35 | 58 | BT50 x STA2 | STA2 - PTER25 - 70 | 4.80 |
| 12.795.25T.195 | BT50 x STA25T - 195 | 195 | 100 | 35 | 58 | BT50 x STA2 | STA2 - PTER25 - 100 | 4.96 |

Product information:

▶ AD+B type is available, please inform us when making an order.

Standard Accessory: • NUT

| Collet | Nut | Pull Stud | Spanner |
|--------|--------|-----------|-----------|
| | | | |
| P.W-5 | P.W-47 | P.W-60~61 | P.W-68~73 |



BT / STA SYNCHRONIZED TAPPING HOLDER



BT / STA 同步補償攻牙刀桿

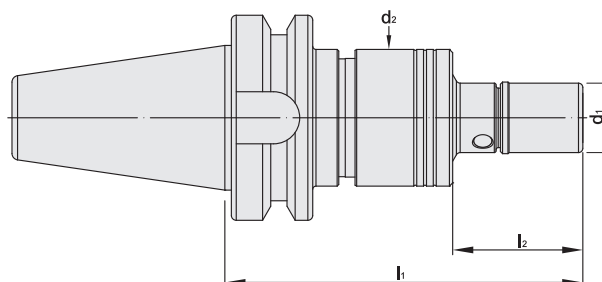

T W PAT NO. M520427
J P PAT NO. 3203456
D E PAT NO. Nr.202016100106

| MODEL NO. | TYPE | l ₁ | l ₂ | d ₁ | d ₂ | COMBINATION | | WEIGHT (KGS) |
|----------------|---------------------|----------------|----------------|----------------|----------------|-------------|-------------------|--------------|
| | | | | | | BODY | TAP ADAPTER | |
| 10.795.16U.090 | BT30 x STA16U - 90 | 90 | 30 | 30 | 42 | BT30 x STA1 | STA1 - UT16 - 30 | 0.71 |
| 10.795.16U.130 | BT30 x STA16U - 130 | 130 | 70 | 30 | 42 | BT30 x STA1 | STA1 - UT16 - 70 | 0.86 |
| 10.795.16U.160 | BT30 x STA16U - 160 | 160 | 100 | 30 | 42 | BT30 x STA1 | STA1 - UT16 - 100 | 1.06 |
| 11.795.16U.100 | BT40 x STA16U - 100 | 100 | 30 | 30 | 42 | BT40 x STA1 | STA1 - UT16 - 30 | 1.33 |
| 11.795.16U.140 | BT40 x STA16U - 140 | 140 | 70 | 30 | 42 | BT40 x STA1 | STA1 - UT16 - 70 | 1.48 |
| 11.795.16U.170 | BT40 x STA16U - 170 | 170 | 100 | 30 | 42 | BT40 x STA1 | STA1 - UT16 - 100 | 1.68 |
| 11.795.20U.115 | BT40 x STA20U - 115 | 115 | 30 | 36 | 58 | BT40 x STA2 | STA2 - UT20 - 30 | 1.78 |
| 11.795.20U.155 | BT40 x STA20U - 155 | 155 | 70 | 36 | 58 | BT40 x STA2 | STA2 - UT20 - 70 | 1.98 |
| 11.795.20U.185 | BT40 x STA20U - 185 | 185 | 100 | 36 | 58 | BT40 x STA2 | STA2 - UT20 - 100 | 2.11 |
| 11.795.25U.120 | BT40 x STA25U - 120 | 120 | 35 | 42 | 58 | BT40 x STA2 | STA2 - UT25 - 35 | 1.78 |
| 11.795.25U.170 | BT40 x STA25U - 170 | 170 | 85 | 42 | 58 | BT40 x STA2 | STA2 - UT25 - 85 | 2.13 |
| 11.795.25U.200 | BT40 x STA25U - 200 | 200 | 115 | 42 | 58 | BT40 x STA2 | STA2 - UT25 - 115 | 2.38 |
| 11.795.32U.135 | BT40 x STA32U - 135 | 135 | 50 | 48 | 58 | BT40 x STA2 | STA2 - UT32 - 50 | 1.83 |
| 11.795.32U.170 | BT40 x STA32U - 170 | 170 | 85 | 48 | 58 | BT40 x STA2 | STA2 - UT32 - 85 | 2.08 |
| 11.795.32U.200 | BT40 x STA32U - 200 | 200 | 115 | 48 | 58 | BT40 x STA2 | STA2 - UT32 - 115 | 2.28 |
| 12.795.16U.090 | BT50 x STA16U - 90 | 90 | 30 | 30 | 42 | BT50 x STA1 | STA1 - UT16 - 30 | 3.83 |
| 12.795.16U.130 | BT50 x STA16U - 130 | 130 | 70 | 30 | 42 | BT50 x STA1 | STA1 - UT16 - 70 | 3.98 |
| 12.795.16U.160 | BT50 x STA16U - 160 | 160 | 100 | 30 | 42 | BT50 x STA1 | STA1 - UT16 - 100 | 4.18 |
| 12.795.20U.125 | BT50 x STA20U - 125 | 125 | 30 | 36 | 58 | BT50 x STA2 | STA2 - UT20 - 30 | 4.28 |
| 12.795.20U.165 | BT50 x STA20U - 165 | 165 | 70 | 36 | 58 | BT50 x STA2 | STA2 - UT20 - 70 | 4.48 |
| 12.795.20U.195 | BT50 x STA20U - 195 | 195 | 100 | 36 | 58 | BT50 x STA2 | STA2 - UT20 - 100 | 4.61 |
| 12.795.25U.130 | BT50 x STA25U - 130 | 130 | 35 | 42 | 58 | BT50 x STA2 | STA2 - UT25 - 35 | 4.28 |
| 12.795.25U.180 | BT50 x STA25U - 180 | 180 | 85 | 42 | 58 | BT50 x STA2 | STA2 - UT25 - 85 | 4.63 |
| 12.795.25U.210 | BT50 x STA25U - 210 | 210 | 115 | 42 | 58 | BT50 x STA2 | STA2 - UT25 - 115 | 4.88 |
| 12.795.32U.145 | BT50 x STA32U - 145 | 145 | 50 | 48 | 58 | BT50 x STA2 | STA2 - UT32 - 50 | 4.33 |
| 12.795.32U.180 | BT50 x STA32U - 180 | 180 | 85 | 48 | 58 | BT50 x STA2 | STA2 - UT32 - 85 | 4.58 |
| 12.795.32U.210 | BT50 x STA32U - 210 | 210 | 115 | 48 | 58 | BT50 x STA2 | STA2 - UT32 - 115 | 4.78 |

Product information:

- ▶ AD+B type is available, please inform us when making an order.
- ▶ MAS/BT30 tool holders are without coolant supply over collars.

Standard Accessory: • NUT

| Collet | Nut | Pull Stud | Spanner |
|----------|--------|-----------|-----------|
| | | | |
| P.W-7~10 | P.W-47 | P.W-60~61 | P.W-68~73 |

BT / STA SYNCHRONIZED TAPPING HOLDER



BT / STA 同步補償攻牙刀桿

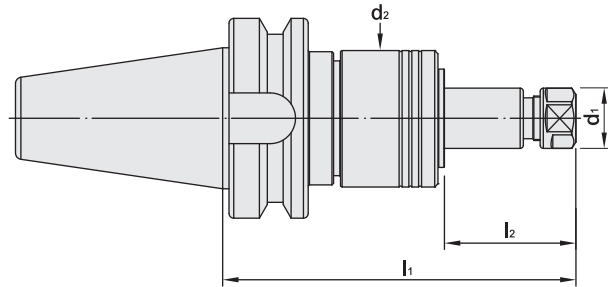

T W PAT NO. M520427
 J P PAT NO. 3203456
 D E PAT NO. Nr.202016100106

| MODEL NO. | TYPE | l ₁ | l ₂ | d ₁ | d ₂ | COMBINATION | | WEIGHT (KGS) |
|----------------|---------------------|----------------|----------------|----------------|----------------|-------------|--------------------|--------------|
| | | | | | | BODY | TAP ADAPTER | |
| 10.795.11E.130 | BT30 x STA11E - 130 | 130 | 70 | 19 | 42 | BT30 x STA1 | STA1 - ER11A - 70 | 0.92 |
| 10.795.16E.085 | BT30 x STA16E - 85 | 85 | 25 | 28 | 42 | BT30 x STA1 | STA1 - ER16A - 25 | 0.66 |
| 10.795.16E.130 | BT30 x STA16E - 130 | 130 | 70 | 28 | 42 | BT30 x STA1 | STA1 - ER16A - 70 | 0.86 |
| 10.795.16E.210 | BT30 x STA16E - 210 | 210 | 150 | 28 | 42 | BT30 x STA1 | STA1 - ER16A - 150 | 1.19 |
| 10.795.20E.094 | BT30 x STA20E - 94 | 94 | 34 | 34 | 42 | BT30 x STA1 | STA1 - ER20A - 34 | 0.70 |
| 10.795.20E.130 | BT30 x STA20E - 130 | 130 | 70 | 34 | 42 | BT30 x STA1 | STA1 - ER20A - 70 | 0.86 |
| 11.795.11E.140 | BT40 x STA11E - 140 | 140 | 70 | 19 | 42 | BT40 x STA1 | STA1 - ER11A - 70 | 1.54 |
| 11.795.16E.095 | BT40 x STA16E - 95 | 95 | 25 | 28 | 42 | BT40 x STA1 | STA1 - ER16A - 25 | 1.28 |
| 11.795.16E.140 | BT40 x STA16E - 140 | 140 | 70 | 28 | 42 | BT40 x STA1 | STA1 - ER16A - 70 | 1.48 |
| 11.795.16E.220 | BT40 x STA16E - 220 | 220 | 150 | 28 | 42 | BT40 x STA1 | STA1 - ER16A - 150 | 1.81 |
| 11.795.20E.104 | BT40 x STA20E - 104 | 104 | 34 | 34 | 42 | BT40 x STA1 | STA1 - ER20A - 34 | 1.32 |
| 11.795.20E.140 | BT40 x STA20E - 140 | 140 | 70 | 34 | 42 | BT40 x STA1 | STA1 - ER20A - 70 | 1.48 |
| 11.795.32E.125 | BT40 x STA32E - 125 | 125 | 40 | 50 | 58 | BT40 x STA2 | STA2 - ER32 - 40 | 1.92 |
| 11.795.32E.155 | BT40 x STA32E - 155 | 155 | 70 | 50 | 58 | BT40 x STA2 | STA2 - ER32 - 70 | 2.15 |
| 12.795.11E.130 | BT50 x STA11E - 130 | 130 | 70 | 19 | 42 | BT40 x STA1 | STA1 - ER11A - 70 | 1.54 |
| 12.795.16E.085 | BT50 x STA16E - 85 | 85 | 25 | 28 | 42 | BT50 x STA1 | STA1 - ER16A - 25 | 3.78 |
| 12.795.16E.130 | BT50 x STA16E - 130 | 130 | 70 | 28 | 42 | BT50 x STA1 | STA1 - ER16A - 70 | 3.98 |
| 12.795.16E.210 | BT50 x STA16E - 210 | 210 | 150 | 28 | 42 | BT50 x STA1 | STA1 - ER16A - 150 | 4.31 |
| 12.795.20E.094 | BT50 x STA20E - 94 | 94 | 34 | 34 | 42 | BT50 x STA1 | STA1 - ER20A - 34 | 3.82 |
| 12.795.20E.140 | BT50 x STA20E - 140 | 140 | 70 | 34 | 42 | BT50 x STA1 | STA1 - ER20A - 70 | 3.98 |
| 12.795.32E.135 | BT50 x STA32E - 135 | 135 | 40 | 50 | 58 | BT50 x STA2 | STA2 - ER32 - 40 | 4.42 |
| 12.795.32E.165 | BT50 x STA32E - 165 | 165 | 70 | 50 | 58 | BT50 x STA2 | STA2 - ER32 - 70 | 4.65 |

Product information:

- ▶ AD+B type is available, please inform us when making an order.
- ▶ MAS/BT30 tool holders are without coolant supply over collars.

Standard Accessory: • NUT

| Collet | Nut | Pull Stud | Spanner |
|----------|--------|-----------|-----------|
| | | | |
| P.W-7~28 | P.W-48 | P.W-60~61 | P.W-68~71 |



CAT / STA SYNCHRONIZED TAPPING HOLDER



CAT / STA 同步補償攻牙刀桿

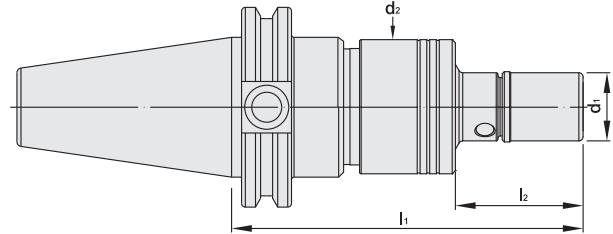

T W PAT NO. M520427
J P PAT NO. 3203456
D E PAT NO. Nr.202016100106

| MODEL NO. | TYPE | l ₁ | l ₂ | d ₁ | d ₂ | COMBINATION | | WEIGHT (KGS) |
|----------------|----------------------|----------------|----------------|----------------|----------------|--------------|---------------------|--------------|
| | | | | | | BODY | TAP ADAPTER | |
| 31.795.08T.100 | CAT40 x STA8T - 100 | 100 | 30 | 12 | 42 | CAT40 x STA1 | STA1 - PTER8 - 30 | 1.24 |
| 31.795.08T.140 | CAT40 x STA8T - 140 | 140 | 70 | 12 | 42 | CAT40 x STA1 | STA1 - PTER8 - 70 | 1.30 |
| 31.795.08T.170 | CAT40 x STA8T - 170 | 170 | 100 | 12 | 42 | CAT40 x STA1 | STA1 - PTER8 - 100 | 1.35 |
| 31.795.11T.100 | CAT40 x STA11T - 100 | 100 | 30 | 16 | 42 | CAT40 x STA1 | STA1 - PTER11 - 30 | 1.69 |
| 31.795.11T.140 | CAT40 x STA11T - 140 | 140 | 70 | 16 | 42 | CAT40 x STA1 | STA1 - PTER11 - 70 | 1.75 |
| 31.795.11T.170 | CAT40 x STA11T - 170 | 170 | 100 | 16 | 42 | CAT40 x STA1 | STA1 - PTER11 - 100 | 1.79 |
| 31.795.16T.100 | CAT40 x STA16T - 100 | 100 | 30 | 22 | 42 | CAT40 x STA1 | STA1 - PTER16 - 30 | 1.70 |
| 31.795.16T.140 | CAT40 x STA16T - 140 | 140 | 70 | 22 | 42 | CAT40 x STA1 | STA1 - PTER16 - 70 | 1.76 |
| 31.795.16T.170 | CAT40 x STA16T - 170 | 170 | 100 | 22 | 42 | CAT40 x STA1 | STA1 - PTER16 - 100 | 1.80 |
| 31.795.20T.100 | CAT40 x STA20T - 100 | 100 | 30 | 28 | 42 | CAT40 x STA1 | STA1 - PTER20 - 30 | 1.67 |
| 31.795.20T.140 | CAT40 x STA20T - 140 | 140 | 70 | 28 | 42 | CAT40 x STA1 | STA1 - PTER20 - 70 | 1.94 |
| 31.795.20T.170 | CAT40 x STA20T - 170 | 170 | 100 | 28 | 42 | CAT40 x STA1 | STA1 - PTER20 - 100 | 2.10 |
| 31.795.25T.120 | CAT40 x STA25T - 120 | 120 | 30 | 35 | 58 | CAT40 x STA2 | STA2 - PTER25 - 30 | 2.00 |
| 31.795.25T.160 | CAT40 x STA25T - 160 | 160 | 70 | 35 | 58 | CAT40 x STA2 | STA2 - PTER25 - 70 | 2.27 |
| 31.795.25T.190 | CAT40 x STA25T - 190 | 190 | 100 | 35 | 58 | CAT40 x STA2 | STA2 - PTER25 - 100 | 2.43 |
| 32.795.08T.100 | CAT50 x STA8T - 100 | 100 | 30 | 12 | 42 | CAT50 x STA1 | STA1 - PTER8 - 30 | 3.24 |
| 32.795.08T.140 | CAT50 x STA8T - 140 | 140 | 70 | 12 | 42 | CAT50 x STA1 | STA1 - PTER8 - 70 | 3.30 |
| 32.795.08T.170 | CAT50 x STA8T - 170 | 170 | 100 | 12 | 42 | CAT50 x STA1 | STA1 - PTER8 - 100 | 3.35 |
| 32.795.11T.100 | CAT50 x STA11T - 100 | 100 | 30 | 16 | 42 | CAT50 x STA1 | STA1 - PTER11 - 30 | 3.69 |
| 32.795.11T.140 | CAT50 x STA11T - 140 | 140 | 70 | 16 | 42 | CAT50 x STA1 | STA1 - PTER11 - 70 | 3.75 |
| 32.795.11T.170 | CAT50 x STA11T - 170 | 170 | 100 | 16 | 42 | CAT50 x STA1 | STA1 - PTER11 - 100 | 3.79 |
| 32.795.16T.100 | CAT50 x STA16T - 100 | 100 | 30 | 22 | 42 | CAT50 x STA1 | STA1 - PTER16 - 30 | 3.70 |
| 32.795.16T.140 | CAT50 x STA16T - 140 | 140 | 70 | 22 | 42 | CAT50 x STA1 | STA1 - PTER16 - 70 | 3.76 |
| 32.795.16T.170 | CAT50 x STA16T - 170 | 170 | 100 | 22 | 42 | CAT50 x STA1 | STA1 - PTER16 - 100 | 3.80 |
| 32.795.20T.100 | CAT50 x STA20T - 100 | 100 | 30 | 28 | 42 | CAT50 x STA1 | STA1 - PTER20 - 30 | 3.67 |
| 32.795.20T.140 | CAT50 x STA20T - 140 | 140 | 70 | 28 | 42 | CAT50 x STA1 | STA1 - PTER20 - 70 | 3.94 |
| 32.795.20T.170 | CAT50 x STA20T - 170 | 170 | 100 | 28 | 42 | CAT50 x STA1 | STA1 - PTER20 - 100 | 4.10 |
| 32.795.25T.125 | CAT50 x STA25T - 125 | 125 | 30 | 35 | 58 | CAT50 x STA2 | STA2 - PTER25 - 30 | 4.08 |
| 32.795.25T.165 | CAT50 x STA25T - 165 | 165 | 70 | 35 | 58 | CAT50 x STA2 | STA2 - PTER25 - 70 | 4.35 |
| 32.795.25T.195 | CAT50 x STA25T - 195 | 195 | 100 | 35 | 58 | CAT50 x STA2 | STA2 - PTER25 - 100 | 4.51 |

Product information:

► AD+B type is available, please inform us when making an order.

Standard Accessory: • NUT

| Collet | Nut | Pull Stud | Spanner |
|--------|--------|-----------|-----------|
| | | | |
| P.W-5 | P.W-47 | P.W-62 | P.W-68~73 |

CAT / STA SYNCHRONIZED TAPPING HOLDER



CAT / STA 同步補償攻牙刀桿

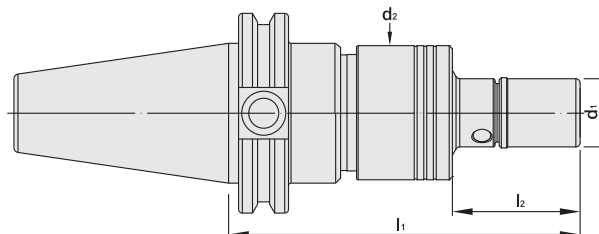

T W PAT NO. M520427
 J P PAT NO. 3203456
 D E PAT NO. Nr.202016100106

| MODEL NO. | TYPE | l ₁ | l ₂ | d ₁ | d ₂ | COMBINATION | | WEIGHT (KGS) |
|----------------|----------------------|----------------|----------------|----------------|----------------|--------------|-------------------|--------------|
| | | | | | | BODY | TAP ADAPTER | |
| 31.795.16U.100 | CAT40 x STA16U - 100 | 100 | 30 | 30 | 42 | CAT40 x STA1 | STA1 - UT16 - 30 | 1.27 |
| 31.795.16U.140 | CAT40 x STA16U - 140 | 140 | 70 | 30 | 42 | CAT40 x STA1 | STA1 - UT16 - 70 | 1.42 |
| 31.795.16U.170 | CAT40 x STA16U - 170 | 170 | 100 | 30 | 42 | CAT40 x STA1 | STA1 - UT16 - 100 | 1.62 |
| 31.795.20U.120 | CAT40 x STA20U - 120 | 120 | 30 | 36 | 58 | CAT40 x STA2 | STA2 - UT20 - 30 | 1.75 |
| 31.795.20U.160 | CAT40 x STA20U - 160 | 160 | 70 | 36 | 58 | CAT40 x STA2 | STA2 - UT20 - 70 | 1.95 |
| 31.795.20U.190 | CAT40 x STA20U - 190 | 190 | 100 | 36 | 58 | CAT40 x STA2 | STA2 - UT20 - 100 | 2.08 |
| 31.795.25U.125 | CAT40 x STA25U - 125 | 125 | 35 | 42 | 58 | CAT40 x STA2 | STA2 - UT25 - 35 | 1.75 |
| 31.795.25U.175 | CAT40 x STA25U - 175 | 175 | 85 | 42 | 58 | CAT40 x STA2 | STA2 - UT25 - 85 | 2.10 |
| 31.795.25U.205 | CAT40 x STA25U - 205 | 205 | 115 | 42 | 58 | CAT40 x STA2 | STA2 - UT25 - 115 | 2.35 |
| 31.795.32U.140 | CAT40 x STA32U - 140 | 140 | 50 | 48 | 58 | CAT40 x STA2 | STA2 - UT32 - 50 | 1.80 |
| 31.795.32U.175 | CAT40 x STA32U - 175 | 175 | 85 | 48 | 58 | CAT40 x STA2 | STA2 - UT32 - 85 | 2.05 |
| 31.795.32U.205 | CAT40 x STA32U - 205 | 205 | 115 | 48 | 58 | CAT40 x STA2 | STA2 - UT32 - 115 | 2.25 |
| 32.795.16U.100 | CAT50 x STA16U - 100 | 100 | 30 | 30 | 42 | CAT50 x STA1 | STA1 - UT16 - 30 | 3.27 |
| 32.795.16U.140 | CAT50 x STA16U - 140 | 140 | 70 | 30 | 42 | CAT50 x STA1 | STA1 - UT16 - 70 | 3.42 |
| 32.795.16U.170 | CAT50 x STA16U - 170 | 170 | 100 | 30 | 42 | CAT50 x STA1 | STA1 - UT16 - 100 | 3.62 |
| 32.795.20U.125 | CAT50 x STA20U - 125 | 125 | 30 | 36 | 58 | CAT50 x STA2 | STA2 - UT20 - 30 | 3.83 |
| 32.795.20U.165 | CAT50 x STA20U - 165 | 165 | 70 | 36 | 58 | CAT50 x STA2 | STA2 - UT20 - 70 | 4.03 |
| 32.795.20U.195 | CAT50 x STA20U - 195 | 195 | 100 | 36 | 58 | CAT50 x STA2 | STA2 - UT20 - 100 | 4.16 |
| 32.795.25U.130 | CAT50 x STA25U - 130 | 130 | 35 | 42 | 58 | CAT50 x STA2 | STA2 - UT25 - 35 | 3.83 |
| 32.795.25U.180 | CAT50 x STA25U - 180 | 180 | 85 | 42 | 58 | CAT50 x STA2 | STA2 - UT25 - 85 | 4.18 |
| 32.795.25U.210 | CAT50 x STA25U - 210 | 210 | 115 | 42 | 58 | CAT50 x STA2 | STA2 - UT25 - 115 | 4.43 |
| 32.795.32U.145 | CAT50 x STA32U - 145 | 145 | 50 | 48 | 58 | CAT50 x STA2 | STA2 - UT32 - 50 | 3.88 |
| 32.795.32U.180 | CAT50 x STA32U - 180 | 180 | 85 | 48 | 58 | CAT50 x STA2 | STA2 - UT32 - 85 | 4.13 |
| 32.795.32U.210 | CAT50 x STA32U - 210 | 210 | 115 | 48 | 58 | CAT50 x STA2 | STA2 - UT32 - 115 | 4.33 |

Product information:

► AD+B type is available, please inform us when making an order.

Standard Accessory: • NUT

| Collet | Nut | Pull Stud | Spanner |
|--------|--------|-----------|-----------|
| | | | |
| P.W-5 | P.W-47 | P.W-62 | P.W-68~73 |



CAT / STA SYNCHRONIZED TAPPING HOLDER



CAT / STA 同步補償攻牙刀桿

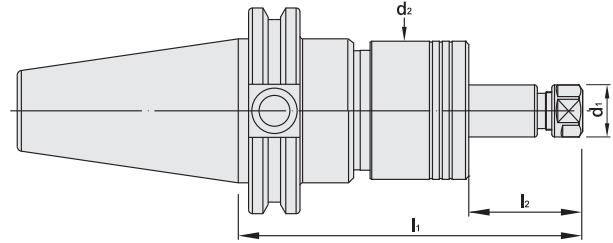

T W PAT NO. M520427
J P PAT NO. 3203456
D E PAT NO. Nr.202016100106

| MODEL NO. | TYPE | l ₁ | l ₂ | d ₁ | d ₂ | COMBINATION | | WEIGHT (KGS) |
|----------------|----------------------|----------------|----------------|----------------|----------------|--------------|--------------------|--------------|
| | | | | | | BODY | TAP ADAPTER | |
| 31.795.11E.140 | CAT40 x STA11E - 140 | 140 | 70 | 19 | 42 | CAT40 x STA1 | STA1 - ER11A - 70 | 1.48 |
| 31.795.16E.095 | CAT40 x STA16E - 95 | 95 | 25 | 28 | 42 | CAT40 x STA1 | STA1 - ER16A - 25 | 1.22 |
| 31.795.16E.140 | CAT40 x STA16E - 140 | 140 | 70 | 28 | 42 | CAT40 x STA1 | STA1 - ER16A - 70 | 1.42 |
| 31.795.16E.220 | CAT40 x STA16E - 220 | 220 | 150 | 28 | 42 | CAT40 x STA1 | STA1 - ER16A - 150 | 1.75 |
| 31.795.20E.104 | CAT40 x STA20E - 104 | 104 | 34 | 34 | 42 | CAT40 x STA1 | STA1 - ER20A - 34 | 1.26 |
| 31.795.20E.140 | CAT40 x STA20E - 140 | 140 | 70 | 34 | 42 | CAT40 x STA1 | STA1 - ER20A - 70 | 1.42 |
| 31.795.32E.130 | CAT40 x STA32E - 130 | 130 | 40 | 50 | 58 | CAT40 x STA2 | STA2 - ER32 - 40 | 1.89 |
| 31.795.32E.160 | CAT40 x STA32E - 160 | 160 | 70 | 50 | 58 | CAT40 x STA2 | STA2 - ER32 - 70 | 2.12 |
| 32.795.11E.140 | CAT50 x STA11E - 140 | 140 | 70 | 19 | 42 | CAT50 x STA1 | STA1 - ER11A - 70 | 3.48 |
| 32.795.16E.095 | CAT50 x STA16E - 95 | 95 | 25 | 28 | 42 | CAT50 x STA1 | STA1 - ER16A - 25 | 3.22 |
| 32.795.16E.140 | CAT50 x STA16E - 140 | 140 | 70 | 28 | 42 | CAT50 x STA1 | STA1 - ER16A - 70 | 3.42 |
| 32.795.16E.220 | CAT50 x STA16E - 220 | 220 | 150 | 28 | 42 | CAT50 x STA1 | STA1 - ER16A - 150 | 3.75 |
| 32.795.20E.104 | CAT50 x STA20E - 104 | 104 | 34 | 34 | 42 | CAT50 x STA1 | STA1 - ER20A - 34 | 3.26 |
| 32.795.20E.140 | CAT50 x STA20E - 140 | 140 | 70 | 34 | 42 | CAT50 x STA1 | STA1 - ER20A - 70 | 3.42 |
| 32.795.32E.135 | CAT50 x STA32E - 135 | 135 | 40 | 50 | 58 | CAT50 x STA2 | STA2 - ER32 - 40 | 3.97 |
| 32.795.32E.165 | CAT50 x STA32E - 165 | 165 | 70 | 50 | 58 | CAT50 x STA2 | STA2 - ER32 - 70 | 4.20 |

Product information:

▶ AD+B type is available, please inform us when making an order.

Standard Accessory: • NUT

| Collet | Nut | Pull Stud | Spanner |
|----------|--------|-----------|-----------|
| | | | |
| P.W-7~28 | P.W-48 | P.W-62 | P.W-68~71 |

DAT / STA SYNCHRONIZED TAPPING HOLDER



DAT / STA 同步補償攻牙刀桿

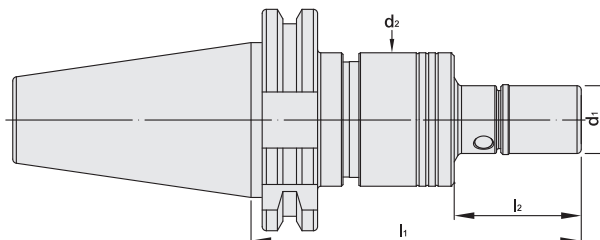

T W PAT NO. M520427
 J P PAT NO. 3203456
 D E PAT NO. Nr.202016100106

| MODEL NO. | TYPE | l ₁ | l ₂ | d ₁ | d ₂ | COMBINATION | | WEIGHT (KGS) |
|----------------|----------------------|----------------|----------------|----------------|----------------|--------------|---------------------|--------------|
| | | | | | | BODY | TAP ADAPTER | |
| 51.795.08T.090 | DAT40 x STA8T - 90 | 90 | 30 | 12 | 42 | DAT40 x STA1 | STA1 - PTER8 - 30 | 1.13 |
| 51.795.08T.130 | DAT40 x STA8T - 130 | 130 | 70 | 12 | 42 | DAT40 x STA1 | STA1 - PTER8 - 70 | 1.19 |
| 51.795.08T.160 | DAT40 x STA8T - 160 | 160 | 100 | 12 | 42 | DAT40 x STA1 | STA1 - PTER8 - 100 | 1.24 |
| 51.795.11T.090 | DAT40 x STA11T - 90 | 90 | 30 | 16 | 42 | DAT40 x STA1 | STA1 - PTER11 - 30 | 1.58 |
| 51.795.11T.130 | DAT40 x STA11T - 130 | 130 | 70 | 16 | 42 | DAT40 x STA1 | STA1 - PTER11 - 70 | 1.64 |
| 51.795.11T.160 | DAT40 x STA11T - 160 | 160 | 100 | 16 | 42 | DAT40 x STA1 | STA1 - PTER11 - 100 | 1.68 |
| 51.795.16T.090 | DAT40 x STA16T - 90 | 90 | 30 | 22 | 42 | DAT40 x STA1 | STA1 - PTER16 - 30 | 1.59 |
| 51.795.16T.130 | DAT40 x STA16T - 130 | 130 | 70 | 22 | 42 | DAT40 x STA1 | STA1 - PTER16 - 70 | 1.65 |
| 51.795.16T.160 | DAT40 x STA16T - 160 | 160 | 100 | 22 | 42 | DAT40 x STA1 | STA1 - PTER16 - 100 | 1.69 |
| 51.795.20T.090 | DAT40 x STA20T - 90 | 90 | 30 | 28 | 42 | DAT40 x STA1 | STA1 - PTER20 - 30 | 1.56 |
| 51.795.20T.130 | DAT40 x STA20T - 130 | 130 | 70 | 28 | 42 | DAT40 x STA1 | STA1 - PTER20 - 70 | 1.83 |
| 51.795.20T.160 | DAT40 x STA20T - 160 | 160 | 100 | 28 | 42 | DAT40 x STA1 | STA1 - PTER20 - 100 | 1.99 |
| 51.795.25T.120 | DAT40 x STA25T - 120 | 120 | 30 | 35 | 58 | DAT40 x STA2 | STA2 - PTER25 - 30 | 2.05 |
| 51.795.25T.160 | DAT40 x STA25T - 160 | 160 | 70 | 35 | 58 | DAT40 x STA2 | STA2 - PTER25 - 70 | 2.32 |
| 51.795.25T.190 | DAT40 x STA25T - 190 | 190 | 100 | 35 | 58 | DAT40 x STA2 | STA2 - PTER25 - 100 | 2.48 |
| 52.795.08T.100 | DAT50 x STA8T - 100 | 100 | 30 | 12 | 42 | DAT50 x STA1 | STA1 - PTER8 - 30 | 2.85 |
| 52.795.08T.140 | DAT50 x STA8T - 140 | 140 | 70 | 12 | 42 | DAT50 x STA1 | STA1 - PTER8 - 70 | 2.91 |
| 52.795.08T.170 | DAT50 x STA8T - 170 | 170 | 100 | 12 | 42 | DAT50 x STA1 | STA1 - PTER8 - 100 | 2.96 |
| 52.795.11T.100 | DAT50 x STA11T - 100 | 100 | 30 | 16 | 42 | DAT50 x STA1 | STA1 - PTER11 - 30 | 3.30 |
| 52.795.11T.140 | DAT50 x STA11T - 140 | 140 | 70 | 16 | 42 | DAT50 x STA1 | STA1 - PTER11 - 70 | 3.36 |
| 52.795.11T.170 | DAT50 x STA11T - 170 | 170 | 100 | 16 | 42 | DAT50 x STA1 | STA1 - PTER11 - 100 | 3.40 |
| 52.795.16T.100 | DAT50 x STA16T - 100 | 100 | 30 | 22 | 42 | DAT50 x STA1 | STA1 - PTER16 - 30 | 3.31 |
| 52.795.16T.140 | DAT50 x STA16T - 140 | 140 | 70 | 22 | 42 | DAT50 x STA1 | STA1 - PTER16 - 70 | 3.37 |
| 52.795.16T.170 | DAT50 x STA16T - 170 | 170 | 100 | 22 | 42 | DAT50 x STA1 | STA1 - PTER16 - 100 | 3.41 |
| 52.795.20T.100 | DAT50 x STA20T - 100 | 100 | 30 | 28 | 42 | DAT50 x STA1 | STA1 - PTER20 - 30 | 3.28 |
| 52.795.20T.140 | DAT50 x STA20T - 140 | 140 | 70 | 28 | 42 | DAT50 x STA1 | STA1 - PTER20 - 70 | 3.55 |
| 52.795.20T.170 | DAT50 x STA20T - 170 | 170 | 100 | 28 | 42 | DAT50 x STA1 | STA1 - PTER20 - 100 | 3.71 |
| 52.795.25T.110 | DAT50 x STA25T - 110 | 110 | 30 | 35 | 58 | DAT50 x STA2 | STA2 - PTER25 - 30 | 3.66 |
| 52.795.25T.150 | DAT50 x STA25T - 150 | 150 | 70 | 35 | 58 | DAT50 x STA2 | STA2 - PTER25 - 70 | 3.93 |
| 52.795.25T.180 | DAT50 x STA25T - 180 | 180 | 100 | 35 | 58 | DAT50 x STA2 | STA2 - PTER25 - 100 | 4.09 |

Product information:

▶ AD+B type is available, please inform us when making an order.

Standard Accessory: • NUT

| Collet | Nut | Pull Stud | Spanner |
|--------|--------|-----------|-----------|
| | | | |
| P.W-5 | P.W-47 | P.W-63 | P.W-68~73 |



DAT / STA SYNCHRONIZED TAPPING HOLDER



DAT / STA 同步補償攻牙刀桿

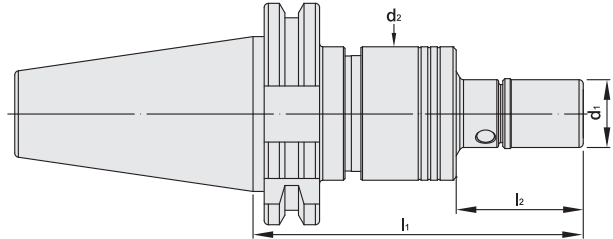

T W PAT NO. M520427
J P PAT NO. 3203456
D E PAT NO. Nr.202016100106

| MODEL NO. | TYPE | l ₁ | l ₂ | d ₁ | d ₂ | COMBINATION | | WEIGHT (KGS) |
|----------------|----------------------|----------------|----------------|----------------|----------------|--------------|-------------------|--------------|
| | | | | | | BODY | TAP ADAPTER | |
| 51.795.16U.100 | DAT40 x STA16U - 100 | 100 | 30 | 30 | 42 | DAT40 x STA1 | STA1 - UT16 - 30 | 1.16 |
| 51.795.16U.140 | DAT40 x STA16U - 140 | 140 | 70 | 30 | 42 | DAT40 x STA1 | STA1 - UT16 - 70 | 1.31 |
| 51.795.16U.170 | DAT40 x STA16U - 170 | 170 | 100 | 30 | 42 | DAT40 x STA1 | STA1 - UT16 - 100 | 1.51 |
| 51.795.20U.120 | DAT40 x STA20U - 120 | 120 | 30 | 36 | 58 | DAT40 x STA2 | STA2 - UT20 - 30 | 1.80 |
| 51.795.20U.160 | DAT40 x STA20U - 160 | 160 | 70 | 36 | 58 | DAT40 x STA2 | STA2 - UT20 - 70 | 2.00 |
| 51.795.20U.190 | DAT40 x STA20U - 190 | 190 | 100 | 36 | 58 | DAT40 x STA2 | STA2 - UT20 - 100 | 2.13 |
| 51.795.25U.125 | DAT40 x STA25U - 125 | 125 | 35 | 42 | 58 | DAT40 x STA2 | STA2 - UT25 - 35 | 1.80 |
| 51.795.25U.175 | DAT40 x STA25U - 175 | 175 | 85 | 42 | 58 | DAT40 x STA2 | STA2 - UT25 - 85 | 2.15 |
| 51.795.25U.205 | DAT40 x STA25U - 205 | 205 | 115 | 42 | 58 | DAT40 x STA2 | STA2 - UT25 - 115 | 2.40 |
| 51.795.32U.140 | DAT40 x STA32U - 140 | 140 | 50 | 48 | 58 | DAT40 x STA2 | STA2 - UT32 - 50 | 1.85 |
| 51.795.32U.175 | DAT40 x STA32U - 175 | 175 | 85 | 48 | 58 | DAT40 x STA2 | STA2 - UT32 - 85 | 2.10 |
| 51.795.32U.205 | DAT40 x STA32U - 205 | 205 | 115 | 48 | 58 | DAT40 x STA2 | STA2 - UT32 - 115 | 2.30 |
| 52.795.16U.090 | DAT50 x STA16U - 90 | 90 | 30 | 30 | 42 | DAT50 x STA1 | STA1 - UT16 - 30 | 2.88 |
| 52.795.16U.130 | DAT50 x STA16U - 130 | 130 | 70 | 30 | 42 | DAT50 x STA1 | STA1 - UT16 - 70 | 3.03 |
| 52.795.16U.160 | DAT50 x STA16U - 160 | 160 | 100 | 30 | 42 | DAT50 x STA1 | STA1 - UT16 - 100 | 3.23 |
| 52.795.20U.110 | DAT50 x STA20U - 110 | 110 | 30 | 36 | 58 | DAT50 x STA2 | STA2 - UT20 - 30 | 3.41 |
| 52.795.20U.150 | DAT50 x STA20U - 150 | 150 | 70 | 36 | 58 | DAT50 x STA2 | STA2 - UT20 - 70 | 3.61 |
| 52.795.20U.180 | DAT50 x STA20U - 180 | 180 | 100 | 36 | 58 | DAT50 x STA2 | STA2 - UT20 - 100 | 3.74 |
| 52.795.25U.115 | DAT50 x STA25U - 115 | 115 | 35 | 42 | 58 | DAT50 x STA2 | STA2 - UT25 - 35 | 3.41 |
| 52.795.25U.165 | DAT50 x STA25U - 165 | 165 | 85 | 42 | 58 | DAT50 x STA2 | STA2 - UT25 - 85 | 3.76 |
| 52.795.25U.195 | DAT50 x STA25U - 195 | 195 | 115 | 42 | 58 | DAT50 x STA2 | STA2 - UT25 - 115 | 4.01 |
| 52.795.32U.130 | DAT50 x STA32U - 130 | 130 | 50 | 48 | 58 | DAT50 x STA2 | STA2 - UT32 - 50 | 3.46 |
| 52.795.32U.165 | DAT50 x STA32U - 165 | 165 | 85 | 48 | 58 | DAT50 x STA2 | STA2 - UT32 - 85 | 3.71 |
| 52.795.32U.195 | DAT50 x STA32U - 195 | 195 | 115 | 48 | 58 | DAT50 x STA2 | STA2 - UT32 - 115 | 3.91 |

Product information:

► AD+B type is available, please inform us when making an order.

Standard Accessory: • NUT

| Collet | Nut | Pull Stud | Spanner |
|----------|--------|-----------|-----------|
| | | | |
| P.W-7~10 | P.W-47 | P.W-63 | P.W-68~73 |



DAT / STA SYNCHRONIZED TAPPING HOLDER



DAT / STA 同步補償攻牙刀桿

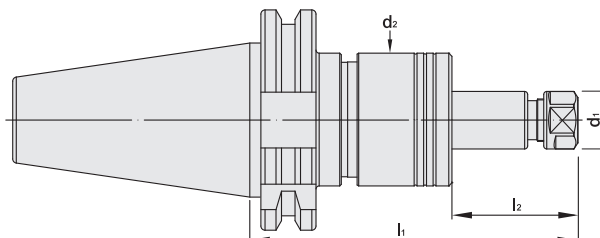

T W PAT NO. M520427
 J P PAT NO. 3203456
 D E PAT NO. Nr.202016100106

| MODEL NO. | TYPE | l ₁ | l ₂ | d ₁ | d ₂ | COMBINATION | | WEIGHT (KGS) |
|----------------|----------------------|----------------|----------------|----------------|----------------|--------------|--------------------|--------------|
| | | | | | | BODY | TAP ADAPTER | |
| 51.795.11E.130 | DAT40 x STA11E - 130 | 130 | 70 | 19 | 42 | DAT40 x STA1 | STA1 - ER11A - 70 | 1.37 |
| 51.795.16E.085 | DAT40 x STA16E - 85 | 85 | 25 | 28 | 42 | DAT40 x STA1 | STA1 - ER16A - 25 | 1.11 |
| 51.795.16E.130 | DAT40 x STA16E - 130 | 130 | 70 | 28 | 42 | DAT40 x STA1 | STA1 - ER16A - 70 | 1.31 |
| 51.795.16E.210 | DAT40 x STA16E - 210 | 210 | 150 | 28 | 58 | DAT40 x STA2 | STA1 - ER16A - 150 | 2.13 |
| 51.795.20E.094 | DAT40 x STA20E - 94 | 94 | 34 | 34 | 58 | DAT40 x STA2 | STA1 - ER20A - 34 | 1.64 |
| 51.795.20E.130 | DAT40 x STA20E - 130 | 130 | 70 | 34 | 58 | DAT40 x STA2 | STA1 - ER20A - 70 | 1.80 |
| 51.795.32E.130 | DAT40 x STA32E - 130 | 130 | 40 | 50 | 58 | DAT40 x STA2 | STA2 - ER32 - 40 | 1.94 |
| 51.795.32E.160 | DAT40 x STA32E - 160 | 160 | 70 | 50 | 58 | DAT40 x STA2 | STA2 - ER32 - 70 | 2.17 |
| 52.795.11E.130 | DAT50 x STA11E - 130 | 130 | 70 | 19 | 58 | DAT40 x STA2 | STA1 - ER11A - 70 | 1.86 |
| 52.795.16E.085 | DAT50 x STA16E - 85 | 85 | 25 | 28 | 58 | DAT40 x STA2 | STA1 - ER16A - 25 | 1.60 |
| 52.795.16E.130 | DAT50 x STA16E - 130 | 130 | 70 | 28 | 58 | DAT40 x STA2 | STA1 - ER16A - 70 | 1.80 |
| 52.795.16E.210 | DAT50 x STA16E - 210 | 210 | 150 | 28 | 58 | DAT40 x STA2 | STA1 - ER16A - 150 | 2.13 |
| 52.795.20E.094 | DAT50 x STA20E - 94 | 94 | 34 | 34 | 42 | DAT50 x STA1 | STA1 - ER20A - 34 | 2.87 |
| 52.795.20E.130 | DAT50 x STA20E - 130 | 130 | 70 | 34 | 42 | DAT50 x STA1 | STA1 - ER20A - 70 | 3.03 |
| 52.795.32E.120 | DAT50 x STA32E - 120 | 120 | 40 | 50 | 42 | DAT50 x STA1 | STA2 - ER32 - 40 | 3.17 |
| 52.795.32E.150 | DAT50 x STA32E - 150 | 150 | 70 | 50 | 58 | DAT50 x STA2 | STA2 - ER32 - 70 | 3.78 |

Product information:

► AD+B type is available, please inform us when making an order.

Standard Accessory: • NUT

| Collet | Nut | Pull Stud | Spanner |
|----------|--------|-----------|-----------|
| | | | |
| P.W-7~28 | P.W-48 | P.W-63 | P.W-68~71 |



SBT / STA SYNCHRONIZED TAPPING HOLDER



SBT / STA 法蘭加厚型同步補償攻牙刀桿

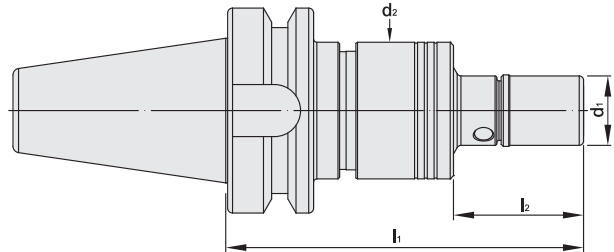

T W PAT NO. M520427
J P PAT NO. 3203456
D E PAT NO. Nr.202016100106

| MODEL NO. | TYPE | l ₁ | l ₂ | d ₁ | d ₂ | COMBINATION | | WEIGHT (KGS) |
|----------------|----------------------|----------------|----------------|----------------|----------------|--------------|---------------------|--------------|
| | | | | | | BODY | TAP ADAPTER | |
| 25.795.08T.090 | SBT30 x STA8T - 90 | 90 | 30 | 12 | 42 | SBT30 x STA1 | STA1 - PTER8 - 30 | 0.68 |
| 25.795.08T.130 | SBT30 x STA8T - 130 | 130 | 70 | 12 | 42 | SBT30 x STA1 | STA1 - PTER8 - 70 | 0.74 |
| 25.795.08T.160 | SBT30 x STA8T - 160 | 160 | 100 | 12 | 42 | SBT30 x STA1 | STA1 - PTER8 - 100 | 0.79 |
| 25.795.11T.090 | SBT30 x STA11T - 90 | 90 | 30 | 16 | 42 | SBT30 x STA1 | STA1 - PTER11 - 30 | 1.13 |
| 25.795.11T.130 | SBT30 x STA11T - 130 | 130 | 70 | 16 | 42 | SBT30 x STA1 | STA1 - PTER11 - 70 | 1.19 |
| 25.795.11T.160 | SBT30 x STA11T - 160 | 160 | 100 | 16 | 42 | SBT30 x STA1 | STA1 - PTER11 - 100 | 1.23 |
| 25.795.16T.090 | SBT30 x STA16T - 90 | 90 | 30 | 22 | 42 | SBT30 x STA1 | STA1 - PTER16 - 30 | 1.14 |
| 25.795.16T.130 | SBT30 x STA16T - 130 | 130 | 70 | 22 | 42 | SBT30 x STA1 | STA1 - PTER16 - 70 | 1.20 |
| 25.795.16T.160 | SBT30 x STA16T - 160 | 160 | 100 | 22 | 42 | SBT30 x STA1 | STA1 - PTER16 - 100 | 1.24 |
| 25.795.20T.090 | SBT30 x STA20T - 90 | 90 | 30 | 28 | 42 | SBT30 x STA1 | STA1 - PTER20 - 30 | 1.11 |
| 25.795.20T.130 | SBT30 x STA20T - 130 | 130 | 70 | 28 | 42 | SBT30 x STA1 | STA1 - PTER20 - 70 | 1.38 |
| 25.795.20T.160 | SBT30 x STA20T - 160 | 160 | 100 | 28 | 42 | SBT30 x STA1 | STA1 - PTER20 - 100 | 1.54 |
| 26.795.08T.100 | SBT40 x STA8T - 100 | 100 | 30 | 12 | 42 | SBT40 x STA1 | STA1 - PTER8 - 30 | 1.30 |
| 26.795.08T.140 | SBT40 x STA8T - 140 | 140 | 70 | 12 | 42 | SBT40 x STA1 | STA1 - PTER8 - 70 | 1.36 |
| 26.795.08T.170 | SBT40 x STA8T - 170 | 170 | 100 | 12 | 42 | SBT40 x STA1 | STA1 - PTER8 - 100 | 1.41 |
| 26.795.11T.100 | SBT40 x STA11T - 100 | 100 | 30 | 16 | 42 | SBT40 x STA1 | STA1 - PTER11 - 30 | 1.75 |
| 26.795.11T.140 | SBT40 x STA11T - 140 | 140 | 70 | 16 | 42 | SBT40 x STA1 | STA1 - PTER11 - 70 | 1.81 |
| 26.795.11T.170 | SBT40 x STA11T - 170 | 170 | 100 | 16 | 42 | SBT40 x STA1 | STA1 - PTER11 - 100 | 1.85 |
| 26.795.16T.100 | SBT40 x STA16T - 100 | 100 | 30 | 22 | 42 | SBT40 x STA1 | STA1 - PTER16 - 30 | 1.76 |
| 26.795.16T.140 | SBT40 x STA16T - 140 | 140 | 70 | 22 | 42 | SBT40 x STA1 | STA1 - PTER16 - 70 | 1.82 |
| 26.795.16T.170 | SBT40 x STA16T - 170 | 170 | 100 | 22 | 42 | SBT40 x STA1 | STA1 - PTER16 - 100 | 1.86 |
| 26.795.20T.100 | SBT40 x STA20T - 100 | 100 | 30 | 28 | 42 | SBT40 x STA1 | STA1 - PTER20 - 30 | 1.73 |
| 26.795.20T.140 | SBT40 x STA20T - 140 | 140 | 70 | 28 | 42 | SBT40 x STA1 | STA1 - PTER20 - 70 | 2.00 |
| 26.795.20T.170 | SBT40 x STA20T - 170 | 170 | 100 | 28 | 42 | SBT40 x STA1 | STA1 - PTER20 - 100 | 2.16 |
| 26.795.25T.115 | SBT40 x STA25T - 115 | 115 | 30 | 35 | 58 | SBT40 x STA2 | STA2 - PTER25 - 30 | 2.03 |
| 26.795.25T.155 | SBT40 x STA25T - 155 | 155 | 70 | 35 | 58 | SBT40 x STA2 | STA2 - PTER25 - 70 | 2.30 |
| 26.795.25T.185 | SBT40 x STA25T - 185 | 185 | 100 | 35 | 58 | SBT40 x STA2 | STA2 - PTER25 - 100 | 2.46 |

Product information:

- ▶ AD+B type is available, please inform us when making an order.
- ▶ SBT30 tool holders are without coolant supply over collars.

Standard Accessory: • NUT

| Collet | Nut | Pull Stud | Spanner |
|--------|--------|-----------|-----------|
| | | | |
| P.W-5 | P.W-47 | P.W-60~61 | P.W-68~73 |



SBT / STA SYNCHRONIZED TAPPING HOLDER



SBT / STA 法蘭加厚型同步補償攻牙刀桿

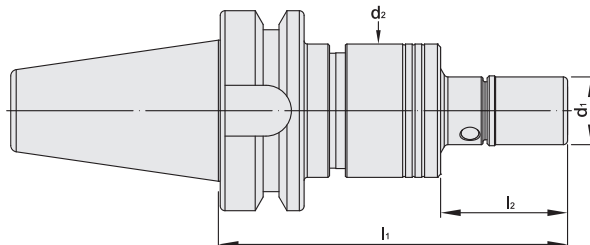

T W PAT NO. M520427
 J P PAT NO. 3203456
 D E PAT NO. Nr.202016100106

| MODEL NO. | TYPE | l ₁ | l ₂ | d ₁ | d ₂ | COMBINATION | | WEIGHT (KGS) |
|----------------|----------------------|----------------|----------------|----------------|----------------|--------------|---------------------|--------------|
| | | | | | | BODY | TAP ADAPTER | |
| 27.795.08T.090 | SBT50 x STA8T - 90 | 90 | 30 | 12 | 42 | SBT50 x STA1 | STA1 - PTER8 - 30 | 3.80 |
| 27.795.08T.130 | SBT50 x STA8T - 130 | 130 | 70 | 12 | 42 | SBT50 x STA1 | STA1 - PTER8 - 70 | 3.86 |
| 27.795.08T.160 | SBT50 x STA8T - 160 | 160 | 100 | 12 | 42 | SBT50 x STA1 | STA1 - PTER8 - 100 | 3.91 |
| 27.795.11T.090 | SBT50 x STA11T - 90 | 90 | 30 | 16 | 42 | SBT50 x STA1 | STA1 - PTER11 - 30 | 4.25 |
| 27.795.11T.130 | SBT50 x STA11T - 130 | 130 | 70 | 16 | 42 | SBT50 x STA1 | STA1 - PTER11 - 70 | 4.31 |
| 27.795.11T.160 | SBT50 x STA11T - 160 | 160 | 100 | 16 | 42 | SBT50 x STA1 | STA1 - PTER11 - 100 | 4.35 |
| 27.795.16T.090 | SBT50 x STA16T - 90 | 90 | 30 | 22 | 42 | SBT50 x STA1 | STA1 - PTER16 - 30 | 4.26 |
| 27.795.16T.130 | SBT50 x STA16T - 130 | 130 | 70 | 22 | 42 | SBT50 x STA1 | STA1 - PTER16 - 70 | 4.32 |
| 27.795.16T.160 | SBT50 x STA16T - 160 | 160 | 100 | 22 | 42 | SBT50 x STA1 | STA1 - PTER16 - 100 | 4.36 |
| 27.795.20T.090 | SBT50 x STA20T - 90 | 90 | 30 | 28 | 42 | SBT50 x STA1 | STA1 - PTER20 - 30 | 4.23 |
| 27.795.20T.130 | SBT50 x STA20T - 130 | 130 | 70 | 28 | 42 | SBT50 x STA1 | STA1 - PTER20 - 70 | 4.50 |
| 27.795.20T.160 | SBT50 x STA20T - 160 | 160 | 100 | 28 | 42 | SBT50 x STA1 | STA1 - PTER20 - 100 | 4.66 |
| 27.795.25T.125 | SBT50 x STA25T - 125 | 125 | 30 | 35 | 58 | SBT50 x STA2 | STA2 - PTER25 - 30 | 4.53 |
| 27.795.25T.165 | SBT50 x STA25T - 165 | 165 | 70 | 35 | 58 | SBT50 x STA2 | STA2 - PTER25 - 70 | 4.80 |
| 27.795.25T.195 | SBT50 x STA25T - 195 | 195 | 100 | 35 | 58 | SBT50 x STA2 | STA2 - PTER25 - 100 | 4.96 |

Product information:

► AD+B type is available, please inform us when making an order.

Standard Accessory: • NUT

| Collet | Nut | Pull Stud | Spanner |
|--------|--------|-----------|-----------|
| | | | |
| P.W-5 | P.W-47 | P.W-60~61 | P.W-68~73 |



SBT / STA SYNCHRONIZED TAPPING HOLDER



SBT / STA 法蘭加厚型同步補償攻牙刀桿

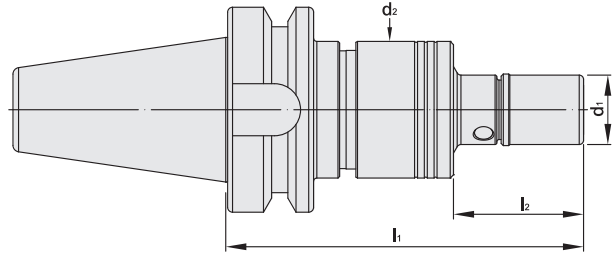

T W PAT NO. M520427
J P PAT NO. 3203456
D E PAT NO. Nr.202016100106

| MODEL NO. | TYPE | l ₁ | l ₂ | d ₁ | d ₂ | COMBINATION | | WEIGHT (KGS) |
|----------------|----------------------|----------------|----------------|----------------|----------------|--------------|-------------------|--------------|
| | | | | | | BODY | TAP ADAPTER | |
| 25.795.16U.090 | SBT30 x STA16U - 90 | 90 | 30 | 30 | 42 | SBT30 x STA1 | STA1 - UT16 - 30 | 0.71 |
| 25.795.16U.130 | SBT30 x STA16U - 130 | 130 | 70 | 30 | 42 | SBT30 x STA1 | STA1 - UT16 - 70 | 0.86 |
| 25.795.16U.160 | SBT30 x STA16U - 160 | 160 | 100 | 30 | 42 | SBT30 x STA1 | STA1 - UT16 - 100 | 1.06 |
| 26.795.16U.100 | SBT40 x STA16U - 100 | 100 | 30 | 30 | 42 | SBT40 x STA1 | STA1 - UT16 - 30 | 1.33 |
| 26.795.16U.140 | SBT40 x STA16U - 140 | 140 | 70 | 30 | 42 | SBT40 x STA1 | STA1 - UT16 - 70 | 1.48 |
| 26.795.16U.170 | SBT40 x STA16U - 170 | 170 | 100 | 30 | 42 | SBT40 x STA1 | STA1 - UT16 - 100 | 1.68 |
| 26.795.20U.115 | SBT40 x STA20U - 115 | 115 | 30 | 36 | 58 | SBT40 x STA2 | STA2 - UT20 - 30 | 1.78 |
| 26.795.20U.155 | SBT40 x STA20U - 155 | 155 | 70 | 36 | 58 | SBT40 x STA2 | STA2 - UT20 - 70 | 1.98 |
| 26.795.20U.185 | SBT40 x STA20U - 185 | 185 | 100 | 36 | 58 | SBT40 x STA2 | STA2 - UT20 - 100 | 2.11 |
| 26.795.25U.120 | SBT40 x STA25U - 120 | 120 | 35 | 42 | 58 | SBT40 x STA2 | STA2 - UT25 - 35 | 1.78 |
| 26.795.25U.170 | SBT40 x STA25U - 170 | 170 | 85 | 42 | 58 | SBT40 x STA2 | STA2 - UT25 - 85 | 2.13 |
| 26.795.25U.200 | SBT40 x STA25U - 200 | 200 | 115 | 42 | 58 | SBT40 x STA2 | STA2 - UT25 - 115 | 2.38 |
| 26.795.32U.135 | SBT40 x STA32U - 135 | 135 | 50 | 48 | 58 | SBT40 x STA2 | STA2 - UT32 - 50 | 1.83 |
| 26.795.32U.170 | SBT40 x STA32U - 170 | 170 | 85 | 48 | 58 | SBT40 x STA2 | STA2 - UT32 - 85 | 2.08 |
| 26.795.32U.200 | SBT40 x STA32U - 200 | 200 | 115 | 48 | 58 | SBT40 x STA2 | STA2 - UT32 - 115 | 2.28 |
| 27.795.16U.090 | SBT50 x STA16U - 90 | 90 | 30 | 30 | 42 | SBT50 x STA1 | STA1 - UT16 - 30 | 3.83 |
| 27.795.16U.130 | SBT50 x STA16U - 130 | 130 | 70 | 30 | 42 | SBT50 x STA1 | STA1 - UT16 - 70 | 3.98 |
| 27.795.16U.160 | SBT50 x STA16U - 160 | 160 | 100 | 30 | 42 | SBT50 x STA1 | STA1 - UT16 - 100 | 4.18 |
| 27.795.20U.125 | SBT50 x STA20U - 125 | 125 | 30 | 36 | 58 | SBT50 x STA2 | STA2 - UT20 - 30 | 4.28 |
| 27.795.20U.165 | SBT50 x STA20U - 165 | 165 | 70 | 36 | 58 | SBT50 x STA2 | STA2 - UT20 - 70 | 4.48 |
| 27.795.20U.195 | SBT50 x STA20U - 195 | 195 | 100 | 36 | 58 | SBT50 x STA2 | STA2 - UT20 - 100 | 4.61 |
| 27.795.25U.130 | SBT50 x STA25U - 130 | 130 | 35 | 42 | 58 | SBT50 x STA2 | STA2 - UT25 - 35 | 4.28 |
| 27.795.25U.180 | SBT50 x STA25U - 180 | 180 | 85 | 42 | 58 | SBT50 x STA2 | STA2 - UT25 - 85 | 4.63 |
| 27.795.25U.210 | SBT50 x STA25U - 210 | 210 | 115 | 42 | 58 | SBT50 x STA2 | STA2 - UT25 - 115 | 4.88 |
| 27.795.32U.145 | SBT50 x STA32U - 145 | 145 | 50 | 48 | 58 | SBT50 x STA2 | STA2 - UT32 - 50 | 4.33 |
| 27.795.32U.180 | SBT50 x STA32U - 180 | 180 | 85 | 48 | 58 | SBT50 x STA2 | STA2 - UT32 - 85 | 4.58 |
| 27.795.32U.210 | SBT50 x STA32U - 210 | 210 | 115 | 48 | 58 | SBT50 x STA2 | STA2 - UT32 - 115 | 4.78 |

Product information:

- ▶ AD+B type is available, please inform us when making an order.
- ▶ SBT30 tool holders are without coolant supply over collars.

Standard Accessory: • NUT

| Collet | Nut | Pull Stud | Spanner |
|----------|--------|-----------|-----------|
| | | | |
| P.W-7~10 | P.W-47 | P.W-60~61 | P.W-68~73 |



SBT / STA SYNCHRONIZED TAPPING HOLDER



SBT / STA 法蘭加厚型同步補償攻牙刀桿

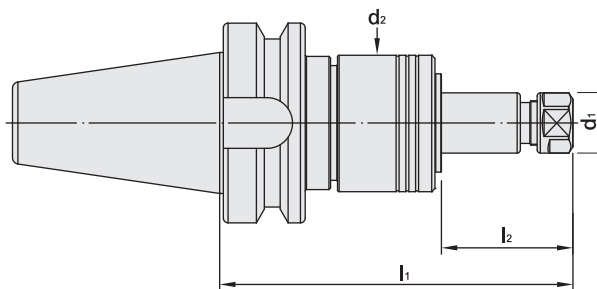

T W PAT NO. M520427
J P PAT NO. 3203456
D E PAT NO. Nr.202016100106

| MODEL NO. | TYPE | l ₁ | l ₂ | d ₁ | d ₂ | COMBINATION | | WEIGHT (KGS) |
|----------------|----------------------|----------------|----------------|----------------|----------------|--------------|--------------------|--------------|
| | | | | | | BODY | TAP ADAPTER | |
| 25.795.11E.130 | SBT30 x STA11E - 130 | 130 | 70 | 19 | 42 | SBT30 x STA1 | STA1 - ER11A - 70 | 0.92 |
| 25.795.16E.085 | SBT30 x STA16E - 85 | 85 | 25 | 28 | 42 | SBT30 x STA1 | STA1 - ER16A - 25 | 0.66 |
| 25.795.16E.130 | SBT30 x STA16E - 130 | 130 | 70 | 28 | 42 | SBT30 x STA1 | STA1 - ER16A - 70 | 0.86 |
| 25.795.16E.210 | SBT30 x STA16E - 210 | 210 | 150 | 28 | 42 | SBT30 x STA1 | STA1 - ER16A - 150 | 1.19 |
| 25.795.20E.094 | SBT30 x STA20E - 94 | 94 | 34 | 34 | 42 | SBT30 x STA1 | STA1 - ER20A - 34 | 0.70 |
| 25.795.20E.130 | SBT30 x STA20E - 130 | 130 | 70 | 34 | 42 | SBT30 x STA1 | STA1 - ER20A - 70 | 0.86 |
| 26.795.11E.140 | SBT40 x STA11E - 140 | 140 | 70 | 19 | 42 | SBT40 x STA1 | STA1 - ER11A - 70 | 1.54 |
| 26.795.16E.095 | SBT40 x STA16E - 95 | 95 | 25 | 28 | 42 | SBT40 x STA1 | STA1 - ER16A - 25 | 1.28 |
| 26.795.16E.140 | SBT40 x STA16E - 140 | 140 | 70 | 28 | 42 | SBT40 x STA1 | STA1 - ER16A - 70 | 1.48 |
| 26.795.16E.220 | SBT40 x STA16E - 220 | 220 | 150 | 28 | 42 | SBT40 x STA1 | STA1 - ER16A - 150 | 1.81 |
| 26.795.20E.104 | SBT40 x STA20E - 104 | 104 | 34 | 34 | 42 | SBT40 x STA1 | STA1 - ER20A - 34 | 1.32 |
| 26.795.20E.140 | SBT40 x STA20E - 140 | 140 | 70 | 34 | 42 | SBT40 x STA1 | STA1 - ER20A - 70 | 1.48 |
| 26.795.32E.125 | SBT40 x STA32E - 125 | 125 | 40 | 50 | 58 | SBT40 x STA2 | STA2 - ER32 - 40 | 1.92 |
| 26.795.32E.155 | SBT40 x STA32E - 155 | 155 | 70 | 50 | 58 | SBT40 x STA2 | STA2 - ER32 - 70 | 2.15 |
| 27.795.11E.130 | SBT50 x STA11E - 130 | 130 | 70 | 19 | 42 | SBT40 x STA1 | STA1 - ER11A - 70 | 1.54 |
| 27.795.16E.085 | SBT50 x STA16E - 85 | 85 | 25 | 28 | 42 | SBT50 x STA1 | STA1 - ER16A - 25 | 3.78 |
| 27.795.16E.130 | SBT50 x STA16E - 130 | 130 | 70 | 28 | 42 | SBT50 x STA1 | STA1 - ER16A - 70 | 3.98 |
| 27.795.16E.210 | SBT50 x STA16E - 210 | 210 | 150 | 28 | 42 | SBT50 x STA1 | STA1 - ER16A - 150 | 4.31 |
| 27.795.20E.094 | SBT50 x STA20E - 94 | 94 | 34 | 34 | 42 | SBT50 x STA1 | STA1 - ER20A - 34 | 3.82 |
| 27.795.20E.140 | SBT50 x STA20E - 140 | 140 | 70 | 34 | 42 | SBT50 x STA1 | STA1 - ER20A - 70 | 3.98 |
| 27.795.32E.135 | SBT50 x STA32E - 135 | 135 | 40 | 50 | 58 | SBT50 x STA2 | STA2 - ER32 - 40 | 4.42 |
| 27.795.32E.165 | SBT50 x STA32E - 165 | 165 | 70 | 50 | 58 | SBT50 x STA2 | STA2 - ER32 - 70 | 4.65 |

Product information:

- ▶ AD+B type is available, please inform us when making an order.
- ▶ SBT30 tool holders are without coolant supply over collars.

Standard Accessory: • NUT

| Collet | Nut | Pull Stud | Spanner |
|----------|--------|-----------|-----------|
| | | | |
| P.W-7~28 | P.W-48 | P.W-60~61 | P.W-68~71 |



SCAT / STA SYNCHRONIZED TAPPING HOLDER



SCAT / STA 法蘭加厚型同步補償攻牙刀桿

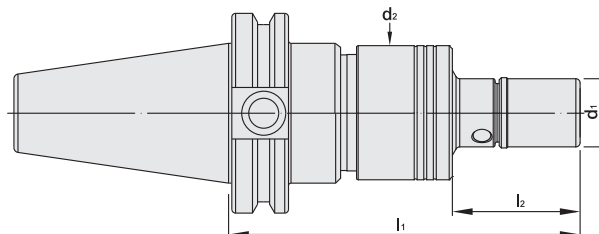

T W PAT NO. M520427
J P PAT NO. 3203456
D E PAT NO. Nr.202016100106

| MODEL NO. | TYPE | l ₁ | l ₂ | d ₁ | d ₂ | COMBINATION | | WEIGHT (KGS) |
|----------------|-----------------------|----------------|----------------|----------------|----------------|---------------|---------------------|--------------|
| | | | | | | BODY | TAP ADAPTER | |
| 43.795.08T.100 | SCAT40 x STA8T - 100 | 100 | 30 | 12 | 42 | SCAT40 x STA1 | STA1 - PTER8 - 30 | 1.24 |
| 43.795.08T.140 | SCAT40 x STA8T - 140 | 140 | 70 | 12 | 42 | SCAT40 x STA1 | STA1 - PTER8 - 70 | 1.30 |
| 43.795.08T.170 | SCAT40 x STA8T - 170 | 170 | 100 | 12 | 42 | SCAT40 x STA1 | STA1 - PTER8 - 100 | 1.35 |
| 43.795.11T.100 | SCAT40 x STA11T - 100 | 100 | 30 | 16 | 42 | SCAT40 x STA1 | STA1 - PTER11 - 30 | 1.69 |
| 43.795.11T.140 | SCAT40 x STA11T - 140 | 140 | 70 | 16 | 42 | SCAT40 x STA1 | STA1 - PTER11 - 70 | 1.75 |
| 43.795.11T.170 | SCAT40 x STA11T - 170 | 170 | 100 | 16 | 42 | SCAT40 x STA1 | STA1 - PTER11 - 100 | 1.79 |
| 43.795.16T.100 | SCAT40 x STA16T - 100 | 100 | 30 | 22 | 42 | SCAT40 x STA1 | STA1 - PTER16 - 30 | 1.70 |
| 43.795.16T.140 | SCAT40 x STA16T - 140 | 140 | 70 | 22 | 42 | SCAT40 x STA1 | STA1 - PTER16 - 70 | 1.76 |
| 43.795.16T.170 | SCAT40 x STA16T - 170 | 170 | 100 | 22 | 42 | SCAT40 x STA1 | STA1 - PTER16 - 100 | 1.80 |
| 43.795.20T.100 | SCAT40 x STA20T - 100 | 100 | 30 | 28 | 42 | SCAT40 x STA1 | STA1 - PTER20 - 30 | 1.67 |
| 43.795.20T.140 | SCAT40 x STA20T - 140 | 140 | 70 | 28 | 42 | SCAT40 x STA1 | STA1 - PTER20 - 70 | 1.94 |
| 43.795.20T.170 | SCAT40 x STA20T - 170 | 170 | 100 | 28 | 42 | SCAT40 x STA1 | STA1 - PTER20 - 100 | 2.10 |
| 43.795.25T.120 | SCAT40 x STA25T - 120 | 120 | 30 | 35 | 58 | SCAT40 x STA2 | STA2 - PTER25 - 30 | 2.00 |
| 43.795.25T.160 | SCAT40 x STA25T - 160 | 160 | 70 | 35 | 58 | SCAT40 x STA2 | STA2 - PTER25 - 70 | 2.27 |
| 43.795.25T.190 | SCAT40 x STA25T - 190 | 190 | 100 | 35 | 58 | SCAT40 x STA2 | STA2 - PTER25 - 100 | 2.43 |
| 44.795.08T.100 | SCAT50 x STA8T - 100 | 100 | 30 | 12 | 42 | SCAT50 x STA1 | STA1 - PTER8 - 30 | 3.24 |
| 44.795.08T.140 | SCAT50 x STA8T - 140 | 140 | 70 | 12 | 42 | SCAT50 x STA1 | STA1 - PTER8 - 70 | 3.30 |
| 44.795.08T.170 | SCAT50 x STA8T - 170 | 170 | 100 | 12 | 42 | SCAT50 x STA1 | STA1 - PTER8 - 100 | 3.35 |
| 44.795.11T.100 | SCAT50 x STA11T - 100 | 100 | 30 | 16 | 42 | SCAT50 x STA1 | STA1 - PTER11 - 30 | 3.69 |
| 44.795.11T.140 | SCAT50 x STA11T - 140 | 140 | 70 | 16 | 42 | SCAT50 x STA1 | STA1 - PTER11 - 70 | 3.75 |
| 44.795.11T.170 | SCAT50 x STA11T - 170 | 170 | 100 | 16 | 42 | SCAT50 x STA1 | STA1 - PTER11 - 100 | 3.79 |
| 44.795.16T.100 | SCAT50 x STA16T - 100 | 100 | 30 | 22 | 42 | SCAT50 x STA1 | STA1 - PTER16 - 30 | 3.70 |
| 44.795.16T.140 | SCAT50 x STA16T - 140 | 140 | 70 | 22 | 42 | SCAT50 x STA1 | STA1 - PTER16 - 70 | 3.76 |
| 44.795.16T.170 | SCAT50 x STA16T - 170 | 170 | 100 | 22 | 42 | SCAT50 x STA1 | STA1 - PTER16 - 100 | 3.80 |
| 44.795.20T.100 | SCAT50 x STA20T - 100 | 100 | 30 | 28 | 42 | SCAT50 x STA1 | STA1 - PTER20 - 30 | 3.67 |
| 44.795.20T.140 | SCAT50 x STA20T - 140 | 140 | 70 | 28 | 42 | SCAT50 x STA1 | STA1 - PTER20 - 70 | 3.94 |
| 44.795.20T.170 | SCAT50 x STA20T - 170 | 170 | 100 | 28 | 42 | SCAT50 x STA1 | STA1 - PTER20 - 100 | 4.10 |
| 44.795.25T.125 | SCAT50 x STA25T - 125 | 125 | 30 | 35 | 58 | SCAT50 x STA2 | STA2 - PTER25 - 30 | 4.08 |
| 44.795.25T.165 | SCAT50 x STA25T - 165 | 165 | 70 | 35 | 58 | SCAT50 x STA2 | STA2 - PTER25 - 70 | 4.35 |
| 44.795.25T.195 | SCAT50 x STA25T - 195 | 195 | 100 | 35 | 58 | SCAT50 x STA2 | STA2 - PTER25 - 100 | 4.51 |

Product information:

► AD+B type is available, please inform us when making an order.

Standard Accessory: • NUT

| Collet | Nut | Pull Stud | Spanner |
|--------|--------|-----------|-----------|
| | | | |
| P.W-5 | P.W-47 | P.W-62 | P.W-68~73 |



SCAT / STA SYNCHRONIZED TAPPING HOLDER



SCAT / STA 法蘭加厚型同步補償攻牙刀桿

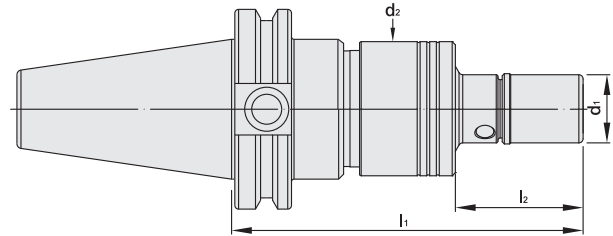

T W PAT NO. M520427
 J P PAT NO. 3203456
 D E PAT NO. Nr.202016100106

| MODEL NO. | TYPE | l ₁ | l ₂ | d ₁ | d ₂ | COMBINATION | | WEIGHT (KGS) |
|----------------|-----------------------|----------------|----------------|----------------|----------------|---------------|-------------------|--------------|
| | | | | | | BODY | TAP ADAPTER | |
| 43.795.16U.100 | SCAT40 x STA16U - 100 | 100 | 30 | 30 | 42 | SCAT40 x STA1 | STA1 - UT16 - 30 | 1.27 |
| 43.795.16U.140 | SCAT40 x STA16U - 140 | 140 | 70 | 30 | 42 | SCAT40 x STA1 | STA1 - UT16 - 70 | 1.42 |
| 43.795.16U.170 | SCAT40 x STA16U - 170 | 170 | 100 | 30 | 42 | SCAT40 x STA1 | STA1 - UT16 - 100 | 1.62 |
| 43.795.20U.120 | SCAT40 x STA20U - 120 | 120 | 30 | 36 | 58 | SCAT40 x STA2 | STA2 - UT20 - 30 | 1.75 |
| 43.795.20U.160 | SCAT40 x STA20U - 160 | 160 | 70 | 36 | 58 | SCAT40 x STA2 | STA2 - UT20 - 70 | 1.95 |
| 43.795.20U.190 | SCAT40 x STA20U - 190 | 190 | 100 | 36 | 58 | SCAT40 x STA2 | STA2 - UT20 - 100 | 2.08 |
| 43.795.25U.125 | SCAT40 x STA25U - 125 | 125 | 35 | 42 | 58 | SCAT40 x STA2 | STA2 - UT25 - 35 | 1.75 |
| 43.795.25U.175 | SCAT40 x STA25U - 175 | 175 | 85 | 42 | 58 | SCAT40 x STA2 | STA2 - UT25 - 85 | 2.10 |
| 43.795.25U.205 | SCAT40 x STA25U - 205 | 205 | 115 | 42 | 58 | SCAT40 x STA2 | STA2 - UT25 - 115 | 2.35 |
| 43.795.32U.140 | SCAT40 x STA32U - 140 | 140 | 50 | 48 | 58 | SCAT40 x STA2 | STA2 - UT32 - 50 | 1.80 |
| 43.795.32U.175 | SCAT40 x STA32U - 175 | 175 | 85 | 48 | 58 | SCAT40 x STA2 | STA2 - UT32 - 85 | 2.05 |
| 43.795.32U.205 | SCAT40 x STA32U - 205 | 205 | 115 | 48 | 58 | SCAT40 x STA2 | STA2 - UT32 - 115 | 2.25 |
| 44.795.16U.100 | SCAT50 x STA16U - 100 | 100 | 30 | 30 | 42 | SCAT50 x STA1 | STA1 - UT16 - 30 | 3.27 |
| 44.795.16U.140 | SCAT50 x STA16U - 140 | 140 | 70 | 30 | 42 | SCAT50 x STA1 | STA1 - UT16 - 70 | 3.42 |
| 44.795.16U.170 | SCAT50 x STA16U - 170 | 170 | 100 | 30 | 42 | SCAT50 x STA1 | STA1 - UT16 - 100 | 3.62 |
| 44.795.20U.125 | SCAT50 x STA20U - 125 | 125 | 30 | 36 | 58 | SCAT50 x STA2 | STA2 - UT20 - 30 | 3.83 |
| 44.795.20U.165 | SCAT50 x STA20U - 165 | 165 | 70 | 36 | 58 | SCAT50 x STA2 | STA2 - UT20 - 70 | 4.03 |
| 44.795.20U.195 | SCAT50 x STA20U - 195 | 195 | 100 | 36 | 58 | SCAT50 x STA2 | STA2 - UT20 - 100 | 4.16 |
| 44.795.25U.130 | SCAT50 x STA25U - 130 | 130 | 35 | 42 | 58 | SCAT50 x STA2 | STA2 - UT25 - 35 | 3.83 |
| 44.795.25U.180 | SCAT50 x STA25U - 180 | 180 | 85 | 42 | 58 | SCAT50 x STA2 | STA2 - UT25 - 85 | 4.18 |
| 44.795.25U.210 | SCAT50 x STA25U - 210 | 210 | 115 | 42 | 58 | SCAT50 x STA2 | STA2 - UT25 - 115 | 4.43 |
| 44.795.32U.145 | SCAT50 x STA32U - 145 | 145 | 50 | 48 | 58 | SCAT50 x STA2 | STA2 - UT32 - 50 | 3.88 |
| 44.795.32U.180 | SCAT50 x STA32U - 180 | 180 | 85 | 48 | 58 | SCAT50 x STA2 | STA2 - UT32 - 85 | 4.13 |
| 44.795.32U.210 | SCAT50 x STA32U - 210 | 210 | 115 | 48 | 58 | SCAT50 x STA2 | STA2 - UT32 - 115 | 4.33 |

Product information:

► AD+B type is available, please inform us when making an order.

Standard Accessory: • NUT

| Collet | Nut | Pull Stud | Spanner |
|----------|--------|-----------|-----------|
| | | | |
| P.W-7~10 | P.W-47 | P.W-62 | P.W-68~73 |



SCAT / STA SYNCHRONIZED TAPPING HOLDER



SCAT / STA 法蘭加厚型同步補償攻牙刀桿

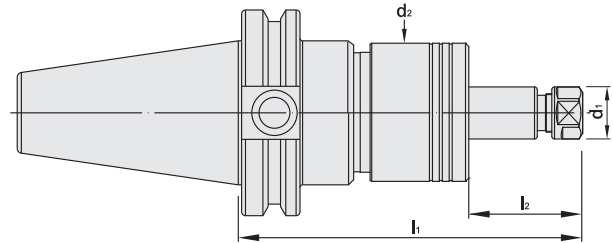

T W PAT NO. M520427
J P PAT NO. 3203456
D E PAT NO. Nr.202016100106

| MODEL NO. | TYPE | l ₁ | l ₂ | d ₁ | d ₂ | COMBINATION | | WEIGHT (KGS) |
|----------------|-----------------------|----------------|----------------|----------------|----------------|---------------|--------------------|--------------|
| | | | | | | BODY | TAP ADAPTER | |
| 43.795.11E.140 | SCAT40 x STA11E - 140 | 140 | 70 | 19 | 42 | SCAT40 x STA1 | STA1 - ER11A - 70 | 1.48 |
| 43.795.16E.095 | SCAT40 x STA16E - 95 | 95 | 25 | 28 | 42 | SCAT40 x STA1 | STA1 - ER16A - 25 | 1.22 |
| 43.795.16E.140 | SCAT40 x STA16E - 140 | 140 | 70 | 28 | 42 | SCAT40 x STA1 | STA1 - ER16A - 70 | 1.42 |
| 43.795.16E.220 | SCAT40 x STA16E - 220 | 220 | 150 | 28 | 42 | SCAT40 x STA1 | STA1 - ER16A - 150 | 1.75 |
| 43.795.20E.104 | SCAT40 x STA20E - 104 | 104 | 34 | 34 | 42 | SCAT40 x STA1 | STA1 - ER20A - 34 | 1.26 |
| 43.795.20E.140 | SCAT40 x STA20E - 140 | 140 | 70 | 34 | 42 | SCAT40 x STA1 | STA1 - ER20A - 70 | 1.42 |
| 43.795.32E.130 | SCAT40 x STA32E - 130 | 130 | 40 | 50 | 58 | SCAT40 x STA2 | STA2 - ER32 - 40 | 1.89 |
| 43.795.32E.160 | SCAT40 x STA32E - 160 | 160 | 70 | 50 | 58 | SCAT40 x STA2 | STA2 - ER32 - 70 | 2.12 |
| 44.795.11E.140 | SCAT50 x STA11E - 140 | 140 | 70 | 19 | 42 | SCAT50 x STA1 | STA1 - ER11A - 70 | 3.48 |
| 44.795.16E.095 | SCAT50 x STA16E - 95 | 95 | 25 | 28 | 42 | SCAT50 x STA1 | STA1 - ER16A - 25 | 3.22 |
| 44.795.16E.140 | SCAT50 x STA16E - 140 | 140 | 70 | 28 | 42 | SCAT50 x STA1 | STA1 - ER16A - 70 | 3.42 |
| 44.795.16E.220 | SCAT50 x STA16E - 220 | 220 | 150 | 28 | 42 | SCAT50 x STA1 | STA1 - ER16A - 150 | 3.75 |
| 44.795.20E.104 | SCAT50 x STA20E - 104 | 104 | 34 | 34 | 42 | SCAT50 x STA1 | STA1 - ER20A - 34 | 3.26 |
| 44.795.20E.140 | SCAT50 x STA20E - 140 | 140 | 70 | 34 | 42 | SCAT50 x STA1 | STA1 - ER20A - 70 | 3.42 |
| 44.795.32E.135 | SCAT50 x STA32E - 135 | 135 | 40 | 50 | 58 | SCAT50 x STA2 | STA2 - ER32 - 40 | 3.97 |
| 44.795.32E.165 | SCAT50 x STA32E - 165 | 165 | 70 | 50 | 58 | SCAT50 x STA2 | STA2 - ER32 - 70 | 4.20 |

Product information:

► AD+B type is available, please inform us when making an order.

Standard Accessory: • NUT

| Collet | Nut | Pull Stud | Spanner |
|----------|--------|-----------|-----------|
| | | | |
| P.W-7~28 | P.W-48 | P.W-62 | P.W-68~71 |



SDAT / STA SYNCHRONIZED TAPPING HOLDER



SDAT / STA 法蘭加厚型同步補償攻牙刀桿

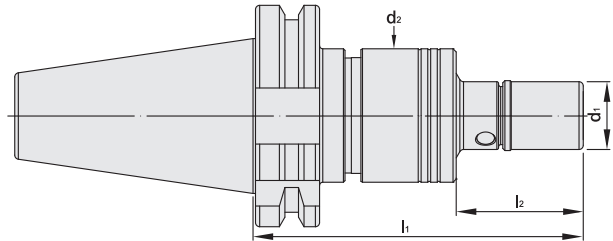

T W PAT NO. M520427
J P PAT NO. 3203456
D E PAT NO. Nr.202016100106

| MODEL NO. | TYPE | l ₁ | l ₂ | d ₁ | d ₂ | COMBINATION | | WEIGHT (KGS) |
|----------------|-----------------------|----------------|----------------|----------------|----------------|---------------|---------------------|--------------|
| | | | | | | BODY | TAP ADAPTER | |
| 66.795.08T.090 | SDAT40 x STA8T - 90 | 90 | 30 | 12 | 42 | SDAT40 x STA1 | STA1 - PTER8 - 30 | 1.13 |
| 66.795.08T.130 | SDAT40 x STA8T - 130 | 130 | 70 | 12 | 42 | SDAT40 x STA1 | STA1 - PTER8 - 70 | 1.19 |
| 66.795.08T.160 | SDAT40 x STA8T - 160 | 160 | 100 | 12 | 42 | SDAT40 x STA1 | STA1 - PTER8 - 100 | 1.24 |
| 66.795.11T.090 | SDAT40 x STA11T - 90 | 90 | 30 | 16 | 42 | SDAT40 x STA1 | STA1 - PTER11 - 30 | 1.58 |
| 66.795.11T.130 | SDAT40 x STA11T - 130 | 130 | 70 | 16 | 42 | SDAT40 x STA1 | STA1 - PTER11 - 70 | 1.64 |
| 66.795.11T.160 | SDAT40 x STA11T - 160 | 160 | 100 | 16 | 42 | SDAT40 x STA1 | STA1 - PTER11 - 100 | 1.68 |
| 66.795.16T.090 | SDAT40 x STA16T - 90 | 90 | 30 | 22 | 42 | SDAT40 x STA1 | STA1 - PTER16 - 30 | 1.59 |
| 66.795.16T.130 | SDAT40 x STA16T - 130 | 130 | 70 | 22 | 42 | SDAT40 x STA1 | STA1 - PTER16 - 70 | 1.65 |
| 66.795.16T.160 | SDAT40 x STA16T - 160 | 160 | 100 | 22 | 42 | SDAT40 x STA1 | STA1 - PTER16 - 100 | 1.69 |
| 66.795.20T.090 | SDAT40 x STA20T - 90 | 90 | 30 | 28 | 42 | SDAT40 x STA1 | STA1 - PTER20 - 30 | 1.56 |
| 66.795.20T.130 | SDAT40 x STA20T - 130 | 130 | 70 | 28 | 42 | SDAT40 x STA1 | STA1 - PTER20 - 70 | 1.83 |
| 66.795.20T.160 | SDAT40 x STA20T - 160 | 160 | 100 | 28 | 42 | SDAT40 x STA1 | STA1 - PTER20 - 100 | 1.99 |
| 66.795.25T.120 | SDAT40 x STA25T - 120 | 120 | 30 | 35 | 58 | SDAT40 x STA2 | STA2 - PTER25 - 30 | 2.05 |
| 66.795.25T.160 | SDAT40 x STA25T - 160 | 160 | 70 | 35 | 58 | SDAT40 x STA2 | STA2 - PTER25 - 70 | 2.32 |
| 66.795.25T.190 | SDAT40 x STA25T - 190 | 190 | 100 | 35 | 58 | SDAT40 x STA2 | STA2 - PTER25 - 100 | 2.48 |
| 67.795.08T.100 | SDAT50 x STA8T - 100 | 100 | 30 | 12 | 42 | SDAT50 x STA1 | STA1 - PTER8 - 30 | 2.85 |
| 67.795.08T.140 | SDAT50 x STA8T - 140 | 140 | 70 | 12 | 42 | SDAT50 x STA1 | STA1 - PTER8 - 70 | 2.91 |
| 67.795.08T.170 | SDAT50 x STA8T - 170 | 170 | 100 | 12 | 42 | SDAT50 x STA1 | STA1 - PTER8 - 100 | 2.96 |
| 67.795.11T.100 | SDAT50 x STA11T - 100 | 100 | 30 | 16 | 42 | SDAT50 x STA1 | STA1 - PTER11 - 30 | 3.30 |
| 67.795.11T.140 | SDAT50 x STA11T - 140 | 140 | 70 | 16 | 42 | SDAT50 x STA1 | STA1 - PTER11 - 70 | 3.36 |
| 67.795.11T.170 | SDAT50 x STA11T - 170 | 170 | 100 | 16 | 42 | SDAT50 x STA1 | STA1 - PTER11 - 100 | 3.40 |
| 67.795.16T.100 | SDAT50 x STA16T - 100 | 100 | 30 | 22 | 42 | SDAT50 x STA1 | STA1 - PTER16 - 30 | 3.31 |
| 67.795.16T.140 | SDAT50 x STA16T - 140 | 140 | 70 | 22 | 42 | SDAT50 x STA1 | STA1 - PTER16 - 70 | 3.37 |
| 67.795.16T.170 | SDAT50 x STA16T - 170 | 170 | 100 | 22 | 42 | SDAT50 x STA1 | STA1 - PTER16 - 100 | 3.41 |
| 67.795.20T.100 | SDAT50 x STA20T - 100 | 100 | 30 | 28 | 42 | SDAT50 x STA1 | STA1 - PTER20 - 30 | 3.28 |
| 67.795.20T.140 | SDAT50 x STA20T - 140 | 140 | 70 | 28 | 42 | SDAT50 x STA1 | STA1 - PTER20 - 70 | 3.55 |
| 67.795.20T.170 | SDAT50 x STA20T - 170 | 170 | 100 | 28 | 42 | SDAT50 x STA1 | STA1 - PTER20 - 100 | 3.71 |
| 67.795.25T.110 | SDAT50 x STA25T - 110 | 110 | 30 | 35 | 58 | SDAT50 x STA2 | STA2 - PTER25 - 30 | 3.66 |
| 67.795.25T.150 | SDAT50 x STA25T - 150 | 150 | 70 | 35 | 58 | SDAT50 x STA2 | STA2 - PTER25 - 70 | 3.93 |
| 67.795.25T.180 | SDAT50 x STA25T - 180 | 180 | 100 | 35 | 58 | SDAT50 x STA2 | STA2 - PTER25 - 100 | 4.09 |

Product information:

► AD+B type is available, please inform us when making an order.

Standard Accessory: • NUT

| Collet | Nut | Pull Stud | Spanner |
|--------|--------|-----------|-----------|
| | | | |
| P.W-5 | P.W-47 | P.W-63 | P.W-68~73 |



SDAT / STA SYNCHRONIZED TAPPING HOLDER



SDAT / STA 法蘭加厚型同步補償攻牙刀桿

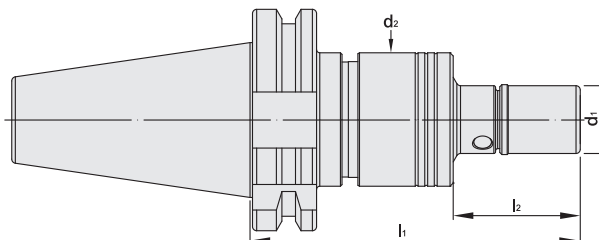

T W PAT NO. M520427
J P PAT NO. 3203456
D E PAT NO. Nr.202016100106

| MODEL NO. | TYPE | l ₁ | l ₂ | d ₁ | d ₂ | COMBINATION | | WEIGHT (KGS) |
|----------------|-----------------------|----------------|----------------|----------------|----------------|---------------|-------------------|--------------|
| | | | | | | BODY | TAP ADAPTER | |
| 66.795.16U.100 | SDAT40 x STA16U- 100 | 100 | 30 | 30 | 42 | SDAT40 x STA1 | STA1 - UT16 - 30 | 1.16 |
| 66.795.16U.140 | SDAT40 x STA16U - 140 | 140 | 70 | 30 | 42 | SDAT40 x STA1 | STA1 - UT16 - 70 | 1.31 |
| 66.795.16U.170 | SDAT40 x STA16U - 170 | 170 | 100 | 30 | 42 | SDAT40 x STA1 | STA1 - UT16 - 100 | 1.51 |
| 66.795.20U.120 | SDAT40 x STA20U - 120 | 120 | 30 | 36 | 58 | SDAT40 x STA2 | STA2 - UT20 - 30 | 1.80 |
| 66.795.20U.160 | SDAT40 x STA20U - 160 | 160 | 70 | 36 | 58 | SDAT40 x STA2 | STA2 - UT20 - 70 | 2.00 |
| 66.795.20U.190 | SDAT40 x STA20U - 190 | 190 | 100 | 36 | 58 | SDAT40 x STA2 | STA2 - UT20 - 100 | 2.13 |
| 66.795.25U.125 | SDAT40 x STA25U - 125 | 125 | 35 | 42 | 58 | SDAT40 x STA2 | STA2 - UT25 - 35 | 1.80 |
| 66.795.25U.175 | SDAT40 x STA25U - 175 | 175 | 85 | 42 | 58 | SDAT40 x STA2 | STA2 - UT25 - 85 | 2.15 |
| 66.795.25U.205 | SDAT40 x STA25U - 205 | 205 | 115 | 42 | 58 | SDAT40 x STA2 | STA2 - UT25 - 115 | 2.40 |
| 66.795.32U.140 | SDAT40 x STA32U - 140 | 140 | 50 | 48 | 58 | SDAT40 x STA2 | STA2 - UT32 - 50 | 1.85 |
| 66.795.32U.175 | SDAT40 x STA32U - 175 | 175 | 85 | 48 | 58 | SDAT40 x STA2 | STA2 - UT32 - 85 | 2.10 |
| 66.795.32U.205 | SDAT40 x STA32U - 205 | 205 | 115 | 48 | 58 | SDAT40 x STA2 | STA2 - UT32 - 115 | 2.30 |
| 67.795.16U.090 | SDAT50 x STA16U - 90 | 90 | 30 | 30 | 42 | SDAT50 x STA1 | STA1 - UT16 - 30 | 2.88 |
| 67.795.16U.130 | SDAT50 x STA16U - 130 | 130 | 70 | 30 | 42 | SDAT50 x STA1 | STA1 - UT16 - 70 | 3.03 |
| 67.795.16U.160 | SDAT50 x STA16U - 160 | 160 | 100 | 30 | 42 | SDAT50 x STA1 | STA1 - UT16 - 100 | 3.23 |
| 67.795.20U.110 | SDAT50 x STA20U - 110 | 110 | 30 | 36 | 58 | SDAT50 x STA2 | STA2 - UT20 - 30 | 3.41 |
| 67.795.20U.150 | SDAT50 x STA20U - 150 | 150 | 70 | 36 | 58 | SDAT50 x STA2 | STA2 - UT20 - 70 | 3.61 |
| 67.795.20U.180 | SDAT50 x STA20U - 180 | 180 | 100 | 36 | 58 | SDAT50 x STA2 | STA2 - UT20 - 100 | 3.74 |
| 67.795.25U.115 | SDAT50 x STA25U - 115 | 115 | 35 | 42 | 58 | SDAT50 x STA2 | STA2 - UT25 - 35 | 3.41 |
| 67.795.25U.165 | SDAT50 x STA25U - 165 | 165 | 85 | 42 | 58 | SDAT50 x STA2 | STA2 - UT25 - 85 | 3.76 |
| 67.795.25U.195 | SDAT50 x STA25U - 195 | 195 | 115 | 42 | 58 | SDAT50 x STA2 | STA2 - UT25 - 115 | 4.01 |
| 67.795.32U.130 | SDAT50 x STA32U - 130 | 130 | 50 | 48 | 58 | SDAT50 x STA2 | STA2 - UT32 - 50 | 3.46 |
| 67.795.32U.165 | SDAT50 x STA32U - 165 | 165 | 85 | 48 | 58 | SDAT50 x STA2 | STA2 - UT32 - 85 | 3.71 |
| 67.795.32U.195 | SDAT50 x STA32U - 195 | 195 | 115 | 48 | 58 | SDAT50 x STA2 | STA2 - UT32 - 115 | 3.91 |

Product information:

► AD+B type is available, please inform us when making an order.

Standard Accessory: • NUT

| Collet | Nut | Pull Stud | Spanner |
|----------|--------|-----------|-----------|
| | | | |
| P.W-7~10 | P.W-47 | P.W-63 | P.W-68~73 |



SDAT / STA SYNCHRONIZED TAPPING HOLDER



SDAT / STA 法蘭加厚型同步補償攻牙刀桿

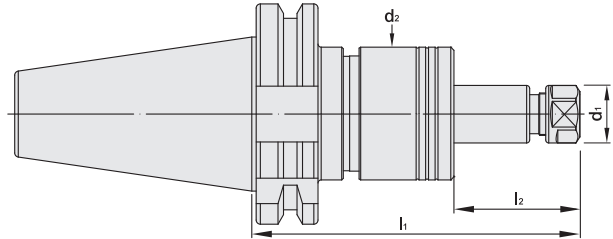

T W PAT NO. M520427
 J P PAT NO. 3203456
 D E PAT NO. Nr.202016100106

| MODEL NO. | TYPE | l ₁ | l ₂ | d ₁ | d ₂ | COMBINATION | | WEIGHT (KGS) |
|----------------|-----------------------|----------------|----------------|----------------|----------------|---------------|--------------------|--------------|
| | | | | | | BODY | TAP ADAPTER | |
| 66.795.11E.130 | SDAT40 x STA11E - 130 | 130 | 70 | 19 | 42 | SDAT40 x STA1 | STA1 - ER11A - 70 | 1.37 |
| 66.795.16E.085 | SDAT40 x STA16E - 85 | 85 | 25 | 28 | 42 | SDAT40 x STA1 | STA1 - ER16A - 25 | 1.11 |
| 66.795.16E.130 | SDAT40 x STA16E - 130 | 130 | 70 | 28 | 42 | SDAT40 x STA1 | STA1 - ER16A - 70 | 1.31 |
| 66.795.16E.210 | SDAT40 x STA16E - 210 | 210 | 150 | 28 | 58 | SDAT40 x STA2 | STA1 - ER16A - 150 | 2.13 |
| 66.795.20E.094 | SDAT40 x STA20E - 94 | 94 | 34 | 34 | 58 | SDAT40 x STA2 | STA1 - ER20A - 34 | 1.64 |
| 66.795.20E.130 | SDAT40 x STA20E - 130 | 130 | 70 | 34 | 58 | SDAT40 x STA2 | STA1 - ER20A - 70 | 1.80 |
| 66.795.32E.130 | SDAT40 x STA32E - 130 | 130 | 40 | 50 | 58 | SDAT40 x STA2 | STA2 - ER32 - 40 | 1.94 |
| 66.795.32E.160 | SDAT40 x STA32E - 160 | 160 | 70 | 50 | 58 | SDAT40 x STA2 | STA2 - ER32 - 70 | 2.17 |
| 67.795.11E.130 | SDAT50 x STA11E - 130 | 130 | 70 | 19 | 58 | SDAT40 x STA2 | STA1 - ER11A - 70 | 1.86 |
| 67.795.16E.085 | SDAT50 x STA16E - 85 | 85 | 25 | 28 | 58 | SDAT40 x STA2 | STA1 - ER16A - 25 | 1.60 |
| 67.795.16E.130 | SDAT50 x STA16E - 130 | 130 | 70 | 28 | 58 | SDAT40 x STA2 | STA1 - ER16A - 70 | 1.80 |
| 67.795.16E.210 | SDAT50 x STA16E - 210 | 210 | 150 | 28 | 58 | SDAT40 x STA2 | STA1 - ER16A - 150 | 2.13 |
| 67.795.20E.094 | SDAT50 x STA20E - 94 | 94 | 34 | 34 | 42 | SDAT50 x STA1 | STA1 - ER20A - 34 | 2.87 |
| 67.795.20E.130 | SDAT50 x STA20E - 130 | 130 | 70 | 34 | 42 | SDAT50 x STA1 | STA1 - ER20A - 70 | 3.03 |
| 67.795.32E.120 | SDAT50 x STA32E - 120 | 120 | 40 | 50 | 42 | SDAT50 x STA1 | STA2 - ER32 - 40 | 3.17 |
| 67.795.32E.150 | SDAT50 x STA32E - 150 | 150 | 70 | 50 | 58 | SDAT50 x STA2 | STA2 - ER32 - 70 | 3.78 |

Product information:

► AD+B type is available, please inform us when making an order.

Standard Accessory: • NUT

| Collet | Nut | Pull Stud | Spanner |
|----------|--------|-----------|-----------|
| | | | |
| P.W-7~28 | P.W-48 | P.W-63 | P.W-68~71 |



HSK / STA SYNCHRONIZED TAPPING HOLDER



HSK / STA 同步補償攻牙刀桿

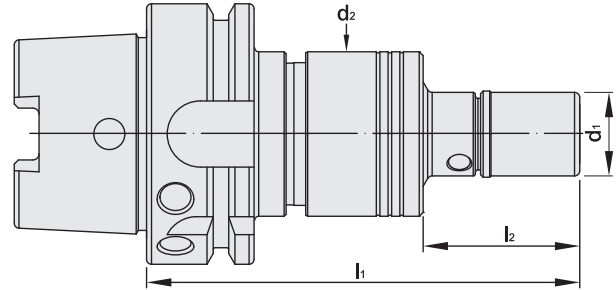

T W PAT NO. M520427
J P PAT NO. 3203456
D E PAT NO. Nr.202016100106

| MODEL NO. | TYPE | l ₁ | l ₂ | d ₁ | d ₂ | COMBINATION | | WEIGHT (KGS) |
|----------------|-----------------------|----------------|----------------|----------------|----------------|---------------|---------------------|--------------|
| | | | | | | BODY | TAP ADAPTER | |
| 71.795.08T.100 | HSK40A x STA8T - 100 | 100 | 30 | 12 | 42 | HSK40A x STA1 | STA1 - PTER8 - 30 | 1.22 |
| 71.795.08T.140 | HSK40A x STA8T - 140 | 140 | 70 | 12 | 42 | HSK40A x STA1 | STA1 - PTER8 - 70 | 1.28 |
| 71.795.08T.170 | HSK40A x STA8T - 170 | 170 | 100 | 12 | 42 | HSK40A x STA1 | STA1 - PTER8 - 100 | 1.33 |
| 71.795.11T.100 | HSK40A x STA11T - 100 | 100 | 30 | 16 | 42 | HSK40A x STA1 | STA1 - PTER11 - 30 | 1.67 |
| 71.795.11T.140 | HSK40A x STA11T - 140 | 140 | 70 | 16 | 42 | HSK40A x STA1 | STA1 - PTER11 - 70 | 1.73 |
| 71.795.11T.170 | HSK40A x STA11T - 170 | 170 | 100 | 16 | 42 | HSK40A x STA1 | STA1 - PTER11 - 100 | 1.77 |
| 71.795.16T.100 | HSK40A x STA16T - 100 | 100 | 30 | 22 | 42 | HSK40A x STA1 | STA1 - PTER16 - 30 | 1.68 |
| 71.795.16T.140 | HSK40A x STA16T - 140 | 140 | 70 | 22 | 42 | HSK40A x STA1 | STA1 - PTER16 - 70 | 1.74 |
| 71.795.16T.170 | HSK40A x STA16T - 170 | 170 | 100 | 22 | 42 | HSK40A x STA1 | STA1 - PTER16 - 100 | 1.78 |
| 71.795.20T.100 | HSK40A x STA20T - 100 | 100 | 30 | 28 | 42 | HSK40A x STA1 | STA1 - PTER20 - 30 | 1.65 |
| 71.795.20T.140 | HSK40A x STA20T - 140 | 140 | 70 | 28 | 42 | HSK40A x STA1 | STA1 - PTER20 - 70 | 1.92 |
| 71.795.20T.170 | HSK40A x STA20T - 170 | 170 | 100 | 28 | 42 | HSK40A x STA1 | STA1 - PTER20 - 100 | 2.08 |
| 72.795.08T.100 | HSK50A x STA8T - 100 | 100 | 30 | 12 | 42 | HSK50A x STA1 | STA1 - PTER8 - 30 | 1.43 |
| 72.795.08T.140 | HSK50A x STA8T - 140 | 140 | 70 | 12 | 42 | HSK50A x STA1 | STA1 - PTER8 - 70 | 1.49 |
| 72.795.08T.170 | HSK50A x STA8T - 170 | 170 | 100 | 12 | 42 | HSK50A x STA1 | STA1 - PTER8 - 100 | 1.54 |
| 72.795.11T.100 | HSK50A x STA11T - 100 | 100 | 30 | 16 | 42 | HSK50A x STA1 | STA1 - PTER11 - 30 | 1.88 |
| 72.795.11T.140 | HSK50A x STA11T - 140 | 140 | 70 | 16 | 42 | HSK50A x STA1 | STA1 - PTER11 - 70 | 1.94 |
| 72.795.11T.170 | HSK50A x STA11T - 170 | 170 | 100 | 16 | 42 | HSK50A x STA1 | STA1 - PTER11 - 100 | 1.98 |
| 72.795.16T.100 | HSK50A x STA16T - 100 | 100 | 30 | 22 | 42 | HSK50A x STA1 | STA1 - PTER16 - 30 | 1.89 |
| 72.795.16T.140 | HSK50A x STA16T - 140 | 140 | 70 | 22 | 42 | HSK50A x STA1 | STA1 - PTER16 - 70 | 1.95 |
| 72.795.16T.170 | HSK50A x STA16T - 170 | 170 | 100 | 22 | 42 | HSK50A x STA1 | STA1 - PTER16 - 100 | 1.99 |
| 72.795.20T.100 | HSK50A x STA20T - 100 | 100 | 30 | 28 | 42 | HSK50A x STA1 | STA1 - PTER20 - 30 | 1.86 |
| 72.795.20T.140 | HSK50A x STA20T - 140 | 140 | 70 | 28 | 42 | HSK50A x STA1 | STA1 - PTER20 - 70 | 2.13 |
| 72.795.20T.170 | HSK50A x STA20T - 170 | 170 | 100 | 28 | 42 | HSK50A x STA1 | STA1 - PTER20 - 100 | 2.29 |
| 73.795.08T.110 | HSK63A x STA8T - 110 | 110 | 30 | 12 | 42 | HSK63A x STA1 | STA1 - PTER8 - 30 | 1.43 |
| 73.795.08T.150 | HSK63A x STA8T - 150 | 150 | 70 | 12 | 42 | HSK63A x STA1 | STA1 - PTER8 - 70 | 1.49 |
| 73.795.08T.180 | HSK63A x STA8T - 180 | 180 | 100 | 12 | 42 | HSK63A x STA1 | STA1 - PTER8 - 100 | 1.54 |
| 73.795.11T.110 | HSK63A x STA11T - 110 | 110 | 30 | 16 | 42 | HSK63A x STA1 | STA1 - PTER11 - 30 | 1.88 |
| 73.795.11T.150 | HSK63A x STA11T - 150 | 150 | 70 | 16 | 42 | HSK63A x STA1 | STA1 - PTER11 - 70 | 1.94 |
| 73.795.11T.180 | HSK63A x STA11T - 180 | 180 | 100 | 16 | 42 | HSK63A x STA1 | STA1 - PTER11 - 100 | 1.98 |
| 73.795.16T.110 | HSK63A x STA16T - 110 | 110 | 30 | 22 | 42 | HSK63A x STA1 | STA1 - PTER16 - 30 | 1.89 |
| 73.795.16T.150 | HSK63A x STA16T - 150 | 150 | 70 | 22 | 42 | HSK63A x STA1 | STA1 - PTER16 - 70 | 1.95 |
| 73.795.16T.180 | HSK63A x STA16T - 180 | 180 | 100 | 22 | 42 | HSK63A x STA1 | STA1 - PTER16 - 100 | 1.99 |
| 73.795.20T.110 | HSK63A x STA20T - 110 | 110 | 30 | 28 | 42 | HSK63A x STA1 | STA1 - PTER20 - 30 | 1.86 |
| 73.795.20T.150 | HSK63A x STA20T - 150 | 150 | 70 | 28 | 42 | HSK63A x STA1 | STA1 - PTER20 - 70 | 2.13 |
| 73.795.20T.180 | HSK63A x STA20T - 180 | 180 | 100 | 28 | 42 | HSK63A x STA1 | STA1 - PTER20 - 100 | 2.29 |

Standard Accessory: • NUT

| Collet | Nut | Coolant Supply Unit | Key | Spanner |
|--------|--------|---------------------|--------|-----------|
| | | | | |
| P.W-5 | P.W-47 | P.W-66 | P.W-66 | P.W-68~73 |



HSK / STA SYNCHRONIZED TAPPING HOLDER



HSK / STA 同步補償攻牙刀桿

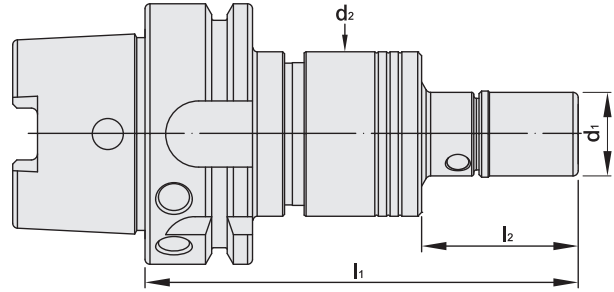

T W PAT NO. M520427
J P PAT NO. 3203456
D E PAT NO. Nr.202016100106

| MODEL NO. | TYPE | l ₁ | l ₂ | d ₁ | d ₂ | COMBINATION | | WEIGHT (KGS) |
|----------------|------------------------|----------------|----------------|----------------|----------------|----------------|---------------------|--------------|
| | | | | | | BODY | TAP ADAPTER | |
| 74.795.08T.110 | HSK80A x STA8T - 110 | 110 | 30 | 12 | 42 | HSK80A x STA1 | STA1 - PTER8 - 30 | 2.10 |
| 74.795.08T.150 | HSK80A x STA8T - 150 | 150 | 70 | 12 | 42 | HSK80A x STA1 | STA1 - PTER8 - 70 | 2.16 |
| 74.795.08T.180 | HSK80A x STA8T - 180 | 180 | 100 | 12 | 42 | HSK80A x STA1 | STA1 - PTER8 - 100 | 2.21 |
| 74.795.11T.110 | HSK80A x STA11T - 110 | 110 | 30 | 16 | 42 | HSK80A x STA1 | STA1 - PTER11 - 30 | 2.55 |
| 74.795.11T.150 | HSK80A x STA11T - 150 | 150 | 70 | 16 | 42 | HSK80A x STA1 | STA1 - PTER11 - 70 | 2.61 |
| 74.795.11T.180 | HSK80A x STA11T - 180 | 180 | 100 | 16 | 42 | HSK80A x STA1 | STA1 - PTER11 - 100 | 2.65 |
| 74.795.16T.110 | HSK80A x STA16T - 110 | 110 | 30 | 22 | 42 | HSK80A x STA1 | STA1 - PTER16 - 30 | 2.56 |
| 74.795.16T.150 | HSK80A x STA16T - 150 | 150 | 70 | 22 | 42 | HSK80A x STA1 | STA1 - PTER16 - 70 | 2.62 |
| 74.795.16T.180 | HSK80A x STA16T - 180 | 180 | 100 | 22 | 42 | HSK80A x STA1 | STA1 - PTER16 - 100 | 2.66 |
| 74.795.20T.110 | HSK80A x STA20T - 110 | 110 | 30 | 28 | 42 | HSK80A x STA1 | STA1 - PTER20 - 30 | 2.53 |
| 74.795.20T.150 | HSK80A x STA20T - 150 | 150 | 70 | 28 | 42 | HSK80A x STA1 | STA1 - PTER20 - 70 | 2.80 |
| 74.795.20T.180 | HSK80A x STA20T - 180 | 180 | 100 | 28 | 42 | HSK80A x STA1 | STA1 - PTER20 - 100 | 2.96 |
| 74.795.25T.125 | HSK80A x STA25T - 125 | 125 | 30 | 35 | 58 | HSK80A x STA2 | STA2 - PTER25 - 30 | 3.35 |
| 74.795.25T.165 | HSK80A x STA25T - 165 | 165 | 70 | 35 | 58 | HSK80A x STA2 | STA2 - PTER25 - 70 | 3.62 |
| 74.795.25T.195 | HSK80A x STA25T - 195 | 195 | 100 | 35 | 58 | HSK80A x STA2 | STA2 - PTER25 - 100 | 3.78 |
| 75.795.08T.110 | HSK100A x STA8T - 110 | 110 | 30 | 12 | 42 | HSK100A x STA1 | STA1 - PTER8 - 30 | 2.90 |
| 75.795.08T.150 | HSK100A x STA8T - 150 | 150 | 70 | 12 | 42 | HSK100A x STA1 | STA1 - PTER8 - 70 | 2.96 |
| 75.795.08T.180 | HSK100A x STA8T - 180 | 180 | 100 | 12 | 42 | HSK100A x STA1 | STA1 - PTER8 - 100 | 3.01 |
| 75.795.11T.110 | HSK100A x STA11T - 110 | 110 | 30 | 16 | 42 | HSK100A x STA1 | STA1 - PTER11 - 30 | 3.35 |
| 75.795.11T.150 | HSK100A x STA11T - 150 | 150 | 70 | 16 | 42 | HSK100A x STA1 | STA1 - PTER11 - 70 | 3.41 |
| 75.795.11T.180 | HSK100A x STA11T - 180 | 180 | 100 | 16 | 42 | HSK100A x STA1 | STA1 - PTER11 - 100 | 3.45 |
| 75.795.16T.110 | HSK100A x STA16T - 110 | 110 | 30 | 22 | 42 | HSK100A x STA1 | STA1 - PTER16 - 30 | 3.36 |
| 75.795.16T.150 | HSK100A x STA16T - 150 | 150 | 70 | 22 | 42 | HSK100A x STA1 | STA1 - PTER16 - 70 | 3.42 |
| 75.795.16T.180 | HSK100A x STA16T - 180 | 180 | 100 | 22 | 42 | HSK100A x STA1 | STA1 - PTER16 - 100 | 3.46 |
| 75.795.20T.110 | HSK100A x STA20T - 110 | 110 | 30 | 28 | 42 | HSK100A x STA1 | STA1 - PTER20 - 30 | 3.33 |
| 75.795.20T.150 | HSK100A x STA20T - 150 | 150 | 70 | 28 | 42 | HSK100A x STA1 | STA1 - PTER20 - 70 | 3.60 |
| 75.795.20T.180 | HSK100A x STA20T - 180 | 180 | 100 | 28 | 42 | HSK100A x STA1 | STA1 - PTER20 - 100 | 3.76 |
| 75.795.25T.125 | HSK100A x STA25T - 125 | 125 | 30 | 35 | 58 | HSK100A x STA2 | STA2 - PTER25 - 30 | 4.15 |
| 75.795.25T.165 | HSK100A x STA25T - 165 | 165 | 70 | 35 | 58 | HSK100A x STA2 | STA2 - PTER25 - 70 | 4.42 |
| 75.795.25T.195 | HSK100A x STA25T - 195 | 195 | 100 | 35 | 58 | HSK100A x STA2 | STA2 - PTER25 - 100 | 4.58 |

Standard Accessory: • NUT

| Collet | Nut | Coolant Supply Unit | Key | Spanner |
|--------|--------|---------------------|--------|-----------|
| | | | | |
| P.W-5 | P.W-47 | P.W-66 | P.W-66 | P.W-68~73 |



HSK / STA SYNCHRONIZED TAPPING HOLDER



HSK / STA 同步補償攻牙刀桿

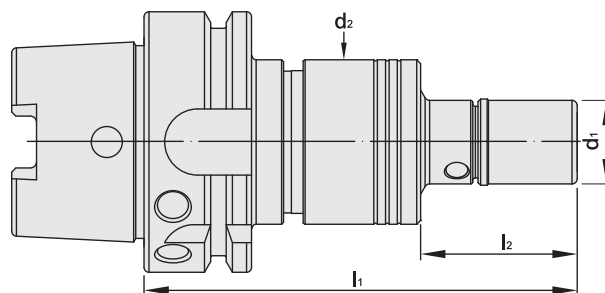

T W PAT NO. M520427
J P PAT NO. 3203456
D E PAT NO. Nr.202016100106

| MODEL NO. | TYPE | l ₁ | l ₂ | d ₁ | d ₂ | COMBINATION | | WEIGHT (KGS) |
|----------------|------------------------|----------------|----------------|----------------|----------------|----------------|-------------------|--------------|
| | | | | | | BODY | TAP ADAPTER | |
| 71.795.16U.100 | HSK40A x STA16U - 100 | 100 | 30 | 30 | 42 | HSK40A x STA1 | STA1 - UT16 - 30 | 1.25 |
| 71.795.16U.140 | HSK40A x STA16U - 140 | 140 | 70 | 30 | 42 | HSK40A x STA1 | STA1 - UT16 - 70 | 1.40 |
| 71.795.16U.170 | HSK40A x STA16U - 170 | 170 | 100 | 30 | 42 | HSK40A x STA1 | STA1 - UT16 - 100 | 1.60 |
| 72.795.16U.100 | HSK50A x STA16U - 100 | 100 | 30 | 30 | 42 | HSK50A x STA1 | STA1 - UT16 - 30 | 1.46 |
| 72.795.16U.140 | HSK50A x STA16U - 140 | 140 | 70 | 30 | 42 | HSK50A x STA1 | STA1 - UT16 - 70 | 1.61 |
| 72.795.16U.170 | HSK50A x STA16U - 170 | 170 | 100 | 30 | 42 | HSK50A x STA1 | STA1 - UT16 - 100 | 1.81 |
| 73.795.16U.120 | HSK63A x STA16U - 120 | 120 | 30 | 30 | 42 | HSK63A x STA1 | STA1 - UT16 - 30 | 1.75 |
| 73.795.16U.160 | HSK63A x STA16U - 160 | 160 | 70 | 30 | 42 | HSK63A x STA1 | STA1 - UT16 - 70 | 1.90 |
| 73.795.16U.190 | HSK63A x STA16U - 190 | 190 | 100 | 30 | 42 | HSK63A x STA1 | STA1 - UT16 - 100 | 2.10 |
| 74.795.16U.110 | HSK80A x STA16U - 110 | 110 | 30 | 30 | 58 | HSK80A x STA1 | STA1 - UT16 - 30 | 2.13 |
| 74.795.16U.150 | HSK80A x STA16U - 150 | 150 | 70 | 30 | 58 | HSK80A x STA1 | STA1 - UT16 - 70 | 2.28 |
| 74.795.16U.180 | HSK80A x STA16U - 180 | 180 | 100 | 30 | 58 | HSK80A x STA1 | STA1 - UT16 - 100 | 2.48 |
| 74.795.20U.125 | HSK80A x STA20U - 125 | 125 | 30 | 36 | 58 | HSK80A x STA2 | STA2 - UT20 - 30 | 3.10 |
| 74.795.20U.165 | HSK80A x STA20U - 165 | 165 | 70 | 36 | 58 | HSK80A x STA2 | STA2 - UT20 - 70 | 3.30 |
| 74.795.20U.195 | HSK80A x STA20U - 195 | 195 | 100 | 36 | 58 | HSK80A x STA2 | STA2 - UT20 - 100 | 3.43 |
| 74.795.25U.130 | HSK80A x STA25U - 130 | 130 | 35 | 42 | 58 | HSK80A x STA2 | STA2 - UT25 - 35 | 3.10 |
| 74.795.25U.180 | HSK80A x STA25U - 180 | 180 | 85 | 42 | 58 | HSK80A x STA2 | STA2 - UT25 - 85 | 3.45 |
| 74.795.25U.210 | HSK80A x STA25U - 210 | 210 | 115 | 42 | 58 | HSK80A x STA2 | STA2 - UT25 - 115 | 3.70 |
| 74.795.32U.145 | HSK80A x STA32U - 145 | 145 | 50 | 48 | 58 | HSK80A x STA2 | STA2 - UT32 - 50 | 3.15 |
| 74.795.32U.180 | HSK80A x STA32U - 180 | 180 | 85 | 48 | 58 | HSK80A x STA2 | STA2 - UT32 - 85 | 3.40 |
| 74.795.32U.210 | HSK80A x STA32U - 210 | 210 | 115 | 48 | 58 | HSK80A x STA2 | STA2 - UT32 - 115 | 3.60 |
| 75.795.16U.110 | HSK100A x STA16U - 110 | 110 | 30 | 30 | 42 | HSK100A x STA1 | STA1 - UT16 - 30 | 2.93 |
| 75.795.16U.150 | HSK100A x STA16U - 150 | 150 | 70 | 30 | 42 | HSK100A x STA1 | STA1 - UT16 - 70 | 3.08 |
| 75.795.16U.180 | HSK100A x STA16U - 180 | 180 | 100 | 30 | 42 | HSK100A x STA1 | STA1 - UT16 - 100 | 3.28 |
| 75.795.20U.125 | HSK100A x STA20U - 125 | 125 | 30 | 36 | 58 | HSK100A x STA2 | STA2 - UT20 - 30 | 3.90 |
| 75.795.20U.165 | HSK100A x STA20U - 165 | 165 | 70 | 36 | 58 | HSK100A x STA2 | STA2 - UT20 - 70 | 4.10 |
| 75.795.20U.195 | HSK100A x STA20U - 195 | 195 | 100 | 36 | 58 | HSK100A x STA2 | STA2 - UT20 - 100 | 4.23 |
| 75.795.25U.130 | HSK100A x STA25U - 130 | 130 | 35 | 42 | 58 | HSK100A x STA2 | STA2 - UT25 - 35 | 3.90 |
| 75.795.25U.180 | HSK100A x STA25U - 180 | 180 | 85 | 42 | 58 | HSK100A x STA2 | STA2 - UT25 - 85 | 4.25 |
| 75.795.25U.210 | HSK100A x STA25U - 210 | 210 | 115 | 42 | 58 | HSK100A x STA2 | STA2 - UT25 - 115 | 4.50 |
| 75.795.32U.145 | HSK100A x STA32U - 145 | 145 | 50 | 48 | 58 | HSK100A x STA2 | STA2 - UT32 - 50 | 3.95 |
| 75.795.32U.180 | HSK100A x STA32U - 180 | 180 | 85 | 48 | 58 | HSK100A x STA2 | STA2 - UT32 - 85 | 4.20 |
| 75.795.32U.210 | HSK100A x STA32U - 210 | 210 | 115 | 48 | 58 | HSK100A x STA2 | STA2 - UT32 - 115 | 4.40 |

Standard Accessory: • NUT

| Collet | Nut | Coolant Supply Unit | Key | Spanner |
|----------|--------|---------------------|--------|-----------|
| | | | | |
| P.W-7~10 | P.W-47 | P.W-66 | P.W-66 | P.W-68~73 |



HSK / STA SYNCHRONIZED TAPPING HOLDER



HSK / STA 同步補償攻牙刀桿

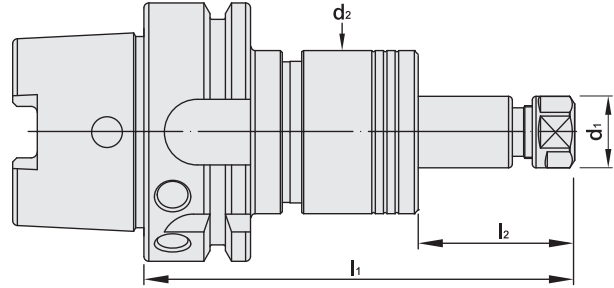

T W PAT NO. M520427
 J P PAT NO. 3203456
 D E PAT NO. Nr.202016100106

| MODEL NO. | TYPE | l ₁ | l ₂ | d ₁ | d ₂ | COMBINATION | | WEIGHT (KGS) |
|----------------|------------------------|----------------|----------------|----------------|----------------|----------------|--------------------|--------------|
| | | | | | | BODY | TAP ADAPTER | |
| 71.795.11E.140 | HSK40A x STA11E - 140 | 140 | 70 | 19 | 42 | HSK40A x STA1 | STA1 - ER11A - 70 | 1.46 |
| 71.795.16E.095 | HSK40A x STA16E - 95 | 95 | 25 | 28 | 42 | HSK40A x STA1 | STA1 - ER16A - 25 | 1.20 |
| 71.795.16E.140 | HSK40A x STA16E - 140 | 140 | 70 | 28 | 42 | HSK40A x STA1 | STA1 - ER16A - 70 | 1.40 |
| 71.795.16E.220 | HSK40A x STA16E - 220 | 220 | 150 | 28 | 42 | HSK40A x STA1 | STA1 - ER16A - 150 | 1.73 |
| 71.795.20E.104 | HSK40A x STA20E - 104 | 104 | 34 | 34 | 42 | HSK40A x STA1 | STA1 - ER20A - 34 | 1.24 |
| 71.795.20E.140 | HSK40A x STA20E - 140 | 140 | 70 | 34 | 42 | HSK40A x STA1 | STA1 - ER20A - 70 | 1.40 |
| 72.795.11E.140 | HSK50A x STA11E - 140 | 140 | 70 | 19 | 42 | HSK50A x STA1 | STA1 - ER11A - 70 | 1.67 |
| 72.795.16E.095 | HSK50A x STA16E - 95 | 95 | 25 | 28 | 42 | HSK50A x STA1 | STA1 - ER16A - 25 | 1.41 |
| 72.795.16E.140 | HSK50A x STA16E - 140 | 140 | 70 | 28 | 42 | HSK50A x STA1 | STA1 - ER16A - 70 | 1.61 |
| 72.795.16E.220 | HSK50A x STA16E - 220 | 220 | 150 | 28 | 42 | HSK50A x STA1 | STA1 - ER16A - 150 | 1.94 |
| 72.795.20E.104 | HSK50A x STA20E - 104 | 104 | 34 | 34 | 42 | HSK50A x STA1 | STA1 - ER20A - 34 | 1.45 |
| 72.795.20E.140 | HSK50A x STA20E - 140 | 140 | 70 | 34 | 42 | HSK50A x STA1 | STA1 - ER20A - 70 | 1.61 |
| 73795.11E.150 | HSK63A x STA11E - 150 | 150 | 70 | 19 | 42 | HSK63A x STA1 | STA1 - ER11A - 70 | 1.96 |
| 73.795.16E.105 | HSK63A x STA16E - 105 | 105 | 25 | 28 | 42 | HSK63A x STA1 | STA1 - ER16A - 25 | 1.70 |
| 73.795.16E.150 | HSK63A x STA16E - 150 | 150 | 70 | 28 | 42 | HSK63A x STA1 | STA1 - ER16A - 70 | 1.90 |
| 73.795.16E.230 | HSK63A x STA16E - 230 | 230 | 150 | 28 | 42 | HSK63A x STA1 | STA1 - ER16A - 150 | 2.23 |
| 73.795.20E.114 | HSK63A x STA20E - 114 | 114 | 34 | 34 | 42 | HSK63A x STA1 | STA1 - ER20A - 34 | 1.74 |
| 73.795.20E.150 | HSK63A x STA20E - 150 | 150 | 70 | 34 | 42 | HSK63A x STA1 | STA1 - ER20A - 70 | 1.90 |
| 74.795.11E.150 | HSK80A x STA11E - 150 | 150 | 70 | 19 | 42 | HSK80A x STA1 | STA1 - ER11A - 70 | 2.34 |
| 74.795.16E.115 | HSK80A x STA16E - 115 | 115 | 25 | 28 | 42 | HSK80A x STA1 | STA1 - ER16A - 25 | 2.08 |
| 74.795.16E.150 | HSK80A x STA16E - 150 | 150 | 70 | 28 | 42 | HSK80A x STA1 | STA1 - ER16A - 70 | 2.28 |
| 74.795.16E.230 | HSK80A x STA16E - 230 | 230 | 150 | 28 | 42 | HSK80A x STA1 | STA1 - ER16A - 150 | 2.61 |
| 74.795.20E.114 | HSK80A x STA20E - 114 | 114 | 34 | 34 | 42 | HSK80A x STA1 | STA1 - ER20A - 34 | 2.12 |
| 74.795.20E.150 | HSK80A x STA20E - 150 | 150 | 70 | 34 | 42 | HSK80A x STA1 | STA1 - ER20A - 70 | 2.28 |
| 74.795.32E.135 | HSK80A x STA32E - 135 | 135 | 40 | 50 | 58 | HSK80A x STA2 | STA2 - ER32 - 40 | 3.24 |
| 74.795.32E.165 | HSK80A x STA32E - 165 | 165 | 70 | 50 | 58 | HSK80A x STA2 | STA2 - ER32 - 70 | 3.47 |
| 75.795.11E.150 | HSK100A x STA11E - 150 | 150 | 70 | 19 | 42 | HSK100A x STA1 | STA1 - ER11A - 70 | 3.14 |
| 75.795.16E.115 | HSK100A x STA16E - 115 | 115 | 25 | 28 | 42 | HSK100A x STA1 | STA1 - ER16A - 25 | 2.88 |
| 75.795.16E.150 | HSK100A x STA16E - 150 | 150 | 70 | 28 | 42 | HSK100A x STA1 | STA1 - ER16A - 70 | 3.08 |
| 75.795.16E.220 | HSK100A x STA16E - 220 | 220 | 150 | 28 | 42 | HSK100A x STA1 | STA1 - ER16A - 150 | 3.41 |
| 75.795.20E.114 | HSK100A x STA20E - 114 | 114 | 34 | 34 | 42 | HSK100A x STA1 | STA1 - ER20A - 34 | 2.92 |
| 75.795.20E.150 | HSK100A x STA20E - 150 | 150 | 70 | 34 | 42 | HSK100A x STA1 | STA1 - ER20A - 70 | 3.08 |
| 75.795.32E.135 | HSK100A x STA32E - 135 | 135 | 40 | 50 | 58 | HSK100A x STA2 | STA2 - ER32 - 40 | 4.04 |
| 75.795.32E.165 | HSK100A x STA32E - 165 | 165 | 70 | 50 | 58 | HSK100A x STA2 | STA2 - ER32 - 70 | 4.27 |

Standard Accessory: • NUT

| Collet | Nut | Coolant Supply Unit | Key | Spanner |
|----------|--------|---------------------|--------|-----------|
| | | | | |
| P.W-7~28 | P.W-48 | P.W-66 | P.W-66 | P.W-68~71 |



PSC / STA SYNCHRONIZED TAPPING HOLDER



PSC / STA 同步補償攻牙刀桿

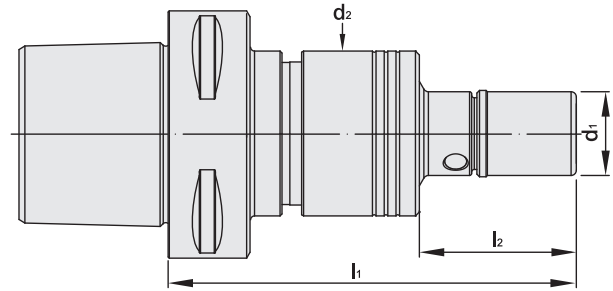

T W PAT NO. M520427
J P PAT NO. 3203456
D E PAT NO. Nr.202016100106

| MODEL NO. | TYPE | l ₁ | l ₂ | d ₁ | d ₂ | COMBINATION | | WEIGHT (KGS) |
|-----------------|----------------------|----------------|----------------|----------------|----------------|--------------|---------------------|--------------|
| | | | | | | BODY | TAP ADAPTER | |
| 142.795.08T.110 | PSC50 x STA8T - 110 | 110 | 30 | 12 | 42 | PSC50 x STA1 | STA1 - PTER8 - 30 | 1.55 |
| 142.795.08T.150 | PSC50 x STA8T - 150 | 150 | 70 | 12 | 42 | PSC50 x STA1 | STA1 - PTER8 - 70 | 1.61 |
| 142.795.08T.180 | PSC50 x STA8T - 180 | 180 | 100 | 12 | 42 | PSC50 x STA1 | STA1 - PTER8 - 100 | 1.66 |
| 142.795.11T.110 | PSC50 x STA11T - 110 | 110 | 30 | 16 | 42 | PSC50 x STA1 | STA1 - PTER11 - 30 | 2.00 |
| 142.795.11T.150 | PSC50 x STA11T - 150 | 150 | 70 | 16 | 42 | PSC50 x STA1 | STA1 - PTER11 - 70 | 2.06 |
| 142.795.11T.180 | PSC50 x STA11T - 180 | 180 | 100 | 16 | 42 | PSC50 x STA1 | STA1 - PTER11 - 100 | 2.10 |
| 142.795.16T.110 | PSC50 x STA16T - 110 | 110 | 30 | 22 | 42 | PSC50 x STA1 | STA1 - PTER16 - 30 | 2.01 |
| 142.795.16T.150 | PSC50 x STA16T - 150 | 150 | 70 | 22 | 42 | PSC50 x STA1 | STA1 - PTER16 - 70 | 2.07 |
| 142.795.16T.180 | PSC50 x STA16T - 180 | 180 | 100 | 22 | 42 | PSC50 x STA1 | STA1 - PTER16 - 100 | 2.11 |
| 142.795.20T.180 | PSC50 x STA20T - 110 | 110 | 30 | 28 | 42 | PSC50 x STA1 | STA1 - PTER20 - 30 | 1.98 |
| 142.795.20T.150 | PSC50 x STA20T - 150 | 150 | 70 | 28 | 42 | PSC50 x STA1 | STA1 - PTER20 - 70 | 2.25 |
| 142.795.20T.180 | PSC50 x STA20T - 180 | 180 | 100 | 28 | 42 | PSC50 x STA1 | STA1 - PTER20 - 100 | 2.41 |
| 143.795.08T.090 | PSC63 x STA8T - 90 | 90 | 30 | 12 | 42 | PSC63 x STA1 | STA1 - PTER8 - 30 | 1.67 |
| 143.795.08T.130 | PSC63 x STA8T - 130 | 130 | 70 | 12 | 42 | PSC63 x STA1 | STA1 - PTER8 - 70 | 1.73 |
| 143.795.08T.160 | PSC63 x STA8T - 160 | 160 | 100 | 12 | 42 | PSC63 x STA1 | STA1 - PTER8 - 100 | 1.78 |
| 143.795.11T.090 | PSC63 x STA11T - 90 | 90 | 30 | 16 | 42 | PSC63 x STA1 | STA1 - PTER11 - 30 | 2.12 |
| 143.795.11T.130 | PSC63 x STA11T - 130 | 130 | 70 | 16 | 42 | PSC63 x STA1 | STA1 - PTER11 - 70 | 2.18 |
| 143.795.11T.160 | PSC63 x STA11T - 160 | 160 | 100 | 16 | 42 | PSC63 x STA1 | STA1 - PTER11 - 100 | 2.22 |
| 143.795.16T.090 | PSC63 x STA16T - 90 | 90 | 30 | 22 | 42 | PSC63 x STA1 | STA1 - PTER16 - 30 | 2.13 |
| 143.795.16T.130 | PSC63 x STA16T - 130 | 130 | 70 | 22 | 42 | PSC63 x STA1 | STA1 - PTER16 - 70 | 2.19 |
| 143.795.16T.160 | PSC63 x STA16T - 160 | 160 | 100 | 22 | 42 | PSC63 x STA1 | STA1 - PTER16 - 100 | 2.23 |
| 143.795.20T.090 | PSC63 x STA20T - 90 | 90 | 30 | 28 | 42 | PSC63 x STA1 | STA1 - PTER20 - 30 | 2.10 |
| 143.795.20T.130 | PSC63 x STA20T - 130 | 130 | 70 | 28 | 42 | PSC63 x STA1 | STA1 - PTER20 - 70 | 2.37 |
| 143.795.20T.160 | PSC63 x STA20T - 160 | 160 | 100 | 28 | 42 | PSC63 x STA1 | STA1 - PTER20 - 100 | 2.53 |
| 143.795.25T.110 | PSC63 x STA25T - 110 | 110 | 30 | 35 | 58 | PSC63 x STA2 | STA2 - PTER25 - 30 | 2.76 |
| 143.795.25T.150 | PSC63 x STA25T - 150 | 150 | 70 | 35 | 58 | PSC63 x STA2 | STA2 - PTER25 - 70 | 3.03 |
| 143.795.25T.180 | PSC63 x STA25T - 180 | 180 | 100 | 35 | 58 | PSC63 x STA2 | STA2 - PTER25 - 100 | 3.19 |

Standard Accessory: • NUT

| Collet | Nut | Spanner |
|--------|--------|-----------|
| | | |
| P.W-5 | P.W-47 | P.W-68~73 |



PSC / STA SYNCHRONIZED TAPPING HOLDER



PSC / STA 同步補償攻牙刀桿

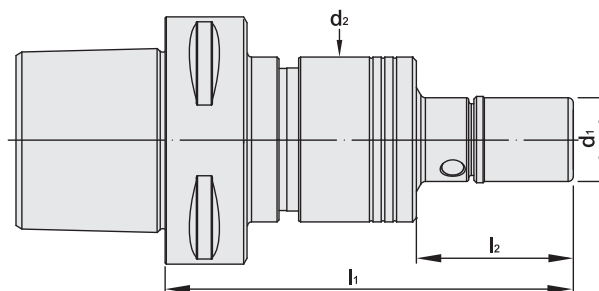

T W PAT NO. M520427
 J P PAT NO. 3203456
 D E PAT NO. Nr.202016100106

| MODEL NO. | TYPE | l ₁ | l ₂ | d ₁ | d ₂ | COMBINATION | | WEIGHT (KGS) |
|-----------------|----------------------|----------------|----------------|----------------|----------------|--------------|---------------------|--------------|
| | | | | | | BODY | TAP ADAPTER | |
| 144.795.08T.095 | PSC80 x STA8T - 95 | 95 | 30 | 12 | 42 | PSC80 x STA1 | STA1 - PTER8 - 30 | 3.09 |
| 144.795.08T.135 | PSC80 x STA8T - 135 | 135 | 70 | 12 | 42 | PSC80 x STA1 | STA1 - PTER8 - 70 | 3.15 |
| 144.795.08T.165 | PSC80 x STA8T - 165 | 165 | 100 | 12 | 42 | PSC80 x STA1 | STA1 - PTER8 - 100 | 3.20 |
| 144.795.11T.095 | PSC80 x STA11T - 95 | 95 | 30 | 16 | 42 | PSC80 x STA1 | STA1 - PTER11 - 30 | 3.54 |
| 144.795.11T.135 | PSC80 x STA11T - 135 | 135 | 70 | 16 | 42 | PSC80 x STA1 | STA1 - PTER11 - 70 | 3.60 |
| 144.795.11T.165 | PSC80 x STA11T - 165 | 165 | 100 | 16 | 42 | PSC80 x STA1 | STA1 - PTER11 - 100 | 3.64 |
| 144.795.16T.095 | PSC80 x STA16T - 95 | 95 | 30 | 22 | 42 | PSC80 x STA1 | STA1 - PTER16 - 30 | 3.55 |
| 144.795.16T.135 | PSC80 x STA16T - 135 | 135 | 70 | 22 | 42 | PSC80 x STA1 | STA1 - PTER16 - 70 | 3.61 |
| 144.795.16T.165 | PSC80 x STA16T - 165 | 165 | 100 | 22 | 42 | PSC80 x STA1 | STA1 - PTER16 - 100 | 3.65 |
| 144.795.20T.095 | PSC80 x STA20T - 95 | 95 | 30 | 28 | 42 | PSC80 x STA1 | STA1 - PTER20 - 30 | 3.52 |
| 144.795.20T.135 | PSC80 x STA20T - 135 | 135 | 70 | 28 | 42 | PSC80 x STA1 | STA1 - PTER20 - 70 | 3.79 |
| 144.795.20T.165 | PSC80 x STA20T - 165 | 165 | 100 | 28 | 42 | PSC80 x STA1 | STA1 - PTER20 - 100 | 3.95 |
| 144.795.25T.115 | PSC80 x STA25T - 115 | 115 | 30 | 35 | 58 | PSC80 x STA2 | STA2 - PTER25 - 30 | 3.66 |
| 144.795.25T.155 | PSC80 x STA25T - 155 | 155 | 70 | 35 | 58 | PSC80 x STA2 | STA2 - PTER25 - 70 | 3.93 |
| 144.795.25T.185 | PSC80 x STA25T - 185 | 185 | 100 | 35 | 58 | PSC80 x STA2 | STA2 - PTER25 - 100 | 4.09 |

Standard Accessory: • NUT

| Collet | Nut | Spanner |
|--------|--------|-----------|
| | | |
| P.W-5 | P.W-47 | P.W-68~73 |



PSC / STA SYNCHRONIZED TAPPING HOLDER



PSC / STA 同步補償攻牙刀桿

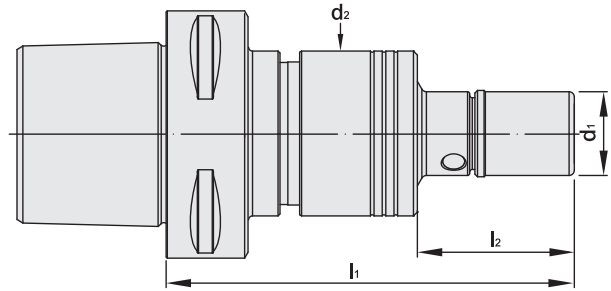

T W PAT NO. M520427
J P PAT NO. 3203456
D E PAT NO. Nr.202016100106

| MODEL NO. | TYPE | l ₁ | l ₂ | d ₁ | d ₂ | COMBINATION | | WEIGHT (KGS) |
|-----------------|----------------------|----------------|----------------|----------------|----------------|--------------|-------------------|--------------|
| | | | | | | BODY | TAP ADAPTER | |
| 142.795.16U.110 | PSC50 x STA16U - 110 | 110 | 30 | 30 | 42 | PSC50 x STA1 | STA1 - UT16 - 30 | 1.58 |
| 142.795.16U.150 | PSC50 x STA16U - 150 | 150 | 70 | 30 | 42 | PSC50 x STA1 | STA1 - UT16 - 70 | 1.73 |
| 142.795.16U.180 | PSC50 x STA16U - 180 | 180 | 100 | 30 | 42 | PSC50 x STA1 | STA1 - UT16 - 100 | 1.93 |
| 143.795.16U.090 | PSC63 x STA16U - 90 | 90 | 30 | 30 | 42 | PSC63 x STA1 | STA1 - UT16 - 30 | 1.70 |
| 143.795.16U.130 | PSC63 x STA16U - 130 | 130 | 70 | 30 | 42 | PSC63 x STA1 | STA1 - UT16 - 70 | 1.85 |
| 143.795.16U.160 | PSC63 x STA16U - 160 | 160 | 100 | 30 | 42 | PSC63 x STA1 | STA1 - UT16 - 100 | 2.05 |
| 143.795.20U.110 | PSC63 x STA20U - 110 | 110 | 30 | 36 | 58 | PSC63 x STA2 | STA2 - UT20 - 30 | 2.51 |
| 143.795.20U.150 | PSC63 x STA20U - 150 | 150 | 70 | 36 | 58 | PSC63 x STA2 | STA2 - UT20 - 70 | 2.71 |
| 143.795.20U.180 | PSC63 x STA20U - 180 | 180 | 100 | 36 | 58 | PSC63 x STA2 | STA2 - UT20 - 100 | 2.84 |
| 143.795.25U.115 | PSC63 x STA25U - 115 | 115 | 35 | 42 | 58 | PSC63 x STA2 | STA2 - UT25 - 35 | 2.51 |
| 143.795.25U.165 | PSC63 x STA25U - 165 | 165 | 85 | 42 | 58 | PSC63 x STA2 | STA2 - UT25 - 85 | 2.86 |
| 143.795.25U.195 | PSC63 x STA25U - 195 | 195 | 115 | 42 | 58 | PSC63 x STA2 | STA2 - UT25 - 115 | 3.11 |
| 143.795.32U.130 | PSC63 x STA32U - 130 | 130 | 50 | 48 | 58 | PSC63 x STA2 | STA2 - UT32 - 50 | 2.56 |
| 143.795.32U.165 | PSC63 x STA32U - 165 | 165 | 85 | 48 | 58 | PSC63 x STA2 | STA2 - UT32 - 85 | 2.81 |
| 143.795.32U.195 | PSC63 x STA32U - 195 | 195 | 115 | 48 | 58 | PSC63 x STA2 | STA2 - UT32 - 115 | 3.01 |
| 144.795.16U.095 | PSC80 x STA16U - 95 | 95 | 30 | 30 | 42 | PSC80 x STA1 | STA1 - UT16 - 30 | 3.12 |
| 144.795.16U.135 | PSC80 x STA16U - 135 | 135 | 70 | 30 | 42 | PSC80 x STA1 | STA1 - UT16 - 70 | 3.27 |
| 144.795.16U.165 | PSC80 x STA16U - 165 | 165 | 100 | 30 | 42 | PSC80 x STA1 | STA1 - UT16 - 100 | 3.47 |
| 144.795.20U.115 | PSC80 x STA20U - 115 | 115 | 30 | 36 | 58 | PSC80 x STA2 | STA2 - UT20 - 30 | 3.41 |
| 144.795.20U.155 | PSC80 x STA20U - 155 | 155 | 70 | 36 | 58 | PSC80 x STA2 | STA2 - UT20 - 70 | 3.61 |
| 144.795.20U.185 | PSC80 x STA20U - 185 | 185 | 100 | 36 | 58 | PSC80 x STA2 | STA2 - UT20 - 100 | 3.74 |
| 144.795.25U.120 | PSC80 x STA25U - 120 | 120 | 35 | 42 | 58 | PSC80 x STA2 | STA2 - UT25 - 35 | 3.41 |
| 144.795.25U.170 | PSC80 x STA25U - 170 | 170 | 85 | 42 | 58 | PSC80 x STA2 | STA2 - UT25 - 85 | 3.76 |
| 144.795.25U.200 | PSC80 x STA25U - 200 | 200 | 115 | 42 | 58 | PSC80 x STA2 | STA2 - UT25 - 115 | 4.01 |
| 144.795.32U.135 | PSC80 x STA32U - 135 | 135 | 50 | 48 | 58 | PSC80 x STA2 | STA2 - UT32 - 50 | 3.46 |
| 144.795.32U.170 | PSC80 x STA32U - 170 | 170 | 85 | 48 | 58 | PSC80 x STA2 | STA2 - UT32 - 85 | 3.71 |
| 144.795.32U.200 | PSC80 x STA32U - 200 | 200 | 115 | 48 | 58 | PSC80 x STA2 | STA2 - UT32 - 115 | 3.91 |

Standard Accessory: • NUT

| Collet | Nut | Spanner |
|--------|--------|-----------|
| | | |
| P.W-5 | P.W-47 | P.W-68~73 |



PSC / STA SYNCHRONIZED TAPPING HOLDER



PSC / STA 同步補償攻牙刀桿

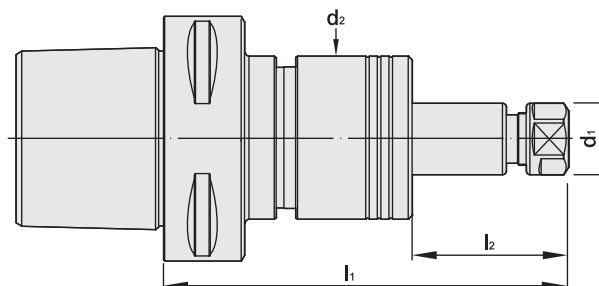

T W PAT NO. M520427
 J P PAT NO. 3203456
 D E PAT NO. Nr.202016100106

| MODEL NO. | TYPE | l ₁ | l ₂ | d ₁ | d ₂ | COMBINATION | | WEIGHT (KGS) |
|-----------------|----------------------|----------------|----------------|----------------|----------------|--------------|--------------------|--------------|
| | | | | | | BODY | TAP ADAPTER | |
| 142.795.11E.150 | PSC50 x STA11E - 150 | 150 | 70 | 19 | 42 | PSC50 x STA1 | STA1 - ER11A - 70 | 1.79 |
| 142.795.16E.105 | PSC50 x STA16E - 105 | 105 | 25 | 28 | 42 | PSC50 x STA1 | STA1 - ER16A - 25 | 1.53 |
| 142.795.16E.150 | PSC50 x STA16E - 150 | 150 | 70 | 28 | 42 | PSC50 x STA1 | STA1 - ER16A - 70 | 1.73 |
| 142.795.16E.230 | PSC50 x STA16E - 230 | 230 | 150 | 28 | 42 | PSC50 x STA1 | STA1 - ER16A - 150 | 2.06 |
| 142.795.20E.114 | PSC50 x STA20E - 114 | 114 | 34 | 34 | 42 | PSC50 x STA1 | STA1 - ER20A - 34 | 1.57 |
| 142.795.20E.150 | PSC50 x STA20E - 150 | 150 | 70 | 34 | 42 | PSC50 x STA1 | STA1 - ER20A - 70 | 1.73 |
| 143.795.11E.130 | PSC63 x STA11E - 130 | 130 | 70 | 19 | 42 | PSC63 x STA1 | STA1 - ER11A - 70 | 1.91 |
| 143.795.16E.085 | PSC63 x STA16E - 85 | 85 | 25 | 28 | 42 | PSC63 x STA1 | STA1 - ER16A - 25 | 1.65 |
| 143.795.16E.130 | PSC63 x STA16E - 130 | 130 | 70 | 28 | 42 | PSC63 x STA1 | STA1 - ER16A - 70 | 1.85 |
| 143.795.16E.210 | PSC63 x STA16E - 210 | 210 | 150 | 28 | 42 | PSC63 x STA1 | STA1 - ER16A - 150 | 2.18 |
| 143.795.20E.094 | PSC63 x STA20E - 94 | 94 | 34 | 34 | 42 | PSC63 x STA1 | STA1 - ER20A - 34 | 1.69 |
| 143.795.20E.130 | PSC63 x STA20E - 130 | 130 | 70 | 34 | 42 | PSC63 x STA1 | STA1 - ER20A - 70 | 1.85 |
| 143.795.32E.120 | PSC63 x STA32E - 120 | 120 | 40 | 50 | 58 | PSC63 x STA2 | STA2 - ER32 - 40 | 2.65 |
| 143.795.32E.150 | PSC63 x STA32E - 150 | 150 | 70 | 50 | 58 | PSC63 x STA2 | STA1 - ER32 - 70 | 2.88 |
| 144.795.11E.135 | PSC80 x STA11E - 135 | 135 | 70 | 19 | 42 | PSC80 x STA1 | STA1 - ER11A - 70 | 3.33 |
| 144.795.16E.090 | PSC80 x STA16E - 90 | 90 | 25 | 28 | 42 | PSC80 x STA1 | STA1 - ER16A - 25 | 3.07 |
| 144.795.16E.135 | PSC80 x STA16E - 135 | 135 | 70 | 28 | 42 | PSC80 x STA1 | STA1 - ER16A - 70 | 3.27 |
| 144.795.16E.215 | PSC80 x STA16E - 215 | 215 | 150 | 28 | 42 | PSC80 x STA1 | STA1 - ER16A - 150 | 3.60 |
| 144.795.20E.099 | PSC80 x STA20E - 99 | 99 | 34 | 34 | 42 | PSC80 x STA1 | STA1 - ER20A - 34 | 3.11 |
| 144.795.20E.135 | PSC80 x STA20E - 135 | 135 | 70 | 34 | 42 | PSC80 x STA1 | STA1 - ER20A - 70 | 3.27 |
| 144.795.32E.125 | PSC80 x STA32E - 125 | 125 | 40 | 50 | 58 | PSC80 x STA2 | STA2 - ER32 - 40 | 3.55 |
| 144.795.32E.155 | PSC80 x STA32E - 155 | 155 | 70 | 50 | 58 | PSC80 x STA2 | STA1 - ER32 - 70 | 3.78 |

Standard Accessory: • NUT

| Collet | Nut | Spanner |
|----------|--------|-----------|
| | | |
| P.W-7~28 | P.W-48 | P.W-68~71 |



STRAIGHT SHANK STA SYNCHRONIZED TAPPING HOLDER



直柄 STA 同步補償攻牙刀桿

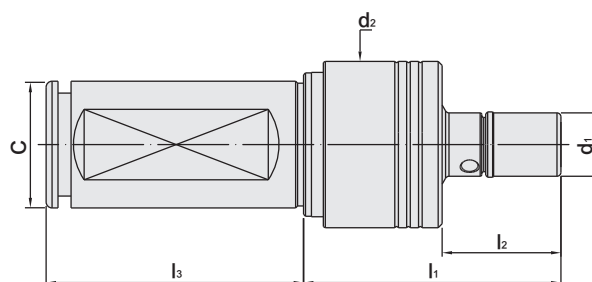

| MODEL NO. | TYPE | l ₁ | l ₂ | l ₃ | C | d ₁ | d ₂ | COMBINATION | | WEIGHT (KGS) |
|-----------------|--------------------|----------------|----------------|----------------|----|----------------|----------------|-------------|---------------------|--------------|
| | | | | | | | | BODY | TAP ADAPTER | |
| C20.795.08T.075 | C20 x STA8T - 75 | 75 | 30 | 55 | 20 | 12 | 42 | C20 x STA1 | STA1 - PTER8 - 30 | 0.50 |
| C20.795.08T.115 | C20 x STA8T - 115 | 115 | 70 | 55 | 20 | 12 | 42 | C20 x STA1 | STA1 - PTER8 - 70 | 0.56 |
| C20.795.08T.145 | C20 x STA8T - 145 | 145 | 100 | 55 | 20 | 12 | 42 | C20 x STA1 | STA1 - PTER8 - 100 | 0.61 |
| C20.795.11T.075 | C20 x STA11T - 75 | 75 | 30 | 55 | 20 | 16 | 42 | C20 x STA1 | STA1 - PTER11 - 30 | 0.95 |
| C20.795.11T.115 | C20 x STA11T - 115 | 115 | 70 | 55 | 20 | 16 | 42 | C20 x STA1 | STA1 - PTER11 - 70 | 1.01 |
| C20.795.11T.145 | C20 x STA11T - 145 | 145 | 100 | 55 | 20 | 16 | 42 | C20 x STA1 | STA1 - PTER11 - 100 | 1.05 |
| C20.795.16T.075 | C20 x STA16T - 75 | 75 | 30 | 55 | 20 | 22 | 42 | C20 x STA1 | STA1 - PTER16 - 30 | 0.96 |
| C20.795.16T.115 | C20 x STA16T - 115 | 115 | 70 | 55 | 20 | 22 | 42 | C20 x STA1 | STA1 - PTER16 - 70 | 1.02 |
| C20.795.16T.145 | C20 x STA16T - 145 | 145 | 100 | 55 | 20 | 22 | 42 | C20 x STA1 | STA1 - PTER16 - 100 | 1.06 |
| C20.795.20T.075 | C20 x STA20T - 75 | 75 | 30 | 55 | 20 | 28 | 42 | C20 x STA1 | STA1 - PTER20 - 30 | 0.93 |
| C20.795.20T.115 | C20 x STA20T - 115 | 115 | 70 | 55 | 20 | 28 | 42 | C20 x STA1 | STA1 - PTER20 - 70 | 1.20 |
| C20.795.20T.145 | C20 x STA20T - 145 | 145 | 100 | 55 | 20 | 28 | 42 | C20 x STA1 | STA1 - PTER20 - 100 | 1.36 |
| C25.795.08T.070 | C25 x STA8T - 70 | 70 | 30 | 60 | 25 | 12 | 42 | C25 x STA1 | STA1 - PTER8 - 30 | 0.54 |
| C25.795.08T.110 | C25 x STA8T - 110 | 110 | 70 | 60 | 25 | 12 | 42 | C25 x STA1 | STA1 - PTER8 - 70 | 0.58 |
| C25.795.08T.140 | C25 x STA8T - 140 | 140 | 100 | 60 | 25 | 12 | 42 | C25 x STA1 | STA1 - PTER8 - 100 | 0.63 |
| C25.795.11T.070 | C25 x STA11T - 070 | 70 | 30 | 60 | 25 | 16 | 42 | C25 x STA1 | STA1 - PTER11 - 30 | 0.99 |
| C25.795.11T.110 | C25 x STA11T - 110 | 110 | 70 | 60 | 25 | 16 | 42 | C25 x STA1 | STA1 - PTER11 - 70 | 1.04 |
| C25.795.11T.140 | C25 x STA11T - 140 | 140 | 100 | 60 | 25 | 16 | 42 | C25 x STA1 | STA1 - PTER11 - 100 | 1.08 |
| C25.795.16T.070 | C25 x STA16T - 70 | 70 | 30 | 60 | 25 | 22 | 42 | C25 x STA1 | STA1 - PTER16 - 30 | 1.00 |
| C25.795.16T.110 | C25 x STA16T - 110 | 110 | 70 | 60 | 25 | 22 | 42 | C25 x STA1 | STA1 - PTER16 - 70 | 1.06 |
| C25.795.16T.140 | C25 x STA16T - 140 | 140 | 100 | 60 | 25 | 22 | 42 | C25 x STA1 | STA1 - PTER16 - 100 | 1.10 |
| C25.795.20T.070 | C25 x STA20T - 70 | 70 | 30 | 60 | 25 | 28 | 42 | C25 x STA1 | STA1 - PTER20 - 30 | 0.97 |
| C25.795.20T.110 | C25 x STA20T - 110 | 110 | 70 | 60 | 25 | 28 | 42 | C25 x STA1 | STA1 - PTER20 - 70 | 1.24 |
| C25.795.20T.140 | C25 x STA20T - 140 | 140 | 100 | 60 | 25 | 28 | 42 | C25 x STA1 | STA1 - PTER20 - 100 | 1.40 |

Standard Accessory: • NUT

| Collet | Nut | Spanner |
|--------|--------|-----------|
| | | |
| P.W-5 | P.W-47 | P.W-68~73 |



STRAIGHT SHANK STA SYNCHRONIZED TAPPING HOLDER



直柄 STA 同步補償攻牙刀桿

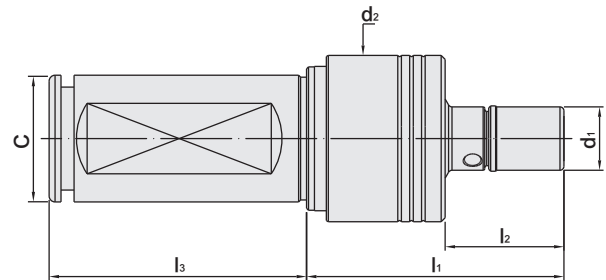

| MODEL NO. | TYPE | l ₁ | l ₂ | l ₃ | C | d ₁ | d ₂ | COMBINATION | | WEIGHT (KGS) |
|-----------------|--------------------|----------------|----------------|----------------|----|----------------|----------------|-------------|---------------------|--------------|
| | | | | | | | | BODY | TAP ADAPTER | |
| C32.795.08T.065 | C32 x STA8T - 65 | 65 | 30 | 65 | 32 | 12 | 42 | C32 x STA1 | STA1 - PTER8 - 30 | 0.65 |
| C32.795.08T.105 | C32 x STA8T - 105 | 105 | 70 | 65 | 32 | 12 | 42 | C32 x STA1 | STA1 - PTER8 - 70 | 0.71 |
| C32.795.08T.135 | C32 x STA8T - 135 | 135 | 100 | 65 | 32 | 12 | 42 | C32 x STA1 | STA1 - PTER8 - 100 | 0.76 |
| C32.795.11T.065 | C32 x STA11T - 65 | 65 | 30 | 65 | 32 | 16 | 42 | C32 x STA1 | STA1 - PTER11 - 30 | 1.10 |
| C32.795.11T.105 | C32 x STA11T - 105 | 105 | 70 | 65 | 32 | 16 | 42 | C32 x STA1 | STA1 - PTER11 - 70 | 1.16 |
| C32.795.11T.135 | C32 x STA11T - 135 | 135 | 100 | 65 | 32 | 16 | 42 | C32 x STA1 | STA1 - PTER11 - 100 | 1.20 |
| C32.795.16T.065 | C32 x STA16T - 65 | 65 | 30 | 65 | 32 | 22 | 42 | C32 x STA1 | STA1 - PTER16 - 30 | 1.11 |
| C32.795.16T.105 | C32 x STA16T - 105 | 105 | 70 | 65 | 32 | 22 | 42 | C32 x STA1 | STA1 - PTER16 - 70 | 1.17 |
| C32.795.16T.135 | C32 x STA16T - 135 | 135 | 100 | 65 | 32 | 22 | 42 | C32 x STA1 | STA1 - PTER16 - 100 | 1.21 |
| C32.795.20T.065 | C32 x STA20T - 65 | 65 | 30 | 65 | 32 | 28 | 42 | C32 x STA1 | STA1 - PTER20 - 30 | 1.08 |
| C32.795.20T.105 | C32 x STA20T - 105 | 105 | 70 | 65 | 32 | 28 | 42 | C32 x STA1 | STA1 - PTER20 - 70 | 1.35 |
| C32.795.20T.135 | C32 x STA20T - 135 | 135 | 100 | 65 | 32 | 28 | 42 | C32 x STA1 | STA1 - PTER20 - 100 | 1.51 |
| C32.795.25T.090 | C32 x STA25T - 90 | 90 | 30 | 65 | 32 | 35 | 58 | C32 x STA2 | STA2 - PTER25 - 30 | 1.40 |
| C32.795.25T.130 | C32 x STA25T - 130 | 130 | 70 | 65 | 32 | 35 | 58 | C32 x STA2 | STA2 - PTER25 - 70 | 1.72 |
| C32.795.25T.160 | C32 x STA25T - 160 | 160 | 100 | 65 | 32 | 35 | 58 | C32 x STA2 | STA2 - PTER25 - 100 | 1.88 |
| C40.795.08T.065 | C40 x STA8T - 65 | 65 | 30 | 75 | 40 | 12 | 42 | C40 x STA1 | STA1 - PTER8 - 30 | 0.97 |
| C40.795.08T.105 | C40 x STA8T - 105 | 105 | 70 | 75 | 40 | 12 | 42 | C40 x STA1 | STA1 - PTER8 - 70 | 1.47 |
| C40.795.08T.135 | C40 x STA8T - 135 | 135 | 100 | 75 | 40 | 12 | 42 | C40 x STA1 | STA1 - PTER8 - 100 | 1.52 |
| C40.795.11T.065 | C40 x STA11T - 65 | 65 | 30 | 75 | 40 | 16 | 42 | C40 x STA1 | STA1 - PTER11 - 30 | 1.42 |
| C40.795.11T.105 | C40 x STA11T - 105 | 105 | 70 | 75 | 40 | 16 | 42 | C40 x STA1 | STA1 - PTER11 - 70 | 1.48 |
| C40.795.11T.135 | C40 x STA11T - 135 | 135 | 100 | 75 | 40 | 16 | 42 | C40 x STA1 | STA1 - PTER11 - 100 | 1.53 |
| C40.795.16T.065 | C40 x STA16T - 65 | 65 | 30 | 75 | 40 | 22 | 42 | C40 x STA1 | STA1 - PTER16 - 30 | 1.43 |
| C40.795.16T.105 | C40 x STA16T - 105 | 105 | 70 | 75 | 40 | 22 | 42 | C40 x STA1 | STA1 - PTER16 - 70 | 1.49 |
| C40.795.16T.135 | C40 x STA16T - 135 | 135 | 100 | 75 | 40 | 22 | 42 | C40 x STA1 | STA1 - PTER16 - 100 | 1.53 |
| C40.795.20T.065 | C40 x STA20T - 65 | 65 | 30 | 75 | 40 | 28 | 42 | C40 x STA1 | STA1 - PTER20 - 30 | 1.40 |
| C40.795.20T.105 | C40 x STA20T - 105 | 105 | 70 | 75 | 40 | 28 | 42 | C40 x STA1 | STA1 - PTER20 - 70 | 1.67 |
| C40.795.20T.135 | C40 x STA20T - 135 | 135 | 100 | 75 | 40 | 28 | 42 | C40 x STA1 | STA1 - PTER20 - 100 | 1.83 |
| C40.795.25T.085 | C40 x STA25T - 85 | 85 | 30 | 75 | 40 | 35 | 58 | C40 x STA2 | STA2 - PTER25 - 30 | 1.75 |
| C40.795.25T.125 | C40 x STA25T - 125 | 125 | 70 | 75 | 40 | 35 | 58 | C40 x STA2 | STA2 - PTER25 - 70 | 2.02 |
| C40.795.25T.155 | C40 x STA25T - 155 | 155 | 100 | 75 | 40 | 35 | 58 | C40 x STA2 | STA2 - PTER25 - 100 | 2.18 |

Standard Accessory: • NUT

| Collet | Nut | Spanner |
|--------|--------|-----------|
| | | |
| P.W-5 | P.W-47 | P.W-68~73 |



STRAIGHT SHANK STA SYNCHRONIZED TAPPING HOLDER



直柄 STA 同步補償攻牙刀桿

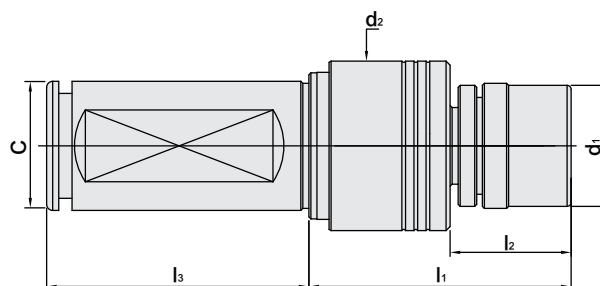

| MODEL NO. | TYPE | l ₁ | l ₂ | l ₃ | C | d ₁ | d ₂ | COMBINATION | | WEIGHT (KGS) |
|-----------------|--------------------|----------------|----------------|----------------|----|----------------|----------------|-------------|-------------------|--------------|
| | | | | | | | | BODY | TAP ADAPTER | |
| C20.795.16U.075 | C20 x STA16U - 75 | 75 | 30 | 55 | 20 | 30 | 42 | C20 x STA1 | STA1 - UT16 - 30 | 0.53 |
| C20.795.16U.115 | C20 x STA16U - 115 | 115 | 70 | 55 | 20 | 30 | 42 | C20 x STA1 | STA1 - UT16 - 70 | 0.68 |
| C20.795.16U.145 | C20 x STA16U - 145 | 145 | 100 | 55 | 20 | 30 | 42 | C20 x STA1 | STA1 - UT16 - 100 | 0.88 |
| C25.795.16U.070 | C25 x STA16U - 70 | 70 | 30 | 60 | 25 | 30 | 42 | C25 x STA1 | STA1 - UT16 - 30 | 0.57 |
| C25.795.16U.110 | C25 x STA16U - 110 | 110 | 70 | 60 | 25 | 30 | 42 | C25 x STA1 | STA1 - UT16 - 70 | 0.72 |
| C25.795.16U.140 | C25 x STA16U - 140 | 140 | 100 | 60 | 25 | 30 | 42 | C25 x STA1 | STA1 - UT16 - 100 | 0.92 |
| C32.795.16U.065 | C32 x STA16U - 65 | 65 | 30 | 65 | 32 | 30 | 42 | C32 x STA1 | STA1 - UT16 - 30 | 0.68 |
| C32.795.16U.105 | C32 x STA16U - 105 | 105 | 70 | 65 | 32 | 30 | 42 | C32 x STA1 | STA1 - UT16 - 70 | 0.83 |
| C32.795.16U.135 | C32 x STA16U - 135 | 135 | 100 | 65 | 32 | 30 | 42 | C32 x STA1 | STA1 - UT16 - 100 | 1.03 |
| C32.795.20U.090 | C32 x STA20U - 90 | 90 | 30 | 65 | 32 | 36 | 58 | C32 x STA2 | STA2 - UT20 - 30 | 1.20 |
| C32.795.20U.130 | C32 x STA20U - 130 | 130 | 70 | 65 | 32 | 36 | 58 | C32 x STA2 | STA2 - UT20 - 70 | 1.40 |
| C32.795.20U.160 | C32 x STA20U - 160 | 160 | 100 | 65 | 32 | 36 | 58 | C32 x STA2 | STA2 - UT20 - 100 | 1.53 |
| C32.795.25U.095 | C32 x STA25U - 95 | 90 | 30 | 65 | 32 | 42 | 58 | C32 x STA2 | STA2 - UT25 - 35 | 1.20 |
| C32.795.25U.145 | C32 x STA25U - 145 | 140 | 70 | 65 | 32 | 42 | 58 | C32 x STA2 | STA2 - UT25 - 85 | 1.55 |
| C32.795.25U.175 | C32 x STA25U - 175 | 170 | 100 | 65 | 32 | 42 | 58 | C32 x STA2 | STA2 - UT25 - 115 | 1.80 |
| C32.795.32U.110 | C32 x STA32U - 110 | 110 | 50 | 65 | 32 | 48 | 58 | C32 x STA2 | STA2 - UT32 - 50 | 1.25 |
| C32.795.32U.145 | C32 x STA32U - 145 | 145 | 85 | 65 | 32 | 48 | 58 | C32 x STA2 | STA2 - UT32 - 85 | 1.50 |
| C32.795.32U.175 | C32 x STA32U - 175 | 175 | 115 | 65 | 32 | 48 | 58 | C32 x STA2 | STA2 - UT32 - 115 | 1.70 |
| C40.795.16U.065 | C40 x STA16U - 65 | 65 | 30 | 75 | 40 | 30 | 42 | C40 x STA1 | STA1 - UT16 - 30 | 1.00 |
| C40.795.16U.105 | C40 x STA16U - 105 | 105 | 70 | 75 | 40 | 30 | 42 | C40 x STA1 | STA1 - UT16 - 70 | 1.15 |
| C40.795.16U.135 | C40 x STA16U - 135 | 135 | 100 | 75 | 40 | 30 | 42 | C40 x STA1 | STA1 - UT16 - 100 | 1.35 |
| C40.795.20U.085 | C40 x STA20U - 85 | 85 | 30 | 75 | 40 | 36 | 58 | C40 x STA2 | STA2 - UT20 - 30 | 1.50 |
| C40.795.20U.125 | C40 x STA20U - 125 | 125 | 70 | 75 | 40 | 36 | 58 | C40 x STA2 | STA2 - UT20 - 70 | 1.70 |
| C40.795.20U.155 | C40 x STA20U - 155 | 155 | 100 | 75 | 40 | 36 | 58 | C40 x STA2 | STA2 - UT20 - 100 | 1.83 |
| C40.795.25U.090 | C40 x STA25U - 90 | 90 | 35 | 75 | 40 | 42 | 58 | C40 x STA2 | STA2 - UT25 - 35 | 1.50 |
| C40.795.25U.140 | C40 x STA25U - 140 | 140 | 85 | 75 | 40 | 42 | 58 | C40 x STA2 | STA2 - UT25 - 85 | 1.85 |
| C40.795.25U.170 | C40 x STA25U - 170 | 170 | 115 | 75 | 40 | 42 | 58 | C40 x STA2 | STA2 - UT25 - 115 | 2.10 |
| C40.795.32U.105 | C40 x STA32U - 105 | 105 | 50 | 75 | 40 | 48 | 58 | C40 x STA2 | STA2 - UT32 - 50 | 1.55 |
| C40.795.32U.140 | C40 x STA32U - 140 | 140 | 85 | 75 | 40 | 48 | 58 | C40 x STA2 | STA2 - UT32 - 85 | 1.80 |
| C40.795.32U.170 | C40 x STA32U - 170 | 170 | 115 | 75 | 40 | 48 | 58 | C40 x STA2 | STA2 - UT32 - 115 | 2.00 |

Standard Accessory: • NUT

| Collet | Nut | Spanner |
|----------|--------|-----------|
| | | |
| P.W-7~10 | P.W-47 | P.W-68~73 |



STRAIGHT SHANK STA SYNCHRONIZED TAPPING HOLDER



直柄 STA 同步補償攻牙刀桿

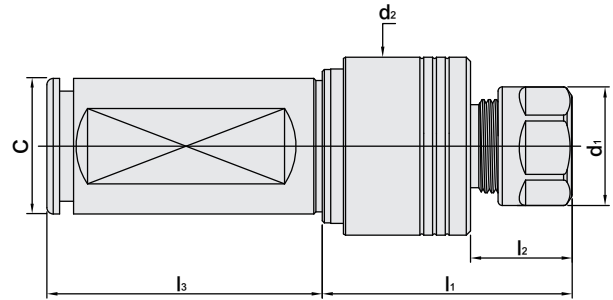

| MODEL NO. | TYPE | l ₁ | l ₂ | l ₃ | C | d ₁ | d ₂ | COMBINATION | | WEIGHT (KGS) |
|-----------------|--------------------|----------------|----------------|----------------|----|----------------|----------------|-------------|--------------------|--------------|
| | | | | | | | | BODY | TAP ADAPTER | |
| C20.795.11E.115 | C20 x STA11E - 115 | 115 | 70 | 55 | 20 | 19 | 42 | C20 x STA1 | STA1 - ER11A - 70 | 0.74 |
| C20.795.16E.070 | C20 x STA16E - 70 | 70 | 25 | 55 | 20 | 28 | 42 | C20 x STA1 | STA1 - ER16A - 25 | 0.48 |
| C20.795.16E.115 | C20 x STA16E - 115 | 115 | 70 | 55 | 20 | 28 | 42 | C20 x STA1 | STA1 - ER16A - 70 | 0.68 |
| C20.795.16E.195 | C20 x STA16E - 195 | 195 | 150 | 55 | 20 | 28 | 42 | C20 x STA1 | STA1 - ER16A - 150 | 1.01 |
| C20.795.20E.079 | C20 x STA20E - 079 | 79 | 34 | 55 | 20 | 34 | 42 | C20 x STA1 | STA1 - ER20A - 34 | 0.52 |
| C20.795.20E.115 | C20 x STA20E - 115 | 115 | 70 | 55 | 20 | 34 | 42 | C20 x STA1 | STA1 - ER20A - 70 | 0.68 |
| C25.795.11E.110 | C25 x STA11E - 110 | 110 | 70 | 60 | 25 | 19 | 42 | C25 x STA1 | STA1 - ER11A - 70 | 0.78 |
| C25.795.16E.065 | C25 x STA16E - 65 | 65 | 25 | 60 | 25 | 28 | 42 | C25 x STA1 | STA1 - ER16A - 25 | 0.52 |
| C25.795.16E.110 | C25 x STA16E - 110 | 110 | 70 | 60 | 25 | 28 | 42 | C25 x STA1 | STA1 - ER16A - 70 | 0.72 |
| C25.795.16E.190 | C25 x STA16E - 190 | 190 | 150 | 60 | 25 | 28 | 42 | C25 x STA1 | STA1 - ER16A - 150 | 1.05 |
| C25.795.20E.079 | C25 x STA20E - 79 | 79 | 34 | 60 | 25 | 34 | 42 | C25 x STA1 | STA1 - ER20A - 34 | 0.52 |
| C25.795.20E.110 | C25 x STA20E - 110 | 110 | 70 | 60 | 25 | 34 | 42 | C25 x STA1 | STA1 - ER20A - 70 | 0.72 |
| C32.795.11E.105 | C32 x STA11E - 105 | 105 | 70 | 65 | 32 | 19 | 42 | C32 x STA1 | STA1 - ER11A - 70 | 0.89 |
| C32.795.16E.060 | C32 x STA16E - 60 | 60 | 25 | 65 | 32 | 28 | 42 | C32 x STA1 | STA1 - ER16A - 25 | 0.63 |
| C32.795.16E.105 | C32 x STA16E - 105 | 105 | 70 | 65 | 32 | 28 | 42 | C32 x STA1 | STA1 - ER16A - 70 | 0.83 |
| C32.795.16E.185 | C32 x STA16E - 185 | 185 | 150 | 65 | 32 | 28 | 42 | C32 x STA1 | STA1 - ER16A - 150 | 1.16 |
| C32.795.20E.069 | C32 x STA20E - 69 | 69 | 34 | 65 | 32 | 34 | 42 | C32 x STA1 | STA1 - ER20A - 34 | 0.67 |
| C32.795.20E.105 | C32 x STA20E - 105 | 105 | 70 | 65 | 32 | 34 | 42 | C32 x STA1 | STA1 - ER20A - 70 | 0.83 |
| C32.795.32E.100 | C32 x STA32E - 100 | 100 | 40 | 65 | 32 | 50 | 58 | C32 x STA2 | STA2 - ER32 - 40 | 1.34 |
| C32.795.32E.130 | C32 x STA32E - 130 | 130 | 70 | 65 | 32 | 50 | 58 | C32 x STA2 | STA2 - ER32 - 70 | 1.57 |
| C40.795.11E.105 | C40 x STA11E - 105 | 105 | 70 | 75 | 40 | 19 | 42 | C40 x STA1 | STA1 - ER11A - 70 | 1.21 |
| C40.795.16E.060 | C40 x STA16E - 60 | 60 | 25 | 75 | 40 | 28 | 42 | C40 x STA1 | STA1 - ER16A - 25 | 0.95 |
| C40.795.16E.105 | C40 x STA16E - 105 | 105 | 70 | 75 | 40 | 28 | 42 | C40 x STA1 | STA1 - ER16A - 70 | 1.15 |
| C40.795.16E.185 | C40 x STA16E - 185 | 185 | 150 | 75 | 40 | 28 | 42 | C40 x STA1 | STA1 - ER16A - 150 | 1.48 |
| C40.795.20E.069 | C40 x STA20E - 69 | 69 | 34 | 75 | 40 | 34 | 42 | C40 x STA1 | STA1 - ER20A - 34 | 0.99 |
| C40.795.20E.105 | C40 x STA20E - 105 | 105 | 70 | 75 | 40 | 34 | 42 | C40 x STA1 | STA1 - ER20A - 70 | 1.15 |
| C40.795.32E.095 | C40 x STA32E - 95 | 95 | 40 | 75 | 40 | 50 | 58 | C40 x STA2 | STA2 - ER32 - 40 | 1.64 |
| C40.795.32E.125 | C40 x STA32E - 125 | 125 | 70 | 75 | 40 | 50 | 58 | C40 x STA2 | STA2 - ER32 - 70 | 1.87 |

Standard Accessory: • NUT



| Collet | Nut | Spanner |
|----------|--------|-----------|
| | | |
| P.W-7~28 | P.W-48 | P.W-68~71 |

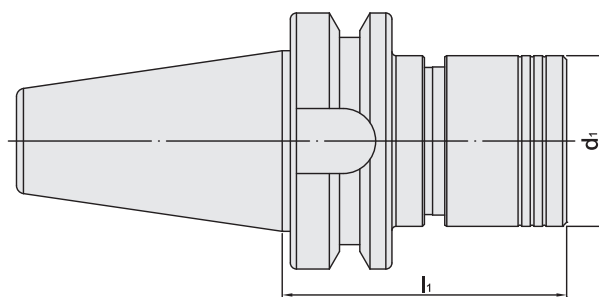

STA SYNCHRONIZED TAPPING HOLDER BODY

STA 同步補償攻牙刀桿本體

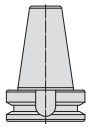
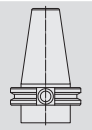
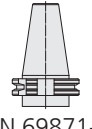
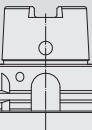



| SHANK | MODEL NO. | TYPE | l_1 | d_1 | STA NO. | WEIGHT (KGS) |
|--|------------|----------------|-------|-------|---------|--------------|
|  MAS 403 | 10.795.01 | BT30 x STA1 | 60 | 42 | 1 | 0.56 |
| | 11.795.01 | BT40 x STA1 | 70 | 42 | 1 | 1.18 |
| | 11.795.02 | BT40 x STA2 | 85 | 58 | 2 | 1.48 |
| | 12.795.01 | BT50 x STA1 | 60 | 42 | 1 | 3.68 |
| | 12.795.02 | BT50 x STA2 | 95 | 58 | 2 | 3.98 |
|  ANSI B5.50 | 31.795.01 | CAT40 x STA1 | 70 | 42 | 1 | 1.12 |
| | 31.795.02 | CAT40 x STA2 | 90 | 58 | 2 | 1.45 |
| | 32.795.01 | CAT50 x STA1 | 70 | 42 | 1 | 3.12 |
| | 32.795.02 | CAT50 x STA2 | 95 | 58 | 2 | 3.53 |
|  DIN 69871-A | 51.795.01 | DAT40 x STA1 | 60 | 42 | 1 | 1.01 |
| | 51.795.02 | DAT40 x STA2 | 90 | 58 | 2 | 1.50 |
| | 52.795.01 | DAT50 x STA1 | 60 | 42 | 1 | 2.73 |
| | 52.795.02 | DAT50 x STA2 | 80 | 58 | 2 | 3.11 |
|  DIN 69893 A | 71.795.01 | HSK40A x STA1 | 70 | 42 | 1 | 1.10 |
| | 72.795.01 | HSK50A x STA1 | 70 | 42 | 1 | 1.31 |
| | 73.795.01 | HSK63A x STA1 | 80 | 42 | 1 | 1.60 |
| | 74.795.01 | HSK80A x STA1 | 80 | 42 | 1 | 1.98 |
| | 74.795.02 | HSK80A x STA2 | 95 | 58 | 2 | 2.80 |
| | 75.795.01 | HSK100A x STA1 | 80 | 42 | 1 | 2.78 |
| | 75.795.02 | HSK100A x STA2 | 95 | 58 | 2 | 3.60 |
|  ISO 26623-1 | 142.795.01 | PSC50 x STA1 | 80 | 42 | 1 | 1.43 |
| | 143.795.01 | PSC63 x STA1 | 60 | 42 | 1 | 1.55 |
| | 143.795.02 | PSC63 x STA2 | 80 | 58 | 2 | 2.21 |
| | 144.795.01 | PSC80 x STA1 | 65 | 42 | 1 | 2.97 |
| | 144.795.02 | PSC80 x STA2 | 85 | 58 | 2 | 3.11 |

STA SYNCHRONIZED TAPPING HOLDER BODY

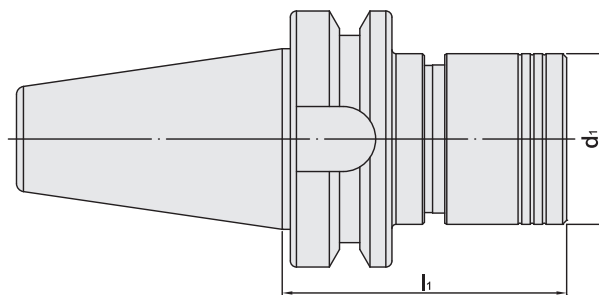
STA 同步補償攻牙刀桿本體

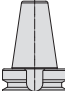

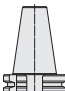
| SHANK | MODEL NO. | TYPE | l_1 | d_1 | STA NO. | WEIGHT (KGS) |
|---|-----------|---------------|-------|-------|---------|--------------|
|  DualDRIVE+ | 25.795.01 | SBT30 x STA1 | 60 | 42 | 1 | 0.56 |
| | 26.795.01 | SBT40 x STA1 | 70 | 42 | 1 | 1.18 |
| | 26.795.02 | SBT40 x STA2 | 85 | 58 | 2 | 1.48 |
| | 27.795.01 | SBT50 x STA1 | 80 | 42 | 1 | 3.68 |
| | 27.795.02 | SBT50 x STA2 | 95 | 58 | 2 | 3.98 |
|  DualDRIVE+ | 43.795.01 | SCAT40 x STA1 | 70 | 42 | 1 | 1.12 |
| | 43.795.02 | SCAT40 x STA2 | 90 | 58 | 2 | 1.45 |
| | 44.795.01 | SCAT50 x STA1 | 70 | 42 | 1 | 3.12 |
| | 44.795.02 | SCAT50 x STA2 | 95 | 58 | 2 | 3.53 |
|  DualDRIVE+ | 66.795.01 | SDAT40 x STA1 | 60 | 42 | 1 | 1.01 |
| | 66.795.02 | SDAT40 x STA2 | 90 | 58 | 2 | 1.50 |
| | 67.795.01 | SDAT50 x STA1 | 60 | 42 | 1 | 2.73 |
| | 67.795.02 | SDAT50 x STA2 | 80 | 58 | 2 | 3.11 |

STRAIGHT SHANK

STA SYNCHRONIZED TAPPING HOLDER BODY

直柄 STA 同步補償攻牙刀桿本體

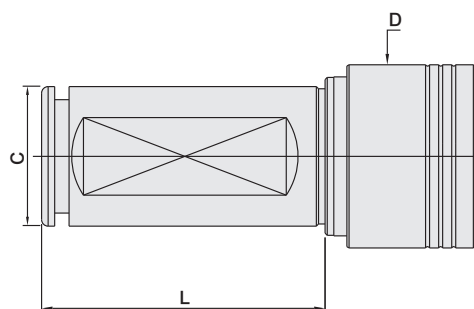

| MODEL NO. | TYPE | L | C | D | STA NO. | WEIGHT (KGS) |
|----------------|------------|----|----|----|---------|--------------|
| C20.795.055.01 | C20 x STA1 | 55 | 20 | 42 | 1 | 0.38 |
| C25.795.060.01 | C25 x STA1 | 60 | 25 | 42 | 1 | 0.42 |
| C32.795.065.01 | C32 x STA1 | 65 | 32 | 42 | 1 | 0.52 |
| C32.795.065.02 | C32 x STA2 | 65 | 32 | 58 | 2 | 0.90 |
| C40.795.075.01 | C40 x STA1 | 75 | 40 | 42 | 1 | 0.82 |
| C40.795.075.02 | C40 x STA2 | 75 | 40 | 58 | 2 | 1.13 |

TAP ADAPTER FOR STA



STA 同步補償攻牙刀桿心軸

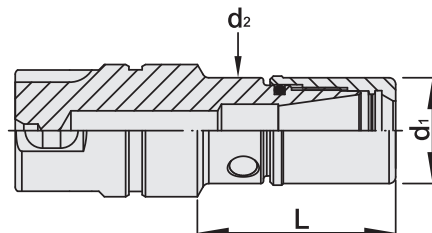

| MODEL NO. | TYPE | L | d ₁ | d ₂ | CAPACITY | WEIGHT (KGS) |
|----------------|---------------------|-----|----------------|----------------|----------|--------------|
| 795.528.08.030 | STA1 - PTER8 - 30 | 30 | 12 | 12 | M3 ~ M5 | 0.12 |
| 795.528.08.070 | STA1 - PTER8 - 70 | 70 | 12 | 12 | M3 ~ M5 | 0.18 |
| 795.528.08.100 | STA1 - PTER8 - 100 | 100 | 12 | 12 | M3 ~ M5 | 0.23 |
| 795.528.11.030 | STA1 - PTER11 - 30 | 30 | 16 | 16 | M3 ~ M6 | 0.57 |
| 795.528.11.070 | STA1 - PTER11 - 70 | 70 | 16 | 16 | M3 ~ M6 | 0.63 |
| 795.528.11.100 | STA1 - PTER11 - 100 | 100 | 16 | 16 | M3 ~ M6 | 0.67 |
| 795.528.16.030 | STA1 - PTER16 - 30 | 30 | 22 | 22 | M3 ~ M12 | 0.58 |
| 795.528.16.070 | STA1 - PTER16 - 70 | 70 | 22 | 22 | M3 ~ M12 | 0.64 |
| 795.528.16.100 | STA1 - PTER16 - 100 | 100 | 22 | 22 | M3 ~ M12 | 0.68 |
| 795.528.20.030 | STA1 - PTER20 - 30 | 30 | 28 | 28 | M3 ~ M16 | 0.55 |
| 795.528.20.070 | STA1 - PTER20 - 70 | 70 | 28 | 28 | M3 ~ M16 | 0.82 |
| 795.528.20.100 | STA1 - PTER20 - 100 | 100 | 28 | 28 | M3 ~ M16 | 0.98 |
| 795.528.25.030 | STA2 - PTER25 - 30 | 30 | 35 | 35 | M6 ~ M18 | 0.55 |
| 795.528.25.070 | STA2 - PTER25 - 70 | 70 | 35 | 35 | M6 ~ M18 | 0.82 |
| 795.528.25.100 | STA2 - PTER25 - 100 | 100 | 35 | 35 | M6 ~ M18 | 0.98 |

Standard Accessory: • NUT

| Collet | Nut | Spanner |
|--------|--------|-----------|
| | | |
| P.W-5 | P.W-47 | P.W-68~73 |



TAP ADAPTER FOR STA



STA 同步補償攻牙刀桿心軸

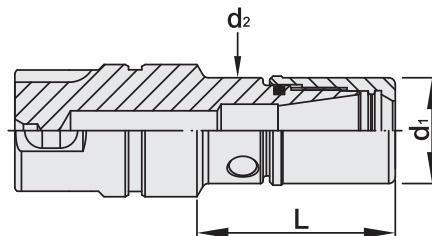

| MODEL NO. | TYPE | L | d ₁ | d ₂ | CAPACITY | WEIGHT (KGS) |
|----------------|-------------------|-----|----------------|----------------|-----------|--------------|
| 795.753.16.030 | STA1 - UT16 - 30 | 30 | 30 | 30 | M3 ~ M12 | 0.15 |
| 795.753.16.070 | STA1 - UT16 - 70 | 70 | 30 | 30 | M3 ~ M12 | 0.30 |
| 795.753.16.100 | STA1 - UT16 - 100 | 100 | 30 | 30 | M3 ~ M12 | 0.50 |
| 795.753.20.030 | STA2 - UT20 - 30 | 30 | 36 | - | M3 ~ M16 | 0.30 |
| 795.753.20.070 | STA2 - UT20 - 70 | 70 | 36 | 36 | M3 ~ M16 | 0.50 |
| 795.753.20.100 | STA2 - UT20 - 100 | 100 | 36 | 36 | M3 ~ M16 | 0.63 |
| 795.753.25.035 | STA2 - UT25 - 35 | 35 | 42 | 42 | M6 ~ M18 | 0.30 |
| 795.753.25.085 | STA2 - UT25 - 85 | 85 | 42 | 42 | M6 ~ M18 | 0.65 |
| 795.753.25.115 | STA2 - UT25 - 115 | 115 | 42 | 42 | M6 ~ M18 | 0.90 |
| 795.753.32.050 | STA2 - UT32 - 50 | 50 | 48 | 48 | M10 ~ M24 | 0.35 |
| 795.753.32.085 | STA2 - UT32 - 85 | 85 | 48 | 48 | M10 ~ M24 | 0.60 |
| 795.753.32.115 | STA2 - UT32 - 115 | 115 | 48 | 48 | M10 ~ M24 | 0.80 |

Standard Accessory: • NUT

| Collet | Nut | Spanner |
|----------|--------|-----------|
| | | |
| P.W-7~10 | P.W-47 | P.W-68~73 |



TAP ADAPTER FOR STA



STA 同步補償攻牙刀桿心軸

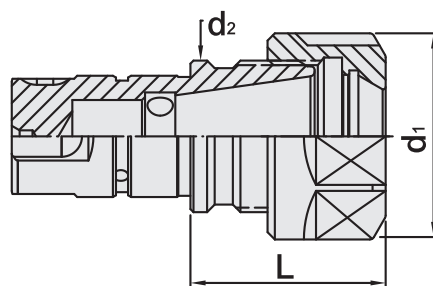

| MODEL NO. | TYPE | L | d ₁ | d ₂ | CAPACITY | WEIGHT (KGS) |
|----------------|--------------------|-----|----------------|----------------|-----------|--------------|
| 686.122.11.070 | STA1 - ER11A - 70 | 70 | 19 | 19 | M3 ~ M6 | 0.36 |
| 686.122.16.025 | STA1 - ER16A - 25 | 25 | 28 | 20 | M3 ~ M12 | 0.10 |
| 686.122.16.070 | STA1 - ER16A - 70 | 70 | 28 | 22 | M3 ~ M12 | 0.30 |
| 686.122.16.150 | STA1 - ER16A - 150 | 150 | 28 | 28 | M3 ~ M12 | 0.63 |
| 686.122.20.034 | STA1 - ER20A - 34 | 34 | 34 | 25 | M3 ~ M16 | 0.14 |
| 686.122.20.070 | STA1 - ER20A - 70 | 70 | 34 | 25 | M3 ~ M16 | 0.30 |
| 686.122.32.040 | STA2 - ER32 - 40 | 40 | 50 | 40 | M10 ~ M24 | 0.44 |
| 686.122.32.070 | STA2 - ER32 - 70 | 70 | 50 | 40 | M10 ~ M24 | 0.67 |

Standard Accessory: • NUT

| Collet | Nut | Spanner |
|----------|--------|-----------|
| | | |
| P.W-7~28 | P.W-48 | P.W-68~71 |



MEMO

Blank lined area for writing a memo.

