



SKX COLLET CHUCK

NO.2018-01

www.syic.com

SKX CATEGORY

SKX PRODUCT DESCRIPTION	1
SBT / SKX COLLET CHUCK	2~4
SCAT / SKX COLLET CHUCK	5~6
SDAT / SKX COLLET CHUCK	7~8
HSK-A / SKX COLLET CHUCK	9~10
HSK-E / SKX COLLET CHUCK	11
HSK-F / SKX COLLET CHUCK	12
PSC / SKX COLLET CHUCK	13
ACCESSORIES	14~17

HIGH SPEED

HIGH RIGIDITY

HIGH PRECISION

5 μ m



SKX COLLET CHUCK SYSTEM

▶ SKX sealed nuts and sealed caps are capable of coolant pressure up to 70 bar.



▶ Compared to other brand, shorter distance between sealed cap, sealed nut and collets allows shorter tool overhanging length.

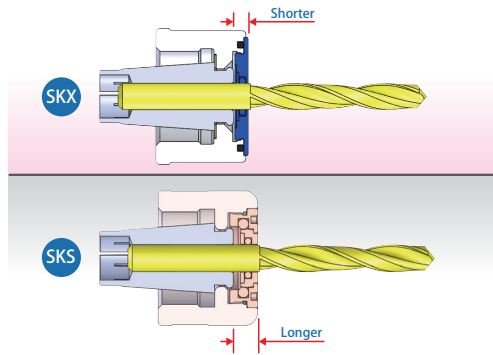

▶ Special SKX sealed cap holes avoid the problem of slipping when fastening.

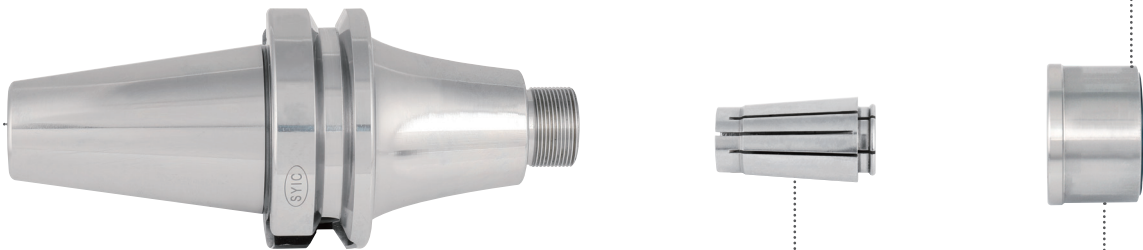

▶ Besides the standard design of straight neck, SKX tool holders of length over 120mm also have curved line design for better rigidity and less vibration.

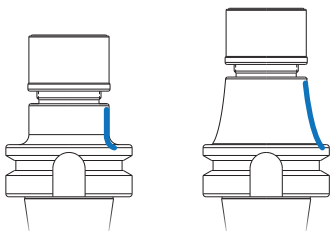

▶ SKX tool holders and collets are exchangeable with other brands.

▶ The OD of SKX nut is the same with other brand, so it's workable with other brand spanners.



SBT / SKX COLLET CHUCK

SBT / SKX 法蘭加厚型立銑刀夾頭

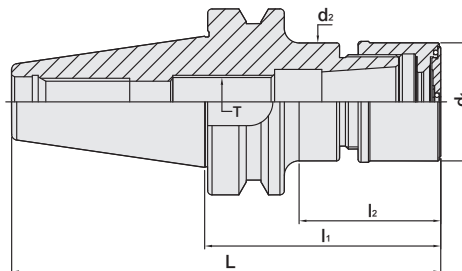

MODEL NO.	TYPE	L	l ₁	l ₂	d ₁	d ₂	T	SIZE RANGE	WEIGHT (KGS)
25.790.06.060	SBT30 x SKX6 - 60	108.4	60	33	18	18	M8 x 1.25P	3 ~ 6	0.70
25.790.06.090	SBT30 x SKX6 - 90	138.4	90	56	18	18	M8 x 1.25P	3 ~ 6	0.70
25.790.06.120	SBT30 x SKX6 - 120	168.4	120	86	18	18	M8 x 1.25P	3 ~ 6	0.80
25.790.10.045	SBT30 x SKX10 - 45	93.4	45	23	30	30	M12 x 1.75P	3 ~ 10	0.80
25.790.10.060	SBT30 x SKX10 - 60	108.4	60	35	30	30	M12 x 1.75P	3 ~ 10	0.90
25.790.10.075	SBT30 x SKX10 - 75	123.4	75	50	30	30	M12 x 1.75P	3 ~ 10	1.00
25.790.10.090	SBT30 x SKX10 - 90	138.4	90	65	30	30	M12 x 1.75P	3 ~ 10	1.00
25.790.10.120	SBT30 x SKX10 - 120	168.4	120	95	30	30	M12 x 1.75P	3 ~ 10	1.10
25.790.16.060	SBT30 x SKX16 - 60	108.4	60	35	40	40	M18 x 1.5P	3 ~ 16	1.10
25.790.16.075	SBT30 x SKX16 - 75	123.4	75	50	40	40	M18 x 1.5P	3 ~ 16	1.20
25.790.16.090	SBT30 x SKX16 - 90	138.4	90	65	40	40	M18 x 1.5P	3 ~ 16	1.20
25.790.16.120	SBT30 x SKX16 - 120	168.4	120	95	40	40	M18 x 1.5P	3 ~ 16	1.30
25.790.20.060	SBT30 x SKX20 - 60	108.4	60	30	48.5	48.5	M12 x 1.75P	3 ~ 20	0.70
25.790.20.075	SBT30 x SKX20 - 75	123.4	75	45	48.5	48.5	M12 x 1.75P	3 ~ 20	0.90
25.790.20.090	SBT30 x SKX20 - 90	138.4	90	60	48.5	48.5	M12 x 1.75P	3 ~ 20	1.20
25.790.25.090	SBT30 x SKX25 - 90	138.4	90	60	55	55	M12 x 1.75P	3 ~ 25	1.50

Features:

- ▶ SKX sealed cap is optional. Please order SKX sealed cap additionally.
- ▶ With the design of SKX sealed cap, coolant pressure capable up to 70 bar.
- ▶ Used with coolant-through tools.
- ▶ Balance: G2.5 25,000rpm.



SBT / SKX COLLET CHUCK

SBT / SKX 法蘭加厚型立銑刀夾頭



Fig.1

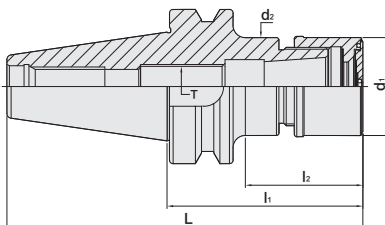
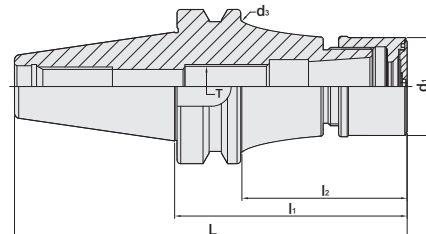

Fig.2



MODEL NO.	TYPE	L	l ₁	l ₂	d ₁	d ₂	d ₃	T	SIZE RANGE	Fig.	WEIGHT (KGS)
26.790.06.060	SBT40 x SKX6 - 60	125.4	60	30	18	18	-	M8 x 1.25P	3 ~ 6	1	1.00
26.790.06.090	SBT40 x SKX6 - 90	155.4	90	51	18	18	-	M8 x 1.25P	3 ~ 6	1	1.10
26.790.06.120	SBT40 x SKX6 - 120	185.4	120	93	18	18	53	M8 x 1.25P	3 ~ 6	2	1.56
26.790.06.150	SBT40 x SKX6 - 150	215.4	150	123	18	18	53	M8 x 1.25P	3 ~ 6	2	1.72
26.790.10.060	SBT40 x SKX10 - 60	125.4	60	32	30	30	-	M12 x 1.75P	3 ~ 10	1	1.10
26.790.10.075	SBT40 x SKX10 - 75	140.4	75	45	30	30	-	M12 x 1.75P	3 ~ 10	1	1.20
26.790.10.090	SBT40 x SKX10 - 90	155.4	90	48	30	30	-	M12 x 1.75P	3 ~ 10	1	1.20
26.790.10.120	SBT40 x SKX10 - 120	185.4	120	93	30	30	53	M12 x 1.75P	3 ~ 10	2	1.40
26.790.10.150	SBT40 x SKX10 - 150	215.4	150	123	30	30	53	M12 x 1.75P	3 ~ 10	2	1.91
26.790.10.180	SBT40 x SKX10 - 180	245.4	180	153	30	30	53	M12 x 1.75P	3 ~ 10	2	2.08
26.790.10.200	SBT40 x SKX10 - 200	265.4	200	173	30	30	53	M12 x 1.75P	3 ~ 10	2	2.17
26.790.10.250	SBT40 x SKX10 - 250	315.4	250	223	30	30	53	M12 x 1.75P	3 ~ 10	2	2.31
26.790.16.060	SBT40 x SKX16 - 60	125.4	60	32	40	40	-	M18 x 1.5P	3 ~ 16	1	1.30
26.790.16.075	SBT40 x SKX16 - 75	140.4	75	43	40	40	-	M18 x 1.5P	3 ~ 16	1	1.40
26.790.16.090	SBT40 x SKX16 - 90	155.4	90	58	40	40	-	M18 x 1.5P	3 ~ 16	1	1.50
26.790.16.120	SBT40 x SKX16 - 120	185.4	120	93	40	40	62.5	M18 x 1.5P	3 ~ 16	2	1.83
26.790.16.150	SBT40 x SKX16 - 150	215.4	150	123	40	40	62.5	M18 x 1.5P	3 ~ 16	2	2.05
26.790.16.180	SBT40 x SKX16 - 180	245.4	180	153	40	40	62.5	M18 x 1.5P	3 ~ 16	2	2.27
26.790.16.200	SBT40 x SKX16 - 200	265.4	200	173	40	40	62.5	M18 x 1.5P	3 ~ 16	2	2.41
26.790.16.250	SBT40 x SKX16 - 250	315.4	250	223	40	40	62.5	M18 x 1.5P	3 ~ 16	2	3.21
26.790.20.060	SBT40 x SKX20 - 60	125.4	60	32	48.5	48.5	-	M22 x 1.5P	3 ~ 20	1	1.30
26.790.20.075	SBT40 x SKX20 - 75	140.4	75	45	48.5	48.5	-	M22 x 1.5P	3 ~ 20	1	1.40
26.790.20.090	SBT40 x SKX20 - 90	155.4	90	60	48.5	48.5	-	M22 x 1.5P	3 ~ 20	1	1.60
26.790.20.120	SBT40 x SKX20 - 120	185.4	120	93	48.5	48.5	62.5	M22 x 1.5P	3 ~ 20	2	2.00
26.790.25.075	SBT40 x SKX25 - 75	140.4	75	47	55	55	-	M28 x 2.0P	3 ~ 25	1	1.70
26.790.25.090	SBT40 x SKX25 - 90	155.4	90	61	55	55	-	M28 x 2.0P	3 ~ 25	1	1.80
26.790.25.120	SBT40 x SKX25 - 120	185.4	120	93	55	55	-	M28 x 2.0P	3 ~ 25	1	2.00

Features:

- ▶ SKX sealed cap is optional. Please order SKX sealed cap additionally.
- ▶ With the design of SKX sealed cap, coolant pressure capable up to 70 bar.
- ▶ Used with coolant-through tools.
- ▶ Balance: G2.5 25,000rpm.

SBT / SKX COLLET CHUCK

SBT / SKX 法蘭加厚型立銑刀夾頭



Fig.1

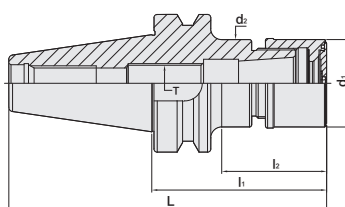
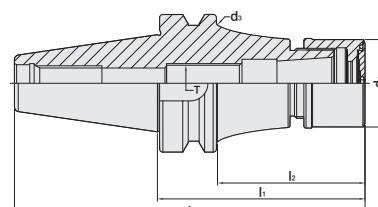

Fig.2



MODEL NO.	TYPE	L	l ₁	l ₂	d ₁	d ₂	d ₃	T	SIZE RANGE	Fig.	WEIGHT (KGS)
27.790.06.105	SBT50 x SKX6 - 105	206.8	105	55	18	18	-	M8 x 1.25P	3 ~ 6	1	3.80
27.790.06.135	SBT50 x SKX6 - 135	236.8	135	60	18	18	-	M8 x 1.25P	3 ~ 6	1	3.90
27.790.06.165	SBT50 x SKX6 - 165	266.8	165	85	18	18	-	M8 x 1.25P	3 ~ 6	1	4.00
27.790.06.200	SBT50 x SKX6 - 200	301.8	200	162	18	18	85	M8 x 1.25P	3 ~ 6	2	5.83
27.790.10.105	SBT50 x SKX10 - 105	206.8	105	57	30	30	-	M12 x 1.75P	3 ~ 10	1	4.20
27.790.10.135	SBT50 x SKX10 - 135	236.8	135	70	30	30	-	M12 x 1.75P	3 ~ 10	1	4.40
27.790.10.165	SBT50 x SKX10 - 165	266.8	165	90	30	30	-	M12 x 1.75P	3 ~ 10	1	4.60
27.790.10.200	SBT50 x SKX10 - 200	301.8	200	162	30	30	85	M12 x 1.75P	3 ~ 10	2	6.19
27.790.10.225	SBT50 x SKX10 - 225	326.8	225	187	30	30	85	M12 x 1.75P	3 ~ 10	2	6.56
27.790.10.250	SBT50 x SKX10 - 250	351.8	250	212	30	30	85	M12 x 1.75P	3 ~ 10	2	6.92
27.790.10.300	SBT50 x SKX10 - 300	401.8	300	262	30	30	85	M12 x 1.75P	3 ~ 10	2	7.55
27.790.16.105	SBT50 x SKX16 - 105	206.8	105	62	40	40	-	M18 x 1.5P	3 ~ 16	1	4.70
27.790.16.135	SBT50 x SKX16 - 135	236.8	135	92	40	40	-	M18 x 1.5P	3 ~ 16	1	4.90
27.790.16.165	SBT50 x SKX16 - 165	266.8	165	90	40	40	-	M18 x 1.5P	3 ~ 16	1	5.10
27.790.16.200	SBT50 x SKX16 - 200	301.8	200	162	40	40	85	M18 x 1.5P	3 ~ 16	2	6.31
27.790.16.250	SBT50 x SKX16 - 250	351.8	250	212	40	40	85	M18 x 1.5P	3 ~ 16	2	7.13
27.790.16.300	SBT50 x SKX16 - 300	401.8	300	262	40	40	85	M18 x 1.5P	3 ~ 16	2	7.87
27.790.20.105	SBT50 x SKX20 - 105	206.8	105	62	48.5	48.5	-	M22 x 1.5P	3 ~ 20	1	4.30
27.790.20.135	SBT50 x SKX20 - 135	236.8	135	92	48.5	48.5	-	M22 x 1.5P	3 ~ 20	1	4.60
27.790.20.165	SBT50 x SKX20 - 165	266.8	165	122	48.5	48.5	-	M22 x 1.5P	3 ~ 20	1	5.00
27.790.20.200	SBT50 x SKX20 - 200	301.8	200	162	48.5	48.5	85	M22 x 1.5P	3 ~ 20	2	6.57
27.790.20.250	SBT50 x SKX20 - 250	351.8	250	212	48.5	48.5	85	M22 x 1.5P	3 ~ 20	2	7.47
27.790.20.300	SBT50 x SKX20 - 300	401.8	300	262	48.5	48.5	85	M22 x 1.5P	3 ~ 20	2	8.27
27.790.25.105	SBT50 x SKX25 - 105	206.8	105	62	55	55	-	M28 x 2.0P	3 ~ 25	1	5.20
27.790.25.135	SBT50 x SKX25 - 135	236.8	135	92	55	55	-	M28 x 2.0P	3 ~ 25	1	5.40
27.790.25.165	SBT50 x SKX25 - 165	266.8	165	122	55	55	-	M28 x 2.0P	3 ~ 25	1	5.60
27.790.25.200	SBT50 x SKX25 - 200	301.8	200	162	55	55	85	M28 x 2.0P	3 ~ 25	2	6.53
27.790.25.250	SBT50 x SKX25 - 250	351.8	250	212	55	55	85	M28 x 2.0P	3 ~ 25	2	7.57
27.790.25.300	SBT50 x SKX25 - 300	401.8	300	262	55	55	85	M28 x 2.0P	3 ~ 25	2	8.51

Features:

- ▶ SKX sealed cap is optional. Please order SKX sealed cap additionally.
- ▶ With the design of SKX sealed cap, coolant pressure capable up to 70 bar.
- ▶ Used with coolant-through tools.
- ▶ Balance: G2.5 25,000rpm.



SCAT / SKX COLLET CHUCK

SCAT / SKX 法蘭加厚型立銑刀夾頭



INCHES

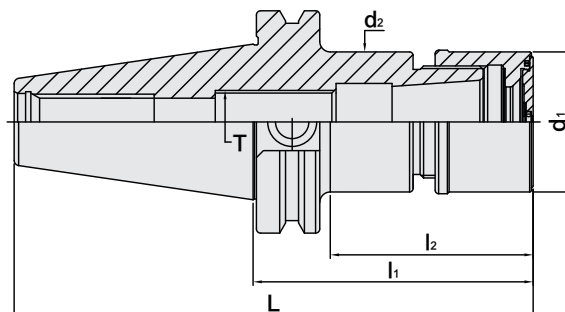

MODEL NO.	TYPE	L	l ₁	l ₂	d ₁	d ₂	T	SIZE RANGE	WEIGHT (KGS)
43.790.06.350	SCAT40 x SKX6 - 3.5"	6.187	3.5	2	0.709	0.709	M8 x 1.25P	0.125 ~ 0.25	1.20
43.790.06.475	SCAT40 x SKX6 - 4.75"	7.437	4.75	2.89	0.709	0.709	M8 x 1.25P	0.125 ~ 0.25	1.50
43.790.06.600	SCAT40 x SKX6 - 6"	8.687	6	4.14	0.709	0.709	M8 x 1.25P	0.125 ~ 0.25	1.60
43.790.10.350	SCAT40 x SKX10 - 3.5"	6.187	3.5	2	1.181	1.181	M12 x 1.75P	0.125 ~ 0.375	1.30
43.790.10.475	SCAT40 x SKX10 - 4.75"	7.437	4.75	3.25	1.181	1.181	M12 x 1.75P	0.125 ~ 0.375	1.50
43.790.10.600	SCAT40 x SKX10 - 6"	8.687	6	4.5	1.181	1.181	M12 x 1.75P	0.125 ~ 0.375	1.70
43.790.10.709	SCAT40 x SKX10 - 7.09"	9.777	7.09	5.59	1.181	1.181	M12 x 1.75P	0.125 ~ 0.375	1.80
43.790.16.350	SCAT40 x SKX16 - 3.5"	6.187	3.5	2.03	1.575	1.575	M18 x 1.5P	0.125 ~ 0.625	1.60
43.790.16.475	SCAT40 x SKX16 - 4.75"	7.437	4.75	3.28	1.575	1.575	M18 x 1.5P	0.125 ~ 0.625	1.80
43.790.16.600	SCAT40 x SKX16 - 6"	8.687	6	4.53	1.575	1.575	M18 x 1.5P	0.125 ~ 0.625	2.00
43.790.16.709	SCAT40 x SKX16 - 7.09"	9.777	7.09	5.62	1.575	1.575	M18 x 1.5P	0.125 ~ 0.625	2.20
43.790.20.350	SCAT40 x SKX20 - 3.5"	6.187	3.5	1.71	1.909	1.909	M22 x 1.5P	0.125 ~ 0.75	1.70
43.790.20.475	SCAT40 x SKX20 - 4.75"	7.437	4.75	2.96	1.909	1.909	M22 x 1.5P	0.125 ~ 0.75	2.00
43.790.20.600	SCAT40 x SKX20 - 6"	8.687	6	4.21	1.909	1.909	M22 x 1.5P	0.125 ~ 0.75	2.20
43.790.25.350	SCAT40 x SKX25 - 3.5"	6.187	3.5	1.71	2.165	2.165	M28 x 2.0P	0.125 ~ 1	1.90
43.790.25.475	SCAT40 x SKX25 - 4.75"	7.437	4.75	2.96	2.165	2.165	M28 x 2.0P	0.125 ~ 1	2.10
43.790.25.600	SCAT40 x SKX25 - 6"	8.687	6	4.21	2.165	2.165	M28 x 2.0P	0.125 ~ 1	2.30

Features:

- ▶ SKX sealed cap is optional. Please order SKX sealed cap additionally.
- ▶ With the design of SKX sealed cap, coolant pressure capable up to 70 bar.
- ▶ Used with coolant-through tools.
- ▶ Balance: G2.5 25,000rpm.

SCAT / SKX COLLET CHUCK

SCAT / SKX 法蘭加厚型立銑刀夾頭



INCHES

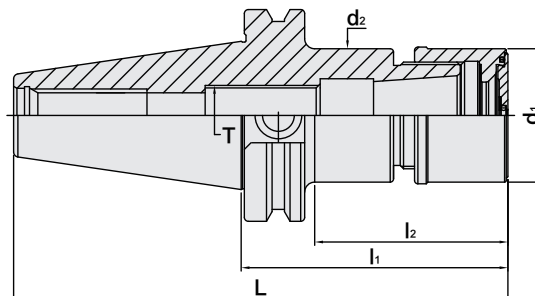

MODEL NO.	TYPE	L	l ₁	l ₂	d ₁	d ₂	T	SIZE RANGE	WEIGHT (KGS)
44.790.06.413	SCAT50 x SKX6 - 4.13"	8.13	4.13	2.27	0.709	0.709	M8 x 1.25P	0.125 ~ 0.25	3.90
44.790.06.650	SCAT50 x SKX6 - 6.5"	10.5	6.5	4.64	0.709	0.709	M8 x 1.25P	0.125 ~ 0.25	4.10
44.790.06.768	SCAT50 x SKX6 - 7.68"	11.68	7.68	5.82	0.709	0.709	M8 x 1.25P	0.125 ~ 0.25	4.50
44.790.10.413	SCAT50 x SKX10 - 4.13"	8.13	4.13	2.55	1.181	1.181	M12 x 1.75P	0.125 ~ 0.375	4.30
44.790.10.650	SCAT50 x SKX10 - 6.5"	10.5	6.5	4.92	1.181	1.181	M12 x 1.75P	0.125 ~ 0.375	4.70
44.790.10.768	SCAT50 x SKX10 - 7.68"	11.68	7.68	6.1	1.181	1.181	M12 x 1.75P	0.125 ~ 0.375	4.80
44.790.10.886	SCAT50 x SKX10 - 8.86"	12.86	8.86	7.28	1.181	1.181	M12 x 1.75P	0.125 ~ 0.375	4.90
44.790.16.413	SCAT50 x SKX16 - 4.13"	8.13	4.13	2.55	1.575	1.575	M18 x 1.5P	0.125 ~ 0.625	4.80
44.790.16.650	SCAT50 x SKX16 - 6.5"	10.5	6.5	4.92	1.575	1.575	M18 x 1.5P	0.125 ~ 0.625	5.20
44.790.16.886	SCAT50 x SKX16 - 8.86"	12.86	8.86	7.28	1.575	1.575	M18 x 1.5P	0.125 ~ 0.625	5.70
44.790.20.413	SCAT50 x SKX20 - 4.13"	8.13	4.13	2.55	1.909	1.909	M22 x 1.5P	0.125 ~ 0.75	4.40
44.790.20.650	SCAT50 x SKX20 - 6.5"	10.5	6.5	4.92	1.909	1.909	M22 x 1.5P	0.125 ~ 0.75	5.10
44.790.20.886	SCAT50 x SKX20 - 8.86"	12.86	8.86	7.28	1.909	1.909	M22 x 1.5P	0.125 ~ 0.75	5.70
44.790.25.413	SCAT50 x SKX25 - 4.13"	8.13	4.13	2.55	2.165	2.165	M28 x 2.0P	0.125 ~ 1	5.30
44.790.25.650	SCAT50 x SKX25 - 6.5"	10.5	6.5	4.92	2.165	2.165	M28 x 2.0P	0.125 ~ 1	6.00
44.790.25.886	SCAT50 x SKX25 - 8.86"	12.86	8.86	7.28	2.165	2.165	M28 x 2.0P	0.125 ~ 1	6.30

Features:

- ▶ SKX sealed cap is optional. Please order SKX sealed cap additionally.
- ▶ With the design of SKX sealed cap, coolant pressure capable up to 70 bar.
- ▶ Used with coolant-through tools.
- ▶ Balance: G2.5 25,000rpm.



SDAT / SKX COLLET CHUCK

SDAT / SKX 法蘭加厚型立銑刀夾頭



Fig.1

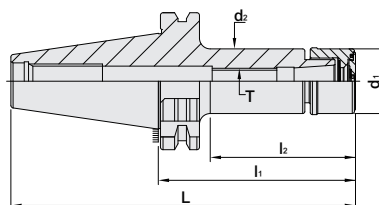
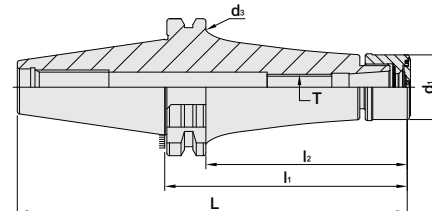

Fig.2



MODEL NO.	TYPE	L	l ₁	l ₂	d ₁	d ₂	d ₃	T	SIZE RANGE	Fig.	WEIGHT (KGS)
66.790.06.060	SDAT40 x SKX6 - 60	128.4	60	30	18	18	-	M8 x 1.25P	3 ~ 6	1	1.00
66.790.06.090	SDAT40 x SKX6 - 90	158.4	90	51	18	18	-	M8 x 1.25P	3 ~ 6	1	1.10
66.790.06.120	SDAT40 x SKX6 - 120	188.4	120	81	18	18	53	M8 x 1.25P	3 ~ 6	2	1.40
66.790.06.150	SDAT40 x SKX6 - 150	218.4	150	111	18	18	53	M8 x 1.25P	3 ~ 6	2	1.50
66.790.10.060	SDAT40 x SKX10 - 60	128.4	60	32	30	30	-	M12 x 1.75P	3 ~ 10	1	1.10
66.790.10.090	SDAT40 x SKX10 - 90	158.4	90	48	30	30	-	M12 x 1.75P	3 ~ 10	1	1.20
66.790.10.120	SDAT40 x SKX10 - 120	188.4	120	78	30	30	53	M12 x 1.75P	3 ~ 10	2	1.40
66.790.10.150	SDAT40 x SKX10 - 150	218.4	150	108	30	30	53	M12 x 1.75P	3 ~ 10	2	1.60
66.790.10.180	SDAT40 x SKX10 - 180	248.4	180	138	30	30	53	M12 x 1.75P	3 ~ 10	2	1.60
66.790.16.060	SDAT40 x SKX16 - 60	128.4	60	32	40	40	-	M18 x 1.5P	3 ~ 16	1	1.30
66.790.16.090	SDAT40 x SKX16 - 90	158.4	90	58	40	40	-	M18 x 1.5P	3 ~ 16	1	1.50
66.790.16.120	SDAT40 x SKX16 - 120	188.4	120	88	40	40	80	M18 x 1.5P	3 ~ 16	2	1.70
66.790.16.150	SDAT40 x SKX16 - 150	218.4	150	118	40	40	80	M18 x 1.5P	3 ~ 16	2	1.90
66.790.16.180	SDAT40 x SKX16 - 180	248.4	180	148	40	40	80	M18 x 1.5P	3 ~ 16	2	2.00
66.790.20.090	SDAT40 x SKX20 - 90	158.4	90	60	48.5	48.5	-	M22 x 1.5P	3 ~ 20	1	1.60
66.790.20.120	SDAT40 x SKX20 - 120	188.4	120	89.9	48.5	48.5	80	M22 x 1.5P	3 ~ 20	2	2.00
66.790.25.090	SDAT40 x SKX25 - 90	158.4	90	61	55	55	-	M28 x 2.0P	3 ~ 25.4	1	1.80
66.790.25.120	SDAT40 x SKX25 - 120	188.4	120	91	55	55	80	M28 x 2.0P	3 ~ 25.4	2	2.00

Features:

- ▶ SKX sealed cap is optional. Please order SKX sealed cap additionally.
- ▶ With the design of SKX sealed cap, coolant pressure capable up to 70 bar.
- ▶ Used with coolant-through tools.
- ▶ Balance: G2.5 25,000rpm.

SDAT / SKX COLLET CHUCK

SDAT / SKX 法蘭加厚型立銑刀夾頭



Fig.1

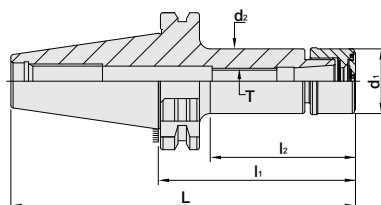
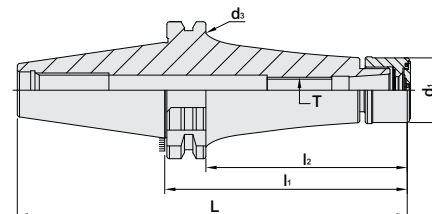

Fig.2



MODEL NO.	TYPE	L	l ₁	l ₂	d ₁	d ₂	d ₃	T	SIZE RANGE	Fig.	WEIGHT (KGS)
67.790.06.105	SDAT50 x SKX6 - 105	206.8	105	55	18	18	-	M8 x 1.25P	3 ~ 6	1	3.80
67.790.06.135	SDAT50 x SKX6 - 135	236.8	135	60	18	18	-	M8 x 1.25P	3 ~ 6	1	3.90
67.790.06.165	SDAT50 x SKX6 - 165	266.8	165	85	18	18	-	M8 x 1.25P	3 ~ 6	1	4.00
67.790.06.200	SDAT50 x SKX6 - 200	301.8	200	120	18	18	80	M8 x 1.25P	3 ~ 6	2	4.20
67.790.10.105	SDAT50 x SKX10 - 105	206.8	105	57	30	30	-	M12 x 1.75P	3 ~ 10	1	4.20
67.790.10.135	SDAT50 x SKX10 - 135	236.8	135	70	30	30	-	M12 x 1.75P	3 ~ 10	1	4.40
67.790.10.165	SDAT50 x SKX10 - 165	266.8	165	90	30	30	-	M12 x 1.75P	3 ~ 10	1	4.60
67.790.10.200	SDAT50 x SKX10 - 200	301.8	200	125	30	30	80	M12 x 1.75P	3 ~ 10	2	4.80
67.790.16.105	SDAT50 x SKX16 - 105	206.8	105	62	40	40	-	M18 x 1.5P	3 ~ 16	1	4.70
67.790.16.135	SDAT50 x SKX16 - 135	236.8	135	92	40	40	-	M18 x 1.5P	3 ~ 16	1	4.90
67.790.16.165	SDAT50 x SKX16 - 165	266.8	165	90	40	40	-	M18 x 1.5P	3 ~ 16	1	5.10
67.790.16.200	SDAT50 x SKX16 - 200	301.8	200	125	40	40	80	M18 x 1.5P	3 ~ 16	2	5.50
67.790.20.105	SDAT50 x SKX20 - 105	206.8	105	62	48.5	48.5	-	M22 x 1.5P	3 ~ 20	1	4.30
67.790.20.135	SDAT50 x SKX20 - 135	236.8	135	92	48.5	48.5	-	M22 x 1.5P	3 ~ 20	1	4.60
67.790.20.165	SDAT50 x SKX20 - 165	266.8	165	122	48.5	48.5	-	M22 x 1.5P	3 ~ 20	1	5.00
67.790.25.105	SDAT50 x SKX25 - 105	206.8	105	62	55	55	-	M28 x 2.0P	3 ~ 25.4	1	5.20
67.790.25.135	SDAT50 x SKX25 - 135	236.8	135	92	55	55	-	M28 x 2.0P	3 ~ 25.4	1	5.40
67.790.25.165	SDAT50 x SKX25 - 165	266.8	165	122	55	55	-	M28 x 2.0P	3 ~ 25.4	1	5.60
67.790.25.200	SDAT50 x SKX25 - 200	301.8	200	157	55	55	80	M28 x 2.0P	3 ~ 25.4	2	6.00

Features:

- ▶ SKX sealed cap is optional. Please order SKX sealed cap additionally.
- ▶ With the design of SKX sealed cap, coolant pressure capable up to 70 bar.
- ▶ Used with coolant-through tools.
- ▶ Balance: G2.5 25,000rpm.



HSK / SKX COLLET CHUCK

HSK / SKX 立銑刀夾頭

〔 DIN 69893-1 〕

5 μ m

Fig.1

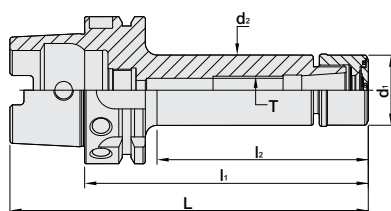
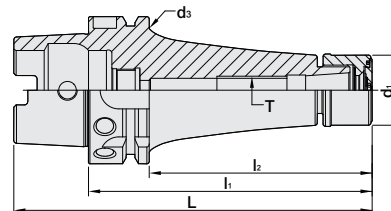

Fig.2



MODEL NO.	TYPE	L	l ₁	l ₂	d ₁	d ₂	d ₃	T	SIZE RANGE	Fig.	WEIGHT (KGS)
71.790.06.060	HSK40A x SKX6 - 60	80	60	35	18	18	-	M8 x 1.25P	3 ~ 6	1	0.25
71.790.10.075	HSK40A x SKX10 - 75	95	75	53	30	30	-	M12 x 1.75P	3 ~ 10	1	0.38
71.790.16.080	HSK40A x SKX16 - 80	100	80	58	40	40	-	-	3 ~ 16	1	0.44
72.790.06.060	HSK50A x SKX6 - 60	85	60	29	18	18	-	-	3 ~ 6	1	0.41
72.790.06.080	HSK50A x SKX6 - 80	105	80	49	18	18	-	M8 x 1.25P	3 ~ 6	1	0.44
72.790.10.060	HSK50A x SKX10 - 60	85	60	29	30	30	-	-	3 ~ 10	1	0.47
72.790.10.090	HSK50A x SKX10 - 90	115	90	59	30	30	-	M12 x 1.75P	3 ~ 10	1	0.61
72.790.16.080	HSK50A x SKX16 - 80	105	80	53	40	40	-	-	3 ~ 16	1	0.63
72.790.16.105	HSK50A x SKX16 - 105	130	105	78	40	40	-	M18 x 1.5P	3 ~ 16	1	0.83
73.790.06.060	HSK63A x SKX6 - 60	92	60	29	18	18	-	-	3 ~ 6	1	0.66
73.790.06.100	HSK63A x SKX6 - 100	132	100	69	18	18	-	M8 x 1.25P	3 ~ 6	1	0.70
73.790.06.120	HSK63A x SKX6 - 120	152	120	94	18	18	53	M8 x 1.25P	3 ~ 6	2	1.08
73.790.10.060	HSK63A x SKX10 - 60	92	60	29	30	30	-	-	3 ~ 10	1	0.72
73.790.10.105	HSK63A x SKX10 - 105	137	105	74	30	30	-	M12 x 1.75P	3 ~ 10	1	0.93
73.790.10.120	HSK63A x SKX10 - 120	152	120	94	30	30	53	M12 x 1.75P	3 ~ 10	2	1.23
73.790.16.080	HSK63A x SKX16 - 80	112	80	49	40	40	-	-	3 ~ 16	1	0.89
73.790.16.105	HSK63A x SKX16 - 105	137	105	74	40	40	-	M12 x 1.75P	3 ~ 16	1	1.07
73.790.16.120	HSK63A x SKX16 - 120	152	120	94	40	40	53	M18 x 1.5P	3 ~ 16	2	1.29
73.790.20.090	HSK63A x SKX20 - 90	122	90	51	48.5	48.5	-	-	3 ~ 20	1	1.14
73.790.20.105	HSK63A x SKX20 - 105	137	105	66	48.5	48.5	-	-	3 ~ 20	1	1.34
73.790.20.135	HSK63A x SKX20 - 135	167	135	96	48.5	48.5	-	M22 x 1.5P	3 ~ 20	1	1.67
73.790.25.090	HSK63A x SKX25 - 90	122	90	63	55	52	-	-	3 ~ 25.4	1	1.09
73.790.25.135	HSK63A x SKX25 - 135	167	135	108	55	52	-	M28 x 2.0P	3 ~ 25.4	1	1.78

Features:

- ▶ SKX sealed cap is optional. Please order SKX sealed cap additionally.
- ▶ With the design of SKX sealed cap, coolant pressure capable up to 70 bar.
- ▶ Used with coolant-through tools.
- ▶ Balance: G2.5 25,000rpm.

HSK / SKX COLLET CHUCK

HSK / SKX 立銑刀夾頭

〔 DIN 69893-1 〕

5 μ m

Fig.1

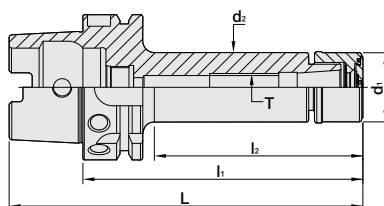
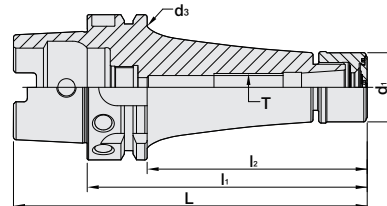

Fig.2



MODEL NO.	TYPE	L	l ₁	l ₂	d ₁	d ₂	d ₃	T	SIZE RANGE	Fig.	WEIGHT (KGS)
75.790.06.105	HSK100A x SKX6 - 105	155	105	61	18	18	-	M8 x 1.25P	3 ~ 6	1	2.08
75.790.10.105	HSK100A x SKX10 - 105	155	105	61	30	30	-	M12 x 1.75P	3 ~ 10	1	0.28
75.790.10.120	HSK100A x SKX10 - 120	170	120	76	30	30	-	M12 x 1.75P	3 ~ 10	1	2.35
75.790.10.150	HSK100A x SKX10 - 150	200	150	106	30	30	-	M12 x 1.75P	3 ~ 10	1	2.50
75.790.16.105	HSK100A x SKX16 - 105	155	105	61	40	40	-	M18 x 1.5P	3 ~ 16	1	2.45
75.790.16.120	HSK100A x SKX16 - 120	170	120	76	40	40	-	M18 x 1.5P	3 ~ 16	1	2.56
75.790.16.150	HSK100A x SKX16 - 150	200	150	106	40	40	-	M18 x 1.5P	3 ~ 16	1	2.80
75.790.20.120	HSK100A x SKX20 - 120	170	120	81	48.5	48.5	-	M22 x 1.5P	3 ~ 20	1	2.80
75.790.20.150	HSK100A x SKX20 - 150	200	150	111	48.5	48.5	-	M22 x 1.5P	3 ~ 20	1	3.15
75.790.20.200	HSK100A x SKX20 - 200	250	200	171	48.5	48.5	88	M22 x 1.5P	3 ~ 20	2	4.82
75.790.25.120	HSK100A x SKX25 - 120	170	120	81	55	55	-	M28 x 2.0P	3 ~ 25.4	1	2.88
75.790.25.145	HSK100A x SKX25 - 145	195	145	106	55	55	-	M28 x 2.0P	3 ~ 25.4	1	3.21

Features:

- ▶ SKX sealed cap is optional. Please order SKX sealed cap additionally.
- ▶ With the design of SKX sealed cap, coolant pressure capable up to 70 bar.
- ▶ Used with coolant-through tools.
- ▶ Balance: G2.5 25,000rpm.



HSK / SKX COLLET CHUCK

HSK / SKX 立銑刀夾頭

〔 DIN 69893-5 〕



5μm



Fig.1

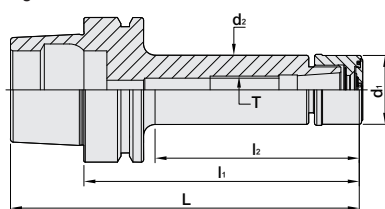
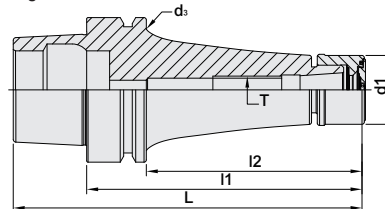

Fig.2



MODEL NO.	TYPE	L	l ₁	l ₂	d ₁	d ₂	d ₃	T	SIZE RANGE	Fig.	WEIGHT (KGS)
97.790.06.045	HSK25E x SKX6 - 45	58	45	34	18	18	-	-	3 ~ 6	1	0.10
97.790.10.055	HSK25E x SKX10 - 55	68	55	35	30	30	-	-	3 ~ 10	1	0.18
98.790.06.060	HSK32E x SKX6 - 60	76	60	36	18	18	-	-	3 ~ 6	1	0.17
98.790.10.060	HSK32E x SKX10 - 60	76	60	25	30	30	-	M6 x 1.0P	3 ~ 10	1	0.26
98.790.10.075	HSK32E x SKX10 - 75	91	75	40	30	30	-	M6 x 1.0P	3 ~ 10	1	0.30
99.790.06.060	HSK40E x SKX6 - 60	80	60	35	18	18	-	-	3 ~ 6	1	0.28
99.790.10.060	HSK40E x SKX10 - 60	80	60	38	30	30	-	M6 x 1.0P	3 ~ 10	1	0.40
99.790.10.075	HSK40E x SKX10 - 75	95	75	53	30	30	-	M6 x 1.0P	3 ~ 10	1	0.50
99.790.16.080	HSK40E x SKX16 - 80	100	80	45	40	40	-	-	3 ~ 16	1	0.60
100.790.06.060	HSK50E x SKX6 - 60	85	60	29	18	18	-	-	3 ~ 6	1	0.50
100.790.06.080	HSK50E x SKX6 - 80	105	80	49	18	18	-	M6 x 1.0P	3 ~ 6	1	0.60
100.790.10.060	HSK50E x SKX10 - 60	85	60	29	30	30	-	-	3 ~ 10	1	0.50
100.790.10.105	HSK50E x SKX10 - 105	130	105	74	30	30	-	M10 x 1.5P	3 ~ 10	1	0.70
100.790.16.080	HSK50E x SKX16 - 80	105	80	53	40	40	-	-	3 ~ 16	1	0.60
100.790.16.120	HSK50E x SKX16 - 120	145	120	92	40	40	-	M16 x 2.0P	3 ~ 16	1	1.10
101.790.06.100	HSK63E x SKX6 - 100	132	100	69	18	18	-	M6 x 1.0P	3 ~ 6	1	0.90
101.790.06.120	HSK63E x SKX6 - 120	152	120	94	18	18	53	M6 x 1.0P	3 ~ 6	2	1.00
101.790.10.105	HSK63E x SKX10 - 105	137	105	74	30	30	-	M10 x 1.5P	3 ~ 10	1	1.30
101.790.10.120	HSK63E x SKX10 - 120	152	120	94	30	30	53	M10 x 1.5P	3 ~ 10	2	1.50
101.790.10.150	HSK63E x SKX10 - 150	182	150	24	30	30	53	M10 x 1.5P	3 ~ 10	2	1.70
101.790.16.120	HSK63E x SKX16 - 120	152	120	94	40	40	-	M18 x 1.5P	3 ~ 16	1	1.70
101.790.16.150	HSK63E x SKX16 - 150	182	150	124	40	40	53	M18 x 1.5P	3 ~ 16	2	1.80
101.790.20.120	HSK63E x SKX20 - 120	152	120	94	48.5	48.5	53	M22 x 1.5P	3 ~ 20	2	1.80
101.790.20.135	HSK63E x SKX20 - 135	167	135	109	48.5	48.5	53	M22 x 1.5P	3 ~ 20	2	2.00
101.790.25.135	HSK63E x SKX25 - 135	167	135	109	55	-	-	M28 x 2.0P	3 ~ 25.4	1	1.90

Features:

- ▶ SKX sealed cap is optional. Please order SKX sealed cap additionally.
- ▶ With the design of SKX sealed cap, coolant pressure capable up to 70 bar.
- ▶ Used with coolant-through tools.
- ▶ Balance: G2.5 25,000rpm.



HSK / SKX COLLET CHUCK

HSK / SKX 立銑刀夾頭

〔 DIN 69893-6 〕

5 μ m

Fig.1

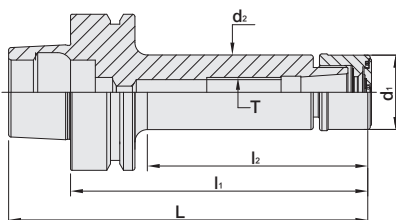
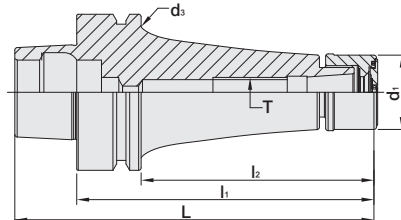

Fig.2



MODEL NO.	TYPE	L	l ₁	l ₂	d ₁	d ₂	d ₃	T	SIZE RANGE	Fig.	WEIGHT (KGS)
103.790.10.090	HSK63F x SKX10 - 90	115	90	60	30	30	-	M12 x 1.75P	3 ~ 10	1	0.86
103.790.10.105	HSK63F x SKX10 - 105	130	105	75	30	30	-	M12 x 1.75P	3 ~ 10	1	0.94
103.790.16.090	HSK63F x SKX16 - 90	115	90	59	40	40	-	M18 x 1.5P	3 ~ 16	1	0.96
103.790.16.105	HSK63F x SKX16 - 105	130	105	74	40	40	-	M18 x 1.5P	3 ~ 16	1	1.08
103.790.16.120	HSK63F x SKX16 - 120	145	120	94	40	40	53	M18 x 1.5P	3 ~ 16	2	1.30
103.790.20.120	HSK63F x SKX20 - 120	145	120	81	48.5	48.5	-	M22 x 1.5P	3 ~ 20	1	1.50
103.790.25.090	HSK63F x SKX25 - 90	115	90	48	55	55	-	-	3 ~ 25.4	1	1.12

Features:

- ▶ SKX sealed cap is optional. Please order SKX sealed cap additionally.
- ▶ With the design of SKX sealed cap, coolant pressure capable up to 70 bar.
- ▶ Used with coolant-through tools.
- ▶ Balance: G2.5 25,000rpm.



PSC / SKX COLLET CHUCK

PSC / SKX 立銑刀夾頭

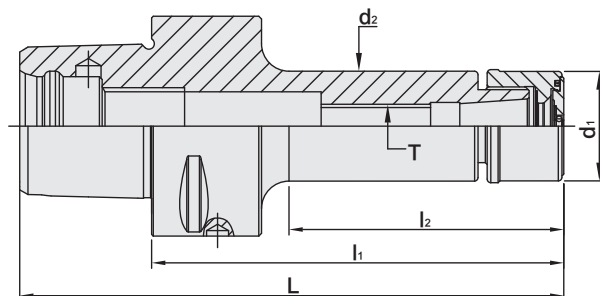

MODEL NO.	TYPE	L	l ₁	l ₂	d ₁	d ₂	T	SIZE RANGE	WEIGHT (KGS)
141.790.06.060	PSC40 x SKX6 - 60	84	60	35	18	18	M8 x 1.25P	3 ~ 6	0.28
141.790.10.075	PSC40 x SKX10 - 75	99	75	50	30	30	M12 x 1.75P	3 ~ 10	0.43
141.790.16.080	PSC40 x SKX16 - 80	104	80	55	40	40	M18 x 1.5P	3 ~ 16	0.54
142.790.06.060	PSC50 x SKX6 - 60	90	60	35	18	18	M8 x 1.25P	3 ~ 6	0.45
142.790.06.080	PSC50 x SKX6 - 80	110	80	55	18	18	M8 x 1.25P	3 ~ 6	0.52
142.790.10.060	PSC50 x SKX10 - 60	90	60	35	30	30	M12 x 1.75P	3 ~ 10	0.53
142.790.10.090	PSC50 x SKX10 - 90	120	90	65	30	30	M12 x 1.75P	3 ~ 10	0.63
142.790.16.080	PSC50 x SKX16 - 80	110	80	55	40	40	M18 x 1.5P	3 ~ 16	0.72
142.790.16.105	PSC50 x SKX16 - 105	135	105	80	40	40	M18 x 1.5P	3 ~ 16	1.27
143.790.06.060	PSC63 x SKX6 - 60	98	60	33	18	18	M8 x 1.25P	3 ~ 6	0.81
143.790.06.100	PSC63 x SKX6 - 100	138	100	73	18	18	M8 x 1.25P	3 ~ 6	0.88
143.790.06.120	PSC63 x SKX6 - 120	158	120	93	18	18	M8 x 1.25P	3 ~ 6	0.92
143.790.10.060	PSC63 x SKX10 - 60	98	60	33	30	30	M12 x 1.75P	3 ~ 10	0.87
143.790.10.105	PSC63 x SKX10 - 105	143	105	78	30	30	M12 x 1.75P	3 ~ 10	1.12
143.790.10.120	PSC63 x SKX10 - 120	158	120	93	30	30	M12 x 1.75P	3 ~ 10	1.19
143.790.16.080	PSC63 x SKX16 - 80	118	80	53	40	40	-	3 ~ 16	1.06
143.790.16.105	PSC63 x SKX16 - 105	143	105	83	40	40	M18 x 1.5P	3 ~ 16	1.28
143.790.16.120	PSC63 x SKX16 - 120	158	120	98	40	40	M18 x 1.5P	3 ~ 16	1.41
143.790.20.090	PSC63 x SKX20 - 90	128	90	60	48.5	48.5	-	3 ~ 20	1.32
143.790.20.105	PSC63 x SKX20 - 105	143	105	80	48.5	48.5	M22 x 1.5P	3 ~ 20	1.48
143.790.20.135	PSC63 x SKX20 - 135	173	135	95	48.5	48.5	M22 x 1.5P	3 ~ 20	1.80
143.790.25.090	PSC63 x SKX25 - 90	128	90	65	55	55	-	3 ~ 25.4	1.32
143.790.25.135	PSC63 x SKX25 - 135	173	135	110	55	55	M22 x 1.5P	3 ~ 25.4	1.82
144.790.10.075	PSC80 x SKX10 - 75	123	75	22	30	30	M28 x 2.0P	3 ~ 10	1.84
144.790.10.090	PSC80 x SKX10 - 90	138	90	42	30	30	-	3 ~ 10	1.91
144.790.16.075	PSC80 x SKX16 - 75	123	75	37	40	40	M12 x 1.75P	3 ~ 16	1.89
144.790.16.090	PSC80 x SKX16 - 90	138	90	57	40	40	M18 x 1.5P	3 ~ 16	2.01

Features:

- ▶ SKX sealed cap is optional. Please order SKX sealed cap additionally.
- ▶ With the design of SKX sealed cap, coolant pressure capable up to 70 bar.
- ▶ Used with coolant-through tools.
- ▶ Balance: G2.5 25,000rpm.

SKX SEALED NUT

SKX 止水螺帽

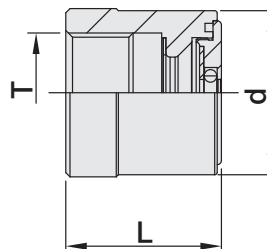

MODLE NO.	TYPE	L	d	T	Max. TORQUE		WEIGHT (KGS)
210.790.06	SKX6 - CO	19.5	19.5	M14 x 1.0P	25 N.m	18 ft/lbs	0.04
210.790.10	SKX10 - CO	21	30	M21.5 x 1.0P	45 N.m	33 ft/lbs	0.08
210.790.16	SKX16 - CO	28	40	M32 x 1.5P	70 N.m	51 ft/lbs	0.15
210.790.20	SKX20 - CO	28	48	M40 x 1.0P	70 N.m	51 ft/lbs	0.19
210.790.25	SKX25 - CO	30	55	M45 x 1.5P	100 N.m	73 ft/lbs	0.27

Features:

- ▶ SKX Sealed Nut is not included with SKX Sealed Cap. Please order the cap additionally.
- ▶ For information of sealed cap spanner, please refer to page 18 (optional).



SKX SEALED CAP

SKX 止水墊片



SKX6 - CO		SKX16 - CO		SKX20 - CO		SKX25 - CO			
MODEL NO.	SIZE	MODEL NO.	SIZE	MODEL NO.	SIZE	MODEL NO.	SIZE	MODEL NO.	SIZE
210.790.06 - 01	1	210.790.16 - 02	2	210.790.20 - 03	3	210.790.25 - 03	3	210.790.25 - 15	15
- 02	2	- 03	3	- 04	4	- 04	4	- 16	16
- 03	3	- 04	4	- 05	5	- 05	5	- 17	17
- 04	4	- 05	5	- 06	6	- 06	6	- 18	18
- 05	5	- 06	6	- 07	7	- 07	7	- 19	19
- 06	6	- 07	7	- 08	8	- 08	8	- 20	20
INCHES		- 08	8	- 09	9	- 09	9	- 21	21
210.790.06 - 1/8	1/8	- 09	9	- 10	10	- 10	10	- 22	22
- 5/32	5/32	- 10	10	- 11	11	- 11	11	- 23	23
- 3/16	3/16	- 11	11	- 12	12	- 12	12	- 24	24
- 7/32	7/32	- 12	12	- 13	13	- 13	13	- 25	25
- 1/4	1/4	- 13	13	- 14	14	- 14	14		
		- 14	14	- 15	15	INCHES			
		- 15	15	- 16	16	210.790.25 - 1/8	1/8	210.790.25 - 1/2	1/2
		- 16	16	- 17	17	- 5/32	5/32	- 17/32	17/32
		INCHES		- 18	18	- 3/16	3/16	- 9/16	9/16
				- 19	19	- 7/32	7/32	- 19/32	19/32
				- 20	20	- 1/4	1/4	- 5/8	5/8
				INCHES		- 9/32	9/32	- 21/32	21/32
				210.790.20 - 1/8	1/8	- 5/16	5/16	- 11/16	11/16
				- 5/32	5/32	- 11/32	11/32	- 23/32	23/32
				- 3/16	3/16	- 3/8	3/8	- 3/4	3/4
				- 7/32	7/32	- 5/16	5/16	- 7/8	7/8
				- 1/4	1/4	- 11/32	11/32	- 1	1
				- 9/32	9/32	- 3/8	3/8		
				- 5/16	5/16	- 13/32	13/32		
				- 11/32	11/32	- 7/16	7/16		
				- 3/8	3/8	- 15/32	15/32		
				- 13/32	13/32				
				- 7/16	7/16				
				- 15/32	15/32				
				- 1/2	1/2				
				- 17/32	17/32				
				- 9/16	9/16				
				- 19/32	19/32				
				- 5/8	5/8				
				- 21/32	21/32				
				- 11/16	11/16				
				- 23/32	23/32				
				- 3/4	3/4				

Features:

- ▶ SKX Sealed Nut is not included with SKX Sealed Cap. Please order the cap additionally.
- ▶ For information of sealed cap spanner, please refer to page 18 (optional).



SKX COLLET

SKX 高速機專用筒夾

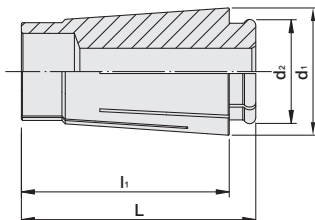

TYPE	d ₁	d ₂	L	l ₁
SKX - 6	10.2	8.88	25	21.4
SKX - 10	15.5	13.18	30.5	26.3
SKX - 16	24.5	20.05	45.1	40
SKX - 20	29	24.85	54.2	48.95
SKX - 25	35.5	30	57.1	51.5

SKX - 6		SKX - 16		SKX - 20		SKX - 25			
MODEL NO.	SIZE	MODEL NO.	SIZE	MODEL NO.	SIZE	MODEL NO.	SIZE	MODEL NO.	SIZE
251.790.06 - 01	1	251.790.16 - 02	2	251.790.20 - 03	3	251.790.25 - 03	3	251.790.25 - 15	15
- 02	2	- 03	3	- 04	4	- 04	4	- 16	16
- 03	3	- 04	4	- 05	5	- 05	5	- 17	17
- 04	4	- 05	5	- 06	6	- 06	6	- 18	18
- 05	5	- 06	6	- 07	7	- 07	7	- 19	19
- 06	6	- 07	7	- 08	8	- 08	8	- 20	20
INCHES		- 08	8	- 09	9	- 09	9	- 21	21
251.790.06 - 1/8	1/8	- 09	9	- 10	10	- 10	10	- 22	22
- 5/32	5/32	- 10	10	- 11	11	- 11	11	- 23	23
- 3/16	3/16	- 11	11	- 12	12	- 12	12	- 24	24
- 7/32	7/32	- 12	12	- 13	13	- 13	13	- 25	25
- 1/4	1/4	- 13	13	- 14	14	- 14	14	INCHES	
SKX - 10		- 14	14	- 15	15	251.790.25 - 1/8	1/8	251.790.25 - 1/2	1/2
MODEL NO.	SIZE	- 15	15	- 16	16	- 5/32	5/32	- 17/32	17/32
251.790.10 - 02	2	INCHES		- 17	17	- 3/16	3/16	- 9/16	9/16
- 03	3	251.790.16 - 1/8	1/8	- 18	18	- 7/32	7/32	- 19/32	19/32
- 04	4	- 5/32	5/32	- 19	19	- 1/4	1/4	- 5/8	5/8
- 05	5	- 3/16	3/16	- 20	20	- 9/32	9/32	- 21/32	21/32
- 06	6	- 7/32	7/32	INCHES		- 5/16	5/16	- 11/16	11/16
- 07	7	- 1/4	1/4	251.790.20 - 1/8	1/8	- 11/32	11/32	- 23/32	23/32
- 08	8	- 9/32	9/32	- 5/32	5/32	- 3/8	3/8	- 3/4	3/4
- 09	9	- 5/16	5/16	- 7/32	7/32	- 13/32	13/32	- 7/8	7/8
- 10	10	- 11/32	11/32	- 1/4	1/4	- 7/16	7/16	- 1	1
INCHES		- 3/8	3/8	- 9/32	9/32	- 15/32	15/32		
251.790.10 - 1/8	1/8	- 13/32	13/32	- 5/16	5/16				
- 5/32	5/32	- 7/16	7/16	- 11/32	11/32				
- 3/16	3/16	- 15/32	15/32	- 3/8	3/8				
- 7/32	7/32	- 1/2	1/2	- 13/32	13/32				
- 1/4	1/4	- 17/32	17/32	- 7/16	7/16				
- 9/32	9/32	- 9/16	9/16	- 15/32	15/32				
- 5/16	5/16	- 19/32	19/32	- 1/2	1/2				
- 11/32	11/32	- 5/8	5/8	- 17/32	17/32				
- 3/8	3/8			- 9/16	9/16				
				- 19/32	19/32				
				- 5/8	5/8				
				- 21/32	21/32				
				- 11/16	11/16				
				- 23/32	23/32				
				- 3/4	3/4				

Features:

- ▶ Runout accuracy: 5μm, S class 7μm, A class 10μm.
- ▶ One size clamping is recommended.
- ▶ Surface roughness: Ra < 0.1μm, S & A class < 0.15μm.



BEARING SPANNER

軸承扳手

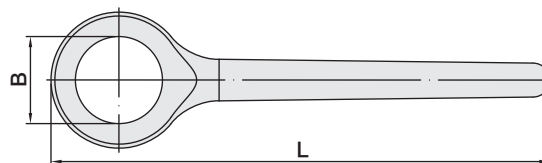

MODEL NO.	TYPE	NUT DIA	L	B	WEIGHT (KGS)
285.19.5	SK306, SKX6-CO	19.5	195	19.5	0.38
285.30	ER16, SKS10, PNER16, UT16, SKX10-CO	30	195	30	0.40
285.40	SKS16, PNER25, SK316, SKX16-CO	40	235	40	0.64
285.48	SKS20, UT32, SKX20-CO	48	235	48	0.69
285.55	SKX25-CO	55	250	55	1

SEALED CAP SPANNER

止水墊片扳手

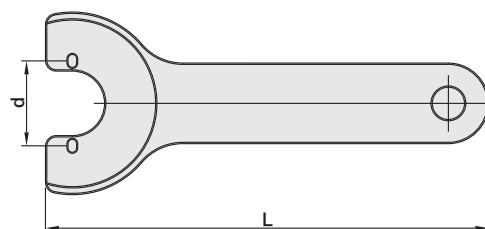

MODEL NO.	TYPE	L	d	WEIGHT (KGS)
288.790.06	SKX06	82.5	10.5	0.06
288.790.10	SKX10	82.5	15.8	0.05
288.790.16	SKX16	92.5	24.8	0.07
288.790.20	SKX20	92.5	28.8	0.07
288.790.25	SKX25	95.0	34.8	0.09

MEMO

A series of 18 horizontal gray bars, each representing a line of text in a memo format.



SHIN-YAIN INDUSTRIAL CO., LTD.
SHINTEK MACHINERY CO., LTD.

No.198, Jingpu Rd., Qingshui Dist., Taichung City 436, Taiwan
Tel: +886-4-26237575 | Fax: +886-4-26237676 | E-mail: sales@syic.com

