



SMG NON-PULLOUT MILLING CHUCK

NO.2021-01





COMPANY INTRODUCTION

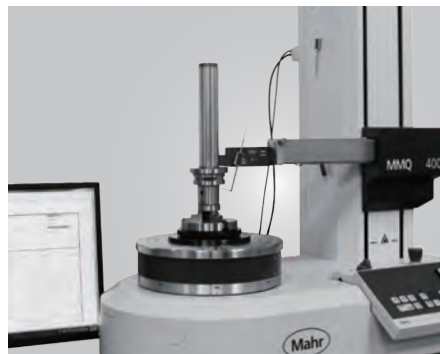



About SYIC

Established in 1979, SYIC is a professional manufacturer of precise tool holders, cutting tools, angel heads, boring series and collets with more than 500 employees. The taper types of tool holders we manufacture include BT (MAS403), CAT (ANSI B5.50), DAT (DIN69871-A), HSK (DIN69893), PSC (ISO26623-1), VDI (DIN ISO10889) and straight shank holders.

SYIC is certified to ISO9001 and ISO14001. With contribution to the design, production and sale of high accuracy and inventive products, SYIC has over 300 pieces of patents worldwide. SYIC keeps investing in high-end equipment and measuring instruments from Japan and Europe to implement excellent quality control and manufacturing capability.

SYIC keeps the core value "Quality creates reputation; reputation ensures quality" to impress our customers, possessing professional technical skills to provide comprehensive solutions for customers, improving customers' machining efficiency, and enhancing the mutual competitiveness with customers. Based on the mission of "Excellent service, supreme quality," SYIC will continue to launch more high precision products to customers.

N



Tool Holders

Your reliable partner!

————— CNC turning, milling and grinding —————

BMT
PSC
HSK
SBT
SCAT
SDAT

Premium
Quality

www.syic.com

供需平衡 共榮共存

Maintain the balance of suppliers and customers and grow together.

未來之路 無限寬廣

Create a great future with infinite opportunities.

營運獲利 永續經營

Run a profitable company with sustainable development.

合作到底 共創通贏

Keep everlasting cooperation and together create a win-win situation.

成就彼此 榮耀一切

Support each other and accomplish mutual success.



Innovation is our mission!

SYIC is committed to developing high precision products to optimize the machining process and offering professional technical service. With experienced technical professionals, our products are developed in response to different types of industries. We aim to achieve customers' demands from different industries including machining industry, mold and die industry, aerospace industry, automotive industry, and energy industry. We offer the most professional and technical service, effectively resolve your machining problems to create maximum production efficiency.

SMG

Non-Pullout Milling Chuck

SBT / SMG NON-PULLOUT MILLING CHUCK	4
HSK / SMG NON-PULLOUT MILLING CHUCK	5
BT PULL STUD	6-7
COOLANT SUPPLY UNIT & KEY	8
ACCESSORIES	9

SMG NON-PULLOUT MILLING CHUCK

NEW



Firmly clamp the tool, ideal for machining difficult-to-cut materials like titanium and nickel alloys.



Durable for coolant pressure up to 70 bar

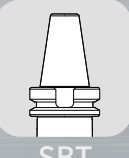
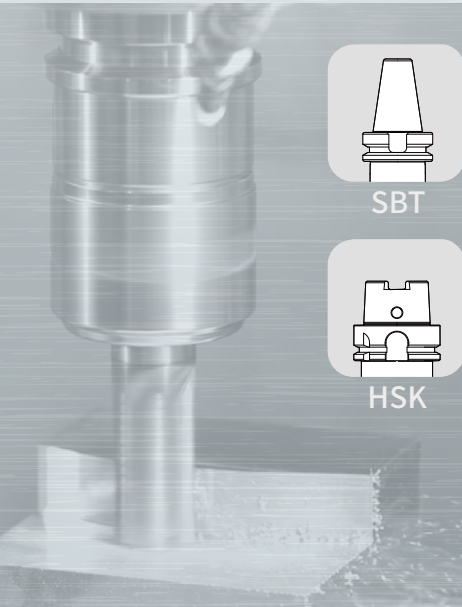

SBT



HSK

Firmly clamp the tool

Run-out accuracy: 5µm

Suitable for heavy duty application

Capable of high coolant pressure

- ▶ Patented positioning chip and backlash remove screw firmly clamp the tool, and effectively prevent tool slippage and pullout during manufacturing process.
- ▶ Used with standard Weldon tools (ISO3338-2, JIS B4005, DIN1835).
- ▶ SMG designed with 3 coolant grooves delivers coolant to improve metal chips removal and prolong tool life.

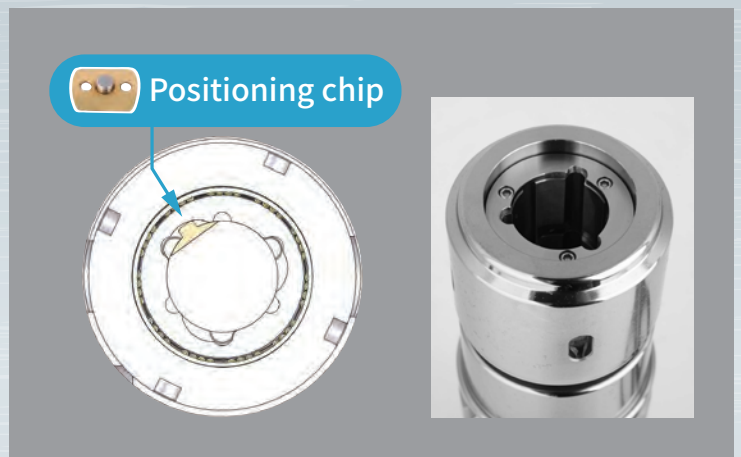
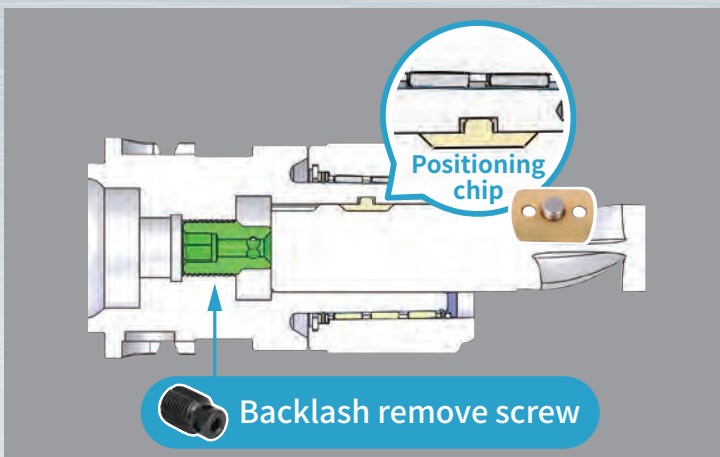

SBT / SMG NON-PULLOUT MILLING CHUCK

SBT / SMG 防脫刀刀桿

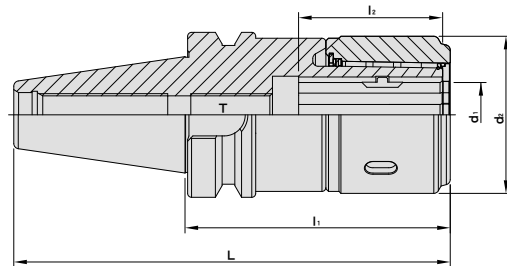

TW PAT NO. M610919

MODEL NO.	TYPE	L	l ₁	l ₂	d ₁	d ₂	T	WEIGHT (KGS)
5026 - 626 - 025 - 100	SBT40 x SMG25 - 100	165.4	100	55	25	60	M16 x 1.5P	2.40
5026 - 626 - 032 - 095	SBT40 x SMG32 - 95	160.4	95	61.8	32	71	M16 x 1.5P	2.70
5026 - 626 - 032 - 105	SBT40 x SMG32 - 105	170.4	105	61.8	32	71	M16 x 1.5P	2.70
5026 - 626 - 032 - 135	SBT40 x SMG32 - 135	200.4	135	61.8	32	71	M16 x 1.5P	3.00
5027 - 626 - 025 - 100	SBT50 x SMG25 - 100	201.8	100	55	25	60	M16 x 1.5P	4.80
5027 - 626 - 025 - 130	SBT50 x SMG25 - 130	231.8	130	55	25	60	M16 x 1.5P	5.70
5027 - 626 - 032 - 105	SBT50 x SMG32 - 105	206.8	105	61.8	32	71	M16 x 1.5P	5.00
5027 - 626 - 032 - 135	SBT50 x SMG32 - 135	236.8	135	61.8	32	71	M16 x 1.5P	5.20
5027 - 626 - 032 - 165	SBT50 x SMG32 - 165	266.8	165	61.8	32	71	M16 x 1.5P	6.70

Features:

- ▶ Run-out accuracy: 5μm
- ▶ Used with Weldon shank cutters.(ISO3338-2, JIS B4005, DIN1835)
- ▶ Ideal for machining difficult-to-cut materials like titanium alloys and nickel alloys in heavy duty applications.
- ▶ Patented backlash remove screw and positioning chip effectively lock cutters, preventing tool slippage and pullout during process.
- ▶ The design of 3 coolant grooves on the front can deliver coolant to remove metal chips and extend cutter use life.

Standard Accessory: • Backlash remove screw • Positioning chip • Spanners

Pull Stud	Backlash Remove Screw	Positioning Chip	Spanner	Allen Wrench
				
P.6~7	P.9	P.9	P.9	P.9



HSK / SMG NON-PULLOUT MILLING CHUCK

HSK / SMG 防脫刀刀桿

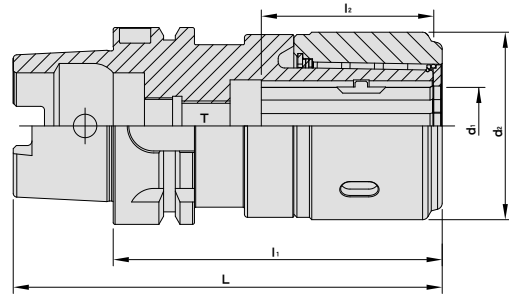







TW PAT NO. M610919

MODEL NO.	TYPE	L	l ₁	l ₂	d ₁	d ₂	T	WEIGHT (KGS)
5073 - 626 - 025 - 105	HSK63A x SMG25 - 105	137	105	55	25	60	M16 x 1.5P	1.85
5073 - 626 - 032 - 120	HSK63A x SMG32 - 120	152	120	61.8	32	71	M16 x 1.5P	1.80
5075 - 626 - 025 - 115	HSK100A x SMG25 - 115	165	115	55	25	60	M16 x 1.5P	3.30
5075 - 626 - 032 - 120	HSK100A x SMG32 - 120	170	120	61.8	32	71	M16 x 1.5P	3.40

Features:

- ▶ Run-out accuracy: 5μm
- ▶ Used with Weldon shank cutters.(ISO3338-2, JIS B4005, DIN1835)
- ▶ Ideal for machining difficult-to-cut materials like titanium alloys and nickel alloys in heavy duty applications.
- ▶ Patented backlash remove screw and positioning chip effectively lock cutters, preventing tool slippage and pullout during process.
- ▶ The design of 3 coolant grooves on the front can deliver coolant to remove metal chips and extend cutter use life.

Standard Accessory: • Backlash remove screw • Positioning chip • Spanners

Backlash Remove Screw	Positioning Chip	Spanner	Allen Wrench	Coolant Supply Unit	Key
					
P.9	P.9	P.9	P.9	P.8	P.8

BT PULL STUD

BT 螺栓拉頭

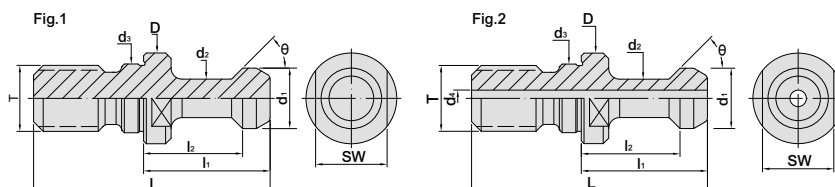

W/O Coolant

MODEL NO.	TYPE	L	l ₁	l ₂	D	d ₁	d ₂	d ₃	d ₄	θ	T	SW	Fig.	WEIGHT (KGS)
5230 - 010 - 45 - 00	BT30 - 45°	43	23	18	16.5	11	7	12.5	-	45°	M12	13	1	0.04
5230 - 011 - 45 - 00	BT40 - 45°	60	35	28	23	15	10	17	-	45°	M16	19	1	0.10
5230 - 012 - 45 - 00	BT50 - 45°	85	45	35	38	23	17	25	-	45°	M24	30	1	0.30
5230 - 010 - 60 - 00	BT30 - 60°	43	23	18	16.5	11	7	12.5	-	60°	M12	13	1	0.04
5230 - 011 - 60 - 00	BT40 - 60°	60	35	28	23	15	10	17	-	60°	M16	19	1	0.10
5230 - 012 - 60 - 00	BT50 - 60°	85	45	35	38	23	17	25	-	60°	M24	30	1	0.30
5230 - 010 - 90 - 00	BT30 - 90°	43	23	18	16.5	11	7	12.5	-	90°	M12	13	1	0.04
5230 - 011 - 90 - 00	BT40 - 90°	60	35	28	23	15	10	17	-	90°	M16	19	1	0.10
5230 - 012 - 90 - 00	BT50 - 90°	85	45	35	38	23	17	25	-	90°	M24	30	1	0.30

Coolant Thru

5231 - 010 - 45 - 00	BT30 - 45° - C	43	23	18	16.5	11	7	12.5	3	45°	M12	13	2	0.10
5231 - 011 - 15 - 00	BT40 - 15° - C	54	29	23	23	19	14	17	7	15°	M16	19	2	0.10
5231 - 011 - 45 - 00	BT40 - 45° - C	60	35	28	23	15	10	17	4	45°	M16	19	2	0.10
5231 - 011 - 45 - 01	BT40 - 45° - C - MAZAK	44.1	19.1	14.02	22	18.79	12.44	17	7	45°	M16	19	2	0.10
5231 - 012 - 45 - 00	BT50 - 45° - C	85	45	35	38	23	17	25	6	45°	M24	30	2	0.30
5231 - 012 - 45 - 01	BT50 - 45° - C - MAZAK	65.4	25.4	17.78	35.5	28.95	20.8	25	10	45°	M24	30	2	0.30
5231 - 011 - 60 - 00	BT40 - 60° - C	60	35	28	23	15	10	17	4	60°	M16	19	2	0.10
5231 - 012 - 60 - 00	BT50 - 60° - C	85	45	35	38	23	17	25	6	60°	M24	30	2	0.30
5231 - 011 - 90 - 00	BT40 - 90° - C	60	35	28	23	15	10	17	4	90°	M16	19	2	0.10
5231 - 012 - 90 - 00	BT50 - 90° - C	85	45	35	38	23	17	25	6	90°	M24	30	2	0.30

Features:

- ▶ Please make sure the pull stud conforms to the machine type.



BT PULL STUD

with ground thread

BT 研磨螺栓拉頭

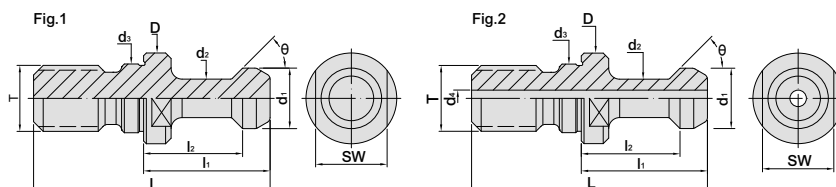

W/O Coolant

MODEL NO.	TYPE	L	l ₁	l ₂	D	d ₁	d ₂	d ₃	d ₄	θ	T	SW	Fig.	WEIGHT (KGS)
5232 - 010 - 45 - 00	BT30 - 45°G	43	23	18	16.5	11	7	12.5	-	45°	M12	13	1	0.04
5232 - 011 - 45 - 00	BT40 - 45°G	60	35	28	23	15	10	17	-	45°	M16	19	1	0.10
5232 - 012 - 45 - 00	BT50 - 45°G	85	45	35	38	23	17	25	-	45°	M24	30	1	0.30
5232 - 010 - 60 - 00	BT30 - 60°G	43	23	18	16.5	11	7	12.5	-	60°	M12	13	1	0.04
5232 - 011 - 60 - 00	BT40 - 60°G	60	35	28	23	15	10	17	-	60°	M16	19	1	0.10
5232 - 012 - 60 - 00	BT50 - 60°G	85	45	35	38	23	17	25	-	60°	M24	30	1	0.30
5232 - 010 - 90 - 00	BT30 - 90°G	43	23	18	16.5	11	7	12.5	-	90°	M12	13	1	0.04
5232 - 011 - 90 - 00	BT40 - 90°G	60	35	28	23	15	10	17	-	90°	M16	19	1	0.10
5232 - 012 - 90 - 00	BT50 - 90°G	85	45	35	38	23	17	25	-	90°	M24	30	1	0.30

Coolant Thru

5233 - 010 - 45 - 00	BT30 - 45°G - C	43	23	18	16.5	11	7	12.5	3	45°	M12	13	2	0.10
5233 - 011 - 45 - 00	BT40 - 45°G - C	60	35	28	23	15	10	17	4	45°	M16	19	2	0.10
5233 - 012 - 45 - 00	BT50 - 45°G - C	85	45	35	38	23	17	25	6	45°	M24	30	2	0.30
5233 - 011 - 60 - 00	BT40 - 60°G - C	60	35	28	23	15	10	17	4	60°	M16	19	2	0.10
5233 - 012 - 60 - 00	BT50 - 60°G - C	85	45	35	38	23	17	25	6	60°	M24	30	2	0.30
5233 - 011 - 90 - 00	BT40 - 90°G - C	60	35	28	23	15	10	17	4	90°	M16	19	2	0.10
5233 - 012 - 90 - 00	BT50 - 90°G - C	85	45	35	38	23	17	25	6	90°	M24	30	2	0.30

Features:

- ▶ Please make sure the pull stud conforms to the machine type.

COOLANT SUPPLY UNIT & KEY

HSK 給水管 / HSK COOLANT SUPPLY UNIT

(DIN 69895)

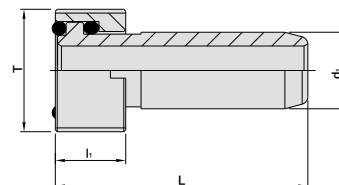

MODEL NO.	TYPE	L	l ₁	d ₁	T	WEIGHT (KGS)
5316 - 2032	HSK32A - CP	26	5.5	6	M10 x 1.0P	0.01
5316 - 2040	HSK40A - CP	29.3	7.5	8	M12 x 1.0P	0.01
5316 - 2050	HSK50A - CP	33	9.5	10	M16 x 1.0P	0.02
5316 - 2063	HSK63A - CP	36.6	11.5	12	M18 x 1.0P	0.02
5316 - 2080	HSK80A - CP	40	13.5	14	M20 x 1.5P	0.04
5316 - 2100	HSK100A - CP	44	15.5	16	M24 x 1.5P	0.06

HSK 給水管扳手 / KEY FOR HSK COOLANT SUPPLY UNIT

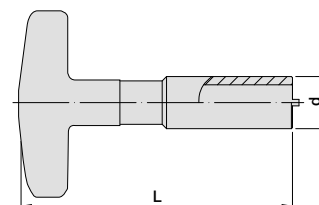

MODEL NO.	TYPE	L	d	WEIGHT (KGS)
5280 - 070 - 032	HSK32A - CPW	90	Ø10mm	0.10
5280 - 071 - 040	HSK40A - CPW	90	Ø13.5mm	0.12
5280 - 072 - 050	HSK50A - CPW	95	Ø15.5mm	0.14
5280 - 073 - 063	HSK63A - CPW	100	Ø17.5mm	0.16
5280 - 074 - 080	HSK80A - CPW	110	Ø19.5mm	0.12
5280 - 075 - 100	HSK100A - CPW	125	Ø23.5mm	0.32

ACCESSORIES

背隙消除螺絲 / BACKLASH REMOVE SCREW



MODEL NO.	TYPE
5296 - 46 - 025 - 08 - 00	M16 x 1.5P - 25

定位片 / POSITIONING CHIP



MODEL NO.	TYPE
5296 - 46 - 025 - 07 - 00	EM - 25
5296 - 46 - 032 - 07 - 00	EM - 32

扳手 / SPANNER

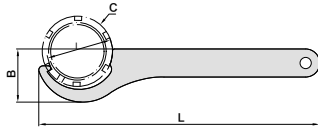

MODEL NO.	TYPE	L	B	C	I	WEIGHT (KGS)
5280 - 121 - 025	SMG25	260	46	60	52	0.30
5280 - 460 - 032	SMG32	272	64	71	63	0.45

T型扳手 / ALLEN WRENCH

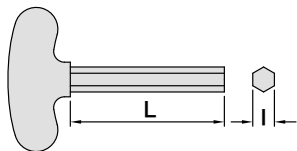

MODEL NO.	TYPE	L	I	WEIGHT (KGS)
210 - 003 - 080 - 002	T8 - 200	200	8	0.14

MEMO

Blank lined area for writing notes.





智能侯

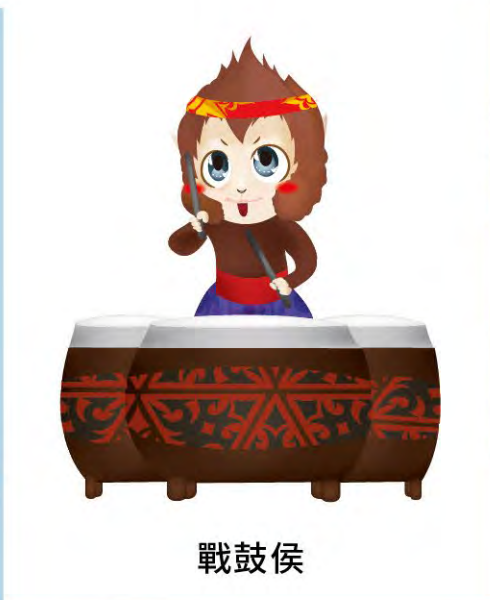

戰鼓侯



學識侯



俠客侯



勝侯王



登山侯



慢跑侯



咖啡侯



鐵馬侯



www.syic.com



SHIN-YAIN INDUSTRIAL CO., LTD.

No.198, Jingpu Rd., Qingshui Dist., Taichung City 436, Taiwan
Tel: +886-4-26237575 | Fax: +886-4-26237676 | E-mail: sales@syic.com

