



# EXTERNAL TURNING TOOL

NO.2021-02





# COMPANY INTRODUCTION

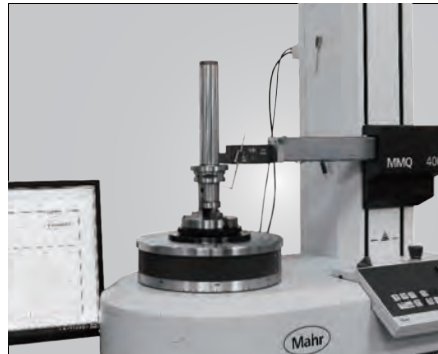





## 品質創造信譽 信譽保證品質

Quality creates reputation; reputation ensures quality.

### About SYIC

Established in 1979, SYIC is a professional manufacturer of precise tool holders, cutting tools, angel heads, boring series and collets with more than 500 employees. The taper types of tool holders we manufacture include BT (MAS403), CAT (ANSI B5.50), DAT (DIN69871-A), HSK (DIN69893), PSC (ISO26623-1), VDI (DIN ISO10889) and straight shank holders.

SYIC is certified to ISO9001 and ISO14001. With contribution to the design, production and sale of high accuracy and inventive products, SYIC has over 300 pieces of patents worldwide. SYIC keeps investing in high-end equipment and measuring instruments from Japan and Europe to implement excellent quality control and manufacturing capability.

SYIC keeps the core value "Quality creates reputation; reputation ensures quality" to impress our customers, possessing professional technical skills to provide comprehensive solutions for customers, improving customers' machining efficiency, and enhancing the mutual competitiveness with customers. Based on the mission of "Excellent service, supreme quality," SYIC will continue to launch more high precision products to customers.



# Tool Holders

**Your reliable partner!**

————— CNC turning, milling and grinding —————

BMT  
PSC  
HSK  
SBT  
SCAT  
SDAT

**Premium  
Quality**

[www.syic.com](http://www.syic.com)

供需平衡 共榮共存

Maintain the balance of suppliers and customers and grow together.

未來之路 無限寬廣

Create a great future with infinite opportunities.

營運獲利 永續經營

Run a profitable company with sustainable development.

合作到底 共創通贏

Keep everlasting cooperation and together create a win-win situation.

成就彼此 榮耀一切

Support each other and accomplish mutual success.



### **Innovation is our mission!**

SYIC is committed to developing high precision products to optimize the machining process and offering professional technical service. With experienced technical professionals, our products are developed in response to different types of industries. We aim to achieve customers' demands from different industries including machining industry, mold and die industry, aerospace industry, automotive industry, and energy industry. We offer the most professional and technical service, effectively resolve your machining problems to create maximum production efficiency.

# REFERENCE DETAILS

- ▶ Shank body standard: **ISO 26623-1**
- ▶ Hardness > **HRC 56°**
- ▶ Roundness < **0.8 μm**
- ▶ The shank has pre-balance at G6.3, and can provide precision balance at G2.5. It can be ordered by request.
- ▶ Taper tolerance < **AT3**
- ▶ Surface roughness: Ra < **0.25 μm**
- ▶ Carbon depth > **0.8mm**

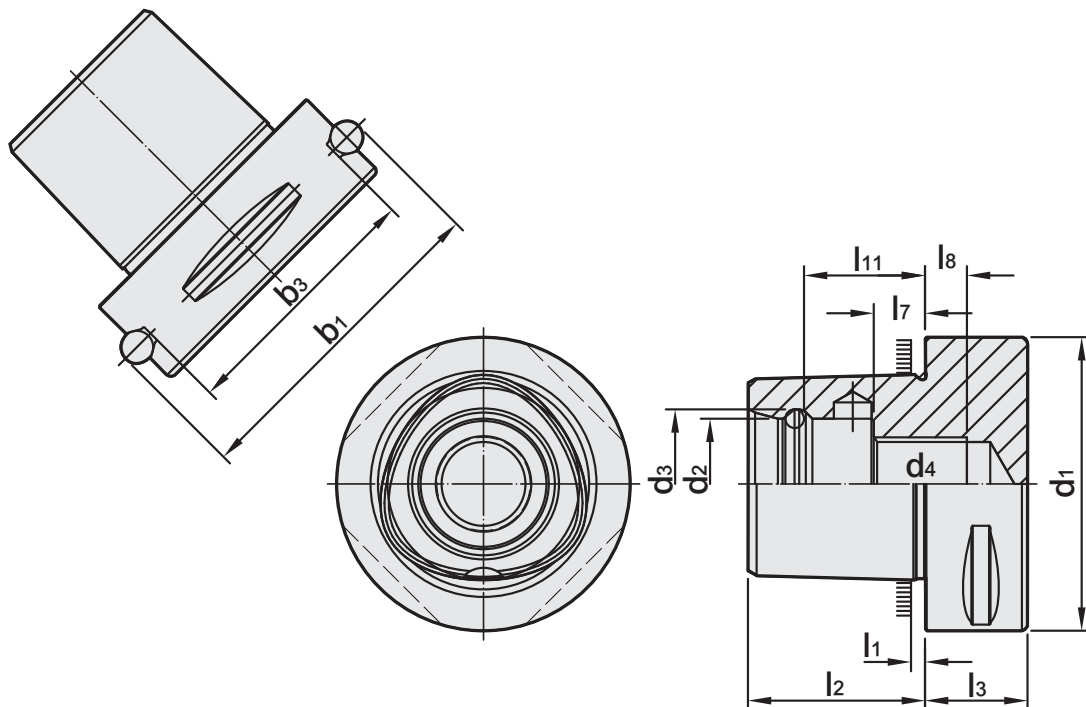

PSC	b <sub>1</sub> ±0.1	b <sub>3</sub> ±0.1	d <sub>1</sub> ±0.1	d <sub>2</sub> +0.1 -0.05	d <sub>3</sub> ±0.05	d <sub>4</sub>
32	39	27.9	32	15	16.5	M12 x 1.5P
40	46	34.9	40	18	20	M14 x 1.5P
50	59.3	44	50	21	24	M16 x 1.5P
63	70.7	55.4	63	28	32	M20 x 2.0P
80	86	70.7	80	32	38	M20 x 2.0P
80X	110	88.3	100	32	38	M20 x 2.0P
100	110	88.3	100	43	50.5	M24 x 2.0P
PSC	l <sub>1</sub>	l <sub>2</sub> ±0.1	l <sub>3</sub> min	l <sub>7</sub> ±0.15	l <sub>8</sub> min	l <sub>11</sub> ±0.1
32	2.5	19	15	6	6	13.5
40	2.5	24	20	9	6	17.5
50	3	30	20	10	7	22
63	3	38	22	11	9	26
80	3	48	30	20	0	34
80X	3	48	32	20	0	34
100	3	60	36	20	10	42.5



# DESIGNATION OF PSC

## PSC 編碼原則

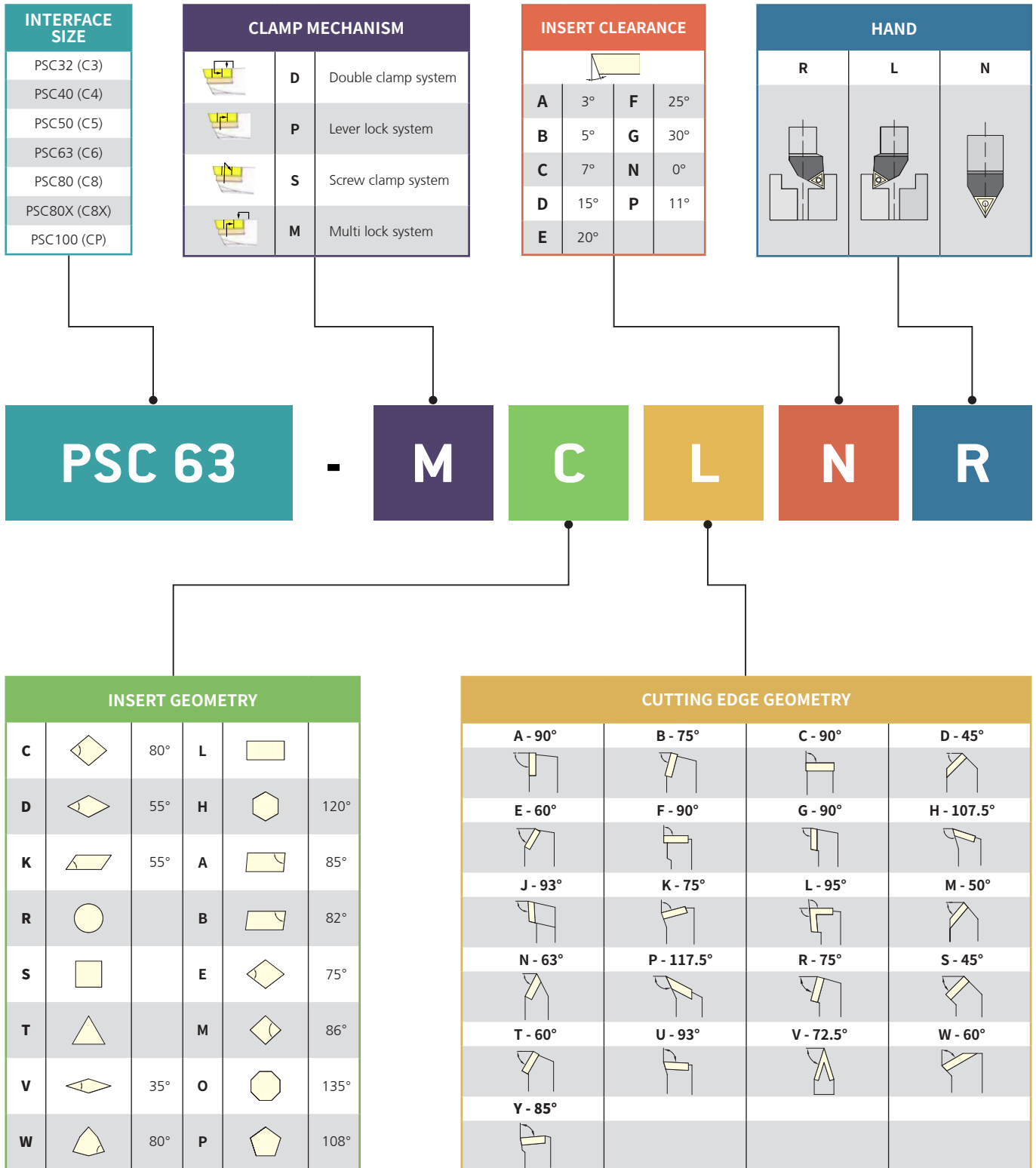







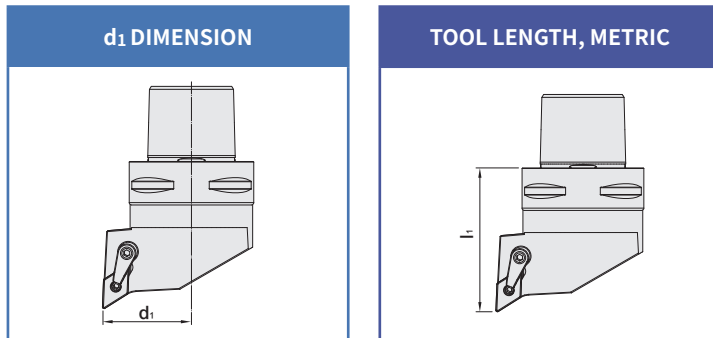

# DESIGNATION OF PSC

## PSC 編碼原則

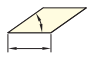
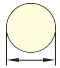

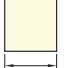
- **45** **065** **12**

INSERT EDGE LENGTH							
Insert inscribed circle	 80°	 55°	 35°				
6.35	06	07	11	-	11	-	-
7.94	08	-	-	-	13	-	-
9.525	09	11	16	-	16	09	06
12.00	-	-	-	12	-	-	-
12.70	12	15	-	-	22	12	08

# PSC EXTERNAL MACHINING OVERVIEW

## PSC 外徑加工應用總表

CC..	SCLC				
	 P.25-26				
CN..	DCLN	PCMN	PCLN	PCBN	PCKN
	 P.27	 P.13	 P.13-15、28、32、34	 P.15	 P.16-17
		PCRN	MCLN	MCMN	
	 P.29、33、35	 P.30	 P.31		
DC..	SDJC				
	 P.36				
DN..	DDJN	PDJN	MDJN	MDNN	
	 P.37、40	 P.17、41	 P.38	 P.39	
RC..	PRDC	PRSC	SRSC	SRDC	
	 P.18、20	 P.18、20-21	 P.19	 P.19	

# PSC EXTERNAL MACHINING OVERVIEW

## PSC 外徑加工應用總表

SN..	PSKN	PSRN	PSBN	PSDN	
	 P.23、42、44	 P.43	 P.22、24	 P.22、24	
TN..	DTJN	MTJN			
	 P.45	 P.46			
VB..	SVJB				
	 P.47				
VN..	MVLN	MVVN			
	 P.48	 P.49			
WN..	DWLN	MWLN			
	 P.50	 P.51			

# COOLANT OUTLETS OF TURNING TOOL

PSC外徑車刀出水介紹

## COOLANT HOLE - UHP TYPE

140bar

*ULTRA HIGH COOLANT PRESSURE WITH 3 COOLANT HOLES*

The coolant pressure of turning tool UHP type can be up to 140 bar. It is designed with 3 coolant holes and assembled with coolant screws to make the coolant more efficient to improve chip control, extend tool life and increase the processing efficiency.



## COOLANT HOLE

70bar

*WITH 1 COOLANT HOLE*

The coolant pressure of this type can be up to 70 bar. It is designed with 1 coolant hole and can deliver coolant directly to the cutting zone.

## COOLANT NOZZLE

10bar

*WITH COOLANT NOZZLE*

The coolant pressure of the turning tool with a coolant nozzle is 10 bar. The angle adjustable nozzle can deliver coolant directly to the cutting zone.



### Application:

► Idea for CNC lathes and millturn machines.



# CLAMPING SYSTEM OF TURNING TOOL

車刀夾持系統

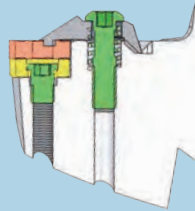

## D TYPE DOUBLE CLAMP

Firmly clamp the insert in two directions with one action.

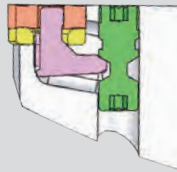

## P TYPE LEVER LOCK

- Easy insert replacement.
- General use.

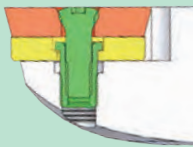

## S TYPE SCREW CLAMP

- Simple mechanism.
- Fewer parts.
- Finishing and medium machining.

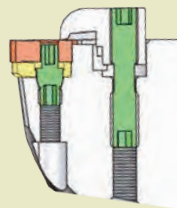

## M TYPE MULTI LOCK

- Combination of top clamp and pin lock.
- Rigid clamping.
- Heavy machining.

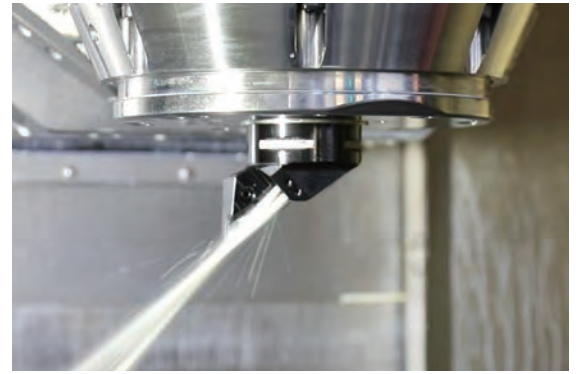

# PSC EXTERNALTURNING TOOL



# PSC EXTERNALTURNING TOOL

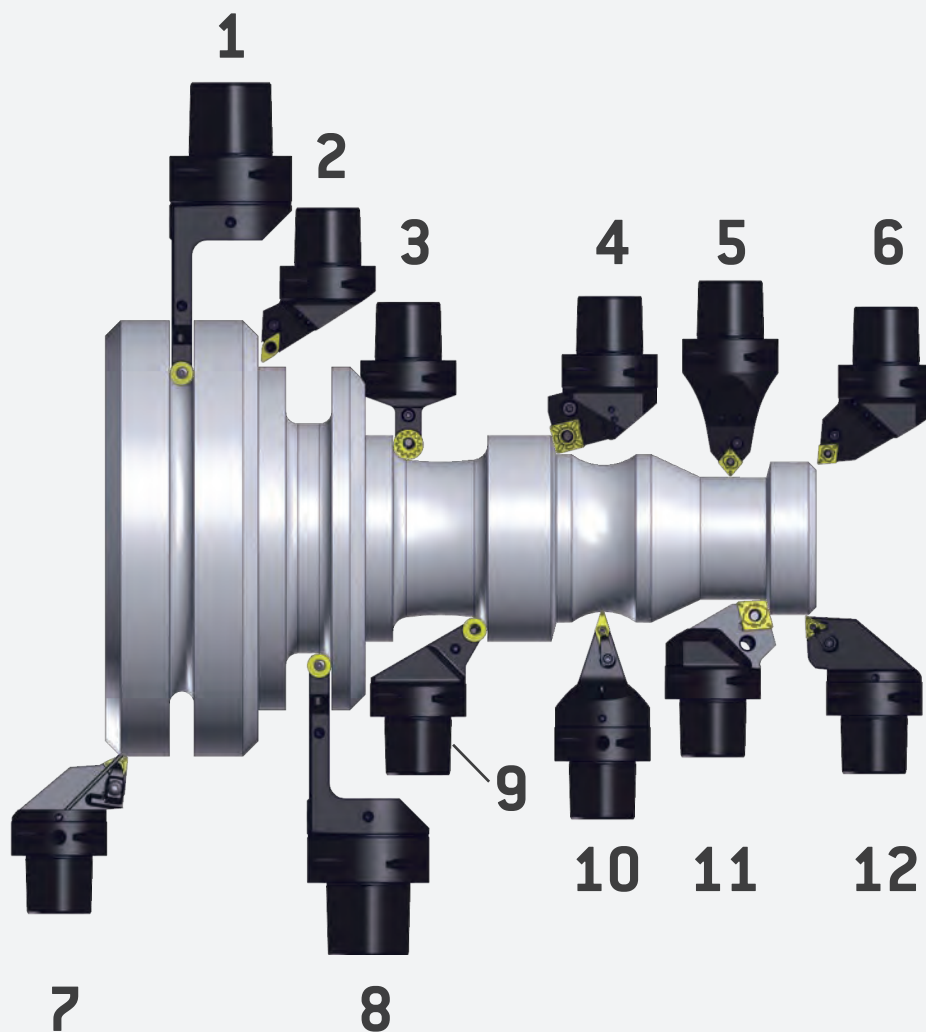

<b>1. PSC SRDC</b>	SEE PAGE P.19	<b>7. PSC MWLN</b>	SEE PAGE P.51
<b>2. PSC PDJN</b>	SEE PAGE P.41	<b>8. PSC SRDC</b>	SEE PAGE P.19
<b>3. PSC PRDC</b>	SEE PAGE P.18\20	<b>9. PSC PRSC</b>	SEE PAGE P.18\20-21
<b>4. PSC PSBN</b>	SEE PAGE P.22\24	<b>10. PSC MVN</b>	SEE PAGE P.49
<b>5. PSC PCMN</b>	SEE PAGE P.13	<b>11. PSC PCBN</b>	SEE PAGE P.15
<b>6. PSC PCLN</b>	SEE PAGE P.13-15\28 32\34	<b>12. PSC MTJN</b>	SEE PAGE P.46

# PSC / PCLN EXTERNAL TURNING TOOL

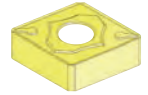

PSC / PCLN 外徑車刀

CN..1204

140  
bar

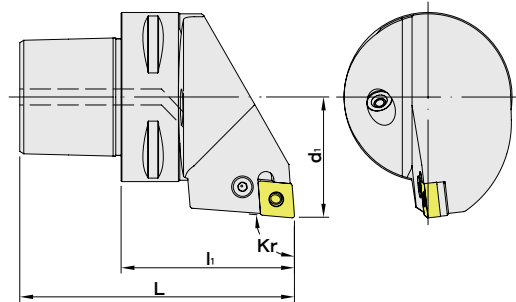







Kr=95°

MODEL NO.	TYPE	L	l <sub>1</sub>	d <sub>1</sub>	Insert	WEIGHT (KGS)
5143 - 563 - 12R - 065	PSC63 - PCLNR - 45065 - 12 - UHP	103	65	45	CN..1204	1.32
5143 - 563 - 12L - 065	PSC63 - PCLNL - 45065 - 12 - UHP	103	65	45	CN..1204	1.32

### Product information:

► Inserts are optional accessories and need to be purchased additionally.

### Accessory:

Insert	Lever	Lever screw	Shim	Shim pin	Wrench
					
CN..1204	LV43	VTL43	GPCN12	SPE30	3mm

# PSC / PCMN EXTERNAL TURNING TOOL

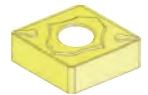

PSC / PCMN 外徑車刀

CN..1204

140  
bar

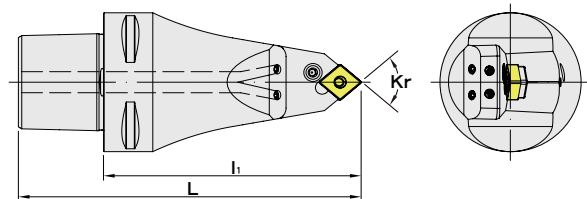







Kr=80°

MODEL NO.	TYPE	L	l <sub>1</sub>	Insert	WEIGHT (KGS)
5143 - 520 - 12N - 090	PSC63 - PCMNN - 00090 - 12 - UHP	128	90	CN..1204	1.40
5143 - 520 - 12N - 115	PSC63 - PCMNN - 00115 - 12 - UHP	153	115	CN..1204	1.75

### Product information:

► Inserts are optional accessories and need to be purchased additionally.

### Accessory:

Insert	Lever	Lever screw	Shim	Shim pin	Wrench
					
CN..1204	LV43	VTL43	GPCN12	SPE30	3mm



# PSC / PCLN EXTERNAL TURNING TOOL

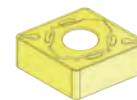

PSC / PCLN 外徑車刀

CN..1606

140  
bar

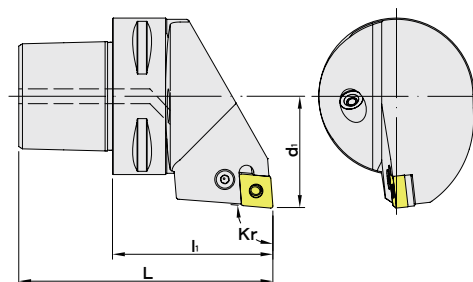







**Kr=95°**

MODEL NO.	TYPE	L	l <sub>1</sub>	d <sub>1</sub>	Insert	WEIGHT (KGS)
5143 - 563 - 16R - 065	PSC63 - PCLNR - 45065 - 16 - UHP	103	65	45	CN..1606	1.29
5143 - 563 - 16L - 065	PSC63 - PCLNL - 45065 - 16 - UHP	103	65	45	CN..1606	1.29

## Product information:

► Inserts are optional accessories and need to be purchased additionally.

## Accessory:

Insert	Lever	Lever screw	Shim	Shim pin	Wrench
					
CN..1606	LV52	VTL52	GPCN16	SPE50	3mm



# PSC / PCBN EXTERNAL TURNING TOOL

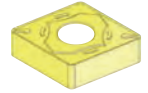

PSC / PCBN 外徑車刀

CN..1906

140  
bar

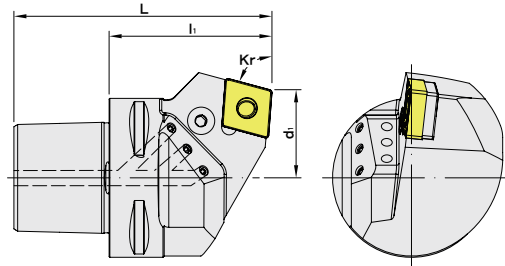

Kr=75°

MODEL NO.	TYPE	L	l <sub>1</sub>	d <sub>1</sub>	Insert	WEIGHT (KGS)
5143 - 539 - 19R - 065	PSC63 - PCBNR - 35065 - 19 - UHP	103	65	35	CN..1906	1.32
5143 - 539 - 19L - 065	PSC63 - PCBNL - 35065 - 19 - UHP	103	65	35	CN..1906	1.32

### Product information:

► Inserts are optional accessories and need to be purchased additionally.

### Accessory:

Insert	Lever	Lever screw	Shim	Shim pin	Wrench
CN..1906	LV60	VTL60	GPCN19	SPE60	4mm

# PSC / PCLN EXTERNAL TURNING TOOL

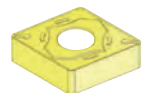

PSC / PCLN 外徑車刀

CN..1906

140  
bar

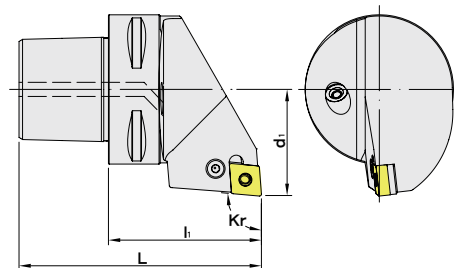

Kr=95°

MODEL NO.	TYPE	L	l <sub>1</sub>	d <sub>1</sub>	Insert	WEIGHT (KGS)
5143 - 563 - 19R - 065	PSC63 - PCLNR - 45065 - 19 - UHP	103	65	45	CN..1906	1.29
5143 - 563 - 19L - 065	PSC63 - PCLNL - 45065 - 19 - UHP	103	65	45	CN..1906	1.29
5144 - 563 - 19R - 080	PSC80 - PCLNR - 55080 - 19 - UHP	128	80	55	CN...1906	2.62
5144 - 563 - 19L - 080	PSC80 - PCLNL - 55080 - 19 - UHP	128	80	55	CN...1906	2.62

### Accessory:

Insert	Lever	Lever screw	Shim	Shim pin	Wrench
CN..1906	LV60	VTL60	GPCN19	SPE60	4mm

### Product information:

► Inserts are optional accessories and need to be purchased additionally.

# PSC / PCKN EXTERNAL TURNING TOOL

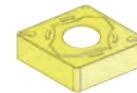

PSC / PCKN 外徑車刀

CN..1906

140  
bar

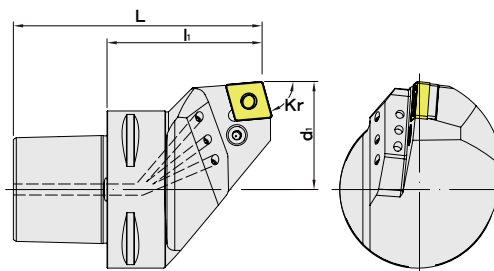







**Kr=75°**

MODEL NO.	TYPE	L	l <sub>1</sub>	d <sub>1</sub>	Insert	WEIGHT (KGS)
5144 - 514 - 19R - 080	PSC80 - PCKNR - 55080 - 19 - UHP	128	80	55	CN..1906	2.78
5144 - 514 - 19L - 080	PSC80 - PCKNL - 55080 - 19 - UHP	128	80	55	CN..1906	2.78

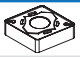
## Product information:

► Inserts are optional accessories and need to be purchased additionally.

## Accessory:

Insert	Lever	Lever screw	Shim	Shim pin	Wrench
					
CN..1906	LV60	VTL60	GPCN19	SPE60	4mm



# PSC / PCKN EXTERNAL TURNING TOOL

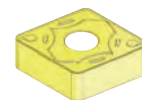

PSC / PCKN 外徑車刀

CN..2509

140  
bar

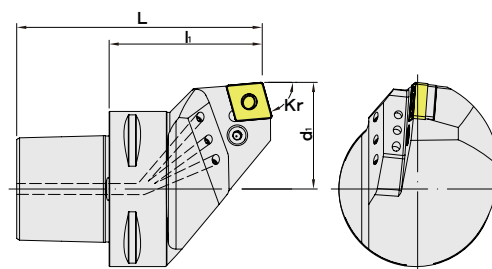

Kr=75°

MODEL NO.	TYPE	L	l <sub>1</sub>	d <sub>1</sub>	Insert	WEIGHT (KGS)
5144 - 514 - 25R - 080	PSC80 - PCKNR - 55080 - 25 - UHP	128	80	55	CN..2509	2.68
5144 - 514 - 25L - 080	PSC80 - PCKNL - 55080 - 25 - UHP	128	80	55	CN..2509	2.68

### Product information:

► Inserts are optional accessories and need to be purchased additionally.

### Accessory:

Insert	Lever	Lever screw	Shim	Shim pin	Wrench
CN..2509	LV70	VTL90	GPCN25	SPE70	5mm

# PSC / PDJN EXTERNAL TURNING TOOL



PSC / PDJN 外徑車刀

DN..1506

140  
bar

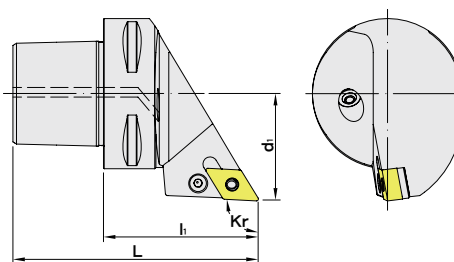

Kr=93°

MODEL NO.	TYPE	L	l <sub>1</sub>	d <sub>1</sub>	Insert	WEIGHT (KGS)
5143 - 564 - 15R - 065	PSC63 - PDJNR - 45065 - 15 - UHP	103	65	45	DN..1506	1.06
5143 - 564 - 15L - 065	PSC63 - PDJNL - 45065 - 15 - UHP	103	65	45	DN..1506	1.06

### Product information:

► Inserts are optional accessories and need to be purchased additionally.

### Accessory:

Insert	Lever	Lever screw	Shim	Shim pin	Wrench
DN..1506	LV82	VTL43	GPDN15	SPE30	4mm



# PSC / PRDC EXTERNAL TURNING TOOL



PSC / PRDC 外徑車刀

RC..1606

140  
bar

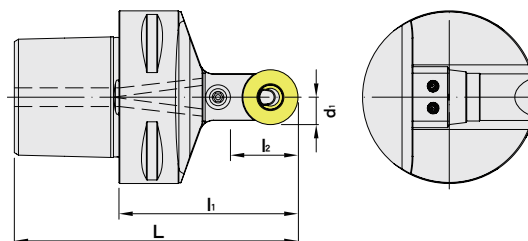

MODEL NO.	TYPE	L	l <sub>1</sub>	l <sub>2</sub>	d <sub>1</sub>	Insert	WEIGHT (KGS)
5143 - 536 - 16N - 065	PSC63 - PRDCN - 00065 - 16 - UHP	103	65	30	8	RC..1606	0.91

### Product information:

► Inserts are optional accessories and need to be purchased additionally.

### Accessory:

Insert	Lever	Lever screw	Shim	Shim pin	Wrench
RC..1606	LV51	VTL50	GPRC16	SPE40	2.5mm

# PSC / PRSC EXTERNAL TURNING TOOL



PSC / PRSC 外徑車刀

RC..1606

140  
bar

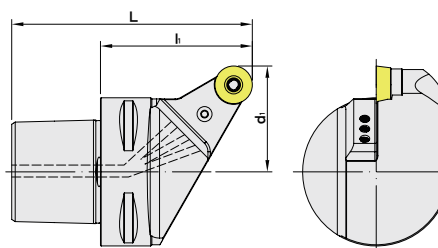

MODEL NO.	TYPE	L	l <sub>1</sub>	d <sub>1</sub>	Insert	WEIGHT (KGS)
5143 - 535 - 16R - 065	PSC63 - PRSCR - 45065 - 16 - UHP	103	65	45	RC..1606	1.11
5143 - 535 - 16L - 065	PSC63 - PRSCL - 45065 - 16 - UHP	103	65	45	RC..1606	1.11

### Product information:

► Inserts are optional accessories and need to be purchased additionally.

### Accessory:

Insert	Lever	Lever screw	Shim	Shim pin	Wrench
RC..1606	LV51	VTL50	GPRC16	SPE40	2.5mm



# PSC / SRDC EXTERNAL TURNING TOOL



PSC / SRDC 外徑車刀

RC..1606

140  
bar

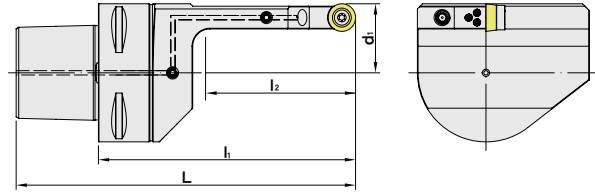





MODEL NO.	TYPE	L	l <sub>1</sub>	l <sub>2</sub>	d <sub>1</sub>	Insert	WEIGHT (KGS)
5144 - S31 - 16R - 150	PSC80 - SRDCR - 40150 - 16 - UHP	143	95	84	40	RC..1606	3.67
5144 - S31 - 16L - 150	PSC80 - SRDCL - 40150 - 16 - UHP	143	95	84	40	RC..1606	3.67

### Product information:

► Inserts are optional accessories and need to be purchased additionally.

### Accessory:

Insert	Shim	Shim screw	Clamp screw
			
RC..1606	SRMP16	BO5080	VTRM16

# PSC / SRSC EXTERNAL TURNING TOOL



PSC / SRSC 外徑車刀

RC..1606

140  
bar

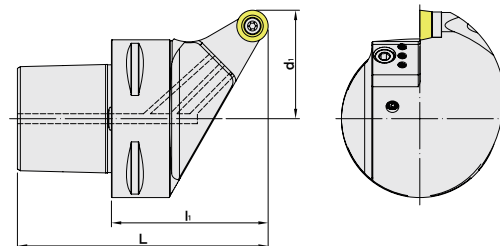





MODEL NO.	TYPE	L	l <sub>1</sub>	d <sub>1</sub>	Insert	WEIGHT (KGS)
5144 - 625 - 16R - 080	PSC80 - SRSCR - 55080 - 16 - UHP	128	80	55	RC..1606	2.47
5144 - 625 - 16L - 080	PSC80 - SRSCCL - 55080 - 16 - UHP	128	80	55	RC..1606	2.47

### Product information:

► Inserts are optional accessories and need to be purchased additionally.

### Accessory:

Insert	Shim	Shim screw	Clamp screw
			
RC..1606	SRMP16	BO5080	VTRM16

# PSC / PRDC EXTERNAL TURNING TOOL



PSC / PRDC 外徑車刀

RC..2006

140  
bar

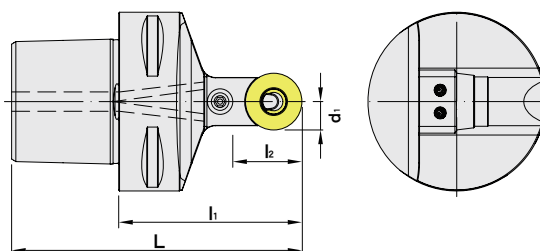

Kr=93°

MODEL NO.	TYPE	L	l <sub>1</sub>	l <sub>2</sub>	d <sub>1</sub>	Insert	WEIGHT (KGS)
5143 - 536 - 20N - 065	PSC63 - PRDCN - 00065 - 20 - UHP	103	65	30	10	RC..2006	0.93

### Product information:

► Inserts are optional accessories and need to be purchased additionally.

### Accessory:

Insert	Lever	Lever screw	Shim	Shim pin	Wrench
RC..2006	LV61	VTL53	GPRC20	SPE50	3mm

# PSC / PRSC EXTERNAL TURNING TOOL



PSC / PRSC 外徑車刀

RC..2006

140  
bar

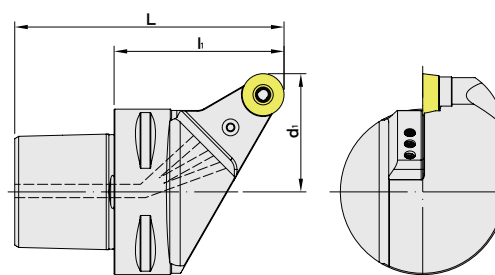

MODEL NO.	TYPE	L	l <sub>1</sub>	d <sub>1</sub>	Insert	WEIGHT (KGS)
5143 - 535 - 20R - 065	PSC63 - PRSCR - 45065 - 20 - UHP	103	65	45	RC..2006	1.12
5143 - 535 - 20L - 065	PSC63 - PRSCL - 45065 - 20 - UHP	103	65	45	RC..2006	1.12
5144 - 535 - 20R - 080	PSC80 - PRSCR - 55080 - 20 - UHP	128	80	55	RC..2006	2.41
5144 - 535 - 20L - 080	PSC80 - PRSCL - 55080 - 20 - UHP	128	80	55	RC..2006	2.41

### Accessory:

Insert	Lever	Lever screw	Shim	Shim pin	Wrench
RC..2006	LV61	VTL53	GPRC20	SPE50	3mm

### Product information:

► Inserts are optional accessories and need to be purchased additionally.



# PSC / PRSC EXTERNAL TURNING TOOL



PSC / PRSC 外徑車刀

RC..2507

140  
bar

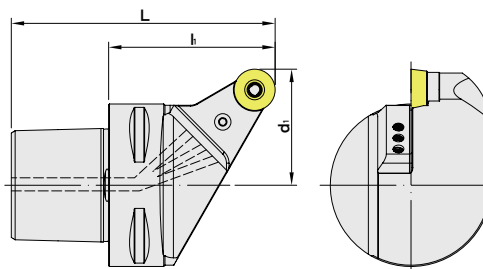







MODEL NO.	TYPE	L	l <sub>1</sub>	d <sub>1</sub>	Insert	WEIGHT (KGS)
5144 - 535 - 25R - 080	PSC80 - PRSCR - 55080 - 25 - UHP	128	80	55	RC..2507	2.39
5144 - 535 - 25L - 080	PSC80 - PRSCL - 55080 - 25 - UHP	128	80	55	RC..2507	2.39

## Product information:

► Inserts are optional accessories and need to be purchased additionally.

## Accessory:

Insert	Lever	Lever screw	Shim	Shim pin	Wrench
 RC..2507	 LV71	 VTL80	 GPRC25	 SPE60	 4mm



# PSC / PSBN EXTERNAL TURNING TOOL

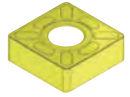

PSC / PSBN 外徑車刀

SN..1906

140  
bar

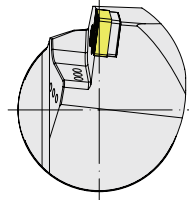
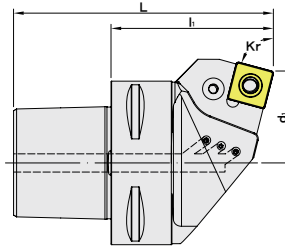

Kr=75°

MODEL NO.	TYPE	L	l <sub>1</sub>	d <sub>1</sub>	Insert	WEIGHT (KGS)
5143 - 534 - 19R - 065	PSC63 - PSBNR - 35065 - 19 - UHP	103	65	35	SN..1906	1.32
5143 - 534 - 19L - 065	PSC63 - PSBNL - 35065 - 19 - UHP	103	65	35	SN..1906	1.32
5144 - 534 - 19R - 080	PSC80 - PSBNR - 45080 - 19 - UHP	128	80	45	SN..1906	2.69
5144 - 534 - 19L - 080	PSC80 - PSBNL - 45080 - 19 - UHP	128	80	45	SN..1906	2.69

## Accessory:

Insert	Lever	Lever screw	Shim	Shim pin	Wrench
SN..1906	LV60	VTL60	GPSN19	SPE60	4mm

## Product information:

▶ Inserts are optional accessories and need to be purchased additionally.

# PSC / PSDN EXTERNAL TURNING TOOL

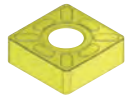

PSC / PSDN 外徑車刀

SN..1906

140  
bar

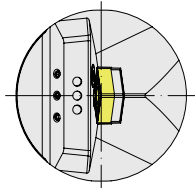
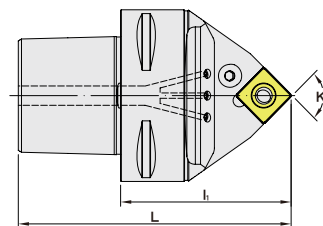

Kr=90°

MODEL NO.	TYPE	L	l <sub>1</sub>	Insert	WEIGHT (KGS)
5144 - 538 - 19N - 080	PSC80 - PSDNN - 00080 - 19 - UHP	128	80	SN..1906	2.35

## Accessory:

Insert	Lever	Lever screw	Shim	Shim pin	Wrench
SN..1906	LV60	VTL60	GPSN19	SPE60	4mm

## Product information:

▶ Inserts are optional accessories and need to be purchased additionally.



# PSC / PSKN EXTERNAL TURNING TOOL

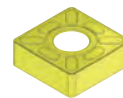

PSC / PSKN 外徑車刀

SN..1906

140  
bar

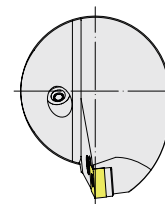
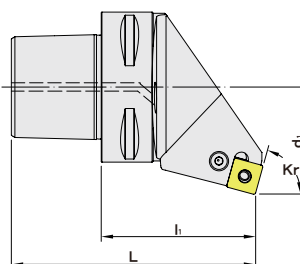







Kr=75°

MODEL NO.	TYPE	L	l <sub>1</sub>	d <sub>1</sub>	Insert	WEIGHT (KGS)
5143 - 565 - 19R - 080	PSC63 - PSKNR - 45080 - 19 - UHP	118	80	45	SN..1906	1.63
5143 - 565 - 19L - 080	PSC63 - PSKNL - 45080 - 19 - UHP	118	80	45	SN..1906	1.63
5144 - 565 - 19R - 080	PSC80 - PSKNR - 55080 - 19 - UHP	128	80	55	SN..1906	2.82
5144 - 565 - 19L - 080	PSC80 - PSKNL - 55080 - 19 - UHP	128	80	55	SN..1906	2.82

## Product information:

► Inserts are optional accessories and need to be purchased additionally.

## Accessory:

Insert	Lever	Lever screw	Shim	Shim pin	Wrench
					
SN..1906	LV60	VTL60	GPSN19	SPE60	4mm

# PSC / PSBN EXTERNAL TURNING TOOL

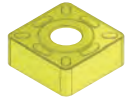

PSC / PSBN 外徑車刀

SN..2509



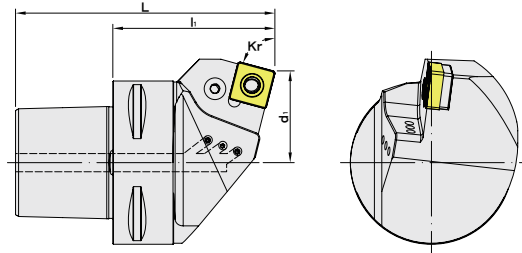



140  
bar

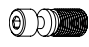

Kr=75°

MODEL NO.	TYPE	L	l <sub>1</sub>	d <sub>1</sub>	Insert	WEIGHT (KGS)
5144 - 534 - 25R - 080	PSC80 - PSBNR - 45080 - 25 - UHP	128	80	45	SN..2509	2.57
5144 - 534 - 25L - 080	PSC80 - PSBNL - 45080 - 25 - UHP	128	80	45	SN..2509	2.57
5146 - 534 - 25L - 110	PSC100 - PSBNL - 58110 - 25 - UHP	170	110	58	SN..2509	5.50
5146 - 534 - 25R - 110	PSC100 - PSBNR - 58110 - 25 - UHP	170	110	58	SN..2509	5.50

## Accessory:

Insert	Lever	Lever screw	Shim	Shim pin	Wrench
 SN..2509	 LV70	 VTL90	 GPCN25	 SPE70	 5mm

## Product information:

- ▶ Inserts are optional accessories and need to be purchased additionally.

# PSC / PSDN EXTERNAL TURNING TOOL

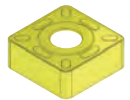

PSC / PSDN 外徑車刀

SN..2509



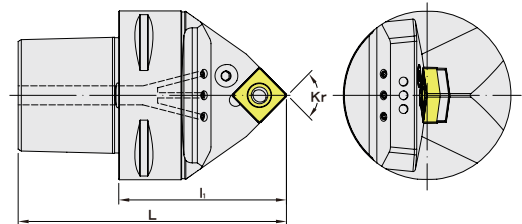



140  
bar



Kr=90°

MODEL NO.	TYPE	L	l <sub>1</sub>	Insert	WEIGHT (KGS)
5144 - 538 - 25N - 080	PSC80 - PSDNN - 00080 - 25 - UHP	128	80	SN..2509	2.19

## Accessory:

Insert	Lever	Lever screw	Shim	Shim pin	Wrench
 SN..2509	 LV70	 VTL90	 GPCN25	 SPE70	 5mm

## Product information:

- ▶ Inserts are optional accessories and need to be purchased additionally.



# PSC / SCLC EXTERNAL TURNING TOOL

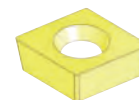

PSC / SCLC 外徑車刀

CC..09T3

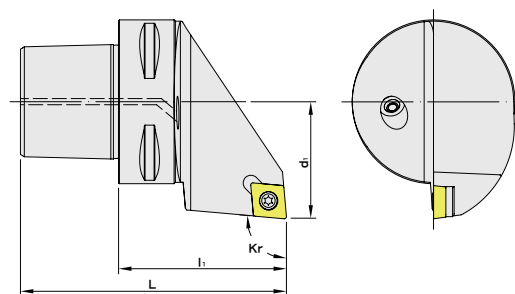



Kr=95°

MODEL NO.	TYPE	L	l <sub>1</sub>	d <sub>1</sub>	Insert	WEIGHT (KGS)
5140 - 787 - 09R - 040	PSC32 - SCLCR - 22040 - 09	59	40	22	CC..09T3	0.20
5140 - 787 - 09L - 040	PSC32 - SCLCL - 22040 - 09	59	40	22	CC..09T3	0.20
5141 - 787 - 09R - 050	PSC40 - SCLCR - 27050 - 09	74	50	27	CC..09T3	0.38
5141 - 787 - 09L - 050	PSC40 - SCLCL - 27050 - 09	74	50	27	CC..09T3	0.38
5142 - 787 - 09R - 060	PSC50 - SCLCR - 35060 - 09	90	60	35	CC..09T3	0.68
5142 - 787 - 09L - 060	PSC50 - SCLCL - 35060 - 09	90	60	35	CC..09T3	0.68
5143 - 787 - 09R - 065	PSC63 - SCLCR - 45065 - 09	103	65	45	CC..09T3	1.11
5143 - 787 - 09L - 065	PSC63 - SCLCL - 45065 - 09	103	65	45	CC..09T3	1.11

## Product information:

► Inserts are optional accessories and need to be purchased additionally.

## Accessory:

Insert	Clamp screw	Wrench
		
CC..09T3	I60M3.5x8	WT15IP

# PSC / SCLC EXTERNAL TURNING TOOL

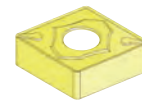

PSC / SCLC 外徑車刀

CC..1204

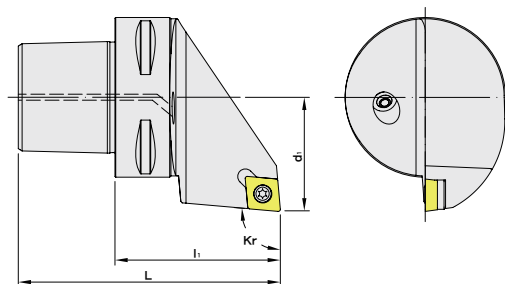







**Kr=95°**

MODEL NO.	TYPE	L	l <sub>1</sub>	d <sub>1</sub>	Insert	WEIGHT (KGS)
5140 - 787 - 12R - 040	PSC32 - SCLCR - 22040 - 12	59	40	22	CC..1204	0.20
5140 - 787 - 12L - 040	PSC32 - SCLCL - 22040 - 12	59	40	22	CC..1204	0.20
5141 - 787 - 12R - 050	PSC40 - SCLCR - 27050 - 12	74	50	27	CC..1204	0.38
5141 - 787 - 12L - 050	PSC40 - SCLCL - 27050 - 12	74	50	27	CC..1204	0.38
5142 - 787 - 12R - 060	PSC50 - SCLCR - 35060 - 12	90	60	35	CC..1204	0.67
5142 - 787 - 12L - 060	PSC50 - SCLCL - 35060 - 12	90	60	35	CC..1204	0.67
5143 - 787 - 12R - 065	PSC63 - SCLCR - 45065 - 12	103	65	45	CC..1204	1.11
5143 - 787 - 12L - 065	PSC63 - SCLCL - 45065 - 12	103	65	45	CC..1204	1.11

## Product information:

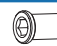
► Inserts are optional accessories and need to be purchased additionally.

## Accessory:

Insert	Shim	Shim screw	Clamp screw	Wrench	Wrench
					
CC..1204	C12BS	SM6x10XA	I60M4x11X	WH40L	WT15IP



# PSC / DCLN EXTERNAL TURNING TOOL

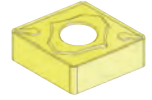

PSC / DCLN 外徑車刀

CN..1204

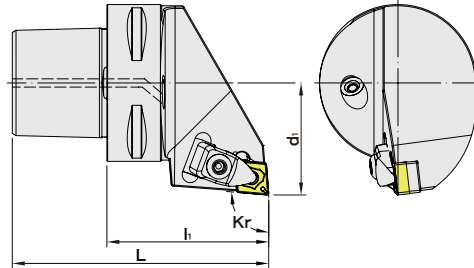

**Kr=95°**

MODEL NO.	TYPE	L	l <sub>1</sub>	d <sub>1</sub>	Insert	WEIGHT (KGS)
5140 - 090 - 12R - 045	PSC32 - DCLNR - 22045 - 12	64	45	22	CN..1204	0.22
5140 - 090 - 12L - 045	PSC32 - DCLNL - 22045 - 12	64	45	22	CN..1204	0.22
5141 - 090 - 12R - 050	PSC40 - DCLNR - 27050 - 12	74	50	27	CN..1204	0.42
5141 - 090 - 12L - 050	PSC40 - DCLNL - 27050 - 12	74	50	27	CN..1204	0.42
5142 - 090 - 12R - 060	PSC50 - DCLNR - 35060 - 12	90	60	35	CN..1204	0.78
5142 - 090 - 12L - 060	PSC50 - DCLNL - 35060 - 12	90	60	35	CN..1204	0.78
5143 - 090 - 12R - 065	PSC63 - DCLNR - 45065 - 12	103	65	45	CN..1204	0.80
5143 - 090 - 12L - 065	PSC63 - DCLNL - 45065 - 12	103	65	45	CN..1204	0.80
5144 - 090 - 12R - 080	PSC80 - DCLNR - 55080 - 12	128	80	55	CN..1204	2.64
5144 - 090 - 12L - 080	PSC80 - DCLNL - 55080 - 12	128	80	55	CN..1204	2.64

## Product information:

► Inserts are optional accessories and need to be purchased additionally.

## Accessory:

Insert	Clamp	Shim	Shim screw	Clamp screw	Spring	Wrench
						
CN..1204	C2RA	C12BM	SM6x10xA1	CM6x25C	SPR4	4mm



# PSC / PCLN EXTERNAL TURNING TOOL

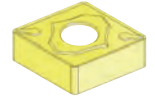

PSC / PCLN 外徑車刀

CN..1204

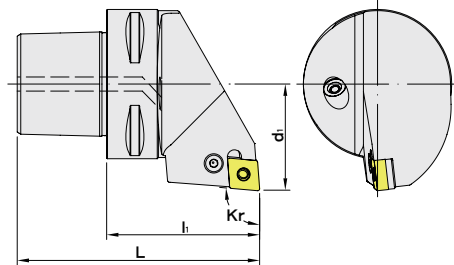







**Kr=95°**

MODEL NO.	TYPE	L	l <sub>1</sub>	d <sub>1</sub>	Insert	WEIGHT (KGS)
5140 - 515 - 12R - 040	PSC32 - PCLNR - 22040 - 12	59	40	22	CN..1204	0.20
5140 - 515 - 12L - 040	PSC32 - PCLNL - 22040 - 12	59	40	22	CN..1204	0.20
5141 - 515 - 12R - 050	PSC40 - PCLNR - 27050 - 12	74	50	27	CN..1204	0.38
5141 - 515 - 12L - 050	PSC40 - PCLNL - 27050 - 12	74	50	27	CN..1204	0.38
5142 - 515 - 12R - 060	PSC50 - PCLNR - 35060 - 12	90	60	35	CN..1204	0.70
5142 - 515 - 12L - 060	PSC50 - PCLNL - 35060 - 12	90	60	35	CN..1204	0.70
5143 - 515 - 12R - 065	PSC63 - PCLNR - 45065 - 12	103	65	45	CN..1204	1.21
5143 - 515 - 12L - 065	PSC63 - PCLNL - 45065 - 12	103	65	45	CN..1204	1.21
5144 - 515 - 12R - 080	PSC80 - PCLNR - 55080 - 12	128	80	55	CN..1204	2.54
5144 - 515 - 12L - 080	PSC80 - PCLNL - 55080 - 12	128	80	55	CN..1204	2.54

## Product information:

► Inserts are optional accessories and need to be purchased additionally.

## Accessory:

Insert	Lever	Lever screw	Shim	Shim pin	Wrench
					
CN..1204	L4	LEM8x21	C12AP	SP4	WH30L



# PSC / PCRN EXTERNAL TURNING TOOL

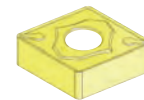

PSC / PCRN 外徑車刀

CN..1204

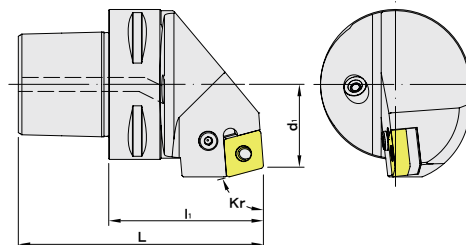

**Kr=75°**

MODEL NO.	TYPE	L	l <sub>1</sub>	d <sub>1</sub>	Insert	WEIGHT (KGS)
5142 - 525 - 12R - 060	PSC50 - PCNRN - 27060 - 12	90	60	27	CN..1204	0.67
5142 - 525 - 12L - 060	PSC50 - PCRNL - 27060 - 12	90	60	27	CN..1204	0.67
5143 - 525 - 12R - 065	PSC63 - PCNRN - 35065 - 12	103	65	35	CN..1204	1.19
5143 - 525 - 12L - 065	PSC63 - PCRNL - 35065 - 12	103	65	35	CN..1204	1.19

**Product information:**

► Inserts are optional accessories and need to be purchased additionally.

**Accessory:**

Insert	Lever	Lever screw	Shim	Shim pin	Wrench
CN..1204	L4	LEM8x21	C12AP	SP4	WH30L



# PSC / MCLN EXTERNAL TURNING TOOL

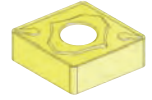

PSC / MCLN 外徑車刀

CN..1204

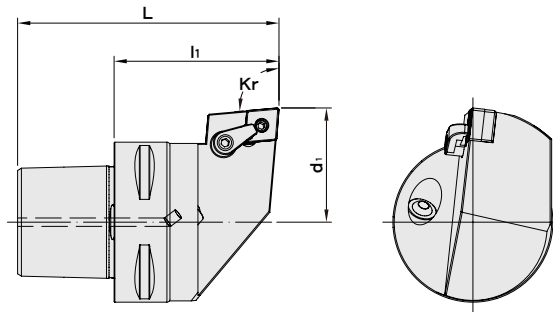







**Kr=95°**

MODEL NO.	TYPE	L	l <sub>1</sub>	d <sub>1</sub>	Insert	WEIGHT (KGS)
5140 - 475 - 12R - 045	PSC32 - MCLNR - 22045 - 12	64	45	22	CN..1204	0.22
5140 - 475 - 12L - 045	PSC32 - MCLNL - 22045 - 12	64	45	22	CN..1204	0.22
5141 - 475 - 12R - 050	PSC40 - MCLNR - 27050 - 12	74	50	27	CN..1204	0.42
5141 - 475 - 12L - 050	PSC40 - MCLNL - 27050 - 12	74	50	27	CN..1204	0.42
5142 - 475 - 12R - 060	PSC50 - MCLNR - 35060 - 12	90	60	35	CN..1204	0.78
5142 - 475 - 12L - 060	PSC50 - MCLNL - 35060 - 12	90	60	35	CN..1204	0.78
5143 - 475 - 12R - 065	PSC63 - MCLNR - 45065 - 12	103	65	45	CN..1204	0.80
5143 - 475 - 12L - 065	PSC63 - MCLNL - 45065 - 12	103	65	45	CN..1204	0.80

## Product information:

► Inserts are optional accessories and need to be purchased additionally.

## Accessory:

Insert	Clamp	Shim	Clamp screw	Shim screw	Clamp wrench	Wrench
						
CN..1204	MC620	SMC432	MS620	MLP46L-A	3mm	2.5mm



# PSC / MCMN EXTERNAL TURNING TOOL

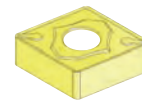

PSC / MCMN 外徑車刀

CN..1204



台灣精品 2012  
TAIWAN EXCELLENCE

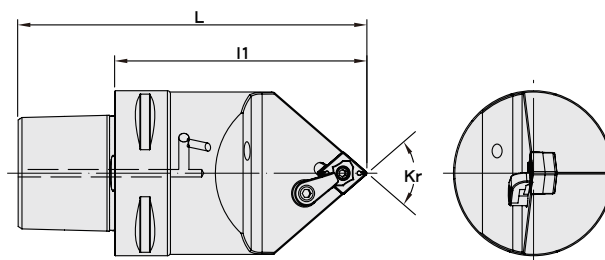



**Kr=80°**

MODEL NO.	TYPE	L	l <sub>1</sub>	Insert	WEIGHT (KGS)
5140 - 480 - 12N - 050	PSC32 - MCMNN - 00050 - 12	69	50	CN..1204	0.24
5141 - 480 - 12N - 060	PSC40 - MCMNN - 00060 - 12	84	60	CN..1204	0.44
5142 - 480 - 12N - 070	PSC50 - MCMNN - 00070 - 12	100	70	CN..1204	0.76
5143 - 480 - 12N - 100	PSC63 - MCMNN - 00100 - 12	138	100	CN..1204	0.86

## Product information:

► Inserts are optional accessories and need to be purchased additionally.

## Accessory:

Insert	Clamp	Shim	Clamp screw	Shim screw	Clamp wrench	Wrench
						
CN..1204	MC620	SMC432	MS620	MLP46L-A	3mm	2.5mm



# PSC / PCLN EXTERNAL TURNING TOOL

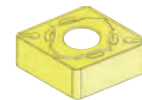

PSC / PCLN 外徑車刀

CN..1606



台灣精品2012  
TAIWAN EXCELLENCE

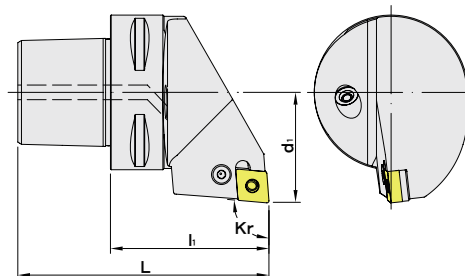







**Kr=95°**

MODEL NO.	TYPE	L	l <sub>1</sub>	d <sub>1</sub>	Insert	WEIGHT (KGS)
5141 - 515 - 16R - 050	PSC40 - PCLNR - 27050 - 16	74	50	27	CN..1606	0.38
5141 - 515 - 16L - 050	PSC40 - PCLNL - 27050 - 16	74	50	27	CN..1606	0.38
5142 - 515 - 16R - 060	PSC50 - PCLNR - 35060 - 16	90	60	35	CN..1606	0.70
5142 - 515 - 16L - 060	PSC50 - PCLNL - 35060 - 16	90	60	35	CN..1606	0.70
5143 - 515 - 16R - 065	PSC63 - PCLNR - 45065 - 16	103	65	45	CN..1606	1.21
5143 - 515 - 16L - 065	PSC63 - PCLNL - 45065 - 16	103	65	45	CN..1606	1.21
5144 - 515 - 16R - 080	PSC80 - PCLNR - 55080 - 16	128	80	55	CN..1606	2.54
5144 - 515 - 16L - 080	PSC80 - PCLNL - 55080 - 16	128	80	55	CN..1606	2.54

## Product information:

► Inserts are optional accessories and need to be purchased additionally.

## Accessory:

Insert	Lever	Lever screw	Shim	Shim pin	Wrench
					
CN..1606	L5	LEM8x25	C16AP	SP5	WH30L



# PSC / PCRN EXTERNAL TURNING TOOL

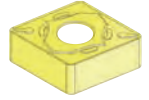

PSC / PCRN 外徑車刀

CN..1606

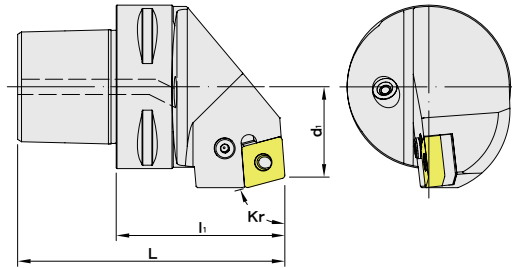







**Kr=80°**

MODEL NO.	TYPE	L	l <sub>1</sub>	d <sub>1</sub>	Insert	WEIGHT (KGS)
5142 - 525 - 16R - 060	PSC50 - PCRN R - 27060 - 16	90	60	27	CN..1606	0.67
5142 - 525 - 16L - 060	PSC50 - PCRN L - 27060 - 16	90	60	27	CN..1606	0.67
5143 - 525 - 16R - 065	PSC63 - PCRN R - 35065 - 16	103	65	35	CN..1606	1.19
5143 - 525 - 16L - 065	PSC63 - PCRN L - 35065 - 16	103	65	35	CN..1606	1.19

## Product information:

► Inserts are optional accessories and need to be purchased additionally.

## Accessory:

Insert	Lever	Lever screw	Shim	Shim pin	Wrench
					
CN..1606	L5	C16AP	SP5	LEM8x25	WH30L



# PSC / PCLN EXTERNAL TURNING TOOL

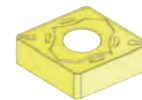

PSC / PCLN 外徑車刀

CN..1906



台灣精品 2012  
TAIWAN EXCELLENCE

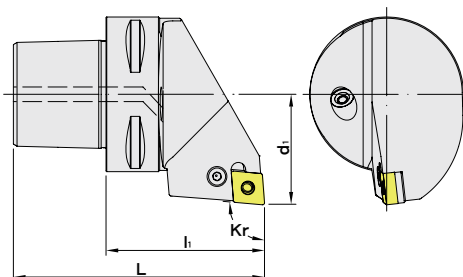







**Kr=95°**

MODEL NO.	TYPE	L	l <sub>1</sub>	d <sub>1</sub>	Insert	WEIGHT (KGS)
5142 - 515 - 19R - 060	PSC50 - PCLNR - 35060 - 19	90	60	35	CN..1906	0.70
5142 - 515 - 19L - 060	PSC50 - PCLNL - 35060 - 19	90	60	35	CN..1906	0.70
5143 - 515 - 19R - 065	PSC63 - PCLNR - 45065 - 19	103	65	45	CN..1906	1.29
5143 - 515 - 19L - 065	PSC63 - PCLNL - 45065 - 19	103	65	45	CN..1906	1.29
5144 - 515 - 19R - 080	PSC80 - PCLNR - 55080 - 19	128	80	55	CN..1906	2.54
5144 - 515 - 19L - 080	PSC80 - PCLNL - 55080 - 19	128	80	55	CN..1906	2.54

## Product information:

► Inserts are optional accessories and need to be purchased additionally.

## Accessory:

Insert	Lever	Lever screw	Shim	Shim pin	Wrench
					
CN..1906	L6	C19AP	SP6	LEM10x27	WH40L



# PSC / PCRN EXTERNAL TURNING TOOL

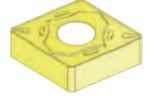

PSC / PCRN 外徑車刀

CN..1906

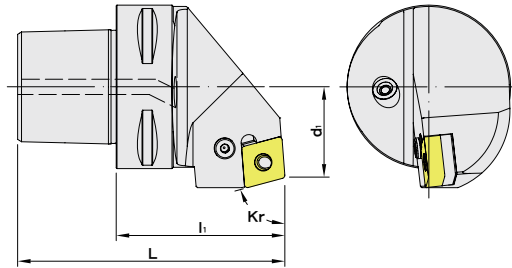







**Kr=80°**

MODEL NO.	TYPE	L	l <sub>1</sub>	d <sub>1</sub>	Insert	WEIGHT (KGS)
5142 - 525 - 19R - 060	PSC50 - PCRN - 27060 - 19	90	60	27	CN..1906	0.67
5142 - 525 - 19L - 060	PSC50 - PCRN - 27060 - 19	90	60	27	CN..1906	0.67
5143 - 525 - 19R - 065	PSC63 - PCRN - 35065 - 19	103	65	35	CN..1906	1.23
5143 - 525 - 19L - 065	PSC63 - PCRN - 35065 - 19	103	65	35	CN..1906	1.23
5144 - 525 - 19R - 080	PSC80 - PCRN - 45080 - 19	128	80	45	CN..1906	2.50
5144 - 525 - 19L - 080	PSC80 - PCRN - 45080 - 19	128	80	45	CN..1906	2.50

## Product information:

► Inserts are optional accessories and need to be purchased additionally.

## Accessory:

Insert	Lever	Lever screw	Shim	Shim pin	Wrench
					
CN..1906	L6	C19AP	SP6	LEM10x27	WH40L

# PSC / SDJC EXTERNAL TURNING TOOL

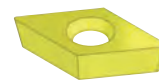

PSC / SDJC 外徑車刀

DC..11T3



台灣精品2012  
TAIWAN EXCELLENCE

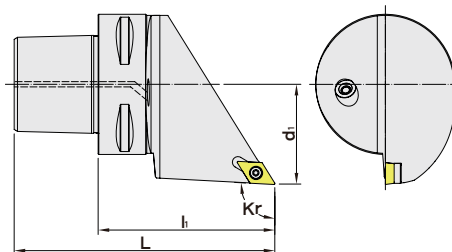







**Kr=93°**

MODEL NO.	TYPE	L	l <sub>1</sub>	d <sub>1</sub>	Insert	WEIGHT (KGS)
5141 - 786 - 11R - 050	PSC40 - SDJCR - 27050 - 11	74	50	27	DC..11T3	0.34
5141 - 786 - 11L - 050	PSC40 - SDJCL - 27050 - 11	74	50	27	DC..11T3	0.34
5142 - 786 - 11R - 060	PSC50 - SDJCR - 35060 - 11	90	60	35	DC..11T3	0.64
5142 - 786 - 11L - 060	PSC50 - SDJCL - 35060 - 11	90	60	35	DC..11T3	0.64
5143 - 786 - 11R - 065	PSC63 - SDJCR - 45065 - 11	103	65	45	DC..11T3	0.99
5143 - 786 - 11L - 065	PSC63 - SDJCL - 45065 - 11	103	65	45	DC..11T3	0.99

## Product information:

► Inserts are optional accessories and need to be purchased additionally.

## Accessory:

Insert	Shim	Shim screw	Clamp screw	Clamp wrench	Wrench
					
DC..11T3	D11BS	SM5x8.65XA	I60M3.5x12	WH35L	WT15IP



# PSC / DDJN EXTERNAL TURNING TOOL

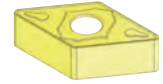

PSC / DDJN 外徑車刀

DN..1104

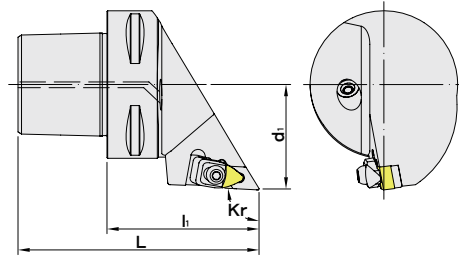







**Kr=93°**

MODEL NO.	TYPE	L	l <sub>1</sub>	d <sub>1</sub>	Insert	WEIGHT (KGS)
5140 - 091 - 11R - 045	PSC32 - DDJNR - 22045 - 11	64	45	22	DN..1104	0.20
5140 - 091 - 11L - 045	PSC32 - DDJNL - 22045 - 11	64	45	22	DN..1104	0.20
5141 - 091 - 11R - 050	PSC40 - DDJNR - 27050 - 11	74	50	27	DN..1104	0.38
5141 - 091 - 11L - 050	PSC40 - DDJNL - 27050 - 11	74	50	27	DN..1104	0.38
5142 - 091 - 11R - 060	PSC50 - DDJNR - 35060 - 11	90	60	35	DN..1104	0.66
5142 - 091 - 11L - 060	PSC50 - DDJNL - 35060 - 11	90	60	35	DN..1104	0.66
5143 - 091 - 11R - 065	PSC63 - DDJNR - 45065 - 11	103	65	45	DN..1104	1.07
5143 - 091 - 11L - 065	PSC63 - DDJNL - 45065 - 11	103	65	45	DN..1104	1.07

## Product information:

► Inserts are optional accessories and need to be purchased additionally.

## Accessory:

Insert	Clamp	Clamp screw	Shim	Shim screw	Spring	Wrench
 DN..1104	 C1RA	 CM5x22C	 D11BM	 SM5x8.65XA1	 SPR6	 WH30L

# PSC / MDJN EXTERNAL TURNING TOOL

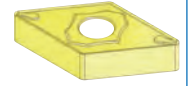

PSC / MDJN 外徑車刀

DN..1504

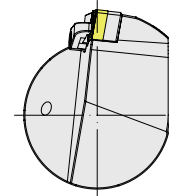
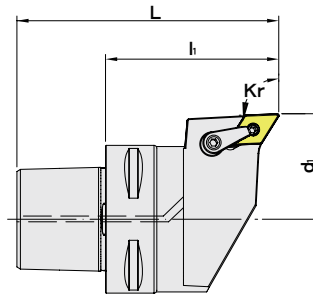



**Kr=93°**

MODEL NO.	TYPE	L	l <sub>1</sub>	d <sub>1</sub>	Insert	WEIGHT (KGS)
5140 - 476 - 15R - 045	PSC32 - MDJNR - 22045 - 15	64	45	22	DN..1504	0.22
5140 - 476 - 15L - 045	PSC32 - MDJNL - 22045 - 15	64	45	22	DN..1504	0.22
5141 - 476 - 15R - 050	PSC40 - MDJNR - 27050 - 15	74	50	27	DN..1504	0.42
5141 - 476 - 15L - 050	PSC40 - MDJNL - 27050 - 15	74	50	27	DN..1504	0.42
5142 - 476 - 15R - 060	PSC50 - MDJNR - 35060 - 15	90	60	35	DN..1504	0.78
5142 - 476 - 15L - 060	PSC50 - MDJNL - 35060 - 15	90	60	35	DN..1504	0.78
5143 - 476 - 15R - 075	PSC63 - MDJNR - 45075 - 15	113	75	45	DN..1504	0.80
5143 - 476 - 15L - 075	PSC63 - MDJNL - 45075 - 15	113	75	45	DN..1504	0.80

## Product information:

► Inserts are optional accessories and need to be purchased additionally.

## Accessory:

Insert	Clamp	Shim	Clamp screw	Shim screw	Clamp wrench	Wrench
						
DN..1504	MC622	SMD463	MS630	MLP46L-A	3mm	2.5mm



# PSC / MDNN EXTERNAL TURNING TOOL



PSC / MDNN 外徑車刀

DN..1504

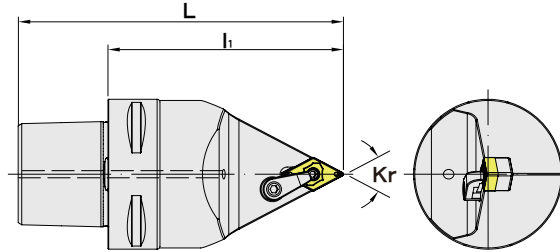







Kr=55°

MODEL NO.	TYPE	L	l <sub>1</sub>	Insert	WEIGHT (KGS)
5140 - 481 - 15N - 050	PSC32 - MDNNN - 00050 - 15	69	50	DN..1504	0.22
5141 - 481 - 15N - 060	PSC40 - MDNNN - 00060 - 15	84	60	DN..1504	0.40
5142 - 481 - 15N - 070	PSC50 - MDNNN - 00070 - 15	100	70	DN..1504	0.70
5143 - 481 - 15N - 100	PSC63 - MDNNN - 00100 - 15	138	100	DN..1504	0.80

## Product information:

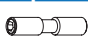
► Inserts are optional accessories and need to be purchased additionally.

## Accessory:

Insert	Clamp	Shim	Clamp Screw	Shim screw	Clamp wrench	Wrench
						
DN..1504	MC622	SMD463	MS630	MLP46L-A	3mm	2.5mm



# PSC / DDJN EXTERNAL TURNING TOOL



PSC / DDJN 外徑車刀

DN..1506

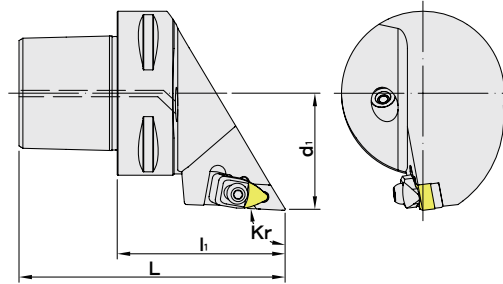



**Kr=55°**

MODEL NO.	TYPE	L	l <sub>1</sub>	d <sub>1</sub>	Insert	WEIGHT (KGS)
5141 - 091 - 15R - 055	PSC40 - DDJNR - 27055 - 15	79	55	27	DN..1506	0.40
5141 - 091 - 15L - 055	PSC40 - DDJNL - 27055 - 15	79	55	27	DN..1506	0.40
5142 - 091 - 15R - 060	PSC50 - DDJNR - 35060 - 15	90	60	35	DN..1506	0.66
5142 - 091 - 15L - 060	PSC50 - DDJNL - 35060 - 15	90	60	35	DN..1506	0.66
5143 - 091 - 15R - 065	PSC63 - DDJNR - 45065 - 15	103	65	45	DN..1506	1.06
5143 - 091 - 15L - 065	PSC63 - DDJNL - 45065 - 15	103	65	45	DN..1506	1.06

## Product information:

► Inserts are optional accessories and need to be purchased additionally.

## Accessory:

Insert	Clamp	Clamp screw	Shim	Shim screw	Spring	Wrench
						
DN..1506	C2RA	CM6x25C	D15BM	SM6x10XA1	SPR4	WH40L



# PSC / PDJN EXTERNAL TURNING TOOL



PSC / PDJN 外徑車刀

DN..1506

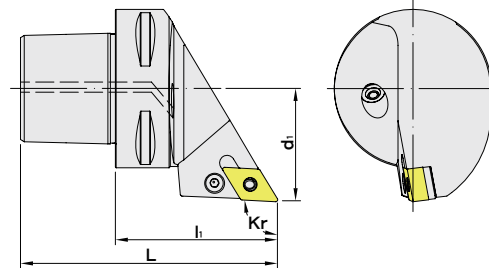







**Kr=93°**

MODEL NO.	TYPE	L	l <sub>1</sub>	d <sub>1</sub>	Insert	WEIGHT (KGS)
5141 - 526 - 15R - 050	PSC40 - PDJNR - 27050 - 15	74	50	27	DN..1506	0.34
5141 - 526 - 15L - 050	PSC40 - PDJNL - 27050 - 15	74	50	27	DN..1506	0.34
5142 - 526 - 15R - 060	PSC50 - PDJNR - 35060 - 15	90	60	35	DN..1506	0.65
5142 - 526 - 15L - 060	PSC50 - PDJNL - 35060 - 15	90	60	35	DN..1506	0.65
5143 - 526 - 15R - 065	PSC63 - PDJNR - 45065 - 15	103	65	45	DN..1506	1.06
5143 - 526 - 15L - 065	PSC63 - PDJNL - 45065 - 15	103	65	45	DN..1506	1.06

## Product information:

► Inserts are optional accessories and need to be purchased additionally.

## Accessory:

Insert	Lever	Lever screw	Shim	Shim pin	Wrench
					
DN..1506	L4B	LEM8x21	D15AP	SP4	WH30L

# PSC / PSKN EXTERNAL TURNING TOOL

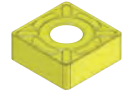

PSC / PSKN 外徑車刀

SN..

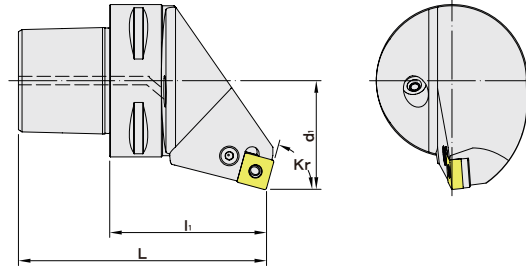

Kr=75°

## SN..1204

MODEL NO.	TYPE	L	l <sub>1</sub>	d <sub>1</sub>	Insert	WEIGHT (KGS)
5142 - 523 - 12R - 060	PSC50 - PSKNR - 35060 - 12	90	60	35	SN..1204	0.68
5142 - 523 - 12L - 060	PSC50 - PSKNL - 35060 - 12	90	60	35	SN..1204	0.68
5143 - 523 - 12R - 065	PSC63 - PSKNR - 45065 - 12	103	65	45	SN..1204	1.21
5143 - 523 - 12L - 065	PSC63 - PSKNL - 45065 - 12	103	65	45	SN..1204	1.21

### Accessory:

Insert	Lever	Shim	Shim pin	Lever screw	Wrench
SN..1204	L4	S12AP	SP4	LEM8x21	WH30L

## SN..1506

MODEL NO.	TYPE	L	l <sub>1</sub>	d <sub>1</sub>	Insert	WEIGHT (KGS)
5142 - 523 - 15R - 060	PSC50 - PSKNR - 35060 - 15	90	60	35	SN..1506	0.68
5142 - 523 - 15L - 060	PSC50 - PSKNL - 35060 - 15	90	60	35	SN..1506	0.68
5143 - 523 - 15R - 065	PSC63 - PSKNR - 45065 - 15	103	65	45	SN..1506	1.21
5143 - 523 - 15L - 065	PSC63 - PSKNL - 45065 - 15	103	65	45	SN..1506	1.21

### Accessory:

Insert	Lever	Shim	Shim pin	Lever screw	Wrench
SN..1506	L5	S15AP	SP5	LEM8x21	WH30L

## SN..1906

MODEL NO.	TYPE	L	l <sub>1</sub>	d <sub>1</sub>	Insert	WEIGHT (KGS)
5143 - 523 - 19R - 065	PSC63 - PSKNR - 45065 - 19	103	65	45	SN..1906	1.21
5143 - 523 - 19L - 065	PSC63 - PSKNL - 45065 - 19	103	65	45	SN..1906	1.21
5144 - 523 - 19R - 080	PSC80 - PSKNR - 55080 - 19	128	80	55	SN..1906	2.82
5144 - 523 - 19L - 080	PSC80 - PSKNL - 55080 - 19	128	80	55	SN..1906	2.82

### Accessory:

Insert	Lever	Shim	Shim pin	Lever screw	Wrench
SN..1906	L6	S19AP	SP6	LEM10x27	WH40L

### Product information:

► Inserts are optional accessories and need to be purchased additionally.



# PSC / PSRN EXTERNAL TURNING TOOL

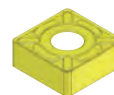

PSC / PSRN 外徑車刀

SN..

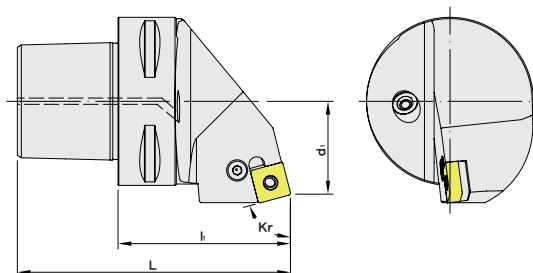

Kr=75°

## SN..1204

MODEL NO.	TYPE	L	l <sub>1</sub>	d <sub>1</sub>	Insert	WEIGHT (KGS)
5142 - 524 - 12R - 060	PSC50 - PSRNR - 27060 - 12	90	60	27	SN..1204	0.65
5142 - 524 - 12L - 060	PSC50 - PSRNL - 27060 - 12	90	60	27	SN..1204	0.65
5143 - 524 - 12R - 065	PSC63 - PSRNR - 35065 - 12	103	65	35	SN..1204	1.13
5143 - 524 - 12L - 065	PSC63 - PSRNL - 35065 - 12	103	65	35	SN..1204	1.13

### Accessory:

Insert	Lever	Shim	Shim pin	Lever screw	Wrench
SN..1204	L4	S12AP	SP4	LEM8x21	WH30L

## SN..1506

MODEL NO.	TYPE	L	l <sub>1</sub>	d <sub>1</sub>	Insert	WEIGHT (KGS)
5142 - 524 - 15R - 060	PSC50 - PSRNR - 27060 - 15	90	60	27	SN..1506	0.65
5142 - 524 - 15L - 060	PSC50 - PSRNL - 27060 - 15	90	60	27	SN..1506	0.65
5143 - 524 - 15R - 065	PSC63 - PSRNR - 35065 - 15	103	65	35	SN..1506	1.13
5143 - 524 - 15L - 065	PSC63 - PSRNL - 35065 - 15	103	65	35	SN..1506	1.13

### Accessory:

Insert	Lever	Shim	Shim pin	Lever screw	Wrench
SN..1506	L4	S12AP	SP4	LEM8x21	WH30L

## SN..1906

MODEL NO.	TYPE	L	l <sub>1</sub>	d <sub>1</sub>	Insert	WEIGHT (KGS)
5143 - 524 - 19R - 065	PSC63 - PSRNR - 35065 - 19	103	65	35	SN..1906	1.13
5143 - 524 - 19L - 065	PSC63 - PSRNL - 35065 - 19	103	65	35	SN..1906	1.13
5144 - 524 - 19R - 080	PSC80 - PSRNR - 45080 - 19	128	80	45	SN..1906	2.45
5144 - 524 - 19L - 080	PSC80 - PSRNL - 45080 - 19	128	80	45	SN..1906	2.45

### Accessory:

Insert	Lever	Shim	Shim pin	Lever screw	Wrench
SN..1906	L6	S19AP	SP6	LEM10x27	WH40L

## SN..2509

MODEL NO.	TYPE	L	l <sub>1</sub>	d <sub>1</sub>	Insert	WEIGHT (KGS)
5144 - 524 - 25R - 080	PSC80 - PSRNR - 45080 - 25	128	80	45	SN..2509	2.6
5144 - 524 - 25L - 080	PSC80 - PSRNL - 45080 - 25	128	80	45	SN..2509	2.6

### Accessory:

Insert	Lever	Shim	Shim pin	Lever screw	Wrench
SN..2509	LV70	VTL90	GPCN25	SPE70	5mm

### Product information:

- ▶ Inserts are optional accessories and need to be purchased additionally.

# PSC / PSKN EXTERNAL TURNING TOOL

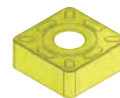

PSC / PSKN 外徑車刀

SN..2509  
SN..2507

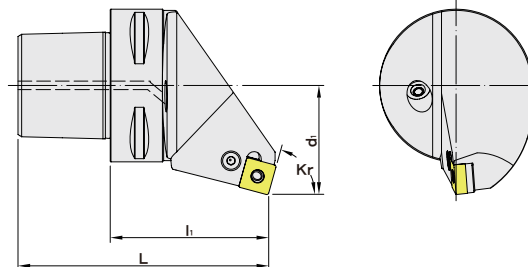







**Kr=75°**

MODEL NO.	TYPE	L	l <sub>1</sub>	d <sub>1</sub>	Insert	WEIGHT (KGS)
5144 - 523 - 25R - 080	PSC80 - PSKNR - 55080 - 25	128	80	55	SN..2509 SN..2507	2.35
5144 - 523 - 25L - 080	PSC80 - PSKNL - 55080 - 25	128	80	55	SN..2509 SN..2507	2.35

## Product information:

► Inserts are optional accessories and need to be purchased additionally.

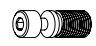
## Accessory:

Insert	Lever	Shim	Shim pin	Lever screw	Wrench
					
SN..2509 SN..2507	L8	S25AP	SP8	LEM12x36A	WH50L



# PSC / DTJN EXTERNAL TURNING TOOL

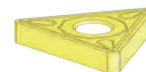

PSC / DTJN 外徑車刀

TN..1604

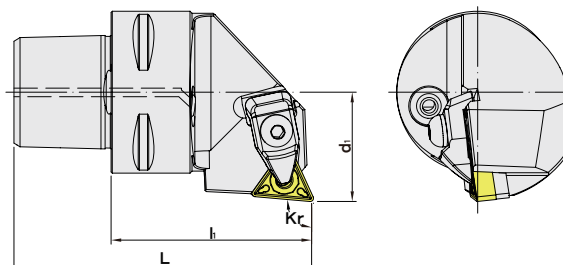

**Kr=93°**

MODEL NO.	TYPE	L	l <sub>1</sub>	d <sub>1</sub>	Insert	WEIGHT (KGS)
5140 - 092 - 16R - 040	PSC32 - DTJNR - 22040 - 16	59	40	22	TN..1604	0.22
5140 - 092 - 16L - 040	PSC32 - DTJNL - 22040 - 16	59	40	22	TN..1604	0.22
5141 - 092 - 16R - 050	PSC40 - DTJNR - 27050 - 16	74	50	27	TN..1604	0.42
5141 - 090 - 16L - 060	PSC40 - DTJNL - 27050 - 16	74	50	27	TN..1604	0.42
5142 - 092 - 16R - 060	PSC50 - DTJNR - 35060 - 16	90	60	35	TN..1604	0.78
5142 - 092 - 16L - 060	PSC50 - DTJNL - 35060 - 16	90	60	35	TN..1604	0.78
5143 - 092 - 16R - 065	PSC63 - DTJNR - 45065 - 16	103	65	45	TN..1604	0.80
5143 - 092 - 16L - 065	PSC63 - DTJNL - 45065 - 16	103	65	45	TN..1604	0.80

## Product information:

► Inserts are optional accessories and need to be purchased additionally.

## Accessory:

Insert	Clamp	Shim	Shim screw	Clamp screw	Spring	Wrench
						
TN..1604	C1RA	T16BM	SM5x8.65xA1	CM5X22C	SPR6	3mm



# PSC / MTJN EXTERNAL TURNING TOOL

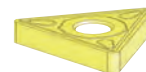

PSC / MTJN 外徑車刀

TN..1604

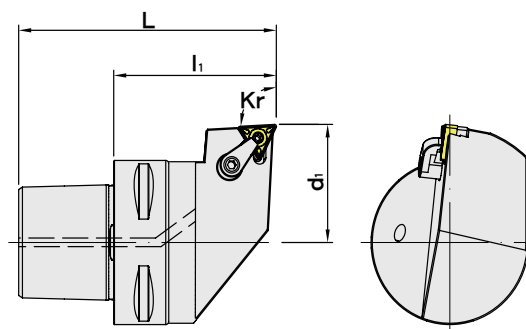





$Kr=93^\circ$

MODEL NO.	TYPE	L	l <sub>1</sub>	d <sub>1</sub>	Insert	WEIGHT (KGS)
5140 - 477 - 16R - 045	PSC32 - MTJNR - 22045 - 16	64	45	22	TN..1604	0.22
5140 - 477 - 16L - 045	PSC32 - MTJNL - 22045 - 16	64	45	22	TN..1604	0.22
5141 - 477 - 16R - 050	PSC40 - MTJNR - 27050 - 16	74	50	27	TN..1604	0.42
5141 - 477 - 16L - 050	PSC40 - MTJNL - 27050 - 16	74	50	27	TN..1604	0.42
5142 - 477 - 16R - 060	PSC50 - MTJNR - 35060 - 16	90	60	35	TN..1604	0.78
5142 - 477 - 16L - 060	PSC50 - MTJNL - 35060 - 16	90	60	35	TN..1604	0.78
5143 - 477 - 16R - 065	PSC63 - MTJNR - 45065 - 16	103	65	45	TN..1604	0.80
5143 - 477 - 16L - 065	PSC63 - MTJNL - 45065 - 16	103	65	45	TN..1604	0.80

## Product information:

► Inserts are optional accessories and need to be purchased additionally.

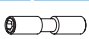
## Accessory:

Insert	Clamp	Shim	Clamp Screw	Shim screw	Clamp wrench	Wrench
						
TN..1604	MC620	SMT322	MS630	MLP34L-A	3mm	2mm



# PSC / SVJB EXTERNAL TURNING TOOL

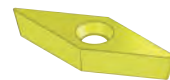

PSC / SVJB 外徑車刀

VB..1604

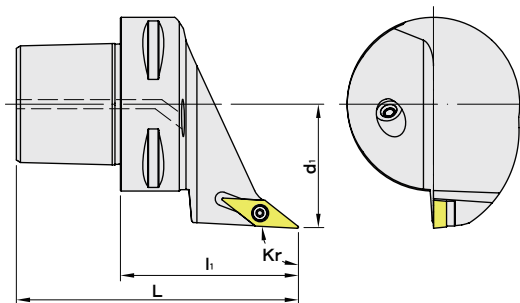







Kr=93°

MODEL NO.	TYPE	L	l <sub>1</sub>	d <sub>1</sub>	Insert	WEIGHT (KGS)
5141 - 760 - 16R - 050	PSC40 - SVJBR - 27050 - 16	74	50	27	VB..1604	0.38
5141 - 760 - 16L - 050	PSC40 - SVJBL - 27050 - 16	74	50	27	VB..1604	0.38
5142 - 760 - 16R - 060	PSC50 - SVJBR - 35060 - 16	90	60	35	VB..1604	0.57
5142 - 760 - 16L - 060	PSC50 - SVJBL - 35060 - 16	90	60	35	VB..1604	0.57
5143 - 760 - 16R - 065	PSC63 - SVJBR - 45065 - 16	103	65	45	VB..1604	0.95
5143 - 760 - 16L - 065	PSC63 - SVJBL - 45065 - 16	103	65	45	VB..1604	0.95

## Product information:

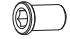
► Inserts are optional accessories and need to be purchased additionally.

## Accessory:

Insert	Shim	Shim Screw	Clamp screw	Wrench	Wrench
					
VB..1604	V16BS	SM5x8.65XA	I60M3.5x12	WH35L	WT15IP

# PSC / MVLN EXTERNAL TURNING TOOL



PSC / MVLN 外徑車刀

VN..1604

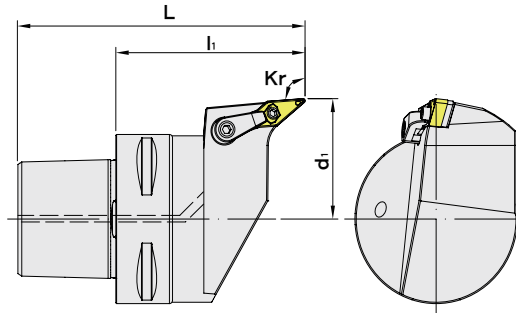







Kr=95°

MODEL NO.	TYPE	L	l <sub>1</sub>	d <sub>1</sub>	Insert	WEIGHT (KGS)
5140 - 479 - 16R - 050	PSC32 - MVLNR - 20050 - 16	69	50	20	VN..1604	0.22
5140 - 479 - 16L - 050	PSC32 - MVLNL - 20050 - 16	69	50	20	VN..1604	0.22
5141 - 479 - 16R - 055	PSC40 - MVLNR - 27055 - 16	79	55	27	VN..1604	0.42
5141 - 479 - 16L - 055	PSC40 - MVLNL - 27055 - 16	79	55	27	VN..1604	0.42
5142 - 479 - 16R - 060	PSC50 - MVLNR - 35060 - 16	90	60	35	VN..1604	0.78
5142 - 479 - 16L - 060	PSC50 - MVLNL - 35060 - 16	90	60	35	VN..1604	0.78
5143 - 479 - 16R - 075	PSC63 - MVLNR - 45075 - 16	113	75	45	VN..1604	0.80
5143 - 479 - 16L - 075	PSC63 - MVLNL - 45075 - 16	113	75	45	VN..1604	0.80

## Product information:

► Inserts are optional accessories and need to be purchased additionally.

## Accessory:

Insert	Clamp	Shim	Clamp Screw	Shim screw	Clamp wrench	Wrench
						
VN..1604	MC622	SMV322	MS630	MLP34L-A	3mm	2mm



# PSC / MVVN EXTERNAL TURNING TOOL



PSC / MVVN 外徑車刀

VN..1604

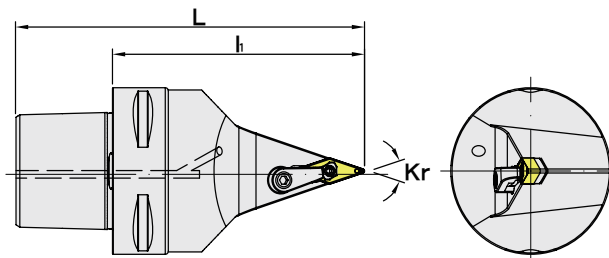

Kr=35°

MODEL NO.	TYPE	L	l <sub>1</sub>	Insert	WEIGHT (KGS)
5140 - 484 - 16N - 055	PSC32 - MVVNN - 00055 - 16	74	55	VN..1604	0.22
5141 - 484 - 16N - 060	PSC40 - MVVNN - 00060 - 16	84	60	VN..1604	0.38
5142 - 484 - 16N - 070	PSC50 - MVVNN - 00070 - 16	100	70	VN..1604	0.68
5143 - 484 - 16N - 100	PSC63 - MVVNN - 00100 - 16	138	100	VN..1604	0.78

## Product information:

► Inserts are optional accessories and need to be purchased additionally.

## Accessory:

Insert	Clamp	Shim	Clamp Screw	Shim screw	Clamp wrench	Wrench
VN..1604	MC622	SMV322	MS630	MLP34L-A	3mm	2mm

# PSC / DWLN EXTERNAL TURNING TOOL

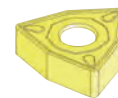

PSC / DWLN 外徑車刀

WN..0804

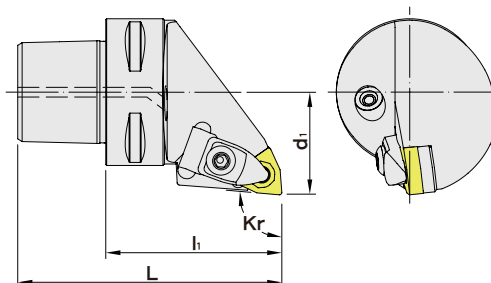

**Kr=95°**

MODEL NO.	TYPE	L	li	di	Insert	WEIGHT (KGS)
5141 - 093 - 08R - 040	PSC40 - DWLNR - 27040 - 08	64	40	27	WN..0804	0.37
5141 - 093 - 08L - 040	PSC40 - DWLNL - 27040 - 08	64	40	27	WN..0804	0.37
5141 - 093 - 08R - 050	PSC40 - DWLNR - 27050 - 08	74	50	27	WN..0804	0.42
5141 - 093 - 08L - 050	PSC40 - DWLNL - 27050 - 08	74	50	27	WN..0804	0.42
5142 - 093 - 08R - 060	PSC50 - DWLNR - 35060 - 08	90	60	35	WN..0804	0.78
5142 - 093 - 08L - 060	PSC50 - DWLNL - 35060 - 08	90	60	35	WN..0804	0.78
5143 - 093 - 08R - 065	PSC63 - DWLNR - 45065 - 08	103	65	45	WN..0804	0.80
5143 - 093 - 08L - 065	PSC63 - DWLNL - 45065 - 08	103	65	45	WN..0804	0.80
5144 - 093 - 08R - 080	PSC80 - DWLNR - 55080 - 08	128	80	55	WN..0804	2.64
5144 - 093 - 08L - 080	PSC80 - DWLNL - 55080 - 08	128	80	55	WN..0804	2.64

## Product information:

► Inserts are optional accessories and need to be purchased additionally.

## Accessory:

Insert	Clamp	Shim	Shim screw	Clamp screw	Spring	Wrench
						
WN..0804	C2RA	W08BM	SM6x10xA1	CM6x25C	SPR4	4mm



# PSC / MWLN EXTERNAL TURNING TOOL

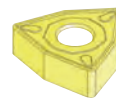

PSC / MWLN 外徑車刀

WN..0804

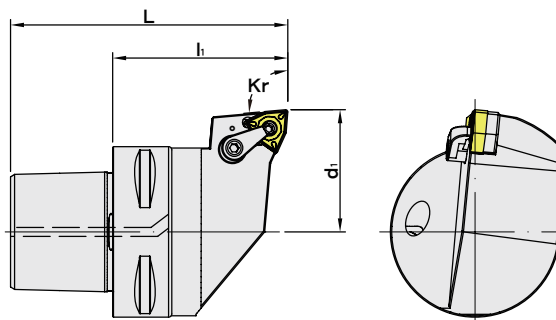





Kr=95°

MODEL NO.	TYPE	L	l <sub>1</sub>	d <sub>1</sub>	Insert	WEIGHT (KGS)
5140 - 478 - 08R - 045	PSC32 - MWLNR - 22045 - 08	64	45	22	WN..0804	0.22
5140 - 478 - 08L - 045	PSC32 - MWLNL - 22045 - 08	64	45	22	WN..0804	0.22
5141 - 478 - 08R - 050	PSC40 - MWLNR - 27050 - 08	74	50	27	WN..0804	0.42
5141 - 478 - 08L - 050	PSC40 - MWLNL - 27050 - 08	74	50	27	WN..0804	0.42
5142 - 478 - 08R - 060	PSC50 - MWLNR - 35060 - 08	90	60	35	WN..0804	0.78
5142 - 478 - 08L - 060	PSC50 - MWLNL - 35060 - 08	90	60	35	WN..0804	0.78
5143 - 478 - 08R - 065	PSC63 - MWLNR - 45065 - 08	103	65	45	WN..0804	0.80
5143 - 478 - 08L - 065	PSC63 - MWLNL - 45065 - 08	103	65	45	WN..0804	0.80

## Product information:

► Inserts are optional accessories and need to be purchased additionally.

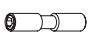
## Accessory:

Insert	Clamp	Shim	Clamp Screw	Shim screw	Clamp wrench	Wrench
						
WN..0804	MC620	SMW422	MS630	MLP46L-A	3mm	2.5mm

# MEMO

Blank lined area for writing the memo content.





# MEMO

Blank lined area for writing the memo content.



# MEMO

Blank lined area for writing the memo content.





智能侯

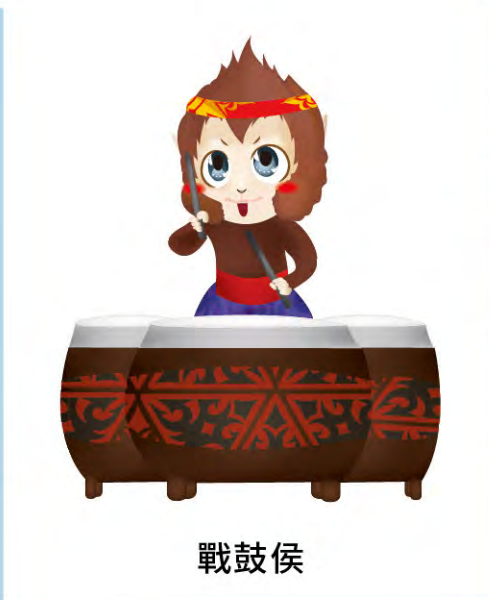

戰鼓侯

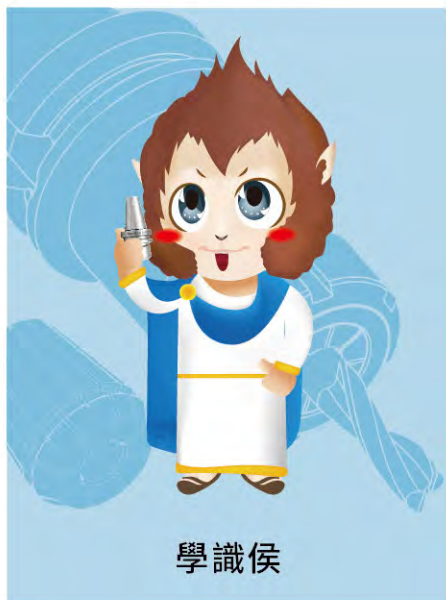

學識侯



俠客侯



勝侯王



登山侯



慢跑侯



咖啡侯



鐵馬侯





[www.syic.com](http://www.syic.com)



SHIN-YAIN INDUSTRIAL CO., LTD.  
No.198, Jingpu Rd., Qingshui Dist., Taichung City 436, Taiwan  
Tel: +886-4-26237575 | Fax: +886-4-26237676 | E-mail: sales@syic.com

