



# BORING SYSTEM

NO.B.75-1903A



[www.syic.com](http://www.syic.com)



# COMPANY INTRODUCTION

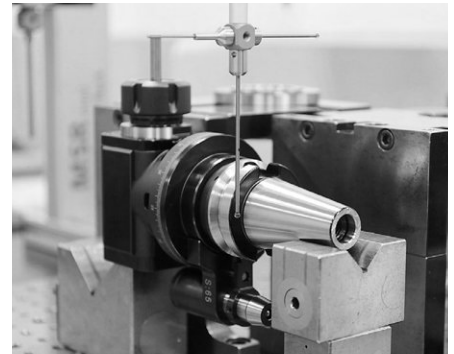
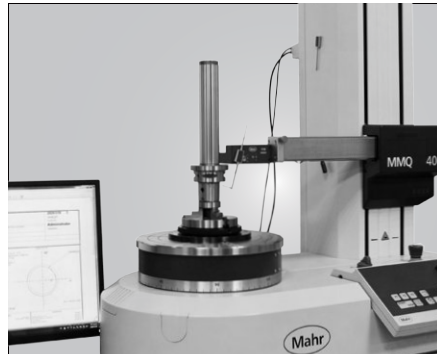



# 品質創造信譽 信譽保證品質

Quality creates reputation; reputation ensures quality.

## About SYIC

Established in 1979, SYIC is a professional manufacturer of precise tool holders, cutting tools, angel heads, boring series and collets with more than 500 employees. The taper types of tool holders we manufacture include BT (MAS403), CAT (ANSI B5.50), DAT (DIN69871-A), HSK (DIN69893), PSC (ISO26623-1), VDI (DIN ISO10889) and straight shank holders.

SYIC is certified to ISO9001 and ISO14001. With contribution to the design, production and sale of high accuracy and inventive products, SYIC has over 300 pieces of patents worldwide. SYIC keeps investing in high-end equipment and measuring instruments from Japan and Europe to implement excellent quality control and manufacturing capability.

SYIC keeps the core value "Quality creates reputation; reputation ensures quality" to impress our customers, possessing professional technical skills to provide comprehensive solutions for customers, improving customers' machining efficiency, and enhancing the mutual competitiveness with customers. Based on the mission of "Excellent service, supreme quality," SYIC will continue to launch more high precision products to customers.

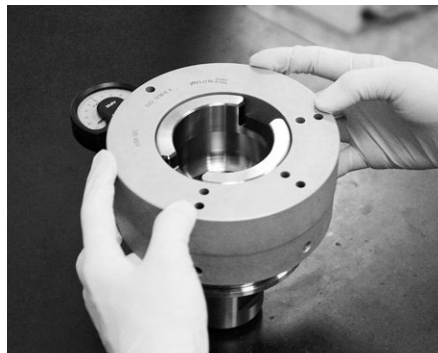

# Tool Holders

**Your reliable partner!**

————— CNC turning, milling and grinding —————

BMT  
PSC  
HSK  
SBT  
SCAT  
SDAT

**Premium  
Quality**

[www.syic.com](http://www.syic.com)

供需平衡 共榮共存

Maintain the balance of suppliers and customers and grow together.

未來之路 無限寬廣

Create a great future with infinite opportunities.

營運獲利 永續經營

Run a profitable company with sustainable development.

合作到底 共創通贏

Keep everlasting cooperation and together create a win-win situation.

成就彼此 榮耀一切

Support each other and accomplish mutual success.



### **Innovation is our mission!**

SYIC is committed to developing high precision products to optimize the machining process and offering professional technical service. With experienced technical professionals, our products are developed in response to different types of industries. We aim to achieve customers' demands from different industries including machining industry, mold and die industry, aerospace industry, automotive industry, and energy industry. We offer the most professional and technical service, effectively resolve your machining problems to create maximum production efficiency.

# INDEX

## **DAMPING BORING SERIES**

PSC / PMB DAMPING FINISH BORING HEAD .....	A-3
SRBH-LA DAMPING TWIN-BIT ROUGH BORING HEAD .....	A-5
SCBH DAMPING FINISH BORING HEAD .....	A-6
SLBK DAMPING EXTENSION SPACER .....	A-7
DAMPING BORING HEAD SHANK .....	A-8

## **ROUGH & FINISH BORING HEAD**

ROUGHING TWIN ADJUSTMENT BORING HEAD .....	B-3
SMU BLACK KNIGHT FINISH BORING HEAD .....	B-4
SUPER MICRON EXCHANGEABLE FINISH BORING HEAD .....	B-5
SBJ BORING HEAD FOR FINISHING .....	B-6
SLEEVE FOR TUNGSTEN STEEL TOOL HOLDER .....	B-6
SBE EXTENDED BORING INSERT SEAT .....	B-7
ANTI-VIBRANT TUNGSTEN STEEL TOOL HOLDER .....	B-8
THROW - AWAY BORING HEAD .....	B-9
SBJ BORING CUTTER .....	B-10
BYB BORING HEAD .....	B-11
BYB FINISH BORING HEAD BODY .....	B-11
CBM55 MICRO ADJUSTMENT BORING HEAD SET .....	B-12
CBM68 MICRO ADJUSTMENT BORING HEAD SET .....	B-13
RBH-LA INDEXABLE TWIN-BIT ROUGH BORING HEAD .....	B-14
CBH FINISH BORING HEAD .....	B-15
MBH FINISH BORING HEAD .....	B-16~B-17
CBI SMALL DIAMETER FINISH BORING HEAD .....	B-18
CBI SMALL DIAMETER ADAPTER .....	B-18
EXTENSION ADAPTER FOR SMALL DIAMETER BORING BAR DEDICATED TO CBI SERIES TYPE AC .....	B-19
SUPER FINE DIAMETER TUNGSTEN CARBIDE BORING BAR DEDICATED TO CBI SERIES TYPE SBJ .....	B-19
SRW ROUGHING BORING HEAD .....	B-20
SMB SUPER MICRON EXCHANGEABLE FINISH BORING HEAD .....	B-21
PSC / PMB FINISH BORING HEAD .....	B-22
PSC / PCK ROUGH BORING HEAD .....	B-23
PSC / PBJ FINISH BORING HEAD .....	B-23

## **MCK BORING HEAD SHANK / HOLDER**

BT / MCK BORING HEAD SHANK .....	C-3~C-7
CAT / MCK BORING HEAD SHANK .....	C-8
DAT / MCK BORING HEAD SHANK .....	C-9
SBT / MCK BORING HEAD SHANK .....	C-10~C-13
SCAT / MCK BORING HEAD SHANK .....	C-14
SDAT / MCK BORING HEAD SHANK .....	C-15
HSK / MCK BORING HEAD SHANK .....	C-16~C-17
PSC / MCK BORING HEAD SHANK .....	C-18~C-19
MCK EXTENSION SPACER .....	C-20
SIMPLIFIED TOOL PRESETTER FOR SRW & SMB BORING HEAD .....	C-21

## **PSC ADAPTERS**

BT / PSC ADAPTERS .....	D-3
CAT / PSC ADAPTERS .....	D-4
DAT / PSC ADAPTERS .....	D-5
SBT / PSC ADAPTERS .....	D-6
SCAT / PSC ADAPTERS .....	D-7
SDAT / PSC ADAPTERS .....	D-8
HSK / PSC ADAPTERS .....	D-9
PSC / EXTENSION ADAPTER FOR SAME DIAMETER .....	D-10
PSC / EXTENSION ADAPTER FOR DIFFERENT DIAMETER .....	D-11

# DAMPING BORING SERIES

PSC / PMB DAMPING FINISH BORING HEAD	A-3
SRBH-LA DAMPING TWIN-BIT ROUGH BORING HEAD	A-5
SCBH DAMPING FINISH BORING HEAD	A-6
SLBK DAMPING EXTENSION SPACER	A-7
DAMPING BORING HEAD SHANK	A-8





# BUILT-IN DAMPING MECHANISM

# SILENT DAMPING GENIUS

## FOR BORING SERIES

**SDG** *KPZ*  
SILENT DAMPING GENIUS

**NEW**



Silent Damping Genius is an anti-vibration technology for long overhanging and deep cavity operations.

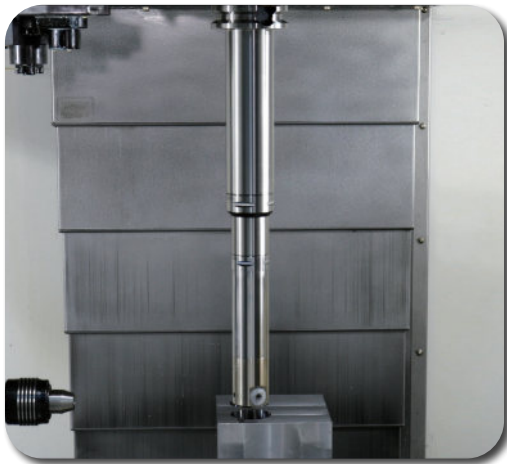

- ▶ Silent Damping Genius equipped with damping mechanism eliminates vibration, improves workpiece surface finish, roundness, tool life, maintain spindle precision, and increase the overall production efficiency!

Set upright in stock



### REMINDER

- ▶ The closer vibrating point gets to the damping mechanism, the higher damping effect will be.
- ▶ To maintain runout accuracy, all damping products need to be placed upright in stock.

# PSC / PMB DAMPING FINISH BORING HEAD

PSC / PMB 抑震精密微調搪頭



One-piece

**SDG** *KPZ*  
SILENT DAMPING GENIUS

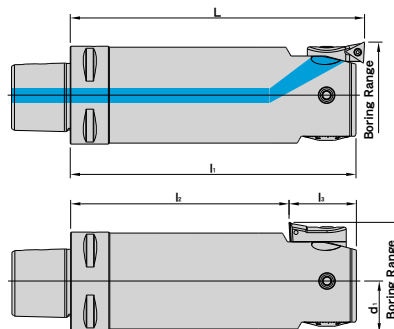

MODEL NO.	TYPE	BORING AND PROCESSING AT FRONT			BORING AND PROCESSING AT BACK			
		BORING RANGE	L	l <sub>1</sub>	BORING RANGE	l <sub>2</sub>	l <sub>3</sub>	d <sub>1</sub>
5140-S24-032-115	PSC32 x PMB32DP - 115	32 ~ 42	115	110	-	90	25	16
		41 ~ 51	115	110	46 ~ 51	90	25	16
		50 ~ 60	115	110	50 ~ 60	90	25	16
5141-S24-041-125	PSC40 x PMB41DP - 125	41 ~ 54	125	121	-	96	29	20
		50 ~ 63	125	121	53 ~ 63	96	29	20
		61 ~ 74	125	121	61 ~ 74	96	29	20
5142-S24-053-150	PSC50 x PMB53DP - 150	53 ~ 70	150	146	62 ~ 70	116	34	25.5
		65 ~ 82	150	146	65 ~ 82	116	34	25.5
		78 ~ 95	150	146	78 ~ 95	116	34	25.5
5143-S24-068-190	PSC63 x PMB68DP - 190	68 ~ 100	190	186.2	80 ~ 100	114.8	45.2	32.5
		94 ~ 126	190	186.2	94 ~ 126	114.8	45.2	32.5
		118 ~ 150	190	186.2	118 ~ 150	114.8	45.2	32.5
5143-S24-100-190	PSC63 x PMB100DP - 190	100 ~ 153	190	186.2	112 ~ 153	114.8	45.2	45.5
		126 ~ 179	190	186.2	126 ~ 179	114.8	45.2	45.5
		150 ~ 203	190	186.2	150 ~ 203	114.8	45.2	45.5

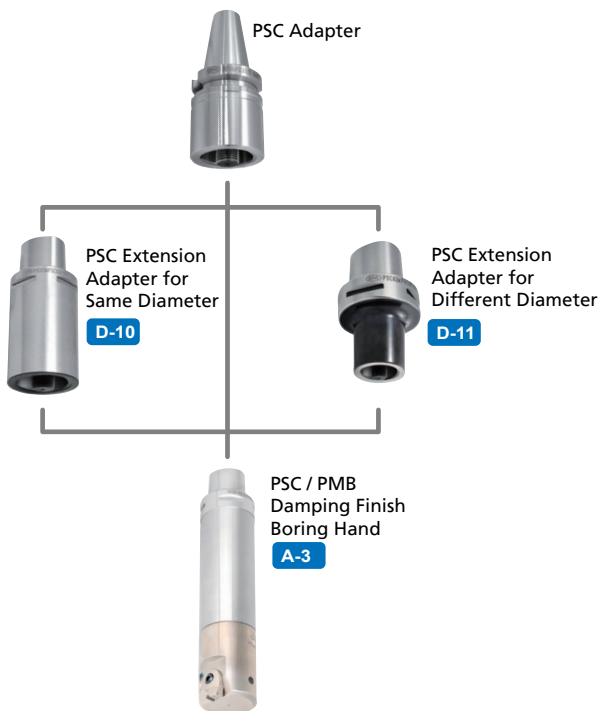

**TYPES FOR INSERT SEAT:**

TYPE	DRAWING	SUITABLE FINISH BORING HEAD	INSERT
SIC32 - 1		PMB32DP	TB06 / TP08
SIC32 - 2			
SIC32 - 3			
SIC41 - 1		PMB41DP	TP09 / TC11
SIC41 - 2			
SIC41 - 3			
SIC53 - 1		PMB53DP	TP09 / TC11
SIC53 - 2			
SIC53 - 3			
SIC68 - 1		PMB68DP	TP09 / TC11
SIC68 - 2			
SIC68 - 3			
SIC32 - 1E		PMB32DP	TB06 / TP08
SIC32 - 2E			
SIC32 - 3E			
SIC41 - 1E		PMB41DP	TP09 / TC11
SIC41 - 2E			
SIC41 - 3E			
SIC53 - 1E		PMB53DP	TP09 / TC11
SIC53 - 2E			
SIC53 - 3E			
SIC68 - 1E		PMB68DP	TP09 / TC11
SIC68 - 2E			
SIC68 - 3E			

STANDARD INSERT SEAT	OPTIONAL INSERT SEAT	
SIC32 - 1	SIC32 - 2	SIC32 - 3
ψ32 ~ ψ42	ψ41 ~ ψ51	ψ50 ~ ψ60



# APPLICATION DIAGRAM

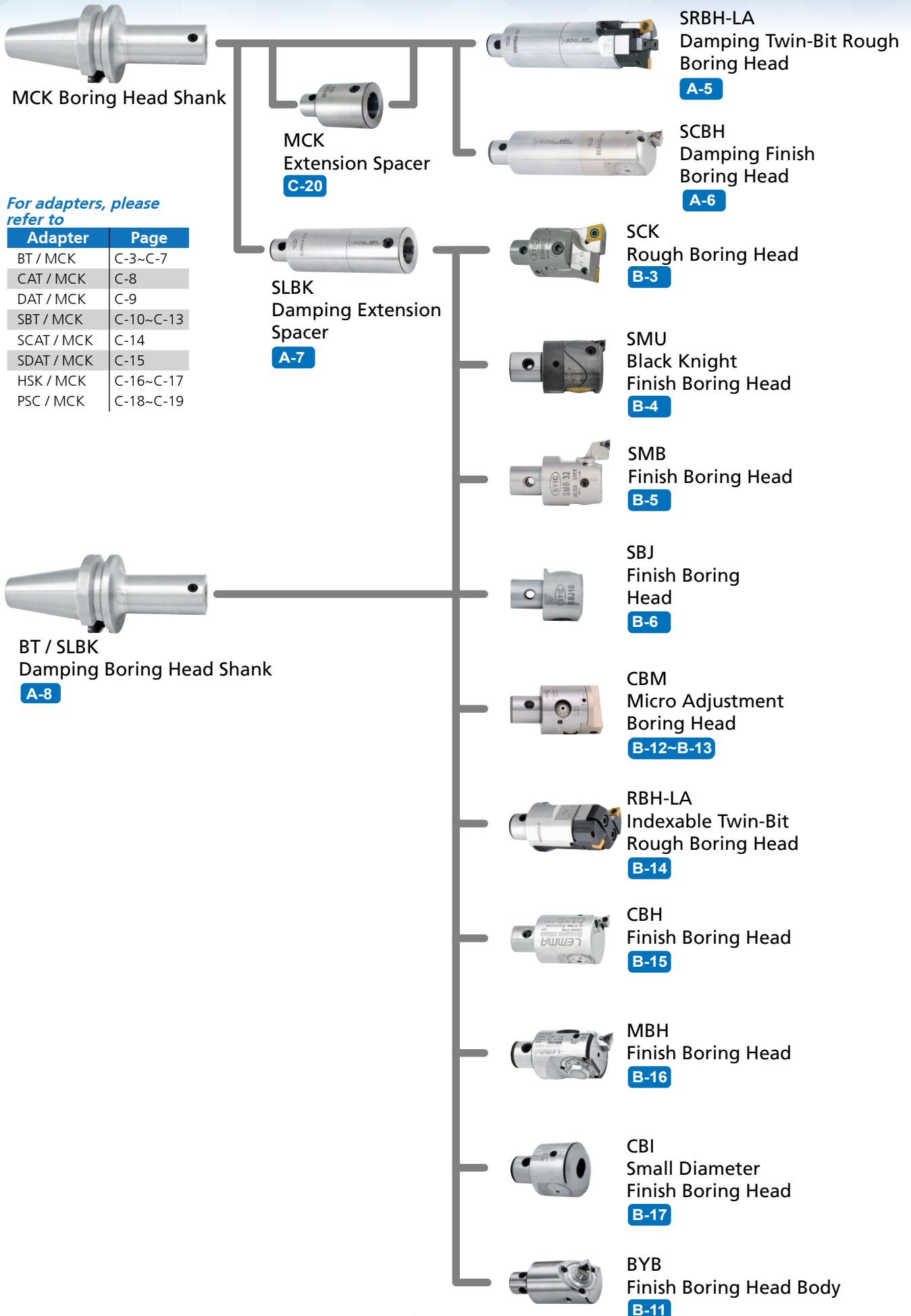

# SRBH-LA DAMPING TWIN-BIT ROUGH BORING HEAD

## SRBH-LA 抑震雙刃搪孔頭



**SDG** *K.P.G.*  
SILENT DAMPING GENIUS

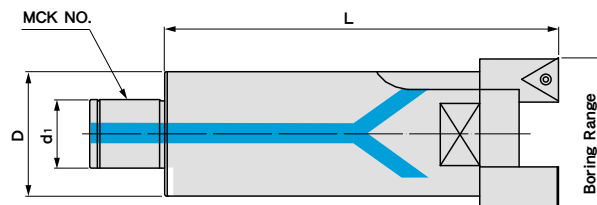

MODEL NO.	TYPE	MCK NO.	BORING RANGE	L	D	d <sub>1</sub>	INSERT	WEIGHT (KGS)
405-008-025	SRBH25LA - 90	MCK2	25 ~ 35	90	24	14	CC..0602	0.22
405-008-032	SRBH32LA - 100	MCK3	32 ~ 45	100	31	18	CC..0602, TC..1102	0.39
405-008-040	SRBH40LA - 110	MCK4	40 ~ 55	110	39	22	CC..09T3, TC..16T3	0.71
405-008-052	SRBH52LA - 140	MCK5	52 ~ 75	140	50	28	CC..09T3, TC..16T3	1.27
405-008-068	SRBH68LA - 175	MCK6	68 ~ 100	175	64	36	CC..1204, TC..16T3	6.20

### ACCESSORIES

INSERT	CLAMPING SCREW	WRENCH
CC..0602	M2.5-6.0-3.5-60	T8
CC..09T3	M4-10-5.7-60	T15
CC..1204	M5-11-7.5-60	T20
TC..1102	M2.5-6.0-3.5-60	T8
TC..16T3	M4-10-5.7-60	T15

### Features:

- ▶ The integrated structure of damper and boring head, it can combined with MCK arbor, and get wider effective length and better surface accuracy.
- ▶ With many specifications from  $\phi 25 \sim \phi 100$ , all with the function of coolant through spindle.
- ▶ Use bilateral symmetry joint to enforce anti-vibration effect.
- ▶ 4D~8D deep machining has the best effect.
- ▶ Compare "the SRBH-LA dampened boring head" and "the SLBK dampened extension combined with RBH-LA boring head", the SRBH-LA can use in higher cutting feed rate to get better machining efficiency.

### Product information:

- ▶ Inserts are optional accessories. Needs to be purchased additionally.

# SCBH DAMPING FINISH BORING HEAD

SCBH 抑震精密微調搪孔頭



**SDG** *K.P.E.*  
SILENT DAMPING GENIUS

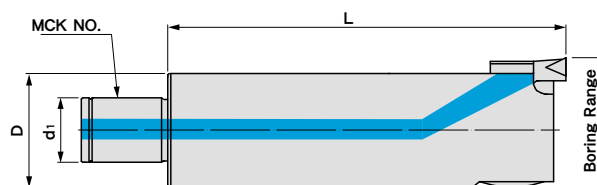

MODEL NO.	TYPE	MCK NO.	BORING RANGE	L	D	d <sub>1</sub>	INSERT	WEIGHT (KGS)
405-009-020	SCBH20 - 90	MCK1	20 ~ 26	90	19	11	TP.08	0.22
405-009-025	SCBH25 - 90	MCK2	25 ~ 33	90	24	14	TP.08	0.39
405-009-032	SCBH32 - 100	MCK3	32 ~ 42	100	31	18	TP.08	0.71
405-009-040	SCBH40 - 110	MCK4	40 ~ 55	110	39	22	TP.08	1.27
405-009-052	SCBH52 - 140	MCK5	52 ~ 75	140	50	28	TP.08	2.72
405-009-068	SCBH68 - 175	MCK6	68 ~ 102	175	64	36	TP.08, TP.09, TC..11	5.70

## ACCESSORIES

INSERT	CLAMPING SCREW	WRENCH
TP.08	M2-5.0-2.7-60	T6
TP.09	M2.5-6.0-3.5-60	T8
TC..1102	M2.5-6.0-3.5-60	T8

### Features:

- ▶ The integrated structure of damper and boring head, it can combined with MCK arbor, and get wider effective length and better surface accuracy.
- ▶ With many specifications from  $\phi 25 \sim \phi 100$ , all with the function of coolant through spindle.
- ▶ Use bilateral symmetry joint to enforce anti-vibration effect.
- ▶ 4D~8D deep machining has the best effect.
- ▶ Compare "the SRBH-LA dampened boring head" and "the SLBK dampened extension combined with RBH-LA boring head", the SRBH-LA can use in higher cutting feed rate to get better machining efficiency.

### Product information:

- ▶ Inserts are optional accessories. Needs to be purchased additionally.



# SLBK DAMPING EXTENSION SPACER

## SLBK 抑震延長桿



**SDG**  
SILENT DAMPING GENIUS

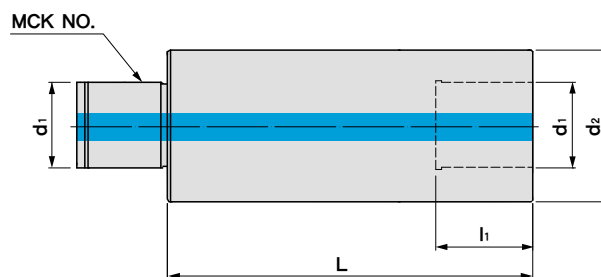

MODEL NO.	TYPE	MCK NO.	L	l <sub>1</sub>	d <sub>1</sub>	d <sub>2</sub>	WEIGHT (KGS)
405-006-002-000	SLBK2 - 2 - 75	MCK2	75	18	14	24	0.33
405-006-003-000	SLBK3 - 3 - 100	MCK3	100	22	18	31	0.62
405-006-004-000	SLBK4 - 4 - 110	MCK4	110	26	22	39	1.11
405-006-005-000	SLBK5 - 5 - 130	MCK5	130	32	28	50	2.30
405-006-006-000	SLBK6 - 6 - 170	MCK6	170	42	36	64	5.10

### Features:

- ▶ The integrated structure of damper and extension, it can combined with MCK arbor, and get wider effective length and better surface accuracy.
- ▶ With many specifications from LBK2~LBK6, all with the function of coolant through spindle.
- ▶ Use bilateral symmetry joint to enforce anti-vibration effect.
- ▶ 4D~7D deep machining has the best effect.

# BT / SLBK DAMPING BORING HEAD SHANK

## BT / SLBK 抑震搪孔刀桿



Fig.1

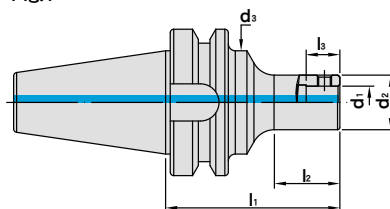
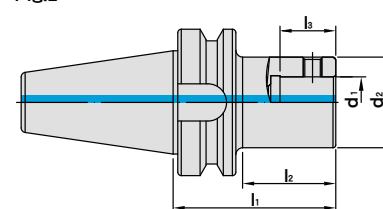

Fig.2



MODEL NO.	TYPE	$l_1$	$l_2$	$l_3$	$d_1$	$d_2$	$d_3$	Fig	WEIGHT (KGS)
5011-808-002-150	BT40 x SLBK2 - 150	150	110	18	14	24	39	1	1.45
5011-808-002-175	BT40 x SLBK2 - 175	175	135	18	14	24	39	1	1.51
5011-808-002-200	BT40 x SLBK2 - 200	200	160	18	14	24	39	1	1.56
5011-808-003-200	BT40 x SLBK3 - 200	200	160	22	18	31	50	1	2.21
5011-808-003-230	BT40 x SLBK3 - 230	230	190	22	18	31	50	1	2.34
5011-808-003-260	BT40 x SLBK3 - 260	260	220	22	18	31	50	1	2.47
5011-808-004-235	BT40 x SLBK4 - 235	235	200	26	22	39	50	1	3.12
5011-808-004-275	BT40 x SLBK4 - 275	275	240	26	22	39	50	1	3.42
5011-808-004-315	BT40 x SLBK4 - 315	315	280	26	22	39	50	1	3.71
5011-808-005-310	BT40 x SLBK5 - 310	310	280	32	28	50	-	2	6.30
5011-808-006-295	BT40 x SLBK6 - 295	295	270	42	36	64	-	2	8.71
5012-808-002-160	BT50 x SLBK2 - 160	160	110	18	14	24	39	1	4.09
5012-808-002-185	BT50 x SLBK2 - 185	185	135	18	14	24	39	1	4.15
5012-808-002-210	BT50 x SLBK2 - 210	210	160	18	14	24	39	1	4.21
5012-808-003-220	BT50 x SLBK3 - 220	220	160	22	18	31	50	1	4.97
5012-808-003-250	BT50 x SLBK3 - 250	250	190	22	18	31	50	1	5.15
5012-808-003-280	BT50 x SLBK3 - 280	280	220	22	18	31	50	1	5.33
5012-808-004-260	BT50 x SLBK4 - 260	260	205	26	22	39	64	1	6.00
5012-808-004-300	BT50 x SLBK4 - 300	300	245	26	22	39	64	1	6.24
5012-808-004-340	BT50 x SLBK4 - 340	340	285	26	22	39	64	1	6.48
5012-808-005-310	BT50 x SLBK5 - 310	310	265	32	28	50	64	1	8.74
5012-808-005-355	BT50 x SLBK5 - 355	355	310	32	28	50	64	1	9.39
5012-808-005-400	BT50 x SLBK5 - 400	400	355	32	28	50	64	1	10.04
5012-808-006-375	BT50 x SLBK6 - 375	375	330	42	36	64	-	2	14.28
5012-808-006-440	BT50 x SLBK6 - 440	440	395	42	36	64	-	2	15.11
5012-808-006-505	BT50 x SLBK6 - 505	505	460	42	36	64	-	2	15.96

### Features:

- ▶ The best efficiency will be reflected by machining with 4D~8D.
- ▶ Center through coolant supply is available.
- ▶ The bilateral symmetry joint allows for almost zero vibration.



# MEMO

Blank lined area for writing a memo.







# ROUGH & FINISH BORING HEAD

ROUGHING TWIN ADJUSTMENT BORING HEAD	B-3
SMU BLACK KNIGHT FINISH BORING HEAD	B-4
SUPER MICRON EXCHANGEABLE FINISH BORING HEAD	B-5
SBJ BORING HEAD FOR FINISHING	B-6
SLEEVE FOR TUNGSTEN STEEL TOOL HOLDER	B-6
SBE EXTENDED BORING INSERT SEAT	B-7
ANTI-VIBRANT TUNGSTEN STEEL TOOL HOLDER	B-8
THROW - AWAY BORING HEAD	B-9
SBJ BORING CUTTER	B-10
BYB BORING HEAD	B-11
BYB FINISH BORING HEAD BODY	B-11
CBM55 MICRO ADJUSTMENT BORING HEAD SET	B-12
CBM68 MICRO ADJUSTMENT BORING HEAD SET	B-13
RBH-LA INDEXABLE TWIN-BIT ROUGH BORING HEAD	B-14
CBH FINISH BORING HEAD	B-15
MBH FINISH BORING HEAD	B-1~B-17
CBI SMALL DIAMETER FINISH BORING HEAD	B-18
CBI SMALL DIAMETER ADAPTER	B-18
EXTENSION ADAPTER FOR SMALL DIAMETER BORING BAR DEDICATED TO CBI SERIES TYPE AC	B-19
SUPER FINE DIAMETER TUNGSTEN CARBIDE BORING BAR DEDICATED TO CBI SERIES TYPE SBJ	B-19
SRW ROUGHING BORING HEAD (OVER 150mm)	B-20
SMB SUPER MICRON EXCHANGEABLE FINISH BORING HEAD (OVER 150mm)	B-21
PSC / PMB FINISH BORING HEAD	B-22
PSC / PCK ROUGH BORING HEAD	B-23
PSC / PBJ FINISH BORING HEAD	B-23

# APPLICATION DIAGRAM

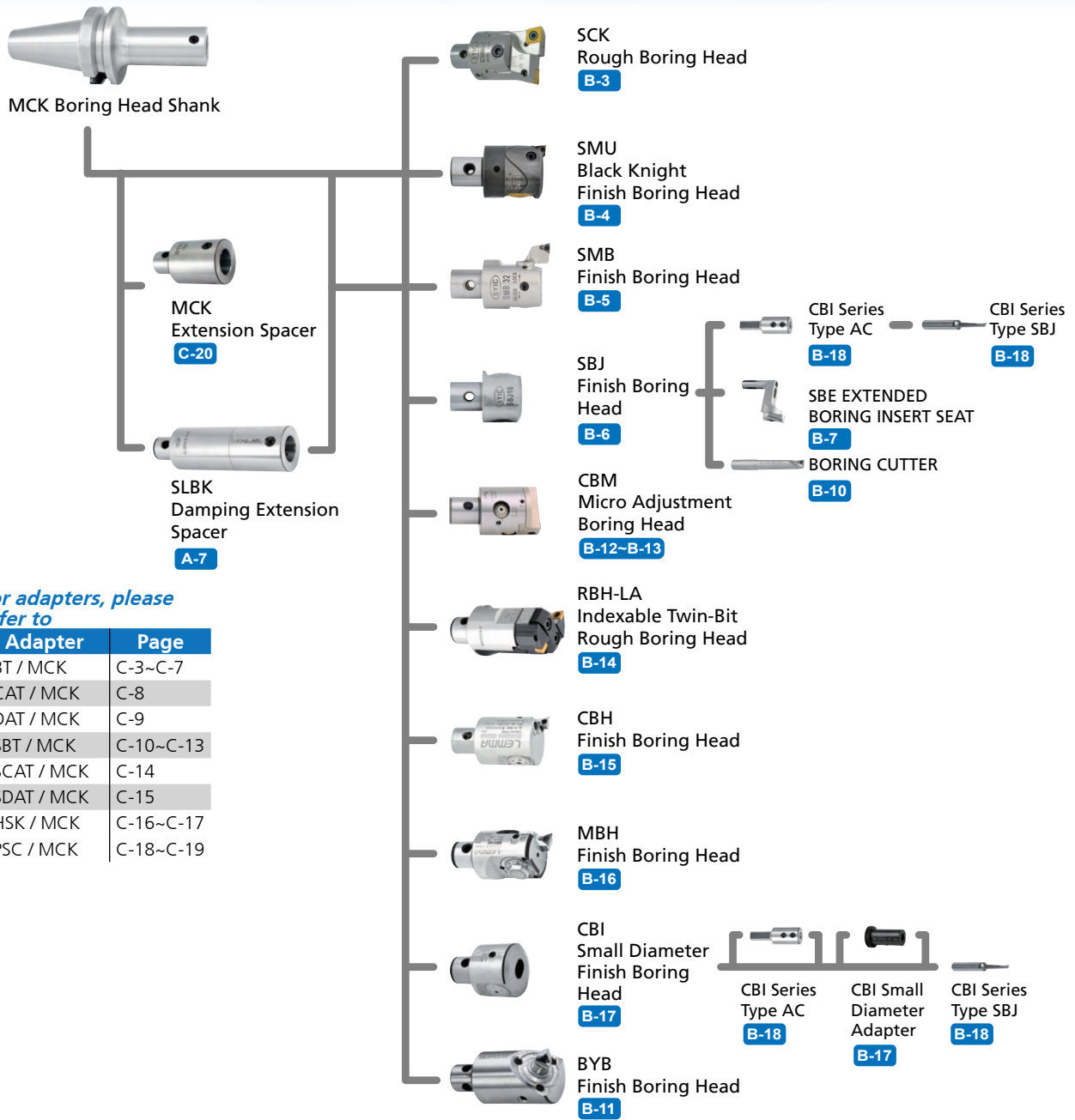

For adapters, please refer to

Adapter	Page
BT / MCK	C-3~C-7
CAT / MCK	C-8
DAT / MCK	C-9
SBT / MCK	C-10~C-13
SCAT / MCK	C-14
SDAT / MCK	C-15
HSK / MCK	C-16~C-17
PSC / MCK	C-18~C-19

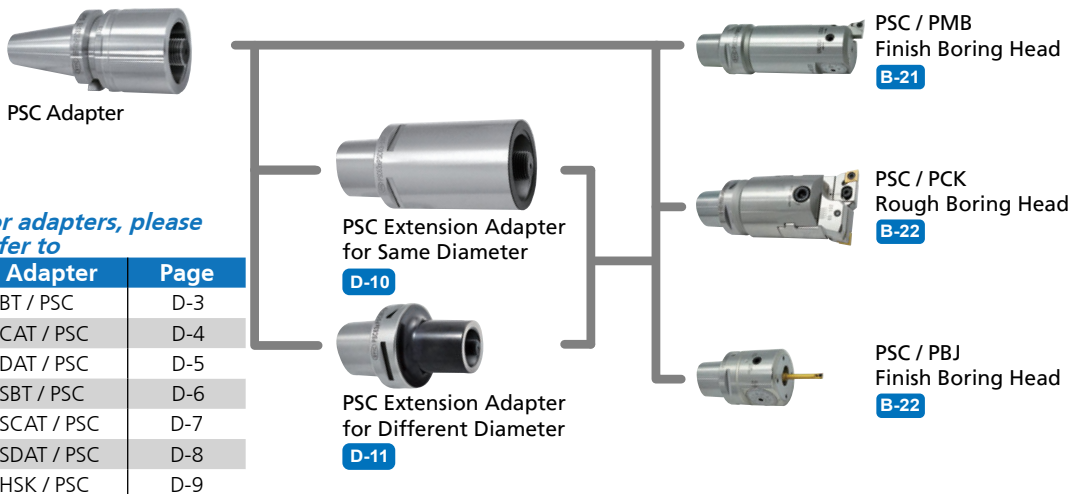

For adapters, please refer to

Adapter	Page
BT / PSC	D-3
CAT / PSC	D-4
DAT / PSC	D-5
SBT / PSC	D-6
SCAT / PSC	D-7
SDAT / PSC	D-8
HSK / PSC	D-9

# ROUGHING TWIN ADJUSTMENT BORING HEAD

## SCK 可調整式雙刃粗搪孔頭

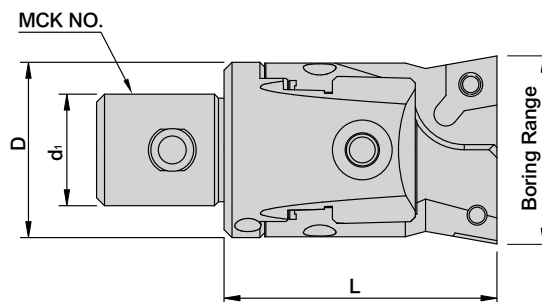

MODEL NO.	TYPE	MCK NO.	BORING RANGE		d <sub>1</sub>	L	D	INSERT	WEIGHT (KGS)
			MIN.	MAX.					
5158-687-024	SCK2430 - C	MCK2	24	30	14	34	22	CC..0602	0.19
5158-687-029	SCK2940 - C	MCK2	29	40	14	42	27	CC..09T3	0.19
5158-687-039	SCK3950 - C	MCK3	39	50	18	45	32	CC..09T3	0.19
5158-687-049	SCK4965 - C	MCK4	49	65	22	56	42	CC..1204	0.10
5158-687-063	SCK6382 - C	MCK5	63	82	28	66	54	CC..1204	0.20
5158-687-080	SCK80102 - C	MCK6	80	102	36	86	68	CC..1204	2.30

### ACCESSORIES

INSERT	CLAMPING SCREW	WRENCH
CC..0602	M2.5-6.45-3.7	T8
CC..09T3	M4-10-5.7-60	T15
CC..1204	M5-11-7.5-60	T20

### Features:

- ▶ Both insert seats move simultaneously while setting diameters, which makes the adjustment precise and save time.
- ▶ High rigidity results from a perfect contact between the insert seats and the boring head body. Suitable for big table feed (F) cutting, heavy-duty and interrupted boring.
- ▶ The small difference of heights between two insert seats decreases the vibration caused by cutting impedance while touching a workpiece.
- ▶ Modular MCK system and exchangeable with CK system on the market.
- ▶ The coating surface treatment improves chips adhesion, increases heat resistance and extends using life.

### Product information:

- ▶ Inserts are optional accessories. Needs to be purchased additionally.



# SMU BLACK KNIGHT FINISH BORING HEAD

## SMU 黑武士精搪頭

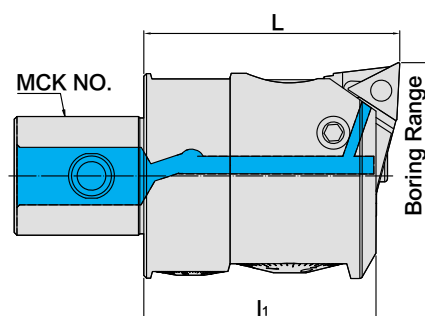

MODEL NO.	TYPE	MCK NO.	BORING AND PROCESSING AT FRONT			INSERT	WEIGHT (KGS)
			BORING RANGE	L	l <sub>1</sub>		
5158-S14-032	SMU32	MCK3	32 ~ 42	40	37	TC..1102	0.20
5158-S14-041	SMU41	MCK4	41 ~ 54	47	43	TC..1102	0.40
5158-S14-053	SMU53	MCK5	53 ~ 70	57	53	TC..1102	0.80
5158-S14-068	SMU68	MCK6	68 ~ 100	71	67	TC..1102	1.65

### ACCESSORIES

INSERT	CLAMPING SCREW	WRENCH
TC..1102	M2.5-6.0-3.5-60	T8

### Features:

- ▶ Micrometric adjustment on the diameters.
- ▶ Exchangeable insert seat is easy and convenient for replacement.
- ▶ Balancing adjustments can be made by users.
- ▶ Special surface structure to absorb shock and drain external water away.
- ▶ Surface treatment of matte finish for anti-glare and acid corrosion prevention.
- ▶ Available with MCK and CK connection.
- ▶ SMU is designed to have a coolant hole, which can remove the metal chips effectively and it's durable for coolant pressure up to 1,300 PSI.

### Product information:

- ▶ Inserts are optional accessories. Needs to be purchased additionally.

# SUPER MICRON EXCHANGEABLE FINISH BORING HEAD

## SMB 超微米搪孔頭

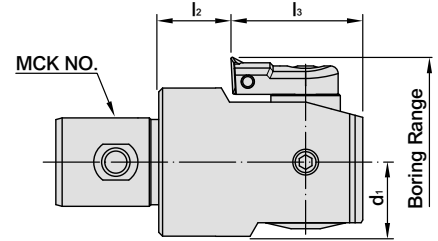
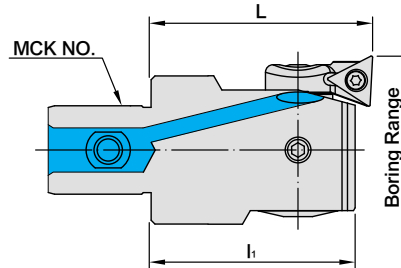

1 division=10μm

MODEL NO.	TYPE	MCK NO.	BORING AND PROCESSING AT FRONT			BORING AND PROCESSING AT BACK				WEIGHT (KGS)
			BORING RANGE	L	l <sub>1</sub>	BORING RANGE	l <sub>2</sub>	l <sub>3</sub>	d <sub>1</sub>	
5158-657-020	SMB20	MCK1	20 ~ 26	32.5	29.5	-	10.5	19.5	10	0.07
			25 ~ 31	32.5	29.5	30 ~ 31	10.5	19.5	10	0.07
			30 ~ 36	32.5	29.5	30 ~ 36	10.5	19.5	10	0.07
5158-657-025	SMB25	MCK2	25 ~ 33	35.5	32.5	-	11.5	21	12.5	0.12
			32 ~ 40	35.5	32.5	36 ~ 40	11.5	21	12.5	0.12
			39 ~ 47	35.5	32.5	39 ~ 47	11.5	21	12.5	0.12
5158-657-032	SMB32	MCK3	32 ~ 42	40	35	-	10	25	16	0.21
			41 ~ 51	40	35	46 ~ 51	10	25	16	0.21
			50 ~ 60	40	35	50 ~ 60	10	25	16	0.21
5158-657-041	SMB41	MCK4	41 ~ 54	47	43	-	14	29	20	0.40
			50 ~ 63	47	43	53 ~ 63	14	29	20	0.40
			61 ~ 74	47	43	61 ~ 74	14	29	20	0.40
5158-657-053	SMB53	MCK5	53 ~ 70	57	53	62 ~ 70	19	34	25.5	1.10
			65 ~ 82	57	53	65 ~ 82	19	34	25.5	1.10
			78 ~ 95	57	53	78 ~ 95	19	34	25.5	1.10
5158-657-068	SMB68	MCK6	68 ~ 100	71	67.2	80 ~ 100	22	45.2	32.5	1.74
			94 ~ 126	71	67.2	94 ~ 126	22	45.2	32.5	1.74
			118 ~ 150	71	67.2	118 ~ 150	22	45.2	32.5	1.74
5158-657-100	SMB100	MCK6	100 ~ 153	71	67.2	112 ~ 153	22	45.2	45.5	2.46
			126 ~ 179	71	67.2	126 ~ 179	22	45.2	45.5	2.46
			150 ~ 203	71	67.2	150 ~ 203	22	45.2	45.5	2.46

### TYPES FOR INSERT SEAT:

TYPE	DRAWING	SUITABLE FINISH BORING HEAD	INSERT	TYPE	DRAWING	SUITABLE FINISH BORING HEAD	INSERT
SIC20 - 1		SMB20	TB06 / TP08	SIC20 - 1E		SMB20	TB06 / TP08
SIC20 - 2				SIC20 - 2E			
SIC20 - 3				SIC20 - 3E			
SIC25 - 1		SMB25	TB06 / TP08	SIC25 - 1E		SMB25	TB06 / TP08
SIC25 - 2				SIC25 - 2E			
SIC25 - 3				SIC25 - 3E			
SIC32 - 1		SMB32	TB06 / TP08	SIC32 - 1E		SMB32	TB06 / TP08
SIC32 - 2				SIC32 - 2E			
SIC32 - 3				SIC32 - 3E			
SIC41 - 1		SMB41	TP09 / TC11	SIC41 - 1E		SMB41	TP09 / TC11
SIC41 - 2				SIC41 - 2E			
SIC41 - 3				SIC41 - 3E			
SIC53 - 1		SMB53	TP09 / TC11	SIC53 - 1E		SMB53	TP09 / TC11
SIC53 - 2				SIC53 - 2E			
SIC53 - 3				SIC53 - 3E			
SIC68 - 1		SMB68 / SMB100	TP09 / TC11	SIC68 - 1E		SMB68 / SMB100	TP09 / TC11
SIC68 - 2				SIC68 - 2E			
SIC68 - 3				SIC68 - 3E			

For example: there are different boring ranges for different insert seats of SMB25.

- ▶ SYIC\_-1 insert seat is a standard accessory.
- ▶ SYIC\_-2 and SYIC\_-3 insert seats are optional accessories and need to be purchased additionally.

#### Product information:

- ▶ Inserts are optional accessories. Needs to be purchased additionally.

STANDARD INSERT SEAT	OPTIONAL INSERT SEAT	
SIC25 - 1	SIC25 - 2	SIC25 - 3
ψ 25 ~ ψ 33	ψ 32 ~ ψ 40	ψ 39 ~ ψ 47



# SBJ BORING HEAD FOR FINISHING

## SBJ 高精密搪孔頭

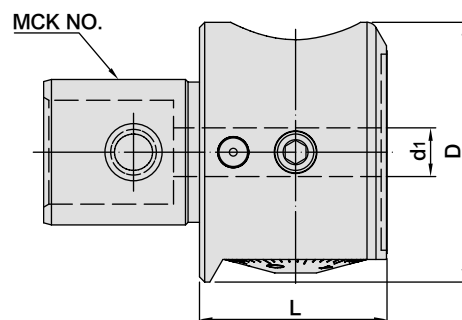

1 division=10 $\mu$ m

MODEL NO.	TYPE	MCK NO.	BORING RANGE	L	D	d <sub>1</sub>	WEIGHT (KGS)
5158-647-010	SBJ10	MCK4	8 - 21	28.5	39	10	0.25
5158-647-012	SBJ12	MCK5	8 - 26	36	50	12	0.50
5158-647-016	SBJ16	MCK6	8 - 50	45	63.5	16	1.00

### Product information:

- ▶ Can choose the shank for boring head fit for the machine spindle.
- ▶ Boring head only, not including shank and cutter.

# SLEEVE FOR TUNGSTEN STEEL TOOL HOLDER

## 鎢鋼刀柄專用套筒

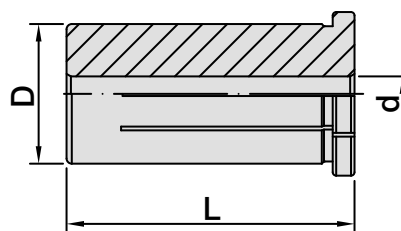

MODEL NO.	TYPE	L	D	d	WEIGHT (KGS)
5191-S19-1004	SBJ - 10 - 4K	25	10	4	0.01
5191-S19-1006	SBJ - 10 - 6K	25	10	6	0.01
5191-S19-1008	SBJ - 10 - 8K	25	10	8	0.01
5191-S19-1204	SBJ - 12 - 4K	30	12	4	0.01
5191-S19-1206	SBJ - 12 - 6K	30	12	6	0.01
5191-S19-1208	SBJ - 12 - 8K	30	12	8	0.01
5191-S19-1210	SBJ - 12 - 10K	30	12	10	0.01
5191-S19-1608	SBJ - 16 - 8K	37	16	8	0.08
5191-S19-1610	SBJ - 16 - 10K	37	16	10	0.04
5191-S19-1612	SBJ - 16 - 12K	37	16	12	0.02
5191-S19-1614	SBJ - 16 - 14K	37	16	14	0.01

# SBE EXTENDED BORING INSERT SEAT

## SBE 延伸搪孔刀座



台灣精品 2013  
TAIWAN EXCELLENCE

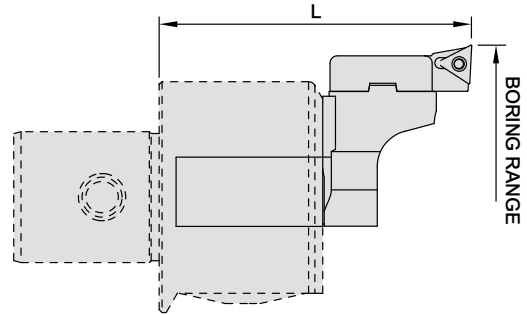

MODEL NO.	TYPE	SBJ NO.	INSERT SEAT	INSERT	BORING AND PROCESSING AT FRONT		WEIGHT (KGS)
					BORING RANGE	L	
5158-684-000	SBE - 0	SBJ16	SIC53 - 1	TP09 / TC11	48 - 60	127	0.16
				TP09 / TC11	60 - 72	127	0.16
				TP09 / TC11	72 - 85	127	0.16
5158-684-001	SBE - 1	SBJ16	SIC68 - 1	TP09 / TC11	84 - 96	85.5	0.18
				TP09 / TC11	95 - 107	85.5	0.18
5158-684-002	SBE - 2	SBJ16	SIC68 - 2	TP09 / TC11	120 - 132	86	0.18
				TP09 / TC11	145 - 157	85.5	0.18
				TP09 / TC11	130 - 142	85.5	0.20
5158-684-003	SBE - 3	SBJ16	SIC68 - 2	TP09 / TC11	156 ~ 168	86	0.20
				TP09 / TC11	180 ~ 192	85.5	0.20
				TP09 / TC11	142 ~ 154	85.5	0.24
5158-684-004	SBE - 4	SBJ16	SIC68 - 3	TP09 / TC11	168 ~ 180	86	0.24
				TP09 / TC11	192 ~ 202	85.5	0.24
				TP09 / TC11			

### ACCESSORIES

INSERT	CLAMPING SCREW	WRENCH
TP..0902	M2.5-6.0-3.5-60	T8
TC..1102	M2.5-6.0-3.5-60	T8

### TYPES FOR INSERT SEAT:

INSERT	DRAWING	INSERT	DRAWING
SIC53 - 1		SIC53 - 1E	
SIC68 - 1		SIC68 - 1E	
SIC68 - 2		SIC68 - 2E	
SIC68 - 3		SIC68 - 3E	

### SBJ16 BORING HEAD

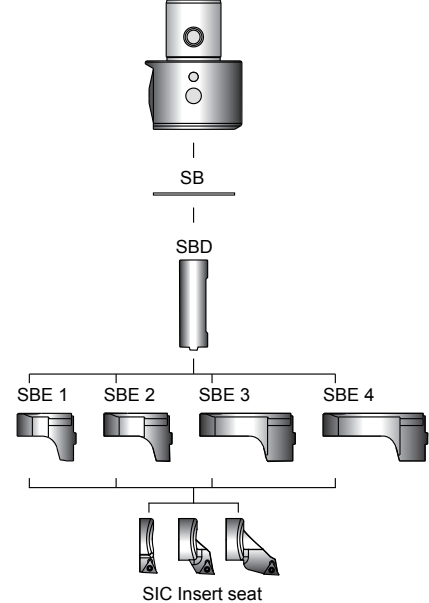

### Features:

- ▶ Depending on the range of work piece's diameter, using SBE Extended Boring Insert Seat to enlarge the range of processing and can solve the difficulty of processing different work piece's diameter.
- ▶ To enlarge the range of processing it is easy to operate by only exchanging the insert seat.
- ▶ According to different processing material, operators choose suitable inserts which can increase precision, stability, and have excellent metal chips removal capability.
- ▶ Suitable for SBJ-16 (5158-647-016).
- ▶ Tool holders, SBJ Boring head for finishing, and Inserts need to be purchased additionally.

### Product information:

- ▶ Inserts are optional accessories. Needs to be purchased additionally.



# ANTI-VIBRANT TUNGSTEN STEEL TOOL HOLDER

抗震鎢鋼刀柄

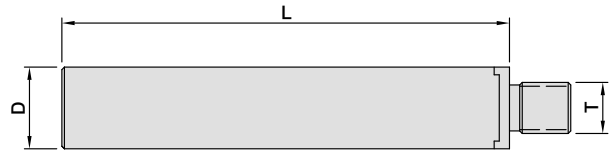

MODEL NO.	TYPE	D	L	T	SUITABLE BORING HEAD	BORING CAPACITY	WEIGHT (KGS)
405-005-008-000	ST08 - W5 - 100L	8	100	M5	SEB09N	9mm ~ 13mm	0.08
405-005-010-000	ST10 - W6 - 110L	10	110	M6	SEB12N	12mm ~ 15mm	0.12
405-005-012-000	ST12 - W6 - 120L	12	120	M6	SEB14N	14mm ~ 17mm	0.21
405-005-014-000	ST14 - W6 - 160L	14	160	M6	SEB16N	16mm ~ 20mm	0.34
405-005-016-000	ST16 - W10 - 160L	16	160	M10	SEB18N ~ SEB40N	18mm ~ 42mm	0.45

## Features:

- ▶ Boring hole in depth can't exceed 6 times of hole diameter.



# THROW - AWAY BORING HEAD

## 捨棄式搪頭

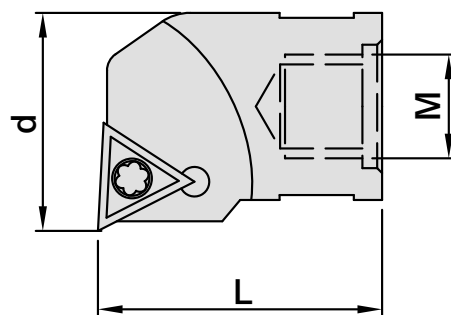

MODEL NO.	TYPE	BORING CAPACITY	d	L	M	INSERTS	SCREW	WRENCH	WEIGHT (KGS)
405-002-09N-001	SEB09N - TP08	9 - 10.5	9	18	M5	TP.0802	M2-5.0-2.7-60	T6	0.02
405-002-10.5N-001	SEB10.5N - TP08	10.5 - 12	10.5	18	M5	TP.0802	M2-5.0-2.7-60	T6	0.02
405-002-12N-001	SEB12N - TP08	12 - 14	12	23	M6	TP.0802	M2-5.0-2.7-60	T6	0.02
405-002-14N-001	SEB14N - TP08	14 - 16	14	23	M6	TP.0802	M2-5.0-2.7-60	T6	0.02
405-002-16N-001	SEB16N - TP08	16 - 18	16	23	M6	TP.0802	M2-5.0-2.7-60	T6	0.03
405-002-18N-001	SEB18N - TP08	18 - 20	18	27	M10	TP.0802	M2-5.0-2.7-60	T6	0.03
405-002-20N-001	SEB20N - TP08	20 - 22	20	27	M10	TP.0802	M2-5.0-2.7-60	T6	0.04
405-002-22N-001	SEB22N - TP08	22 - 24	22	27	M10	TP.0802	M2-5.0-2.7-60	T6	0.04
405-002-24N-001	SEB24N - TP08	24 - 26	24	27	M10	TP.0802	M2-5.0-2.7-60	T6	0.04
405-002-26N-001	SEB26N - TP08	26 - 28	26	27	M10	TP.0802	M2-5.0-2.7-60	T6	0.04
405-002-28N-001	SEB28N - TP08	28 - 30	28	27	M10	TP.0802	M2-5.0-2.7-60	T6	0.04
405-002-30N-001	SEB30N - TP08	30 - 32	30	27	M10	TP.0802	M2-5.0-2.7-60	T6	0.04
405-002-32N-001	SEB32N - TP08	32 - 34	32	27	M10	TP.0802	M2-5.0-2.7-60	T6	0.04
405-002-34N-001	SEB34N - TP08	34 - 36	34	27	M10	TP.0802	M2-5.0-2.7-60	T6	0.05
405-002-36N-001	SEB36N - TP08	36 - 38	36	27	M10	TP.0802	M2-5.0-2.7-60	T6	0.04
405-002-38N-001	SEB38N - TP08	38 - 40	38	27	M10	TP.0802	M2-5.0-2.7-60	T6	0.05
405-002-40N-001	SEB40N - TP08	40 - 42	40	27	M10	TP.0802	M2-5.0-2.7-60	T6	0.05
405-002-42N-001	SEB42N - TP08	42 - 44	42	27	M10	TP.0802	M2-5.0-2.7-60	T6	0.05
405-002-44N-001	SEB44N - TP08	44 - 46	44	27	M10	TP.0802	M2-5.0-2.7-60	T6	0.05
405-002-46N-001	SEB46N - TP08	46 - 48	46	27	M10	TP.0802	M2-5.0-2.7-60	T6	0.05
405-002-48N-001	SEB48N - TP08	48 - 50	48	27	M10	TP.0802	M2-5.0-2.7-60	T6	0.05
405-002-50N-001	SEB50N - TP08	50 - 52	50	27	M10	TP.0802	M2-5.0-2.7-60	T6	0.05
405-002-09N-000	SEB09N - 06 - TB06	9 - 10.5	9	18	M5	TB.0601	M2-5.0-2.7-60	T6	0.02
405-002-16N-000	SEB12N - 06 - TB06	12 - 14	12	23	M6	TB.0601	M2-5.0-2.7-60	T6	0.02
405-002-14N-000	SEB14N - 09 - TP09	14 - 16	14	23	M6	TP.0902	M2.5-6.0-3.5-60	T8	0.02
405-002-16N-000	SEB16N - 09 - TP09	16 - 18	16	23	M6	TP.0902	M2.5-6.0-3.5-60	T8	0.03
405-002-18N-000	SEB18N - 09 - TP09	18 - 20	18	27	M10	TP.0902	M2.5-6.0-3.5-60	T8	0.03
405-002-20N-000	SEB20N - 09 - TP09	20 - 22	20	27	M10	TP.0902	M2.5-6.0-3.5-60	T8	0.04
405-002-22N-000	SEB22N - 11 - TP11	22 - 24	22	27	M10	TP.1103	M3-8.0-4.0-43	T9	0.04
405-002-24N-000	SEB24N - 11 - TP11	24 - 26	24	27	M10	TP.1103	M3-8.0-4.0-43	T9	0.04
405-002-26N-000	SEB26N - 11 - TP11	26 - 28	26	27	M10	TP.1103	M3-8.0-4.0-43	T9	0.04
405-002-28N-000	SEB28N - 11 - TP11	28 - 30	28	27	M10	TP.1103	M3-8.0-4.0-43	T9	0.04
405-002-030N-000	SEB30N - 11 - TP11	30 - 32	30	27	M10	TP.1103	M3-8.0-4.0-43	T9	0.04
405-002-032N-000	SEB32N - 11 - TP11	32 - 34	32	27	M10	TP.1103	M3-8.0-4.0-43	T9	0.04
405-002-34N-000	SEB34N - 11 - TP11	34 - 36	34	27	M10	TP.1103	M3-8.0-4.0-43	T9	0.05
405-002-36N-000	SEB36N - 11 - TP11	36 - 38	36	27	M10	TP.1103	M3-8.0-4.0-43	T9	0.04
405-002-38N-000	SEB38N - 11 - TP11	38 - 40	38	27	M10	TP.1103	M3-8.0-4.0-43	T9	0.05
405-002-40N-000	SEB40N - 11 - TP11	40 - 42	40	27	M10	TP.1103	M3-8.0-4.0-43	T9	0.04

### Product information:

- ▶ Inserts are optional accessories. Needs to be purchased additionally.



# BORING CUTTER

## INTERCHANGEABLE

### 替換式 搪孔刀

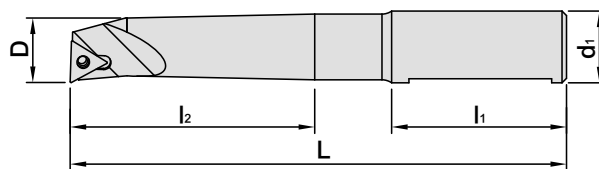

MODEL NO.	TYPE	BORING CAPACITY	D	d <sub>1</sub>	L	l <sub>1</sub>	l <sub>2</sub>	INSERTS	WEIGHT (KGS)
5158-S19-1008-024	SBJ - 1008 - 24	8 - 11	8	10	58	25	24	TB..0601	0.02
5158-S19-1010-030	SBJ - 1010 - 30	10 - 13	10	10	64	25	30	TB..0601	0.04
5158-S19-1012-036	SBJ - 1012 - 36	12 - 17	12	10	70	25	36	TP..0902	0.04
5158-S19-1016-048	SBJ - 1016 - 48	16 - 21	16	10	78	25	48	TP..0902	0.08
5366-158-S19-010-000	SBJ - 10 4PCS / SET INCLUDE BOX								
5158-S19-1208-028	SBJ - 1208 - 28	8 - 11	8	12	67	30	28	TB..0601	0.04
5158-S19-1210-035	SBJ - 1210 - 35	10 - 13	10	12	74	30	35	TB..0601	0.04
5158-S19-1212-042	SBJ - 1212 - 42	12 - 17	12	12	81	30	42	TP..0902	0.06
5158-S19-1216-056	SBJ - 1216 - 56	16 - 21	16	12	95	30	56	TP..0902	0.08
5158-S19-1220-070	SBJ - 1220 - 70	20 - 26	20	12	105	30	70	TP..1103	0.12
5366-158-S19-012-000	SBJ - 12 5PCS / SET INCLUDE BOX								
5158-S19-1608-032	SBJ - 1608 - 32	8 - 11	8	16	64	32	32	TB..0601	0.06
5158-S19-1610-040	SBJ - 1610 - 40	10 - 13	10	16	72	32	40	TB..0601	0.07
5158-S19-1612-053	SBJ - 1612 - 53	12 - 17	12	16	85	32	53	TP..0902	0.08
5158-S19-1616-068	SBJ - 1616 - 68	16 - 21	16	16	100	32	68	TP..0902	0.12
5158-S19-1620-083	SBJ - 1620 - 83	20 - 26	20	16	115	32	83	TP..1103	0.16
5158-S19-1625-090	SBJ - 1625 - 90	25 - 32	25	16	122	32	90	TP..1103	0.25
5158-S19-1630-090	SBJ - 1630 - 90	30 - 42	30	16	122	32	90	TP..1103	0.30
5158-S19-1640-090	SBJ - 1640 - 90	40 - 50	40	16	122	32	90	TP..1103	0.40
5366-158-S19-016-000	SBJ - 16 8PCS / SET INCLUDE BOX								
5158-S19-2008-032	SBJ - 2008 - 32	8 - 11	8	20	64	32	32	TB..0601	0.09
5158-S19-2010-040	SBJ - 2010 - 40	10 - 13	10	20	72	32	40	TB..0601	0.11
5158-S19-2012-053	SBJ - 2012 - 53	12 - 17	12	20	85	32	53	TP..0902	0.11
5158-S19-2016-068	SBJ - 2016 - 68	16 - 21	16	20	100	32	68	TP..0902	0.15
5158-S19-2020-083	SBJ - 2020 - 83	20 - 26	20	20	115	32	83	TP..1103	0.20
5158-S19-2025-096	SBJ - 2025 - 96	25 - 135	25	20	128	32	96	TP..1103	0.30
5158-S19-2030-115	SBJ - 2030 - 115	30 - 140	30	20	147	32	115	TP..1103	0.50
5158-S19-20-20	SBJ - 20 - 20L	280	40	20	97	-	-	TP..1103	0.25
5366-158-S19-020-000	SBJ - 20 8PCS / SET INCLUDE BOX								
									3.00

#### ACCESSORIES

INSERT	CLAMPING SCREW	WRENCH
TB..0601	M2-5.0-2.7-60	T6
TP..0902	M2.5-6.0-3.5-60	T8
TP..1103	M3-8.0-4.0-43	T9

#### Product information:

- ▶ Inserts are optional accessories. Needs to be purchased additionally.

# BYB BORING HEAD

## MICROMETER ADJUSTABLE

### BYB 微切削搪孔頭

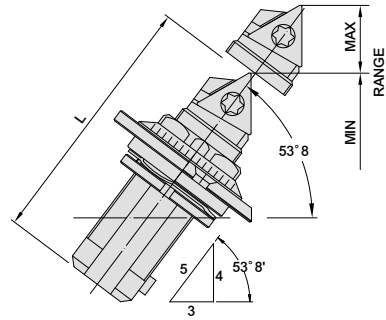

MODEL NO.	TYPE	RANGE		L	INSERT	SCREW	WRENCH	BYB BORING HEAD TYPE	WEIGHT (KGS)
		MIN.	MAX.						
5158-7019-02-00	M2 - 19	19	22.5	20.7	TB..0601	M2-3.8-2.68-43	T6	M2 - 19	0.06
5158-7022-02-00	M2 - 22	22	29.5	23.5	TB..0601	M2-3.8-2.68-43	T6	M2 - 19	0.06
5158-7029-02-00	M3 - 29	29	41	31	TB..0601	M2-5.0-2.7-60	T6	M2 - 19	0.07
5158-7038-02-00	M5 - 38	38	50	40	TP..1103	M2.5-7.5-4.3-60	T8	M2 - 22	0.08
5158-7048-02-00	M5 - 48	48	65	47.7	TP..1103	M2.5-7.5-4.3-60	T8	M2 - 22	0.10
5158-7062-02-00	M7 - 62	62	90	63.5	TP..16T3	M4-10-5.0-43	T15	M3 - 29	0.20

**Product information:**

► For the body of boring head, please refer to BYB FINISH BORING HEAD BODY. ► Inserts are optional accessories. Need to be purchased additionally.

# BYB FINISH BORING HEAD BODY

### BYB 微切削搪刀柄

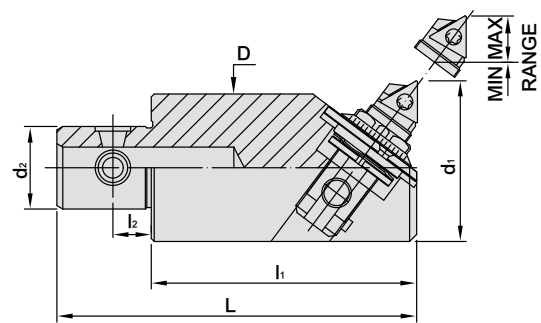

MODEL NO.	TYPE	ASSEMBLE TOOL HOLDER	d <sub>1</sub>		d <sub>2</sub>	L	l <sub>1</sub>	l <sub>2</sub>	D	WEIGHT (KGS)
			MIN.	MAX.						
5158-7019-01-00	BYB19	MCK1	19	22.5	11	51	35	4.75	18	0.36
5158-7022-01-00	BYB22	MCK1	22	29.5	11	51	35	4.75	20	0.36
5158-7029-01-00	BYB29	MCK2	29	41	14	61	45	6.5	25	0.37
5158-7038-01-00	BYB38	MCK3	38	50	18	90	70	7.7	35	0.41
5158-7048-01-00	BYB48	MCK4	48	65	22	84	60	7.7	41	0.59
5158-7062-01-00	BYB62	MCK5	62	90	28	110	80	12.7	54	0.70
5158-7082-01-00	BYB82	MCK6	82	110	36	150	110	15.7	67	1.05

**Product information:**

► Only contains the body, not including BYB Micrometer Adjustable Boring Head.  
 ► Inserts are optional accessories. Need to be purchased additionally.



# CBM55 MICRO ADJUSTMENT BORING HEAD SET

## CBM55 精密微調搪孔頭套組



MODEL NO.	TYPE	BORING CAPACITY	BORING CUTTER W / O INSERTS			WEIGHT (KGS)
			TYPE	INSERTS / Clamp Screw	WRENCH	
405-007-055-000	CBM55	6 ~ 9	BR1606 - 21	WB06 / Ø3 x M2	T6	4.7
		8 ~ 11	BR1608 - 28			
		10 ~ 13	BR1610 - 35	TB06 / Ø2.7 x M2	T6	
		12 ~ 15	BR1612 - 42			
		14 ~ 17	BR1614 - 50			
		16 ~ 20	BR1616 - 60			
		20 ~ 24	BR1620 - 65			
		24 ~ 28	BR1624 - 68	TP09 / M2.5	T8	
		27 ~ 40	C16 - BR27 + SP27			
		35 ~ 50	C16 - BR35 + SP35			
		45 ~ 68	C16 - BR45 + SP45			
		55 ~ 80	CB-M10 + SP55			
		68 ~ 104	CB-M10 + SP68			
100 ~ 154	CB-M10 + SP100					

### CBM55 ( Boring Range from Ø6 - Ø154 mm )

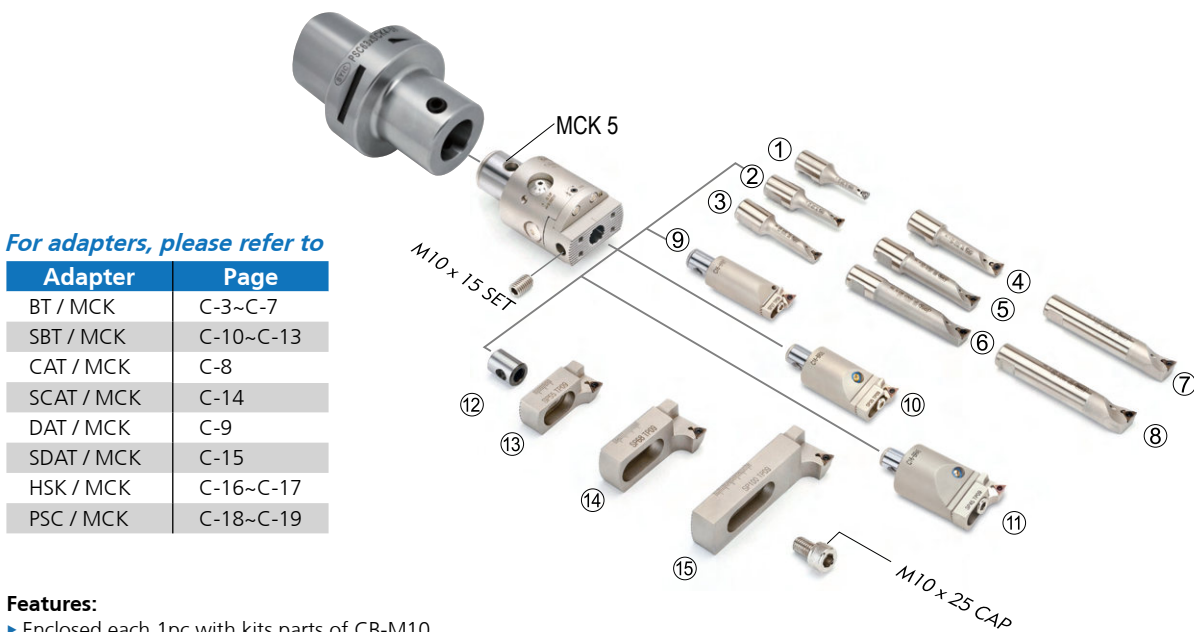

For adapters, please refer to

Adapter	Page
BT / MCK	C-3~C-7
SBT / MCK	C-10~C-13
CAT / MCK	C-8
SCAT / MCK	C-14
DAT / MCK	C-9
SDAT / MCK	C-15
HSK / MCK	C-16~C-17
PSC / MCK	C-18~C-19

**Features:**

- ▶ Enclosed each 1pc with kits parts of CB-M10.
- ▶ Boring range up to Ø204mm can be match with option of CB150 adapter plate and RCM100 balance base.

**Product information:**

- ▶ Inserts are optional accessories. Needs to be purchased additionally.
- ▶ MCK boring head shank is optional accessory. Needs to be purchased additionally.



# CBM68 MICRO ADJUSTMENT BORING HEAD SET

## CBM68 精密微調搪孔頭套組



MODEL NO.	TYPE	BORING CAPACITY	BORING CUTTER W / O INSERTS			WEIGHT (KGS)
			TYPE	INSERTS / Clamp Screw	WRENCH	
405-007-068-000	CBM68	6 ~ 9	BR1606 - 21	WB06 / Ø3 x M2	T6	6.3
		8 ~ 11	BR1608 - 28	TB06 / Ø2.7 x M2	T6	
		10 ~ 13	BR1610 - 35			
		12 ~ 15	BR1612 - 42			
		14 ~ 17	BR1614 - 50			
		16 ~ 20	BR1616 - 60			
		20 ~ 24	BR1620 - 65	TP09 / M2.5	T8	
		24 ~ 28	BR1624 - 68			
		27 ~ 40	C16 - BR27 + SP27			
		35 ~ 50	C16 - BR35 + SP35			
		45 ~ 68	C16 - BR45 + SP45			
		68 ~ 104	CB - M10 + SP68			
		100 ~ 154	CB - M10 + SP100			
150 ~ 204	CB150 + RCM100 + SP100					

### CBM68 ( Boring Range from Ø6 - Ø204 mm )

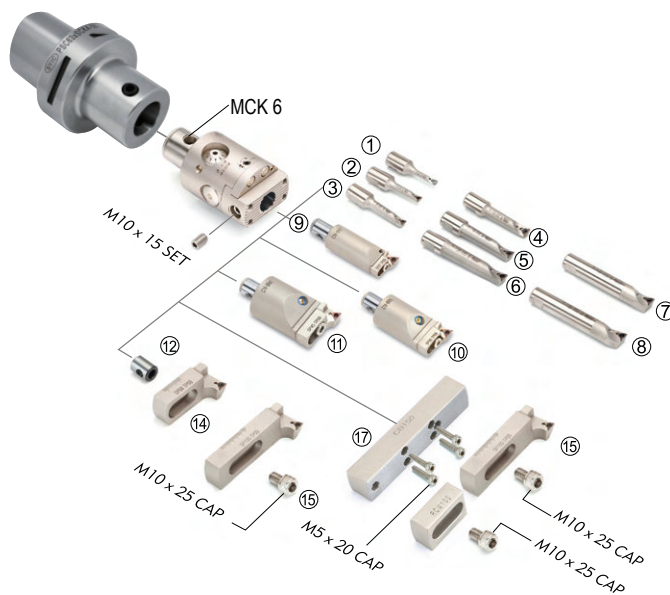

For adapters, please refer to

Adapter	Page
BT / MCK	C-3~C-7
SBT / MCK	C-10~C-13
CAT / MCK	C-8
SCAT / MCK	C-14
DAT / MCK	C-9
SDAT / MCK	C-15
HSK / MCK	C-16~C-17
PSC / MCK	C-18~C-19

**Features:**

- ▶ Enclosed each 1pc with kits parts of CB-M10 and SP100.
- ▶ Boring range up to Ø254mm can be match with option of CB200 adapter plate.
- ▶ Boring range up to Ø304mm can be match with option of CB250 adapter plate.

**Product information:**

- ▶ Inserts are optional accessories. Needs to be purchased additionally.
- ▶ MCK boring head shank is optional accessory. Needs to be purchased additionally.



# RBH-LA INDEXABLE TWIN-BIT ROUGH BORING HEAD

## RBH-LA 新型可調整式雙刃粗搪孔頭

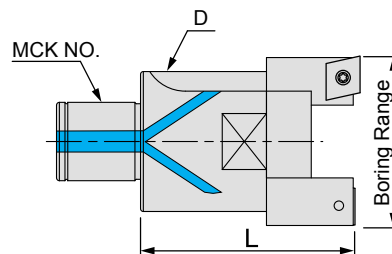

MODEL NO.	TYPE	MCK NO.	L	D	BORING RANGE	INSERT	WEIGHT (KGS)
405-010-025-000	RBH - 25-35LA - C	MCK2	50	24	25 ~ 35	CC..0602	0.18
405-010-032-000	RBH - 32-45LA - C	MCK3	60	31	32 ~ 45	CC..0602	0.34
405-010-032-001	RBH - 32-45LA - T	MCK3	60	31	32 ~ 45	TC..1102	0.35
405-010-040-000	RBH - 40-55LA - C	MCK4	74	39	40 ~ 55	CC..09T3	0.62
405-010-040-001	RBH - 40-55LA - T	MCK4	74	39	40 ~ 55	TC..16T3	0.61
405-010-052-000	RBH - 52-75LA - C	MCK5	80	50	52 ~ 75	CC..09T3	1.13
405-010-052-001	RBH - 52-75LA - T	MCK5	80	50	52 ~ 75	TC..16T3	1.11
405-010-068-000	RBH - 68-100LA - C	MCK6	90	66	68 ~ 100	CC..1204	2.20
405-010-068-001	RBH - 68-100LA - T	MCK6	90	66	68 ~ 100	TC..16T3	2.21
405-010-090-000	RBH - 90-130LA - C	MCK6	100	88	90 ~ 130	CC..1204	3.10
405-010-090-001	RBH - 90-130LA - T	MCK6	100	88	90 ~ 130	TC..16T3	2.99

### ACCESSORIES

INSERT	CLAMPING SCREW	WRENCH
CC..0602	M2.5-6.0-3.5-60	T8
CC..09T3	M4-10-5.7-60	T15
CC..1204	M5-11-7.5-60	T20
TC..1102	M2.5-6.0-3.5-60	T8
TC..16T3	M4-10-5.7-60	T15

### Features:

- ▶ Thickened cartridge with higher rigidity.
- ▶ RBH-25LA~RBH-160LA Coolant nozzle easily cools the insert elongating its working life.
- ▶ Completed with chip pocket, improving chip flow of deep boring.
- ▶ Clamp plate solidifies cartridges and head, upgrading cutting rigidity.
- ▶ Patented step boring design; suitable for both level boring and step boring.

# CBH FINISH BORING HEAD

## CBH 微調精搪孔頭

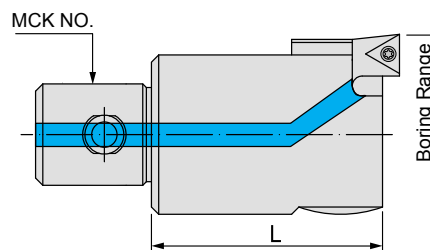

MODEL NO.	TYPE	MCK NO.	L	BORING RANGE	INSERT	Torque (N.m)	WEIGHT (KGS)
405-011-020-000	CBH20 - TB06	MCK1	35	20 ~ 26	TB..0601	0.6	0.19
405-011-025-000	CBH25 - TB06	MCK2	40	25 ~ 33	TB..0601	0.6	0.20
405-011-032-000	CBH32 - TB06	MCK3	40	32 ~ 42	TB..0601	0.6	0.28
405-011-040-000	CBH40 - TB06	MCK4	50	40 ~ 55	TB..0601	0.6	0.59
405-011-020-001	CBH20 - TP08	MCK1	35	20 ~ 26	TP..0802	0.6	0.19
405-011-025-001	CBH25 - TP08	MCK2	40	25 ~ 33	TP..0802	0.6	0.26
405-011-032-001	CBH32 - TP08	MCK3	40	32 ~ 42	TP..0802	0.6	0.37
405-011-040-001	CBH40 - TP08	MCK4	50	40 ~ 55	TP..0802	0.6	0.52
405-011-020-002	CBH20 - TC09	MCK1	35	20 ~ 26	TC..0902	0.6	0.19
405-011-025-002	CBH25 - TC09	MCK2	40	25 ~ 33	TC..0902	0.6	0.20
405-011-032-002	CBH32 - TC09	MCK3	40	32 ~ 42	TC..0902	0.6	0.37
405-011-040-002	CBH40 - TC09	MCK4	50	40 ~ 55	TC..0902	0.6	0.50
405-011-020-003	CBH20 - TP09	MCK1	35	20 ~ 26	TP..0902	1.2	0.10
405-011-025-003	CBH25 - TP09	MCK2	40	25 ~ 33	TP..0902	1.2	0.20
405-011-032-003	CBH32 - TP09	MCK3	40	32 ~ 42	TP..0902	1.2	0.30
405-011-040-003	CBH40 - TP09	MCK4	50	40 ~ 55	TP..0902	1.2	0.50
405-011-052-003	CBH52 - TP08	MCK5	60	52 ~ 75	TP..0802	0.6	1.02
405-011-068-003	CBH68 - TP08	MCK6	72	68 ~ 102	TP..0802	0.6	2.02
405-011-100-003	CBH100 - TP08	MCK6	72	100 ~ 152	TP..0802	0.6	2.90
405-011-150-003	CBH150 - TP08	MCK6	72	150 ~ 202	TP..0802	0.6	4.43
405-011-052-004	CBH52 - TP09	MCK5	60	52 ~ 75	TP..0902	1.2	1.00
405-011-068-004	CBH68 - TP09	MCK6	72	68 ~ 102	TP..0902	1.2	2.00
405-011-100-004	CBH100 - TP09	MCK6	72	100 ~ 152	TP..0902	1.2	3.16
405-011-150-004	CBH150 - TP09	MCK6	72	150 ~ 202	TP..0902	1.2	4.20
405-011-052-005	CBH52 - TC11	MCK5	60	52 ~ 75	TC..1102	1.2	1.00
405-011-068-005	CBH68 - TC11	MCK6	72	68 ~ 102	TC..1102	1.2	2.00
405-011-100-005	CBH100 - TC11	MCK6	72	100 ~ 152	TC..1102	1.2	2.90
405-011-150-005	CBH150 - TC11	MCK6	72	150 ~ 202	TC..1102	1.2	4.20

### ACCESSORIES

INSERT	CLAMPING SCREW	WRENCH	INSERT	CLAMPING SCREW	WRENCH
TB..0601	M2-5.0-2.7-60	T6	TC..0902	M2-5.0-3.1-60	T6
TP..0802	M2-5.0-3.1-60	T6	TC..1102	M2.5-6.0-3.5-60	T8
TP..0902	M2.5-6.0-3.5-60	T8			

### Features:

- ▶ Micro-adjustments with fifty 0.01mm in diameter. Includes a sub-dial for finer adjustments ranging from  $\phi$  20mm~ $\phi$  202mm.
- ▶ T-type insert has a clearance angle of 3°.
- ▶ The insert seat spindle use square structure with two face support, proving high stability and rigidity on diameter.



# MBH FINISH BORING HEAD

## MBH 微調精搪孔頭

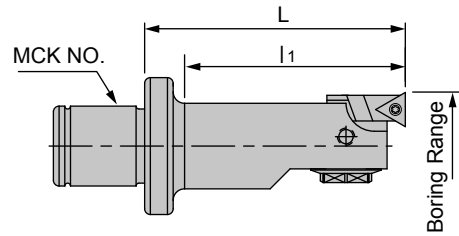

MODEL NO.	TYPE	MCK NO.	L	l <sub>1</sub>	BORING RANGE	INSERT	TORQUE (N.M)	WEIGHT (KGS)
405-012-16A	MBH16A	MCK2	55	50	16 ~ 20	WC..02	0.6	0.09
405-012-16B	MBH16B	MCK2	80	75	16 ~ 20	WC..02	0.6	0.12



# MBH FINISH BORING HEAD

## MBH 微調精搪孔頭

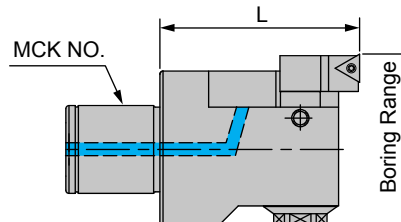

MODEL NO.	TYPE	MCK NO.	L	BORING RANGE	INSERT	Torque (N.m)	WEIGHT (KGS)
405-012-020	MBH20 - WC02	MCK1	35	20 ~ 26	WC..02	0.6	0.07
405-012-025	MBH25 - WC02	MCK2	40	25 ~ 32	WC..02	0.6	0.12
405-012-032	MBH32 - TP09	MCK3	40	32 ~ 42	TP..0902	1.2	0.23
	MBH32 - TC09	MCK3	40	32 ~ 42	TC..0902	0.6	0.23
405-012-40A	MBH32 - CC06	MCK3	40	32 ~ 42	CC..0602	1.2	0.23
	MBH40A - TP11	MCK4	50	40 ~ 55	TP..1103	1.4	0.43
	MBH40A - TC11	MCK4	50	40 ~ 55	TC..1102	1.2	0.43
405-012-40B	MBH40A - CC06	MCK4	50	40 ~ 55	CC..0602	1.2	0.43
	MBH40B - TP11	MCK4	50	55 ~ 70	TP..1103	1.4	0.43
	MBH40B - TC11	MCK4	50	55 ~ 70	TC..1102	1.2	0.43
405-012-52A	MBH40B - CC06	MCK4	50	55 ~ 70	CC..0602	1.2	0.43
	MBH52A - TP11	MCK5	60	52 ~ 70	TP..1103	1.4	0.90
	MBH52A - TC11	MCK5	60	52 ~ 70	TC..1102	1.2	0.90
405-012-52B	MBH52A - CC06	MCK5	60	52 ~ 70	CC..0602	1.2	0.90
	MBH52B - TP11	MCK5	60	67 ~ 85	TP..1103	1.4	0.90
	MBH52B - TC11	MCK5	60	67 ~ 85	TC..1102	1.2	0.90
405-012-68A	MBH52B - CC06	MCK5	60	67 ~ 85	CC..0602	1.2	0.90
	MBH68A - TP11	MCK6	75	68 ~ 88	TP..1103	1.4	1.86
	MBH68A - TC11	MCK6	75	68 ~ 88	TC..1102	1.2	1.86
405-012-68B	MBH68A - CC09	MCK6	75	68 ~ 88	CC..09T3	3.0	1.86
	MBH68B - TP11	MCK6	75	85 ~ 105	TP..1103	1.4	1.86
	MBH68B - TC11	MCK6	75	85 ~ 105	TC..1102	1.2	1.86
	MBH68B - CC09	MCK6	75	85 ~ 105	CC..09T3	3.0	1.86

### ACCESSORIES

INSERT	CLAMPING SCREW	WRENCH	INSERT	CLAMPING SCREW	WRENCH
WC..02	M2.0-5.0-2.7-60	T6	TC..1102	M2.5-6.0-3.5-60	T8
CC..0602	M2.5-6.0-3.5-60	T8	TP..0902	M2.5-6.0-3.5-60	T8
CC..09T3	M4-10-5.7-60	T15	TP..1103	M3-8.0-4.0-43	T9
TC..0902	M2-5.0-3.1-60	T6			

### Product Information:

- ▶ Each of MBH40, MBH52, MBH68, MBH100, MBH140, MBH200, MBH300, MBH400, MBH500 is with both A and B insert-holders for exchange on demand to obtain the maximum boring range.



# CBI SMALL DIAMETER FINISH BORING HEAD

## CBI 小徑微調精搪頭

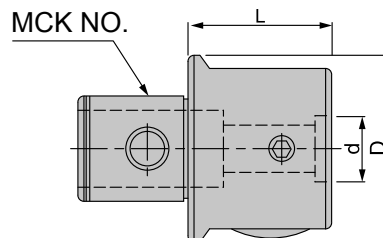

MODEL NO.	TYPE	MCK NO.	L	D	d	WEIGHT (KGS)
405-013-004-000	CBI4	MCK4	32	39	10	0.40
405-013-005-000	CBI5	MCK5	40	50	12	0.80
405-013-006-000	CBI6	MCK6	50	64	16	1.27

### Features:

- ▶ Available are three different styles enabling small diameter boring from  $\phi$  8mm to  $\phi$  50mm. Boring range can be with in  $\phi$  3mm to  $\phi$  10mm if small diameter solid carbide boring bar has been employed.
- ▶ The dial has been graduated into 50 divisions, each of which is 0.01mm on diameter. Available is sub-dial for finer adjustment.
- ▶ High precision internal lead screw with inner lubrication is free from the effects of chip, featuring high durability.

# CBI SMALL DIAMETER ADAPTER

## CBI 小徑套筒

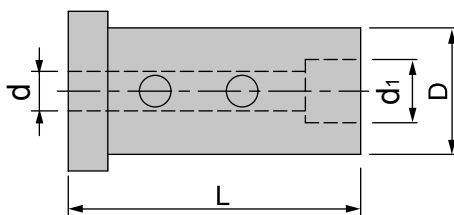

MODEL NO.	TYPE	L	D	d	d <sub>1</sub>	CLAMPING SCREW	WRENCH	TORQUE (N.M)	WEIGHT (KGS)
408-013-0416-000	SH-0416-37	37	16	4	8	HS4×4	PL2	3	0.07
408-013-0516-000	SH-0516-37	37	16	5	8	HS5×5.5	PL2	3	0.06
408-013-0616-000	SH-0616-37	37	16	6	8	HS6×4	PL2	3	0.06
408-013-0716-000	SH-0716-37	37	16	7	8	HS6×4	PL2	3	0.06

# EXTENSION ADAPTER FOR SMALL DIAMETER BORING BAR DEDICATED TO CBI SERIES TYPE AC

CBI 系列專用小徑搪刀延長桿 AC 型

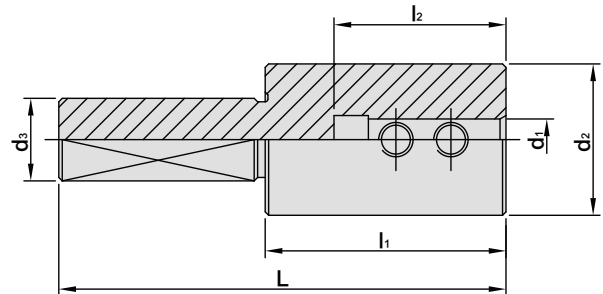

MODEL NO.	TYPE	L	l <sub>1</sub>	l <sub>2</sub>	d <sub>1</sub>	d <sub>2</sub>	d <sub>3</sub>	SUITABLE BORING HEAD	WEIGHT (KGS)
405-015-010-000	AC1006 - 30	55	30	25	6	18	10	CBI4	0.06
405-015-012-000	AC1206 - 35	65	35	25	6	22	12	CBI5	0.12
405-015-012-001	AC1210 - 35	65	35	30	10	22	12	CBI5	0.11
405-015-016-000	AC1606 - 35	85	35	25	6	16	16	CBI6	0.12
405-015-016-001	AC1610 - 35	85	35	30	10	22	16	CBI6	0.15

# SUPER FINE DIAMETER TUNGSTEN CARBIDE BORING BAR DEDICATED TO CBI SERIES TYPE SBJ

CBI 系列專用超小徑碳化鎢搪孔刀 SBJ 型

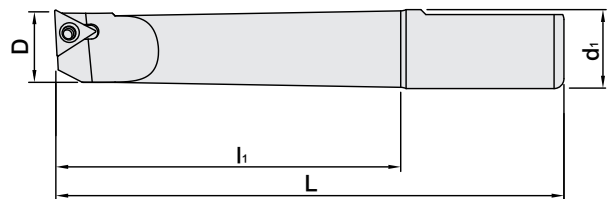

MODEL NO.	TYPE	L	MAX. BORING DIA.			l <sub>1</sub>	D	d <sub>1</sub>	WEIGHT (KGS)
			CBI4	CBI5	CBI6				
405-016-006-000	SBJ0603 - 15	50	7	10	13	15	3	6	0.02
405-016-006-001	SBJ0604 - 20	50	8	11	14	20	4	6	0.02
405-016-006-002	SBJ0605 - 25	60	9	12	15	25	5	6	0.02
405-016-006-003	SBJ0606 - 30	60	10	13	16	30	6	6	0.02
405-016-010-000	SBJ1008 - 35	75	12	15	18	35	8	10	0.06
405-016-010-001	SBJ1010 - 40	75	14	17	20	40	10	10	0.06



# SRW ROUGHING BORING HEAD

SRW 大孔徑粗搪頭 (150mm 以上系列)



150mm  
~  
830mm

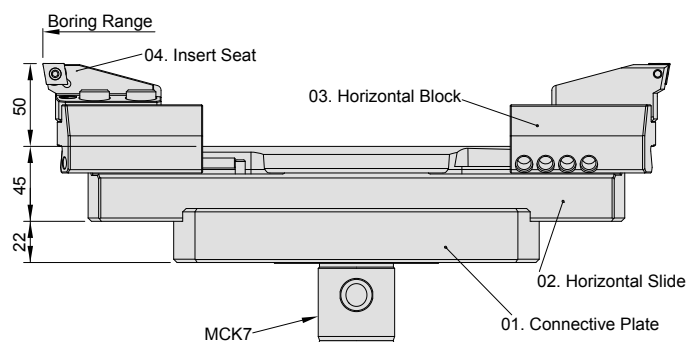

MODEL NO.	TYPE	BORING RANGE		01. CONNECTIVE PLATE	02. HORIZONTAL SLIDE	03. HORIZONTAL BLOCK	04. INSERT SEAT	WEIGHT (KGS)
		MIN.	MAX.					
5158-S18-150	SRW 150A	150	200	SFL135	SSL150 - 200	SCB150 - 200	SRW150A	7.24
5158-S18-200	SRW 200A	200	270	SFL135	SSL200 - 270	SCB200 - 550	SRW150A	8.85
5158-S18-270	SRW 270A	270	340	SFL135	SSL270 - 340	SCB200 - 550	SRW150A	10.3
5158-S18-340	SRW 340A	340	410	SFL135	SSL340 - 410	SCB200 - 550	SRW150A	11.8
5158-S18-410	SRW 410A	410	480	SFL135	SSL410 - 480	SCB200 - 550	SRW150A	13.2
5158-S18-480	SRW 480A	480	550	SFL135	SSL480 - 550	SCB200 - 550	SRW150A	14.7
5158-S18-550	SRW 550A	550	620	SFL220	SSL550 - 620	SCB200 - 550	SRW150A	18.6
5158-S18-620	SRW 620A	620	690	SFL220	SSL620 - 690	SCB200 - 550	SRW150A	20.1
5158-S18-690	SRW 690A	690	760	SFL220	SSL690 - 760	SCB200 - 550	SRW150A	21.5
5158-S18-760	SRW 760A	760	830	SFL220	SSL760 - 830	SCB200 - 550	SRW150A	22.9

## ACCESSORIES

INSERT	CLAMPING SCREW	WRENCH
CC..1204	M5-11-7.5-60	T20

### Features:

- ▶ Spare parts can be purchased individually.
- ▶ Boring range:  $\phi$  150mm ~  $\phi$  830mm

### Product information:

- ▶ Inserts are optional accessories. Needs to be purchased additionally.

# SMB SUPER MICRON EXCHANGEABLE FINISH BORING HEAD

SMB 大孔徑精搪頭 (150mm 以上系列)

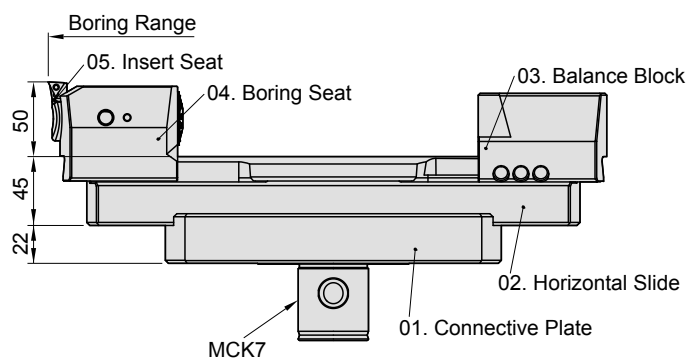

MODEL NO.	TYPE	01. CONNECTIVE PLATE	02. HORIZONTAL SLIDE	03. BALANCE BLOCK	04. BORING SEAT	05. INSERT SEAT	BORING RANGE	WEIGHT (KGS)
5158-657-150	SMB150	SFL135	SSL150~200	SWB150~200	SMB150L	SIC68-1	150~200	10.6
						SIC68-2	176~226	10.6
						SIC68-3	200~250	10.6
5158-657-200	SMB200	SFL135	SSL200~270	SWB200~550	SMB150L	SIC68-1	200~270	11.6
						SIC68-2	226~296	11.6
						SIC68-3	250~320	11.6
5158-657-270	SMB270	SFL135	SSL270~340	SWB200~550	SMB150L	SIC68-1	270~340	13.0
						SIC68-2	296~366	13.0
						SIC68-3	320~390	13.0
5158-657-340	SMB340	SFL135	SSL340~410	SWB200~550	SMB150L	SIC68-1	340~410	14.4
						SIC68-2	366~436	14.4
						SIC68-3	390~460	14.4
5158-657-410	SMB410	SFL135	SSL410~480	SWB200~550	SMB150L	SIC68-1	410~480	15.8
						SIC68-2	436~506	15.8
						SIC68-3	460~530	15.8
5158-657-480	SMB480	SFL135	SSL480~550	SWB200~550	SMB150L	SIC68-1	480~550	17.2
						SIC68-2	506~576	17.2
						SIC68-3	530~600	17.2
5158-657-550	SMB550	SFL220	SSL550~620	SWB200~550	SMB150L	SIC68-1	550~620	20.0
						SIC68-2	576~646	20.0
						SIC68-3	600~670	20.0
5158-657-620	SMB620	SFL220	SSL620~690	SWB200~550	SMB150L	SIC68-1	620~690	21.4
						SIC68-2	646~716	21.4
						SIC68-3	670~740	21.4
5158-657-690	SMB690	SFL220	SSL690~760	SWB200~550	SMB150L	SIC68-1	690~760	22.9
						SIC68-2	716~786	22.9
						SIC68-3	740~810	22.9
5158-657--760	SMB760	SFL220	SSL760~830	SWB200~550	SMB150L	SIC68-1	760~830	24.3
						SIC68-2	786~856	24.3
						SIC68-3	810~880	24.3

**ACCESSORIES**

INSERT	CLAMPING SCREW	WRENCH
TP..0902	M2.5-6.0-3.5-60	T8
TC..1102	M2.5-6.0-3.5-60	T8

**TYPES FOR INSERT SEAT:**

INSERT	DRAWING	INSERT	DRAWING
SIC68 - 1		SIC68 - 1E	
SIC68 - 2		SIC68 - 2E	
SIC68 - 3		SIC68 - 3E	



# PSC / PMB FINISH BORING HEAD

## ONE-PIECE TYPE

### PSC / PMB 超微米精搪頭[一體式]

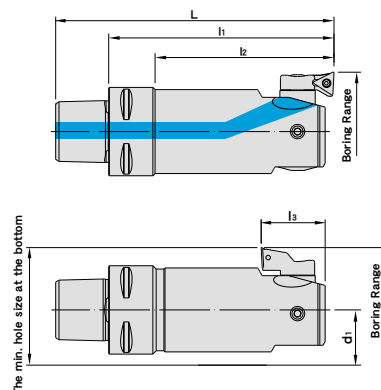

MODEL NO.	TYPE	INSERT SEAT	INSERT	INSERT SCREW	BORING AND PROCESSING AT FRONT					
					BORING RANGE	L	l <sub>1</sub>	l <sub>2</sub>	l <sub>3</sub>	d <sub>1</sub>
5140-544-032-085	PSC32 x PMB32 - 85	SIC32 - 1	TB..06 TP..08	M2.5-0-2.7-60	32 ~ 42	104	85	55	25	16
5140-544-032-085	PSC32 x PMB32 - 85	SIC32 - 2	TB..06 TP..08	M2.5-0-2.7-60	41 ~ 51	104	85	55	25	16
5140-544-032-085	PSC32 x PMB32 - 85	SIC32 - 3	TB..06 TP..08	M2.5-0-2.7-60	50 ~ 60	104	85	55	25	16
5141-544-041-102	PSC40 x PMB41 - 102	SIC41 - 1	TP..09 TC..11	M2.5-6.0-3.5-60	41 ~ 54	126	102	70	29	20
5141-544-041-102	PSC40 x PMB41 - 102	SIC41 - 2	TP..09 TC..11	M2.5-6.0-3.5-60	50 ~ 63	126	102	70	29	20
5141-544-041-102	PSC40 x PMB41 - 102	SIC41 - 3	TP..09 TC..11	M2.5-6.0-3.5-60	61 ~ 74	126	102	70	29	20
5142-544-053-112	PSC50 x PMB53 - 112	SIC53 - 1	TP..09 TC..11	M2.5-6.0-3.5-60	53 ~ 70	142	112	74	34	25.5
5142-544-053-112	PSC50 x PMB53 - 112	SIC53 - 2	TP..09 TC..11	M2.5-6.0-3.5-60	65 ~ 82	142	112	74	34	25.5
5142-544-053-112	PSC50 x PMB53 - 112	SIC53 - 3	TP..09 TC..11	M2.5-6.0-3.5-60	78 ~ 95	142	112	74	34	25.5
5143-544-068-140	PSC63 x PMB68 - 140	SIC68 - 1	TP..09 TC..11	M2.5-6.0-3.5-60	68 ~ 100	178	140	90.8	45.2	32.5
5143-544-068-140	PSC63 x PMB68 - 140	SIC68 - 2	TP..09 TC..11	M2.5-6.0-3.5-60	94 ~ 126	178	140	90.8	45.2	32.5
5143-544-068-140	PSC63 x PMB68 - 140	SIC68 - 3	TP..09 TC..11	M2.5-6.0-3.5-60	118 ~ 150	178	140	90.8	45.2	32.5

#### TYPES FOR INSERT SEAT:

TYPE	DRAWING	SUITABLE FINISH BORING HEAD	TYPE	DRAWING	SUITABLE FINISH BORING HEAD	STANDARD INSERT SEAT	OPTIONAL INSERT SEAT	
SIC32 - 1		PMB32	SIC32 - 1E		PMB32	SIC32 - 1	SIC32 - 2	SIC32 - 3
SIC32 - 2			SIC32 - 2E			$\psi 32 \sim \psi 42$	$\psi 41 \sim \psi 51$	$\psi 50 \sim \psi 60$
SIC32 - 3			SIC32 - 3E					
SIC41 - 1		PMB41	SIC41 - 1E		PMB41			
SIC41 - 2			SIC41 - 2E					
SIC41 - 3			SIC41 - 3E					
SIC53 - 1		PMB53	SIC53 - 1E		PMB53			
SIC53 - 2			SIC53 - 2E					
SIC53 - 3			SIC53 - 3E					
SIC68 - 1		PMB68	SIC68 - 1E		PMB68			
SIC68 - 2			SIC68 - 2E					
SIC68 - 3			SIC68 - 3E					

► For example: there are different boring ranges for different insert seats of PMB32.

#### Product information:

- ▶ With the design of PSC one piece boring head to lock with adapters, the total length is shorter than old design and the rigidity and stability are improved!
- ▶ The body of PMB Finish Boring Head is always designed to have coolant outlet.
- ▶ There are 3 types of insert seats and the boring range can be enlarged by exchanging another insert seat.
- ▶ SIC\_-1 insert seat is a standard accessory. SIC\_-2 and SIC\_-3 insert seats are optional accessories and need to be purchased additionally.
- ▶ Inserts are optional accessories. Needs to be purchased additionally.



# PSC / PCK ROUGH BORING HEAD

## ONE-PIECE TYPE

PSC / PCK 可調整式雙刃粗搪孔頭[一體式]

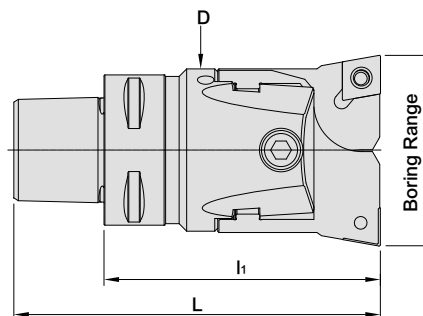

MODEL NO.	TYPE	BORING RANGE		L	l <sub>1</sub>	D	INSERT	SCREW	WRENCH	WEIGHT (KGS)
		MIN.	MAX.							
5140-543-039-080	PSC32 x PCK3950 - 80	39	50	99	80	32	CC..09T3	M4 - 10 - 5.7 - 60	T15	0.49
5141-543-049-082	PSC40 x PCK4965 - 82	49	65	106	82	42	CC..1204	M5 - 11 - 7.5 - 60	T20	0.49
5142-543-063-092	PSC50 x PCK6382 - 92	63	82	122	92	54	CC..1204	M5 - 11 - 7.5 - 60	T20	0.70
5143-543-080-140	PSC63 x PCK80102 - 140	80	102	178	140	68	CC..1204	M5 - 9.2 - 7.6 - 60	T20	3.60

**Product information:**

- ▶ With the design of PSC one piece boring head to lock with adapters, the total length is shorter than old design and the rigidity and stability are improved!
- ▶ Inserts are optional accessories. Needs to be purchased additionally.

# PSC / PBJ FINISH BORING HEAD

## ONE-PIECE TYPE

PSC / PBJ 高精密搪孔頭[一體式]

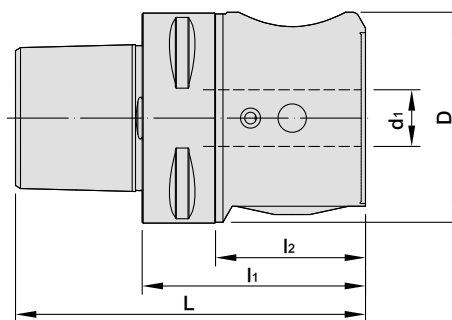

DE PAT NO. 202015103465  
JP PAT NO. 3200982

MODEL NO.	TYPE	L	l <sub>1</sub>	l <sub>2</sub>	D	d <sub>1</sub>	WEIGHT (KGS)
5141-542-010-049	PSC40 x PBJ10 - 48.5	72.5	48.5	28.5	39	10	0.49
5142-542-012-056	PSC50 x PBJ12 - 56	86	56	36	50	12	0.91
5143-542-016-067	PSC63 x PBJ16 - 67	105	67	45	63.5	16	1.76

For adapters, please refer to

Adapter	Page	Adapter	Page
BT	D-3	SCAT	D-7
CAT	D-4	SDAT	D-8
DAT	D-5	HSK	D-9
SBT	D-6		

**Product information:**

- ▶ Inserts are optional accessories. Needs to be purchased additionally.



# MEMO

Blank memo area consisting of 18 horizontal grey bars for writing.





# MCK BORING HEAD SHANK

BT / MCK BORING HEAD SHANK	C-3~C-7
CAT / MCK BORING HEAD SHANK	C-8
DAT / MCK BORING HEAD SHANK	C-9
SBT / MCK BORING HEAD SHANK	C-10~C-13
SCAT / MCK BORING HEAD SHANK	C-14
SDAT / MCK BORING HEAD SHANK	C-15
HSK / MCK BORING HEAD SHANK	C-16~C-17
PSC / MCK BORING HEAD SHANK	C-18~C-19
MCK EXTENSION SPACER	C-20
SIMPLIFIED TOOL PRESETTER FOR SRW & SMB BORING HEAD	C-21

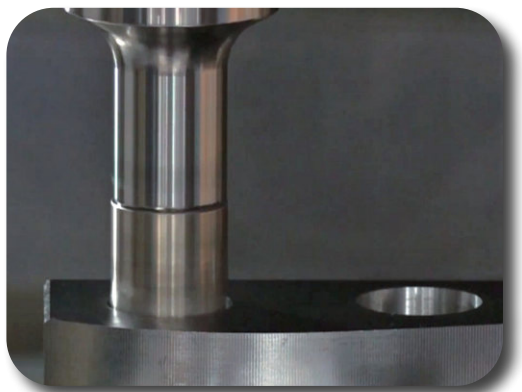

# MCK CONNECTION SYSTEM

## EXCELLENT CONTACT

- ▶ The 30° steep taper of set screw creates an radial and axial force after assembling, which results in excellent contact between boring head and shank.

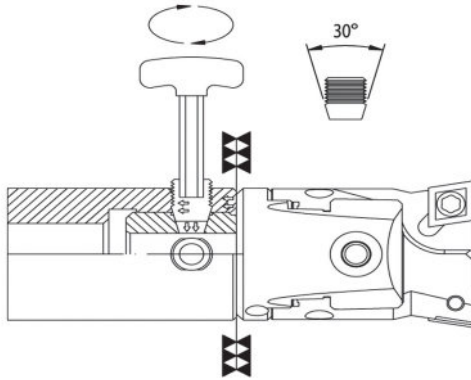

## MCK CONNECTION

- ▶ Two set screws form 90° with the drive keys of spindle, ensuring the retract position during boring process.

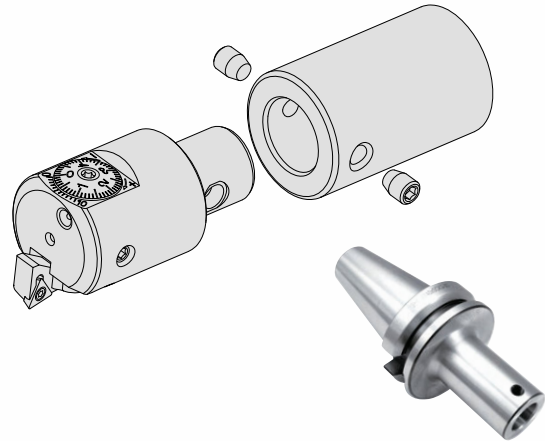

## MODULAR DESIGN

- ▶ MCK connection system is a flexible modular system and able to increase the length with extension spacers and change boring diameters conveniently by changing different boring heads for long overhanging boring operations.

**Extension spacer for same diameter**



**Extension spacer for different diameter**



..... Better rigidity for anti-vibration

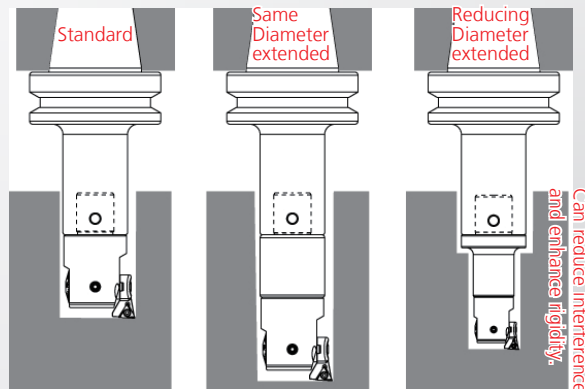

# BT / MCK BORING HEAD SHANK

## BT / MCK 搪孔刀桿

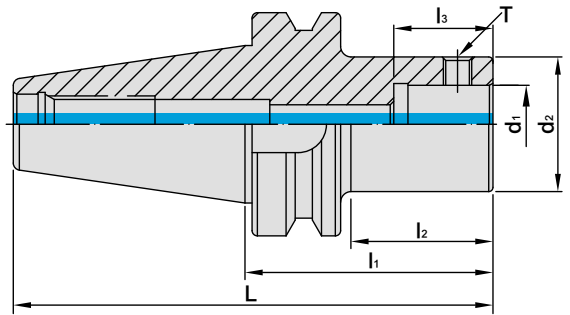

MODEL NO.	TYPE	L	l <sub>1</sub>	l <sub>2</sub>	l <sub>3</sub>	d <sub>1</sub>	d <sub>2</sub>	T	WEIGHT (KGS)
5010-487-001-055	BT30 x MCK1 - 55	103.4	55	28	18	11	19	M4 x 0.5P	0.70
5010-487-001-070	BT30 x MCK1 - 70	118.4	70	43	18	11	19	M4 x 0.5P	0.80
5010-487-002-060	BT30 x MCK2 - 60	108.4	60	33	18.5	14	23.5	M5 x 0.5P	0.80
5010-487-002-075	BT30 x MCK2 - 75	123.4	75	48	18.5	14	23.5	M5 x 0.5P	0.80
5010-487-002-080	BT30 x MCK2 - 80	128.4	80	53	18.5	14	23.5	M5 x 0.5P	0.81
5010-487-003-050	BT30 x MCK3 - 50	98.4	50	26	24	18	31	M6 x 0.75P	0.90
5010-487-003-080	BT30 x MCK3 - 80	128.4	80	56	24	18	31	M6 x 0.75P	0.95
5010-487-004-060	BT30 x MCK4 - 60	108.4	60	37	28	22	39	M8 x 0.75P	1.00
5010-487-004-070	BT30 x MCK4 - 70	118.4	70	47	29	22	39	M8 x 0.75P	1.00
5010-487-005-070	BT30 x MCK5 - 70	118.4	70	47	35	28	50	M10 x 1.0P	1.10
5010-487-006-060	BT30 x MCK6 - 60	108.4	60	38	42	36	63	M12 x 1.0P	1.20

### Features:

- ▶ Internal tolerance is H6.
- ▶ Center though coolant supply is available.
- ▶ MAS/BT30 tool holders are without coolant supply over collars.



# BT / MCK BORING HEAD SHANK

## BT / MCK 搪孔刀桿



Fig.1

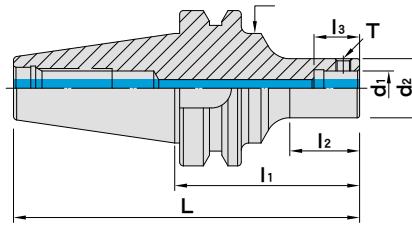
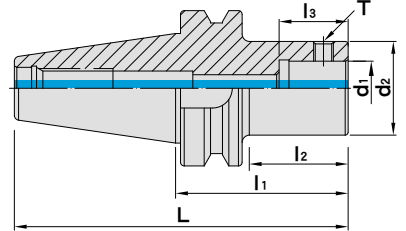

Fig.2



MODEL NO.	TYPE	L	l <sub>1</sub>	l <sub>2</sub>	l <sub>3</sub>	d <sub>1</sub>	d <sub>2</sub>	d <sub>3</sub>	T	Fig	WEIGHT (KGS)
5011-487-001-100	BT40 x MCK1 - 100	165.4	100	51	18	11	19	44.45	M4 x 0.5P	1	1.20
5011-487-001-115	BT40 x MCK1 - 115	180.4	115	66	18	11	19	44.45	M4 x 0.5P	1	1.30
5011-487-002-075	BT40 x MCK2 - 75	140.4	75	28	18.5	14	23.5	44.45	M5 x 0.5P	1	1.14
5011-487-002-085	BT40 x MCK2 - 85	150.4	85	38	18.5	14	23.5	44.45	M5 x 0.5P	1	1.24
5011-487-002-115	BT40 x MCK2 - 115	180.4	115	68	18.5	14	23.5	44.45	M5 x 0.5P	1	1.30
5011-487-002-175	BT40 x MCK2 - 175	240.4	175	128	18.5	14	23.5	44.45	M5 x 0.5P	1	1.40
5011-487-003-080	BT40 x MCK3 - 80	145.4	80	48	24	18	31	-	M6 x 0.75P	2	3.90
5011-487-003-095	BT40 x MCK3 - 95	160.4	95	63	24	18	31	-	M6 x 0.75P	2	4.00
5011-487-003-125	BT40 x MCK3 - 125	190.4	125	93	24	18	31	-	M6 x 0.75P	2	4.10
5011-487-003-155	BT40 x MCK3 - 155	220.4	155	123	24	18	31	-	M6 x 0.75P	2	4.00
5011-487-003-200	BT40 x MCK3 - 200	265.4	200	168	24	18	31	-	M6 x 0.75P	2	4.10
5011-487-004-070	BT40 x MCK4 - 70	135.4	70	40	28	22	39	-	M8 x 0.75P	2	4.20
5011-487-004-100	BT40 x MCK4 - 100	165.4	100	70	28	22	39	-	M8 x 0.75P	2	4.40
5011-487-004-120	BT40 x MCK4 - 120	185.4	120	85	28	22	39	-	M8 x 0.75P	2	4.50
5011-487-004-130	BT40 x MCK4 - 130	195.4	130	98	28	22	39	-	M8 x 0.75P	2	1.66
5011-487-004-150	BT40 x MCK4 - 150	215.4	150	115	28	22	39	-	M8 x 0.75P	2	1.70
5011-487-004-175	BT40 x MCK4 - 175	240.4	175	143	28	22	39	-	M8 x 0.75P	2	1.76
5011-487-004-195	BT40 x MCK4 - 195	260.4	195	163	28	22	39	-	M8 x 0.75P	2	1.80

### Features:

- ▶ Internal tolerance is H6.
- ▶ Center though coolant supply is available.
- ▶ AD+B type is available, please inform us when making an order.

# BT / MCK BORING HEAD SHANK

## BT / MCK 搪孔刀桿

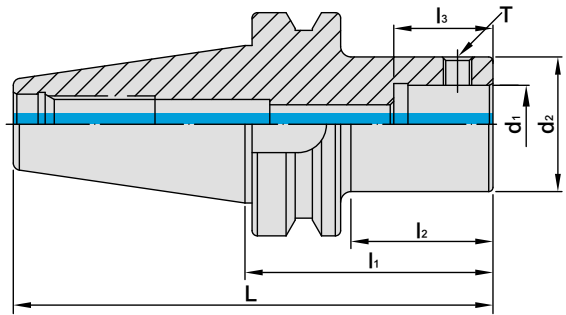

MODEL NO.	TYPE	L	l <sub>1</sub>	l <sub>2</sub>	l <sub>3</sub>	d <sub>1</sub>	d <sub>2</sub>	T	WEIGHT (KGS)
5011-487-005-060	BT40 x MCK5 - 60	125.4	60	30	35	28	50	M10 x 1.0P	1.30
5011-487-005-080	BT40 x MCK5 - 80	145.4	80	51	35	28	50	M10 x 1.0P	1.60
5011-487-005-100	BT40 x MCK5 - 100	165.4	100	70	35	28	50	M10 x 1.0P	1.65
5011-487-005-120	BT40 x MCK5 - 120	185.4	120	90	35	28	50	M10 x 1.0P	1.69
5011-487-005-125	BT40 x MCK5 - 125	190.4	125	96	35	28	50	M10 x 1.0P	1.70
5011-487-005-150	BT40 x MCK5 - 150	215.4	150	120	35	28	50	M10 x 1.0P	1.80
5011-487-005-175	BT40 x MCK5 - 175	240.4	175	146	35	28	50	M10 x 1.0P	1.90
5011-487-006-055	BT40 x MCK6 - 55	120.4	55	28	42	36	63	M12 x 1.0P	2.15
5011-487-006-065	BT40 x MCK6 - 65	130.4	65	38	42	36	63	M12 x 1.0P	2.20
5011-487-006-100	BT40 x MCK6 - 100	165.4	100	73	42	36	63	M12 x 1.0P	2.30
5011-487-006-115	BT40 x MCK6 - 115	180.4	115	88	42	36	63	M12 x 1.0P	2.40
5011-487-006-120	BT40 x MCK6 - 120	185.4	120	93	42	36	63	M12 x 1.0P	2.41
5011-487-006-150	BT40 x MCK6 - 150	215.4	150	123	42	36	63	M12 x 1.0P	2.45
5011-487-006-165	BT40 x MCK6 - 165	230.4	165	138	42	36	63	M12 x 1.0P	2.50

### Features:

- ▶ Internal tolerance is H6.
- ▶ Center through coolant supply is available.
- ▶ AD+B type is available, please inform us when making an order.



# BT / MCK BORING HEAD SHANK

## BT / MCK 搪孔刀桿



Fig.1

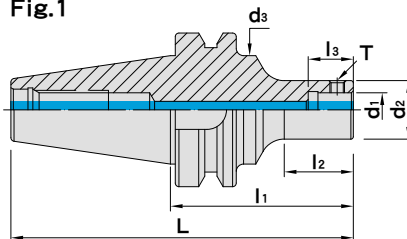
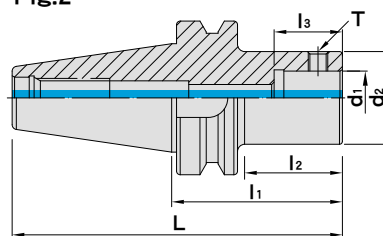

Fig.2



MODEL NO.	TYPE	L	l <sub>1</sub>	l <sub>2</sub>	l <sub>3</sub>	d <sub>1</sub>	d <sub>2</sub>	d <sub>3</sub>	T	Fig	WEIGHT (KGS)
5012-487-001-105	BT50 x MCK1 - 105	206.8	105	38	18	11	19	69.85	M4 x 0.5P	1	3.90
5012-487-001-115	BT50 x MCK1 - 115	216.8	115	48	18	11	19	69.85	M4 x 0.5P	1	4.00
5012-487-001-145	BT50 x MCK1 - 145	246.8	145	78	18	11	19	69.85	M4 x 0.5P	1	4.10
5012-487-002-105	BT50 x MCK2 - 105	206.8	105	39	18.5	14	23.5	69.85	M5 x 0.5P	1	4.00
5012-487-002-135	BT50 x MCK2 - 135	236.8	135	67	18.5	14	23.5	69.85	M5 x 0.5P	1	4.10
5012-487-002-140	BT50 x MCK2 - 140	241.8	140	74	18.5	14	23.5	69.85	M5 x 0.5P	1	4.20
5012-487-002-175	BT50 x MCK2 - 175	276.8	175	109	18.5	14	23.5	69.85	M5 x 0.5P	1	4.40
5012-487-002-225	BT50 x MCK2 - 225	326.8	225	159	18.5	14	23.5	69.85	M5 x 0.5P	1	4.50
5012-487-003-110	BT50 x MCK3 - 110	211.8	110	62	24	18	31	-	M6 x 0.75P	2	4.40
5012-487-003-140	BT50 x MCK3 - 140	241.8	140	92	24	18	31	-	M6 x 0.75P	2	4.60
5012-487-003-155	BT50 x MCK3 - 155	256.8	155	107	24	18	31	-	M6 x 0.75P	2	4.80
5012-487-003-200	BT50 x MCK3 - 200	301.8	200	152	24	18	31	-	M6 x 0.75P	2	5.00
5012-487-003-240	BT50 x MCK3 - 240	341.8	240	192	24	18	31	-	M6 x 0.75P	2	5.20
5012-487-004-100	BT50 x MCK4 - 100	201.8	100	52	28	22	39	-	M8 x 0.75P	2	4.80
5012-487-004-160	BT50 x MCK4 - 160	261.8	160	112	28	22	39	-	M8 x 0.75P	2	5.20
5012-487-004-175	BT50 x MCK4 - 175	276.8	175	127	28	22	39	-	M8 x 0.75P	2	2.30
5012-487-004-205	BT50 x MCK4 - 205	306.8	205	160	28	22	39	-	M8 x 0.75P	2	5.40
5012-487-004-235	BT50 x MCK4 - 235	336.8	235	187	28	22	39	-	M8 x 0.75P	2	5.50
5012-487-004-265	BT50 x MCK4 - 265	366.8	265	217	28	22	39	-	M8 x 0.75P	2	5.60

### Features:

- ▶ Internal tolerance is H6.
- ▶ Center though coolant supply is available.
- ▶ AD+B type is available, please inform us when making an order.

# BT / MCK BORING HEAD SHANK

## BT / MCK 搪孔刀桿

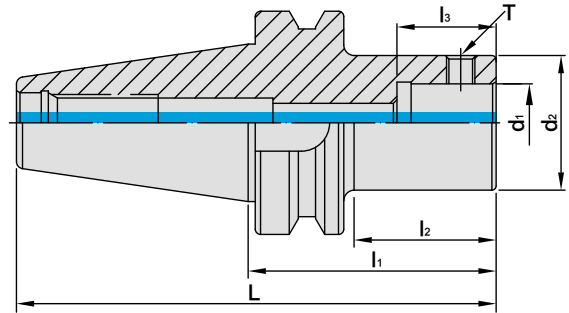

MODEL NO.	TYPE	L	l <sub>1</sub>	l <sub>2</sub>	l <sub>3</sub>	d <sub>1</sub>	d <sub>2</sub>	T	WEIGHT (KGS)
5012-487-005-090	BT50 x MCK5 - 90	191.8	90	42	35	28	50	M10 x 1.0P	5.40
5012-487-005-105	BT50 x MCK5 - 105	206.8	105	57	35	28	50	M10 x 1.0P	5.60
5012-487-005-110	BT50 x MCK5 - 110	211.8	110	62	35	28	50	M10 x 1.0P	5.70
5012-487-005-165	BT50 x MCK5 - 165	266.8	165	117	35	28	50	M10 x 1.0P	6.20
5012-487-005-185	BT50 x MCK5 - 185	286.8	185	137	35	28	50	M10 x 1.0P	6.30
5012-487-005-210	BT50 x MCK5 - 210	311.8	210	162	35	28	50	M10 x 1.0P	6.40
5012-487-005-240	BT50 x MCK5 - 240	341.8	240	192	35	28	50	M10 x 1.0P	6.60
5012-487-005-265	BT50 x MCK5 - 265	366.8	265	217	35	28	50	M10 x 1.0P	6.70
5012-487-005-300	BT50 x MCK5 - 300	401.8	300	252	35	28	50	M10 x 1.0P	6.80
5012-487-006-085	BT50 x MCK6 - 85	186.8	85	37	42	36	63	M12 x 1.0P	5.90
5012-487-006-155	BT50 x MCK6 - 155	256.8	155	107	42	36	63	M12 x 1.0P	6.50
5012-487-006-215	BT50 x MCK6 - 215	316.8	215	167	42	36	63	M12 x 1.0P	6.90
5012-487-006-240	BT50 x MCK6 - 240	341.8	240	192	42	36	63	M12 x 1.0P	6.95
5012-487-006-265	BT50 x MCK6 - 265	366.8	265	217	42	36	63	M12 x 1.0P	7.00
5012-487-006-290	BT50 x MCK6 - 290	391.8	290	242	42	36	63	M12 x 1.0P	7.10
5012-487-006-300	BT50 x MCK6 - 300	401.8	300	252	42	36	63	M12 x 1.0P	7.12
5012-487-006-350	BT50 x MCK6 - 350	451.8	350	302	42	36	63	M12 x 1.0P	7.50
5012-487-007-093	BT50 x MCK7 - 93	194.8	93	52	52	46	90	M20 x 1.5P	5.00
5012-487-007-183	BT50 x MCK7 - 183	284.8	183	142	52	46	90	M20 x 1.5P	9.40
5012-487-007-243	BT50 x MCK7 - 243	344.8	243	202	52	46	90	M20 x 1.5P	6.90

### Features:

- ▶ Internal tolerance is H6.
- ▶ Center through coolant supply is available.
- ▶ AD+B type is available, please inform us when making an order.



# CAT / MCK BORING HEAD SHANK

## CAT / MCK 搪孔刀桿

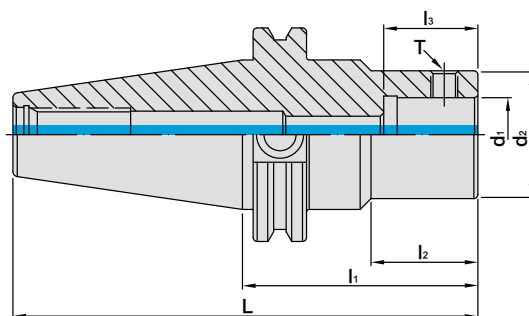

### INCHES

MODEL NO.	TYPE	L	l <sub>1</sub>	l <sub>2</sub>	l <sub>3</sub>	d <sub>1</sub>	d <sub>2</sub>	T	WEIGHT (KGS)
5031-487-001-076	CAT40 x MCK1 - 3"	5.687	3	1.105	0.708	0.433	0.748	M4 x 0.5P	1.20
5031-487-001-095	CAT40 x MCK1 - 3.75"	6.437	3.75	1.856	0.708	0.433	0.748	M4 x 0.5P	1.25
5031-487-002-076	CAT40 x MCK2 - 3"	5.687	3	1.39	0.728	0.551	0.925	M5 x 0.5P	1.30
5031-487-002-110	CAT40 x MCK2 - 4.35"	7.037	4.35	2.656	0.728	0.551	0.925	M5 x 0.5P	1.35
5031-487-003-076	CAT40 x MCK3 - 3"	5.687	3	1.356	0.945	0.709	1.22	M6 x 0.75P	1.40
5031-487-003-127	CAT40 x MCK3 - 5"	7.687	5	3.36	0.945	0.709	1.22	M6 x 0.75P	1.45
5031-487-004-076	CAT40 x MCK4 - 3"	5.687	3	1.515	1.102	0.866	1.535	M8 x 0.75P	1.50
5031-487-004-108	CAT40 x MCK4 - 4.25"	6.937	4.25	2.765	1.102	0.866	1.535	M8 x 0.75P	1.55
5031-487-005-076	CAT40 x MCK5 - 3"	5.687	3	2.219	1.378	1.102	1.969	M10 x 1.0P	1.60
5031-487-005-108	CAT40 x MCK5 - 4.25"	6.937	4.25	3.469	1.378	1.102	1.969	M10 x 1.0P	1.65
5031-487-006-076	CAT40 x MCK6 - 3"	5.687	3	2.219	1.653	1.417	2.48	M12 x 1.0P	1.70
5031-487-006-108	CAT40 x MCK6 - 4.25"	6.937	4.25	3.469	1.653	1.417	2.48	M12 x 1.0P	1.75
5032-487-001-089	CAT50 x MCK1 - 3.5"	7.5	3.5	1.317	0.708	0.433	0.748	M4 x 0.5P	3.30
5032-487-001-102	CAT50 x MCK1 - 4"	8	4	1.817	0.708	0.433	0.748	M4 x 0.5P	3.35
5032-487-002-089	CAT50 x MCK2 - 3.5"	7.5	3.5	1.368	0.728	0.551	0.925	M5 x 0.5P	3.40
5032-487-002-135	CAT50 x MCK2 - 5.3"	9.3	5.3	3.167	0.728	0.551	0.925	M5 x 0.5P	3.45
5032-487-003-089	CAT50 x MCK3 - 3.5"	7.5	3.5	1.453	0.945	0.709	1.22	M6 x 0.75P	3.50
5032-487-003-140	CAT50 x MCK3 - 5.5"	9.5	5.5	3.453	0.945	0.709	1.22	M6 x 0.75P	3.55
5032-487-004-089	CAT50 x MCK4 - 3.5"	7.5	3.5	1.544	1.102	0.866	1.535	M8 x 0.75P	3.60
5032-487-004-140	CAT50 x MCK4 - 5.5"	9.5	5.5	3.544	1.102	0.866	1.535	M8 x 0.75P	3.65
5032-487-005-089	CAT50 x MCK5 - 3.5"	7.5	3.5	1.669	1.378	1.102	1.969	M10 x 1.0P	3.70
5032-487-005-140	CAT50 x MCK5 - 5.5"	9.5	5.5	3.669	1.378	1.102	1.969	M10 x 1.0P	3.75
5032-487-006-089	CAT50 x MCK6 - 3.5"	7.5	3.5	1.988	1.653	1.417	2.48	M12 x 1.0P	3.80
5032-487-006-140	CAT50 x MCK6 - 5.5"	9.5	5.5	3.987	1.653	1.417	2.48	M12 x 1.0P	3.85
5032-487-007-095	CAT50 x MCK7-3.74"	7.74	3.74	2.362	2.047	1.811	3.54	M20 x 1.5P	5.00

#### Features:

- ▶ Internal tolerance is H6.
- ▶ Center though coolant supply is available.
- ▶ AD+B type is available, please inform us when making an order.



# DAT / MCK BORING HEAD SHANK

## DAT / MCK 搪孔刀桿

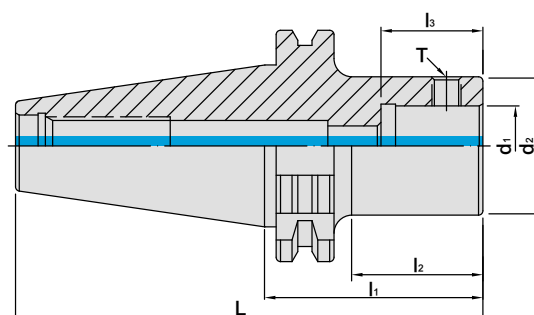

MODEL NO.	TYPE	L	l <sub>1</sub>	l <sub>2</sub>	l <sub>3</sub>	d <sub>1</sub>	d <sub>2</sub>	T	WEIGHT (KGS)
5050-487-001-050	DAT30 x MCK1 - 50	97.8	50	27.9	18	11	19	M4 x 0.5P	0.60
5050-487-002-065	DAT30 x MCK2 - 65	112.8	65	42.9	18.5	14	23.5	M5 x 0.5P	0.70
5050-487-003-050	DAT30 x MCK3 - 50	97.8	50	27.9	24	18	31	M6 x 0.75P	0.80
5050-487-004-050	DAT30 x MCK4 - 50	97.8	50	27.9	28	22	39	M8 x 0.75P	1.30
5051-487-001-080	DAT40 x MCK1 - 80	148.4	80	50.9	18	11	19	M4 x 0.5P	1.00
5051-487-001-095	DAT40 x MCK1 - 95	163.4	95	65.9	18	11	19	M4 x 0.5P	1.05
5051-487-002-080	DAT40 x MCK2 - 80	148.4	80	50.9	18.5	14	23.5	M5 x 0.5P	1.10
5051-487-002-110	DAT40 x MCK2 - 110	178.4	110	80.9	18.5	14	23.5	M5 x 0.5P	1.15
5051-487-003-090	DAT40 x MCK3 - 90	158.4	90	65.9	24	18	31	M6 x 0.75P	1.20
5051-487-003-125	DAT40 x MCK3 - 125	193.4	125	100.9	24	18	31	M6 x 0.75P	1.25
5051-487-004-080	DAT40 x MCK4 - 80	148.4	80	55.9	28	22	39	M8 x 0.75P	1.30
5051-487-004-110	DAT40 x MCK4 - 110	178.4	110	85.9	28	22	39	M8 x 0.75P	1.35
5051-487-005-095	DAT40 x MCK5 - 95	163.4	95	75.4	35	28	50	M10 x 1.0P	1.40
5051-487-005-110	DAT40 x MCK5 - 110	178.4	110	90.4	35	28	50	M10 x 1.0P	1.45
5051-487-006-065	DAT40 x MCK6 - 65	133.4	65	45.4	42	36	63	M12 x 1.0P	1.50
5051-487-006-095	DAT40 x MCK6 - 95	163.4	95	75.4	42	36	63	M12 x 1.0P	1.55
5052-487-001-110	DAT50 x MCK1 - 110	211.75	110	80.9	18	11	19	M4 x 0.5P	3.10
5052-487-001-125	DAT50 x MCK1 - 125	226.75	125	95.9	18	11	19	M4 x 0.5P	3.15
5052-487-002-095	DAT50 x MCK2 - 95	196.75	95	65.9	18.5	14	23.5	M5 x 0.5P	3.20
5052-487-002-125	DAT50 x MCK2 - 125	226.75	125	95.9	18.5	14	23.5	M5 x 0.5P	3.25
5052-487-003-125	DAT50 x MCK3 - 125	226.75	125	95.9	24	18	31	M6 x 0.75P	3.30
5052-487-003-155	DAT50 x MCK3 - 155	256.75	155	125.9	24	18	31	M6 x 0.75P	3.35
5052-487-004-110	DAT50 x MCK4 - 110	211.75	110	80.9	28	22	39	M8 x 0.75P	3.40
5052-487-004-125	DAT50 x MCK4 - 125	226.75	125	95.9	28	22	39	M8 x 0.75P	3.45
5052-487-005-065	DAT50 x MCK5 - 65	166.75	65	35.9	35	28	50	M10 x 1.0P	3.50
5052-487-005-140	DAT50 x MCK5 - 140	241.75	140	110.9	35	28	50	M10 x 1.0P	3.55
5052-487-006-140	DAT50 x MCK6 - 140	241.75	140	110.9	42	36	63	M12 x 1.0P	3.60
5052-487-006-170	DAT50 x MCK6 - 170	271.75	170	140.9	42	36	63	M12 x 1.0P	3.65
5052-487-007-095	DAT50 x MCK7-95	196.75	95	60	52	46	90	M20 x 1.5P	5.00

### Features:

- ▶ Internal tolerance is H6.
- ▶ Center through coolant supply is available.
- ▶ AD+B type is available, please inform us when making an order.
- ▶ DAT30 tool holders are without coolant supply over collars.



# SBT / MCK BORING HEAD SHANK

Dual  
DRIVE+

SBT / MCK 法蘭加厚型搪孔刀桿

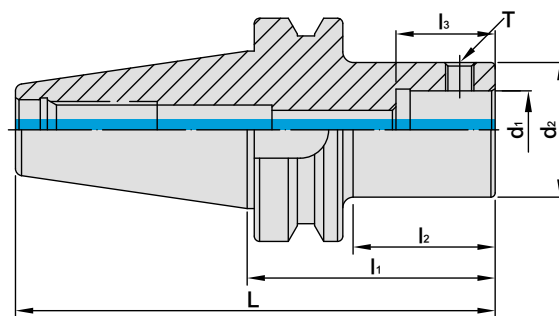

MODEL NO.	TYPE	L	l <sub>1</sub>	l <sub>2</sub>	l <sub>3</sub>	d <sub>1</sub>	d <sub>2</sub>	T	WEIGHT (KGS)
5025-487-001-055	SBT30 x MCK1 - 55	103.4	55	28	18	11	19	M4 x 0.5P	0.70
5025-487-001-070	SBT30 x MCK1 - 70	118.4	70	43	18	11	19	M4 x 0.5P	0.80
5025-487-002-060	SBT30 x MCK2 - 60	108.4	60	33	18.5	14	23.5	M5 x 0.5P	0.80
5025-487-002-075	SBT30 x MCK2 - 75	123.4	75	48	18.5	14	23.5	M5 x 0.5P	0.80
5025-487-002-080	SBT30 x MCK2 - 80	128.4	80	53	18.5	14	23.5	M5 x 0.5P	0.85
5025-487-003-050	SBT30 x MCK3 - 50	98.4	50	26	24	18	31	M6 x 0.75P	0.90
5025-487-003-080	SBT30 x MCK3 - 80	128.4	80	56	24	18	31	M6 x 0.75P	0.95
5025-487-004-060	SBT30 x MCK4 - 60	108.4	60	37	28	22	39	M8 x 0.75P	1.00
5025-487-004-070	SBT30 x MCK4 - 70	118.4	70	47	28	22	39	M8 x 0.75P	1.00
5025-487-005-070	SBT30 x MCK5 - 70	118.4	70	47	35	28	50	M10 x 1.0P	1.10
5025-487-006-060	SBT30 x MCK6 - 60	108.4	60	38	42	36	63	M12 x 1.0P	1.20
5026-487-003-080	SBT40 x MCK3 - 80	145.4	80	48	24	18	31	M6 x 0.75P	1.22
5026-487-003-095	SBT40 x MCK3 - 95	160.4	95	63	24	18	31	M6 x 0.75P	1.24
5026-487-003-125	SBT40 x MCK3 - 125	190.4	125	93	24	18	31	M6 x 0.75P	1.30
5026-487-003-155	SBT40 x MCK3 - 155	220.4	155	123	24	18	31	M6 x 0.75P	1.40
5026-487-004-070	SBT40 x MCK4 - 70	135.4	70	40	28	22	39	M8 x 0.75P	1.50
5026-487-004-100	SBT40 x MCK4 - 100	165.4	100	70	28	22	39	M8 x 0.75P	1.56
5026-487-004-130	SBT40 x MCK4 - 130	195.4	130	98	28	22	39	M8 x 0.75P	1.60
5026-487-004-175	SBT40 x MCK4 - 175	240.4	175	143	28	22	39	M8 x 0.75P	1.70
5026-487-005-060	SBT40 x MCK5 - 60	125.4	60	30	35	28	50	M10 x 1.0P	1.30
5026-487-005-080	SBT40 x MCK5 - 80	145.4	80	51	35	28	50	M10 x 1.0P	1.60
5026-487-005-125	SBT40 x MCK5 - 125	190.4	125	96	35	28	50	M10 x 1.0P	1.70
5026-487-005-175	SBT40 x MCK5 - 175	240.4	175	146	35	28	50	M10 x 1.0P	1.80
5026-487-006-055	SBT40 x MCK6 - 55	120.4	55	28	42	36	63	M12 x 1.0P	2.15
5026-487-006-065	SBT40 x MCK6 - 65	130.4	65	38	42	36	63	M12 x 1.0P	2.20
5026-487-006-115	SBT40 x MCK6 - 115	170.4	115	88	42	36	63	M12 x 1.0P	2.30
5026-487-006-165	SBT40 x MCK6 - 165	230.4	165	138	42	36	63	M12 x 1.0P	2.50

**Features:**

- ▶ Internal tolerance is H6.
- ▶ Center through coolant supply is available.
- ▶ AD+B type is available, please inform us when making an order.
- ▶ SBT30 tool holders are without coolant supply over collars.

# SBT / MCK BORING HEAD SHANK

Dual  
DRIVE+

SBT / MCK 法蘭加厚型搪孔刀桿

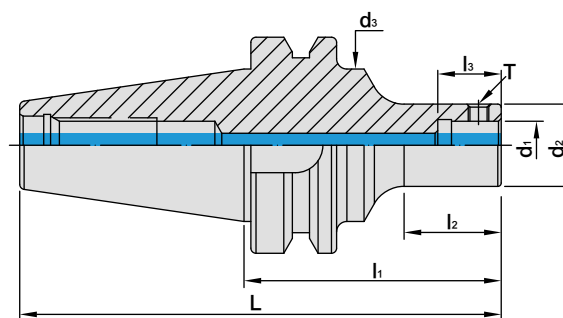

MODEL NO.	TYPE	L	l <sub>1</sub>	l <sub>2</sub>	l <sub>3</sub>	d <sub>1</sub>	d <sub>2</sub>	d <sub>3</sub>	T	WEIGHT (KGS)
5026-487-001-100	SBT40 x MCK1 - 100	165.4	100	51	18	11	19	44.45	M4 x 0.5P	1.20
5026-487-001-115	SBT40 x MCK1 - 115	180.4	115	66	18	11	19	44.45	M4 x 0.5P	1.30
5026-487-002-075	SBT40 x MCK2 - 75	140.4	75	28	18.5	14	23.5	44.45	M5 x 0.5P	1.14
5026-487-002-085	SBT40 x MCK2 - 85	150.4	85	38	18.5	14	23.5	44.45	M5 x 0.5P	1.20
5026-487-002-115	SBT40 x MCK2 - 115	180.4	115	68	18.5	14	23.5	44.45	M5 x 0.5P	1.25
5027-487-001-105	SBT50 x MCK1 - 105	206.8	105	38	18	11	19	69.85	M4 x 0.5P	3.90
5027-487-001-115	SBT50 x MCK1 - 115	216.8	115	48	18	11	19	69.85	M4 x 0.5P	4.00
5027-487-001-145	SBT50 x MCK1 - 145	246.8	145	97	18	11	19	69.85	M4 x 0.5P	4.10
5027-487-002-105	SBT50 x MCK2 - 105	206.8	105	39	18.5	14	23.5	69.85	M5 x 0.5P	4.00
5027-487-002-135	SBT50 x MCK2 - 135	236.8	135	67	18.5	14	23.5	69.85	M5 x 0.5P	4.10
5027-487-002-140	SBT50 x MCK2 - 140	241.8	140	72	18.5	14	23.5	69.85	M5 x 0.5P	4.20

#### Features:

- ▶ Internal tolerance is H6.
- ▶ Center though coolant supply is available.
- ▶ AD+B type is available, please inform us when making an order.



# SBT / MCK BORING HEAD SHANK

Dual  
DRIVE+



SBT / MCK 法蘭加厚型搪孔刀桿

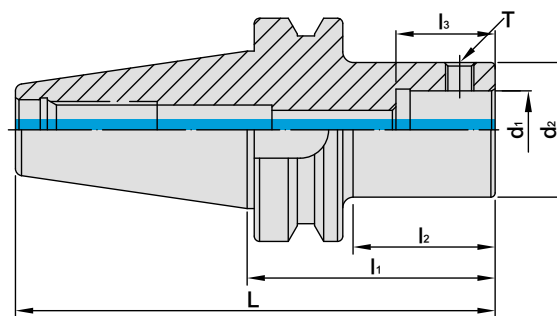

MODEL NO.	TYPE	L	l <sub>1</sub>	l <sub>2</sub>	l <sub>3</sub>	d <sub>1</sub>	d <sub>2</sub>	T	WEIGHT (KGS)
5027-487-003-110	SBT50 x MCK3 - 110	211.8	110	62	24	18	31	M6 x 0.75P	4.40
5027-487-003-140	SBT50 x MCK3 - 140	241.8	140	92	24	18	31	M6 x 0.75P	4.60
5027-487-003-155	SBT50 x MCK3 - 155	256.8	155	107	24	18	31	M6 x 0.75P	4.80
5027-487-004-100	SBT50 x MCK4 - 100	201.8	100	52	28	22	39	M8 x 0.75P	4.80
5027-487-004-160	SBT50 x MCK4 - 160	261.8	160	112	28	22	39	M8 x 0.75P	5.20
5027-487-004-175	SBT50 x MCK4 - 175	276.8	175	127	28	22	39	M8 x 0.75P	2.30
5027-487-004-205	SBT50 x MCK4 - 205	306.8	205	205	28	22	39	M8 x 0.75P	5.40
5027-487-005-090	SBT50 x MCK5 - 90	191.8	90	42	35	28	50	M10 x 1.0P	5.40
5027-487-005-105	SBT50 x MCK5 - 105	206.8	105	57	35	28	50	M10 x 1.0P	5.60
5027-487-005-165	SBT50 x MCK5 - 165	266.8	165	117	35	28	50	M10 x 1.0P	6.20
5027-487-005-210	SBT50 x MCK5 - 210	311.8	210	162	35	28	50	M10 x 1.0P	6.40
5027-487-005-240	SBT50 x MCK5 - 240	341.8	240	192	35	28	50	M10 x 1.0P	6.60
5027-487-005-300	SBT50 x MCK5 - 300	401.8	300	252	35	28	50	M10 x 1.0P	6.80
5027-487-006-085	SBT50 x MCK6 - 85	186.8	85	37	42	36	63	M12 x 1.0P	5.90
5027-487-006-155	SBT50 x MCK6 - 155	256.8	155	107	42	36	63	M12 x 1.0P	6.50
5027-487-006-215	SBT50 x MCK6 - 215	316.8	215	167	42	36	63	M12 x 1.0P	6.90
5027-487-007-180	SBT50 x MCK7 - 180	281.8	180	139	52	46	90	M20 x 1.5P	5.00
5027-487-007-330	SBT50 x MCK7 - 330	431.8	330	289	52	46	90	M20 x 1.5P	12.5

#### Features:

- ▶ Internal tolerance is H6.
- ▶ Center through coolant supply is available.
- ▶ AD+B type is available, please inform us when making an order.

# SBT / MCK BORING HEAD SHANK

Dual  
DRIVE+

SBT / MCK 法蘭加厚型搪孔刀桿

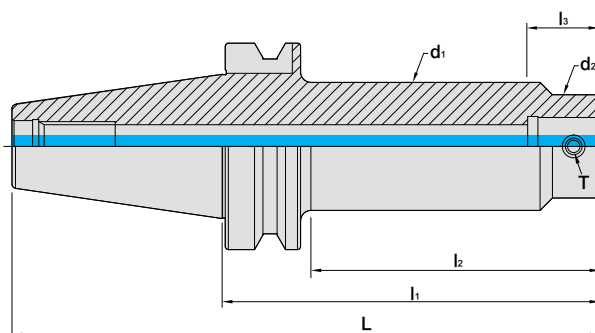

MODEL NO.	TYPE	L	l <sub>1</sub>	l <sub>2</sub>	l <sub>3</sub>	d <sub>1</sub>	d <sub>2</sub>	T	WEIGHT (KGS)
5027-491-004-193	SBT50 x MCK4 - 193BG	294.8	193	150	28	48	39	M8 x 0.75P	5.50
5027-491-004-238	SBT50 x MCK4 - 238BG	339.8	238	195	28	48	39	M8 x 0.75P	6.10
5027-491-005-243	SBT50 x MCK5 - 243BG	344.8	243	200	35	62	50	M10 x 1.0P	8.10
5027-491-005-303	SBT50 x MCK5 - 303BG	404.8	303	260	35	62	50	M10 x 1.0P	9.50
5027-491-006-259	SBT50 x MCK6 - 259BG	360.8	259	216	42	72	63	M12 x 1.0P	10.3
5027-491-006-314	SBT50 x MCK6 - 314BG	415.8	314	271	42	72	63	M12 x 1.0P	12.0
5027-491-006-289	SBT50 x MCK6 - 289BG	390.8	289	246	42	80	63	M12 x 1.0P	12.9
5027-491-006-349	SBT50 x MCK6 - 349BG	450.8	349	306	42	80	63	M12 x 1.0P	15.2

#### Features:

- ▶ Internal tolerance is H6.
- ▶ Center through coolant supply is available.
- ▶ The shank with the step design of outside diameter, improve the machining rigidity.
- ▶ AD+B type is available, please inform us when making an order.



# SCAT / MCK BORING HEAD SHANK

Dual  
DRIVE+

SCAT / MCK 法蘭加厚型搪孔刀桿

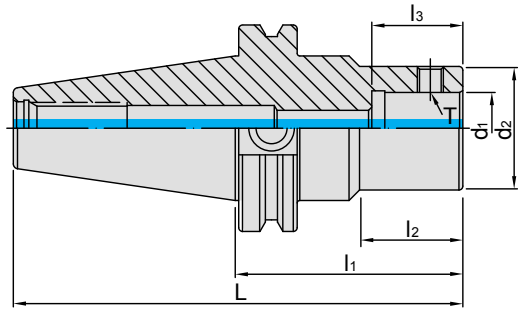

INCHES

MODEL NO.	TYPE	L	l <sub>1</sub>	l <sub>2</sub>	l <sub>3</sub>	d <sub>1</sub>	d <sub>2</sub>	T	WEIGHT (KGS)
5043-487-001-076	SCAT40 x MCK1 - 3"	5.687	3	1.105	0.708	0.433	0.748	M4 x 0.5P	1.20
5043-487-001-095	SCAT40 x MCK1 - 3.75"	6.437	3.75	1.856	0.708	0.433	0.748	M4 x 0.5P	1.25
5043-487-002-076	SCAT40 x MCK2 - 3"	5.687	3	1.39	0.728	0.551	0.925	M5 x 0.5P	1.30
5043-487-002-110	SCAT40 x MCK2 - 4.35"	7.037	4.35	2.656	0.728	0.551	0.925	M5 x 0.5P	1.35
5043-487-003-076	SCAT40 x MCK3 - 3"	5.687	3	1.356	0.945	0.709	1.22	M6 x 0.75P	1.40
5043-487-003-127	SCAT40 x MCK3 - 5"	7.687	5	3.36	0.945	0.709	1.22	M6 x 0.75P	1.45
5043-487-004-076	SCAT40 x MCK4 - 3"	5.687	3	1.515	1.102	0.866	1.535	M8 x 0.75P	1.50
5043-487-004-108	SCAT40 x MCK4 - 4.25"	6.937	4.25	2.765	1.102	0.866	1.535	M8 x 0.75P	1.55
5043-487-005-076	SCAT40 x MCK5 - 3"	5.687	3	2.219	1.378	1.102	1.969	M10 x 1.0P	1.60
5043-487-005-108	SCAT40 x MCK5 - 4.25"	6.937	4.25	3.469	1.378	1.102	1.969	M10 x 1.0P	1.65
5043-487-006-076	SCAT40 x MCK6 - 3"	5.687	3	2.219	1.653	1.417	2.48	M12 x 1.0P	1.70
5043-487-006-108	SCAT40 x MCK6 - 4.25"	6.937	4.25	3.469	1.653	1.417	2.48	M12 x 1.0P	1.75
5044-487-001-089	SCAT50 x MCK1 - 3.5"	7.5	3.5	1.317	0.708	0.433	0.748	M4 x 0.5P	3.30
5044-487-001-102	SCAT50 x MCK1 - 4"	8	4	1.817	0.708	0.433	0.748	M4 x 0.5P	3.35
5044-487-002-089	SCAT50 x MCK2 - 3.5"	7.5	3.5	1.368	0.728	0.551	0.925	M5 x 0.5P	3.40
5044-487-002-135	SCAT50 x MCK2 - 5.3"	9.3	5.3	3.167	0.728	0.551	0.925	M5 x 0.5P	3.45
5044-487-003-089	SCAT50 x MCK3 - 3.5"	7.5	3.5	1.453	0.945	0.709	1.22	M6 x 0.75P	3.50
5044-487-003-140	SCAT50 x MCK3 - 5.5"	9.5	5.5	3.453	0.945	0.709	1.22	M6 x 0.75P	3.55
5044-487-004-089	SCAT50 x MCK4 - 3.5"	7.5	3.5	1.544	1.102	0.866	1.535	M8 x 0.75P	3.60
5044-487-004-140	SCAT50 x MCK4 - 5.5"	9.5	5.5	3.544	1.102	0.866	1.535	M8 x 0.75P	3.65
5044-487-005-089	SCAT50 x MCK5 - 3.5"	7.5	3.5	1.669	1.378	1.102	1.969	M10 x 1.0P	3.70
5044-487-005-140	SCAT50 x MCK5 - 5.5"	9.5	5.5	3.669	1.378	1.102	1.969	M10 x 1.0P	3.75
5044-487-006-089	SCAT50 x MCK6 - 3.5"	7.5	3.5	1.988	1.653	1.417	2.48	M12 x 1.0P	3.80
5044-487-006-140	SCAT50 x MCK6 - 5.5"	9.5	5.5	3.987	1.653	1.417	2.48	M12 x 1.0P	3.85

**Features:**

- ▶ Internal tolerance is H6.
- ▶ Center though coolant supply is available.
- ▶ AD+B type is available, please inform us when making an order.

# SDAT / MCK BORING HEAD SHANK

Dual  
DRIVE+

SDAT / MCK 法蘭加厚型搪孔刀桿

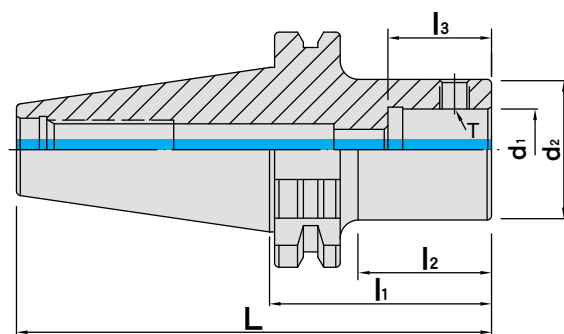

MODEL NO.	TYPE	L	l <sub>1</sub>	l <sub>2</sub>	l <sub>3</sub>	d <sub>1</sub>	d <sub>2</sub>	T	WEIGHT (KGS)
5066-487-001-080	SDAT40 x MCK1 - 80	148.4	80	50.9	18	11	19	M4 x 0.5P	1.00
5066-487-001-095	SDAT40 x MCK1 - 95	163.4	95	65.9	18	11	19	M4 x 0.5P	1.05
5066-487-002-080	SDAT40 x MCK2 - 80	148.4	80	50.9	18.5	14	23.5	M5 x 0.5P	1.10
5066-487-002-110	SDAT40 x MCK2 - 110	178.4	110	80.9	18.5	14	23.5	M5 x 0.5P	1.15
5066-487-003-090	SDAT40 x MCK3 - 90	158.4	90	65.9	24	18	31	M6 x 0.75P	1.20
5066-487-003-125	SDAT40 x MCK3 - 125	193.4	125	100.9	24	18	31	M6 x 0.75P	1.25
5066-487-004-080	SDAT40 x MCK4 - 80	148.4	80	55.9	28	22	39	M8 x 0.75P	1.30
5066-487-004-110	SDAT40 x MCK4 - 110	178.4	110	85.9	28	22	39	M8 x 0.75P	1.35
5066-487-005-095	SDAT40 x MCK5 - 95	163.4	95	75.4	35	28	50	M10 x 1.0P	1.40
5066-487-005-110	SDAT40 x MCK5 - 110	178.4	110	90.4	35	28	50	M10 x 1.0P	1.45
5066-487-006-065	SDAT40 x MCK6 - 65	133.4	65	45.4	42	36	63	M12 x 1.0P	1.50
5066-487-006-095	SDAT40 x MCK6 - 95	163.4	95	75.4	42	36	63	M12 x 1.0P	1.55
5067-487-001-110	SDAT50 x MCK1 - 110	211.75	110	80.9	18	11	19	M4 x 0.5P	3.10
5067-487-001-125	SDAT50 x MCK1 - 125	226.75	125	95.9	18	11	19	M4 x 0.5P	3.15
5067-487-002-095	SDAT50 x MCK2 - 95	196.75	95	65.9	18.5	14	23.5	M5 x 0.5P	3.20
5067-487-002-125	SDAT50 x MCK2 - 125	226.75	125	95.9	18.5	14	23.5	M5 x 0.5P	3.25
5067-487-003-125	SDAT50 x MCK3 - 125	226.75	125	95.9	24	18	31	M6 x 0.75P	3.30
5067-487-003-155	SDAT50 x MCK3 - 155	256.75	155	125.9	24	18	31	M6 x 0.75P	3.35
5067-487-004-110	SDAT50 x MCK4 - 110	211.75	110	80.9	28	22	39	M8 x 0.75P	3.40
5067-487-004-125	SDAT50 x MCK4 - 125	226.75	125	95.9	28	22	39	M8 x 0.75P	3.45
5067-487-005-065	SDAT50 x MCK5 - 65	166.75	65	35.9	35	28	50	M10 x 1.0P	3.50
5067-487-005-140	SDAT50 x MCK5 - 140	241.75	140	110.9	35	28	50	M10 x 1.0P	3.55
5067-487-006-140	SDAT50 x MCK6 - 140	241.75	140	110.9	42	36	63	M12 x 1.0P	3.60
5067-487-006-170	SDAT50 x MCK6 - 170	271.75	170	140.9	42	36	63	M12 x 1.0P	3.65

## Features:

- ▶ Internal tolerance is H6.
- ▶ Center through coolant supply is available.
- ▶ AD+B type is available, please inform us when making an order.



# HSK / MCK BORING HEAD SHANK

HSK / MCK 搪孔刀桿

(DIN 69893-1)

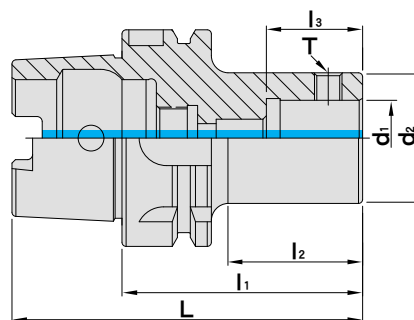

MODEL NO.	TYPE	L	l <sub>1</sub>	l <sub>2</sub>	l <sub>3</sub>	d <sub>1</sub>	d <sub>2</sub>	T	WEIGHT (KGS)
5071-487-001-050	HSK40A x MCK1 - 50	70	50	27	15	11	19	M4 x 0.5P	0.60
5071-487-002-060	HSK40A x MCK2 - 60	80	60	37	18.5	14	23.5	M5 x 0.5P	0.70
5071-487-003-060	HSK40A x MCK3 - 60	80	60	38	24	18	31	M6 x 0.75P	0.80
5072-487-001-060	HSK50A x MCK1 - 60	85	60	31	18	11	19	M4 x 0.5P	1.00
5072-487-002-060	HSK50A x MCK2 - 60	85	60	31	18.5	14	23.5	M5 x 0.5P	1.10
5072-487-003-060	HSK50A x MCK3 - 60	85	60	32	24	18	31	M6 x 0.75P	1.20
5072-487-004-060	HSK50A x MCK4 - 60	85	60	32	28	22	39	M8 x 0.75P	1.30
5072-487-005-080	HSK50A x MCK5 - 80	105	80	53	35	28	50	M10 x 1.0P	1.40
5072-487-006-080	HSK50A x MCK6 - 80	105	80	53	42	36	63	M12 x 1.0P	1.50
5073-487-001-080	HSK63A x MCK1 - 80	112	80	49	15	11	19	M4 x 0.5P	1.20
5073-487-001-095	HSK63A x MCK1 - 95	127	95	64	18	11	19	M4 x 0.5P	1.25
5073-487-002-080	HSK63A x MCK2 - 80	112	80	44	18.5	14	23.5	M5 x 0.5P	1.30
5073-487-002-110	HSK63A x MCK2 - 110	142	110	79	18.5	14	23.5	M5 x 0.5P	1.35
5073-487-003-090	HSK63A x MCK3 - 90	122	90	59	24	18	31	M6 x 0.75P	1.40
5073-487-003-125	HSK63A x MCK3 - 125	157	125	94	24	18	31	M6 x 0.75P	1.45
5073-487-004-080	HSK63A x MCK4 - 80	112	80	49	28	22	39	M8 x 0.75P	1.50
5073-487-004-110	HSK63A x MCK4 - 110	142	110	79	28	22	39	M8 x 0.75P	1.55
5073-487-005-095	HSK63A x MCK5 - 95	127	95	67.5	35	28	50	M10 x 1.0P	1.60
5073-487-005-110	HSK63A x MCK5 - 110	142	110	82.5	35	28	50	M10 x 1.0P	1.65
5073-487-006-070	HSK63A x MCK6 - 70	102	70	43.5	42	36	63	M12 x 1.0P	1.70
5073-487-006-095	HSK63A x MCK6 - 95	127	95	68.5	42	36	63	M12 x 1.0P	1.75

**Features:**

- ▶ Internal tolerance is H6.
- ▶ Center through coolant supply is available



# HSK / MCK BORING HEAD SHANK

HSK / MCK 搪孔刀桿

[DIN 69893-1]

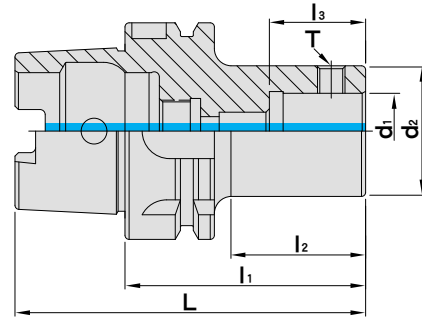

MODEL NO.	TYPE	L	l <sub>1</sub>	l <sub>2</sub>	l <sub>3</sub>	d <sub>1</sub>	d <sub>2</sub>	T	WEIGHT (KGS)
5075-487-001-100	HSK100A x MCK1 - 100	150	100	61	18	11	19	M4 x 0.5P	2.07
5075-487-002-075	HSK100A x MCK2 - 75	125	75	36	18.5	14	23.5	M5 x 0.5P	2.09
5075-487-002-115	HSK100A x MCK2 - 115	165	115	76	18.5	14	23.5	M5 x 0.5P	2.18
5075-487-003-060	HSK100A x MCK3 - 60	110	60	21	24	18	31	M6 x 0.75P	2.15
5075-487-003-125	HSK100A x MCK3 - 125	175	15	86	24	18	31	M6 x 0.75P	2.47
5075-487-004-070	HSK100A x MCK4 - 70	120	70	31	28	22	39	M8 x 0.75P	2.34
5075-487-004-120	HSK100A x MCK4 - 120	170	120	86	28	22	39	M8 x 0.75P	2.76
5075-487-005-070	HSK100A x MCK5 - 70	120	70	31	35	28	50	M10 x 1.0P	2.60
5075-487-005-110	HSK100A x MCK5 - 110	160	110	76	35	28	50	M10 x 1.0P	3.17
5075-487-006-075	HSK100A x MCK6 - 75	125	75	41	42	36	63	M12 x 1.0P	3.02
5075-487-006-100	HSK100A x MCK6 - 100	150	100	66	42	36	63	M12 x 1.0P	3.60
5075-487-007-123	HSK100A x MCK7-123	173	123	93	52	46	90	M20 x 1.5P	4.00
5075-487-007-273	HSK100A x MCK7-273	323	273	228	52	46	90	M20 x 1.5P	5.00
5076-487-006-094	HSK125A x MCK6 - 94	157	94	50	42	36	63	M12 x 1.0P	4.70
5076-487-007-123	HSK125A x MCK7 - 123	186	123	84	52	46	90	M20 x 1.5P	7.20

**Features:**

- ▶ Internal tolerance is H6.
- ▶ Center through coolant supply is available.



# PSC / MCK BORING HEAD SHANK

## PSC / MCK 搪孔刀桿

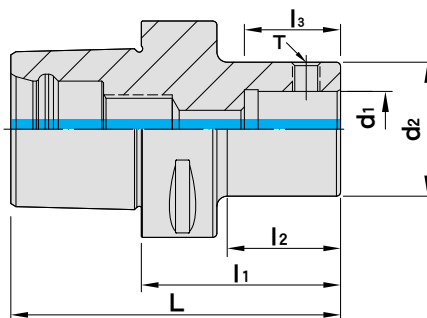

MODEL NO.	TYPE	L	l <sub>1</sub>	l <sub>2</sub>	l <sub>3</sub>	d <sub>1</sub>	d <sub>2</sub>	T	WEIGHT (KGS)
5141-487-001-048	PSC40 x MCK1 - 48	72	48	22.5	18	11	19	M4 x 0.5P	0.40
5141-487-002-045	PSC40 x MCK2 - 45	69	45	19.5	18.5	14	24	M5 x 0.5P	0.40
5141-487-003-040	PSC40 x MCK3 - 40	64	40	17	24	18	31	M6 x 0.75P	0.50
5141-487-004-033	PSC40 x MCK4 - 33	57	33	12.5	28	22	39	M8 x 0.75P	0.50
5142-487-001-073	PSC50 x MCK1 - 73	103	73	47.5	18	11	19	M4 x 0.5P	0.50
5142-487-002-085	PSC50 x MCK2 - 85	115	85	60.5	18.5	14	24	M5 x 0.5P	0.60
5142-487-003-055	PSC50 x MCK3 - 55	85	55	30	24	18	31	M6 x 0.75P	0.60
5142-487-003-080	PSC50 x MCK3 - 80	110	80	55	24	18	31	M6 x 0.75P	0.70
5142-487-004-048	PSC50 x MCK4 - 48	78	48	23	28	22	39	M8 x 0.75P	0.60
5142-487-004-073	PSC50 x MCK4 - 73	103	73	48	28	22	39	M8 x 0.75P	0.70
5142-487-005-050	PSC50 x MCK5 - 50	80	50	30	35	28	50	M10 x 1.0P	0.60
5142-487-005-083	PSC50 x MCK5 - 83	113	83	63	35	28	50	M10 x 1.0P	1.30
5142-487-006-050	PSC50 x MCK6 - 50	80	50	30	42	36	63	M12 x 1.0P	1.00
5143-487-001-078	PSC63 x MCK1 - 78	116	78	44	18	11	19	M4 x 0.5P	1.20
5143-487-002-090	PSC63 x MCK2 - 90	128	90	53	18.5	14	24	M5 x 0.5P	1.30
5143-487-003-065	PSC63 x MCK3 - 65	103	65	38	24	18	31	M6 x 0.75P	1.30
5143-487-003-100	PSC63 x MCK3 - 100	138	100	73	24	18	31	M6 x 0.75P	1.50
5143-487-004-058	PSC63 x MCK4 - 58	96	58	31	28	22	39	M8 x 0.75P	1.30
5143-487-004-093	PSC63 x MCK4 - 93	131	93	66	28	22	39	M8 x 0.75P	1.70
5143-487-005-048	PSC63 x MCK5 - 48	86	48	22	35	28	50	M10 x 1.0P	1.30
5143-487-005-083	PSC63 x MCK5 - 83	121	83	57	35	28	50	M10 x 1.0P	1.70
5143-487-006-059	PSC63 x MCK6 - 59	97	59	37	42	36	63	M12 x 1.0P	1.60
5143-487-006-094	PSC63 x MCK6 - 94	132	94	72	42	36	63	M12 x 1.0P	2.30

### Features:

- ▶ Internal tolerance is H6.
- ▶ Center through coolant supply is available.



# PSC / MCK BORING HEAD SHANK

## PSC / MCK 搪孔刀桿

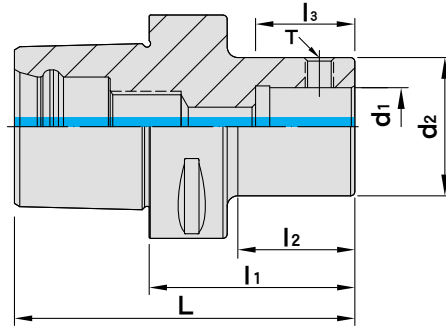

MODEL NO.	TYPE	L	l <sub>1</sub>	l <sub>2</sub>	l <sub>3</sub>	d <sub>1</sub>	d <sub>2</sub>	T	WEIGHT (KGS)
5144-487-001-103	PSC80 x MCK1 - 103	151	103	68	18	11	19	M4 x 0.5P	2.60
5144-487-002-115	PSC80 x MCK2 - 115	163	115	80	18.5	14	23.5	M5 x 0.5P	2.70
5144-487-003-125	PSC80 x MCK3 - 125	173	125	90	24	18	31	M6 x 0.75P	2.90
5144-487-004-118	PSC80 x MCK4 - 118	166	118	83	28	22	39	M8 x 0.75P	3.10
5144-487-004-178	PSC80 x MCK4 - 178	226	178	138	28	22	39	M8 x 0.75P	3.70
5144-487-005-108	PSC80 x MCK5 - 108	156	108	73	35	28	50	M10 x 1.0P	3.50
5144-487-005-183	PSC80 x MCK5 - 183	231	183	143	35	28	50	M10 x 1.0P	4.60
5144-487-006-074	PSC80 x MCK6 - 74	122	74	39	42	36	63	M12 x 1.0P	3.20
5144-487-006-169	PSC80 x MCK6 - 169	217	169	134	42	36	63	M12 x 1.0P	5.80
5144-487-007-073	PSC80 x MCK7 - 73	121	73	38	52	46	90	M20 x 1.5P	5.00
5144-487-007-123	PSC80 x MCK7 - 123	171	123	88	52	46	90	M20 x 1.5P	8.40

### Features:

- ▶ Internal tolerance is H6.
- ▶ Center through coolant supply is available.



# MCK EXTENSION SPACER

## MCK 搪孔頭延長桿

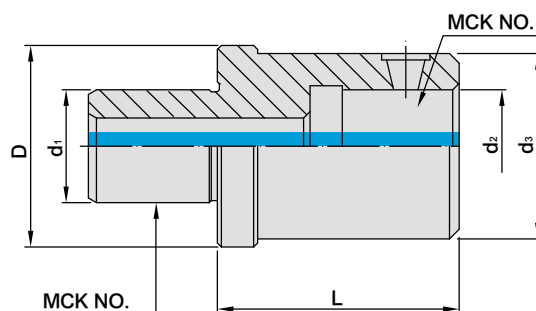

MODEL NO.	TYPE	L	D	d <sub>1</sub>	d <sub>2</sub>	d <sub>3</sub>	WEIGHT (KGS)
5272-487-00101-030	MCK1 - 1 - 30	30	-	11	11	19	0.20
5272-487-00202-030	MCK2 - 2 - 30	30	-	14	14	24	0.30
5272-487-00302-037	MCK3 - 2 - 37	37	31	18	14	24	0.34
5272-487-00303-030	MCK3 - 3 - 30	30	-	18	18	31	0.32
5272-487-00402-050	MCK4 - 2 - 50	50	39	22	14	24	0.60
5272-487-00403-050	MCK4 - 3 - 50	50	39	22	18	31	0.56
5272-487-00404-045	MCK4 - 4 - 45	45	-	22	22	39	0.52
5272-487-00502-054	MCK5 - 2 - 54	54	49	28	14	24	0.72
5272-487-00503-047	MCK5 - 3 - 47	47	49	28	18	31	0.70
5272-487-00504-042	MCK5 - 4 - 42	42	49	28	22	39	0.65
5272-487-00505-060	MCK5 - 5 - 60	60	-	28	28	50	0.60
5272-487-00602-063	MCK6 - 2 - 63	63	64	36	14	24	1.50
5272-487-00603-056	MCK6 - 3 - 56	56	64	36	18	31	1.30
5272-487-00604-051	MCK6 - 4 - 51	51	64	36	22	39	1.10
5272-487-00605-041	MCK6 - 5 - 41	41	64	36	28	50	1.05
5272-487-00606-060	MCK6 - 6 - 60	60	-	36	36	63	0.95

### MODULAR DESIGN

- ▶ Mck connection system is a flexible modular system and able to increase the length with extension spacers and change boring diameters conveniently by changing different boring heads for long overhanging boring operations.

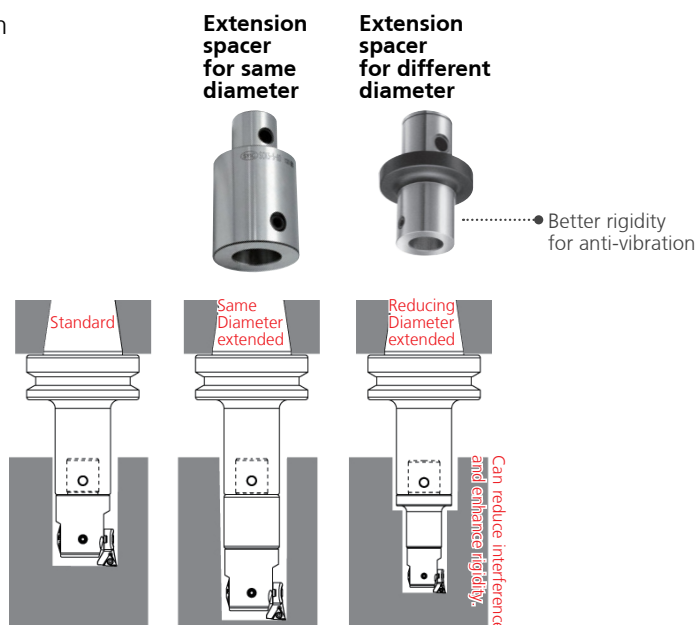

# SIMPLIFIED TOOL PRESETTER FOR SRW & SMB BORING HEAD

## 簡易式搪刀設定儀

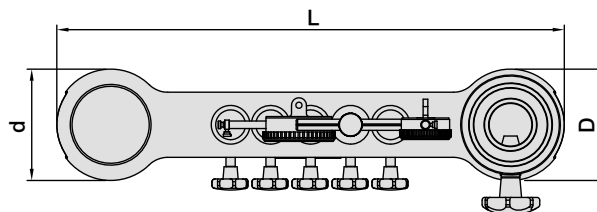

MODEL NO.	TYPE	L	D	d	MEASURING RANGE	MCK NO.	WEIGHT (KGS)
5353-S93-550	SET 410 - 550	410	55	55	Ø100 ~ Ø550	MCK7	10.4
5353-S93-830	SET 410 - 830	610	55	55	Ø550 ~ Ø830	MCK7	12.8

### Features:

- ▶ Used for SRW & SMB boring heads for large boring diameter.
- ▶ Make quick adjustment for boring dimensions.
- ▶ Capable of measuring boring range from Ø100mm ~ Ø830mm.
- ▶ Each unit of dial indicator: Radial 0.02mm and Axial 0.01mm.



# MEMO

Blank memo area consisting of 18 horizontal grey bars for writing.



# PSC ADAPTERS

BT / PSC ADAPTER	D-3
CAT / PSC ADAPTER	D-4
DAT / PSC ADAPTER	D-5
SBT / PSC ADAPTER	D-6
SCAT / PSC ADAPTER	D-7
SDAT / PSC ADAPTER	D-8
HSK / PSC ADAPTER	D-9
PSC / EXTENSION ADAPTER FOR SAME DIAMETER	D-10
PSC / EXTENSION ADAPTER FOR DIFFERENT DIAMETER	D-11

# APPLICATION DIAGRAM



**PSC Adapter**

*For adapters, please refer to*

Adapter	Page
BT / PSC	D-3
CAT / PSC	D-4
DAT / PSC	D-5
SBT / PSC	D-6
SCAT / PSC	D-7
SDAT / PSC	D-8
HSK / PSC	D-9



**PSC Extension Adapter for Same Diameter**

**D-10**



**PSC Extension Adapter for Different Diameter**

**D-11**



**PSC / PMB Finish Boring Head**

**B-21**



**PSC / PCK Rough Boring Head**

**B-22**



**PSC / PBJ Finish Boring Head**

**B-22**



**PSC / SPMB Damping Finish Boring Head**

**A-3**



# BT / PSC ADAPTER

## BT / PSC 套筒

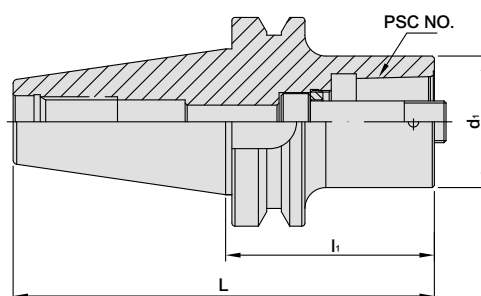

MODEL NO.	TYPE	NO.	L	l <sub>1</sub>	d <sub>1</sub>	T	MAX. TORQUE		WEIGHT (KGS)
							Nm	ft-lbs	
5012-013-140-040	BT50 x PSC32 - 40	PSC32	141.8	40	32	M12 x 1.5P	45	33	4.60
5012-013-141-040	BT50 x PSC40 - 40	PSC40	141.8	40	40	M14 x 1.5P	55	40	4.60
5012-013-142-040	BT50 x PSC50 - 40	PSC50	141.8	40	50	M16 x 1.5P	95	70	4.60
5012-013-143-100	BT50 x PSC63 - 100	PSC63	201.8	100	63	M20 x 2.0P	170	125	5.00
5012-013-143-150	BT50 x PSC63 - 150	PSC63	251.8	150	63	M20 x 2.0P	170	125	5.93
5012-013-143-200	BT50 x PSC63 - 200	PSC63	301.8	200	63	M20 x 2.0P	170	125	6.99
5012-013-143-250	BT50 x PSC63 - 250	PSC63	351.8	250	63	M20 x 2.0P	170	125	8.06
5012-013-143-300	BT50 x PSC63 - 300	PSC63	401.8	300	63	M20 x 2.0P	170	125	8.91
5012-013-144-070	BT50 x PSC80 - 70	PSC80	171.8	70	80	M20 x 2.0P	170	125	3.86
5012-013-144-120	BT50 x PSC80 - 120	PSC80	221.8	120	80	M20 x 2.0P	170	125	5.67
5012-013-146-140	BT50 x PSC100 - 140	PSC100	241.8	140	100	M24 x 2.0P	380	277	7.62

### Features:

- Convert the machine taper for use with different taper types or taper sizes of tool holders, or offer great flexibility by extending the tooling length.



# CAT / PSC ADAPTER

## CAT / PSC 套筒

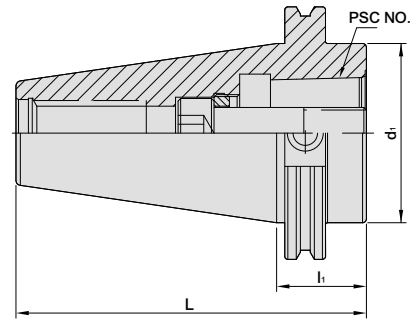

MODEL NO.	TYPE	NO.	L	l <sub>1</sub>	d <sub>1</sub>	T	MAX. TORQUE		WEIGHT (KGS)
							Nm	ft-lbs	
5031-013-140-035	CAT40 x PSC32 - 35	PSC32	103.249	35	44.45	M12 x 1.5P	45	33	0.99
5031-013-141-035	CAT40 x PSC40 - 35	PSC40	103.249	35	44.45	M14 x 1.5P	55	40	0.90
5031-013-142-035	CAT40 x PSC50 - 35	PSC50	103.249	35	44.45	M16 x 1.5P	95	70	0.82
5031-013-143-090	CAT40 x PSC63 - 90	PSC63	158.249	90	63	M20 x 2.0P	170	125	1.83
5032-013-140-035	CAT50 x PSC32 - 35	PSC32	136.6	35	69.85	M12 x 1.5P	45	33	3.00
5032-013-141-035	CAT50 x PSC40 - 35	PSC40	136.6	35	69.85	M14 x 1.5P	55	40	2.95
5032-013-142-035	CAT50 x PSC50 - 35	PSC50	136.6	35	69.85	M16 x 1.5P	95	70	2.85
5032-013-143-035	CAT50 x PSC63 - 35	PSC63	136.6	35	69.85	M20 x 2.0P	170	125	2.63

### INCHES

5032-013-143-102	CAT50 x PSC63 - 4"	PSC63	203.2	101.6	63	M20 x 2.0P	170	125	4.05
5032-013-143-152	CAT50 x PSC63 - 6"	PSC63	254	152.4	63	M20 x 2.0P	170	125	5.14
5032-013-143-203	CAT50 x PSC63 - 8"	PSC63	304.8	203.2	63	M20 x 2.0P	170	125	6.23
5032-013-143-254	CAT50 x PSC63 - 10"	PSC63	355.6	254	63	M20 x 2.0P	170	125	7.31
5032-013-143-305	CAT50 x PSC63 - 12"	PSC63	406.4	304.8	63	M20 x 2.0P	170	125	8.40
5032-013-144-095	CAT50 x PSC80 - 3.74"	PSC80	196.6	95	80	M20 x 2.0P	170	125	3.05

### Features:

- Convert the machine taper for use with different taper types or taper sizes of tool holders, or offer great flexibility by extending the tooling length.

# DAT / PSC ADAPTER

## DAT / PSC 套筒

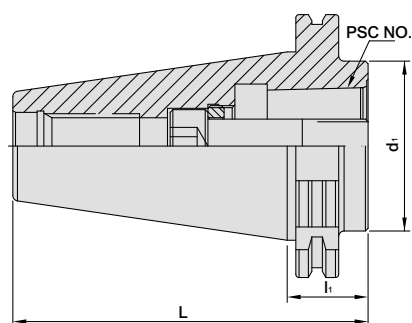

MODEL NO.	TYPE	NO.	L	l <sub>1</sub>	d <sub>1</sub>	T	MAX. TORQUE		WEIGHT (KGS)
							Nm	ft-lbs	
5052-013-140-030	DAT50 x PSC32 - 30	PSC32	131.75	30	32	M12 x 1.5P	45	33	4.20
5052-013-141-030	DAT50 x PSC40 - 30	PSC40	131.75	30	40	M14 x 1.5P	55	40	4.30
5052-013-142-030	DAT50 x PSC50 - 30	PSC50	131.75	30	50	M16 x 1.5P	95	70	4.40
5052-013-143-030	DAT50 x PSC63 - 30	PSC63	131.75	30	63	M20 x 2.0P	170	125	4.50
5052-013-143-100	DAT50 x PSC63 - 100	PSC63	201.75	100	63	M20 x 2.0P	170	125	5.00
5052-013-143-150	DAT50 x PSC63 - 150	PSC63	251.75	150	63	M20 x 2.0P	170	125	5.20
5052-013-143-200	DAT50 x PSC63 - 200	PSC63	301.75	200	63	M20 x 2.0P	170	125	5.40
5052-013-143-250	DAT50 x PSC63 - 250	PSC63	351.75	250	63	M20 x 2.0P	170	125	5.80
5052-013-143-300	DAT50 x PSC63 - 300	PSC63	401.75	300	63	M20 x 2.0P	170	125	6.00
5052-013-144-050	DAT50 x PSC80 - 50	PSC80	151.75	50	80	M20 x 2.0P	170	125	4.80
5052-013-144-070	DAT50 x PSC80 - 70	PSC80	171.75	70	80	M20 x 2.0P	170	125	4.90
5052-013-144-100	DAT50 x PSC80 - 100	PSC80	201.75	100	80	M20 x 2.0P	170	125	5.10
5052-013-144-120	DAT50 x PSC80 - 120	PSC80	221.75	120	80	M20 x 2.0P	170	125	5.20
5052-013-146-140	DAT50 x PSC100 - 140	PSC100	241.75	140	100	M24 x 2.0P	380	277	7.40

### Features:

- Convert the machine taper for use with different taper types or taper sizes of tool holders, or offer great flexibility by extending the tooling length.



# SBT / PSC ADAPTER

Dual  
DRIVE+

## SBT / PSC 法蘭加厚型套筒

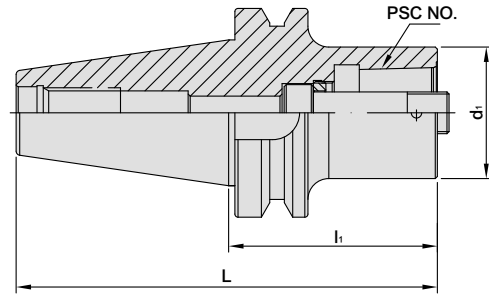

MODEL NO.	TYPE	NO.	L	l <sub>1</sub>	d <sub>1</sub>	T	MAX. TORQUE		WEIGHT (KGS)
							Nm	ft-lbs	
5025-013-140-080	SBT30 x PSC32 - 80	PSC32	128.4	80	32	M12 x 1.5P	45	33	0.60
5026-013-140-030	SBT40 x PSC32 - 30	PSC32	95.4	30	32	M12 x 1.5P	45	33	1.70
5026-013-140-080	SBT40 x PSC32 - 80	PSC32	145.4	80	32	M12 x 1.5P	45	33	1.20
5026-013-141-030	SBT40 x PSC40 - 30	PSC40	95.4	30	40	M14 x 1.5P	55	40	1.70
5026-013-141-100	SBT40 x PSC40 - 100	PSC40	165.4	100	40	M14 x 1.5P	55	40	1.41
5026-013-142-030	SBT40 x PSC50 - 30	PSC50	95.4	30	50	M16 x 1.5P	95	70	1.70
5026-013-142-100	SBT40 x PSC50 - 100	PSC50	165.4	100	50	M16 x 1.5P	95	70	1.72
5026-013-143-075	SBT40 x PSC63 - 75	PSC63	140.4	75	63	M20 x 2.0P	170	125	1.90
5026-013-144-135	SBT40 x PSC80 - 135	PSC80	200.4	135	80	M20 x 2.0P	170	125	3.78
5027-013-140-040	SBT50 x PSC32 - 40	PSC32	141.8	40	32	M12 x 1.5P	45	33	4.80
5027-013-140-150	SBT50 x PSC32 - 150	PSC32	251.8	150	32	M12 x 1.5P	45	33	4.10
5027-013-141-040	SBT50 x PSC40 - 40	PSC40	141.8	40	40	M14 x 1.5P	55	40	4.80
5027-013-141-135	SBT50 x PSC40 - 135	PSC40	236.8	135	40	M14 x 1.5P	55	40	4.20
5027-013-141-160	SBT50 x PSC40 - 160	PSC40	261.8	160	40	M14 x 1.5P	55	40	4.40
5027-013-141-200	SBT50 x PSC40 - 200	PSC40	301.8	200	40	M14 x 1.5P	55	40	4.80
5027-013-142-040	SBT50 x PSC50 - 40	PSC50	141.8	40	50	M16 x 1.5P	95	70	4.80
5027-013-142-135	SBT50 x PSC50 - 135	PSC50	236.8	135	50	M16 x 1.5P	95	70	4.60
5027-013-142-240	SBT50 x PSC50 - 240	PSC50	341.8	240	50	M16 x 1.5P	95	70	6.10
5027-013-143-100	SBT50 x PSC63 - 100	PSC63	201.8	100	63	M20 x 2.0P	170	125	4.68
5027-013-143-150	SBT50 x PSC63 - 150	PSC63	251.8	150	63	M20 x 2.0P	170	125	5.75
5027-013-143-200	SBT50 x PSC63 - 200	PSC63	301.8	200	63	M20 x 2.0P	170	125	6.81
5027-013-143-250	SBT50 x PSC63 - 250	PSC63	351.8	250	63	M20 x 2.0P	170	125	7.88
5027-013-143-300	SBT50 x PSC63 - 300	PSC63	401.8	300	63	M20 x 2.0P	170	125	8.73
5027-013-144-070	SBT50 x PSC80 - 70	PSC80	171.8	70	80	M20 x 2.0P	170	125	3.91
5027-013-144-093	SBT50 x PSC80 - 93	PSC80	194.8	93	80	M20 x 2.0P	170	125	4.73
5027-013-144-120	SBT50 x PSC80 - 120	PSC80	221.8	120	80	M20 x 2.0P	170	125	5.71
5027-013-144-183	SBT50 x PSC80 - 183	PSC80	284.8	183	80	M20 x 2.0P	170	125	7.98
5027-013-144-243	SBT50 x PSC80 - 243	PSC80	344.8	243	80	M20 x 2.0P	170	125	10.14

### Features:

- Convert the machine taper for use with different taper types or taper sizes of tool holders, or offer great flexibility by extending the tooling length.

# SCAT / PSC ADAPTER

Dual  
DRIVE+

SCAT / PSC 法蘭加厚型套筒

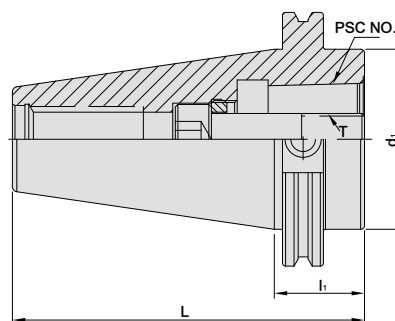

MODEL NO.	TYPE	NO.	L	l <sub>1</sub>	d <sub>1</sub>	T	MAX. TORQUE		WEIGHT (KGS)
							Nm	ft-lbs	
5043-013-140-035	SCAT40 x PSC32 - 35	PSC32	103.249	35	44.45	M12 x 1.5P	45	33	1.02
5043-013-141-035	SCAT40 x PSC40 - 35	PSC40	103.249	35	44.45	M14 x 1.5P	55	40	0.93
5043-013-142-035	SCAT40 x PSC50 - 35	PSC50	103.249	35	44.45	M16 x 1.5P	95	70	0.85
5043-013-143-090	SCAT40 x PSC63 - 90	PSC63	158.249	90	63	M20 x 2.0P	170	125	1.85
5044-013-140-035	SCAT50 x PSC32 - 35	PSC32	136.6	35	69.85	M12 x 1.5P	45	33	3.05
5044-013-141-035	SCAT50 x PSC40 - 35	PSC40	136.6	35	69.85	M14 x 1.5P	55	40	3.00
5044-013-142-035	SCAT50 x PSC50 - 35	PSC50	136.6	35	69.85	M16 x 1.5P	95	70	2.90
5044-013-143-035	SCAT50 x PSC63 - 35	PSC63	136.6	35	69.85	M20 x 2.0P	170	125	2.68

## INCHES

5044-013-143-102	SCAT50 x PSC63 - 4"	PSC63	203.2	101.6	63	M20 x 2.0P	170	125	4.42
5044-013-143-152	SCAT50 x PSC63 - 6"	PSC63	254	152.4	69.85	M20 x 2.0P	170	125	5.78
5044-013-143-203	SCAT50 x PSC63 - 8"	PSC63	304.8	203.2	63	M20 x 2.0P	170	125	7.14
5044-013-143-254	SCAT50 x PSC63 - 10"	PSC63	355.6	254	63	M20 x 2.0P	170	125	8.50
5044-013-143-305	SCAT50 x PSC63 - 12"	PSC63	406.4	304.8	63	M20 x 2.0P	170	125	9.87
5044-013-144-095	SCAT50 x PSC80 - 3.74"	PSC80	196.6	95	80	M20 x 2.0P	170	125	3.05

## Features:

- Convert the machine taper for use with different taper types or taper sizes of tool holders, or offer great flexibility by extending the tooling length.



## SDAT / PSC ADAPTER

Dual  
DRIVE+

SDAT / PSC 法蘭加厚型套筒

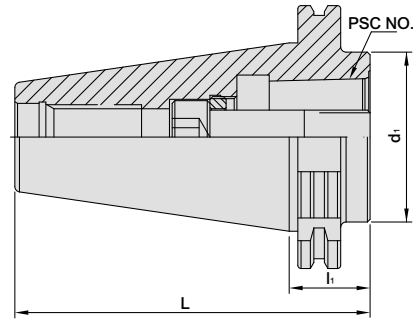

MODEL NO.	TYPE	NO.	L	l <sub>i</sub>	d <sub>i</sub>	T	MAX. TORQUE		WEIGHT (KGS)
							Nm	ft-lbs	
5066-013-140-030	SDAT40 x PSC32 - 30	PSC32	98.4	30	32	M12 x 1.5P	45	33	1.40
5066-013-141-040	SDAT40 x PSC40 - 40	PSC40	108.4	40	40	M14 x 1.5P	55	40	1.50
5066-013-142-050	SDAT40 x PSC50 - 50	PSC50	118.4	50	50	M16 x 1.5P	95	70	1.60
5066-013-143-090	SDAT40 x PSC63 - 90	PSC63	158.4	90	63	M20 x 2.0P	170	125	2.00
5067-013-140-030	SDAT50 x PSC32 - 30	PSC32	131.75	30	32	M12 x 1.5P	45	33	4.20
5067-013-141-030	SDAT50 x PSC40 - 30	PSC40	131.75	30	40	M14 x 1.5P	55	40	4.30
5067-013-142-030	SDAT50 x PSC50 - 30	PSC50	131.75	30	50	M16 x 1.5P	95	70	4.40
5067-013-143-030	SDAT50 x PSC63 - 30	PSC63	131.75	30	63	M20 x 2.0P	170	125	4.50
5067-013-143-100	SDAT50 x PSC63 - 100	PSC63	201.75	100	63	M20 x 2.0P	170	125	5.00
5067-013-143-150	SDAT50 x PSC63 - 150	PSC63	251.75	150	63	M20 x 2.0P	170	125	5.20
5067-013-143-200	SDAT50 x PSC63 - 200	PSC63	301.75	200	63	M20 x 2.0P	170	125	5.40
5067-013-143-250	SDAT50 x PSC63 - 250	PSC63	351.75	250	63	M20 x 2.0P	170	125	5.80
5067-013-143-300	SDAT50 x PSC63 - 300	PSC63	401.75	300	63	M20 x 2.0P	170	125	6.20
5067-013-144-050	SDAT50 x PSC80 - 50	PSC80	151.75	50	80	M20 x 2.0P	170	125	2.90
5067-013-144-070	SDAT50 x PSC80 - 70	PSC80	171.75	70	80	M20 x 2.0P	170	125	3.30
5067-013-144-100	SDAT50 x PSC80 - 100	PSC80	201.75	100	80	M20 x 2.0P	170	125	4.00
5067-013-144-120	SDAT50 x PSC80 - 120	PSC80	221.75	120	80	M20 x 2.0P	170	125	4.70

**Features:**

- Convert the machine taper for use with different taper types or taper sizes of tool holders, or offer great flexibility by extending the tooling length.

# HSK / PSC ADAPTER

## HSK / PSC 套筒

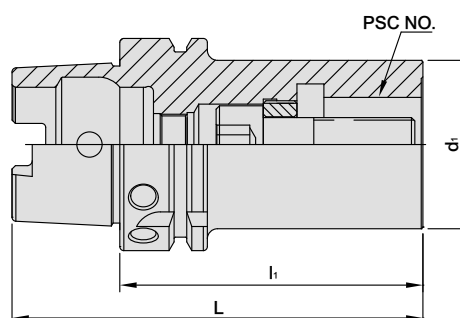

MODEL NO.	TYPE	NO.	L	l <sub>1</sub>	d <sub>1</sub>	T	MAX. TORQUE		WEIGHT (KGS)
							Nm	ft-lbs	
5073-013-140-075	HSK63A x PSC32 - 75	PSC32	107	75	32	M12 x 1.5P	45	33	0.92
5073-013-141-080	HSK63A x PSC40 - 80	PSC40	112	80	40	M14 x 1.5P	55	40	1.06
5073-013-142-090	HSK63A x PSC50 - 90	PSC50	122	90	50	M16 x 1.5P	95	70	1.39
5075-013-140-080	HSK100A x PSC32 - 80	PSC32	130	80	32	M12 x 1.5P	45	33	2.25
5075-013-141-090	HSK100A x PSC40 - 90	PSC40	140	90	40	M14 x 1.5P	55	40	2.43
5075-013-142-100	HSK100A x PSC50 - 100	PSC50	150	100	50	M16 x 1.5P	95	70	2.80
5075-013-143-110	HSK100A x PSC63 - 110	PSC63	160	110	63	M20 x 2.0P	170	125	3.41
5075-013-143-150	HSK100A x PSC63 - 150	PSC63	200	150	63	M20 x 2.0P	170	125	4.18
5075-013-143-200	HSK100A x PSC63 - 200	PSC63	250	200	63	M20 x 2.0P	170	125	5.14
5075-013-143-250	HSK100A x PSC63 - 250	PSC63	300	250	63	M20 x 2.0P	170	125	6.10
5075-013-143-300	HSK100A x PSC63 - 300	PSC63	350	300	63	M20 x 2.0P	170	125	7.07
5075-013-144-120	HSK100A x PSC80 - 120	PSC80	170	120	80	M20 x 2.0P	170	125	4.93
5075-013-146-155	HSK100A x PSC100 - 155	PSC100	205	155	100	M24 x 2.0P	380	277	7.29

### Features:

- Convert the machine taper for use with different taper types or taper sizes of tool holders, or offer great flexibility by extending the tooling length.



# PSC EXTENSION ADAPTER

## FOR SAME DIAMETER

PSC等徑套筒



台灣精品 2012  
TAIWAN EXCELLENCE

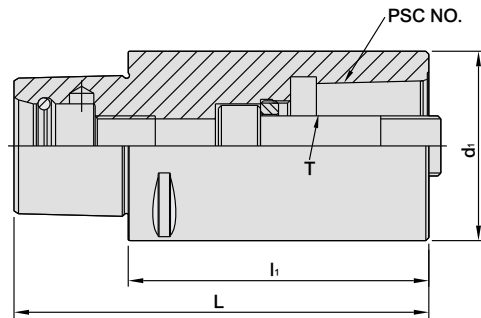

MODEL NO.	TYPE	PSC NO.	L	l <sub>1</sub>	d <sub>1</sub>	T	MAX. TORQUE		WEIGHT (KGS)
							Nm	ft-lbs	
5140-013-140-060	PSC32 x PSC32 - 60	PSC32	79	60	32	M12 x 1.5P	45	33	0.40
5140-013-140-080	PSC32 x PSC32 - 80	PSC32	99	80	32	M12 x 1.5P	45	33	0.50
5141-013-141-060	PSC40 x PSC40 - 60	PSC40	84	60	40	M14 x 1.5P	55	40	0.50
5141-013-141-080	PSC40 x PSC40 - 80	PSC40	104	80	40	M14 x 1.5P	55	40	0.70
5142-013-142-080	PSC50 x PSC50 - 80	PSC50	110	80	50	M16 x 1.5P	95	70	1.10
5142-013-142-100	PSC50 x PSC50 - 100	PSC50	130	100	50	M16 x 1.5P	95	70	1.40
5143-013-143-080	PSC63 x PSC63 - 80	PSC63	118	80	63	M20 x 2.0P	170	125	2.00
5143-013-143-100	PSC63 x PSC63 - 100	PSC63	138	100	63	M20 x 2.0P	170	125	2.20
◆ 5144-013-144-065	PSC80 x PSC80 - 65	PSC80	113	65	80	M20 x 2.0P	170	125	3.10
5144-013-144-100	PSC80 x PSC80 - 100	PSC80	148	100	80	M20 x 2.0P	170	125	3.60
5144-013-144-125	PSC80 x PSC80 - 125	PSC80	173	125	80	M20 x 2.0P	170	125	4.60
5145-013-145-100	PSC80X x PSC80X - 100	PSC80X	148	100	100	M20 x 2.0P	170	125	5.80
5146-013-146-200	PSC100 x PSC100 - 200	PSC100	260	200	100	M24 x 2.0P	380	277	10.6

**Features:**

- ▶ Convert the machine taper for use with different taper types or taper sizes of tool holders, or offer great flexibility by extending the tooling length.

**Product information:**

- ▶ ◆ marked models means only for segment clamping, not for bolt clamping.



# PSC EXTENSION ADAPTER

## FOR DIFFERENT DIAMETER

### PSC異徑套筒



台灣精品 2012  
TAIWAN EXCELLENCE

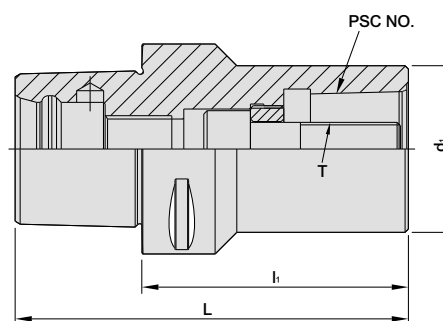

MODEL NO.	TYPE	NO.	L	l <sub>1</sub>	d <sub>1</sub>	T	MAX. TORQUE		WEIGHT (KGS)
							Nm	ft-lbs	
5141-013-140-055	PSC40 x PSC32 - 55	PSC32	79	55	32	M12 x 1.5P	45	33	0.50
5141-013-140-070	PSC40 x PSC32 - 70	PSC32	94	70	32	M12 x 1.5P	45	33	0.60
5142-013-140-060	PSC50 x PSC32 - 60	PSC32	90	60	32	M12 x 1.5P	45	33	0.60
5142-013-141-065	PSC50 x PSC40 - 65	PSC40	95	65	40	M14 x 1.5P	55	40	0.80
5142-013-141-085	PSC50 x PSC40 - 85	PSC40	115	85	40	M14 x 1.5P	55	40	1.10
5143-013-140-070	PSC63 x PSC32 - 70	PSC32	108	70	32	M12 x 1.5P	45	33	1.10
5143-013-141-080	PSC63 x PSC40 - 80	PSC40	118	80	40	M14 x 1.5P	55	40	1.20
5143-013-142-080	PSC63 x PSC50 - 80	PSC50	118	80	50	M16 x 1.5P	95	70	1.50
5143-013-142-110	PSC63 x PSC50 - 110	PSC50	148	110	50	M16 x 1.5P	95	70	2.20
5144-013-140-060	PSC80 x PSC32 - 60	PSC32	108	60	32	M12 x 1.5P	45	33	1.70
5144-013-141-070	PSC80 x PSC40 - 70	PSC40	118	70	40	M14 x 1.5P	55	40	1.90
◆ 5144-013-142-045	PSC80 x PSC50 - 45	PSC50	93	45	50	M16 x 1.5P	95	70	1.50
5144-013-142-080	PSC80 x PSC50 - 80	PSC50	128	80	50	M16 x 1.5P	95	70	2.20
◆ 5144-013-143-055	PSC80 x PSC63 - 55	PSC63	103	55	63	M20 x 2.0P	170	125	2.30
5144-013-143-080	PSC80 x PSC63 - 80	PSC63	128	80	63	M20 x 2.0P	170	125	2.50
5144-013-143-120	PSC80 x PSC63 - 120	PSC63	168	120	63	M20 x 2.0P	170	125	4.00
◆ 5145-013-143-055	PSC80X x PSC63 - 55	PSC63	103	55	63	M20 x 2.0P	170	125	3.00
5145-013-143-080	PSC80X x PSC63 - 80	PSC63	128	80	63	M20 x 2.0P	170	125	3.40
◆ 5145-013-144-065	PSC80X x PSC80 - 65	PSC80	113	65	80	M20 x 2.0P	170	125	4.00
◆ 5145-013-144-100	PSC80X x PSC80 - 100	PSC80	148	100	80	M20 x 2.0P	170	125	4.40
◆ 5145-013-144-150	PSC80X x PSC80 - 150	PSC80	198	150	80	M20 x 2.0P	170	125	5.20
5146-013-143-200	PSC100 x PSC63 - 200	PSC63	260	200	63	M20 x 2.0P	170	125	6.20
5146-013-144-200	PSC100 x PSC80 - 200	PSC80	260	200	80	M20 x 2.0P	170	125	8.18

#### Features:

- ▶ Convert the machine taper for use with different taper types or taper sizes of tool holders, or offer great flexibility by extending the tooling length.

#### Product information:

- ▶ ◆ marked models means only for segment clamping, not for bolt clamping.



# MEMO

Blank memo area consisting of 18 horizontal grey bars for writing.



# MEMO

Blank memo area consisting of 18 horizontal grey bars for writing.



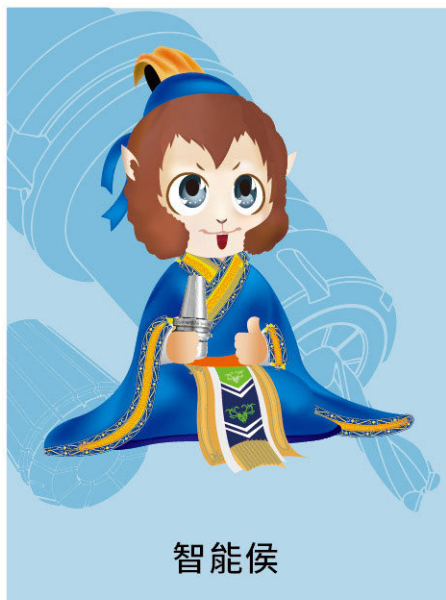

智能侯

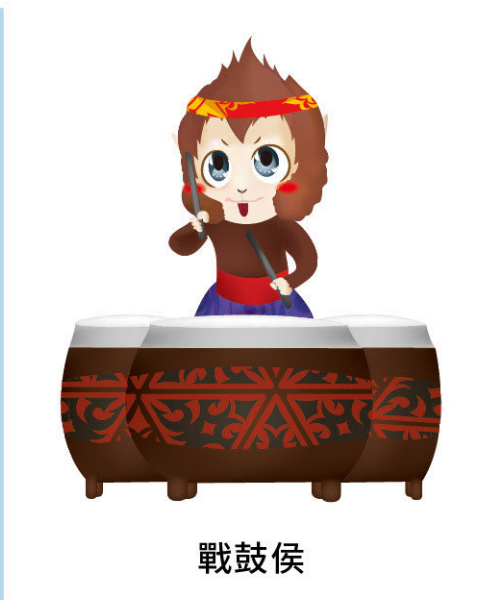

戰鼓侯



學識侯



俠客侯



勝侯王

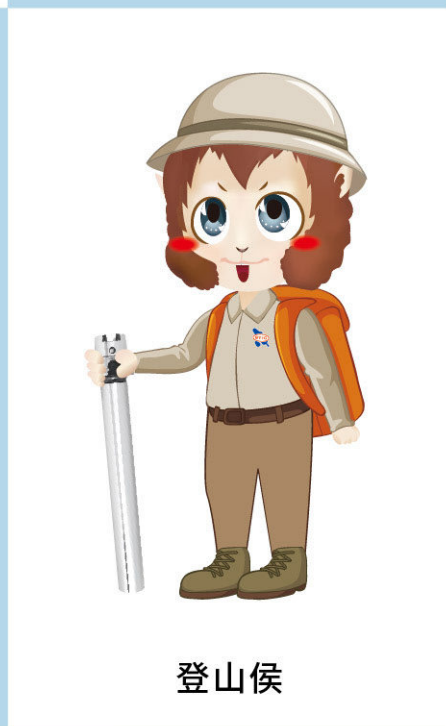

登山侯

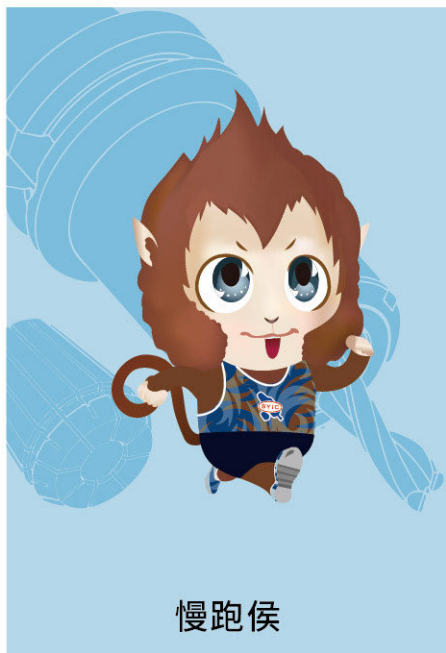

慢跑侯



咖啡侯



鐵馬侯



[www.syic.com](http://www.syic.com)



## SHIN-YAIN INDUSTRIAL CO., LTD.

No.198, Jingpu Rd., Qingshui Dist., Taichung City 436, Taiwan  
Tel: +886-4-26237575 | Fax: +886-4-26237676 | E-mail: sales@syic.com

