

SCAT CATEGORY

PRO-E COLLET CHUCK	E-3~4
UT COLLET CHUCK	E-5
ER COLLET CHUCK	E-6~7
ER COLLET CHUCK [M TYPE]	E-8
SKX COLLET CHUCK	E-9~10
SK3 COLLET CHUCK	E-11
SBL SLIM-FIT COLLET CHUCK	E-12
SBLC SLIM-FIT COLLET CHUCK	E-13
EBL SLIM-FIT COLLET CHUCK	E-14
EBLC SLIM-FIT COLLET CHUCK	E-15
HBL SLIM-FIT COLLET CHUCK	E-16
MLD MULTI-LOCK MILLING CHUCK	E-17
SAF RUNOUT ADJUSTABLE HOLDER	E-18~21
SLN SIDE LOCK END MILL HOLDER	E-22
FACE MILL ARBOR	E-23
STA SYNCHRONIZED TAPPING HOLDER	E-24~25
QTC QUICK CHANGE TAPPING CHUCK	E-26
MORSE TAPER ADAPTER	E-27
ADAPTER	E-28
BLANK	E-29

SCAT / PRO-E COLLET CHUCK



SCAT / PRO-E 法蘭加厚型筒夾式刀桿

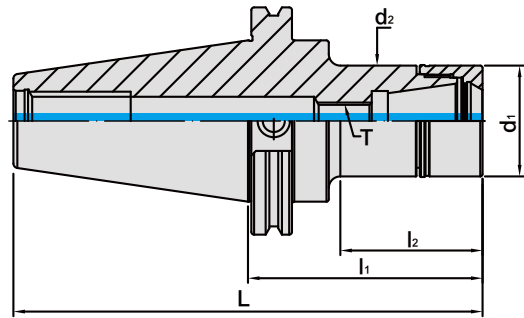

INCHES

MODEL NO.	TYPE	L	l ₁	l ₂	d ₁	d ₂	T	SIZE RANGE	WEIGHT (KGS)
5043-529-016-070	SCAT40 x PRO-E16 - 2.76"	5.447	2.76	1.259	1.181	1.181	M10 x 1.5P	0.0625~ 0.406	1.13
5043-529-016-102	SCAT40 x PRO-E16 - 4"	6.687	4	2.175	1.181	1.181	M10 x 1.5P	0.0625~ 0.406	1.29
5043-529-016-127	SCAT40 x PRO-E16 - 5"	7.687	5	3.175	1.181	1.181	M10 x 1.5P	0.0625~ 0.406	1.40
5043-529-016-152	SCAT40 x PRO-E16 - 6"	8.687	6	4.175	1.181	1.181	M10 x 1.5P	0.0625~ 0.406	1.51
5043-529-016-203	SCAT40 x PRO-E16 - 8"	10.687	8	6.175	1.181	1.181	M10 x 1.5P	0.0625~ 0.406	1.72
5043-529-020-070	SCAT40 x PRO-E20 - 2.76"	5.447	2.76	1.299	1.378	1.378	M12 x 1.75P	0.0625 ~ 0.5	1.17
5043-529-020-102	SCAT40 x PRO-E20 - 4"	6.687	4	2.354	1.378	1.378	M12 x 1.75P	0.0625 ~ 0.5	1.37
5043-529-020-127	SCAT40 x PRO-E20 - 5"	7.687	5	3.354	1.378	1.378	M12 x 1.75P	0.0625 ~ 0.5	1.53
5043-529-020-152	SCAT40 x PRO-E20 - 6"	8.687	6	4.354	1.378	1.378	M12 x 1.75P	0.0625 ~ 0.5	1.69
5043-529-020-203	SCAT40 x PRO-E20 - 8"	10.687	8	6.354	1.378	1.378	M12 x 1.75P	0.0625 ~ 0.5	2.01
5043-529-025-070	SCAT40 x PRO-E25 - 2.76"	5.447	2.76	1.329	1.653	1.653	M16 x 2.0P	0.093 ~ 0.625	1.21
5043-529-025-102	SCAT40 x PRO-E25 - 4"	6.687	4	2.573	1.653	1.653	M16 x 2.0P	0.093 ~ 0.625	1.51
5043-529-025-127	SCAT40 x PRO-E25 - 5"	7.687	5	3.573	1.653	1.653	M16 x 2.0P	0.093 ~ 0.625	1.75
5043-529-025-152	SCAT40 x PRO-E25 - 6"	8.687	6	4.573	1.653	1.653	M16 x 2.0P	0.093 ~ 0.625	2.00
5043-529-025-203	SCAT40 x PRO-E25 - 8"	10.687	8	6.573	1.653	1.653	M16 x 2.0P	0.093 ~ 0.625	2.48
5043-529-032-070	SCAT40 x PRO-E32 - 2.76"	5.447	2.76	1.378	1.969	1.969	M16 x 2.0P	0.0625 ~ 0.75	1.22
5043-529-032-102	SCAT40 x PRO-E32 - 4"	6.687	4	2.622	1.969	1.969	M16 x 2.0P	0.0625 ~ 0.75	1.66
5043-529-032-127	SCAT40 x PRO-E32 - 5"	7.687	5	3.622	1.969	1.969	M16 x 2.0P	0.0625 ~ 0.75	2.01
5043-529-032-152	SCAT40 x PRO-E32 - 6"	8.687	6	4.622	1.969	1.969	M16 x 2.0P	0.0625 ~ 0.75	2.37
5043-529-032-203	SCAT40 x PRO-E32 - 8"	10.687	8	6.622	1.969	1.969	M16 x 2.0P	0.0625 ~ 0.75	3.08

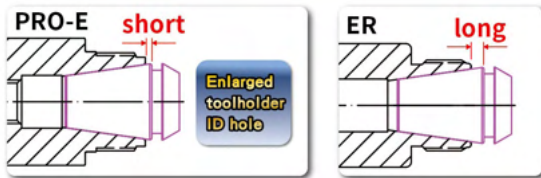

Features:

- ▶ Superior interchangeability with ER collets.
- ▶ Assembled with ER spring collet (15µm, 10µm, 5µm), ERS metallic sealed collet (10µm, 7µm, 5µm, 3µm) and ERS coolant FOD collet (10µm, 7µm, 5µm, 3µm).
- ▶ The design of enlarged holder ID hole optimizes the coverage of ER collet, shortens the tool overhanging length, and improves runout accuracy and machining stability.
- ▶ The design of straight parts above and below the thread makes PRO-E tool holders have better contact with clamping nuts to achieve higher runout accuracy.
- ▶ PRO-E nuts without slots reduce the wind shear at high speed.

Product information:

- ▶ Higher balancing grade and revolution can be done upon request but additional charge is needed.
- ▶ AD+B type is available, please inform us when making an order.

Standard Accessory: • NUT

Collet	Nut	Pull Stud	Spanner	Torque Wrench Adapter (Pull Stud)	Spanner (Pull Stud)	Preset Screw
P.X-18~38	P.X-53	P.X-66	P.X-73、75、82	P.X-77	P.X-78	P.X-111



SCAT / PRO-E COLLET CHUCK



SCAT / PRO-E 法蘭加厚型筒夾式刀桿

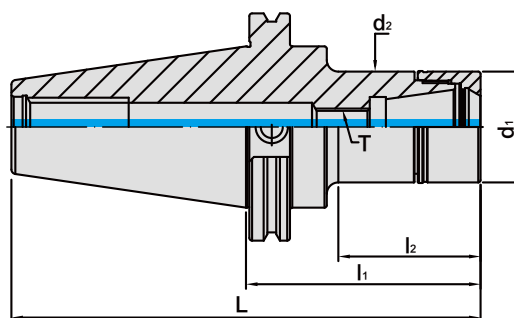

INCHES

MODEL NO.	TYPE	L	l ₁	l ₂	d ₁	d ₂	T	SIZE RANGE	WEIGHT (KGS)
5044-529-016-070	SCAT50 x PRO-E16 - 2.75"	6.75	2.75	1.175	1.181	1.181	M10 x 1.5P	0.0625 ~ 0.406	3.17
5044-529-016-102	SCAT50 x PRO-E16 - 4"	8	4	2.228	1.181	1.181	M10 x 1.5P	0.0625 ~ 0.406	3.27
5044-529-016-127	SCAT50 x PRO-E16 - 5"	9	5	3.031	1.181	1.181	M10 x 1.5P	0.0625 ~ 0.406	3.42
5044-529-016-152	SCAT50 x PRO-E16 - 6"	10	6	4.031	1.181	1.181	M10 x 1.5P	0.0625 ~ 0.406	3.53
5044-529-016-203	SCAT50 x PRO-E16 - 8"	12	8	6.031	1.181	1.181	M10 x 1.5P	0.0625 ~ 0.406	3.73
5044-529-016-254	SCAT50 x PRO-E16 - 10"	14	10	8.031	1.181	1.181	M10 x 1.5P	0.0625 ~ 0.406	3.95
5044-529-020-070	SCAT50 x PRO-E20 - 2.75"	6.75	2.75	1.175	1.378	1.378	M12 x 1.75P	0.0625 ~ 0.5	3.20
5044-529-020-102	SCAT50 x PRO-E20 - 4"	8	4	2.425	1.378	1.378	M12 x 1.75P	0.0625 ~ 0.5	3.35
5044-529-020-127	SCAT50 x PRO-E20 - 5"	9	5	3.228	1.378	1.378	M12 x 1.75P	0.0625 ~ 0.5	3.52
5044-529-020-152	SCAT50 x PRO-E20 - 6"	10	6	4.228	1.378	1.378	M12 x 1.75P	0.0625 ~ 0.5	3.67
5044-529-020-203	SCAT50 x PRO-E20 - 8"	12	8	6.228	1.378	1.378	M12 x 1.75P	0.0625 ~ 0.5	3.96
5044-529-020-254	SCAT50 x PRO-E20 - 10"	14	10	8.228	1.378	1.378	M12 x 1.75P	0.0625 ~ 0.5	4.26
5044-529-025-070	SCAT50 x PRO-E25 - 2.75"	6.75	2.75	1.175	1.653	1.653	M16 x 2.0P	0.093 ~ 0.625	3.24
5044-529-025-102	SCAT50 x PRO-E25 - 4"	8	4	2.228	1.653	1.653	M16 x 2.0P	0.093 ~ 0.625	3.52
5044-529-025-127	SCAT50 x PRO-E25 - 5"	9	5	3.228	1.653	1.653	M16 x 2.0P	0.093 ~ 0.625	3.72
5044-529-025-152	SCAT50 x PRO-E25 - 6"	10	6	4.228	1.653	1.653	M16 x 2.0P	0.093 ~ 0.625	3.92
5044-529-025-203	SCAT50 x PRO-E25 - 8"	12	8	6.228	1.653	1.653	M16 x 2.0P	0.093 ~ 0.625	4.33
5044-529-025-254	SCAT50 x PRO-E25 - 10"	14	10	8.228	1.653	1.653	M16 x 2.0P	0.093 ~ 0.625	4.74
5044-529-032-070	SCAT50 x PRO-E32 - 2.75"	6.75	2.75	1.254	1.969	1.969	M16 x 2.0P	0.0625 ~ 0.75	3.28
5044-529-032-102	SCAT50 x PRO-E32 - 4"	8	4	2.425	1.969	1.969	M16 x 2.0P	0.0625 ~ 0.75	3.68
5044-529-032-127	SCAT50 x PRO-E32 - 5"	9	5	3.425	1.969	1.969	M16 x 2.0P	0.0625 ~ 0.75	3.99
5044-529-032-152	SCAT50 x PRO-E32 - 6"	10	6	4.425	1.969	1.969	M16 x 2.0P	0.0625 ~ 0.75	4.31
5044-529-032-203	SCAT50 x PRO-E32 - 8"	12	8	6.425	1.969	1.969	M16 x 2.0P	0.0625 ~ 0.75	4.94
5044-529-032-254	SCAT50 x PRO-E32 - 10"	14	10	8.425	1.969	1.969	M16 x 2.0P	0.0625 ~ 0.75	5.58

Features:

- ▶ Superior interchangeability with ER collets.
- ▶ Assembled with ER spring collet (15µm, 10µm, 5µm), ERS metallic sealed collet (10µm, 7µm, 5µm, 3µm) and ERS coolant FOD collet (10µm, 7µm, 5µm, 3µm).
- ▶ The design of enlarged holder ID hole optimizes the coverage of ER collet, shortens the tool overhanging length, and improves runout accuracy and machining stability.
- ▶ The design of straight parts above and below the thread makes PRO-E tool holders have better contact with clamping nuts to achieve higher runout accuracy.
- ▶ PRO-E nuts without slots reduce the wind shear at high speed.

Product information:

- ▶ Higher balancing grade and revolution can be done upon request but additional charge is needed.
- ▶ AD+B type is available, please inform us when making an order.

Standard Accessory: • NUT

Collet	Nut	Pull Stud	Spanner	Torque Wrench Adapter (Pull Stud)	Spanner (Pull Stud)	Preset Screw
P.X-18~38	P.X-53	P.X-66	P.X-73、75、82	P.X-77	P.X-78	P.X-111

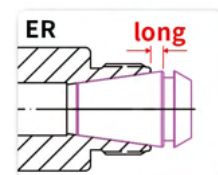
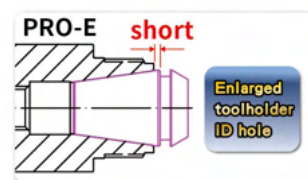

SCAT / UT COLLET CHUCK



SCAT / UT 法蘭加厚型立銑刀夾頭

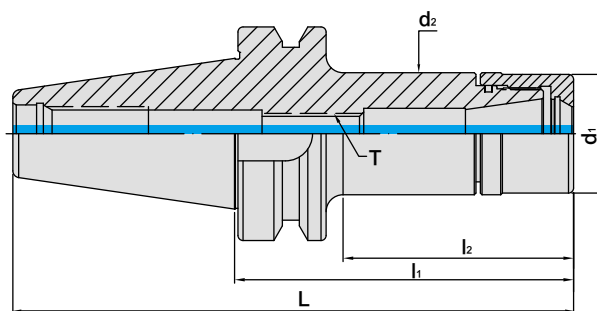
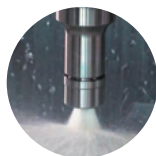

INCHES

MODEL NO.	TYPE	L	l ₁	l ₂	d ₁	d ₂	T	SIZE RANGE	WEIGHT (KGS)
5043-753-016-076	SCAT40 x UT16 - 3"	5.687	3	1.583	1.181	1.181	M10 x 1.5P	0.0625 ~ 0.406	1.16
5043-753-016-102	SCAT40 x UT16 - 4"	6.687	4	2.175	1.181	1.181	M10 x 1.5P	0.0625 ~ 0.406	1.29
5043-753-016-152	SCAT40 x UT16 - 6"	8.687	6	4.175	1.181	1.181	M10 x 1.5P	0.0625 ~ 0.406	1.51
5043-753-020-076	SCAT40 x UT20 - 3"	5.687	3	1.583	1.378	1.417	M12 x 1.75P	0.0625 ~ 0.5	1.20
5043-753-020-102	SCAT40 x UT20 - 4"	6.687	4	2.374	1.378	1.417	M12 x 1.75P	0.0625 ~ 0.5	1.38
5043-753-020-152	SCAT40 x UT20 - 6"	8.687	6	4.374	1.378	1.417	M12 x 1.75P	0.0625 ~ 0.5	1.72
5043-753-032-076	SCAT40 x UT32 - 3"	5.687	3	1.622	1.890	1.890	M16 x 2.0P	0.062 ~ 0.75	1.24
5043-753-032-102	SCAT40 x UT32 - 4"	6.687	4	2.622	1.890	1.890	M16 x 2.0P	0.062 ~ 0.75	1.56
5043-753-032-152	SCAT40 x UT32 - 6"	8.687	6	4.622	1.890	1.890	M16 x 2.0P	0.062 ~ 0.75	2.21
5044-753-016-076	SCAT50 x UT16 - 3"	7	3	1.425	1.181	1.181	M10 x 1.5P	0.062 ~ 0.406	3.19
5044-753-016-102	SCAT50 x UT16 - 4"	8	4	2.228	1.181	1.181	M10 x 1.5P	0.062 ~ 0.406	3.27
5044-753-016-152	SCAT50 x UT16 - 6"	10	6	4.065	1.181	1.181	M10 x 1.5P	0.062 ~ 0.406	3.59
5044-753-020-076	SCAT50 x UT20 - 3"	7	3	1.504	1.378	1.417	M12 x 1.75P	0.0625 ~ 0.5	3.25
5044-753-020-102	SCAT50 x UT20 - 4"	8	4	2.425	1.378	1.417	M12 x 1.75P	0.0625 ~ 0.5	3.39
5044-753-020-152	SCAT50 x UT20 - 6"	10	6	4.228	1.378	1.417	M12 x 1.75P	0.0625 ~ 0.5	3.72
5044-753-032-076	SCAT50 x UT32 - 3"	7	3	1.504	1.890	1.890	M16 x 2.0P	0.0625 ~ 0.75	3.31
5044-753-032-102	SCAT50 x UT32 - 4"	8	4	2.425	1.890	1.890	M16 x 2.0P	0.0625 ~ 0.75	3.60
5044-753-032-152	SCAT50 x UT32 - 6"	10	6	4.425	1.890	1.890	M16 x 2.0P	0.0625 ~ 0.75	4.18

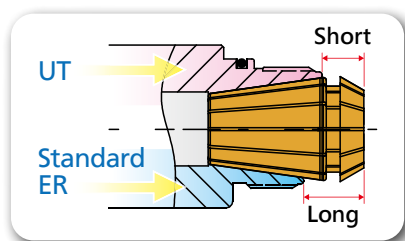

Features:

- ▶ The deeper holder gauge line optimizes the coverage of ER spring collet and increases machining stability.
- ▶ UT clamping nut is designed without eccentric. Used with ER and ERE spring collets.
- ▶ The O-ring design on the front of holders prevents chips and coolant from entering holders
- ▶ UT nuts without slots reduce the wind shear at high speed.

Product information:

- ▶ The pre-balance reaches G6.3 10,000 rpm. Higher balancing grade and revolution can be done upon request but additional charge is needed.
- ▶ AD+B type is available, please inform us when making an order.

Standard Accessory: • NUT

Collet	Nut	Pull Stud	Spanner	Torque Wrench Adapter (Pull Stud)	Spanner (Pull Stud)	Preset Screw
P.X-18~21	P.X-54	P.X-66	PX-73、75、82	P.X-77	P.X-78	P.X-111



SCAT / ER COLLET CHUCK



SCAT / ER 法蘭加厚型立銑刀夾頭

(ISO 15488)

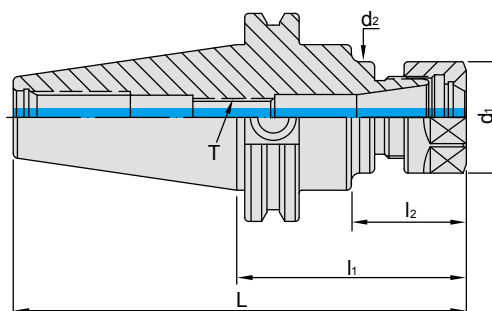

INCHES

MODEL NO.	TYPE	L	l ₁	l ₂	d ₁	d ₂	T	SIZE RANGE	WEIGHT (KGS)
5043-108-016-070	SCAT40 x ER16A - 2.76"	5.442	2.76	1.28	1.102	1.1	M10 x 1.5P	0.062 ~ 0.406	1.50
5043-108-016-102	SCAT40 x ER16A - 4"	6.687	4	2.14	1.102	1.1	M10 x 1.5P	0.062 ~ 0.406	1.10
5043-108-016-152	SCAT40 x ER16A - 6"	8.687	6	4.14	1.102	1.1	M10 x 1.5P	0.062 ~ 0.406	1.55
5043-108-016-203	SCAT40 x ER16A - 8"	10.687	8	6.29	1.102	1.1	M10 x 1.5P	0.062 ~ 0.406	1.85
5043-108-020-070	SCAT40 x ER20A - 2.76"	5.442	2.76	1.28	1.339	1.3	M12 x 1.75P	0.0625 ~ 0.5	1.25
5043-108-020-102	SCAT40 x ER20A - 4"	6.687	4	2.37	1.339	1.3	M12 x 1.75P	0.0625 ~ 0.5	1.65
5043-108-020-152	SCAT40 x ER20A - 6"	8.687	6	4.33	1.339	1.3	M12 x 1.75P	0.0625 ~ 0.5	1.85
5043-110-025-070	SCAT40 x ER25 - 2.76"	5.447	2.76	1.38	1.654	1.75	M16 x 2.0P	0.093 ~ 0.625	1.35
5043-110-025-102	SCAT40 x ER25 - 4"	6.687	4	2.57	1.654	1.65	M16 x 2.0P	0.093 ~ 0.625	1.70
5043-110-025-152	SCAT40 x ER25 - 6"	8.687	6	4.62	1.654	1.65	M16 x 2.0P	0.093 ~ 0.625	2.25
5043-110-025-203	SCAT40 x ER25 - 8"	10.687	8	6.62	1.654	1.65	M16 x 2.0P	0.093 ~ 0.625	2.55
5043-110-032-070	SCAT40 x ER32 - 2.76"	5.447	2.76	1.38	1.969	1.75	M16 x 2.0P	0.0625 ~ 0.75	1.16
5043-110-032-076	SCAT40 x ER32 - 3"	5.687	3	1.62	1.969	1.75	M16 x 2.0P	0.0625 ~ 0.75	1.50
5043-110-032-102	SCAT40 x ER32 - 4"	6.687	4	2.62	1.969	1.75	M16 x 2.0P	0.0625 ~ 0.75	1.75
5043-110-032-152	SCAT40 x ER32 - 6"	8.687	6	5.21	1.969	1.75	M16 x 2.0P	0.0625 ~ 0.75	2.15
5043-110-032-203	SCAT40 x ER32 - 8"	10.687	8	6.62	1.969	1.75	M16 x 2.0P	0.0625 ~ 0.75	2.70
5043-110-040-080	SCAT40 x ER40 - 3.15"	5.837	3.15	1.72	2.48	1.75	M20 x 2.0P	0.125 ~ 1	1.25
5043-110-040-102	SCAT40 x ER40 - 4"	6.687	4	2.48	2.48	2.36	M20 x 2.0P	0.125 ~ 1	1.80
5043-110-040-152	SCAT40 x ER40 - 6"	8.687	6	4.48	2.48	2.36	M20 x 2.0P	0.125 ~ 1	3.00
5043-110-050-102	SCAT40 x ER50 - 4"	6.687	4	2.48	3.07	2.52	M24 x 2.0P	0.219 ~ 1.313	2.65

Features:

- ▶ According to ISO 15488.
- ▶ This ER collet chuck has superior flexibility for use with all tool types, e.g. drills, taps, mills, reamers.
- ▶ It is recommended to tighten the clamping nuts using a torque wrench. Refer to the catalogue page of POWER GOOD VUT for the info. of recommended tightening torque.

Product information:

- ▶ The pre-balance reaches G6.3 10,000 rpm. Higher balancing grade and revolution can be done upon request but additional charge is needed.
- ▶ AD+B type is available, please inform us when making an order.

Standard Accessory: • NUT

Collet	Nut	Pull Stud	Spanner	Torque Wrench Adapter (Pull Stud)	Spanner (Pull Stud)	Preset Screw
P.X-18~38	P.X-54~58	P.X-66	PX-73~76、79	P.X-77	P.X-78	P.X-111

SCAT / ER COLLET CHUCK



SCAT / ER 法蘭加厚型立銑刀夾頭

[ISO 15488]

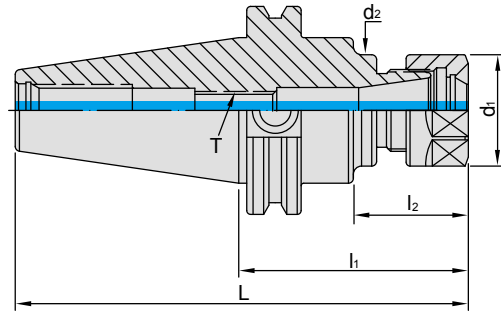

INCHES

MODEL NO.	TYPE	L	l ₁	l ₂	d ₁	d ₂	T	SIZE RANGE	WEIGHT (KGS)
5044-108-016-076	SCAT50 x ER16A - 3"	7	3	1.43	1.102	1.1	M10 x 1.5P	0.062 ~ 0.406	4.05
5044-108-016-102	SCAT50 x ER16A - 4"	8	4	2.07	1.102	1.1	M10 x 1.5P	0.062 ~ 0.406	4.20
5044-108-016-127	SCAT50 x ER16A - 5"	9	5	3.07	1.102	1.1	M10 x 1.5P	0.062 ~ 0.406	4.30
5044-108-016-152	SCAT50 x ER16A - 6"	10	6	4.29	1.102	1.1	M10 x 1.5P	0.062 ~ 0.406	4.40
5044-108-016-203	SCAT50 x ER16A - 8"	12	8	6.15	1.102	1.1	M10 x 1.5P	0.062 ~ 0.406	4.50
5044-108-020-102	SCAT50 x ER20A - 4"	8	4	2.07	1.339	1.34	M12 x 1.75P	0.0625 ~ 0.5	4.20
5044-108-020-152	SCAT50 x ER20A - 6"	10	6	4.15	1.339	1.34	M12 x 1.75P	0.0625 ~ 0.5	4.45
5044-108-020-203	SCAT50 x ER20A - 8"	12	8	6.07	1.339	1.34	M12 x 1.75P	0.0625 ~ 0.5	4.60
5044-110-025-102	SCAT50 x ER25 - 4"	8	4	2.45	1.654	1.65	M16 x 2.0P	0.093 ~ 0.625	4.15
5044-110-025-152	SCAT50 x ER25 - 6"	10	6	3.92	1.654	1.65	M16 x 2.0P	0.093 ~ 0.625	4.50
5044-110-025-203	SCAT50 x ER25 - 8"	12	8	5.91	1.654	1.65	M16 x 2.0P	0.093 ~ 0.625	4.70
5044-110-032-102	SCAT50 x ER32 - 4"	8	4	2.15	1.969	1.96	M16 x 2.0P	0.0625 ~ 0.75	4.35
5044-110-032-152	SCAT50 x ER32 - 6"	10	6	4.15	1.969	1.96	M16 x 2.0P	0.0625 ~ 0.75	4.60
5044-110-032-203	SCAT50 x ER32 - 8"	12	8	6.07	1.969	1.96	M16 x 2.0P	0.0625 ~ 0.75	4.90
5044-110-040-102	SCAT50 x ER40 - 4"	8	4	2.35	2.48	2.36	M20 x 2.0P	0.125 ~ 1	4.25
5044-110-040-152	SCAT50 x ER40 - 6"	10	6	4.43	2.48	2.36	M20 x 2.0P	0.125 ~ 1	4.80
5044-110-040-203	SCAT50 x ER40 - 8"	12	8	6.43	2.48	2.36	M20 x 2.0P	0.125 ~ 1	5.10
5044-110-050-102	SCAT50 x ER50 - 4"	8	4	2.62	3.07	2.75	M24 x 2.0P	0.219 ~ 1.313	4.85
5044-110-050-152	SCAT50 x ER50 - 6"	10	6	4.62	3.07	2.75	M24 x 2.0P	0.219 ~ 1.313	5.55

Features:

- ▶ According to DIN ISO 15488.
- ▶ This ER collet chuck has superior flexibility for use with all tool types, e.g. drills, taps, mills, reamers.
- ▶ It is recommended to tighten the clamping nuts using a torque wrench. Refer to the catalogue page of POWER GOOD VUT for the info. of recommended tightening torque.

Product information:

- ▶ The pre-balance reaches G6.3 10,000 rpm. Higher balancing grade and revolution can be done upon request but additional charge is needed.
- ▶ AD+B type is available, please inform us when making an order.

Standard Accessory: • NUT

Collet	Nut	Pull Stud	Spanner	Torque Wrench Adapter (Pull Stud)	Spanner (Pull Stud)	Preset Screw
P.X-18~38	P.X-54~58	P.X-66	PX-73-76、79	P.X-77	P.X-78	P.X-111



SCAT / ER COLLET CHUCK

M TYPE



M 型 SCAT / ER 法蘭加厚型立銑刀夾頭

(ISO 15488)

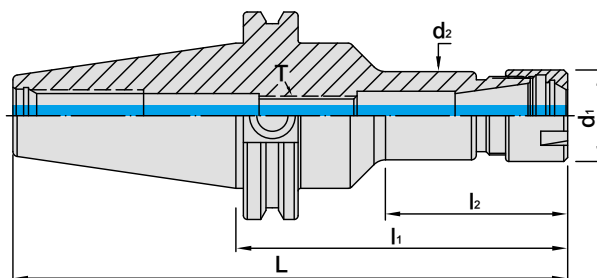
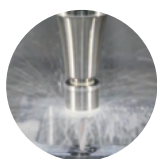

INCHES

MODEL NO.	TYPE	L	l ₁	l ₂	d ₁	d ₂	T	SIZE RANGE	WEIGHT (KGS)
5043-123-011-070	SCAT40 x ER11M - 2.75"	5.437	2.75	1.175	0.63	0.59	M6 x 1.0P	0.0625 ~ 0.25	1.10
5043-123-011-102	SCAT40 x ER11M - 4"	6.687	4	2.228	0.63	0.59	M6 x 1.0P	0.0625 ~ 0.25	1.20
5043-123-016-070	SCAT40 x ER16M - 2.76"	5.447	2.76	1.322	0.87	0.83	M10 x 1.5P	0.0625 ~ 0.406	1.20
5043-123-016-102	SCAT40 x ER16M - 4"	6.687	4	2.425	0.87	0.83	M10 x 1.5P	0.0625 ~ 0.406	1.30
5043-123-020-070	SCAT40 x ER20M - 2.76"	5.447	2.76	1.323	1.102	1.06	M12 x 1.75P	0.0625 ~ 0.5	1.20
5043-123-020-102	SCAT40 x ER20M - 4"	6.687	4	2.197	1.102	1.06	M12 x 1.75P	0.0625 ~ 0.5	1.50
5044-123-016-102	SCAT50 x ER16M - 4"	8	4	1.927	0.87	0.83	M10 x 1.5P	0.0625 ~ 0.406	3.90
5044-123-016-152	SCAT50 x ER16M - 6"	10	6	4.009	0.87	0.83	M10 x 1.5P	0.0625 ~ 0.406	4.00
5044-123-020-102	SCAT50 x ER20M - 4"	8	4	2.127	1.102	1.06	M12 x 1.75P	0.0625 ~ 0.5	4.20
5044-123-020-152	SCAT50 x ER20M - 6"	10	6	4.127	1.102	1.06	M12 x 1.75P	0.0625 ~ 0.5	5.20

Features:

- ▶ According to ISO 15488.
- ▶ This ER collet chuck has superior flexibility for use with all tool types, e.g. drills, taps, mills, reamers.
- ▶ It is recommended to tighten the clamping nuts using a torque wrench. Refer to the catalogue page of ER POWER GOOD NUT for the info. of recommended tightening torque.

Product information:

- ▶ The pre-balance reaches G6.3 10,000 rpm. Higher balancing grade and revolution can be done upon request but additional charge is needed.
- ▶ AD+B type is available, please inform us when making an order.

Standard Accessory: • NUT

Collet	Nut	Pull Stud	Spanner	Torque Wrench Adapter (Pull Stud)	Spanner (Pull Stud)	Preset Screw
P.X-18~38	P.X-55	P.X-66	PX-73-74、79	P.X-77	P.X-78	P.X-111

SCAT / SKX COLLET CHUCK



SCAT / SKX 法蘭加厚型立銑刀夾頭

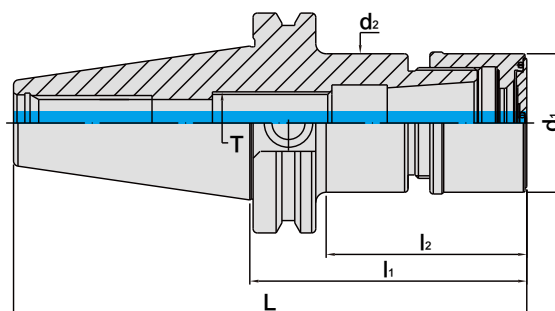
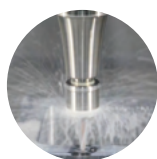

INCHES

MODEL NO.	TYPE	L	l ₁	l ₂	d ₁	d ₂	T	SIZE RANGE	WEIGHT (KGS)
5043-790-006-089	SCAT40 x SKX6 - 3.5"	6.187	3.5	2	0.768	0.768	M8 x 1.25P	0.125 ~ 0.25	1.20
5043-790-006-121	SCAT40 x SKX6 - 4.75"	7.437	4.75	2.89	0.768	0.768	M8 x 1.25P	0.125 ~ 0.25	1.50
5043-790-006-152	SCAT40 x SKX6 - 6"	8.687	6	4.14	0.768	0.768	M8 x 1.25P	0.125 ~ 0.25	1.60
5043-790-010-089	SCAT40 x SKX10 - 3.5"	6.187	3.5	2	1.181	1.181	M12 x 1.75P	0.125 ~ 0.375	1.30
5043-790-010-121	SCAT40 x SKX10 - 4.75"	7.437	4.75	3.25	1.181	1.181	M12 x 1.75P	0.125 ~ 0.375	1.50
5043-790-010-152	SCAT40 x SKX10 - 6"	8.687	6	4.5	1.181	1.181	M12 x 1.75P	0.125 ~ 0.375	1.70
5043-790-010-180	SCAT40 x SKX10 - 7.09"	9.777	7.09	5.59	1.181	1.181	M12 x 1.75P	0.125 ~ 0.375	1.80
5043-790-013-089	SCAT40 x SKX13 - 3.5"	6.187	3.5	2.004	1.299	1.299	M12 x 1.75P	0.125 ~ 0.5	1.05
5043-790-013-102	SCAT40 x SKX13 - 4"	6.687	4	2.504	1.299	1.299	M12 x 1.75P	0.125 ~ 0.5	1.65
5043-790-016-089	SCAT40 x SKX16 - 3.5"	6.187	3.5	2.03	1.575	1.575	M18 x 1.5P	0.125 ~ 0.625	1.60
5043-790-016-121	SCAT40 x SKX16 - 4.75"	7.437	4.75	3.28	1.575	1.575	M18 x 1.5P	0.125 ~ 0.625	1.80
5043-790-016-152	SCAT40 x SKX16 - 6"	8.687	6	4.53	1.575	1.575	M18 x 1.5P	0.125 ~ 0.625	2.00
5043-790-016-180	SCAT40 x SKX16 - 7.09"	9.777	7.09	5.62	1.575	1.575	M18 x 1.5P	0.125 ~ 0.625	2.20
5043-790-020-089	SCAT40 x SKX20 - 3.5"	6.187	3.5	1.71	1.890	1.909	M22 x 1.5P	0.125 ~ 0.75	1.70
5043-790-020-121	SCAT40 x SKX20 - 4.75"	7.437	4.75	2.96	1.890	1.909	M22 x 1.5P	0.125 ~ 0.75	2.00
5043-790-020-152	SCAT40 x SKX20 - 6"	8.687	6	4.21	1.890	1.909	M22 x 1.5P	0.125 ~ 0.75	2.20
5043-790-025-089	SCAT40 x SKX25 - 3.5"	6.187	3.5	1.71	2.165	2.165	M28 x 2.0P	0.125 ~ 1	1.90
5043-790-025-121	SCAT40 x SKX25 - 4.75"	7.437	4.75	2.96	2.165	2.165	M28 x 2.0P	0.125 ~ 1	2.10
5043-790-025-152	SCAT40 x SKX25 - 6"	8.687	6	4.21	2.165	2.165	M28 x 2.0P	0.125 ~ 1	2.30

Features:

- ▶ Higher clamping force and precision stability than 8° ER design due to 4° taper angle collet design.
- ▶ SKX sealed nuts are capable of coolant pressure up to 70bar.
- ▶ Nuts in smaller OD and without slots are suitable for high-speed machining with less interference.
- ▶ Shorter overhanging tool length, better rigidity.
- ▶ SKX tool holders of the length over 120mm have curved line design for better rigidity.

Product information:

- ▶ SKX sealed cap is optional. Please order SKX sealed cap additionally.
- ▶ With the design of SKX sealed cap, coolant pressure capable up to 70 bar.
- ▶ Used with coolant-through tools.

Standard Accessory: • NUT

Collet	Nut	Sealed Cap	Pull Stud	Spanner	Torque Wrench Adapter (Pull Stud)	Spanner (Pull Stud)	Sealed Cap Spanner	Easy Carry Spanner	Preset Screw
P.X-39~40	P.X-59	P.X-60	P.X-66	PX-73、75、82	P.X-77	P.X-78	P.X-80	P.X-80	P.X-111



SCAT / SKX COLLET CHUCK



SCAT / SKX 法蘭加厚型立銑刀夾頭

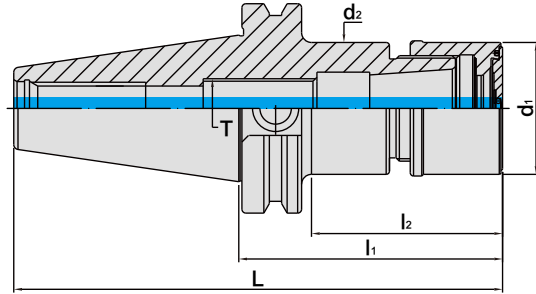
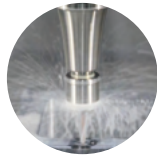

INCHES

MODEL NO.	TYPE	L	l ₁	l ₂	d ₁	d ₂	T	SIZE RANGE	WEIGHT (KGS)
5044-790-006-105	SCAT50 x SKX6 - 4.13"	8.13	4.13	2.27	0.768	0.768	M8 x 1.25P	0.125 ~ 0.25	3.90
5044-790-006-165	SCAT50 x SKX6 - 6.5"	10.5	6.5	4.64	0.768	0.768	M8 x 1.25P	0.125 ~ 0.25	4.10
5044-790-006-195	SCAT50 x SKX6 - 7.68"	11.68	7.68	5.82	0.768	0.768	M8 x 1.25P	0.125 ~ 0.25	4.50
5044-790-010-105	SCAT50 x SKX10 - 4.13"	8.13	4.13	2.55	1.181	1.181	M12 x 1.75P	0.125 ~ 0.375	4.30
5044-790-010-165	SCAT50 x SKX10 - 6.5"	10.5	6.5	4.92	1.181	1.181	M12 x 1.75P	0.125 ~ 0.375	4.70
5044-790-010-195	SCAT50 x SKX10 - 7.68"	11.68	7.68	6.1	1.181	1.181	M12 x 1.75P	0.125 ~ 0.375	4.80
5044-790-010-225	SCAT50 x SKX10 - 8.86"	12.86	8.86	7.28	1.181	1.181	M12 x 1.75P	0.125 ~ 0.375	4.90
5044-790-013-102	SCAT50 x SKX13 - 4"	8	4	2.425	1.299	1.299	M12 x 1.75P	0.125 ~ 0.5	3.80
5044-790-013-114	SCAT50 x SKX13 - 4.5"	8.5	4.5	2.925	1.299	1.299	M12 x 1.75P	0.125 ~ 0.5	4.00
5044-790-016-105	SCAT50 x SKX16 - 4.13"	8.13	4.13	2.55	1.575	1.575	M18 x 1.5P	0.125 ~ 0.625	4.80
5044-790-016-165	SCAT50 x SKX16 - 6.5"	10.5	6.5	4.92	1.575	1.575	M18 x 1.5P	0.125 ~ 0.625	5.20
5044-790-016-225	SCAT50 x SKX16 - 8.86"	12.86	8.86	7.28	1.575	1.575	M18 x 1.5P	0.125 ~ 0.625	5.70
5044-790-020-105	SCAT50 x SKX20 - 4.13"	8.13	4.13	2.55	1.89	1.909	M22 x 1.5P	0.125 ~ 0.75	4.40
5044-790-020-165	SCAT50 x SKX20 - 6.5"	10.5	6.5	4.92	1.89	1.909	M22 x 1.5P	0.125 ~ 0.75	5.10
5044-790-020-225	SCAT50 x SKX20 - 8.86"	12.86	8.86	7.28	1.89	1.909	M22 x 1.5P	0.125 ~ 0.75	5.70
5044-790-025-105	SCAT50 x SKX25 - 4.13"	8.13	4.13	2.55	2.165	2.165	M28 x 2.0P	0.125 ~ 1	5.30
5044-790-025-165	SCAT50 x SKX25 - 6.5"	10.5	6.5	4.92	2.165	2.165	M28 x 2.0P	0.125 ~ 1	6.00
5044-790-025-225	SCAT50 x SKX25 - 8.86"	12.86	8.86	7.28	2.165	2.165	M28 x 2.0P	0.125 ~ 1	6.30

Features:

- ▶ Higher clamping force and precision stability than 8° ER design due to 4° taper angle collet design.
- ▶ SKX sealed nuts are capable of coolant pressure up to 70bar.
- ▶ Nuts in smaller OD and without slots are suitable for high-speed machining with less interference.
- ▶ Shorter overhanging tool length, better rigidity.
- ▶ SKX tool holders of the length over 120mm have curved line design for better rigidity.

Product information:

- ▶ SKX sealed cap is optional. Please order SKX sealed cap additionally.
- ▶ With the design of SKX sealed cap, coolant pressure capable up to 70 bar.
- ▶ Used with coolant-through tools.

Standard Accessory: • NUT

Collet	Nut	Sealed Cap	Pull Stud	Spanner	Torque Wrench Adapter (Pull Stud)	Spanner (Pull Stud)	Sealed Cap Spanner	Easy Carry Spanner	Preset Screw
P.X-39~40	P.X-59	P.X-60	P.X-66	PX-73、75、82	P.X-77	P.X-78	P.X-80	P.X-80	P.X-111

SCAT / SK3 COLLET CHUCK



SCAT / SK3 高速機專用夾頭

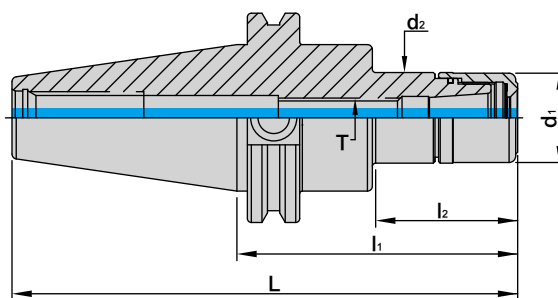

INCHES

MODEL NO.	TYPE	L	l ₁	l ₂	d ₁	d ₂	T	SIZE RANGE	WEIGHT (KGS)
5043-763-006-089	SCAT40 x SK306 - 3.5"	6.187	3.5	1.468	0.768	0.768	M8 x 1.25P	0.0625 ~ 0.1875	1.05
5043-763-006-102	SCAT40 x SK306 - 4"	6.687	4	1.968	0.768	0.768	M8 x 1.25P	0.0625 ~ 0.1875	1.65
5043-763-010-089	SCAT40 x SK310 - 3.5"	6.187	3.5	2.062	1.083	1.083	M12 x 1.75P	0.125 ~ 0.375	1.05
5043-763-010-102	SCAT40 x SK310 - 4"	6.687	4	2.562	1.083	1.083	M12 x 1.75P	0.125 ~ 0.375	1.65
5043-763-013-089	SCAT40 x SK313 - 3.5"	6.187	3.5	2.004	1.299	1.299	M12 x 1.75P	0.125 ~ 0.5	1.05
5043-763-013-102	SCAT40 x SK313 - 4"	6.687	4	2.504	1.299	1.299	M12 x 1.75P	0.125 ~ 0.5	1.65
5043-763-016-089	SCAT40 x SK316 - 3.5"	6.187	3.5	2.034	1.575	1.575	M18 x 1.5P	0.125 ~ 0.625	1.35
5043-763-016-102	SCAT40 x SK316 - 4"	6.687	4	2.534	1.575	1.575	M18 x 1.5P	0.125 ~ 0.625	2.10
5043-763-020-089	SCAT40 x SK320 - 3.5"	6.187	3.5	2.12	1.89	1.91	M22 x 1.5P	0.125 ~ 0.75	1.60
5043-763-020-102	SCAT40 x SK320 - 4"	6.687	4	2.62	1.89	1.91	M22 x 1.5P	0.125 ~ 0.75	2.00
5043-763-025-089	SCAT40 x SK325 - 3.5"	6.187	3.5	2.12	2.17	2.17	M28 x 2.0P	0.125 ~ 1	1.70
5043-763-025-102	SCAT40 x SK325 - 4"	6.687	4	2.62	2.17	2.17	M28 x 2.0P	0.125 ~ 1	1.80
5044-763-006-089	SCAT50 x SK306 - 3.5"	7.5	3.5	1.728	0.768	0.768	M8 x 1.25P	0.0625 ~ 0.1875	3.60
5044-763-006-102	SCAT50 x SK306 - 4"	8	4	2.228	0.768	0.768	M8 x 1.25P	0.0625 ~ 0.1875	4.00
5044-763-010-102	SCAT50 x SK310 - 4"	8	4	2.562	1.083	1.083	M12 x 1.75P	0.125 ~ 0.375	3.80
5044-763-010-114	SCAT50 x SK310 - 4.5"	8.5	4.5	2.044	1.083	1.083	M12 x 1.75P	0.125 ~ 0.375	4.00
5044-763-013-102	SCAT50 x SK313 - 4"	8	4	2.425	1.299	1.299	M12 x 1.75P	0.125 ~ 0.5	3.80
5044-763-013-114	SCAT50 x SK313 - 4.5"	8.5	4.5	2.925	1.299	1.299	M12 x 1.75P	0.125 ~ 0.5	4.00
5044-763-016-102	SCAT50 x SK316 - 4"	8	4	2.425	1.575	1.575	M18 x 1.5P	0.125 ~ 0.625	4.00
5044-763-016-114	SCAT50 x SK316 - 4.5"	8.5	4.5	2.945	1.575	1.575	M18 x 1.5P	0.1250 ~ 0.625	4.15
5044-763-020-102	SCAT50 x SK320 - 4"	8	4	2.504	1.89	1.91	M22 x 1.5P	0.125 ~ 0.75	4.30
5044-763-020-114	SCAT50 x SK320 - 4.5"	8.5	4.5	3.004	1.89	1.91	M22 x 1.5P	0.125 ~ 0.75	4.60
5044-763-025-102	SCAT50 x SK325 - 4"	8	4	2.17	2.17	2.17	M28 x 2.0P	0.125 ~ 1	4.50
5044-763-025-114	SCAT50 x SK325 - 4.5"	8.5	4.5	2.67	2.17	2.17	M28 x 2.0P	0.125 ~ 1	4.80

Features:

- ▶ Using 4° taper angle collets achieves higher clamping power and stability than 8° design of the ER system.
- ▶ Smaller OD nuts without slots are ideal for high-speed machining with less interference.
- ▶ Dustproof design of adding O rings prevents metal chips and coolants from getting into tool holders.

Product information:

- ▶ Higher balancing grade and revolution can be done upon request but additional charge is needed.
- ▶ AD+B type is available, please inform us when making an order.

Standard Accessory: • NUT

Collet	Nut	Pull Stud	Spanner	Torque Wrench Adapter (Pull Stud)	Spanner (Pull Stud)	Preset Screw
P.X-39~41	P.X-58	P.X-66	PX-73、75、82	P.X-77	P.X-78	P.X-111



SCAT / SBL SLIM-FIT COLLET CHUCK



SCAT / SBL 法蘭加厚型後拉式立銑刀夾頭

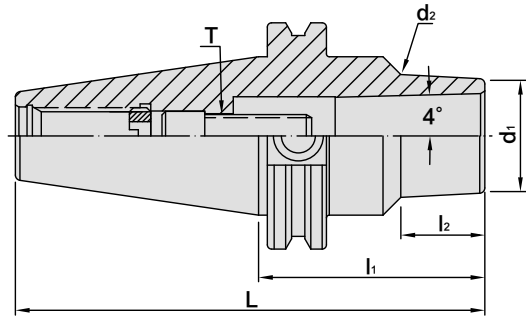

INCHES

MODEL NO.	TYPE	L	l ₁	l ₂	d ₁	d ₂	T	RECOMMENDED TORQUE		SIZE RANGE	WEIGHT (KGS)
								N.m	1bf-ft		
5043-648-006-076	SCAT40 x SBL6 - 3"	5.687	3	1.09	0.55	0.65	M6 x 1.0P	12	9	0.125 ~ 0.25	1.00
5043-648-006-102	SCAT40 x SBL6 - 4"	6.687	4	2.12	0.55	0.74	M6 x 1.0P	12	9	0.125 ~ 0.25	1.25
5043-648-006-152	SCAT40 x SBL6 - 6"	8.687	6	4.17	0.55	0.92	M6 x 1.0P	12	9	0.125 ~ 0.25	1.20
5043-648-008-102	SCAT40 x SBL8 - 4"	6.687	4	2.18	0.787	1.02	M8 x 1.25P	29	21	0.125 ~ 0.3125	1.13
5043-648-008-127	SCAT40 x SBL8 - 5"	7.687	5	3.43	0.787	1.14	M8 x 1.25P	29	21	0.125 ~ 0.3125	1.24
5043-648-008-152	SCAT40 x SBL8 - 6"	8.687	6	4.43	0.787	1.25	M8 x 1.25P	29	21	0.125 ~ 0.3125	1.39
5043-648-012-064	SCAT40 x SBL12 - 2.5"	5.187	2.5	0.82	1.02	1.15	M10 x 1.5P	45	33	0.125 ~ 0.5	1.45
5043-648-012-102	SCAT40 x SBL12 - 4"	6.687	4	2.23	1.02	1.26	M10 x 1.5P	45	33	0.125 ~ 0.5	1.20
5043-648-012-152	SCAT40 x SBL12 - 6"	8.687	6	4.49	1.02	1.49	M10 x 1.5P	45	33	0.125 ~ 0.5	1.45
5043-648-020-064	SCAT40 x SBL20 - 2.5"	5.187	2.5	0.98	1.38	1.46	M12 x 1.75P	60	44	0.125 ~ 0.75	1.20
5043-648-020-102	SCAT40 x SBL20 - 4"	6.687	4	2.55	1.37	1.6	M12 x 1.75P	60	44	0.125 ~ 0.75	1.60
5043-648-020-152	SCAT40 x SBL20 - 6"	8.687	6	4.62	1.37	-	M12 x 1.75P	60	44	0.125 ~ 0.75	1.50
5043-648-025-083	SCAT40 x SBL25 - 3.25"	5.937	3.25	1.86	1.57	1.73	M16 x 1.5P	90	66	0.125 ~ 1	1.40
5043-648-025-102	SCAT40 x SBL25 - 4"	6.687	4	2.61	1.57	1.75	M16 x 1.5P	90	66	0.125 ~ 1	1.60
5044-648-006-089	SCAT50 x SBL6 - 3.5"	7.5	3.5	1.56	0.55	0.71	M6 x 1.0P	12	9	0.125 ~ 0.25	1.70
5044-648-006-114	SCAT50 x SBL6 - 4.5"	8.5	4.5	2.38	0.55	0.8	M6 x 1.0P	12	9	0.125 ~ 0.25	1.50
5044-648-006-152	SCAT50 x SBL6 - 6"	10	6	3.96	0.55	0.97	M6 x 1.0P	12	9	0.125 ~ 0.25	1.70
5044-648-008-102	SCAT50 x SBL8 - 4"	8	4	2.24	0.787	1.01	M8 x 1.25P	29	21	0.125 ~ 0.3125	3.23
5044-648-008-127	SCAT50 x SBL8 - 5"	9	5	3.25	0.787	1.12	M8 x 1.25P	29	21	0.125 ~ 0.3125	3.36
5044-648-008-152	SCAT50 x SBL8 - 6"	10	6	4.24	0.787	1.23	M8 x 1.25P	29	21	0.125 ~ 0.3125	3.51
5044-648-012-064	SCAT50 x SBL12 - 2.5"	6.5	2.5	0.93	1.02	1.11	M10 x 1.5P	45	33	0.125 ~ 0.5	4.00
5044-648-012-114	SCAT50 x SBL12 - 4.5"	8.5	4.5	2.75	1.02	1.27	M10 x 1.5P	45	33	0.125 ~ 0.5	4.10
5044-648-012-152	SCAT50 x SBL12 - 6"	10	6	4.25	1.02	1.4	M10 x 1.5P	45	33	0.125 ~ 0.5	4.20
5044-648-020-064	SCAT50 x SBL20 - 2.5"	6.5	2.5	0.75	1.37	1.44	M12 x 1.75P	60	44	0.125 ~ 0.75	4.30
5044-648-020-114	SCAT50 x SBL20 - 4.5"	8.5	4.5	2.75	1.37	1.62	M12 x 1.75P	60	44	0.125 ~ 0.75	4.60
5044-648-020-152	SCAT50 x SBL20 - 6"	10	6	4.12	1.37	1.74	M12 x 1.75P	60	44	0.125 ~ 0.75	4.70
5044-648-025-070	SCAT50 x SBL25 - 2.75"	6.75	2.75	1.33	1.69	1.57	M16 x 1.5P	90	66	0.125 ~ 1	4.40
5044-648-025-114	SCAT50 x SBL25 - 4.5"	8.5	4.5	3.06	1.84	1.57	M16 x 1.5P	90	66	0.125 ~ 1	4.60

Features:

- ▶ The design of non-clamping nut and slim front ends reduces interference, ideal for deep hole machining.
- ▶ Taper angle 4° increases the stability of clamping precision.
- ▶ T.I.R. is within 5µm at 4D distance.

Product information:

- ▶ Higher balancing grade and revolution can be done upon request but additional charge is needed.

Collet	Pull Stud	Torque Wrench Adapter (Pull Stud)	Spanner (Pull Stud)	SCREW	Spanner
P.X-42	P.X-66	P.X-73、77	P.X-78	P.X-114	P.X-80

SCAT / SBLC SLIM-FIT COLLET CHUCK



SCAT / SBLC 法蘭加厚型後拉式立銼刀夾頭

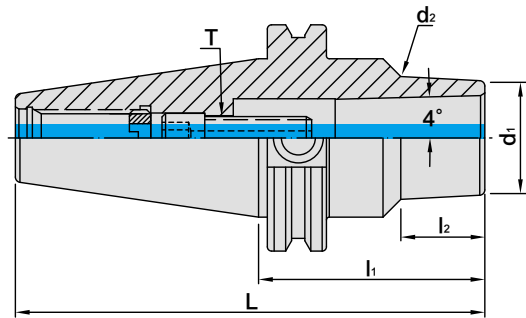

INCHES

MODEL NO.	TYPE	L	l ₁	l ₂	d ₁	d ₂	T	RECOMMENDED TORQUE		SIZE RANGE	WEIGHT (KGS)
								N.m	1bf-ft		
5043-623-006-076	SCAT40 x SBLC6 - 3"	5.687	3	1.09	0.55	0.65	M6 x 1.0P	12	9	0.125 ~ 0.25	1.00
5043-623-006-102	SCAT40 x SBLC6 - 4"	6.687	4	2.12	0.55	0.74	M6 x 1.0P	12	9	0.125 ~ 0.25	1.25
5043-623-006-152	SCAT40 x SBLC6 - 6"	8.687	6	4.17	0.55	0.92	M6 x 1.0P	12	9	0.125 ~ 0.25	1.20
5043-623-008-102	SCAT40 x SBLC8 - 4"	6.687	4	2.18	0.787	1.02	M8 x 1.25P	29	21	0.125 ~ 0.3125	1.13
5043-623-008-127	SCAT40 x SBLC8 - 5"	7.687	5	3.43	0.787	1.14	M8 x 1.25P	29	21	0.125 ~ 0.3125	1.24
5043-623-008-152	SCAT40 x SBLC8 - 6"	8.687	6	4.43	0.787	1.25	M8 x 1.25P	29	21	0.125 ~ 0.3125	1.39
5043-623-012-064	SCAT40 x SBLC12 - 2.5"	5.187	2.5	0.82	1.02	1.15	M10 x 1.5P	45	33	0.125 ~ 0.5	1.45
5043-623-012-102	SCAT40 x SBLC12 - 4"	6.687	4	2.23	1.02	1.26	M10 x 1.5P	45	33	0.125 ~ 0.5	1.20
5043-623-012-152	SCAT40 x SBLC12 - 6"	8.687	6	4.49	1.02	1.49	M10 x 1.5P	45	33	0.125 ~ 0.5	1.45
5043-623-020-064	SCAT40 x SBLC20 - 2.5"	5.187	2.5	0.98	1.38	1.46	M12 x 1.75P	60	44	0.125 ~ 0.75	1.20
5043-623-020-102	SCAT40 x SBLC20 - 4"	6.687	4	2.55	1.37	1.6	M12 x 1.75P	60	44	0.125 ~ 0.75	1.60
5043-623-020-152	SCAT40 x SBLC20 - 6"	8.687	6	4.62	1.37	-	M12 x 1.75P	60	44	0.125 ~ 0.75	1.50
5043-623-025-083	SCAT40 x SBLC25 - 3.25"	5.937	3.25	1.86	1.57	1.73	M16 x 1.5P	90	66	0.125 ~ 1	1.40
5043-623-025-102	SCAT40 x SBLC25 - 4"	6.687	4	2.61	1.57	1.75	M16 x 1.5P	90	66	0.125 ~ 1	1.60
5044-623-006-089	SCAT50 x SBLC6 - 3.5"	7.5	3.5	1.56	0.55	0.71	M6 x 1.0P	12	9	0.125 ~ 0.25	1.70
5044-623-006-114	SCAT50 x SBLC6 - 4.5"	8.5	4.5	2.38	0.55	0.8	M6 x 1.0P	12	9	0.125 ~ 0.25	1.50
5044-623-006-152	SCAT50 x SBLC6 - 6"	10	6	3.96	0.55	0.97	M6 x 1.0P	12	9	0.125 ~ 0.25	1.70
5044-623-008-102	SCAT50 x SBLC8 - 4"	8	4	2.24	0.787	1.01	M8 x 1.25P	29	21	0.125 ~ 0.3125	3.23
5044-623-008-127	SCAT50 x SBLC8 - 5"	9	5	3.25	0.787	1.12	M8 x 1.25P	29	21	0.125 ~ 0.3125	3.36
5044-623-008-152	SCAT50 x SBLC8 - 6"	10	6	4.24	0.787	1.23	M8 x 1.25P	29	21	0.125 ~ 0.3125	3.51
5044-623-012-064	SCAT50 x SBLC12 - 2.5"	6.5	2.5	0.93	1.02	1.11	M10 x 1.5P	45	33	0.125 ~ 0.5	4.00
5044-623-012-114	SCAT50 x SBLC12 - 4.5"	8.5	4.5	2.75	1.02	1.27	M10 x 1.5P	45	33	0.125 ~ 0.5	4.10
5044-623-012-152	SCAT50 x SBLC12 - 6"	10	6	4.25	1.02	1.4	M10 x 1.5P	45	33	0.125 ~ 0.5	4.20
5044-623-020-064	SCAT50 x SBLC20 - 2.5"	6.5	2.5	0.75	1.37	1.44	M12 x 1.75P	60	44	0.125 ~ 0.75	4.30
5044-623-020-114	SCAT50 x SBLC20 - 4.5"	8.5	4.5	2.75	1.37	1.62	M12 x 1.75P	60	44	0.125 ~ 0.75	4.60
5044-623-020-152	SCAT50 x SBLC20 - 6"	10	6	4.12	1.37	1.74	M12 x 1.75P	60	44	0.125 ~ 0.75	4.70
5044-623-025-070	SCAT50 x SBLC25 - 2.75"	6.75	2.75	1.33	1.57	1.69	M16 x 1.5P	90	66	0.125 ~ 1	4.40
5044-623-025-114	SCAT50 x SBLC25 - 4.5"	8.5	4.5	3.06	1.57	1.84	M16 x 1.5P	90	66	0.125 ~ 1	4.60

Features:

- ▶ SBLC collet chuck used for center coolant improves the metal chip removal capability and the surface finish of the workpiece.
- ▶ The design of non-clamping nut and slim front ends reduces interference, ideal for deep hole machining.
- ▶ T.I.R. is within 5µm at 4D distance.
- ▶ Taper angle 4° increases the stability of clamping precision.

Product information:

- ▶ Higher balancing grade and revolution can be done upon request but additional charge is needed.
- ▶ Used with SLC sealed collet and coolant through cutters.
- ▶ AD+B type is available, please inform us when making an order.

Standard Accessory: • SPANNER

Collet	Pull Stud	Torque Wrench Adapter (Pull Stud)	Spanner (Pull Stud)	Screw	Spanner
P.X-43	P.X-66	P.X-73、77	P.X-78	P.X-114	P.X-80



SCAT/EBL SLIM-FIT COLLET CHUCK



SCAT / EBL 法蘭加厚型後拉式刀桿

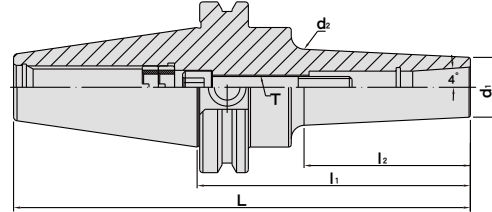

INCHES

MODEL NO.	TYPE	L	l ₁	l ₂	d ₁	d ₂	T	RECOMMENDED TORQUE		SIZE RANGE	WEIGHT (KGS)
								N.m	lbf-ft		
5043-277-006-076	SCAT40 x EBL6 - 3"	5.687	3	1.43	0.75	0.89	M6 x 1.0P	12	9	0.125 ~ 0.25	1.21
5043-277-006-102	SCAT40 x EBL6 - 4"	6.687	4	2.43	0.75	0.98	M6 x 1.0P	12	9	0.125 ~ 0.25	1.21
5043-277-006-152	SCAT40 x EBL6 - 6"	8.687	6	4.43	0.75	1.18	M6 x 1.0P	12	9	0.125 ~ 0.25	1.48
5043-277-008-076	SCAT40 x EBL8 - 3"	5.687	3	1.43	0.875	1.01	M8 x 1.25P	29	21	0.125 ~ 0.3125	1.08
5043-277-008-102	SCAT40 x EBL8 - 4"	6.687	4	2.43	0.875	1.11	M8 x 1.25P	29	21	0.125 ~ 0.3125	1.25
5043-277-008-152	SCAT40 x EBL8 - 6"	8.687	6	4.50	0.875	1.31	M8 x 1.25P	29	21	0.125 ~ 0.3125	1.50
5044-277-006-076	SCAT50 x EBL6 - 3"	7	3	1.24	0.75	0.87	M6 x 1.0P	12	9	0.125 ~ 0.25	3.19
5044-277-006-102	SCAT50 x EBL6 - 4"	8	4	2.24	0.75	0.96	M6 x 1.0P	12	9	0.125 ~ 0.25	3.31
5044-277-006-152	SCAT50 x EBL6 - 6"	10	6	4.24	0.75	1.16	M6 x 1.0P	12	9	0.125 ~ 0.25	3.53
5044-277-008-076	SCAT50 x EBL8 - 3"	7	3	1.24	0.875	0.96	M8 x 1.25P	29	21	0.125 ~ 0.3125	3.26
5044-277-008-102	SCAT50 x EBL8 - 4"	8	4	2.24	0.875	1.092	M8 x 1.25P	29	21	0.125 ~ 0.3125	3.33
5044-277-008-152	SCAT50 x EBL8 - 6"	10	6	4.24	0.875	1.29	M8 x 1.25P	29	21	0.125 ~ 0.3125	3.53



▶ SBL



▶ EBL

Features:

- ▶ EBL collet with extended length shortens tool overhanging length and improves the machining stability.
- ▶ The optimized design of thicker neck improves the machining rigidity and eliminates vibration, resulting in excellent surface finish of workpiece.

Product information:

- ▶ AD+B type is available, please inform us when making an order.

Standard Accessory: •SPANNER

Collet	Pull Stud	Torque Wrench Adapter (Pull Stud)	Spanner (Pull Stud)	Spanner	Screw
P.X-44	P.X-66	P.X-73、77	P.X-78	P.X-80	P.X-114

SCAT/EBLC SLIM-FIT COLLET CHUCK



SCAT / EBLC 法蘭加厚型後拉式刀桿

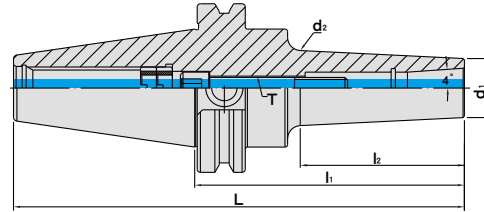

INCHES

MODEL NO.	TYPE	L	l ₁	l ₂	d ₁	d ₂	T	RECOMMENDED TORQUE		SIZE RANGE	WEIGHT (KGS)
								N.m	lbf-ft		
5043-195-006-076	SCAT40 x EBLC6 - 3"	5.687	3	1.43	0.75	0.89	M6 x 1.0P	12	9	0.125 ~ 0.25	1.21
5043-195-006-102	SCAT40 x EBLC6 - 4"	6.687	4	2.43	0.75	0.98	M6 x 1.0P	12	9	0.125 ~ 0.25	1.21
5043-195-006-152	SCAT40 x EBLC6 - 6"	8.687	6	4.43	0.75	1.18	M6 x 1.0P	12	9	0.125 ~ 0.25	1.48
5043-195-008-076	SCAT40 x EBLC8 - 3"	5.687	3	1.43	0.875	1.01	M8 x 1.25P	29	21	0.125 ~ 0.3125	1.08
5043-195-008-102	SCAT40 x EBLC8 - 4"	6.687	4	2.43	0.875	1.11	M8 x 1.25P	29	21	0.125 ~ 0.3125	1.25
5043-195-008-152	SCAT40 x EBLC8 - 6"	8.687	6	4.5	0.875	1.31	M8 x 1.25P	29	21	0.125 ~ 0.3125	1.50
5044-195-006-076	SCAT50 x EBLC6 - 3"	7	3	1.24	0.75	0.87	M6 x 1.0P	12	9	0.125 ~ 0.25	3.19
5044-195-006-102	SCAT50 x EBLC6 - 4"	8	4	2.24	0.75	0.96	M6 x 1.0P	12	9	0.125 ~ 0.25	3.31
5044-195-006-152	SCAT50 x EBLC6 - 6"	10	6	4.24	0.75	1.16	M6 x 1.0P	12	9	0.125 ~ 0.25	3.53
5044-195-008-076	SCAT50 x EBLC8 - 3"	7	3	1.24	0.875	0.96	M8 x 1.25P	29	21	0.125 ~ 0.3125	3.26
5044-195-008-102	SCAT50 x EBLC8 - 4"	8	4	2.24	0.875	1.092	M8 x 1.25P	29	21	0.125 ~ 0.3125	3.33
5044-195-008-152	SCAT50 x EBLC8 - 6"	10	6	4.24	0.875	1.29	M8 x 1.25P	29	21	0.125 ~ 0.3125	3.53



▶ SBLC



▶ EBLC

Features:

- ▶ EBLC collet chuck used for center coolant improves the metal chip removal capability and the surface finish of the workpiece.
- ▶ EBL sealed collet with extended length shortens tool overhanging length and improves the machining stability.
- ▶ The optimized design of thicker neck improves the machining rigidity and eliminates vibration, resulting in excellent surface finish of workpiece.
- ▶ EBL sealed collet is capable of coolant pressure up to 25bar.

Product information:

- ▶ AD+B type is available, please inform us when making an order.

Standard Accessory: •SPANNER

Collet	Pull Stud	Torque Wrench Adapter (Pull Stud)	Spanner (Pull Stud)	Spanner	Screw
P.X-44	P.X-66	P.X-73、77	P.X-78	P.X-80	P.X-114



SCAT / HBL SLIM-FIT COLLET CHUCK



SCAT / HBL 法蘭加厚型後拉式立銑刀夾頭

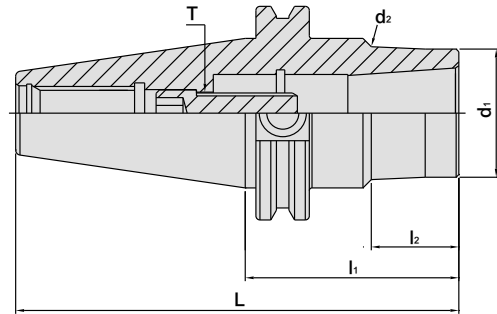

INCHES

MODEL NO.	TYPE	L	l ₁	l ₂	d ₁	d ₂	T	WEIGHT (KGS)
5043-275-012-064	SCAT40 x HBL12 - 2.5"	5.187	2.5	0.89	1.25	1.29	M10 x 1.5P	1.65
5043-275-012-102	SCAT40 x HBL12 - 4"	6.687	4	2.46	1.25	1.43	M10 x 1.5P	1.40
5043-275-020-064	SCAT40 x HBL20 - 2.5"	5.187	2.5	1.02	1.5	1.56	M12 x 1.75P	1.40
5043-275-020-102	SCAT40 x HBL20 - 4"	6.687	4	2.59	1.5	1.69	M12 x 1.75P	1.80
5043-275-025-083	SCAT40 x HBL25 - 3.25"	5.937	3.25	1.81	1.75	1.874	M16 x 1.5P	1.60
5043-275-025-102	SCAT40 x HBL25 - 4"	6.687	4	2.529	1.75	1.936	M16 x 1.5P	1.80
5044-275-012-064	SCAT50 x HBL12 - 2.5"	6.5	2.5	1.12	1.25	1.30	M10 x 1.5P	4.20
5044-275-012-114	SCAT50 x HBL12 - 4.5"	8.5	4.5	2.75	1.25	1.46	M10 x 1.5P	4.30
5044-275-020-064	SCAT50 x HBL20 - 2.5"	6.5	2.5	0.93	1.5	1.55	M12 x 1.75P	4.50
5044-275-020-114	SCAT50 x HBL20 - 4.5"	8.5	4.5	2.93	1.5	1.72	M12 x 1.75P	4.80
5044-275-025-070	SCAT50 x HBL25 - 2.75"	6.75	2.75	1.316	1.75	1.831	M16 x 1.5P	4.60
5044-275-025-114	SCAT50 x HBL25 - 4.5"	8.5	4.5	3.066	1.75	1.983	M16 x 1.5P	4.80

HLB Cutter for HBL Slim-Fit Collet Chuck

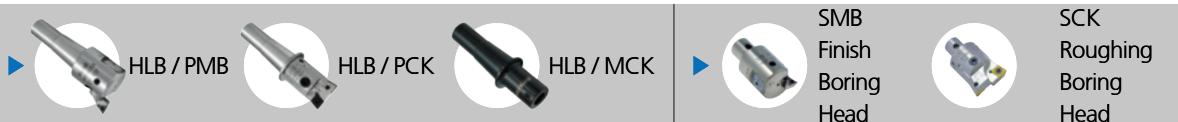

Features:

- ▶ Two-face contact between collet taper, collet flange and the end of HBL tool holder, increases the rigidity of machining.
- ▶ Modular system, assembled with HLB tools.
- ▶ HBL drawbar clamping design strengthens the axial clamping force.

Product information:

- ▶ Higher balancing grade and revolution can be done upon request but additional charge is needed.
- ▶ When assembling with coolant through HLB cutter SLC sealed collet, please change the screw into coolant screw, which is available to order separately.
- ▶ AD+B type is available, please inform us when making an order.

SLC Collet	Pull Stud	Torque Wrench Adapter (Pull Stud)	Spanner (Pull Stud)	Spanner	HLB Cutter	Screw
P.X-42~43	P.X-66	P.X-73、77	P.X-78	P.X-80	P.X-83~97	P.X-114

SCAT / MLD MULTI - LOCK MILLING CHUCK



SCAT / MLD 法蘭加厚型直式筒夾 銑床夾頭

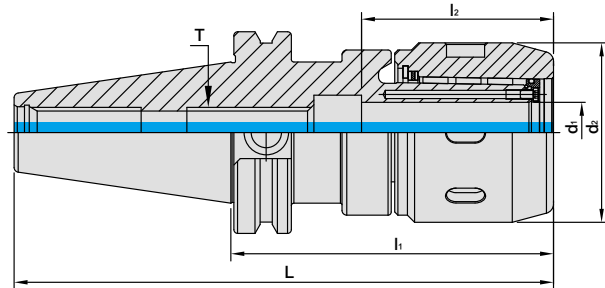

INCHES

MODEL NO.	TYPE	L	l ₁	l ₂	d ₁	d ₂	T	WEIGHT (KGS)
5043-460-A32-335	SCAT40 x MLD1/2" - 3.35"	6.03	3.35	1.84	0.5	1.654	M12 x 1.75P	1.80
5043-460-A40-350	SCAT40 x MLD5/8" - 3.5"	6.187	3.5	2.23	0.625	1.889	M12 x 1.75P	1.90
5043-460-A48-400	SCAT40 x MLD3/4" - 4"	6.687	4	2.34	0.75	2.224	5/8" - 11	1.90
5043-460-A48-600	SCAT40 x MLD3/4" - 6"	8.687	6	2.34	0.75	2.224	5/8" - 11	2.10
5043-460-A64-400	SCAT40 x MLD1" - 4"	6.687	4	2.49	1	2.362	5/8" - 11	2.00
5043-460-A72-420	SCAT40 x MLD1-1/4" - 4.2"	6.887	4.2	2.8	1.25	2.795	5/8" - 11	2.50
5043-460-A72-600	SCAT40 x MLD1-1/4" - 6"	8.687	6	2.8	1.25	2.795	5/8" - 11	2.70
5044-460-A32-350	SCAT50 x MLD1/2" - 3.5"	7.5	3.5	1.84	0.5	1.654	M12 x 1.75P	2.50
5044-460-A40-350	SCAT50 x MLD5/8" - 3.5"	7.5	3.5	2.23	0.625	1.889	M12 x 1.75P	2.70
5044-460-A48-400	SCAT50 x MLD3/4" - 4"	8	4	2.34	0.75	2.224	5/8" - 11	2.50
5044-460-A48-600	SCAT50 x MLD3/4" - 6"	10	6	2.34	0.75	2.224	5/8" - 11	2.80
5044-460-A64-400	SCAT50 x MLD1" - 4"	8	4	2.49	1	2.362	5/8" - 11	2.90
5044-460-A72-413	SCAT50 x MLD1-1/4" - 4.13"	8.13	4.13	2.8	1.25	2.795	1" - 8	2.70
5044-460-A72-600	SCAT50 x MLD1-1/4" - 6"	10	6	2.8	1.25	2.795	5/8" - 11	3.00

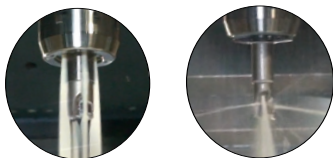

Features:

- ▶ The special slotted design of the internal hole increases the clamping force and decreases vibration, making this milling chuck set suitable for heavy-duty machining.
- ▶ Collet runout accuracy: HSC collet 5µm and SSC collet 20µm two options to choose from.
- ▶ After fastening, the nuts and tool holders contact tight to enhance the cutting rigidity and achieve dustproof purposes.
- ▶ Coolant options: through the center of the holder or cutter. Use a sealed cap and SR ring for coolant through the cutter.

Product information:

- ▶ The pre-balance reaches G6.3 8,000 rpm. Higher balancing grade and revolution can be done upon request but additional charge is needed.
- ▶ AD+B type is available, please inform us when making an order.

Standard Accessory: • NUT

Collet	Sealed Cap	SR Sealed Ring	Pull Stud	Torque Wrench Adapter (Pull Stud)	Spanner (Pull Stud)	Spanner	Spanner	Set Screw
P.X-46~47	P.X-62	P.X-63	P.X-66	P.X-73、77	P.X-78	P.X-79~80	P.X-82	P.X-111



SCAT / SAF RUNOUT ADJUSTABLE HOLDER

Dual
DRIVE+

4.5°

SCAT / SAF 法蘭加厚型可調式刀桿

[SFC TYPE]

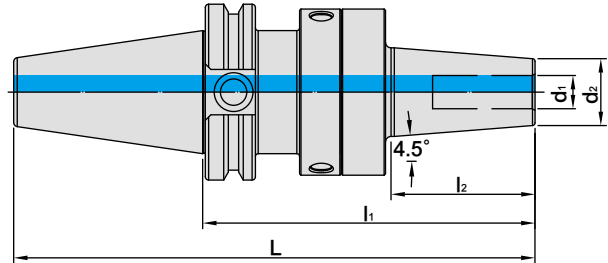

J P PAT NO. 3237773
D E PAT NO. 202022102696
C N PAT NO. ZL202221891039.3

MODEL NO.	TYPE	L	l ₁	l ₂	d ₁	d ₂	COMBINATION		WEIGHT (KGS)
							BODY	FLANGE ADAPTER	
5043-S27-006-120	SCAT40 x SAF6C - 120	188.249	120	52	6	21	SCAT40 x SAF25	SFC6 - 70	1.74
5043-S27-008-120	SCAT40 x SAF8C - 120	188.249	120	52	8	21	SCAT40 x SAF25	SFC8 - 70	1.73
5043-S27-010-120	SCAT40 x SAF10C - 120	188.249	120	52	10	24	SCAT40 x SAF25	SFC10 - 70	1.78
5043-S27-012-120	SCAT40 x SAF12C - 120	188.249	120	52	12	24	SCAT40 x SAF25	SFC12 - 70	1.76
5043-S27-016-125	SCAT40 x SAF16C - 125	193.249	125	57	16	27	SCAT40 x SAF25	SFC16 - 75	1.81
5043-S27-020-140	SCAT40 x SAF20C - 140	208.249	140	60	20	33	SCAT40 x SAF40	SFC20 - 80	2.92
5043-S27-025-160	SCAT40 x SAF25C - 160	228.249	160	81	25	44	SCAT40 x SAF40	SFC25 - 100	3.45
5043-S27-032-160	SCAT40 x SAF32C - 160	228.249	160	81	32	44	SCAT40 x SAF40	SFC32 - 100	3.31
5044-S27-006-130	SCAT50 x SAF6C - 130	231.6	130	52	6	21	SCAT50 x SAF25	SFC6 - 70	4.02
5044-S27-008-130	SCAT50 x SAF8C - 130	231.6	130	52	8	21	SCAT50 x SAF25	SFC8 - 70	4.01
5044-S27-010-130	SCAT50 x SAF10C - 130	231.6	130	52	10	24	SCAT50 x SAF25	SFC10 - 70	4.06
5044-S27-012-130	SCAT50 x SAF12C - 130	231.6	130	52	12	24	SCAT50 x SAF25	SFC12 - 70	4.04
5044-S27-016-135	SCAT50 x SAF16C - 135	236.6	135	57	16	27	SCAT50 x SAF25	SFC16 - 75	4.09
5044-S27-020-140	SCAT50 x SAF20C - 140	241.6	140	60	20	33	SCAT50 x SAF40	SFC20 - 80	5.00
5044-S27-025-160	SCAT50 x SAF25C - 160	261.6	160	81	25	44	SCAT50 x SAF40	SFC25 - 100	5.53
5044-S27-032-160	SCAT50 x SAF32C - 160	261.6	160	81	32	44	SCAT50 x SAF40	SFC32 - 100	5.39

Features:

- ▶ The runout accuracy of tool edges can be adjusted within 5µm.
- ▶ Different output options to meet customer machining requirements.
- ▶ Suitable for reaming, drilling and milling.

Standard Accessory: • WRENCH (FOR ADJUSTMENT SCREW) • PIN

Pull Stud	Torque Wrench Adapter (Pull Stud)	Spanner (Pull Stud)	Flange	Preset Screw
P.X-66	P.X-73、77	P.X-78	P.X-98	P.X-111

SCAT / SAF RUNOUT ADJUSTABLE HOLDER

Dual
DRIVE+

SCAT / SAF 法蘭加厚型可調式刀桿

[SK3 TYPE]

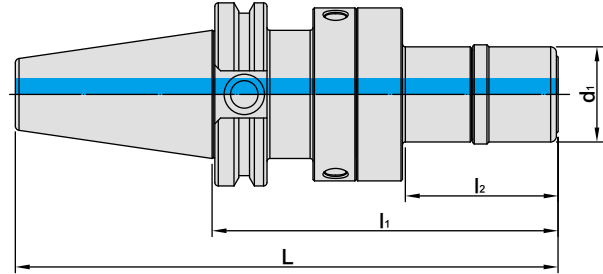

J P PAT NO. 3237773
D E PAT NO. 202022102696
C N PAT NO. ZL202221891039.3

MODEL NO.	TYPE	L	l ₁	l ₂	d ₁	COMBINATION		COLLET	WEIGHT (KGS)
						BODY	FLANGE ADAPTER		
5043-S28-006-100	SCAT40 x SAF6K - 100	168.249	100	29	19.5	SCAT40 x SAF25	SK306 - 50	SKX6	1.61
5043-S28-006-150	SCAT40 x SAF6K - 150	218.249	150	79	19.5	SCAT40 x SAF25	SK306 - 100	SKX6	1.70
5043-S28-010-100	SCAT40 x SAF10K - 100	168.249	100	32.5	27.5	SCAT40 x SAF25	SK310 - 50	SKX10	1.64
5043-S28-010-150	SCAT40 x SAF10K - 150	218.249	150	82.5	27.5	SCAT40 x SAF25	SK310 - 100	SKX10	1.83
5043-S28-013-120	SCAT40 x SAF13K - 120	188.249	120	53	33	SCAT40 x SAF25	SK313 - 70	SKX13	1.77
5043-S28-013-150	SCAT40 x SAF13K - 150	218.249	150	83	33	SCAT40 x SAF25	SK313 - 100	SKX13	1.95
5043-S28-016-130	SCAT40 x SAF16K - 130	198.249	130	49.9	40	SCAT40 x SAF40	SK316 - 70	SKX16	2.81
5043-S28-016-160	SCAT40 x SAF16K - 160	228.249	160	79.9	40	SCAT40 x SAF40	SK316 - 100	SKX16	3.07
5044-S28-006-110	SCAT50 x SAF6K - 110	211.6	110	29	19.5	SCAT50 x SAF25	SK306 - 50	SKX6	3.89
5044-S28-006-160	SCAT50 x SAF6K - 160	261.6	160	79	19.5	SCAT50 x SAF25	SK306 - 100	SKX6	3.98
5044-S28-010-110	SCAT50 x SAF10K - 110	211.6	110	32.5	27.5	SCAT50 x SAF25	SK310 - 50	SKX10	3.92
5044-S28-010-160	SCAT50 x SAF10K - 160	261.6	160	82.5	27.5	SCAT50 x SAF25	SK310 - 100	SKX10	4.11
5044-S28-013-130	SCAT50 x SAF13K - 130	231.6	130	53	33	SCAT50 x SAF25	SK313 - 70	SKX13	4.05
5044-S28-013-160	SCAT50 x SAF13K - 160	261.6	160	83	33	SCAT50 x SAF25	SK313 - 100	SKX13	4.23
5044-S28-016-130	SCAT50 x SAF16K - 130	231.6	130	49.9	40	SCAT50 x SAF40	SK316 - 70	SKX16	4.89
5044-S28-016-160	SCAT50 x SAF16K - 160	261.6	160	79.9	40	SCAT50 x SAF40	SK316 - 100	SKX16	5.15

Features:

- ▶ The runout accuracy of tool edges can be adjusted within 5µm.
- ▶ Different output options to meet customer machining requirements.
- ▶ Suitable for reaming, drilling and milling.

Standard Accessory: • NUT • WRENCH (FOR ADJUSTMENT SCREW) • PIN

Collet	Nut	Pull Stud	Torque Wrench Adapter (Pull Stud)	Spanner (Pull Stud)	Spanner	Flange	Preset Screw
P.X-39~41	P.X-58	P.X-66	P.X-77	P.X-78	P.X-73、75、82	P.X-99	P.X-111



SCAT / SAF RUNOUT ADJUSTABLE HOLDER



SCAT / SAF 法蘭加厚型可調式刀桿

(UT TYPE)

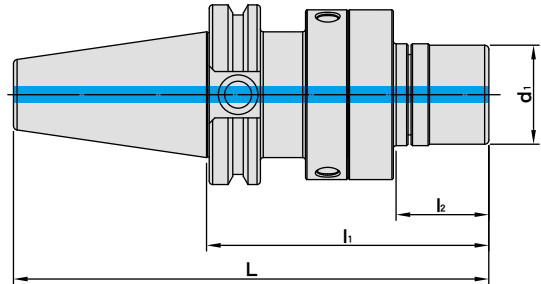

J P PAT NO. 3237773
D E PAT NO. 202022102696
C N PAT NO. ZL202221891039.3

MODEL NO.	TYPE	L	l ₁	l ₂	d ₁	COMBINATION		COLLET	WEIGHT (KGS)
						BODY	FLANGE ADAPTER		
5043-S30-160-100	SCAT40 x SAF16U - 100	168.249	100	32	30	SCAT40 x SAF25	UT16 - 50	ER16	1.69
5043-S30-020-100	SCAT40 x SAF20U - 100	168.249	100	33	35	SCAT40 x SAF25	UT20 - 50	ER20	1.71
5043-S30-025-120	SCAT40 x SAF25U - 120	188.249	120	38.9	42	SCAT40 x SAF40	UT25 - 60	ER25	2.82
5043-S30-032-120	SCAT40 x SAF32U - 120	188.249	120	40.9	48	SCAT40 x SAF40	UT32 - 60	ER32	2.85
5044-S30-016-110	SCAT50 x SAF16U - 110	211.6	110	32	30	SCAT50 x SAF25	UT16 - 50	ER16	3.97
5044-S30-020-110	SCAT50 x SAF20U - 110	211.6	110	33	35	SCAT50 x SAF25	UT20 - 50	ER20	3.99
5044-S30-025-120	SCAT50 x SAF25U - 120	221.6	120	38.9	42	SCAT50 x SAF40	UT25 - 60	ER25	4.90
5044-S30-032-120	SCAT50 x SAF32U - 120	221.6	120	40.9	48	SCAT50 x SAF40	UT32 - 60	ER32	4.93

Features:

- ▶ The runout accuracy of tool edges can be adjusted within 5µm.
- ▶ Different output options to meet customer machining requirements.
- ▶ Suitable for reaming, drilling and milling.

Standard Accessory: • NUT • WRENCH (FOR ADJUSTMENT SCREW) • PIN

Collet	Nut	Pull Stud	Torque Wrench Adapter (Pull Stud)	Spanner (Pull Stud)	Spanner	Flange	Preset Screw
P.X-18~21	P.X-54	P.X-66	P.X-77	P.X-78	P.X-73、75、82	P.X-100	P.X-111

SAF RUNOUT ADJUSTABLE HOLDER BODY



SAF 可調式刀桿本體

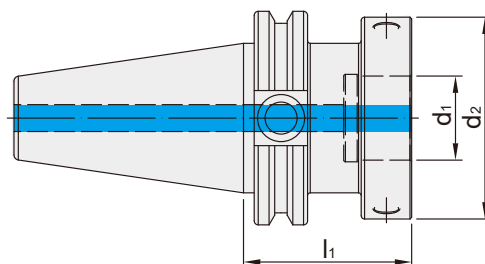

MODEL NO.	TYPE	l_1	d_2	SAF NO.	WEIGHT (KGS)
5043-783-025-050	SCAT40 x SAF25 - 50	50	60	1	1.22
5043-783-040-060	SCAT40 x SAF40 - 60	60	80	2	1.73
5044-783-025-060	SCAT50 x SAF25 - 60	60	60	1	3.50
5044-783-040-060	SCAT50 x SAF40 - 60	60	80	2	3.81



SCAT / SLN SIDE LOCK END MILL HOLDER

Dual
DRIVE+

SCAT / SLN 法蘭加厚型側固式立銑刀桿

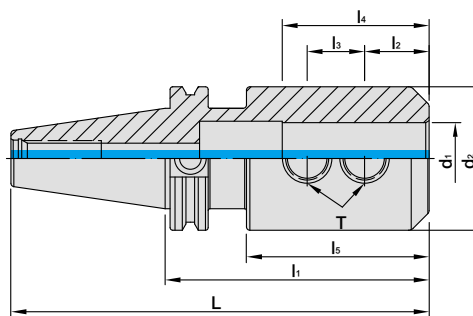

INCHES





MODEL NO.	TYPE	L	l ₁	l ₂	l ₃	l ₄	l ₅	d ₁	d ₂	T	WEIGHT (KGS)
5043-653-A08-238	SCAT40 x SLN1/8" - 2.375"	5.062	2.375	0.37	-	0.787	0.8	0.125	0.69	6# - 32	1.15
5043-653-A12-250	SCAT40 x SLN3/16" - 2.5"	5.187	2.5	0.562	-	0.984	0.73	0.1875	0.69	8# - 32	1.20
5043-653-A16-300	SCAT40 x SLN1/4" - 3"	5.687	3	0.63	-	1.38	1.28	0.25	0.78	1/4 - 28	1.15
5043-653-A20-300	SCAT40 x SLN5/16" - 3"	5.687	3	0.63	-	1.38	1.11	0.3125	0.88	5/16 - 24	1.20
5043-653-A24-300	SCAT40 x SLN3/8" - 3"	5.687	3	0.75	-	1.535	1.08	0.375	1	3/8 - 24	1.20
5043-653-A32-300	SCAT40 x SLN1/2" - 3"	5.687	3	0.875	-	1.732	1.29	0.5	1.25	7/16 - 20	1.40
5043-653-A40-300	SCAT40 x SLN5/8" - 3"	5.687	3	0.937	-	1.85	1.46	0.625	1.5	1/2 - 20	1.50
5043-653-A48-300	SCAT40 x SLN3/4" - 3"	5.687	3	1	-	1.929	2.12	0.75	1.75	5/8 - 18	1.65
5043-653-A48-350	SCAT40 x SLN3/4" - 3.5"	6.187	3.5	1	-	1.929	2.12	0.75	1.75	5/8 - 18	1.70
5043-653-A56-350	SCAT40 x SLN7/8" - 3.5"	6.187	3.5	1.063	0.875	2.36	2.06	0.875	1.88	5/8 - 18	2.55
5043-653-A64-400	SCAT40 x SLN1" - 4"	6.687	4	1.125	1	2.56	2.5	1	2	3/4 - 16	2.80
5043-653-A72-460	SCAT40 x SLN1-1/4" - 4.6"	7.287	4.6	1.125	1	2.56	3.12	1.25	2.5	3/4 - 16	2.90
5043-653-A80-450	SCAT40 x SLN1-1/2" - 4.5"	7.187	4.5	1.125	1	2.56	3.02	1.5	2.5	3/4 - 16	3.20
5044-653-A16-400	SCAT50 x SLN1/4" - 4"	8	4	0.63	-	1.38	1.85	0.25	0.78	1/4 - 28	3.95
5044-653-A20-400	SCAT50 x SLN5/16" - 4"	8	4	0.63	-	1.38	2.23	0.3125	0.88	5/16 - 24	3.95
5044-653-A24-400	SCAT50 x SLN3/8" - 4"	8	4	0.781	-	1.535	1.89	0.375	1	3/8 - 24	4.00
5044-653-A32-400	SCAT50 x SLN1/2" - 4"	8	4	0.875	-	1.732	2.08	0.5	1.25	7/16 - 20	4.15
5044-653-A40-400	SCAT50 x SLN5/8" - 4"	8	4	0.937	-	1.85	1.83	0.625	1.5	1/2 - 20	4.30
5044-653-A48-400	SCAT50 x SLN3/4" - 4"	8	4	1	-	1.929	1.96	0.75	1.75	5/8 - 18	4.35
5044-653-A56-400	SCAT50 x SLN7/8" - 4"	8	4	1.063	0.875	2.36	2.43	0.875	1.88	5/8 - 18	5.30
5044-653-A64-400	SCAT50 x SLN1" - 4"	8	4	1.125	1	2.56	2.5	1	2	3/4 - 16	5.50
5044-653-A72-400	SCAT50 x SLN1-1/4" - 4"	8	4	1.125	1	2.756	2.5	1.25	2.5	3/4 - 16	5.65
5044-653-A72-460	SCAT50 x SLN1-1/4" - 4.6"	8.6	4.6	1.125	1	2.756	3.1	1.25	2.5	3/4 - 16	5.70
5044-653-A80-460	SCAT50 x SLN1-1/2" - 4.6"	8.6	4.6	1.125	1	2.756	3.14	1.5	2.5	3/4 - 16	5.70
5044-653-A96-600	SCAT50 x SLN2" - 6"	10	6	1.335	1.41	3.347	4.48	2	3.75	1 - 14	5.90

Features:

- ▶ Internal hole tolerance: H5 (DIN-1835-B standard).
- ▶ The tolerance requirement of tool shank diameter is h6.
- ▶ Taking use of side lock screws to clamp tools with lateral flat surfaces. Good at heavy-duty machining.

Product information:

- ▶ The pre-balance reaches G6.3 8,000 rpm. Higher balancing grade and revolution can be done upon request but additional charge is needed.
- ▶ AD+B type is available, please inform us when making an order.

Pull Stud	Torque Wrench Adapter (Pull Stud)	Spanner (Pull Stud)	Lock Screw
			
P.X-66	P.X-73、77	P.X-78	P.X-113

SCAT FACE MILL ARBOR



SCAT / FMA 法蘭加厚型平面銑刀桿

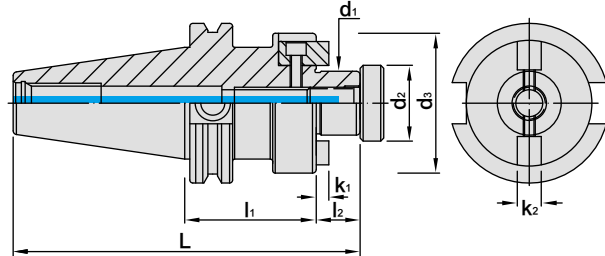
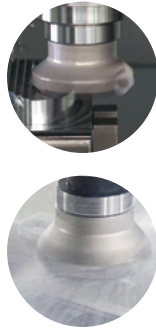

INCHES

MODEL NO.	TYPE	L	l ₁	l ₂	d ₁	d ₂	d ₃	K ₁	K ₂	WEIGHT (KGS)
5043-151-A48-137	SCAT40 x FMA3/4" - 1.37"	4.752	1.38	0.687	0.75	0.875	1.69	0.16	0.3125	1.50
5043-151-A48-400	SCAT40 x FMA3/4" - 4"	7.374	4	0.687	0.75	0.875	1.69	0.16	0.3125	1.70
5043-151-A48-600	SCAT40 x FMA3/4" - 6"	9.374	6	0.687	0.75	0.875	1.69	0.16	0.3125	1.90
5043-151-A64-206	SCAT40 x FMA1" - 2.06"	5.434	2.06	0.687	1	1.1875	2.19	0.2	0.375	1.50
5043-151-A64-400	SCAT40 x FMA1" - 4"	7.374	4	0.687	1	1.1875	2.19	0.2	0.375	2.55
5043-151-A64-600	SCAT40 x FMA1" - 6"	9.374	6	0.687	1	1.1875	2.19	0.2	0.375	2.75
5043-151-A72-221	SCAT40 x FMA1-1/4" - 2.21"	5.584	2.21	0.687	1.25	1.5	2.75	0.24	0.5	2.60
5043-151-A72-400	SCAT40 x FMA1-1/4" - 4"	7.374	4	0.687	1.25	1.5	2.75	0.24	0.5	2.75
5043-151-A72-600	SCAT40 x FMA1-1/4" - 6"	9.374	6	0.687	1.25	1.5	2.75	0.24	0.5	2.95
5043-151-A80-221	SCAT40 x FMA1-1/2" - 2.21"	5.837	2.21	0.938	1.5	1.875	3.81	0.31	0.625	2.70
5043-151-A80-400	SCAT40 x FMA1-1/2" - 4"	7.627	4	0.938	1.5	1.875	3.81	0.31	0.625	2.95
5044-151-A48-150	SCAT50 x FMA3/4" - 1.5"	6.187	1.5	0.687	0.75	0.875	-	0.12	0.3125	4.20
5044-151-A48-350	SCAT50 x FMA3/4" - 3.5"	8.187	3.5	0.687	0.75	0.875	1.69	0.16	0.3125	4.40
5044-151-A48-550	SCAT50 x FMA3/4" - 5.5"	10.187	5.5	0.687	0.75	0.875	1.69	0.16	0.3125	4.60
5044-151-A64-200	SCAT50 x FMA1" - 2"	6.687	2	0.687	1	1.1875	2.19	0.2	0.375	4.50
5044-151-A64-400	SCAT50 x FMA1" - 4"	8.687	4	0.687	1	1.1875	2.19	0.2	0.375	4.70
5044-151-A64-600	SCAT50 x FMA1" - 6"	10.687	6	0.687	1	1.1875	2.19	0.2	0.375	4.90
5044-151-A72-150	SCAT50 x FMA1-1/4" - 1.5"	6.187	1.5	0.687	1.25	1.5	2.75	0.24	0.5	4.70
5044-151-A72-350	SCAT50 x FMA1-1/4" - 3.5"	8.187	3.5	0.687	1.25	1.5	2.75	0.24	0.5	4.80
5044-151-A72-500	SCAT50 x FMA1-1/4" - 5"	9.687	5	0.687	1.25	1.5	2.75	0.24	0.5	5.00
5044-151-A72-600	SCAT50 x FMA1-1/4" - 6"	10.687	6	0.687	1.25	1.5	2.75	0.24	0.5	5.10
5044-151-A80-240	SCAT50 x FMA1-1/2" - 2.4"	7.338	2.4	0.938	1.5	1.875	3.81	0.31	0.625	5.00
5044-151-A80-400	SCAT50 x FMA1-1/2" - 4"	8.938	4	0.938	1.5	1.875	3.81	0.31	0.625	5.20
5044-151-A80-600	SCAT50 x FMA1-1/2" - 6"	10.938	6	0.938	1.5	1.875	3.81	0.31	0.625	5.40
5044-151-A96-240	SCAT50 x FMA2" - 2.4"	7.338	2.4	0.938	2	2.5	4.88	0.39	0.75	5.40
5044-151-A96-400	SCAT50 x FMA2" - 4"	8.938	4	0.938	2	2.5	4.88	0.39	0.75	5.60

Features:

- ▶ Tolerance of d1 the connection part with cutter: h6, which is good for less chatter and longer cutter life.
- ▶ Standard screw attached is w/o coolant hole.
- ▶ To use with face mill cutters with coolant holes, the standard screw has to be changed into the screw with coolant flute, which is available to order separately.

Product information:

- ▶ The pre-balance reaches G6.3 3,000 rpm. Higher balancing grade and revolution can be done upon request but additional charge is needed.
- ▶ AD+B type is available, please inform us when making an order.

Pull Stud	Torque Wrench Adapter (Pull Stud)	Spanner (Pull Stud)	Screw
P.X-66	P.X-73、77	P.X-78	P.X-112



SCAT / STA SYNCHRONIZED TAPPING HOLDER



SCAT / STA 法蘭加厚型同步補償攻牙刀桿

[ER TYPE]

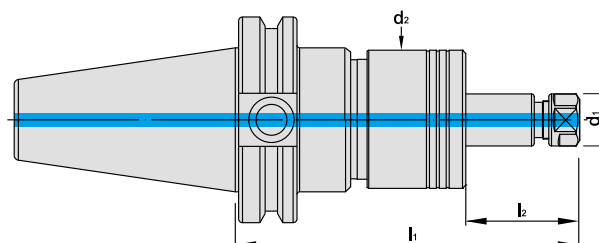

TW PAT NO. I615223
CN PAT NO. 201620889099.X
J P PAT NO. 3203456
D E PAT NO. 202016100106
U S PAT NO. US9796059

MODEL NO.	TYPE	l ₁	l ₂	d ₁	d ₂	COMBINATION		WEIGHT (KGS)
						BODY	TAP ADAPTER	
5043-S22-011-140	SCAT40 x STA11E - 140	140	70	19	42	SCAT40 x STA1	STA1 - ER11A - 70	1.48
5043-S22-016-095	SCAT40 x STA16E - 95	95	25	28	42	SCAT40 x STA1	STA1 - ER16A - 25	1.22
5043-S22-016-140	SCAT40 x STA16E - 140	140	70	28	42	SCAT40 x STA1	STA1 - ER16A - 70	1.42
5043-S22-016-220	SCAT40 x STA16E - 220	220	150	28	42	SCAT40 x STA1	STA1 - ER16A - 150	1.75
5043-S22-020-104	SCAT40 x STA20E - 104	104	34	34	42	SCAT40 x STA1	STA1 - ER20A - 34	1.26
5043-S22-020-140	SCAT40 x STA20E - 140	140	70	34	42	SCAT40 x STA1	STA1 - ER20A - 70	1.42
5043-S22-032-130	SCAT40 x STA32E - 130	130	40	50	58	SCAT40 x STA2	STA2 - ER32 - 40	1.89
5043-S22-032-160	SCAT40 x STA32E - 160	160	70	50	58	SCAT40 x STA2	STA2 - ER32 - 70	2.12
5044-S22-011-140	SCAT50 x STA11E - 140	140	70	19	42	SCAT50 x STA1	STA1 - ER11A - 70	3.48
5044-S22-016-095	SCAT50 x STA16E - 95	95	25	28	42	SCAT50 x STA1	STA1 - ER16A - 25	3.22
5044-S22-016-140	SCAT50 x STA16E - 140	140	70	28	42	SCAT50 x STA1	STA1 - ER16A - 70	3.42
5044-S22-016-220	SCAT50 x STA16E - 220	220	150	28	42	SCAT50 x STA1	STA1 - ER16A - 150	3.75
5044-S22-020-104	SCAT50 x STA20E - 104	104	34	34	42	SCAT50 x STA1	STA1 - ER20A - 34	3.26
5044-S22-020-140	SCAT50 x STA20E - 140	140	70	34	42	SCAT50 x STA1	STA1 - ER20A - 70	3.42
5044-S22-032-135	SCAT50 x STA32E - 135	135	40	50	58	SCAT50 x STA2	STA2 - ER32 - 40	3.97
5044-S22-032-165	SCAT50 x STA32E - 165	165	70	50	58	SCAT50 x STA2	STA2 - ER32 - 70	4.20

Features:

- ▶ Internal steel component allows the micro-compensation for the misfeed of spindle ballscrew and overload. Improve tapping quality and tap life. Optimum male and female threaded fitting is achieved due to the premium design!
- ▶ To prevent from interfering, the longer adapter can be custom made.
- ▶ Coolant-through is available with coolant pressure up to 70 bar. STA has long use life even the synchronized micro-compensation mechanism is used at high coolant pressure.
- ▶ Modular design to meet more diverse demand.
- ▶ One of SYIC products patented by US invention.

Product information:

- ▶ AD+B type is available, please inform us when making an order.

Application:

- ▶ Ideal for everyday tapping, high speed and high production tapping for modern CNC machines capable of rigid tapping.
- ▶ Also ideal for high-end tapping applications in modern CNC machines (small taps or difficult materials resulting in high torque loads).

Standard Accessory: • NUT

Collet	Nut	Pull Stud	Spanner	Torque Wrench Adapter (Pull Stud)	Spanner (Pull Stud)	Flange
P.X-18~38	P.X-54~58	P.X-66	PX-73~76、79、82	P.X-73、77	P.X-78	P.X-101

STA SYNCHRONIZED TAPPING HOLDER BODY

Dual
DRIVE+

STA 同步補償攻牙刀桿本體

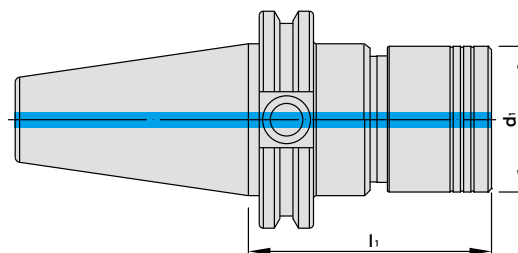

MODEL NO.	TYPE	l_1	d_1	STA NO.	WEIGHT (KGS)
5043-795-001-070	SCAT40 x STA1 - 70	70	42	1	1.12
5043-795-002-090	SCAT40 x STA2 - 90	90	58	2	1.45
5044-795-001-070	SCAT50 x STA1 - 70	70	42	1	3.12
5044-795-002-095	SCAT50 x STA2 - 95	95	58	2	3.53



SCAT / QTC QUICK CHANGE TAPPING CHUCK

With length compensation on tension and compression

Dual
DRIVE+

SCAT / QTC 法蘭加厚型快換式扭力攻牙刀桿 [伸縮緩衝型]

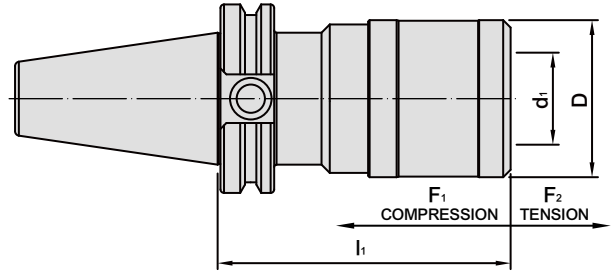
**INCHES**





MODEL NO.	TYPE	TAPPING COLLET	TAPPING CAPACITY	COMPENSATION		l ₁	D	d ₁	WEIGHT (KGS)
				F ₁	F ₂				
5043-580-001-089	SCAT40 x QTC1 - 3.5"	TCS - 1B	M3 - M14	0.295	0.295	3.5	1.417	1.337	1.38
5043-580-002-114	SCAT40 x QTC2 - 4.5"	TCS - 2B	M8 - M24	0.492	0.492	4.5	2.087	1.220	1.92
5043-580-003-152	SCAT40 x QTC3 - 6"	TCS - 3B	M14 - M36	0.787	0.787	6	3.071	1.890	3.28
5044-580-001-070	SCAT50 x QTC1 - 2.75"	TCS - 1B	M3 - M14	0.295	0.295	2.75	1.417	1.337	2.95
5044-580-002-102	SCAT50 x QTC2 - 4"	TCS - 2B	M8 - M24	0.492	0.492	4	2.087	1.220	3.62
5044-580-003-146	SCAT50 x QTC3 - 5.75"	TCS - 3B	M14 - M36	0.787	0.787	5.75	3.071	1.890	5.19

Features:

- ▶ Quick and easy tool change in seconds!
- ▶ Absorb any inaccuracies between the rotating spindle and the moving Z-axis, increasing tap life and the improving tapping quality.
- ▶ Most commonly used for old CNC machines without rigid tapping. The length compensation prevents oversized threads and helps prevent tap breakage from excessive torque or over travel when the tap hits the bottom of the hole.

Synchronized Tapping Holder:

- ▶ Ideal for everyday tapping, high speed and high production tapping for modern CNC machines capable of rigid tapping.
- ▶ Also ideal for high-end tapping applications in modern CNC machines, such as: small taps or difficult materials resulting in high torque loads.

Tapping Collet	Pull Stud	Torque Wrench Adapter (Pull Stud)	Spanner (Pull Stud)
			
P.A-56~59	P.X-66	P.X-73、77	P.X-78

SCAT MORSE TAPER ADAPTER TANG TYPE



SCAT 法蘭加厚型斜柄鑽頭套筒

(DIN 228-2)

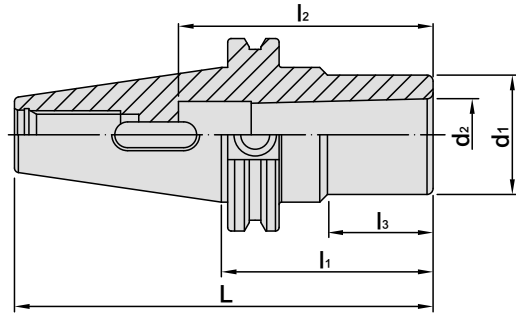

INCHES

MODEL NO.	TYPE	L	l ₁	l ₂	l ₃	d ₁	d ₂	WEIGHT (KGS)
5043-465-001-041	SCAT40 x MTA1 - 1.6"	4.287	1.6	2.205	0.12	1	0.475	1.30
5043-465-002-051	SCAT40 x MTA2 - 2"	4.687	2	2.638	0.32	1.25	0.7	1.50
5043-465-003-070	SCAT40 x MTA3 - 2.75"	5.437	2.75	3.307	1.29	1.57	0.938	1.14
5043-465-004-095	SCAT40 x MTA4 - 3.75"	6.437	3.75	4.213	2.37	1.75	1.23	1.20
5044-465-001-051	SCAT50 x MTA1 - 2"	6	2	2.205	0.62	1	0.475	4.05
5044-465-002-051	SCAT50 x MTA2 - 2"	6	2	2.638	0.5	1.25	0.7	4.40
5044-465-003-064	SCAT50 x MTA3 - 2.5"	6.5	2.5	3.307	1	1.55	0.938	4.50
5044-465-004-084	SCAT50 x MTA4 - 3.3"	7.3	3.3	4.213	1.8	1.75	1.23	4.90
5044-465-005-104	SCAT50 x MTA5 - 4.1"	8.1	4.1	5.315	2.59	2.48	1.748	5.15

Features:

- The tools used for MTA are consistent with Morse Taper DIN 228 FORM B (with Tang).

Pull Stud	Torque Wrench Adapter (Pull Stud)	Spanner (Pull Stud)
P.X-66	P.X-73、77	P.X-78



SCAT ADAPTER

Dual
DRIVE+

SCAT 法蘭加厚型套筒

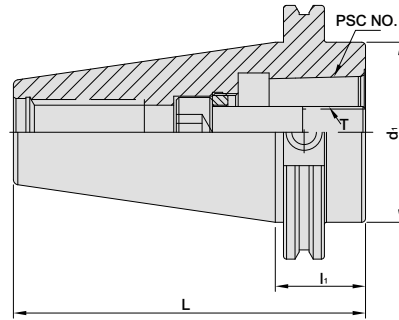

MODEL NO.	TYPE	NO.	L	l ₁	d ₁	T	MAX. TORQUE		WEIGHT (KGS)
							Nm	ft-lbs	
5043-013-140-035	SCAT40 x PSC32 - 35	PSC32	103.249	35	44.45	M12 x 1.5P	45	33	1.02
5043-013-141-035	SCAT40 x PSC40 - 35	PSC40	103.249	35	44.45	M14 x 1.5P	55	40	0.93
5043-013-142-035	SCAT40 x PSC50 - 35	PSC50	103.249	35	44.45	M16 x 1.5P	95	70	0.85
5043-013-143-090	SCAT40 x PSC63 - 90	PSC63	158.249	90	63	M20 x 2.0P	170	125	1.85
5044-013-140-035	SCAT50 x PSC32 - 35	PSC32	136.6	35	69.85	M12 x 1.5P	45	33	3.05
5044-013-141-035	SCAT50 x PSC40 - 35	PSC40	136.6	35	69.85	M14 x 1.5P	55	40	3.00
5044-013-142-035	SCAT50 x PSC50 - 35	PSC50	136.6	35	69.85	M16 x 1.5P	95	70	2.90
5044-013-143-035	SCAT50 x PSC63 - 35	PSC63	136.6	35	69.85	M20 x 2.0P	170	125	2.68

INCHES

5044-013-143-102	SCAT50 x PSC63 - 4"	PSC63	203.2	101.6	63	M20 x 2.0P	170	125	4.42
5044-013-143-152	SCAT50 x PSC63 - 6"	PSC63	254	152.4	69.85	M20 x 2.0P	170	125	5.78
5044-013-143-203	SCAT50 x PSC63 - 8"	PSC63	304.8	203.2	63	M20 x 2.0P	170	125	7.14
5044-013-143-254	SCAT50 x PSC63 - 10"	PSC63	355.6	254	63	M20 x 2.0P	170	125	8.50
5044-013-143-305	SCAT50 x PSC63 - 12"	PSC63	406.4	304.8	63	M20 x 2.0P	170	125	9.87
5044-013-144-095	SCAT50 x PSC80 - 3.74"	PSC80	196.6	95	80	M20 x 2.0P	170	125	3.05

Features:

- Convert the machine taper for use with different taper types or taper sizes of tool holders, or offer great flexibility by extending the tooling length.

Pull Stud	Torque Wrench Adapter (Pull Stud)	Spanner (Pull Stud)
		
P.X-66	P.X-73、77	P.X-78

SCAT BLANK

Dual
DRIVE+

SCAT 法蘭加厚型素材

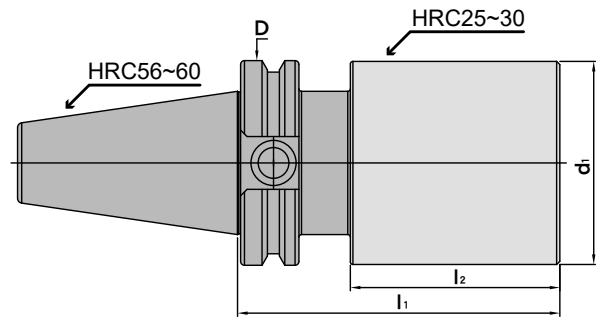

INCHES

MODEL NO.	TYPE	D	d ₁	l ₁	l ₂	WEIGHT (KGS)
5043-001-B06-800	SCAT40 x Ø3" - 8"	2.5	3	8	6.625	6.94
5044-001-B07-800	SCAT50 x Ø3.15" - 8"	3.875	3.15	8	6.625	6.91
5044-001-B07-1200	SCAT50 x Ø3.15" - 12"	3.875	3.15	12	10.625	13.55
5044-001-B16-800	SCAT50 x Ø4" - 8"	3.875	4	8	6.625	13.60
5044-001-B16-1200	SCAT50 x Ø4" - 12"	3.875	4	12	10.625	19.95
5044-001-B20-800	SCAT50 x Ø6" - 8"	3.875	6	8	6.625	26.73
5044-001-B20-1200	SCAT50 x Ø6" - 12"	3.875	6	12	10.625	41.0

Features:

- Blanks can be machined according to customer demands. It is not recommended to do heat treatment after machining.

Pull Stud	Torque Wrench Adapter (Pull Stud)	Spanner (Pull Stud)
		
P.X-66	P.X-73、77	P.X-78



MEMO

Blank lined area for writing a memo.

