

ANGLE HEAD HOLDER CATEGORY

SHG ANGLE HEAD HOLDER	S-2
SAG-D ANGLE HEAD HOLDER	S-3~6
SAU ANGLE HEAD HOLDER [UNIVERSAL TYPE]	S-7
SAR ANGLE HEAD HOLDER	S-8~12
SAC ANGLE HEAD HOLDER	S-13~21
SAM-HSC ANGLE HEAD HOLDER [HIGH REVOLUTION & HIGH COOLANT PRESSURE TYPE]	S-22~23
SAM ANGLE HEAD HOLDER	S-24~32
SAG ANGLE HEAD HOLDER [SLIM TYPE]	S-33~37
SAD ANGLE HEAD HOLDER [SLIM TYPE]	S-38~39
CUTTING CONDITIONS	S-40
FIXED BLOCK BLANK	S-41
FIXED BLOCK	S-42~43
REFERENCE DRAWING OF SPINDLE FIXED BLOCK	S-44

SHG ANGLE HEAD HOLDER

SHG 小徑銑削頭

[ER & SK3 TYPE]

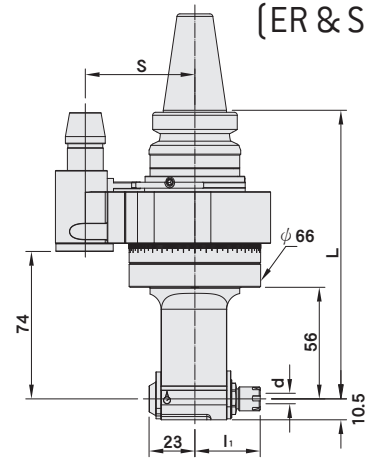

DE PAT NO. 202021100353
 CN PAT NO. ZL202022589176.9
 TW PAT NO. M617869
 DE PAT NO. 202022101763
 JP PAT NO. 3237391
 US PAT NO. 11548110

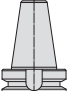
SHANK	MODEL NO.	TYPE	L	l ₁	S	TORQUE	COLLET	d SIZE RANGE	WEIGHT (KGS)
 MAS 403	5010-015-084-145	BT30 x SHG8P - 145	145	32.8	55	15 N·m	ER8	1 ~ 5	2.15
	5010-019-064-145	BT30 x SHG6K - 145	145	44.6	55	15 N·m	SKX6	1 ~ 6	2.15
 DaulDRIVE+	5025-015-084-145	SBT30 x SHG8P - 145	145	32.8	55	15 N·m	ER8	1 ~ 5	2.15
	5025-019-064-145	SBT30 x SHG6K - 145	145	44.6	55	15 N·m	SKX6	1 ~ 6	2.15

Product information:

- ▶ Suitable for drilling, tapping, light milling, and machining stepped workpiece or workpiece with ID size more than $\phi 60$.
- ▶ Max. revolution: 3,000rpm.
- ▶ Recommended cutting depth (A_p) ≤ 2 mm.
- ▶ Max. torque: 15N·m.
- ▶ Rotating direction opposite to machine spindle.
- ▶ Workable for ATC system.



Reminder:

- ▶ Fixed blocks are necessary for installing angle head on the machine.
- ▶ Fixed blocks are varied by different machine designs. Please confirm the detailed dimensions when ordering.

Optional
Fixed Block



P.S-41~43



SAG-D ANGLE HEAD HOLDER

FOR DUAL SIDE MACHINING

BT / SAG-D 雙頭龍銑削頭 [用於雙面加工]

(ER TYPE)

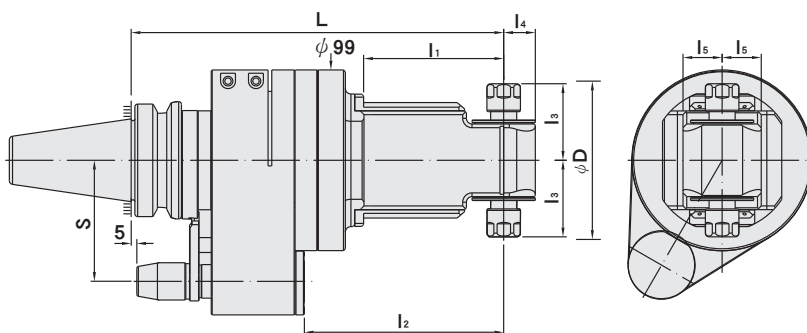

MODEL NO.	TYPE	L	l ₁	l ₂	l ₃	l ₄	l ₅	φ D	S	TORQUE	COLLET	SIZE RANGE	WEIGHT (KGS)
5011-804-161-170	BT40 x SAG16DE - 170	170	38.5	77	59.3	28	34	125	65	25N-m	ER16	1~10	5.50
5011-804-161-200	BT40 x SAG16DE - 200	200	98	107	59.3	28	34	125	65	25N-m	ER16	1~10	6.20
5011-804-161-230	BT40 x SAG16DE - 230	230	128	137	59.3	28	34	125	65	25N-m	ER16	1~10	6.90
5011-804-161-260	BT40 x SAG16DE - 260	260	158	167	59.3	28	34	125	65	25N-m	ER16	1~10	7.60
5011-804-201-170	BT40 x SAG20DE - 170	170	38.5	77	60.5	28	34	125	65	25N-m	ER20	1~13	5.50
5011-804-201-200	BT40 x SAG20DE - 200	200	98	107	60.5	28	34	125	65	25N-m	ER20	1~13	6.20
5011-804-201-230	BT40 x SAG20DE - 230	230	128	137	60.5	28	34	125	65	25N-m	ER20	1~13	6.90
5011-804-201-260	BT40 x SAG20DE - 260	260	158	167	60.5	28	34	125	65	25N-m	ER20	1~13	7.60
5012-804-162-185	BT50 x SAG16DE - 185	185	38.5	77	59.3	28	34	125	80	25N-m	ER16	1~10	9.10
5012-804-162-215	BT50 x SAG16DE - 215	215	98	107	59.3	28	34	125	80	25N-m	ER16	1~10	9.50
5012-804-162-245	BT50 x SAG16DE - 245	245	128	137	59.3	28	34	125	80	25N-m	ER16	1~10	9.90
5012-804-162-275	BT50 x SAG16DE - 275	275	158	167	59.3	28	34	125	80	25N-m	ER16	1~10	10.3
5012-804-202-185	BT50 x SAG20DE - 185	185	38.5	77	60.5	28	34	125	80	25N-m	ER20	1~13	9.10
5012-804-202-215	BT50 x SAG20DE - 215	215	98	107	60.5	28	34	125	80	25N-m	ER20	1~13	9.50
5012-804-202-245	BT50 x SAG20DE - 245	245	128	137	60.5	28	34	125	80	25N-m	ER20	1~13	9.90
5012-804-202-275	BT50 x SAG20DE - 275	275	158	167	60.5	28	34	125	80	25N-m	ER20	1~13	10.3

Feature:

- ▶ SAG-D has two output tool shafts and can achieve machining at 180 degree opposite directions.
- ▶ Reduce tool changing frequency and increase machining efficiency.
- ▶ Save your money buying another angle head for different direction of lateral machining.
- ▶ Conserve the space of tool magazine.

Product information:

- ▶ Gear ratio 1:1.
- ▶ Max. revolution: 6000rpm.
- ▶ Suggested Ap ≤ 2mm.
- ▶ Coolant feed through dowel pin, coolant outlet from 2 coolant holes.
- ▶ Max. water pressure: 7kgf/cm² (100PSI).
- ▶ Two outputs rotate in different directions.
- ▶ Can be used for ATC.



Reminder:

- ▶ Fixed blocks are necessary for installing angle head on the machine.
- ▶ Fixed blocks are varied by different machine designs. Please confirm the detailed dimensions when ordering.

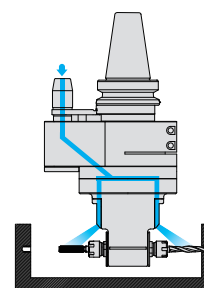
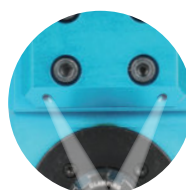

Optional Fixed Block



P.S-41~43



SAG-D ANGLE HEAD HOLDER

FOR DUAL SIDE MACHINING



SBT / SAG-D 雙頭龍銑削頭 [用於雙面加工]

(ER TYPE)

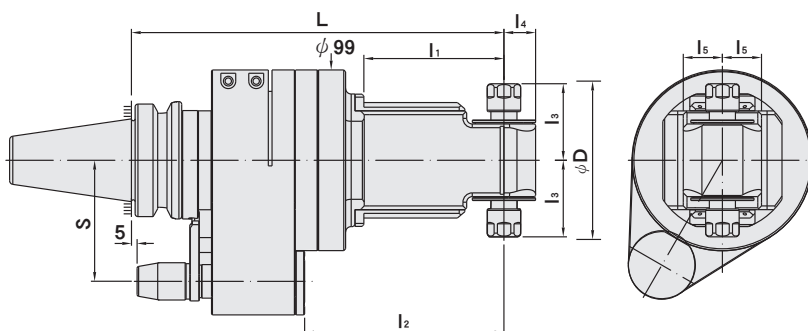

MODEL NO.	TYPE	L	l ₁	l ₂	l ₃	l ₄	l ₅	φ D	S	TORQUE	COLLET	SIZE RANGE	WEIGHT (KGS)
5026-804-111-170	SBT40 x SAG11DE - 170	170	45.2	77	39.2	17	21	80	65	10N-m	ER11	3 ~ 7	5.10
5026-804-111-200	SBT40 x SAG11DE - 200	200	75.2	107	39.2	17	21	80	65	10N-m	ER11	3 ~ 7	5.30
5026-804-111-230	SBT40 x SAG11DE - 230	230	105.2	137	39.2	17	21	80	65	10N-m	ER11	3 ~ 7	5.50
5026-804-111-260	SBT40 x SAG11DE - 260	260	135.2	167	39.2	17	21	80	65	10N-m	ER11	3 ~ 7	5.70
5026-804-161-170	SBT40 x SAG16DE - 170	170	38.5	77	59.3	28	34	125	65	25N-m	ER16	1~10	5.50
5026-804-161-200	SBT40 x SAG16DE - 200	200	98	107	59.3	28	34	125	65	25N-m	ER16	1~10	6.20
5026-804-161-230	SBT40 x SAG16DE - 230	230	128	137	59.3	28	34	125	65	25N-m	ER16	1~10	6.90
5026-804-161-260	SBT40 x SAG16DE - 260	260	158	167	59.3	28	34	125	65	25N-m	ER16	1~10	7.60
5026-804-201-170	SBT40 x SAG20DE - 170	170	38.5	77	60.5	28	34	125	65	25N-m	ER20	1~13	5.50
5026-804-201-200	SBT40 x SAG20DE - 200	200	98	107	60.5	28	34	125	65	25N-m	ER20	1~13	6.20
5026-804-201-230	SBT40 x SAG20DE - 230	230	128	137	60.5	28	34	125	65	25N-m	ER20	1~13	6.90
5026-804-201-260	SBT40 x SAG20DE - 260	260	158	167	60.5	28	34	125	65	25N-m	ER20	1~13	7.60
5027-804-162-185	SBT50 x SAG16DE - 185	185	38.5	77	59.3	28	34	125	80	25N-m	ER16	1~10	9.10
5027-804-162-215	SBT50 x SAG16DE - 215	215	98	107	59.3	28	34	125	80	25N-m	ER16	1~10	9.50
5027-804-162-245	SBT50 x SAG16DE - 245	245	128	137	59.3	28	34	125	80	25N-m	ER16	1~10	9.90
5027-804-162-275	SBT50 x SAG16DE - 275	275	158	167	59.3	28	34	125	80	25N-m	ER16	1~10	10.3
5027-804-202-185	SBT50 x SAG20DE - 185	185	38.5	77	60.5	28	34	125	80	25N-m	ER20	1~13	9.10
5027-804-202-215	SBT50 x SAG20DE - 215	215	98	107	60.5	28	34	125	80	25N-m	ER20	1~13	9.50
5027-804-202-245	SBT50 x SAG20DE - 245	245	128	137	60.5	28	34	125	80	25N-m	ER20	1~13	9.90
5027-804-202-275	SBT50 x SAG20DE - 275	275	158	167	60.5	28	34	125	80	25N-m	ER20	1~13	10.3

Feature:

- ▶ SAG-D has two output tool shafts and can achieve machining at 180 degree opposite directions.
- ▶ Reduce tool changing frequency and increase machining efficiency.
- ▶ Save your money buying another angle head for different direction of lateral machining.
- ▶ Conserve the space of tool magazine.

Product information:

- ▶ Gear ratio 1:1.
- ▶ Max. revolution: 6000rpm.
- ▶ Suggested Ap ≤ 2mm.
- ▶ Coolant feed through dowel pin, coolant outlet from 2 coolant holes.
- ▶ Max. water pressure: 7kgf/cm² (100PSI).
- ▶ Two outputs rotate in different directions.
- ▶ Can be used for ATC.



Reminder:

- ▶ Fixed blocks are necessary for installing angle head on the machine.
- ▶ Fixed blocks are varied by different machine designs. Please confirm the detailed dimensions when ordering.

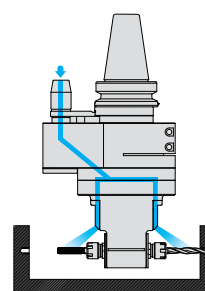
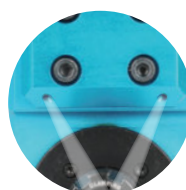

Optional Fixed Block



P.S-41~43



SAG-D ANGLE HEAD HOLDER

FOR DUAL SIDE MACHINING

BT / SAG-D 雙頭龍銑削頭 [用於雙面加工]

[SK3 TYPE]

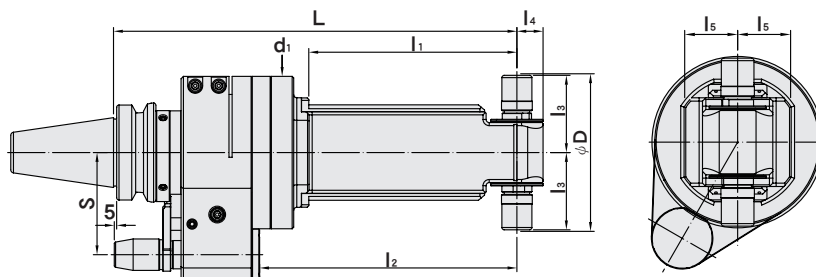

MODEL NO.	TYPE	L	l ₁	l ₂	l ₃	l ₄	l ₅	φ D	S	TORQUE	COLLET	SIZE RANGE	WEIGHT (KGS)
5011-723-061-200	BT40 x SAG06DS - 200	200	75.2	107	50.2	17	21	104	65	10N-m	SKX6	3 ~ 6	5.30
5011-723-061-230	BT40 x SAG06DS - 230	230	105.2	137	50.2	17	21	104	65	10N-m	SKX6	3 ~ 6	5.50
5011-723-061-260	BT40 x SAG06DS - 260	260	135.2	167	50.2	17	21	104	65	10N-m	SKX6	3 ~ 6	5.70
5011-723-101-170	BT40 x SAG10DS - 170	170	38.5	77	64.75	28	34	135	65	25N-m	SKX10	3~10	5.50
5011-723-101-200	BT40 x SAG10DS - 200	200	98	107	64.75	28	34	135	65	25N-m	SKX10	3~10	6.20
5011-723-101-230	BT40 x SAG10DS - 230	230	128	137	64.75	28	34	135	65	25N-m	SKX10	3~10	6.90
5011-723-101-260	BT40 x SAG10DS - 260	260	158	167	64.75	28	34	135	65	25N-m	SKX10	3~10	7.60
5011-723-131-170	BT40 x SAG13DS - 170	170	38.5	77	66.25	28	34	138	65	25N-m	SKX13	3~13	5.50
5011-723-131-200	BT40 x SAG13DS - 200	200	98	107	66.25	28	34	138	65	25N-m	SKX13	3~13	6.20
5011-723-131-230	BT40 x SAG13DS - 230	230	128	137	66.25	28	34	138	65	25N-m	SKX13	3~13	6.90
5011-723-131-260	BT40 x SAG13DS - 260	260	158	167	66.25	28	34	138	65	25N-m	SKX13	3~13	7.60
5012-723-102-215	BT50 x SAG10DS - 215	215	98	107	64.75	28	34	135	80	25N-m	SKX10	3~10	9.50
5012-723-102-245	BT50 x SAG10DS - 245	245	128	137	64.75	28	34	135	80	25N-m	SKX10	3~10	9.90
5012-723-102-275	BT50 x SAG10DS - 275	275	158	167	64.75	28	34	135	80	25N-m	SKX10	3~10	10.3
5012-723-132-185	BT50 x SAG13DS - 185	185	38.5	77	66.25	28	34	138	80	25N-m	SKX13	3~13	9.10
5012-723-132-215	BT50 x SAG13DS - 215	215	98	107	66.25	28	34	138	80	25N-m	SKX13	3~13	9.50
5012-723-132-245	BT50 x SAG13DS - 245	245	128	137	66.25	28	34	138	80	25N-m	SKX13	3~13	9.90
5012-723-132-275	BT50 x SAG13DS - 275	275	158	167	66.25	28	34	138	80	25N-m	SKX13	3~13	10.3

Feature:

- ▶ SAG-D has two output tool shafts and can achieve machining at 180 degree opposite directions.
- ▶ Reduce tool changing frequency and increase machining efficiency.
- ▶ Save your money buying another angle head for different direction of lateral machining.
- ▶ Conserve the space of tool magazine.

Product information:

- ▶ Gear ratio 1:1.
- ▶ Max. revolution: 6000rpm.
- ▶ Suggested $A_p \leq 2\text{mm}$.
- ▶ Coolant feed through dowel pin, coolant outlet from 2 coolant holes.
- ▶ Max. water pressure: 7kgf/cm^2 (100PSI).
- ▶ Two outputs rotate in different directions.
- ▶ Can be used for ATC.



Reminder:

- ▶ Fixed blocks are necessary for installing angle head on the machine.
- ▶ Fixed blocks are varied by different machine designs. Please confirm the detailed dimensions when ordering.

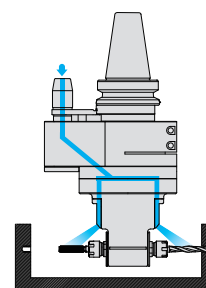
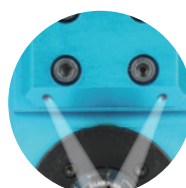

Optional Fixed Block



P.S-41~43



SAG-D ANGLE HEAD HOLDER

FOR DUAL SIDE MACHINING



SBT / SAG-D 雙頭龍銑削頭 [用於雙面加工]

(SK3 TYPE)

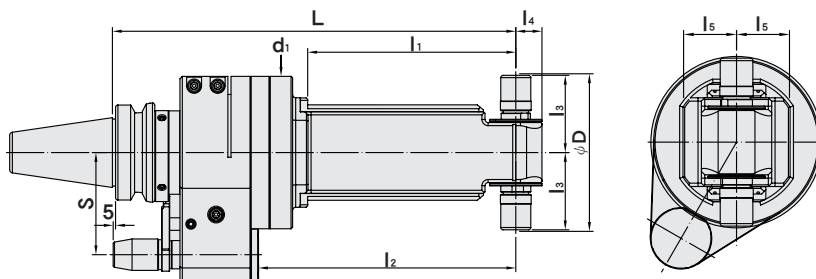

MODEL NO.	TYPE	L	l ₁	l ₂	l ₃	l ₄	l ₅	φ D	S	TORQUE	COLLET	SIZE RANGE	WEIGHT (KGS)
5026-723-061-170	SBT40 x SAG06DS - 170	170	45.2	77	50.2	17	21	104	65	10N-m	SKX6	3 ~ 6	5.1
5026-723-061-200	SBT40 x SAG06DS - 200	200	75.2	107	50.2	17	21	104	65	10N-m	SKX6	3 ~ 6	5.3
5026-723-061-230	SBT40 x SAG06DS - 230	230	105.2	137	50.2	17	21	104	65	10N-m	SKX6	3 ~ 6	5.5
5026-723-061-260	SBT40 x SAG06DS - 260	260	135.2	167	50.2	17	21	104	65	10N-m	SKX6	3 ~ 6	5.7
5026-723-101-170	SBT40 x SAG10DS - 170	170	38.5	77	64.75	28	34	135	65	25N-m	SKX10	3~10	5.5
5026-723-101-200	SBT40 x SAG10DS - 200	200	98	107	64.75	28	34	135	65	25N-m	SKX10	3~10	6.2
5026-723-101-230	SBT40 x SAG10DS - 230	230	128	137	64.75	28	34	135	65	25N-m	SKX10	3~10	6.9
5026-723-101-260	SBT40 x SAG10DS - 260	260	158	167	64.75	28	34	135	65	25N-m	SKX10	3~10	7.6
5026-723-131-170	SBT40 x SAG13DS - 170	170	38.5	77	66.25	28	34	138	65	25N-m	SKX13	3~13	5.5
5026-723-131-200	SBT40 x SAG13DS - 200	200	98	107	66.25	28	34	138	65	25N-m	SKX13	3~13	6.2
5026-723-131-230	SBT40 x SAG13DS - 230	230	128	137	66.25	28	34	138	65	25N-m	SKX13	3~13	6.9
5026-723-131-260	SBT40 x SAG13DS - 260	260	158	167	66.25	28	34	138	65	25N-m	SKX13	3~13	7.6
5027-723-102-185	SBT50 x SAG10DS - 185	185	38.5	77	64.75	28	34	135	80	25N-m	SKX10	3~10	9.1
5027-723-102-215	SBT50 x SAG10DS - 215	215	98	107	64.75	28	34	135	80	25N-m	SKX10	3~10	9.5
5027-723-102-245	SBT50 x SAG10DS - 245	245	128	137	64.75	28	34	135	80	25N-m	SKX10	3~10	9.9
5027-723-102-275	SBT50 x SAG10DS - 275	275	158	167	64.75	28	34	135	80	25N-m	SKX10	3~10	10.3
5027-723-132-185	SBT50 x SAG13DS - 185	185	38.5	77	66.25	28	34	138	80	25N-m	SKX13	3~13	9.1
5027-723-132-215	SBT50 x SAG13DS - 215	215	98	107	66.25	28	34	138	80	25N-m	SKX13	3~13	9.5
5027-723-132-245	SBT50 x SAG13DS - 245	245	128	137	66.25	28	34	138	80	25N-m	SKX13	3~13	9.9
5027-723-132-275	SBT50 x SAG13DS - 275	275	158	167	66.25	28	34	138	80	25N-m	SKX13	3~13	10.3

Feature:

- ▶ SAG-D has two output tool shafts and can achieve machining at 180 degree opposite directions.
- ▶ Reduce tool changing frequency and increase machining efficiency.
- ▶ Save your money buying another angle head for different direction of lateral machining.
- ▶ Conserve the space of tool magazine.

Product information:

- ▶ Gear ratio 1:1.
- ▶ Max. revolution: 6000rpm.
- ▶ Suggested Ap ≤ 2mm.
- ▶ Coolant feed through dowel pin, coolant outlet from 2 coolant holes.
- ▶ Max. water pressure: 7kgf/cm² (100PSI).
- ▶ Two outputs rotate in different directions.
- ▶ Can be used for ATC.



Reminder:

- ▶ Fixed blocks are necessary for installing angle head on the machine.
- ▶ Fixed blocks are varied by different machine designs. Please confirm the detailed dimensions when ordering.

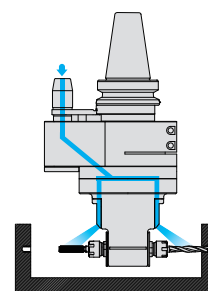
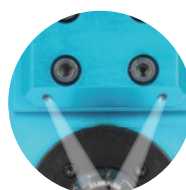

Optional Fixed Block



P.S-41~43



SAU ANGLE HEAD HOLDER

UNIVERSAL TYPE FOR MEDIUM CUTTING

SAU 萬向銑削頭

(ER TYPE)

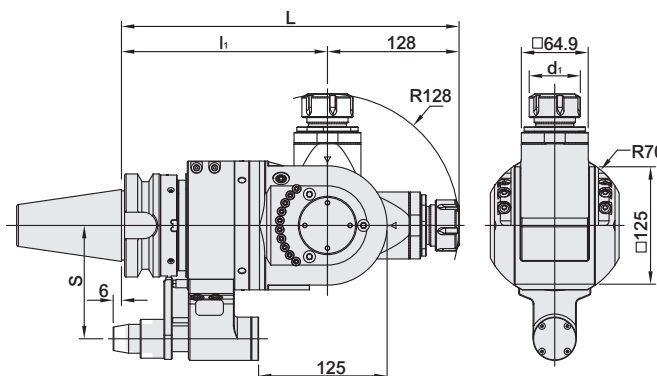

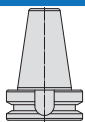
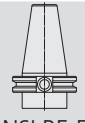
SHANK	MODEL NO.	TYPE	L	l ₁	S	TORQUE	COLLET	SIZE RANGE	WEIGHT (KGS)
 MAS 403	5012-789-323-328	BT50 x SAU32E - 328	328	200	110	40 N-m	ER32	3 ~ 20	20.9
INCHES									
 ANSI B5.50	5032-789-323-333	CAT50 x SAU32E - 13.1"	13.1	7.87	4.33	40 N-m	ER32	3 ~ 20	21.5

Product information:

- ▶ Gear ration 1:1.
- ▶ Max. revolution: 4,000rpm.
- ▶ Suggested Ap≤4mm.
- ▶ Adjustable spindle angle from 0° to 90° on inclined surfaces.
- ▶ Adjustabl angle increment: 1°.
- ▶ Coolant feed through dowel pin, coolant outlet from coolant pipes or coolant nozzle.
- ▶ Rotating direction opposite to machine spindle.
- ▶ Can be used for ATC.



Reminder:

- ▶ Fixed blocks are necessary for installing angle head on the machine.
- ▶ Fixed blocks are varied by different machine designs. Please confirm the detailed dimensions when ordering.

**Optional
Fixed Block**



P.S-41~43





SAR ANGLE HEAD HOLDER

FOR HEAVY-DUTY CUTTING

SAR 大鋼炮銑削頭

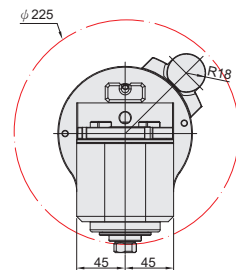
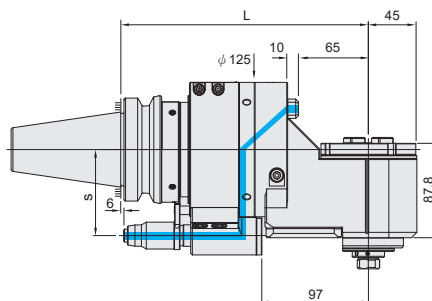
[SBT TYPE]



SHANK	MODEL NO.	TYPE	L	S	TORQUE	WEIGHT (KGS)
 MAS 403	5012-643-302-230	BT50 x SAR50 / SBT30 - 230	230	80	50 N-m	16.1
	5012-643-303-230	BT50 x SAR50 / SBT30 - 230S	230	110	50 N-m	16.1
 DaulDRIVE+	5027-643-302-230	SBT50 x SAR50 / SBT30 - 230	230	80	50 N-m	16.1
	5027-643-303-230	SBT50 x SAR50 / SBT30 - 230S	230	110	50 N-m	16.1
 ANSI B5.50	5032-643-302-230	CAT50 x SAR50 / SBT30 - 230	234.95	80	50 N-m	16.1
	5032-643-303-230	CAT50 x SAR50 / SBT30 - 230S	234.95	110	50 N-m	16.1
 DaulDRIVE+	5044-643-302-230	SCAT50 x SAR50 / SBT30 - 230	234.95	80	50 N-m	16.1
	5044-643-303-230	SCAT50 x SAR50 / SBT30 - 230S	234.95	110	50 N-m	16.1
 DIN 69871-A	5052-643-302-230	DAT50 x SAR50 / SBT30 - 230	235	80	50 N-m	16.1
	5052-643-303-230	DAT50 x SAR50 / SBT30 - 230S	235	110	50 N-m	16.1
 DaulDRIVE+	5067-643-302-230	SDAT50 x SAR50 / SBT30 - 230	235	80	50 N-m	16.1
	5067-643-303-230	SDAT50 x SAR50 / SBT30 - 230S	235	110	50 N-m	16.1

Product information:

- ▶ Gear ratio 1:1.
- ▶ Max. revolution: 3000rpm.
- ▶ Suggested $A_p \leq 4\text{mm}$.
- ▶ Coolant feed through dowel pin, coolant outlet from a coolant nozzle.
- ▶ Max. water pressure: 7kgf/cm^2 (100PSI).
- ▶ Rotating direction same as machine spindle.
- ▶ Can be used for ATC.



Reminder:

- ▶ Fixed blocks are necessary for installing angle head on the machine.
- ▶ Fixed blocks are varied by different machine designs. Please confirm the detailed dimensions when ordering.

Optional
Fixed Block



P.S-41~43



SAR ANGLE HEAD HOLDER

FOR HEAVY-DUTY CUTTING

SAR 大鋼炮銑削頭

[PSC TYPE]

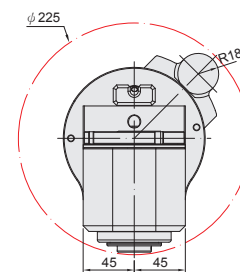
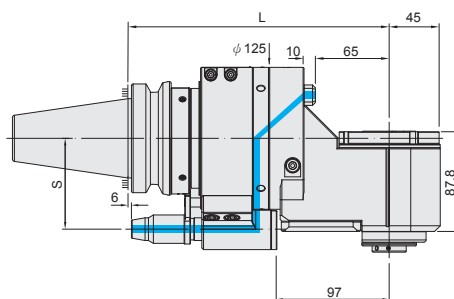

SHANK	MODEL NO.	TYPE	L	S	TORQUE	WEIGHT (KGS)
 MAS 403	5012-646-502-230	BT50 x SAR50 / PSC50 - 230	230	80	50 N-m	16.1
	5012-646-503-230	BT50 x SAR50 / PSC50 - 230S	230	110	50 N-m	16.1
 DaulDRIVE+	5027-646-502-230	SBT50 x SAR50 / PSC50 - 230	230	80	50 N-m	16.1
	5027-646-503-230	SBT50 x SAR50 / PSC50 - 230S	230	110	50 N-m	16.1
 ANSI B5.50	5032-646-502-230	CAT50 x SAR50 / PSC50 - 230	234.95	80	50 N-m	16.1
	5032-646-503-230	CAT50 x SAR50 / PSC50 - 230S	234.95	110	50 N-m	16.1
 DaulDRIVE+	5044-646-502-230	SCAT50 x SAR50 / PSC50 - 230	234.95	80	50 N-m	16.1
	5044-646-503-230	SCAT50 x SAR50 / PSC50 - 230S	234.95	110	50 N-m	16.1
 DIN 69871-A	5052-646-502-230	DAT50 x SAR50 / PSC50 - 230	235	80	50 N-m	16.1
	5052-646-503-230	DAT50 x SAR50 / PSC50 - 230S	235	110	50 N-m	16.1
 DaulDRIVE+	5067-646-502-230	SDAT50 x SAR50 / PSC50 - 230	235	80	50 N-m	16.1
	5067-646-503-230	SDAT50 x SAR50 / PSC50 - 230S	235	110	50 N-m	16.1

Product information:

- ▶ Gear ratio 1:1.
- ▶ Max. revolution: 3000rpm.
- ▶ Suggested $A_p \leq 4\text{mm}$.
- ▶ Coolant feed through dowel pin, coolant outlet from a coolant nozzle.
- ▶ Max. water pressure: 7kgf/cm^2 (100PSI).
- ▶ Rotating direction same as machine spindle.
- ▶ Can be used for ATC.



Reminder:

- ▶ Fixed blocks are necessary for installing angle head on the machine.
- ▶ Fixed blocks are varied by different machine designs. Please confirm the detailed dimensions when ordering.

Optional
Fixed Block



PS-41~43



SAR ANGLE HEAD HOLDER

FOR HEAVY-DUTY CUTTING

SAR 大鋼炮銑削頭

[MLD TYPE]

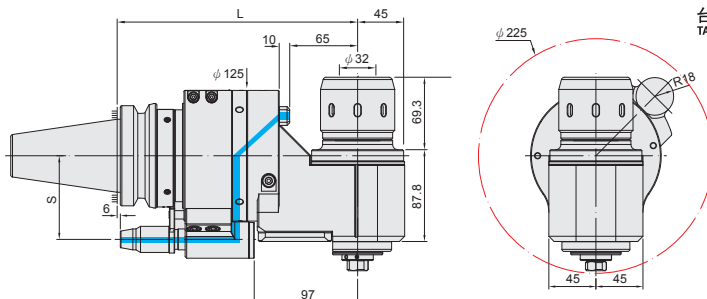

SHANK	MODEL NO.	TYPE	L	S	TORQUE	WEIGHT (KGS)
 MAS 403	5012-645-322-230	BT50 x SAR50 / MLD32 - 230	230	80	50 N-m	16.1
	5012-645-323-230	BT50 x SAR50 / MLD32 - 230S	230	110	50 N-m	16.1
 DaulDRIVE+	5027-645-322-230	SBT50 x SAR50 / MLD32 - 230	230	80	50 N-m	16.1
	5027-645-323-230	SBT50 x SAR50 / MLD32 - 230S	230	110	50 N-m	16.1
 ANSI B5.50	5032-645-322-230	CAT50 x SAR50 / MLD32 - 230	234.95	80	50 N-m	16.1
	5032-645-323-230	CAT50 x SAR50 / MLD32 - 230S	234.95	110	50 N-m	16.1
 DaulDRIVE+	5044-645-322-230	SCAT50 x SAR50 / MLD32 - 230	234.95	80	50 N-m	16.1
	5044-645-323-230	SCAT50 x SAR50 / MLD32 - 230S	234.95	110	50 N-m	16.1
 DIN 69871-A	5052-645-322-230	DAT50 x SAR50 / MLD32 - 230	235	80	50 N-m	16.1
	5052-645-323-230	DAT50 x SAR50 / MLD32 - 230S	235	110	50 N-m	16.1
 DaulDRIVE+	5067-645-322-230	SDAT50 x SAR50 / MLD32 - 230	235	80	50 N-m	16.1
	5067-645-323-230	SDAT50 x SAR50 / MLD32 - 230S	235	110	50 N-m	16.1

Product information:

- ▶ Gear ratio 1:1.
- ▶ Max. revolution: 3000rpm.
- ▶ Suggested $A_p \leq 4\text{mm}$.
- ▶ Coolant feed through dowel pin, coolant outlet from a coolant nozzle.
- ▶ Max. water pressure: $7\text{kgf/cm}^2(100\text{PSI})$.
- ▶ Rotating direction same as machine spindle.
- ▶ Can be used for ATC.



Reminder:

- ▶ Fixed blocks are necessary for installing angle head on the machine.
- ▶ Fixed blocks are varied by different machine designs. Please confirm the detailed dimensions when ordering.

Optional
Fixed Block



P.S-41~43







SAR ANGLE HEAD HOLDER

FOR HEAVY-DUTY CUTTING

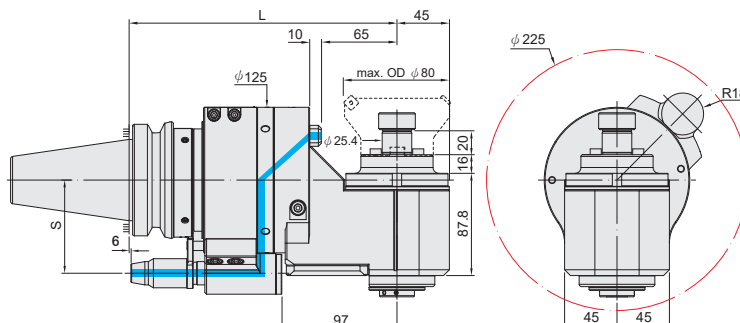
SAR 大鋼炮銑削頭

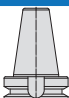
[FMA TYPE]

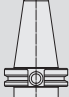
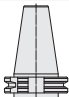

SHANK	MODEL NO.	TYPE	L	S	TORQUE	WEIGHT (KGS)
 MAS 403	5012-644-A642-906	BT50 x SAR50 / FMA25.4 - 230	230	80	50 N-m	16.1
	5012-644-A643-906	BT50 x SAR50 / FMA25.4 - 230S	230	110	50 N-m	16.1
 DaulDRIVE+	5027-644-A642-906	SBT50 x SAR50 / FMA25.4 - 230	230	80	50 N-m	16.1
	5027-644-A643-906	SBT50 x SAR50 / FMA25.4 - 230S	230	110	50 N-m	16.1
 ANSI B5.50	5032-644-A642-906	CAT50 x SAR50 / FMA25.4 - 230	234.95	80	50 N-m	16.1
	5032-644-A643-906	CAT50 x SAR50 / FMA25.4 - 230S	234.95	110	50 N-m	16.1
 DaulDRIVE+	5044-644-A642-906	SCAT50 x SAR50 / FMA25.4 - 230	234.95	80	50 N-m	16.1
	5044-644-A643-906	SCAT50 x SAR50 / FMA25.4 - 230S	234.95	110	50 N-m	16.1
 DIN 69871-A	5052-644-A642-906	DAT50 x SAR50 / FMA25.4 - 230	235	80	50 N-m	16.1
	5052-644-A643-906	DAT50 x SAR50 / FMA25.4 - 230S	235	110	50 N-m	16.1
 DaulDRIVE+	5067-644-A642-906	SDAT50 x SAR50 / FMA25.4 - 230	235	80	50 N-m	16.1
	5067-644-A643-906	SDAT50 x SAR50 / FMA25.4 - 230S	235	110	50 N-m	16.1

Product information:

- ▶ Gear ratio 1:1.
- ▶ Max. revolution: 3000rpm.
- ▶ Suggested $A_p \leq 4\text{mm}$.
- ▶ Coolant feed through dowel pin, coolant outlet from a coolant nozzle.
- ▶ Max. water pressure: 7kgf/cm^2 (100PSI).
- ▶ Rotating direction same as machine spindle.
- ▶ Can be used for ATC.



Reminder:

- ▶ Fixed blocks are necessary for installing angle head on the machine.
- ▶ Fixed blocks are varied by different machine designs. Please confirm the detailed dimensions when ordering.

Optional
Fixed Block



PS-41~43



SAR ANGLE HEAD HOLDER

FOR HEAVY-DUTY CUTTING

SAR 大鋼炮銑削頭

[ER TYPE]

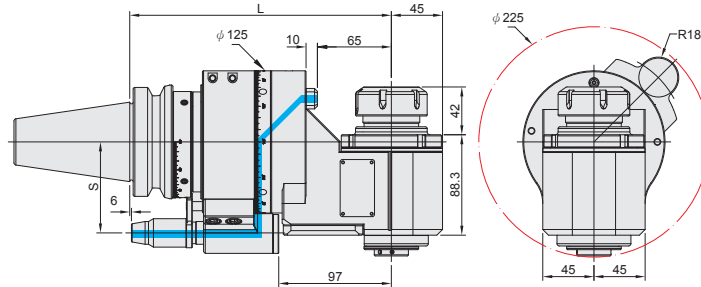

SHANK	MODEL NO.	TYPE	L	S	TORQUE	WEIGHT (KGS)
 MAS 403	5012-120-402-230	BT50 x SAR50 / ER40 - 230	230	80	50 N-m	16.4
	5012-120-403-230	BT50 x SAR50 / ER40 - 230S	230	110	50 N-m	16.4
 DaulDRIVE+	5027-120-402-230	SBT50 x SAR50 / ER40 - 230	230	80	50 N-m	16.4
	5027-120-403-230	SBT50 x SAR50 / ER40 - 230S	230	110	50 N-m	16.4
 ANSI B5.50	5032-120-402-230	CAT50 x SAR50 / ER40 - 230	230	80	50 N-m	16.4
	5032-120-403-230	CAT50 x SAR50 / ER40 - 230S	230	110	50 N-m	16.4
 DaulDRIVE+	5044-120-402-230	SCAT50 x SAR50 / ER40 - 230	230	80	50 N-m	16.4
	5044-120-403-230	SCAT50 x SAR50 / ER40 - 230S	230	110	50 N-m	16.4
 DIN 69871-A	5052-120-402-230	DAT50 x SAR50 / ER40 - 230	230	80	50 N-m	16.4
	5052-120-403-230	DAT50 x SAR50 / ER40 - 230S	230	110	50 N-m	16.4
 DaulDRIVE+	5067-120-402-230	SDAT50 x SAR50 / ER40 - 230	230	80	50 N-m	16.4
	5067-120-403-230	SDAT50 x SAR50 / ER40 - 230S	230	110	50 N-m	16.4

Product information:

- ▶ Gear ratio 1:1.
- ▶ Max. revolution: 3000rpm.
- ▶ Suggested $A_p \leq 4\text{mm}$.
- ▶ Coolant feed through dowel pin, coolant outlet from a coolant nozzle.
- ▶ Max. water pressure: 7kgf/cm^2 (100PSI).
- ▶ Rotating direction same as machine spindle.
- ▶ Can be used for ATC.



Reminder:

- ▶ Fixed blocks are necessary for installing angle head on the machine.
- ▶ Fixed blocks are varied by different machine designs. Please confirm the detailed dimensions when ordering.

Optional
Fixed Block



P.S-41~43



SAC ANGLE HEAD HOLDER

FOR MEDIUM CUTTING

SAC 中鋼炮銑削頭

(SK3TYPE)

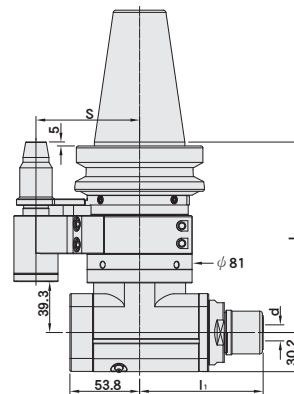

MODEL NO.	TYPE	L	h ₁	S	TORQUE	COLLET	SIZE RANGE	WEIGHT (KGS)
5011-720-101-130	BT40 x SAC10S - 130	130	91.5	65	25 N-m	SKX10	3 ~ 10	6.4
5011-720-131-130	BT40 x SAC13S - 130	130	93	65	25 N-m	SKX13	3 ~ 13	6.4
5011-720-161-130	BT40 x SAC16S - 130	130	99.3	65	25 N-m	SKX16	3 ~ 16	6.4
5012-720-102-147	BT50 x SAC10S - 147	147	91.5	80	25 N-m	SKX10	3 ~ 10	8.4
5012-720-132-147	BT50 x SAC13S - 147	147	93	80	25 N-m	SKX13	3 ~ 13	8.4
5012-720-162-147	BT50 x SAC16S - 147	147	99.3	80	25 N-m	SKX16	3 ~ 16	8.4
5031-720-101-150	CAT40 x SAC10S - 150	150	91.5	65	25 N-m	SKX10	3 ~ 10	6.4
5031-720-131-150	CAT40 x SAC13S - 150	150	93	65	25 N-m	SKX13	3 ~ 13	6.4
5031-720-161-150	CAT40 x SAC16S - 150	150	99.3	65	25 N-m	SKX16	3 ~ 16	6.4
5032-720-102-150	CAT50 x SAC10S - 150	150	91.5	80	25 N-m	SKX10	3 ~ 10	8.4
5032-720-132-150	CAT50 x SAC13S - 150	150	93	80	25 N-m	SKX13	3 ~ 13	8.4
5032-720-162-150	CAT50 x SAC16S - 150	150	99.3	80	25 N-m	SKX16	3 ~ 16	8.4
5051-720-101-146	DAT40 x SAC10S - 146	146	91.5	65	25 N-m	SKX10	3 ~ 10	6.4
5051-720-131-146	DAT40 x SAC13S - 146	146	93	65	25 N-m	SKX13	3 ~ 13	6.4
5051-720-161-146	DAT40 x SAC16S - 146	146	99.3	65	25 N-m	SKX16	3 ~ 16	6.4
5052-720-102-150	DAT50 x SAC10S - 150	150	91.5	80	25 N-m	SKX10	3 ~ 10	8.4
5052-720-132-150	DAT50 x SAC13S - 150	150	93	80	25 N-m	SKX13	3 ~ 13	8.4
5052-720-162-150	DAT50 x SAC16S - 150	150	99.3	80	25 N-m	SKX16	3 ~ 16	8.4
5073-720-101-155	HSK63A x SAC10S - 155	155	91.5	65	25 N-m	SKX10	3 ~ 10	6.4
5073-720-131-155	HSK63A x SAC13S - 155	155	93	65	25 N-m	SKX13	3 ~ 13	6.4
5073-720-161-155	HSK63A x SAC16S - 155	155	99.3	65	25 N-m	SKX16	3 ~ 16	6.4
5075-720-102-151	HSK100A x SAC10S - 151	151	91.5	80	25 N-m	SKX10	3 ~ 10	8.4
5075-720-132-151	HSK100A x SAC13S - 151	151	93	80	25 N-m	SKX13	3 ~ 13	8.4
5075-720-162-151	HSK100A x SAC16S - 151	151	99.3	80	25 N-m	SKX16	3 ~ 16	8.4

Product information:

- ▶ Gear ratio 1:1. ▶ Max. revolution: 3000rpm. ▶ Suggested Ap ≤ 3mm.
- ▶ Internal coolant not available. ▶ Rotating direction opposite to machine spindle. ▶ Can be used for ATC.



Reminder:

- ▶ Fixed blocks are necessary for installing angle head on the machine.
- ▶ Fixed blocks are varied by different machine designs. Please confirm the detailed dimensions when ordering.

Optional Fixed Block



P.S-41~43



SAC ANGLE HEAD HOLDER

FOR MEDIUM CUTTING



SAC 中鋼炮銑削頭

(SK3 TYPE)

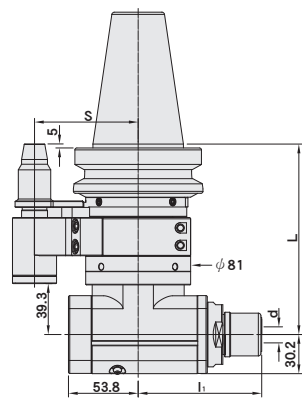

MODEL NO.	TYPE	L	l ₁	S	TORQUE	COLLET	SIZE RANGE	WEIGHT (KGS)
5026-720-101-130	SBT40 x SAC10S - 130	130	91.5	65	25 N-m	SKX10	3 ~ 10	6.4
5026-720-131-130	SBT40 x SAC13S - 130	130	93	65	25 N-m	SKX13	3 ~ 13	6.4
5026-720-161-130	SBT40 x SAC16S - 130	130	99.3	65	25 N-m	SKX16	3 ~ 16	6.4
5027-720-102-147	SBT50 x SAC10S - 147	147	91.5	80	25 N-m	SKX10	3 ~ 10	8.4
5027-720-132-147	SBT50 x SAC13S - 147	147	93	80	25 N-m	SKX13	3 ~ 13	8.4
5027-720-162-147	SBT50 x SAC16S - 147	147	99.3	80	25 N-m	SKX16	3 ~ 16	8.4
5043-720-101-150	SCAT40 x SAC10S - 150	150	91.5	65	25 N-m	SKX10	3 ~ 10	6.4
5043-720-131-150	SCAT40 x SAC13S - 150	150	93	65	25 N-m	SKX13	3 ~ 13	6.4
5043-720-161-150	SCAT40 x SAC16S - 150	150	99.3	65	25 N-m	SKX16	3 ~ 16	6.4
5044-720-102-150	SCAT50 x SAC10S - 150	150	91.5	80	25 N-m	SKX10	3 ~ 10	8.4
5044-720-132-150	SCAT50 x SAC13S - 150	150	93	80	25 N-m	SKX13	3 ~ 13	8.4
5044-720-162-150	SCAT50 x SAC16S - 150	150	99.3	80	25 N-m	SKX16	3 ~ 16	8.4
5066-720-101-146	SDAT40 x SAC10S - 146	146	91.5	65	25 N-m	SKX10	3 ~ 10	6.4
5066-720-131-146	SDAT40 x SAC13S - 146	146	93	65	25 N-m	SKX13	3 ~ 13	6.4
5066-720-161-146	SDAT40 x SAC16S - 146	146	99.3	65	25 N-m	SKX16	3 ~ 16	6.4
5067-720-102-150	SDAT50 x SAC10S - 150	150	91.5	80	25 N-m	SKX10	3 ~ 10	8.4
5067-720-132-150	SDAT50 x SAC13S - 150	150	93	80	25 N-m	SKX13	3 ~ 13	8.4
5067-720-162-150	SDAT50 x SAC16S - 150	150	99.3	80	25 N-m	SKX16	3 ~ 16	8.4

Product information:

- ▶ Gear ratio 1:1.
- ▶ Max. revolution: 3000rpm.
- ▶ Suggested Ap ≤ 3mm.
- ▶ Internal coolant not available.
- ▶ Rotating direction opposite to machine spindle.
- ▶ Can be used for ATC.



Reminder:

- ▶ Fixed blocks are necessary for installing angle head on the machine.
- ▶ Fixed blocks are varied by different machine designs. Please confirm the detailed dimensions when ordering.

Optional Fixed Block



P.S-41~43



SAC ANGLE HEAD HOLDER

FOR MEDIUM CUTTING

Dual
DRIVE+

SAC 中鋼炮銑削頭

(PRO-E TYPE)

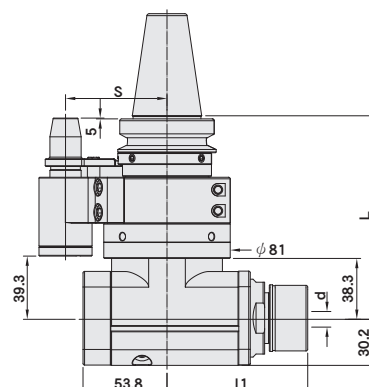

MODEL NO.	TYPE	L	l ₁	S	TORQUE	COLLET	d SIZE RANGE	WEIGHT (KGS)
5026-S96-161-130	SBT40 x SAC16P - 130	130	90	65	25 N-m	ER16	1 ~ 10	6.40
5026-S96-201-130	SBT40 x SAC20P - 130	130	90	65	25 N-m	ER20	1 ~ 13	6.40
5026-S96-251-130	SBT40 x SAC25P - 130	130	90	65	25 N-m	ER25	1 ~ 16	6.40
5026-S96-321-130	SBT40 x SAC32P - 130	130	95	65	25 N-m	ER32	2 ~ 20	6.44
5027-S96-162-147	SBT50 x SAC16P - 147	147	90	80	25 N-m	ER16	1 ~ 10	8.40
5027-S96-202-147	SBT50 x SAC20P - 147	147	90	80	25 N-m	ER20	1 ~ 13	8.40
5027-S96-252-147	SBT50 x SAC25P - 147	147	90	80	25 N-m	ER25	1 ~ 16	8.40
5027-S96-322-147	SBT50 x SAC32P - 147	147	95	80	25 N-m	ER32	2 ~ 20	8.44

Product information:

- ▶ Gear ratio 1:1. ▶ Max. revolution: 3000rpm. ▶ Suggested Ap ≤ 3mm.
- ▶ Internal coolant not available. ▶ Rotating direction opposite to machine spindle. ▶ Can be used for ATC.



Reminder:

- ▶ Fixed blocks are necessary for installing angle head on the machine.
- ▶ Fixed blocks are varied by different machine designs. Please confirm the detailed dimensions when ordering.

Optional
Fixed Block



P.S-41~43



SAC ANGLE HEAD HOLDER

FOR MEDIUM CUTTING

SAC 中鋼炮銑削頭

(ER TYPE)

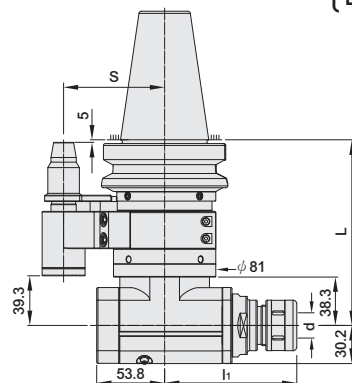

MODEL NO.	TYPE	L	l ₁	S	TORQUE	COLLET	d SIZE RANGE	WEIGHT (KGS)
5011-640-161-130	BT40 x SAC16E - 130	130	89.6	65	25 N-m	ER16	3 ~ 10	6.40
5011-640-201-130	BT40 x SAC20E - 130	130	91	65	25 N-m	ER20	3 ~ 13	6.40
5011-640-251-130	BT40 x SAC25E - 130	130	92	65	25 N-m	ER25	3 ~ 16	6.40
5011-640-321-130	BT40 x SAC32E - 130	130	96	65	25 N-m	ER32	3 ~ 20	6.44
5012-640-162-147	BT50 x SAC16E - 147	147	89.6	80	25 N-m	ER16	3 ~ 10	8.40
5012-640-202-147	BT50 x SAC20E - 147	147	91	80	25 N-m	ER20	3 ~ 13	8.40
5012-640-252-147	BT50 x SAC25E - 147	147	92	80	25 N-m	ER25	3 ~ 16	8.40
5012-640-322-147	BT50 x SAC32E - 147	147	96	80	25 N-m	ER32	3 ~ 20	8.44
5031-640-161-150	CAT40 x SAC16E - 150	150	89.6	65	25 N-m	ER16	3 ~ 10	6.40
5031-640-201-150	CAT40 x SAC20E - 150	150	91	65	25 N-m	ER20	3 ~ 13	6.40
5031-640-251-150	CAT40 x SAC25E - 150	150	92	65	25 N-m	ER25	3 ~ 16	6.40
5031-640-321-150	CAT40 x SAC32E - 150	150	96	65	25 N-m	ER32	3 ~ 20	6.40
5032-640-162-150	CAT50 x SAC16E - 150	150	89.6	80	25 N-m	ER16	3 ~ 10	8.40
5032-640-202-150	CAT50 x SAC20E - 150	150	91	80	25 N-m	ER20	3 ~ 13	8.40
5032-640-252-150	CAT50 x SAC25E - 150	150	92	80	25 N-m	ER25	3 ~ 16	8.40
5032-640-322-150	CAT50 x SAC32E - 150	150	96	80	25 N-m	ER32	3 ~ 20	8.44
5051-640-161-146	DAT40 x SAC16E - 146	146	89.6	65	25 N-m	ER16	3 ~ 10	6.40
5051-640-201-146	DAT40 x SAC20E - 146	146	91	65	25 N-m	ER20	3 ~ 13	6.40
5051-640-251-146	DAT40 x SAC25E - 146	146	92	65	25 N-m	ER25	3 ~ 16	6.40
5051-640-321-146	DAT40 x SAC32E - 146	146	96	65	25 N-m	ER32	3 ~ 20	6.40
5052-640-162-150	DAT50 x SAC16E - 150	150	89.6	80	25 N-m	ER16	3 ~ 10	8.40
5052-640-202-150	DAT50 x SAC20E - 150	150	91	80	25 N-m	ER20	3 ~ 13	8.40
5052-640-252-150	DAT50 x SAC25E - 150	150	92	80	25 N-m	ER25	3 ~ 16	8.40
5052-640-322-150	DAT50 x SAC32E - 150	150	96	80	25 N-m	ER32	3 ~ 20	8.44
5073-640-161-155	HSK63A x SAC16E - 155	155	89.6	65	25 N-m	ER16	3 ~ 10	6.40
5073-640-201-155	HSK63A x SAC20E - 155	155	91	65	25 N-m	ER20	3 ~ 13	6.40
5073-640-251-155	HSK63A x SAC25E - 155	155	92	65	25 N-m	ER25	3 ~ 16	6.40
5073-640-321-155	HSK63A x SAC32E - 155	155	96	65	25 N-m	ER32	3 ~ 20	6.44
5075-640-162-151	HSK100A x SAC16E - 151	151	89.6	80	25 N-m	ER16	3 ~ 10	8.40
5075-640-202-151	HSK100A x SAC20E - 151	151	91	80	25 N-m	ER20	3 ~ 13	8.40
5075-640-252-151	HSK100A x SAC25E - 151	151	92	80	25 N-m	ER25	3 ~ 16	8.40
5075-640-322-151	HSK100A x SAC32E - 151	151	96	80	25 N-m	ER32	3 ~ 20	8.44

Product information:

- ▶ Gear ratio 1:1. ▶ Max. revolution: 3000rpm. ▶ Suggested Ap ≤ 3mm.
- ▶ Internal coolant not available. ▶ Rotating direction opposite to machine spindle. ▶ Can be used for ATC.



Reminder:

- ▶ Fixed blocks are necessary for installing angle head on the machine.
- ▶ Fixed blocks are varied by different machine designs. Please confirm the detailed dimensions when ordering.

Optional
Fixed Block



P.S-41~43



SAC ANGLE HEAD HOLDER

FOR MEDIUM CUTTING

Dual
DRIVE+



SAC 中鋼炮銑削頭

[ER TYPE]

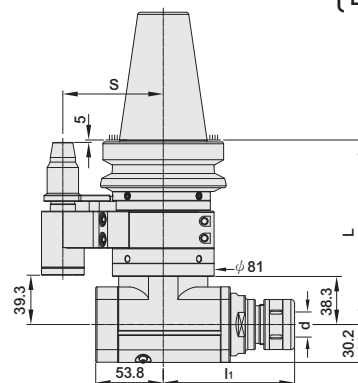

MODEL NO.	TYPE	L	l ₁	S	TORQUE	COLLET	d SIZE RANGE	WEIGHT (KGS)
5026-640-161-130	SBT40 x SAC16E - 130	130	89.6	65	25 N-m	ER16	3 ~ 10	6.40
5026-640-201-130	SBT40 x SAC20E - 130	130	91	65	25 N-m	ER20	3 ~ 13	6.40
5026-640-251-130	SBT40 x SAC25E - 130	130	92	65	25 N-m	ER25	3 ~ 16	6.40
5026-640-321-130	SBT40 x SAC32E - 130	130	96	65	25 N-m	ER32	3 ~ 20	6.44
5027-640-162-147	SBT50 x SAC16E - 147	147	89.6	80	25 N-m	ER16	3 ~ 10	8.40
5027-640-202-147	SBT50 x SAC20E - 147	147	91	80	25 N-m	ER20	3 ~ 13	8.40
5027-640-252-147	SBT50 x SAC25E - 147	147	92	80	25 N-m	ER25	3 ~ 16	8.40
5027-640-322-147	SBT50 x SAC32E - 147	147	96	80	25 N-m	ER32	3 ~ 20	8.44
5043-640-161-150	SCAT40 x SAC16E - 150	150	89.6	65	25 N-m	ER16	3 ~ 10	6.40
5043-640-201-150	SCAT40 x SAC20E - 150	150	91	65	25 N-m	ER20	3 ~ 13	6.40
5043-640-251-150	SCAT40 x SAC25E - 150	150	92	65	25 N-m	ER25	3 ~ 16	6.40
5043-640-321-150	SCAT40 x SAC32E - 150	150	96	65	25 N-m	ER32	3 ~ 20	6.44
5044-640-162-150	SCAT50 x SAC16E - 150	150	89.6	80	25 N-m	ER16	3 ~ 10	8.40
5044-640-202-150	SCAT50 x SAC20E - 150	150	91	80	25 N-m	ER20	3 ~ 13	8.40
5044-640-252-150	SCAT50 x SAC25E - 150	150	92	80	25 N-m	ER25	3 ~ 16	8.40
5044-640-322-150	SCAT50 x SAC32E - 150	150	96	80	25 N-m	ER32	3 ~ 20	8.44
5066-640-161-146	SDAT40 x SAC16E - 146	146	89.6	65	25 N-m	ER16	3 ~ 10	6.40
5066-640-201-146	SDAT40 x SAC20E - 146	146	91	65	25 N-m	ER20	3 ~ 13	6.40
5066-640-251-146	SDAT40 x SAC25E - 146	146	92	65	25 N-m	ER25	3 ~ 16	6.40
5066-640-321-146	SDAT40 x SAC32E - 146	146	96	65	25 N-m	ER32	3 ~ 20	6.44
5067-640-162-150	SDAT50 x SAC16E - 150	150	89.6	80	25 N-m	ER16	3 ~ 10	8.40
5067-640-202-150	SDAT50 x SAC20E - 150	150	91	80	25 N-m	ER20	3 ~ 13	8.40
5067-640-252-150	SDAT50 x SAC25E - 150	150	92	80	25 N-m	ER25	3 ~ 16	8.40
5067-640-322-150	SDAT50 x SAC32E - 150	150	96	80	25 N-m	ER32	3 ~ 20	8.44

Product information:

- ▶ Gear ratio 1:1.
- ▶ Max. revolution: 3000rpm.
- ▶ Suggested Ap ≤ 3mm.
- ▶ Internal coolant not available.
- ▶ Rotating direction opposite to machine spindle.
- ▶ Can be used for ATC.



Reminder:

- ▶ Fixed blocks are necessary for installing angle head on the machine.
- ▶ Fixed blocks are varied by different machine designs. Please confirm the detailed dimensions when ordering.

Optional
Fixed Block



P.S-41~43



SAC ANGLE HEAD HOLDER

FOR MEDIUM CUTTING

SAC 中鋼炮銑削頭

[FMA/B TYPE]

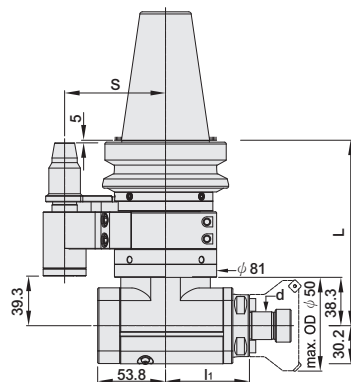

MODEL NO.	TYPE	L	d	l ₁	S	TORQUE	WEIGHT (KGS)
5011-641-A641-512	BT40 x SAC25.4FA - 130	130	25.4	66	65	25 N-m	6.54
5011-641-221-130	BT40 x SAC22FB - 130	130	22	66	65	25 N-m	6.54
5012-641-A642-579	BT50 x SAC25.4FA - 147	147	25.4	66	80	25 N-m	8.54
5012-641-222-147	BT50 x SAC22FB - 147	147	22	66	80	25 N-m	8.54
5031-641-A641-591	CAT40 x SAC25.4FA - 150	150	25.4	66	65	25 N-m	6.54
5031-641-221-150	CAT40 x SAC22FB - 150	150	22	66	65	25 N-m	6.54
5032-641-A642-591	CAT50 x SAC25.4FA - 150	150	25.4	66	80	25 N-m	8.54
5032-641-222-150	CAT50 x SAC22FB - 150	150	22	66	80	25 N-m	8.54
5051-641-A641-575	DAT40 x SAC25.4FA - 146	146	25.4	66	65	25 N-m	6.54
5051-641-221-146	DAT40 x SAC22FB - 146	146	22	66	65	25 N-m	6.54
5052-641-A642-591	DAT50 x SAC25.4FA - 150	150	25.4	66	80	25 N-m	8.54
5052-641-222-150	DAT50 x SAC22FB - 150	150	22	66	80	25 N-m	8.54
5073-641-A641-610	HSK63A x SAC25.4FA - 155	155	25.4	66	65	25 N-m	6.54
5073-641-221-155	HSK63A x SAC22FB - 155	155	22	66	65	25 N-m	6.54
5075-641-A642-594	HSK100A x SAC25.4FA - 151	151	25.4	66	80	25 N-m	8.54
5075-641-222-151	HSK100A x SAC22FB - 151	151	22	66	80	25 N-m	8.54

Product information:

- ▶ Gear ratio 1:1.
- ▶ Max. revolution: 3000rpm.
- ▶ Suggested Ap ≤ 3mm.
- ▶ Internal coolant not available.
- ▶ Rotating direction opposite to machine spindle.
- ▶ Can be used for ATC.



Reminder:

Fixed blocks are necessary for installing angle head on the machine.
 Fixed blocks are varied by different machine designs. Please confirm the detailed dimensions when ordering.

Optional Fixed Block



P.S-41~43



SAC ANGLE HEAD HOLDER

FOR MEDIUM CUTTING

Dual
DRIVE+

SAC 中鋼炮銑削頭

[FMA/B TYPE]

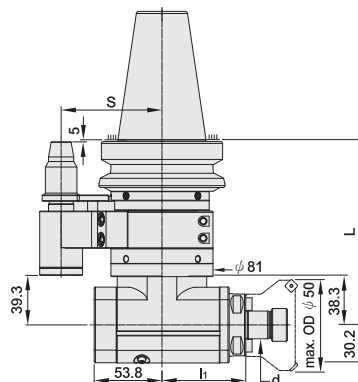

MODEL NO.	TYPE	L	d	h ₁	S	TORQUE	WEIGHT (KGS)
5026-641-A641-512	SBT40 x SAC25.4FA - 130	130	25.4	66	65	25 N-m	6.54
5026-641-221-130	SBT40 x SAC22FB - 130	130	22	66	65	25 N-m	6.54
5027-641-A642-579	SBT50 x SAC25.4FA - 147	147	25.4	66	80	25 N-m	8.54
5027-641-222-147	SBT50 x SAC22FB - 147	147	22	66	80	25 N-m	8.54
5043-641-A641-591	SCAT40 x SAC25.4FA - 150	150	25.4	66	65	25 N-m	6.54
5043-641-221-150	SCAT40 x SAC22FB - 150	150	22	66	65	25 N-m	6.54
5044-641-A642-591	SCAT50 x SAC25.4FA - 150	150	25.4	66	80	25 N-m	8.54
5044-641-222-150	SCAT50 x SAC22FB - 150	150	22	66	80	25 N-m	8.54
5066-641-A641-575	SDAT40 x SAC25.4FA - 146	146	25.4	66	65	25 N-m	6.54
5066-641-221-146	SDAT40 x SAC22FB - 146	146	22	66	65	25 N-m	6.54
5067-641-A642-591	SDAT50 x SAC25.4FA - 150	150	25.4	66	80	25 N-m	8.54
5067-641-222-150	SDAT50 x SAC22FB - 150	150	22	66	80	25 N-m	8.54

Product information:

- ▶ Gear ratio 1:1.
- ▶ Max. revolution: 3000rpm.
- ▶ Suggested $A_p \leq 3\text{mm}$.
- ▶ Internal coolant not available.
- ▶ Rotating direction opposite to machine spindle.
- ▶ Can be used for ATC.



Reminder:

- ▶ Fixed blocks are necessary for installing angle head on the machine.
- ▶ Fixed blocks are varied by different machine designs. Please confirm the detailed dimensions when ordering.

Optional
Fixed Block



P.S-41~43



SAC ANGLE HEAD HOLDER

FOR MEDIUM CUTTING

SAC 中鋼炮銑削頭

[SCA TYPE]

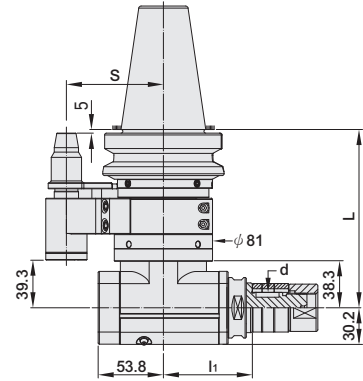

MODEL NO.	TYPE	L	l ₁	d	S	TORQUE	WEIGHT (KGS)
5011-S32-221-130	BT40 x SAC22SC - 130	130	67.5	22	65	25 N-m	6.40
5011-S32-A641-512	BT40 x SAC25.4SC - 130	130	67.5	25.4	65	25 N-m	6.40
5012-S32-222-147	BT50 x SAC22SC - 147	147	67.5	22	80	25 N-m	6.44
5012-S32-A642-579	BT50 x SAC25.4SC - 147	147	67.5	25.4	80	25 N-m	6.44
5031-S32-221-150	CAT40 x SAC22SC - 150	150	67.5	22	65	25 N-m	6.40
5031-S32-A641-591	CAT40 x SAC25.4SC - 150	150	67.5	25.4	65	25 N-m	6.40
5032-S32-222-150	CAT50 x SAC22SC - 150	150	67.5	22	80	25 N-m	6.44
5032-S32-A642-591	CAT50 x SAC25.4SC - 150	150	67.5	25.4	80	25 N-m	6.44
5051-S32-221-146	DAT40 x SAC22SC - 146	146	67.5	22	65	25 N-m	6.40
5051-S32-A641-575	DAT40 x SAC25.4SC - 146	146	67.5	25.4	65	25 N-m	6.40
5052-S32-222-150	DAT50 x SAC22SC - 150	150	67.5	22	80	25 N-m	6.44
5052-S32-A642-591	DAT50 x SAC25.4SC - 150	150	67.5	25.4	80	25 N-m	6.44
5073-S32-221-155	HSK63A x SAC22SC - 155	155	67.5	22	65	25 N-m	8.40
5073-S32-A641-610	HSK63A x SAC25.4SC - 155	155	67.5	25.4	65	25 N-m	8.40
5075-S32-222-151	HSK100A x SAC22SC - 151	151	67.5	22	80	25 N-m	8.40
5075-S32-A642-594	HSK100A x SAC25.4SC - 151	151	67.5	25.4	80	25 N-m	8.40

Product information:

- ▶ Gear ratio 1:1.
- ▶ Max. revolution: 3000rpm.
- ▶ Suggested Ap ≤ 3mm.
- ▶ Internal coolant not available.
- ▶ Rotating direction opposite to machine spindle.
- ▶ Can be used for ATC.



Reminder:

- ▶ Fixed blocks are necessary for installing angle head on the machine.
- ▶ Fixed blocks are varied by different machine designs. Please confirm the detailed dimensions when ordering.

Optional
Fixed Block



P.S-41~43



SAC ANGLE HEAD HOLDER

FOR MEDIUM CUTTING

Dual
DRIVE+

SAC 中鋼炮銑削頭

(SCA TYPE)

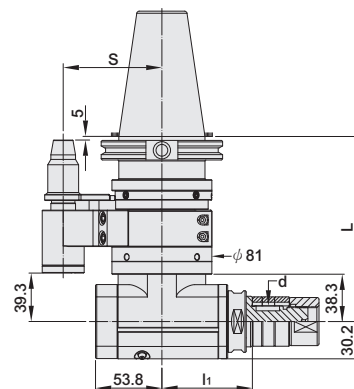

MODEL NO.	TYPE	L	l ₁	d	S	TORQUE	WEIGHT (KGS)
5026-S32-221-130	SBT40 x SAC22SC - 130	130	67.5	22	65	25 N-m	6.40
5026-S32-A641-512	SBT40 x SAC25.4SC - 130	130	67.5	25.4	65	25 N-m	6.40
5027-S32-222-147	SBT50 x SAC22SC - 147	147	67.5	22	80	25 N-m	6.44
5027-S32-A642-579	SBT50 x SAC25.4SC - 147	147	67.5	25.4	80	25 N-m	6.44
5043-S32-221-150	SCAT40 x SAC22SC - 150	150	67.5	22	65	25 N-m	6.40
5043-S32-A641-591	SCAT40 x SAC25.4SC - 150	150	67.5	25.4	65	25 N-m	6.40
5044-S32-222-150	SCAT50 x SAC22SC - 150	150	67.5	22	80	25 N-m	6.44
5044-S32-A642-591	SCAT50 x SAC25.4SC - 150	150	67.5	25.4	80	25 N-m	6.44
5066-S32-221-146	SDAT40 x SAC22SC - 146	146	67.5	22	65	25 N-m	6.40
5066-S32-A641-575	SDAT40 x SAC25.4SC - 146	146	67.5	25.4	65	25 N-m	6.40
5067-S32-222-150	SDAT50 x SAC22SC - 150	150	67.5	22	80	25 N-m	6.44
5067-S32-A642-591	SDAT50 x SAC25.4SC - 150	150	67.5	25.4	80	25 N-m	6.44

Product information:

- ▶ Gear ratio 1:1.
- ▶ Max. revolution: 3000rpm.
- ▶ Suggested $A_p \leq 3\text{mm}$.
- ▶ Internal coolant not available.
- ▶ Rotating direction opposite to machine spindle.
- ▶ Can be used for ATC.



Reminder:

- ▶ Fixed blocks are necessary for installing angle head on the machine.
- ▶ Fixed blocks are varied by different machine designs. Please confirm the detailed dimensions when ordering.

Optional
Fixed Block



P.S-41~43



SAM-HSC ANGLE HEAD HOLDER

HIGH REVOLUTION & HIGH COOLANT PRESSURE TYPE

SAM-HSC 小鋼炮銑削頭 [高轉速高水壓型]

[ER TYPE]

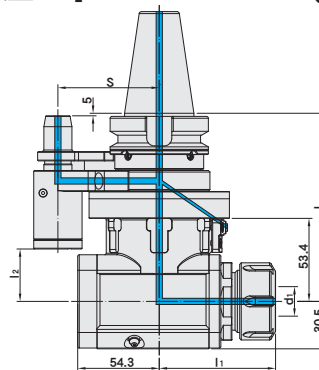

JP PAT NO. 3240336
CN PAT NO. ZL202222671204.0
DE PAT NO. 202022106588

MODEL NO.	TYPE	L	l ₁	l ₂	S	TORQUE	COLLET	SIZE RANGE	WEIGHT (KGS)
5011-636-16A-120	BT40 x SAM16E - 120HSC	120	70	33.7	65	20 N-m	ER16	3 ~ 10	6.40
5011-636-20A-120	BT40 x SAM20E - 120HSC	120	70	33.7	65	20 N-m	ER20	3 ~ 13	6.40
5011-636-25A-120	BT40 x SAM25E - 120HSC	120	70	33.7	65	20 N-m	ER25	3 ~ 16	6.40
5011-636-32A-120	BT40 x SAM32E - 120HSC	120	79.5	33.7	65	20 N-m	ER32	3 ~ 20	6.44
5012-636-16B-135	BT50 x SAM16E - 135HSC	135	70	29	80	20 N-m	ER16	3 ~ 10	8.40
5012-636-20B-135	BT50 x SAM20E - 135HSC	135	70	29	80	20 N-m	ER20	3 ~ 13	8.40
5012-636-25B-135	BT50 x SAM25E - 135HSC	135	70	29	80	20 N-m	ER25	3 ~ 16	8.40
5012-636-32B-135	BT50 x SAM32E - 135HSC	135	79.5	29	80	20 N-m	ER32	3 ~ 20	8.44
5031-636-16A-136	CAT40 x SAM16E - 5.372" HSC	5.372	2.76	1.327	2.559	20 N-m	ER16	3 ~ 10	6.40
5031-636-20A-136	CAT40 x SAM20E - 5.372" HSC	5.372	2.76	1.327	2.559	20 N-m	ER20	3 ~ 13	6.40
5031-636-25A-136	CAT40 x SAM25E - 5.372" HSC	5.372	2.76	1.327	2.559	20 N-m	ER25	3 ~ 16	6.40
5031-636-32A-136	CAT40 x SAM32E - 5.372" HSC	5.372	3.13	1.327	2.559	20 N-m	ER32	3 ~ 20	6.44
5032-636-16B-140	CAT50 x SAM16E - 5.5" HSC	5.5	2.76	1.142	3.145	20 N-m	ER16	3 ~ 10	8.40
5032-636-20B-140	CAT50 x SAM20E - 5.5" HSC	5.5	2.76	1.142	3.145	20 N-m	ER20	3 ~ 13	8.40
5032-636-25B-140	CAT50 x SAM25E - 5.5" HSC	5.5	2.76	1.142	3.145	20 N-m	ER25	3 ~ 16	8.40
5032-636-32B-140	CAT50 x SAM32E - 5.5" HSC	5.5	3.13	1.142	3.145	20 N-m	ER32	3 ~ 20	8.44
5051-636-16A-137	DAT40 x SAM16E - 137HSC	137	70	33.7	65	20 N-m	ER16	3 ~ 10	6.40
5051-636-20A-137	DAT40 x SAM20E - 137HSC	137	70	33.7	65	20 N-m	ER20	3 ~ 13	6.40
5051-636-25A-137	DAT40 x SAM25E - 137HSC	137	70	33.7	65	20 N-m	ER25	3 ~ 16	6.40
5051-636-32A-137	DAT40 x SAM32E - 137HSC	137	79.5	33.7	65	20 N-m	ER32	3 ~ 20	6.44
5052-636-16B-140	DAT50 x SAM16E - 140HSC	140	70	29	80	20 N-m	ER16	3 ~ 10	8.40
5052-636-20B-140	DAT50 x SAM20E - 140HSC	140	70	29	80	20 N-m	ER20	3 ~ 13	8.40
5052-636-25B-140	DAT50 x SAM25E - 140HSC	140	70	29	80	20 N-m	ER25	3 ~ 16	8.40
5052-636-32B-140	DAT50 x SAM32E - 140HSC	140	79.5	29	80	20 N-m	ER32	3 ~ 20	8.44
5073-636-16A-145	HSK63A x SAM16E - 145HSC	145	70	33.7	65	20 N-m	ER16	3 ~ 10	6.40
5073-636-20A-145	HSK63A x SAM20E - 145HSC	145	70	33.7	65	20 N-m	ER20	3 ~ 13	6.40
5073-636-25A-145	HSK63A x SAM25E - 145HSC	145	70	33.7	65	20 N-m	ER25	3 ~ 16	6.40
5073-636-32A-145	HSK63A x SAM32E - 145HSC	145	79.5	33.7	65	20 N-m	ER32	3 ~ 20	6.44
5075-636-16B-150	HSK100A x SAM16E - 150HSC	150	70	29	80	20 N-m	ER16	3 ~ 10	8.40
5075-636-20B-150	HSK100A x SAM20E - 150HSC	150	70	29	80	20 N-m	ER20	3 ~ 13	8.40
5075-636-25B-150	HSK100A x SAM25E - 150HSC	150	70	29	80	20 N-m	ER25	3 ~ 16	8.40
5075-636-32B-150	HSK100A x SAM32E - 150HSC	150	79.5	29	80	20 N-m	ER32	3 ~ 20	8.44

Product information:

- ▶ Gear ratio 1:1. ▶ Max. water pressure: 20bar.
- ▶ Max. revolution: 8000rpm. ▶ Suggested Ap ≤ 2mm.
- ▶ Rotating direction opposite to machine spindle.
- ▶ Can be used for ATC.



Reminder:

- ▶ Fixed blocks are necessary for installing angle head on the machine.
- ▶ Fixed blocks are varied by different machine designs. Please confirm the detailed dimensions when ordering.

Optional
Fixed Block



P.S-41~43



SAM-HSC ANGLE HEAD HOLDER

HIGH REVOLUTION & HIGH COOLANT PRESSURE TYPE



SAM-HSC 小鋼炮銑削頭 [高轉速高水壓型]

[ER TYPE]

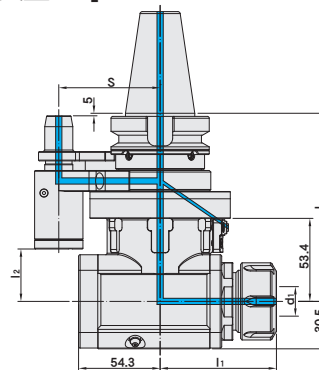

J P PAT NO. 3240336
CN PAT NO. ZL202222671204.0
DE PAT NO. 202022106588

MODEL NO.	TYPE	L	l ₁	l ₂	S	TORQUE	COLLET	SIZE RANGE	WEIGHT (KGS)
5026-636-16A-120	SBT40 x SAM16E - 120HSC	120	70	33.7	65	20 N-m	ER16	3 ~ 10	6.40
5026-636-20A-120	SBT40 x SAM20E - 120HSC	120	70	33.7	65	20 N-m	ER20	3 ~ 13	6.40
5026-636-25A-120	SBT40 x SAM25E - 120HSC	120	70	33.7	65	20 N-m	ER25	3 ~ 16	6.40
5026-636-32A-120	SBT40 x SAM32E - 120HSC	120	79.5	33.7	65	20 N-m	ER32	3 ~ 20	6.44
5027-636-16B-135	SBT50 x SAM16E - 135HSC	135	70	29	80	20 N-m	ER16	3 ~ 10	8.40
5027-636-20B-135	SBT50 x SAM20E - 135HSC	135	70	29	80	20 N-m	ER20	3 ~ 13	8.40
5027-636-25B-135	SBT50 x SAM25E - 135HSC	135	70	29	80	20 N-m	ER25	3 ~ 16	8.40
5027-636-32B-135	SBT50 x SAM32E - 135HSC	135	79.5	29	80	20 N-m	ER32	3 ~ 20	8.44
5043-636-16A-136	SCAT40 x SAM16E - 5.372" HSC	5.372	2.76	1.327	2.559	20 N-m	ER16	3 ~ 10	6.40
5043-636-20A-136	SCAT40 x SAM20E - 5.372" HSC	5.372	2.76	1.327	2.559	20 N-m	ER20	3 ~ 13	6.40
5043-636-25A-136	SCAT40 x SAM25E - 5.372" HSC	5.372	2.76	1.327	2.559	20 N-m	ER25	3 ~ 16	6.40
5043-636-32A-136	SCAT40 x SAM32E - 5.372" HSC	5.372	3.13	1.327	2.559	20 N-m	ER32	3 ~ 20	6.44
5044-636-16B-140	SCAT50 x SAM16E - 5.5" HSC	5.5	2.76	1.142	3.145	20 N-m	ER16	3 ~ 10	8.40
5044-636-20B-140	SCAT50 x SAM20E - 5.5" HSC	5.5	2.76	1.142	3.145	20 N-m	ER20	3 ~ 13	8.40
5044-636-25B-140	SCAT50 x SAM25E - 5.5" HSC	5.5	2.76	1.142	3.145	20 N-m	ER25	3 ~ 16	8.40
5044-636-32B-140	SCAT50 x SAM32E - 5.5" HSC	5.5	3.13	1.142	3.145	20 N-m	ER32	3 ~ 20	8.44
5066-636-16A-137	SDAT40 x SAM16E - 137HSC	137	70	33.7	65	20 N-m	ER16	3 ~ 10	6.40
5066-636-20A-137	SDAT40 x SAM20E - 137HSC	137	70	33.7	65	20 N-m	ER20	3 ~ 13	6.40
5066-636-25A-137	SDAT40 x SAM25E - 137HSC	137	70	33.7	65	20 N-m	ER25	3 ~ 16	6.40
5066-636-32A-137	SDAT40 x SAM32E - 137HSC	137	79.5	33.7	65	20 N-m	ER32	3 ~ 20	6.44
5067-636-16B-140	SDAT50 x SAM16E - 140HSC	140	70	29	80	20 N-m	ER16	3 ~ 10	8.40
5067-636-20B-140	SDAT50 x SAM20E - 140HSC	140	70	29	80	20 N-m	ER20	3 ~ 13	8.40
5067-636-25B-140	SDAT50 x SAM25E - 140HSC	140	70	29	80	20 N-m	ER25	3 ~ 16	8.40
5067-636-32B-140	SDAT50 x SAM32E - 140HSC	140	79.5	29	80	20 N-m	ER32	3 ~ 20	8.44

Product information:

- ▶ Gear ratio 1:1. ▶ Max. water pressure: 20bar.
- ▶ Max. revolution: 8000rpm. ▶ Suggested Ap ≤ 2mm.
- ▶ Rotating direction opposite to machine spindle.
- ▶ Can be used for ATC.



Reminder:

- ▶ Fixed blocks are necessary for installing angle head on the machine.
- ▶ Fixed blocks are varied by different machine designs. Please confirm the detailed dimensions when ordering.

Optional Fixed Block



P.S-41~43



SAM ANGLE HEAD HOLDER

FOR LIGHT CUTTING

SAM 小鋼炮銑削頭

(SK3 TYPE)

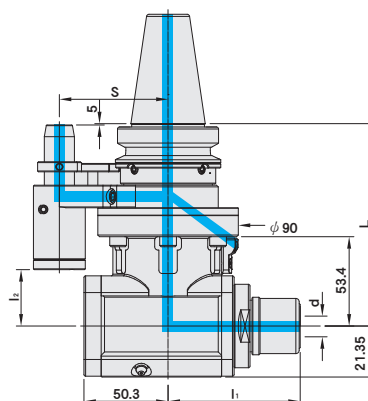

J P PAT NO. 3240336
CN PAT NO. ZL202222671204.0
D E PAT NO. 202022106588

WITH COOLANT SYSTEM

MODEL NO.	TYPE	L	l ₁	l ₂	S	TORQUE	COLLET	d SIZE RANGE	WEIGHT (KGS)
5011-638-101-120	BT40 x SAM10S - 120	120	75	33.7	65	20 N-m	SKX10	3 ~ 10	5.2
5011-638-131-120	BT40 x SAM13S - 120	120	76.5	33.7	65	20 N-m	SKX13	3 ~ 13	5.2
5011-638-161-120	BT40 x SAM16S - 120	120	82.8	33.7	65	20 N-m	SKX16	3 ~ 16	5.2
5012-638-102-135	BT50 x SAM10S - 135	135	75	29	80	20 N-m	SKX10	3 ~ 10	6.3
5012-638-132-135	BT50 x SAM13S - 135	135	76.5	29	80	20 N-m	SKX13	3 ~ 13	6.3
5012-638-162-135	BT50 x SAM16S - 135	135	82.8	29	80	20 N-m	SKX16	3 ~ 16	6.3
5031-638-101-136	CAT40 x SAM10S - 5.372"	5.372	2.953	1.327	2.559	20 N-m	SKX10	3 ~ 10	5.2
5031-638-131-136	CAT40 x SAM13S - 5.372"	5.372	3.012	1.327	2.559	20 N-m	SKX13	3 ~ 13	5.2
5031-638-161-136	CAT40 x SAM16S - 5.372"	5.372	3.26	1.327	2.559	20 N-m	SKX16	3 ~ 16	5.2
5032-638-102-140	CAT50 x SAM10S - 5.5"	5.5	2.953	1.142	3.145	20 N-m	SKX10	3 ~ 10	6.3
5032-638-132-140	CAT50 x SAM13S - 5.5"	5.5	3.012	1.142	3.145	20 N-m	SKX13	3 ~ 13	6.3
5032-638-162-140	CAT50 x SAM16S - 5.5"	5.5	3.26	1.142	3.145	20 N-m	SKX16	3 ~ 16	6.3
5051-638-101-137	DAT40 x SAM10S - 137	137	75	33.7	65	20 N-m	SKX10	3 ~ 10	5.2
5051-638-131-137	DAT40 x SAM13S - 137	137	76.5	33.7	65	20 N-m	SKX13	3 ~ 13	5.2
5051-638-161-137	DAT40 x SAM16S - 137	137	82.8	33.7	65	20 N-m	SKX16	3 ~ 16	5.2
5052-638-102-140	DAT50 x SAM10S - 140	140	75	29	80	20 N-m	SKX10	3 ~ 10	6.3
5052-638-132-140	DAT50 x SAM13S - 140	140	76.5	29	80	20 N-m	SKX13	3 ~ 13	6.3
5052-638-162-140	DAT50 x SAM16S - 140	140	82.8	29	80	20 N-m	SKX16	3 ~ 16	6.3
5073-638-101-145	HSK63A x SAM10S - 145	145	75	33.7	65	20 N-m	SKX10	3 ~ 10	5.2
5073-638-131-145	HSK63A x SAM13S - 145	145	76.5	33.7	65	20 N-m	SKX13	3 ~ 13	5.2
5073-638-161-145	HSK63A x SAM16S - 145	145	82.8	33.7	65	20 N-m	SKX16	3 ~ 16	5.2
5075-638-102-150	HSK100A x SAM10S - 150	150	75	29	80	20 N-m	SKX10	3 ~ 10	6.3
5075-638-132-150	HSK100A x SAM13S - 150	150	76.5	29	80	20 N-m	SKX13	3 ~ 13	6.3
5075-638-162-150	HSK100A x SAM16S - 150	150	82.8	29	80	20 N-m	SKX16	3 ~ 16	6.3

Product information: ▶ Gear ratio 1:1. ▶ Max. revolution: 4000rpm. ▶ Suggested $A_p \leq 2\text{mm}$. ▶ Can be used for ATC.
▶ Coolant feed through spindle or dowel pin, coolant outlet from cutting tools or coolant nozzle. ▶ Max. water pressure: $7\text{kgf/cm}^2(100\text{PSI})$.
▶ Rotating direction opposite to machine spindle.



Reminder:

- ▶ Fixed blocks are necessary for installing angle head on the machine.
- ▶ Fixed blocks are varied by different machine designs. Please confirm the detailed dimensions when ordering.

**Optional
Fixed Block**



P.S-41~43



SAM ANGLE HEAD HOLDER

FOR LIGHT CUTTING

Dual
DRIVE+

SAM 小鋼炮銑削頭

(SK3 TYPE)



J P PAT NO. 3240336
CN PAT NO. ZL202222671204.0
DE PAT NO. 202022106588

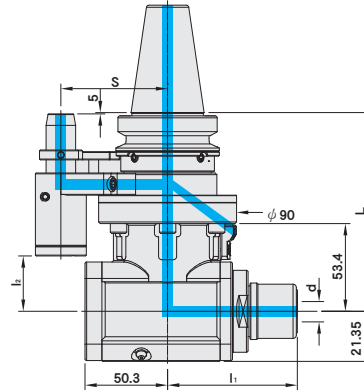

台灣精品 2009
TAIWAN EXCELLENCE

WITH COOLANT SYSTEM

MODEL NO.	TYPE	L	l ₁	l ₂	S	TORQUE	COLLET	d SIZE RANGE	WEIGHT (KGS)
5026-638-101-120	SBT40 x SAM10S - 120	120	75	33.7	65	20 N-m	SKX10	3 ~ 10	5.2
5026-638-131-120	SBT40 x SAM13S - 120	120	76.5	33.7	65	20 N-m	SKX13	3 ~ 13	5.2
5026-638-161-120	SBT40 x SAM16S - 120	120	82.8	33.7	65	20 N-m	SKX16	3 ~ 16	5.2
5027-638-102-135	SBT50 x SAM10S - 135	135	75	29	80	20 N-m	SKX10	3 ~ 10	6.3
5027-638-132-135	SBT50 x SAM13S - 135	135	76.5	29	80	20 N-m	SKX13	3 ~ 13	6.3
5027-638-162-135	SBT50 x SAM16S - 135	135	82.8	29	80	20 N-m	SKX16	3 ~ 16	6.3
5043-638-101-136	SCAT40 x SAM10S - 5.372"	5.372	2.953	1.327	2.559	20 N-m	SKX10	3 ~ 10	5.2
5043-638-131-136	SCAT40 x SAM13S - 5.372"	5.372	3.012	1.327	2.559	20 N-m	SKX13	3 ~ 13	5.2
5043-638-161-136	SCAT40 x SAM16S - 5.372"	5.372	3.26	1.327	2.559	20 N-m	SKX16	3 ~ 16	5.2
5044-638-102-140	SCAT50 x SAM10S - 5.5"	5.5	2.953	1.142	3.145	20 N-m	SKX10	3 ~ 10	6.3
5044-638-132-140	SCAT50 x SAM13S - 5.5"	5.5	3.012	1.142	3.145	20 N-m	SKX13	3 ~ 13	6.3
5044-638-162-140	SCAT50 x SAM16S - 5.5"	5.5	3.26	1.142	3.145	20 N-m	SKX16	3 ~ 16	6.3
5066-638-101-137	SDAT40 x SAM10S - 137	137	75	33.7	65	20 N-m	SKX10	3 ~ 10	5.2
5066-638-131-137	SDAT40 x SAM13S - 137	137	76.5	33.7	65	20 N-m	SKX13	3 ~ 13	5.2
5066-638-161-137	SDAT40 x SAM16S - 137	137	82.8	33.7	65	20 N-m	SKX16	3 ~ 16	5.2
5067-638-102-140	SDAT50 x SAM10S - 140	140	75	29	80	20 N-m	SKX10	3 ~ 10	6.3
5067-638-132-140	SDAT50 x SAM13S - 140	140	76.5	29	80	20 N-m	SKX13	3 ~ 13	6.3
5067-638-162-140	SDAT50 x SAM16S - 140	140	82.8	29	80	20 N-m	SKX16	3 ~ 16	6.3

Product information:

- ▶ Gear ratio 1:1.
- ▶ Max. revolution: 4000rpm.
- ▶ Suggested $A_p \leq 2\text{mm}$.
- ▶ Coolant feed through spindle or dowel pin, coolant outlet from cutting tools or coolant nozzle.
- ▶ Max. water pressure: $7\text{kgf/cm}^2(100\text{PSI})$.
- ▶ Rotating direction opposite to machine spindle.
- ▶ Can be used for ATC.



Reminder:

- ▶ Fixed blocks are necessary for installing angle head on the machine.
- ▶ Fixed blocks are varied by different machine designs. Please confirm the detailed dimensions when ordering.

Optional
Fixed Block



P.S-41~43



SAM ANGLE HEAD HOLDER

FOR LIGHT CUTTING

SAM 小鋼炮銑削頭

{SK3 TYPE}

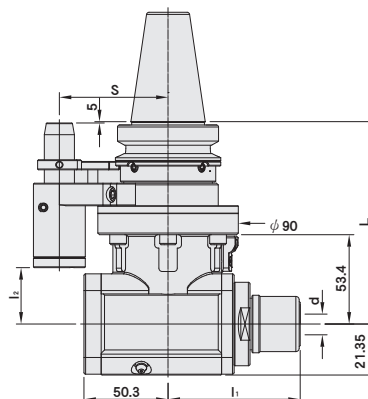

J P PAT NO. 3240336
 CN PAT NO. ZL202222671204.0
 DE PAT NO. 202022106588

WITHOUT COOLANT SYSTEM

MODEL NO.	TYPE	L	l ₁	l ₂	S	TORQUE	COLLET	SIZE RANGE	WEIGHT (KGS)
5011-721-101-120	BT40 x SAM10SX - 120	120	75	33.7	65	20 N-m	SKX10	3 ~ 10	5.2
5011-721-131-120	BT40 x SAM13SX - 120	120	76.5	33.7	65	20 N-m	SKX13	3 ~ 13	5.2
5011-721-161-120	BT40 x SAM16SX - 120	120	82.8	33.7	65	20 N-m	SKX16	3 ~ 16	5.2
5012-721-102-135	BT50 x SAM10SX - 135	135	75	29	80	20 N-m	SKX10	3 ~ 10	6.3
5012-721-132-135	BT50 x SAM13SX - 135	135	76.5	29	80	20 N-m	SKX13	3 ~ 13	6.3
5012-721-162-135	BT50 x SAM16SX - 135	135	82.8	29	80	20 N-m	SKX16	3 ~ 16	6.3
5031-721-101-136	CAT40 x SAM10SX - 5.372"	5.372	2.953	1.327	2.559	20 N-m	SKX10	3 ~ 10	5.2
5031-721-131-136	CAT40 x SAM13SX - 5.372"	5.372	3.012	1.327	2.559	20 N-m	SKX13	3 ~ 13	5.2
5031-721-161-136	CAT40 x SAM16SX - 5.372"	5.372	3.26	1.327	2.559	20 N-m	SKX16	3 ~ 16	5.2
5032-721-102-140	CAT50 x SAM10SX - 5.5"	5.5	2.953	1.142	3.145	20 N-m	SKX10	3 ~ 10	6.3
5032-721-132-140	CAT50 x SAM13SX - 5.5"	5.5	3.012	1.142	3.145	20 N-m	SKX13	3 ~ 13	6.3
5032-721-162-140	CAT50 x SAM16SX - 5.5"	5.5	3.26	1.142	3.145	20 N-m	SKX16	3 ~ 16	6.3
5051-721-101-137	DAT40 x SAM10SX - 137	137	75	33.7	65	20 N-m	SKX10	3 ~ 10	5.2
5051-721-131-137	DAT40 x SAM13SX - 137	137	76.5	33.7	65	20 N-m	SKX13	3 ~ 13	5.2
5051-721-161-137	DAT40 x SAM16SX - 137	137	82.8	33.7	65	20 N-m	SKX16	3 ~ 16	5.2
5052-721-102-140	DAT50 x SAM10SX - 140	140	75	29	80	20 N-m	SKX10	3 ~ 10	6.3
5052-721-132-140	DAT50 x SAM13SX - 140	140	76.5	29	80	20 N-m	SKX13	3 ~ 13	6.3
5052-721-162-140	DAT50 x SAM16SX - 140	140	82.8	29	80	20 N-m	SKX16	3 ~ 16	6.3
5073-721-101-145	HSK63A x SAM10SX - 145	145	75	33.7	65	20 N-m	SKX10	3 ~ 10	5.2
5073-721-131-145	HSK63A x SAM13SX - 145	145	76.5	33.7	65	20 N-m	SKX13	3 ~ 13	5.2
5073-721-161-145	HSK63A x SAM16SX - 145	145	82.8	33.7	65	20 N-m	SKX16	3 ~ 16	5.2
5075-721-102-150	HSK100A x SAM10SX - 150	150	75	29	80	20 N-m	SKX10	3 ~ 10	6.3
5075-721-132-150	HSK100A x SAM13SX - 150	150	76.5	29	80	20 N-m	SKX13	3 ~ 13	6.3
5075-721-162-150	HSK100A x SAM16SX - 150	150	82.8	29	80	20 N-m	SKX16	3 ~ 16	6.3

Product information:

- ▶ Gear ratio 1:1.
- ▶ Max. revolution: 4000rpm.
- ▶ Suggested Ap ≤ 2mm.
- ▶ Rotating direction opposite to machine spindle.
- ▶ Can be used for ATC.



Reminder:

- ▶ Fixed blocks are necessary for installing angle head on the machine [P.5-37~38].
- ▶ Fixed blocks are varied by different machine designs. Please confirm the detailed dimensions when ordering.

Optional
Fixed Block



P.5-41~43



SAM ANGLE HEAD HOLDER

FOR LIGHT CUTTING

Dual
DRIVE+

SAM 小鋼炮銑削頭

(SK3 TYPE)



J P PAT NO. 3240336
CN PAT NO. ZL202222671204.0
D E PAT NO. 202022106588

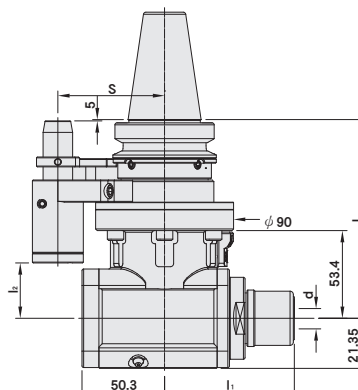

WITHOUT COOLANT SYSTEM

MODEL NO.	TYPE	L	l ₁	l ₂	S	TORQUE	COLLET	d SIZE RANGE	WEIGHT (KGS)
5026-721-101-120	SBT40 x SAM10SX - 120	120	75	33.7	65	20 N-m	SKX10	3 ~ 10	6.4
5026-721-131-120	SBT40 x SAM13SX - 120	120	76.5	33.7	65	20 N-m	SKX13	3 ~ 13	6.4
5026-721-161-120	SBT40 x SAM16SX - 120	120	82.8	33.7	65	20 N-m	SKX16	3 ~ 16	6.4
5027-721-102-135	SBT50 x SAM10SX - 135	135	75	29	80	20 N-m	SKX10	3 ~ 10	8.4
5027-721-132-135	SBT50 x SAM13SX - 135	135	76.5	29	80	20 N-m	SKX13	3 ~ 13	8.4
5027-721-162-135	SBT50 x SAM16SX - 135	135	82.8	29	80	20 N-m	SKX16	3 ~ 16	8.4
5043-721-101-136	SCAT40 x SAM10SX - 5.372"	5.372	2.953	1.327	2.559	20 N-m	SKX10	3 ~ 10	6.4
5043-721-131-136	SCAT40 x SAM13SX - 5.372"	5.372	3.012	1.327	2.559	20 N-m	SKX13	3 ~ 13	6.4
5043-721-161-136	SCAT40 x SAM16SX - 5.372"	5.372	3.26	1.327	2.559	20 N-m	SKX16	3 ~ 16	6.4
5044-721-102-140	SCAT50 x SAM10SX - 5.5"	5.5	2.953	1.142	3.145	20 N-m	SKX10	3 ~ 10	8.4
5044-721-132-140	SCAT50 x SAM13SX - 5.5"	5.5	3.012	1.142	3.145	20 N-m	SKX13	3 ~ 13	8.4
5044-721-162-140	SCAT50 x SAM16SX - 5.5"	5.5	3.26	1.142	3.145	20 N-m	SKX16	3 ~ 16	8.4
5066-721-101-137	SDAT40 x SAM10SX - 137	137	75	33.7	65	20 N-m	SKX10	3 ~ 10	6.4
5066-721-131-137	SDAT40 x SAM13SX - 137	137	76.5	33.7	65	20 N-m	SKX13	3 ~ 13	6.4
5066-721-161-137	SDAT40 x SAM16SX - 137	137	82.8	33.7	65	20 N-m	SKX16	3 ~ 16	6.4
5067-721-102-140	SDAT50 x SAM10SX - 140	140	75	29	80	20 N-m	SKX10	3 ~ 10	8.4
5067-721-132-140	SDAT50 x SAM13SX - 140	140	76.5	29	80	20 N-m	SKX13	3 ~ 13	8.4
5067-721-162-140	SDAT50 x SAM16SX - 140	140	82.8	29	80	20 N-m	SKX16	3 ~ 16	8.4

Product information:

- ▶ Gear ratio 1:1.
- ▶ Max. revolution: 4000rpm.
- ▶ Suggested $A_p \leq 2\text{mm}$.
- ▶ Internal coolant not available.
- ▶ Rotating direction opposite to machine spindle.
- ▶ Can be used for ATC.



Reminder:

- ▶ Fixed blocks are necessary for installing angle head on the machine [P.5-37~38].
- ▶ Fixed blocks are varied by different machine designs. Please confirm the detailed dimensions when ordering.

Optional
Fixed Block



P.5-41~43



SAM ANGLE HEAD HOLDER

FOR LIGHT CUTTING

Dual
DRIVE+

SAM 小鋼炮銑削頭

[PRO-E TYPE]

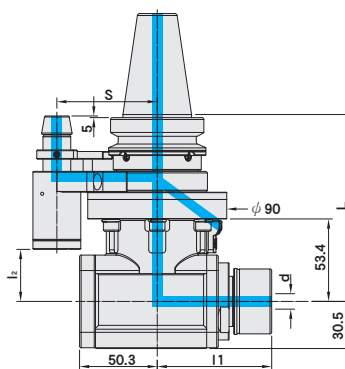

J P PAT NO. 3240336
CN PAT NO. ZL202222671204.0
D E PAT NO. 202022106588

WITH COOLANT SYSTEM

MODEL NO.	TYPE	L	l ₁	l ₂	S	TORQUE	COLLET	SIZE RANGE ^d	WEIGHT (KGS)
5026-634-161-120	SBT40 x SAM16P - 120	120	71	33.7	65	20 N-m	ER16	1 ~ 10	6.40
5026-634-201-120	SBT40 x SAM20P - 120	120	73	33.7	65	20 N-m	ER20	1 ~ 13	6.40
5026-634-251-120	SBT40 x SAM25P - 120	120	74	33.7	65	20 N-m	ER25	1 ~ 16	6.40
5026-634-321-120	SBT40 x SAM32P - 120	120	76	33.7	65	20 N-m	ER32	2 ~ 20	6.44
5027-634-162-135	SBT50 x SAM16P - 135	135	71	29	80	20 N-m	ER16	1 ~ 10	8.40
5027-634-202-135	SBT50 x SAM20P - 135	135	73	29	80	20 N-m	ER20	1 ~ 13	8.40
5027-634-252-135	SBT50 x SAM25P - 135	135	74	29	80	20 N-m	ER25	1 ~ 16	8.40
5027-634-322-135	SBT50 x SAM32P - 135	135	76	29	80	20 N-m	ER32	2 ~ 20	8.44

Product information:

- ▶ Gear ratio 1:1.
- ▶ Max. revolution: 4000rpm.
- ▶ Suggested $A_p \leq 2\text{mm}$.
- ▶ Coolant feed through spindle or dowel pin, coolant outlet from cutting tools or coolant nozzle.
- ▶ Max. water pressure: $7\text{kgf/cm}^2(100\text{PSI})$.
- ▶ Rotating direction opposite to machine spindle.
- ▶ Can be used for ATC.



Reminder:

- ▶ Fixed blocks are necessary for installing angle head on the machine.
- ▶ Fixed blocks are varied by different machine designs. Please confirm the detailed dimensions when ordering.

Optional
Fixed Block



P.S-41~43



SAM ANGLE HEAD HOLDER

FOR LIGHT CUTTING

SAM 小鋼炮銑削頭

(ER TYPE)



J P PAT NO. 3240336
CN PAT NO. ZL202222671204.0
D E PAT NO. 202022106588

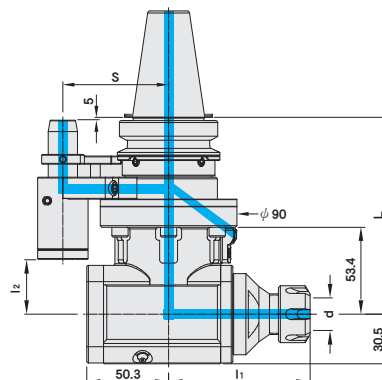

WITH COOLANT SYSTEM

MODEL NO.	TYPE	L	l ₁	l ₂	S	TORQUE	COLLET	SIZE RANGE	WEIGHT (KGS)
5011-636-161-120	BT40 x SAM16E - 120	120	84.5	33.7	65	20 N-m	ER16	3 ~ 10	6.40
5011-636-201-120	BT40 x SAM20E - 120	120	84.5	33.7	65	20 N-m	ER20	3 ~ 13	6.40
5011-636-251-120	BT40 x SAM25E - 120	120	84.5	33.7	65	20 N-m	ER25	3 ~ 16	6.40
5011-636-321-120	BT40 x SAM32E - 120	120	79.5	33.7	65	20 N-m	ER32	3 ~ 20	6.44
5012-636-162-135	BT50 x SAM16E - 135	135	84.5	29	80	20 N-m	ER16	3 ~ 10	8.40
5012-636-202-135	BT50 x SAM20E - 135	135	84.5	29	80	20 N-m	ER20	3 ~ 13	8.40
5012-636-252-135	BT50 x SAM25E - 135	135	84.5	29	80	20 N-m	ER25	3 ~ 16	8.40
5012-636-322-135	BT50 x SAM32E - 135	135	79.5	29	80	20 N-m	ER32	3 ~ 20	8.44
5031-636-161-136	CAT40 x SAM16E - 5.372"	5.372	3.327	1.327	2.559	20 N-m	ER16	3 ~ 10	6.40
5031-636-201-136	CAT40 x SAM20E - 5.372"	5.372	3.327	1.327	2.559	20 N-m	ER20	3 ~ 13	6.40
5031-636-251-136	CAT40 x SAM25E - 5.372"	5.372	3.327	1.327	2.559	20 N-m	ER25	3 ~ 16	6.40
5031-636-321-136	CAT40 x SAM32E - 5.372"	5.372	3.130	1.327	2.559	20 N-m	ER32	3 ~ 20	6.44
5032-636-162-140	CAT50 x SAM16E - 5.5"	5.5	3.327	1.142	3.145	20 N-m	ER16	3 ~ 10	8.40
5032-636-202-140	CAT50 x SAM20E - 5.5"	5.5	3.327	1.142	3.145	20 N-m	ER20	3 ~ 13	8.40
5032-636-252-140	CAT50 x SAM25E - 5.5"	5.5	3.327	1.142	3.145	20 N-m	ER25	3 ~ 16	8.40
5032-636-322-140	CAT50 x SAM32E - 5.5"	5.5	3.130	1.142	3.145	20 N-m	ER32	3 ~ 20	8.44
5051-636-161-137	DAT40 x SAM16E - 137	137	84.5	33.7	65	20 N-m	ER16	3 ~ 10	6.40
5051-636-201-137	DAT40 x SAM20E - 137	137	84.5	33.7	65	20 N-m	ER20	3 ~ 13	6.40
5051-636-251-137	DAT40 x SAM25E - 137	137	84.5	33.7	65	20 N-m	ER25	3 ~ 16	6.40
5051-636-321-137	DAT40 x SAM32E - 137	137	79.5	33.7	65	20 N-m	ER32	3 ~ 20	6.44
5052-636-162-140	DAT50 x SAM16E - 140	140	84.5	29	80	20 N-m	ER16	3 ~ 10	8.40
5052-636-202-140	DAT50 x SAM20E - 140	140	84.5	29	80	20 N-m	ER20	3 ~ 13	8.40
5052-636-252-140	DAT50 x SAM25E - 140	140	84.5	29	80	20 N-m	ER25	3 ~ 16	8.40
5052-636-322-140	DAT50 x SAM32E - 140	140	79.5	29	80	20 N-m	ER32	3 ~ 20	8.44
5073-636-161-145	HSK63A x SAM16E - 145	145	84.5	33.7	65	20 N-m	ER16	3 ~ 10	6.40
5073-636-201-145	HSK63A x SAM20E - 145	145	84.5	33.7	65	20 N-m	ER20	3 ~ 13	6.40
5073-636-251-145	HSK63A x SAM25E - 145	145	84.5	33.7	65	20 N-m	ER25	3 ~ 16	6.40
5073-636-321-145	HSK63A x SAM32E - 145	145	79.5	33.7	65	20 N-m	ER32	3 ~ 20	6.44
5075-636-162-150	HSK100A x SAM16E - 150	150	84.5	29	80	20 N-m	ER16	3 ~ 10	8.40
5075-636-202-150	HSK100A x SAM20E - 150	150	84.5	29	80	20 N-m	ER20	3 ~ 13	8.40
5075-636-252-150	HSK100A x SAM25E - 150	150	84.5	29	80	20 N-m	ER25	3 ~ 16	8.40
5075-636-322-150	HSK100A x SAM32E - 150	150	79.5	29	80	20 N-m	ER32	3 ~ 20	8.44

Product information: ▶ Gear ratio 1:1. ▶ Max. revolution: 4000rpm. ▶ Suggested Ap ≤ 2mm.

▶ Coolant feed through spindle or dowel pin, coolant outlet from cutting tools or coolant nozzle.

▶ Max. water pressure: 7kgf/cm²(100PSI).

▶ Rotating direction opposite to machine spindle.

▶ Can be used for ATC.



Reminder:

▶ Fixed blocks are necessary for installing angle head on the machine.

▶ Fixed blocks are varied by different machine designs. Please confirm the detailed dimensions when ordering.

Optional
Fixed Block



P.S-41~43



SAM ANGLE HEAD HOLDER

FOR LIGHT CUTTING



SAM 小鋼炮銑削頭

(ER TYPE)

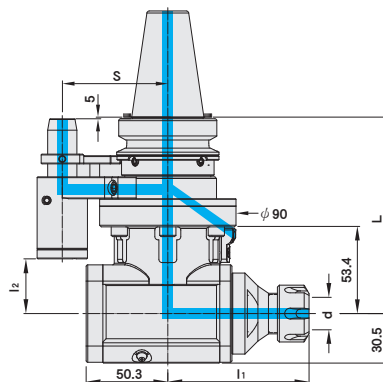

J P PAT NO. 3240336
CN PAT NO. ZL202222671204.0
DE PAT NO. 202022106588

WITH COOLANT SYSTEM

MODEL NO.	TYPE	L	l ₁	l ₂	S	TORQUE	COLLET	SIZE RANGE	WEIGHT (KGS)
5026-636-161-120	SBT40 x SAM16E - 120	120	84.5	33.7	65	20 N-m	ER16	3 ~ 10	6.40
5026-636-201-120	SBT40 x SAM20E - 120	120	84.5	33.7	65	20 N-m	ER20	3 ~ 13	6.40
5026-636-251-120	SBT40 x SAM25E - 120	120	84.5	33.7	65	20 N-m	ER25	3 ~ 16	6.40
5026-636-321-120	SBT40 x SAM32E - 120	120	79.5	33.7	65	20 N-m	ER32	3 ~ 20	6.44
5027-636-162-135	SBT50 x SAM16E - 135	135	84.5	29	80	20 N-m	ER16	3 ~ 10	8.40
5027-636-202-135	SBT50 x SAM20E - 135	135	84.5	29	80	20 N-m	ER20	3 ~ 13	8.40
5027-636-252-135	SBT50 x SAM25E - 135	135	84.5	29	80	20 N-m	ER25	3 ~ 16	8.40
5027-636-322-135	SBT50 x SAM32E - 135	135	79.5	29	80	20 N-m	ER32	3 ~ 20	8.44
5043-636-161-136	SCAT40 x SAM16E - 5.372"	5.372	3.327	1.327	2.559	20 N-m	ER16	3 ~ 10	6.40
5043-636-201-136	SCAT40 x SAM20E - 5.372"	5.372	3.327	1.327	2.559	20 N-m	ER20	3 ~ 13	6.40
5043-636-251-136	SCAT40 x SAM25E - 5.372"	5.372	3.327	1.327	2.559	20 N-m	ER25	3 ~ 16	6.40
5043-636-321-136	SCAT40 x SAM32E - 5.372"	5.372	3.130	1.327	2.559	20 N-m	ER32	3 ~ 20	6.44
5044-636-162-140	SCAT50 x SAM16E - 5.5"	5.5	3.327	1.142	3.145	20 N-m	ER16	3 ~ 10	8.40
5044-636-202-140	SCAT50 x SAM20E - 5.5"	5.5	3.327	1.142	3.145	20 N-m	ER20	3 ~ 13	8.40
5044-636-252-140	SCAT50 x SAM25E - 5.5"	5.5	3.327	1.142	3.145	20 N-m	ER25	3 ~ 16	8.40
5044-636-322-140	SCAT50 x SAM32E - 5.5"	5.5	3.130	1.142	3.145	20 N-m	ER32	3 ~ 20	8.44
5066-636-161-137	SDAT40 x SAM16E - 137	137	84.5	33.7	65	20 N-m	ER16	3 ~ 10	6.40
5066-636-201-137	SDAT40 x SAM20E - 137	137	84.5	33.7	65	20 N-m	ER20	3 ~ 13	6.40
5066-636-251-137	SDAT40 x SAM25E - 137	137	84.5	33.7	65	20 N-m	ER25	3 ~ 16	6.40
5066-636-321-137	SDAT40 x SAM32E - 137	137	79.5	33.7	65	20 N-m	ER32	3 ~ 20	6.44
5067-636-162-140	SDAT50 x SAM16E - 140	140	84.5	29	80	20 N-m	ER16	3 ~ 10	8.40
5067-636-202-140	SDAT50 x SAM20E - 140	140	84.5	29	80	20 N-m	ER20	3 ~ 13	8.40
5067-636-252-140	SDAT50 x SAM25E - 140	140	84.5	29	80	20 N-m	ER25	3 ~ 16	8.40
5067-636-322-140	SDAT50 x SAM32E - 140	140	79.5	29	80	20 N-m	ER32	3 ~ 20	8.44

Product information:

- ▶ Gear ratio 1:1.
- ▶ Max. revolution: 4000rpm.
- ▶ Suggested $A_p \leq 2\text{mm}$.
- ▶ Coolant feed through spindle or dowel pin, coolant outlet from cutting tools or coolant nozzle.
- ▶ Max. water pressure: $7\text{kgf/cm}^2(100\text{PSI})$.
- ▶ Rotating direction opposite to machine spindle.
- ▶ Can be used for ATC.



Reminder:

- ▶ Fixed blocks are necessary for installing angle head on the machine.
- ▶ Fixed blocks are varied by different machine designs. Please confirm the detailed dimensions when ordering.

Optional Fixed Block



P.S-41~43



SAM ANGLE HEAD HOLDER FOR LIGHT CUTTING

SAM 小鋼炮銑削頭

(ER TYPE)



J P PAT NO. 3240336
CN PAT NO. ZL202222671204.0
DE PAT NO. 202022106588

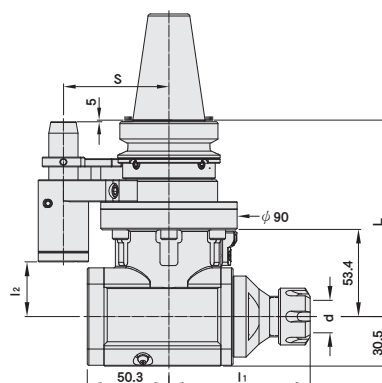

WITHOUT COOLANT SYSTEM

MODEL NO.	TYPE	L	l ₁	l ₂	S	TORQUE	COLLET	SIZE d RANGE	WEIGHT (KGS)
5011-679-161-120	BT40 x SAM16EX - 120	120	84.5	33.7	65	20 N-m	ER16	3 ~ 10	6.40
5011-679-201-120	BT40 x SAM20EX - 120	120	84.5	33.7	65	20 N-m	ER20	3 ~ 13	6.40
5011-679-251-120	BT40 x SAM25EX - 120	120	84.5	33.7	65	20 N-m	ER25	3 ~ 16	6.40
5011-679-321-120	BT40 x SAM32EX - 120	120	79.5	33.7	65	20 N-m	ER32	3 ~ 20	6.44
5012-679-162-135	BT50 x SAM16EX - 135	135	84.5	29	80	20 N-m	ER16	3 ~ 10	8.40
5012-679-202-135	BT50 x SAM20EX - 135	135	84.5	29	80	20 N-m	ER20	3 ~ 13	8.40
5012-679-252-135	BT50 x SAM25EX - 135	135	84.5	29	80	20 N-m	ER25	3 ~ 16	8.40
5012-679-322-135	BT50 x SAM32EX - 135	135	79.5	29	80	20 N-m	ER32	3 ~ 20	8.44
5031-679-161-136	CAT40 x SAM16EX - 5.372"	5.372	3.327	1.327	2.559	20 N-m	ER16	3 ~ 10	6.40
5031-679-201-136	CAT40 x SAM20EX - 5.372"	5.372	3.327	1.327	2.559	20 N-m	ER20	3 ~ 13	6.40
5031-679-251-136	CAT40 x SAM25EX - 5.372"	5.372	3.327	1.327	2.559	20 N-m	ER25	3 ~ 16	6.40
5031-679-321-136	CAT40 x SAM32EX - 5.372"	5.372	3.130	1.327	2.559	20 N-m	ER32	3 ~ 20	6.44
5032-679-162-140	CAT50 x SAM16EX - 5.5"	5.5	3.327	1.142	3.145	20 N-m	ER16	3 ~ 10	8.40
5032-679-202-140	CAT50 x SAM20EX - 5.5"	5.5	3.327	1.142	3.145	20 N-m	ER20	3 ~ 13	8.40
5032-679-252-140	CAT50 x SAM25EX - 5.5"	5.5	3.327	1.142	3.145	20 N-m	ER25	3 ~ 16	8.40
5032-679-322-140	CAT50 x SAM32EX - 5.5"	5.5	3.130	1.142	3.145	20 N-m	ER32	3 ~ 20	8.44
5051-679-161-137	DAT40 x SAM16EX - 137	137	84.5	33.7	65	20 N-m	ER16	3 ~ 10	6.40
5051-679-201-137	DAT40 x SAM20EX - 137	137	84.5	33.7	65	20 N-m	ER20	3 ~ 13	6.40
5051-679-251-137	DAT40 x SAM25EX - 137	137	84.5	33.7	65	20 N-m	ER25	3 ~ 16	6.40
5051-679-321-137	DAT40 x SAM32EX - 137	137	79.5	33.7	65	20 N-m	ER32	3 ~ 20	6.44
5052-679-162-140	DAT50 x SAM16EX - 140	140	84.5	29	80	20 N-m	ER16	3 ~ 10	8.40
5052-679-202-140	DAT50 x SAM20EX - 140	140	84.5	29	80	20 N-m	ER20	3 ~ 13	8.40
5052-679-252-140	DAT50 x SAM25EX - 140	140	84.5	29	80	20 N-m	ER25	3 ~ 16	8.40
5052-679-322-140	DAT50 x SAM32EX - 140	140	79.5	29	80	20 N-m	ER32	3 ~ 20	8.44
5073-679-161-145	HSK63A x SAM16EX - 145	145	84.5	33.7	65	20 N-m	ER16	3 ~ 10	6.40
5073-679-201-145	HSK63A x SAM20EX - 145	145	84.5	33.7	65	20 N-m	ER20	3 ~ 13	6.40
5073-679-251-145	HSK63A x SAM25EX - 145	145	84.5	33.7	65	20 N-m	ER25	3 ~ 16	6.40
5073-679-321-145	HSK63A x SAM32EX - 145	145	79.5	33.7	65	20 N-m	ER32	3 ~ 20	6.44
5075-679-162-150	HSK100A x SAM16EX - 150	150	84.5	29	80	20 N-m	ER16	3 ~ 10	8.40
5075-679-202-150	HSK100A x SAM20EX - 150	150	84.5	29	80	20 N-m	ER20	3 ~ 13	8.40
5075-679-252-150	HSK100A x SAM25EX - 150	150	84.5	29	80	20 N-m	ER25	3 ~ 16	8.40
5075-679-322-150	HSK100A x SAM32EX - 150	150	79.5	29	80	20 N-m	ER32	3 ~ 20	8.44

Product information: ▶ Gear ratio 1:1. ▶ Max. revolution: 4000rpm. ▶ Suggested $A_p \leq 2$ mm.

▶ Rotating direction opposite to machine spindle.

▶ Can be used for ATC.



Reminder:

▶ Fixed blocks are necessary for installing angle head on the machine [P.5-37~38].

▶ Fixed blocks are varied by different machine designs. Please confirm the detailed dimensions when ordering.

Optional
Fixed Block



P.5-41~43



SAM ANGLE HEAD HOLDER FOR LIGHT CUTTING



SAM 小鋼炮銑削頭

(ER TYPE)



J P PAT NO. 3240336
CN PAT NO. ZL202222671204.0
DE PAT NO. 202022106588

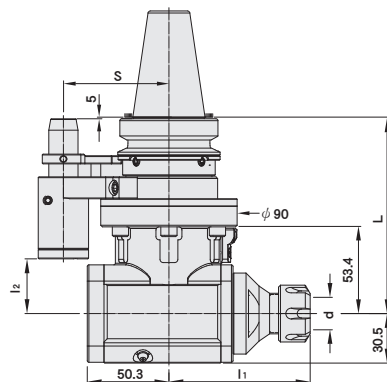

WITHOUT COOLANT SYSTEM

MODEL NO.	TYPE	L	l ₁	l ₂	S	TORQUE	COLLET	SIZE RANGE	WEIGHT (KGS)
5026-679-161-120	SBT40 x SAM16EX - 120	120	84.5	33.7	65	20 N-m	ER16	3 ~ 10	6.40
5026-679-201-120	SBT40 x SAM20EX - 120	120	84.5	33.7	65	20 N-m	ER20	3 ~ 13	6.40
5026-679-251-120	SBT40 x SAM25EX - 120	120	84.5	33.7	65	20 N-m	ER25	3 ~ 16	6.40
5026-679-321-120	SBT40 x SAM32EX - 120	120	79.5	33.7	65	20 N-m	ER32	3 ~ 20	6.44
5027-679-162-135	SBT50 x SAM16EX - 135	135	84.5	29	80	20 N-m	ER16	3 ~ 10	8.40
5027-679-202-135	SBT50 x SAM20EX - 135	135	84.5	29	80	20 N-m	ER20	3 ~ 13	8.40
5027-679-252-135	SBT50 x SAM25EX - 135	135	84.5	29	80	20 N-m	ER25	3 ~ 16	8.40
5027-679-322-135	SBT50 x SAM32EX - 135	135	79.5	29	80	20 N-m	ER32	3 ~ 20	8.44
5043-679-161-136	SCAT40 x SAM16EX - 5.372"	5.372	3.327	1.327	2.559	20 N-m	ER16	3 ~ 10	6.40
5043-679-201-136	SCAT40 x SAM20EX - 5.372"	5.372	3.327	1.327	2.559	20 N-m	ER20	3 ~ 13	6.40
5043-679-251-136	SCAT40 x SAM25EX - 5.372"	5.372	3.327	1.327	2.559	20 N-m	ER25	3 ~ 16	6.40
5043-679-321-136	SCAT40 x SAM32EX - 5.372"	5.372	3.130	1.327	2.559	20 N-m	ER32	3 ~ 20	6.44
5044-679-162-140	SCAT50 x SAM16EX - 5.5"	5.5	3.327	1.142	3.145	20 N-m	ER16	3 ~ 10	8.40
5044-679-202-140	SCAT50 x SAM20EX - 5.5"	5.5	3.327	1.142	3.145	20 N-m	ER20	3 ~ 13	8.40
5044-679-252-140	SCAT50 x SAM25EX - 5.5"	5.5	3.327	1.142	3.145	20 N-m	ER25	3 ~ 16	8.40
5044-679-322-140	SCAT50 x SAM32EX - 5.5"	5.5	3.130	1.142	3.145	20 N-m	ER32	3 ~ 20	8.44
5066-679-161-137	SDAT40 x SAM16EX - 137	137	84.5	33.7	65	20 N-m	ER16	3 ~ 10	6.40
5066-679-201-137	SDAT40 x SAM20EX - 137	137	84.5	33.7	65	20 N-m	ER20	3 ~ 13	6.40
5066-679-251-137	SDAT40 x SAM25EX - 137	137	84.5	33.7	65	20 N-m	ER25	3 ~ 16	6.40
5066-679-321-137	SDAT40 x SAM32EX - 137	137	79.5	33.7	65	20 N-m	ER32	3 ~ 20	6.44
5067-679-162-140	SDAT50 x SAM16EX - 140	140	84.5	29	80	20 N-m	ER16	3 ~ 10	8.40
5067-679-202-140	SDAT50 x SAM20EX - 140	140	84.5	29	80	20 N-m	ER20	3 ~ 13	8.40
5067-679-252-140	SDAT50 x SAM25EX - 140	140	84.5	29	80	20 N-m	ER25	3 ~ 16	8.40
5067-679-322-140	SDAT50 x SAM32EX - 140	140	79.5	29	80	20 N-m	ER32	3 ~ 20	8.44

Product information:

- ▶ Gear ratio 1:1.
- ▶ Max. revolution: 4000rpm.
- ▶ Suggested Ap ≤ 2mm.
- ▶ Internal coolant not available.
- ▶ Rotating direction opposite to machine spindle.
- ▶ Can be used for ATC.



Reminder:

- ▶ Fixed blocks are necessary for installing angle head on the machine [P.5-37~38].
- ▶ Fixed blocks are varied by different machine designs. Please confirm the detailed dimensions when ordering.

Optional
Fixed Block



P.5-41~43



SAG ANGLE HEAD HOLDER

SLIM TYPE

BT / SAG 小徑銑削頭

(SK3 TYPE)

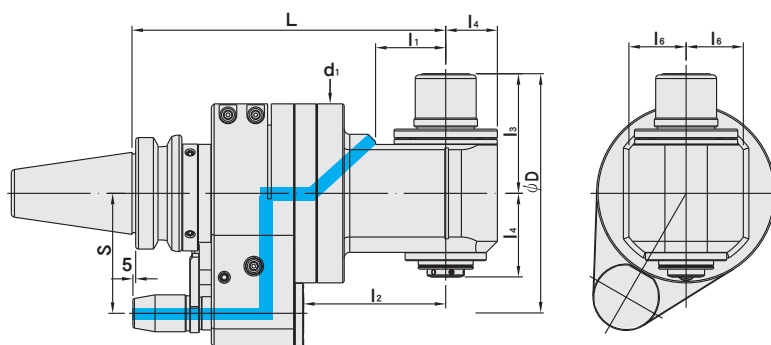

MODEL NO.	TYPE	L	l ₁	l ₂	l ₃	l ₄	l ₅	l ₆	d ₁	φ D	S	TORQUE	COLLET	WEIGHT (KGS)
5011-722-061-170	BT40 x SAG6S - 170	170	45.2	77	46.2	24	17	21	97	95	65	10N-m	SKX6	4.80
5011-722-061-200	BT40 x SAG6S - 200	200	75.2	107	46.2	24	17	21	97	95	65	10N-m	SKX6	5.10
5011-722-061-230	BT40 x SAG6S - 230	230	105.2	137	46.2	24	17	21	97	95	65	10N-m	SKX6	5.30
5011-722-061-260	BT40 x SAG6S - 260	260	135.2	167	46.2	24	17	21	97	95	65	10N-m	SKX6	5.60
5011-722-101-170	BT40 x SAG10S - 170	170	38	77	62.25	45.3	28	31	99	128	65	10N-m	SKX10	5.60
5011-722-101-200	BT40 x SAG10S - 200	200	68	107	62.25	45.3	28	31	99	128	65	10N-m	SKX10	6.10
5011-722-101-230	BT40 x SAG10S - 230	230	98	137	62.25	45.3	28	31	99	128	65	10N-m	SKX10	6.60
5011-722-101-260	BT40 x SAG10S - 260	260	128	167	62.25	45.3	28	31	99	128	65	10N-m	SKX10	7.10
5011-722-131-170	BT40 x SAG13S - 170	170	38	77	63.75	45.3	28	31	99	135	65	15N-m	SKX13	5.60
5011-722-131-200	BT40 x SAG13S - 200	200	82	107	63.75	45.3	28	31	99	135	65	15N-m	SKX13	6.10
5011-722-131-230	BT40 x SAG13S - 230	230	112	137	63.75	45.3	28	31	99	135	65	15N-m	SKX13	6.40
5011-722-131-260	BT40 x SAG13S - 260	260	142	167	63.75	45.3	28	31	99	135	65	15N-m	SKX13	6.80
5012-722-102-185	BT50 x SAG10S - 185	185	38	77	62.25	45.3	28	31	99	128	80	10N-m	SKX10	9.10
5012-722-102-215	BT50 x SAG10S - 215	215	68	107	62.25	45.3	28	31	99	128	80	10N-m	SKX10	9.50
5012-722-102-245	BT50 x SAG10S - 245	245	98	137	62.25	45.3	28	31	99	128	80	10N-m	SKX10	9.90
5012-722-102-275	BT50 x SAG10S - 275	275	128	167	62.25	45.3	28	31	99	128	80	10N-m	SKX10	10.3
5012-722-132-185	BT50 x SAG13S - 185	185	38	77	63.75	45.3	28	31	99	135	80	15N-m	SKX13	9.10
5012-722-132-215	BT50 x SAG13S - 215	215	82	107	63.75	45.3	28	31	99	135	80	15N-m	SKX13	9.50
5012-722-132-245	BT50 x SAG13S - 245	245	112	137	63.75	45.3	28	31	99	135	80	15N-m	SKX13	9.90
5012-722-132-275	BT50 x SAG13S - 275	275	142	167	63.75	45.3	28	31	99	135	80	15N-m	SKX13	10.3

COLLET	SIZE RANGE
SKX6	3 ~ 6
SKX10	3 ~ 10
SKX13	3 ~ 13

Product information:

- ▶ Gear ratio 1:1.
- ▶ Max. revolution: 6000rpm.
- ▶ Suggested Ap ≤ 2mm.
- ▶ Coolant feed through dowel pin, coolant outlet from 2 coolant holes.
- ▶ Max. water pressure: 7kgf/cm²(100PSI).
- ▶ Rotating direction opposite to machine spindle.
- ▶ Can be used for ATC.



Reminder:

- ▶ Fixed blocks are necessary for installing angle head on the machine.
- ▶ Fixed blocks are varied by different machine designs. Please confirm the detailed dimensions when ordering.

Optional Fixed Block



P.S-41~43



SAG ANGLE HEAD HOLDER

SLIM TYPE

Dual
DRIVE+



SBT / SAG 小徑銑削頭

(SK3 TYPE)

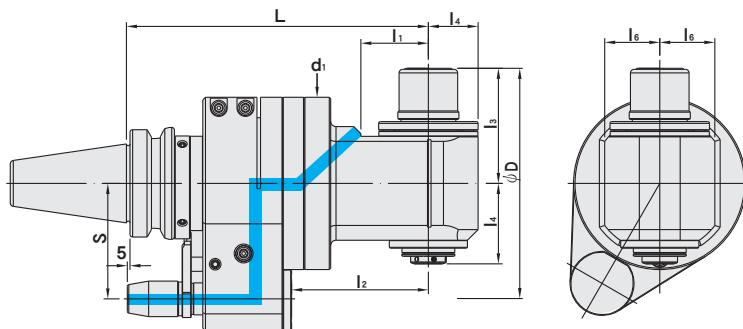

MODEL NO.	TYPE	L	l ₁	l ₂	l ₃	l ₄	l ₅	l ₆	d ₁	φ D	S	TORQUE	COLLET	WEIGHT (KGS)
5026-722-061-170	SBT40 x SAG6S - 170	170	45.2	77	46.2	24	17	21	97	95	65	10N-m	SKX6	4.8
5026-722-061-200	SBT40 x SAG6S - 200	200	75.2	107	46.2	24	17	21	97	95	65	10N-m	SKX6	5.1
5026-722-061-230	SBT40 x SAG6S - 230	230	105.2	137	46.2	24	17	21	97	95	65	10N-m	SKX6	5.3
5026-722-061-260	SBT40 x SAG6S - 260	260	135.2	167	46.2	24	17	21	97	95	65	10N-m	SKX6	5.6
5026-722-101-170	SBT40 x SAG10S - 170	170	38	77	62.25	45.3	28	31	99	128	65	10N-m	SKX10	5.6
5026-722-101-200	SBT40 x SAG10S - 200	200	68	107	62.25	45.3	28	31	99	128	65	10N-m	SKX10	6.1
5026-722-101-230	SBT40 x SAG10S - 230	230	98	137	62.25	45.3	28	31	99	128	65	10N-m	SKX10	6.6
5026-722-101-260	SBT40 x SAG10S - 260	260	128	167	62.25	45.3	28	31	99	128	65	10N-m	SKX10	7.1
5026-722-131-170	SBT40 x SAG13S - 170	170	38	77	63.75	45.3	28	31	99	135	65	15N-m	SKX13	5.6
5026-722-131-200	SBT40 x SAG13S - 200	200	82	107	63.75	45.3	28	31	99	135	65	15N-m	SKX13	6.1
5026-722-131-230	SBT40 x SAG13S - 230	230	112	137	63.75	45.3	28	31	99	135	65	15N-m	SKX13	6.4
5026-722-131-260	SBT40 x SAG13S - 260	260	142	167	63.75	45.3	28	31	99	135	65	15N-m	SKX13	6.8
5027-722-102-185	SBT50 x SAG10S - 185	185	38	77	62.25	45.3	28	31	99	128	80	10N-m	SKX10	9.10
5027-722-102-215	SBT50 x SAG10S - 215	215	68	107	62.25	45.3	28	31	99	128	80	10N-m	SKX10	9.50
5027-722-102-245	SBT50 x SAG10S - 245	245	98	137	62.25	45.3	28	31	99	128	80	10N-m	SKX10	9.85
5027-722-102-275	SBT50 x SAG10S - 275	275	128	167	62.25	45.3	28	31	99	128	80	10N-m	SKX10	10.3
5027-722-132-185	SBT50 x SAG13S - 185	185	38	77	63.75	45.3	28	31	99	135	80	15N-m	SKX13	9.10
5027-722-132-215	SBT50 x SAG13S - 215	215	82	107	63.75	45.3	28	31	99	135	80	15N-m	SKX13	9.45
5027-722-132-245	SBT50 x SAG13S - 245	245	112	137	63.75	45.3	28	31	99	135	80	15N-m	SKX13	9.84
5027-722-132-275	SBT50 x SAG13S - 275	275	142	167	63.75	45.3	28	31	99	135	80	15N-m	SKX13	10.30

COLLET	SIZE RANGE
SKX6	3 ~ 6
SKX10	3 ~ 10
SKX13	3 ~ 13

Product information:

- ▶ Gear ratio 1:1.
- ▶ Max. revolution: 6000rpm.
- ▶ Suggested Ap ≤ 2mm.
- ▶ Coolant feed through dowel pin, coolant outlet from 2 coolant holes.
- ▶ Max. water pressure: 7kgf/cm²(100PSI).
- ▶ Rotating direction opposite to machine spindle.
- ▶ Can be used for ATC.



Reminder:

- ▶ Fixed blocks are necessary for installing angle head on the machine.
- ▶ Fixed blocks are varied by different machine designs. Please confirm the detailed dimensions when ordering.

Optional
Fixed Block



P.S-41~43



SAG ANGLE HEAD HOLDER

SLIM TYPE

HSK / SAG 小徑銑削頭

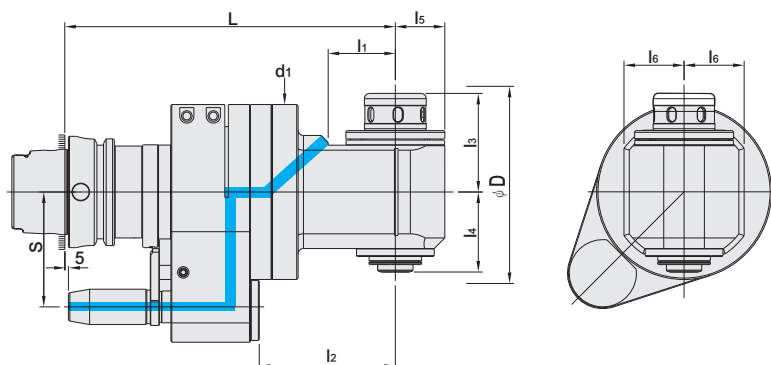

MODEL NO.	TYPE	L	l ₁	l ₂	l ₃	l ₄	l ₅	l ₆	d ₁	φ D	S	TORQUE	COLLET	WEIGHT (KGS)
5073-S39-111-185	HSK63A x SAG11E - 185	185	45.2	77	35.2	24	17	21	99	72	65	10N-m	ER11	5.52
5073-S39-111-215	HSK63A x SAG11E - 215	215	75.2	107	35.2	24	17	21	99	72	65	10N-m	ER11	5.95
5073-S39-111-245	HSK63A x SAG11E - 245	245	105.2	137	35.2	24	17	21	99	72	65	10N-m	ER11	6.35
5073-S39-111-275	HSK63A x SAG11E - 275	275	135.2	167	35.2	24	17	21	99	72	65	10N-m	ER11	6.73
5073-S39-161-185	HSK63A x SAG16E - 185	185	38	77	57.1	45.3	17	21	97	120	65	15N-m	ER16	5.50
5073-S39-161-215	HSK63A x SAG16E - 215	215	82	107	57.1	45.3	17	21	97	120	65	15N-m	ER16	5.93
5073-S39-161-245	HSK63A x SAG16E - 245	245	112	137	57.1	45.3	17	21	97	120	65	15N-m	ER16	6.32
5073-S39-161-275	HSK63A x SAG16E - 275	275	142	167	57.1	45.3	17	21	97	120	65	15N-m	ER16	6.72
5073-S39-201-185	HSK63A x SAG20E - 185	185	38	77	58.5	45.3	17	21	97	120	65	15N-m	ER20	5.37
5073-S39-201-215	HSK63A x SAG20E - 215	215	82	107	58.5	45.3	17	21	97	120	65	15N-m	ER20	5.81
5073-S39-201-245	HSK63A x SAG20E - 245	245	112	137	58.5	45.3	17	21	97	120	65	15N-m	ER20	6.21
5073-S39-201-275	HSK63A x SAG20E - 275	275	142	167	58.5	45.3	17	21	97	120	65	15N-m	ER20	6.60
5073-722-061-185	HSK63A x SAG6S - 185	185	45.2	77	46.2	24	17	21	97	95	65	10N-m	SKX6	5.55
5073-722-061-215	HSK63A x SAG6S - 215	215	75.2	107	46.2	24	17	21	97	95	65	10N-m	SKX6	6.10
5073-722-061-245	HSK63A x SAG6S - 245	245	105.2	137	46.2	24	17	21	97	95	65	10N-m	SKX6	6.36
5073-722-061-275	HSK63A x SAG6S - 275	275	135.2	167	46.2	24	17	21	97	95	65	10N-m	SKX6	6.76
5073-722-131-185	HSK63A x SAG13S - 185	185	38	77	63.75	45.3	28	31	99	135	65	15N-m	SKX13	5.52
5073-722-131-215	HSK63A x SAG13S - 215	215	82	107	63.75	45.3	28	31	99	135	65	15N-m	SKX13	5.95
5073-722-131-245	HSK63A x SAG13S - 245	245	112	137	63.75	45.3	28	31	99	135	65	15N-m	SKX13	6.35
5073-722-131-275	HSK63A x SAG13S - 275	275	142	167	63.75	45.3	28	31	99	135	65	15N-m	SKX13	6.73

COLLET	SIZE RANGE
ER11	3 ~ 7
ER16	3 ~ 10
ER20	3 ~ 13
SKX6	3 ~ 6
SKX13	3 ~ 13

Product information:

- ▶ Gear ratio 1:1. ▶ Max. revolution: 6000rpm.
- ▶ Suggested $A_p \leq 2\text{mm}$. ▶ Coolant feed through dowel pin, coolant outlet from 2 coolant holes.
- ▶ Max. water pressure: 7kgf/cm^2 (100PSI). ▶ Rotating direction opposite to machine spindle.
- ▶ Can be used for ATC.



Reminder:

- ▶ Fixed blocks are necessary for installing angle head on the machine.
- ▶ Fixed blocks are varied by different machine designs. Please confirm the detailed dimensions when ordering.

Optional Fixed Block



P.S-41~43



SAG ANGLE HEAD HOLDER

SLIM TYPE

BT / SAG 小徑銑削頭

(ER TYPE)

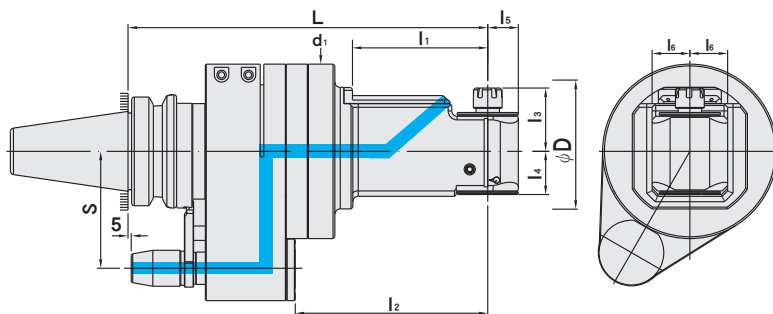

MODEL NO.	TYPE	L	l ₁	l ₂	l ₃	l ₄	l ₅	l ₆	d ₁	φ D	S	TORQUE	COLLET	WEIGHT (KGS)
5011-S39-111-170	BT40 x SAG11E - 170	170	45.2	77	35.2	24	17	21	99	72	65	10N-m	ER11	5.10
5011-S39-111-200	BT40 x SAG11E - 200	200	75.2	107	35.2	24	17	21	99	72	65	10N-m	ER11	5.30
5011-S39-111-230	BT40 x SAG11E - 230	230	105.2	137	35.2	24	17	21	99	72	65	10N-m	ER11	5.50
5011-S39-111-260	BT40 x SAG11E - 260	260	135.2	167	35.2	24	17	21	99	72	65	10N-m	ER11	5.70
5011-S39-161-170	BT40 x SAG16E - 170	170	38	77	57.1	45.3	28	31	99	120	65	15N-m	ER16	5.50
5011-S39-161-200	BT40 x SAG16E - 200	200	82	107	57.1	45.3	28	31	99	120	65	15N-m	ER16	5.93
5011-S39-161-230	BT40 x SAG16E - 230	230	112	137	57.1	45.3	28	31	99	120	65	15N-m	ER16	6.32
5011-S39-161-260	BT40 x SAG16E - 260	260	142	167	57.1	45.3	28	31	99	120	65	15N-m	ER16	6.72
5011-S39-201-170	BT40 x SAG20E - 170	170	38	77	58.5	45.3	28	31	99	120	65	15N-m	ER20	5.80
5011-S39-201-200	BT40 x SAG20E - 200	200	82	107	58.5	45.3	28	31	99	120	65	15N-m	ER20	5.90
5011-S39-201-230	BT40 x SAG20E - 230	230	112	137	58.5	45.3	28	31	99	120	65	15N-m	ER20	6.60
5011-S39-201-260	BT40 x SAG20E - 260	260	142	167	58.5	45.3	28	31	99	120	65	15N-m	ER20	6.80
5012-S39-162-185	BT50 x SAG16E - 185	185	38	77	57.1	45.3	28	31	99	120	80	15N-m	ER16	9.00
5012-S39-162-215	BT50 x SAG16E - 215	215	82	107	57.1	45.3	28	31	99	120	80	15N-m	ER16	9.41
5012-S39-162-245	BT50 x SAG16E - 245	245	112	137	57.1	45.3	28	31	99	120	80	15N-m	ER16	9.81
5012-S39-162-275	BT50 x SAG16E - 275	275	142	167	57.1	45.3	28	31	99	120	80	15N-m	ER16	10.2
5012-S39-202-185	BT50 x SAG20E - 185	185	38	77	58.5	45.3	28	31	99	120	80	15N-m	ER20	8.90
5012-S39-202-215	BT50 x SAG20E - 215	215	82	107	58.5	45.3	28	31	99	120	80	15N-m	ER20	9.50
5012-S39-202-245	BT50 x SAG20E - 245	245	112	137	58.5	45.3	28	31	99	120	80	15N-m	ER20	9.80
5012-S39-202-275	BT50 x SAG20E - 275	275	142	167	58.5	45.3	28	31	99	120	80	15N-m	ER20	10.9

COLLET	SIZE RANGE
ER11	3 ~ 7
ER16	3 ~ 10
ER20	3 ~ 13

Product information:

- ▶ Gear ratio 1:1.
- ▶ Max. revolution: 6000rpm.
- ▶ Suggested $A_p \leq 2\text{mm}$.
- ▶ Coolant feed through dowel pin, coolant outlet from 2 coolant holes.
- ▶ Max. water pressure: $7\text{kgf/cm}^2(100\text{PSI})$.
- ▶ Rotating direction opposite to machine spindle.
- ▶ Can be used for ATC.



Reminder:

- ▶ Fixed blocks are necessary for installing angle head on the machine.
- ▶ Fixed blocks are varied by different machine designs. Please confirm the detailed dimensions when ordering.

Optional
Fixed Block



P.S-41~43



SAG ANGLE HEAD HOLDER

SLIM TYPE



SBT / SAG 小徑銑削頭

(ER TYPE)

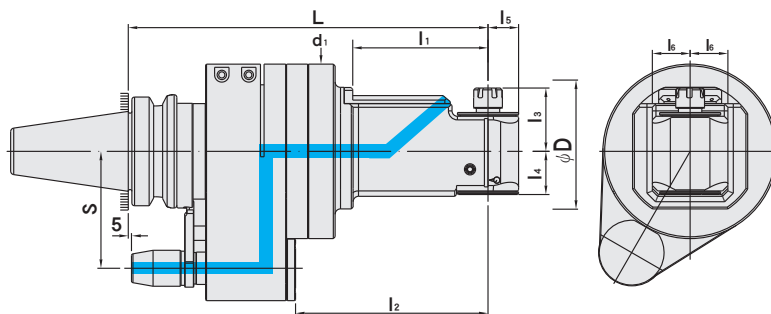

MODEL NO.	TYPE	L	l ₁	l ₂	l ₃	l ₄	l ₅	l ₆	d ₁	φ D	S	TORQUE	COLLET	WEIGHT (KGS)
5026-S39-111-170	SBT40 x SAG11E - 170	170	45.2	77	35.2	24	17	21	99	72	65	10N-m	ER11	5.10
5026-S39-111-200	SBT40 x SAG11E - 200	200	75.2	107	35.2	24	17	21	99	72	65	10N-m	ER11	5.30
5026-S39-111-230	SBT40 x SAG11E - 230	230	105.2	137	35.2	24	17	21	99	72	65	10N-m	ER11	5.50
5026-S39-111-260	SBT40 x SAG11E - 260	260	135.2	167	35.2	24	17	21	99	72	65	10N-m	ER11	5.70
5026-S39-161-170	SBT40 x SAG16E - 170	170	38	77	57.1	45.3	28	31	99	120	65	15N-m	ER16	5.50
5026-S39-161-200	SBT40 x SAG16E - 200	200	82	107	57.1	45.3	28	31	99	120	65	15N-m	ER16	5.93
5026-S39-161-230	SBT40 x SAG16E - 230	230	112	137	57.1	45.3	28	31	99	120	65	15N-m	ER16	6.32
5026-S39-161-260	SBT40 x SAG16E - 260	260	142	167	57.1	45.3	28	31	99	120	65	15N-m	ER16	6.72
5026-S39-201-170	SBT40 x SAG20E - 170	170	38	77	58.5	45.3	28	31	99	120	65	15N-m	ER20	5.80
5026-S39-201-200	SBT40 x SAG20E - 200	200	82	107	58.5	45.3	28	31	99	120	65	15N-m	ER20	5.90
5026-S39-201-230	SBT40 x SAG20E - 230	230	112	137	58.5	45.3	28	31	99	120	65	15N-m	ER20	6.60
5026-S39-201-260	SBT40 x SAG20E - 260	260	142	167	58.5	45.3	28	31	99	120	65	15N-m	ER20	6.80
5027-S39-162-185	SBT50 x SAG16E - 185	185	38	77	57.1	45.3	28	31	99	120	80	15N-m	ER16	9.00
5027-S39-162-215	SBT50 x SAG16E - 215	215	82	107	57.1	45.3	28	31	99	120	80	15N-m	ER16	9.41
5027-S39-162-245	SBT50 x SAG16E - 245	245	112	137	57.1	45.3	28	31	99	120	80	15N-m	ER16	9.81
5027-S39-162-275	SBT50 x SAG16E - 275	275	142	167	57.1	45.3	28	31	99	120	80	15N-m	ER16	10.2
5027-S39-202-185	SBT50 x SAG20E - 185	185	38	77	58.5	45.3	28	31	99	120	80	15N-m	ER20	8.90
5027-S39-202-215	SBT50 x SAG20E - 215	215	82	107	58.5	45.3	28	31	99	120	80	15N-m	ER20	9.50
5027-S39-202-245	SBT50 x SAG20E - 245	245	112	137	58.5	45.3	28	31	99	120	80	15N-m	ER20	9.80
5027-S39-202-275	SBT50 x SAG20E - 275	275	142	167	58.5	45.3	28	31	99	120	80	15N-m	ER20	10.9

COLLET	SIZE RANGE
ER11	3 ~ 7
ER16	3 ~ 10
ER20	3 ~ 13

Product information:

- ▶ Gear ratio 1:1.
- ▶ Max. revolution: 6000rpm.
- ▶ Suggested Ap ≤ 2mm.
- ▶ Coolant feed through dowel pin, coolant outlet from 2 coolant holes.
- ▶ Max. water pressure: 7kgf/cm²(100PSI).
- ▶ Rotating direction opposite to machine spindle.
- ▶ Can be used for ATC.



Reminder:

- ▶ Fixed blocks are necessary for installing angle head on the machine.
- ▶ Fixed blocks are varied by different machine designs. Please confirm the detailed dimensions when ordering.

Optional Fixed Block



PS-41~43



SAD ANGLE HEAD HOLDER

SLIM TYPE

SAD 小徑銑削頭

(EBL TYPE)

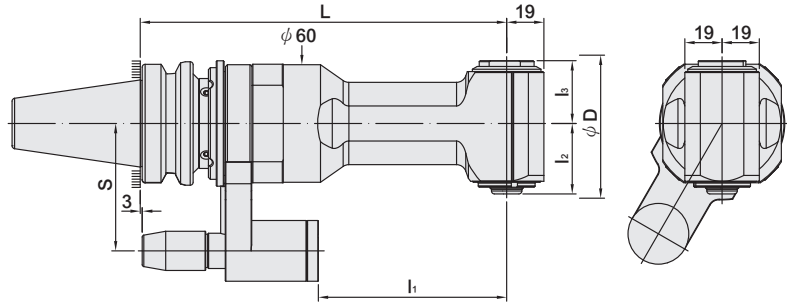

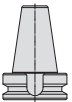
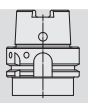
SHANK	MODEL NO.	TYPE	L	l ₁	l ₂	l ₃	φD	S	TORQUE	COLLET	SIZE RANGE	WEIGHT (KGS)
 DaulDRIVE+	5025-791-084-130	SBT30 x SAD8B - 130	130	74.6	36	32.5	76	55	10N-m	EBL8	3~8	2.60
	5025-791-084-182	SBT30 x SAD8B - 182	182	96.1	36	32.5	76	55	10N-m	EBL8	3~8	3.00
	5026-791-081-135	SBT40 x SAD8B - 135	135	74.6	36	32.5	76	65	10N-m	EBL8	3~8	3.40
	5026-791-081-187	SBT40 x SAD8B - 187	187	96.1	36	32.5	76	65	10N-m	EBL8	3~8	3.70
 DIN 69893 A	5073-S41-081-195	HSK63A x SAD8B - 195	195	74.6	36	32.5	76	65	10N-m	EBL8	3~8	3.50

Product information:

- ▶ Max. revolution: 6000rpm.
- ▶ Suggested $A_p \leq 1.5\text{mm}$.
- ▶ Slim design, for deep hole machining.
- ▶ For drilling, tapping & light milling.
- ▶ For tapping centers.
- ▶ Internal coolant not available.
- ▶ Rotating direction opposite to machine spindle.
- ▶ Can be used for ATC.



Reminder:

- ▶ Fixed blocks are necessary for installing angle head on the machine.
- ▶ Fixed blocks are varied by different machine designs. Please confirm the detailed dimensions when ordering.

Optional
Fixed Block



P.S-41~43



SAD ANGLE HEAD HOLDER

SLIM TYPE

SAD 小徑銑削頭

[SK3 TYPE]

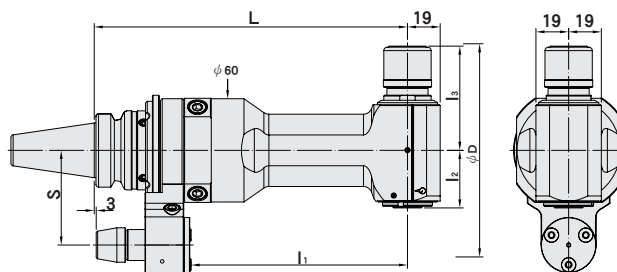

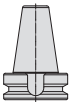
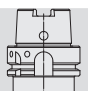
SHANK	MODEL NO.	TYPE	L	l ₁	l ₂	l ₃	φ D	S	TORQUE	COLLET	SIZE RANGE	WEIGHT (KGS)
 DaulDRIVE+	5025-724-104-130	SBT30 x SAD10S - 130	130	74.6	34	60.55	125	55	10N-m	SKX10	3~10	2.66
	5025-724-104-182	SBT30 x SAD10S - 182	182	96.1	34	60.55	125	55	10N-m	SKX10	3~10	3.1
	5026-724-101-135	SBT40 x SAD10S - 135	135	74.6	34	60.55	125	65	10N-m	SKX10	3~10	3.5
	5026-724-101-187	SBT40 x SAD10S - 187	187	96.1	34	60.55	125	65	10N-m	SKX10	3~10	3.75
 DIN 69893 A	5073-724-101-195	HSK63A x SAD10S - 195	195	96.1	34	60.55	125	65	10N-m	SKX10	3~10	3.80

Product information:

- ▶ Max. revolution: 6000rpm.
- ▶ Suggested $A_p \leq 1.5\text{mm}$.
- ▶ Slim design, for deep hole machining.
- ▶ For drilling, tapping & light milling.
- ▶ For tapping centers.
- ▶ Internal coolant not available.
- ▶ Rotating direction opposite to machine spindle.
- ▶ Can be used for ATC.



Reminder:

- ▶ Fixed blocks are necessary for installing angle head on the machine.
- ▶ Fixed blocks are varied by different machine designs. Please confirm the detailed dimensions when ordering.

Optional
Fixed Block



P.S-41~43



CUTTING CONDITIONS

切削數據

Drilling

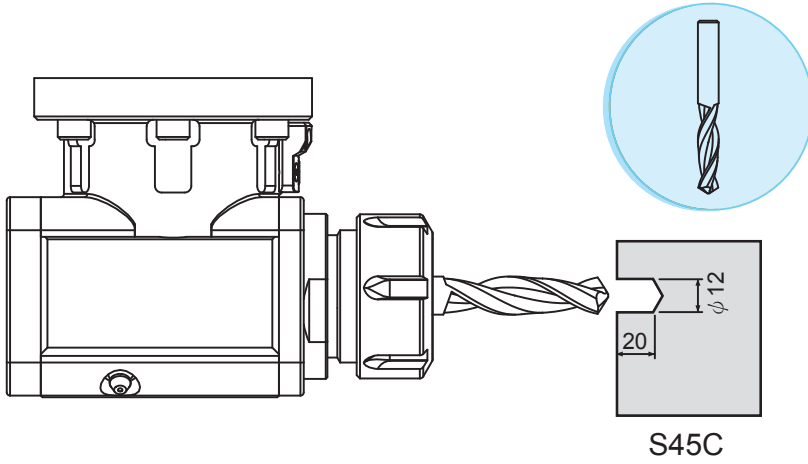

SAC	N: 1100 min ⁻¹ F: 120 mm/min V: 35.5 m/min Max. Torque: 25 N-m
SAM	N: 670 min ⁻¹ F: 80 mm/min V: 25.5 m/min Max. Torque: 20 N-m

Milling

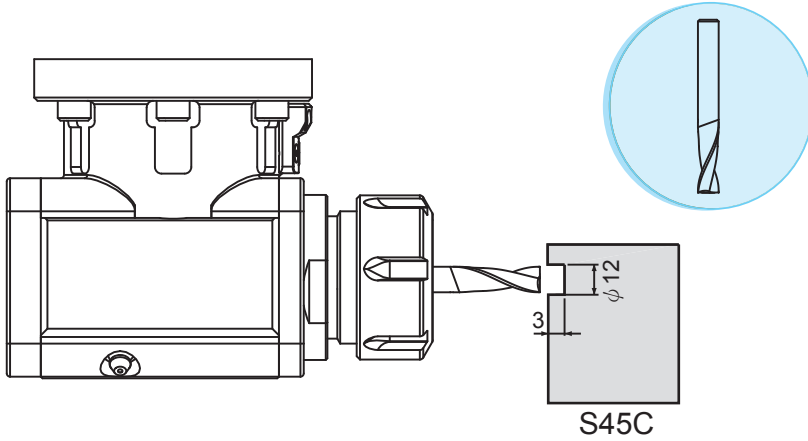

SAC	N: 500 min ⁻¹ F: 150 mm/min V: 18.8 m/min Max. Torque: 20 N-m
-----	---

Tapping

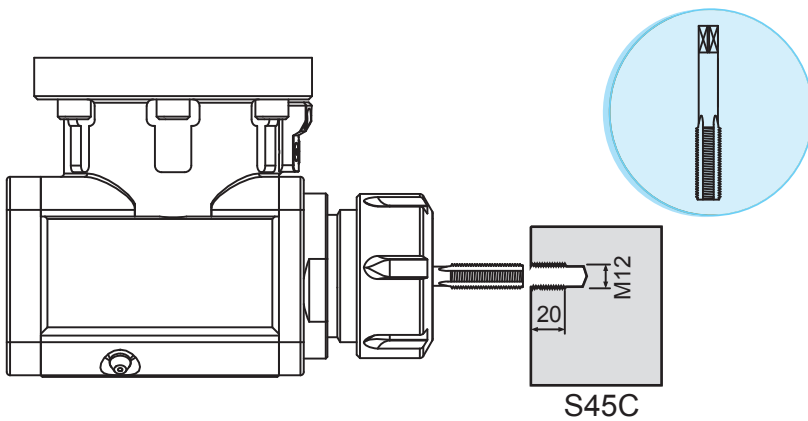

SAC	N: 200 min ⁻¹ F: 350 mm/min V: 7.53 m/min Max. Torque: 25 N-m
SAM	N: 200 min ⁻¹ F: 350 mm/min V: 7.53 m/min Max. Torque: 20 N-m

FIXED BLOCK BLANK

STRAIGHT TYPE

直式素材型定位塊

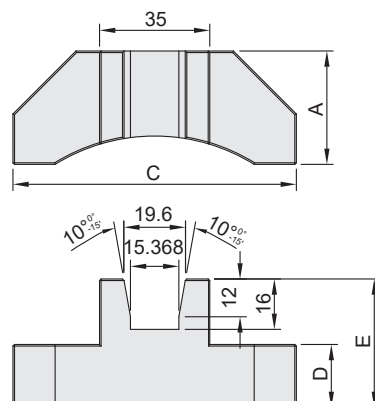

MODEL NO.	TYPE	A	C	D	E	WEIGHT (KGS)
5350-671-040-00	SFA - 40	36	90	20	40.8	0.49
5350-671-050-00	SFA - 50	38	106	20	42.3	0.60

FIXED BLOCK BLANK

TAPER TYPE

錐度素材型定位塊

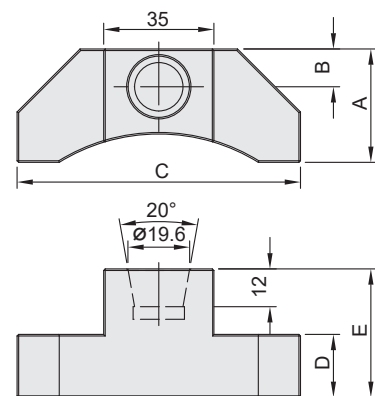
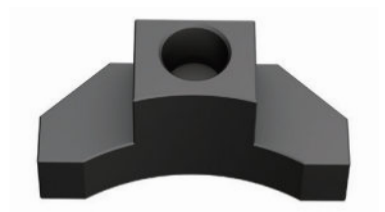

MODEL NO.	TYPE	A	B	C	D	E	WEIGHT (KGS)
5350-671-040-01	SFB - 40	36	12	90	20	40.8	0.52
5350-671-050-02	SFB - 50	38	18	106	20	42.3	0.65

FIXED BLOCK

ONE PIECE TYPE

定位塊

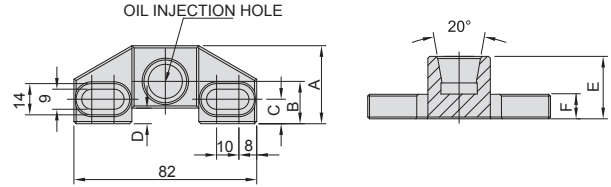

MODEL NO.	TYPE	NAME	A	B	C	D	E	F	WEIGHT (KGS)
5350-673-040-00	SFT - 40	#40 FIXED BLOCK (Taper Type)	40	18.5	10	5	30	13	0.30
5350-673-050-00	SFT - 50	#50 FIXED BLOCK (Taper Type)	34	19	11	7	35	15	0.32

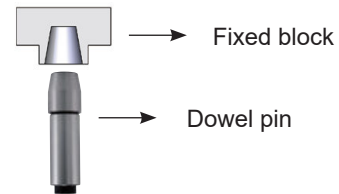

Features:

- ▶ Fixed block must be purchased according to the type of dowel pin.
- ▶ Fixed block can be installed on the spindle but must be fixed on the machine well. Otherwise, it is a threat for ATC tool change arm. Installation way changes with different machines. Please confirm with your machine supplier about correct installation way.



FIXED BLOCK COMBINATION TYPE

組合式定位塊

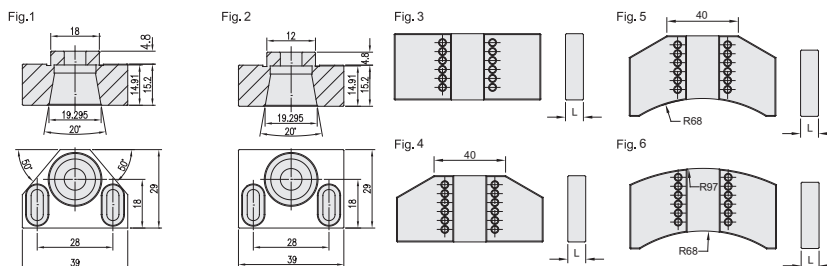

	TYPE	UPPER SEAT		BOTTOM SEAT		
		TYPE	Fig.	TYPE	Fig.	L
<p>SFO-A-1-10</p> <p>THICKNESS OF THE BOTTOM SEAT</p> <p>UPPER SEAT Fig.1</p> <p>BOTTOM SEAT Fig.2</p> <p>TYPE:1</p> <p>TYPE:2</p> <p>TYPE:3</p> <p>TYPE:4</p> <p>A</p> <p>B</p>	5350-771-010-00	SFO-A	1	SFO-1-10	3	10
	5350-771-015-00	SFO-A	1	SFO-1-15	3	15
	5350-771-010-01	SFO-A	1	SFO-2-10	4	10
	5350-771-015-01	SFO-A	1	SFO-2-15	4	15
	5350-771-010-02	SFO-A	1	SFO-3-10	5	10
	5350-771-015-02	SFO-A	1	SFO-3-15	5	15
	5350-771-010-03	SFO-A	1	SFO-4-10	6	10
	5350-771-015-03	SFO-A	1	SFO-4-15	6	15
	5350-772-010-00	SFO-B	2	SFO-1-10	3	10
	5350-772-015-00	SFO-B	2	SFO-1-15	3	15
	5350-772-010-01	SFO-B	2	SFO-2-10	4	10
	5350-772-015-01	SFO-B	2	SFO-2-15	4	15
	5350-772-010-02	SFO-B	2	SFO-3-10	5	10
	5350-772-015-02	SFO-B	2	SFO-3-15	5	15
	5350-772-010-03	SFO-B	2	SFO-4-10	6	10
	5350-772-015-03	SFO-B	2	SFO-4-15	6	15

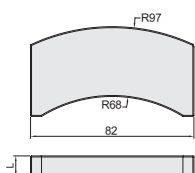

TYPE	L	TYPE	L
5350-622-005-00	5	SFD-4-20	20
5350-622-010-00	10	SFD-4-25	25
5350-622-015-00	15		

Product information:

► If the height of the fixed block needs to be added, adjustable pads need to be purchased additionally.



REFERENCE DRAWING OF SPINDLE FIXED BLOCK

主軸定位塊參考圖

- ▶ When ordering custom-made products, please notice the distance variation between the spindle center and fixed block center hole, as well as indicate the size and position of fixed screw hole on your machine spindle flange.
- ▶ Before placing purchase order, please offer the related dimensions in detail by filling out the form and you could contact us via e-mail, telephone or fax.

TYPE ONE:

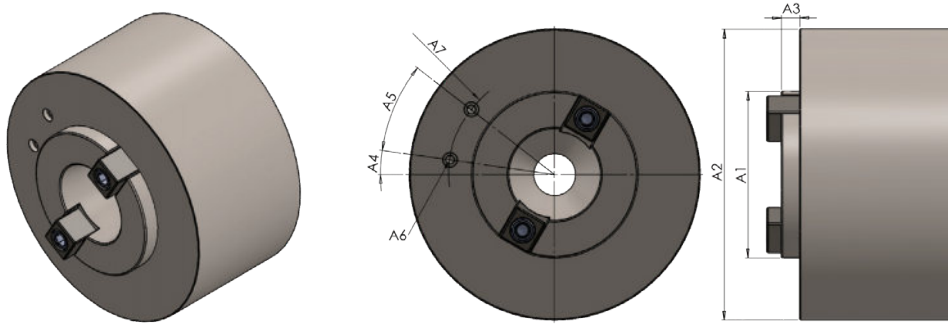

TYPE TWO:

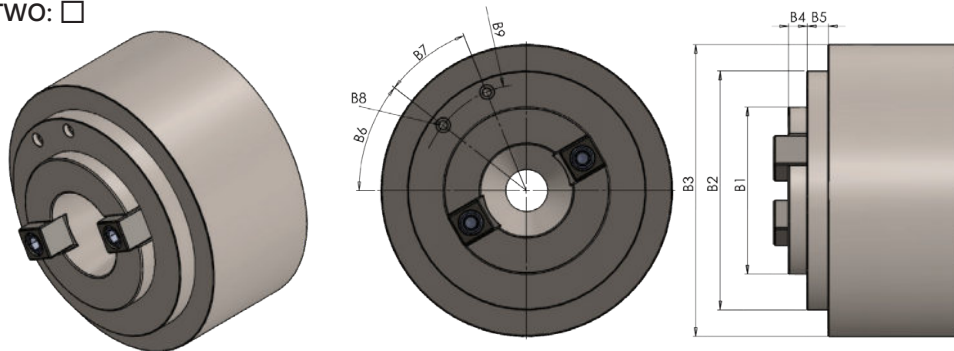

UNIT: mm

TYPE ONE: <input type="checkbox"/>				TYPE TWO: <input type="checkbox"/>			
The brand of machine				The brand of machine			
The model of machine				The model of machine			
A1		A5		B1		B6	
A2		A6		B2		B7	
A3		A7		B3		B8	
A4		S		B4		B9	
				B5		S	



"S" is the distance between the center of the dowel pin to center of the spindle.



MEMO

Blank lined area for writing.



MEMO

Blank lined area for writing a memo.

