

CAT CATEGORY

ANSI B5.50

UT COLLET CHUCK	B-3
ER COLLET CHUCK	B-4~5
ER COLLET CHUCK [M TYPE]	B-6
ER SHORT LENGTH COLLET CHUCK	B-7
SK3 COLLET CHUCK	B-8
SBL SLIM-FIT COLLET CHUCK	B-9
SBLC SLIM-FIT COLLET CHUCK	B-10
EBL SLIM-FIT COLLET CHUCK	B-11
EBLC SLIM-FIT COLLET CHUCK	B-12
HBL SLIM-FIT COLLET CHUCK	B-13
MLD MULTI-LOCK MILLING CHUCK	B-14
EOC COLLET CHUCK	B-15
TG COLLET CHUCK	B-16
SAF RUNOUT ADJUSTABLE HOLDER	B-17~20
SLN SIDE LOCK END MILL HOLDER	B-21
FACE MILL ARBOR	B-22
STA SYNCHRONIZED TAPPING HOLDER	B-23~24
SPH DRILL CHUCK ADAPTER	B-25
SPU DRILL CHUCK ADAPTER	B-26
EXPANSION ER TAPPER	B-27
SIDE LOCK OIL HOLE HOLDER	B-28
OTHER OIL HOLE COLLET CHUCK	B-29
SOM SCREWED END MILL HOLDER	B-30
MORSE TAPER ADAPTER	B-31
ADAPTER	B-32
BLANK	B-33

REFERENCE DETAILS

- ▶ Shank body standard : **ANSI B5.50**
- ▶ Taper tolerance < **AT3**
- ▶ Hardness > **HRC 56°**
- ▶ Surface roughness: Ra < **0.25 μm**
- ▶ Roundness < **0.8 μm**
- ▶ Carbon depth > **0.8mm**
- ▶ The shank has pre-balance at G6.3, and can provide precision balance at G2.5. It can be ordered by request.

ANSI B5.50/CAT A

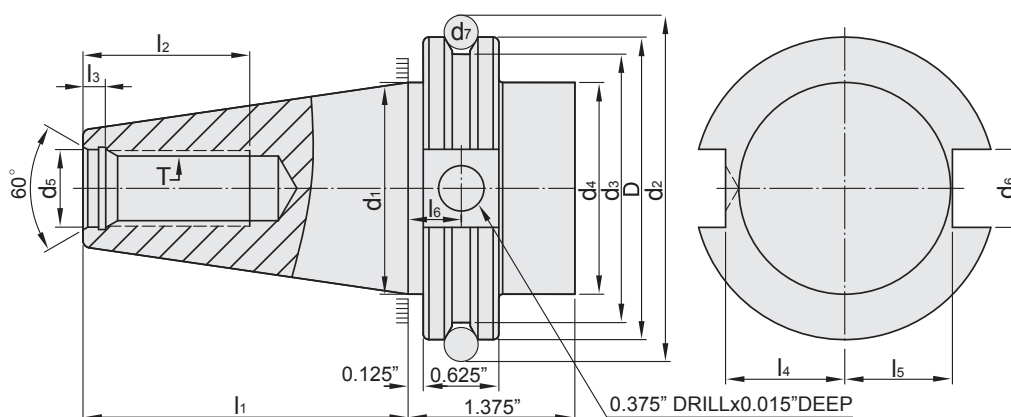

ANSI B5.50/CAT AD+B

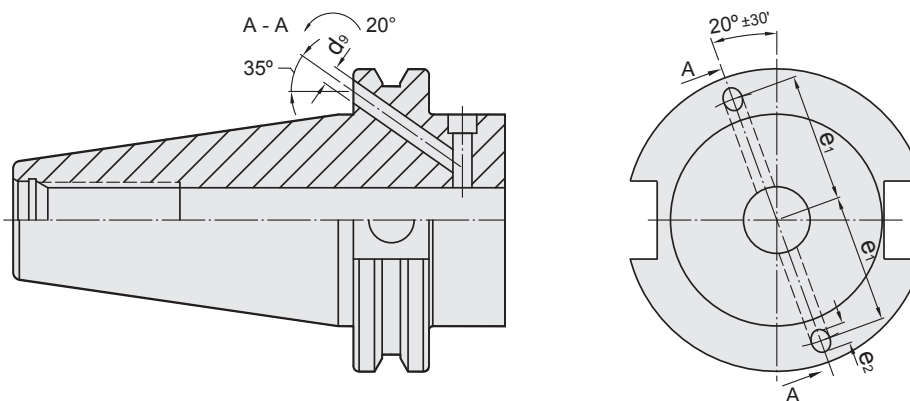

INCHES

CAT	D ±0.002	d ₁	d ₂ ±0.002	d ₃ ±0.01	d ₄ ±0.005	d ₅ +0.015 0	d ₆ ±0.01	d ₇	d ₉
30	1.812	1.250	2.176	1.531	1.250	0.516	0.645	0.2813	-
40	2.500	1.750	2.863	2.219	1.750	0.641	0.645	0.2813	0.157
45	3.250	2.250	3.613	2.969	2.250	0.766	0.770	0.2813	-
50	3.875	2.750	4.238	3.594	2.750	1.031	1.020	0.2813	0.236
CAT	l ₁ ±0.005	l ₂ min	l ₃ ±0.01	l ₄ +0 -0.015	l ₅ +0 -0.015	e ₁ ±0.1	e ₂ MAX	T UNC 2B	
30	1.875	1.00	0.188	0.735	0.640	-	-	1/2" - 13	
40	2.687	1.12	0.188	0.985	0.890	1.063	0.199	5/8" - 11	
45	3.250	1.50	0.188	1.235	1.140	-	-	3/4" - 10	
50	4.000	1.75	0.250	1.485	1.390	1.654	0.276	1" - 8	

CAT / UT COLLET CHUCK



CAT / UT 立銑刀夾頭

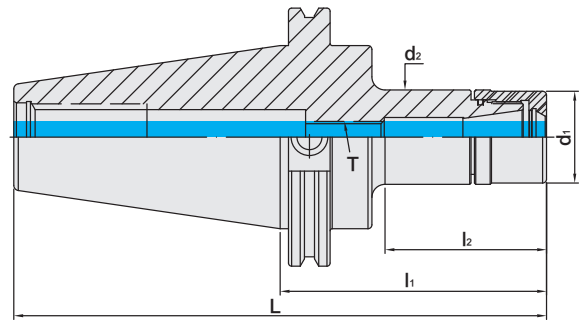

INCHES

MODEL NO.	TYPE	L	l ₁	l ₂	d ₁	d ₂	T	SIZE RANGE	WEIGHT (KGS)
5031-753-016-076	CAT40 x UT16 - 3"	5.687	3	1.583	1.181	1.181	M10 x 1.5P	0.062 ~ 0.406	1.14
5031-753-016-102	CAT40 x UT16 - 4"	6.687	4	2.175	1.181	1.181	M10 x 1.5P	0.062 ~ 0.406	1.27
5031-753-016-152	CAT40 x UT16 - 6"	8.687	6	4.175	1.181	1.181	M10 x 1.5P	0.062 ~ 0.406	1.49
5031-753-020-076	CAT40 x UT20 - 3"	5.687	3	1.583	1.378	1.417	M12 x 1.75P	0.062 ~ 0.5	1.18
5031-753-020-102	CAT40 x UT20 - 4"	6.687	4	2.374	1.378	1.417	M12 x 1.75P	0.062 ~ 0.5	1.36
5031-753-020-152	CAT40 x UT20 - 6"	8.687	6	4.374	1.378	1.417	M12 x 1.75P	0.062 ~ 0.5	1.70
5031-753-025-076	CAT40 x UT25 - 3"	5.687	3	1.574	1.653	1.653	M16 x 2.0P	0.093 ~ 0.625	1.22
5031-753-025-102	CAT40 x UT25 - 4"	6.687	4	2.546	1.653	1.653	M16 x 2.0P	0.093 ~ 0.625	1.46
5031-753-025-152	CAT40 x UT25 - 6"	8.687	6	4.546	1.653	1.653	M16 x 2.0P	0.093 ~ 0.625	1.94
5031-753-032-076	CAT40 x UT32 - 3"	5.687	3	1.622	1.890	1.890	M16 x 2.0P	0.062 ~ 0.75	1.22
5031-753-032-102	CAT40 x UT32 - 4"	6.687	4	2.622	1.890	1.890	M16 x 2.0P	0.062 ~ 0.75	1.54
5031-753-032-152	CAT40 x UT32 - 6"	8.687	6	4.622	1.890	1.890	M16 x 2.0P	0.062 ~ 0.75	2.19
5032-753-016-076	CAT50 x UT16 - 3"	7	3	1.425	1.181	1.181	M10 x 1.5P	0.062 ~ 0.406	3.15
5032-753-016-102	CAT50 x UT16 - 4"	8	4	2.228	1.181	1.181	M10 x 1.5P	0.062 ~ 0.406	3.23
5032-753-016-152	CAT50 x UT16 - 6"	10	6	4.065	1.181	1.181	M10 x 1.5P	0.062 ~ 0.406	3.55
5032-753-020-076	CAT50 x UT20 - 3"	7	3	1.504	1.378	1.417	M12 x 1.75P	0.062 ~ 0.5	3.21
5032-753-020-102	CAT50 x UT20 - 4"	8	4	2.425	1.378	1.417	M12 x 1.75P	0.062 ~ 0.5	3.35
5032-753-020-152	CAT50 x UT20 - 6"	10	6	4.228	1.378	1.417	M12 x 1.75P	0.062 ~ 0.5	3.68
5032-753-025-076	CAT50 x UT25 - 3"	7	3	1.504	1.653	1.653	M16 x 2.0P	0.093 ~ 0.625	3.25
5032-753-025-102	CAT50 x UT25 - 4"	8	4	2.425	1.653	1.653	M16 x 2.0P	0.093 ~ 0.625	3.46
5032-753-025-152	CAT50 x UT25 - 6"	10	6	4.425	1.653	1.653	M16 x 2.0P	0.093 ~ 0.625	3.87
5032-753-032-076	CAT50 x UT32 - 3"	7	3	1.504	1.890	1.890	M16 x 2.0P	0.062 ~ 0.75	3.27
5032-753-032-102	CAT50 x UT32 - 4"	8	4	2.425	1.890	1.890	M16 x 2.0P	0.062 ~ 0.75	3.56
5032-753-032-152	CAT50 x UT32 - 6"	10	6	4.425	1.890	1.890	M16 x 2.0P	0.062 ~ 0.75	4.13

Features:

- ▶ The deeper holder gauge line optimizes the coverage of ER spring collet and increases machining stability.
- ▶ UT clamping nut is designed without eccentric. Used with ER and ERE spring collets.
- ▶ The O-ring design on the front of holders prevents chips and coolant from entering holders
- ▶ UT nuts without slots reduce the wind shear at high speed

Product information:

- ▶ The pre-balance reaches G6.3 10,000 rpm. Higher balancing grade and revolution can be done upon request but additional charge is needed.
- ▶ AD+B type is available, please inform us when making an order.

Standard Accessory: • NUT

Collet	Nut	Pull Stud	Spanner	Torque Wrench Adapter (Pull Stud)	Spanner (Pull Stud)	Preset Screw
P.X-18~21	P.X-53	P.X-66	P.X-73、75、82	P.X-77	P.X-78	P.X-111

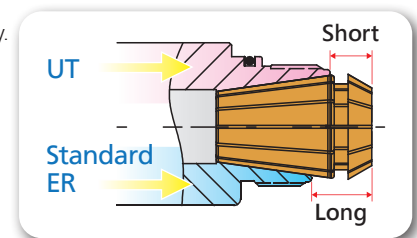

CAT / ER COLLET CHUCK



CAT / ER 立銑刀夾頭

(DIN ISO 15488)

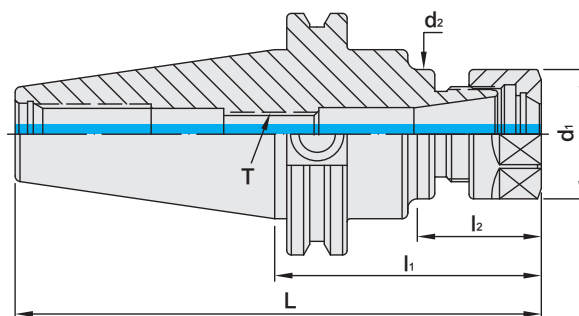

INCHES

MODEL NO.	TYPE	L	l ₁	l ₂	d ₁	d ₂	T	SIZE RANGE	WEIGHT (KGS)
5031-108-016-051	CAT40 x ER16A - 2"	4.687	2	1.211	1.102	1.1	M10 x 1.5P	0.062 ~ 0.406	1.00
5031-108-016-070	CAT40 x ER16A - 2.76"	5.442	2.76	1.280	1.102	1.1	M10 x 1.5P	0.062 ~ 0.406	1.05
5031-108-016-102	CAT40 x ER16A - 4"	6.687	4	2.135	1.102	1.1	M10 x 1.5P	0.062 ~ 0.406	1.35
5031-108-016-152	CAT40 x ER16A - 6"	8.687	6	4.135	1.102	1.1	M10 x 1.5P	0.062 ~ 0.406	1.65
5031-108-016-203	CAT40 x ER16A - 8"	10.687	8	6.135	1.102	1.1	M10 x 1.5P	0.062 ~ 0.406	1.85
5031-108-020-070	CAT40 x ER20A - 2.76"	5.442	2.76	1.280	1.339	1.34	M12 x 1.75P	0.0625 ~ 0.5	1.25
5031-108-020-102	CAT40 x ER20A - 4"	6.687	4	2.367	1.339	1.34	M12 x 1.75P	0.0625 ~ 0.5	1.65
5031-108-020-152	CAT40 x ER20A - 6"	8.687	6	4.334	1.339	1.34	M12 x 1.75P	0.0625 ~ 0.5	1.85
5031-110-025-070	CAT40 x ER25 - 2.76"	5.442	2.76	1.974	1.654	1.75	M16 x 2.0P	0.093 ~ 0.625	1.35
5031-110-025-102	CAT40 x ER25 - 4"	6.687	4	2.573	1.654	1.65	M16 x 2.0P	0.093 ~ 0.625	1.70
5031-110-025-152	CAT40 x ER25 - 6"	8.687	6	4.622	1.654	1.65	M16 x 2.0P	0.093 ~ 0.625	2.25
5031-110-025-203	CAT40 x ER25 - 8"	10.687	8	6.622	1.654	1.65	M16 x 2.0P	0.093 ~ 0.625	2.55
5031-110-032-070	CAT40 x ER32 - 2.76"	5.442	2.76	1.974	1.969	1.75	M16 x 2.0P	0.0625 ~ 0.75	1.16
5031-110-032-076	CAT40 x ER32 - 3"	5.687	3	2.219	1.969	1.75	M16 x 2.0P	0.0625 ~ 0.75	1.50
5031-110-032-102	CAT40 x ER32 - 4"	6.687	4	3.219	1.969	1.75	M16 x 2.0P	0.0625 ~ 0.75	1.75
5031-110-032-152	CAT40 x ER32 - 6"	8.687	6	5.219	1.969	1.75	M16 x 2.0P	0.0625 ~ 0.75	2.15
5031-110-032-203	CAT40 x ER32 - 8"	10.687	8	7.219	1.969	1.75	M16 x 2.0P	0.0625 ~ 0.75	2.70
5031-110-040-080	CAT40 x ER40 - 3.15"	5.837	3.15	2.368	2.48	1.75	M20 x 2.0P	0.125 ~ 1	1.25
5031-110-040-102	CAT40 x ER40 - 4"	6.687	4	2.543	2.48	2.36	M20 x 2.0P	0.125 ~ 1	1.80
5031-110-040-152	CAT40 x ER40 - 6"	8.687	6	4.543	2.48	2.36	M20 x 2.0P	0.125 ~ 1	2.90
5031-110-050-102	CAT40 x ER50 - 4"	6.687	4	2.543	3.07	2.523	M24 x 2.0P	0.219 ~ 1.313	2.65

Features:

- ▶ According to ISO 15488.
- ▶ This ER collet chuck has superior flexibility for use with all tool types, e.g. drills, taps, mills, reamers.
- ▶ It is recommended to tighten the clamping nuts using a torque wrench. Refer to the catalogue page of ER POWER GOOD NUT for the info of recommended tightening torque.

Product information:

- ▶ The pre-balance reaches G6.3 10,000 rpm. Higher balancing grade and revolution can be done upon request but additional charge is needed.
- ▶ AD+B type is available, please inform us when making an order.

Standard Accessory: • NUT

Collet	Nut	Pull Stud	Spanner	Torque Wrench Adapter (Pull Stud)	Spanner (Pull Stud)	Preset Screw
P.X-18~38	P.X-54~58	P.X-66	PX-73~76、79、82	P.X-77	P.X-78	P.X-111

CAT / ER COLLET CHUCK



CAT / ER 立銑刀夾頭

(DIN ISO 15488)

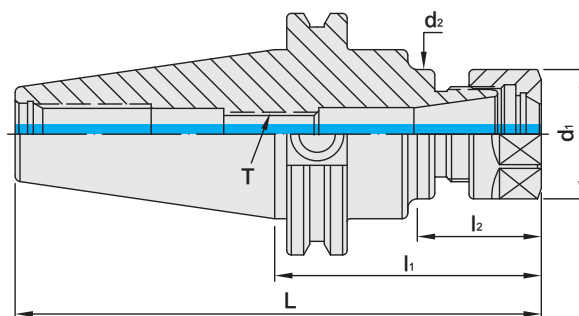

INCHES

MODEL NO.	TYPE	L	l ₁	l ₂	d ₁	d ₂	T	SIZE RANGE	WEIGHT (KGS)
5032-108-016-076	CAT50 x ER16A - 3"	7	3	1.425	1.102	1.1	M10 x 1.5P	0.062 ~ 0.406	4.05
5032-108-016-102	CAT50 x ER16A - 4"	8	4	2.065	1.102	1.1	M10 x 1.5P	0.062 ~ 0.406	4.20
5032-108-016-127	CAT50 x ER16A - 5"	9	5	3.065	1.102	1.1	M10 x 1.5P	0.062 ~ 0.406	4.30
5032-108-016-152	CAT50 x ER16A - 6"	10	6	4.147	1.102	1.1	M10 x 1.5P	0.062 ~ 0.406	4.40
5032-108-016-203	CAT50 x ER16A - 8"	12	8	6.147	1.102	1.1	M10 x 1.5P	0.062 ~ 0.406	4.50
5032-108-020-102	CAT50 x ER20A - 4"	8	4	2.065	1.339	1.34	M12 x 1.75P	0.0625 ~ 0.5	4.20
5032-108-020-152	CAT50 x ER20A - 6"	10	6	4.146	1.339	1.34	M12 x 1.75P	0.0625 ~ 0.5	4.45
5032-108-020-203	CAT50 x ER20A - 8"	12	8	6.065	1.339	1.34	M12 x 1.75P	0.0625 ~ 0.5	4.60
5032-110-025-102	CAT50 x ER25 - 4"	8	4	2.504	1.654	1.65	M16 x 2.0P	0.093 ~ 0.625	4.15
5032-110-025-152	CAT50 x ER25 - 6"	10	6	3.913	1.654	1.65	M16 x 2.0P	0.093 ~ 0.625	4.50
5032-110-025-203	CAT50 x ER25 - 8"	12	8	5.91	1.654	1.65	M16 x 2.0P	0.093 ~ 0.625	4.70
5032-110-032-102	CAT50 x ER32 - 4"	8	4	2.149	1.969	1.97	M16 x 2.0P	0.0625 ~ 0.75	4.35
5032-110-032-152	CAT50 x ER32 - 6"	10	6	4.152	1.969	1.97	M16 x 2.0P	0.0625 ~ 0.75	4.60
5032-110-032-203	CAT50 x ER32 - 8"	12	8	6.068	1.969	1.97	M16 x 2.0P	0.0625 ~ 0.75	4.90
5032-110-040-102	CAT50 x ER40 - 4"	8	4	2.347	2.48	2.36	M20 x 2.0P	0.125 ~ 1	5.26
5032-110-040-152	CAT50 x ER40 - 6"	10	6	4.428	2.48	2.36	M20 x 2.0P	0.125 ~ 1	6.36
5032-110-040-203	CAT50 x ER40 - 8"	12	8	6.428	2.48	2.36	M20 x 2.0P	0.125 ~ 1	5.10
5032-110-050-102	CAT50 x ER50 - 4"	8	4	3.219	3.07	2.75	M24 x 2.0P	0.219 ~ 1.313	4.85
5032-110-050-152	CAT50 x ER50 - 6"	10	6	5.219	3.07	2.75	M24 x 2.0P	0.219 ~ 1.313	5.55

Features:

- ▶ According to ISO 15488.
- ▶ This ER collet chuck has superior flexibility for use with all tool types, e.g. drills, taps, mills, reamers.
- ▶ It is recommended to tighten the clamping nuts using a torque wrench. Refer to the catalogue page of ER POWER GOOD NUT for the info of recommended tightening torque.

Product information:

- ▶ The pre-balance reaches G6.3 10,000 rpm. Higher balancing grade and revolution can be done upon request but additional charge is needed.
- ▶ AD+B type is available, please inform us when making an order.

Standard Accessory: • NUT

Collet	Nut	Pull Stud	Spanner	Torque Wrench Adapter (Pull Stud)	Spanner (Pull Stud)	Preset Screw
P.X-18~38	P.X-54~58	P.X-66	PX-73~76、79、82	P.X-77	P.X-78	P.X-111



CAT / ER COLLET CHUCK

M TYPE



M 型 CAT / ER 立銑刀夾頭

(DIN ISO 15488)

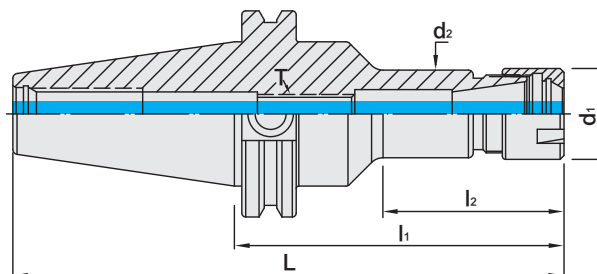

INCHES

MODEL NO.	TYPE	L	l ₁	l ₂	d ₁	d ₂	T	SIZE RANGE	WEIGHT (KGS)
5031-123-011-070	CAT40 x ER11M - 2.75"	5.437	2.75	1.175	0.63	0.59	M6 x 1.0P	0.0625 ~ 0.25	1.10
5031-123-011-102	CAT40 x ER11M - 4"	6.687	4	2.228	0.63	0.59	M6 x 1.0P	0.0625 ~ 0.25	1.20
5031-123-016-070	CAT40 x ER16M - 2.76"	5.447	2.76	1.323	0.87	0.83	M10 x 1.5P	0.0625 ~ 0.406	1.20
5031-123-016-102	CAT40 x ER16M - 4"	6.687	4	2.425	0.87	0.83	M10 x 1.5P	0.0625 ~ 0.406	1.30
5031-123-020-070	CAT40 x ER20M - 2.76"	5.447	2.76	1.323	1.102	1.06	M12 x 1.75P	0.0625 ~ 0.5	1.20
5031-123-020-102	CAT40 x ER20M - 4"	6.687	4	2.196	1.102	1.06	M12 x 1.75P	0.0625 ~ 0.5	1.50
5032-123-016-102	CAT50 x ER16M - 4"	8	4	1.927	0.87	0.83	M10 x 1.5P	0.0625 ~ 0.406	3.90
5032-123-016-152	CAT50 x ER16M - 6"	10	6	4.008	0.87	0.83	M10 x 1.5P	0.0625 ~ 0.406	4.00
5032-123-020-102	CAT50 x ER20M - 4"	8	4	2.127	1.102	1.06	M12 x 1.75P	0.0625 ~ 0.5	4.20
5032-123-020-152	CAT50 x ER20M - 6"	10	6	4.127	1.102	1.06	M12 x 1.75P	0.0625 ~ 0.5	5.20

Features:

- ▶ According to ISO 15488.
- ▶ This ER collet chuck has superior flexibility for use with all tool types, e.g. drills, taps, mills, reamers.
- ▶ It is recommended to tighten the clamping nuts using a torque wrench. Refer to the catalogue page of ER POWER GOOD NUT for the info of recommended tightening torque.

Product information:

- ▶ The pre-balance reaches G6.3 10,000 rpm. Higher balancing grade and revolution can be done upon request but additional charge is needed.
- ▶ AD+B type is available, please inform us when making an order.

Standard Accessory: • NUT

Collet	Nut	Pull Stud	Spanner	Torque Wrench Adapter (Pull Stud)	Spanner (Pull Stud)	Preset Screw
P.X-18~38	P.X-54~58	P.X-66	PX-73、74、79	P.X-77	P.X-78	P.X-111

CAT / ER SHORT LENGTH COLLET CHUCK



CAT / ER 短徑立銑刀夾頭

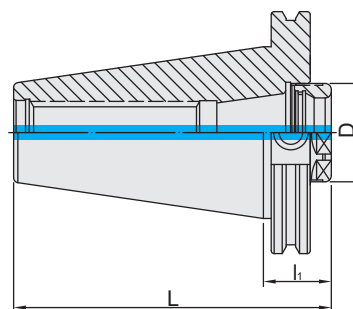

MODEL NO.	TYPE	L	l ₁	d ₁	SIZE RANGE	WEIGHT (KGS)
5031-125-016-023	CAT40 x ER16S	3.598	0.911	0.748	0.062~0.406	0.78
5031-125-020-028	CAT40 x ER20S	3.783	1.096	0.866	0.0625~0.5	0.76
5031-125-025-025	CAT40 x ER25S	3.657	0.97	0.984	0.093~0.625	0.69
5031-125-032-024	CAT40 x ER32S	3.65	0.963	1.417	0.0625~0.75	0.62
5032-125-016-023	CAT50 x ER16S	4.911	0.911	0.748	0.062~0.406	2.6
5032-125-020-028	CAT50 x ER20S	5.096	1.096	0.866	0.0625~0.5	2.56
5032-125-025-025	CAT50 x ER25S	4.97	0.97	0.984	0.093~0.625	2.49
5032-125-032-024	CAT50 x ER32S	4.963	0.963	1.417	0.0625~0.75	2.41



Features:

- ▶ Used with all ER collets.
- ▶ The front short design increases rigidity. Suitable for high speed or high torque processing.

Standard Accessory: • NUT

Collet	Nut	Pull Stud	Spanner	Torque Wrench Adapter (Pull Stud)	Spanner (Pull Stud)
P.X-18~38	P.X-55	P.X-66	P.X-79	P.X-73、77	P.X-78



CAT / SK3 COLLET CHUCK



CAT / SK3 高速機專用夾頭

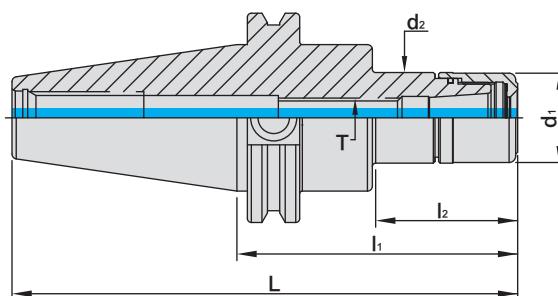

INCHES

MODEL NO.	TYPE	L	l ₁	l ₂	d ₁	d ₂	T	SIZE RANGE	WEIGHT (KGS)
5031-763-006-089	CAT40 x SK306 - 3.5"	6.187	3.5	1.468	0.768	0.768	M8 x 1.25P	0.125 ~ 0.25	1.05
5031-763-006-102	CAT40 x SK306 - 4"	6.687	4	1.968	0.768	0.768	M8 x 1.25P	0.125 ~ 0.25	1.65
5031-763-010-089	CAT40 x SK310 - 3.5"	6.187	3.5	2.062	1.083	1.083	M12 x 1.75P	0.125 ~ 0.375	1.05
5031-763-010-102	CAT40 x SK310 - 4"	6.687	4	2.562	1.083	1.083	M12 x 1.75P	0.125 ~ 0.375	1.65
5031-763-013-089	CAT40 x SK313 - 3.5"	6.187	3.5	2.004	1.299	1.299	M12 x 1.75P	0.125 ~ 0.5	1.05
5031-763-013-102	CAT40 x SK313 - 4"	6.687	4	2.504	1.299	1.299	M12 x 1.75P	0.125 ~ 0.5	1.65
5031-763-016-089	CAT40 x SK316 - 3.5"	6.187	3.5	2.034	1.575	1.575	M18 x 1.5P	0.125 ~ 0.625	1.35
5031-763-016-102	CAT40 x SK316 - 4"	6.687	4	2.534	1.575	1.575	M18 x 1.5P	0.125 ~ 0.625	2.10
5031-763-020-089	CAT40 x SK320 - 3.5"	6.187	3.5	2.12	1.89	1.91	M22 x 1.5P	0.125 ~ 0.75	1.60
5031-763-020-102	CAT40 x SK320 - 4"	6.687	4	2.62	1.89	1.91	M22 x 1.5P	0.125 ~ 0.75	2.00
5031-763-025-089	CAT40 x SK325 - 3.5"	6.187	3.5	2.12	2.17	2.17	M28 x 2.0P	0.125 ~ 1	1.70
5031-763-025-102	CAT40 x SK325 - 4"	6.687	4	2.62	2.17	2.17	M28 x 2.0P	0.125 ~ 1	1.80
5032-763-006-089	CAT50 x SK306 - 3.5"	7.5	3.5	1.728	0.768	0.768	M8 x 1.25P	0.125 ~ 0.25	3.60
5032-763-006-102	CAT50 x SK306 - 4"	8	4	2.228	0.768	0.768	M8 x 1.25P	0.125 ~ 0.25	4.00
5032-763-010-102	CAT50 x SK310 - 4"	8	4	2.562	1.083	1.083	M12 x 1.75P	0.125 ~ 0.375	3.80
5032-763-010-114	CAT50 x SK310 - 4.5"	8.5	4.5	2.044	1.083	1.083	M12 x 1.75P	0.125 ~ 0.375	4.00
5032-763-013-102	CAT50 x SK313 - 4"	8	4	2.425	1.299	1.299	M12 x 1.75P	0.125 ~ 0.5	3.80
5032-763-013-114	CAT50 x SK313 - 4.5"	8.5	4.5	2.925	1.299	1.299	M12 x 1.75P	0.125 ~ 0.5	4.00
5032-763-016-102	CAT50 x SK316 - 4"	8	4	2.425	1.575	1.575	M18 x 1.5P	0.125 ~ 0.625	4.00
5032-763-016-114	CAT50 x SK316 - 4.5"	8.5	4.5	2.945	1.575	1.575	M18 x 1.5P	0.125 ~ 0.625	4.15
5032-763-020-102	CAT50 x SK320 - 4"	8	4	2.504	1.89	1.91	M22 x 1.5P	0.125 ~ 0.75	4.30
5032-763-020-114	CAT50 x SK320 - 4.5"	8.5	4.5	3.004	1.89	1.91	M22 x 1.5P	0.125 ~ 0.75	4.60
5032-763-025-102	CAT50 x SK325 - 4"	8	4	2.17	2.17	2.17	M28 x 2.0P	0.125 ~ 1	4.50
5032-763-025-114	CAT50 x SK325 - 4.5"	8.5	4.5	2.67	2.17	2.17	M28 x 2.0P	0.125 ~ 1	4.80

Features:

- ▶ Using 4° taper angle collets achieves higher clamping power and stability than 8° design of the ER system.
- ▶ Smaller OD nuts without slots are ideal for high-speed machining with less interference.
- ▶ Dustproof design of adding O rings prevents metal chips and coolants from getting into tool holders

Product information:

- ▶ Higher balancing grade and revolution can be done upon request but additional charge is needed.
- ▶ AD+B type is available, please inform us when making an order.

Standard Accessory: • NUT

Collet	Nut	Pull Stud	Spanner	Torque Wrench Adapter (Pull Stud)	Spanner (Pull Stud)	Preset Screw
P.X-39~41	P.X-58	P.X-66	PX-73、75、76、81	P.X-77	P.X-78	P.X-111

CAT / SBL SLIM-FIT COLLET CHUCK



CAT / SBL 後拉式立銑刀夾頭

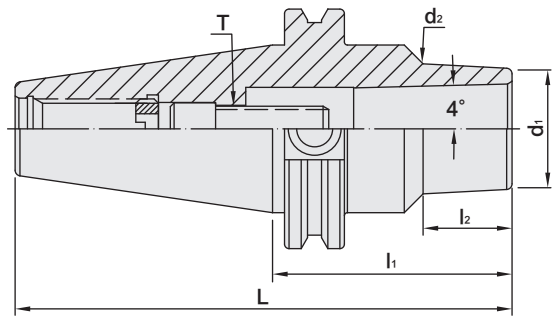

INCHES

MODEL NO.	TYPE	L	l ₁	l ₂	d ₁	d ₂	T	RECOMMENDED TORQUE		SIZE RANGE	WEIGHT (KGS)
								N.m	lbf-ft		
5031-648-006-076	CAT40 x SBL6 - 3"	5.687	3	1.09	0.55	0.65	M6 x 1.0P	12	9	0.125 ~ 0.25	1.00
5031-648-006-102	CAT40 x SBL6 - 4"	6.687	4	2.12	0.55	0.74	M6 x 1.0P	12	9	0.125 ~ 0.25	1.25
5031-648-006-152	CAT40 x SBL6 - 6"	8.687	6	4.17	0.55	0.92	M6 x 1.0P	12	9	0.125 ~ 0.25	1.20
5031-648-008-102	CAT40 x SBL8 - 4"	6.687	4	2.18	0.787	1.02	M8 x 1.25P	29	21	0.125 ~ 0.3125	1.13
5031-648-008-127	CAT40 x SBL8 - 5"	7.687	5	3.43	0.787	1.15	M8 x 1.25P	29	21	0.125 ~ 0.3125	1.24
5031-648-008-152	CAT40 x SBL8 - 6"	8.687	6	4.43	0.787	1.25	M8 x 1.25P	29	21	0.125 ~ 0.3125	1.39
5031-648-012-064	CAT40 x SBL12 - 2.5"	5.187	2.5	0.82	1.02	1.15	M10 x 1.5P	45	33	0.125 ~ 0.5	1.45
5031-648-012-102	CAT40 x SBL12 - 4"	6.687	4	2.23	1.02	1.26	M10 x 1.5P	45	33	0.125 ~ 0.5	1.20
5031-648-012-152	CAT40 x SBL12 - 6"	8.687	6	4.49	1.02	1.5	M10 x 1.5P	45	33	0.125 ~ 0.5	1.45
5031-648-020-064	CAT40 x SBL20 - 2.5"	5.187	2.5	0.98	1.38	1.46	M12 x 1.75P	60	44	0.125 ~ 0.75	1.20
5031-648-020-102	CAT40 x SBL20 - 4"	6.687	4	2.55	1.38	1.6	M12 x 1.75P	60	44	0.125 ~ 0.75	1.60
5031-648-020-152	CAT40 x SBL20 - 6"	8.687	6	4.26	1.38	-	M12 x 1.75P	60	44	0.125 ~ 0.75	1.50
5031-648-025-083	CAT40 x SBL25 - 3.25"	5.937	3.25	1.86	1.58	1.74	M16 x 2.0P	90	66	0.125 ~ 1	1.40
5031-648-025-102	CAT40 x SBL25 - 4"	6.687	4	2.01	1.58	-	M16 x 2.0P	90	66	0.125 ~ 1	1.60
5032-648-006-089	CAT50 x SBL6 - 3.5"	7.5	3.5	1.56	0.55	0.71	M6 x 1.0P	12	9	0.125 ~ 0.25	1.70
5032-648-006-114	CAT50 x SBL6 - 4.5"	8.5	4.5	2.38	0.55	0.8	M6 x 1.0P	12	9	0.125 ~ 0.25	1.50
5032-648-006-152	CAT50 x SBL6 - 6"	10	6	3.96	0.55	0.97	M6 x 1.0P	12	9	0.125 ~ 0.25	1.70
5032-648-008-102	CAT50 x SBL8 - 4"	8	4	2.25	0.787	1.02	M8 x 1.25P	29	21	0.125 ~ 0.3125	3.23
5032-648-008-127	CAT50 x SBL8 - 5"	9	5	3.25	0.787	1.13	M8 x 1.25P	29	21	0.125 ~ 0.3125	3.36
5032-648-008-152	CAT50 x SBL8 - 6"	10	6	4.25	0.787	1.23	M8 x 1.25P	29	21	0.125 ~ 0.3125	3.51
5032-648-012-064	CAT50 x SBL12 - 2.5"	6.5	2.5	0.93	1.02	1.11	M10 x 1.5P	45	33	0.125 ~ 0.5	4.00
5032-648-012-114	CAT50 x SBL12 - 4.5"	8.5	4.5	2.75	1.02	1.27	M10 x 1.5P	45	33	0.125 ~ 0.5	4.10
5032-648-012-152	CAT50 x SBL12 - 6"	10	6	4.25	1.02	1.4	M10 x 1.5P	45	33	0.125 ~ 0.5	4.20
5032-648-020-064	CAT50 x SBL20 - 2.5"	6.5	2.5	0.75	1.38	1.44	M12 x 1.75P	60	44	0.125 ~ 0.75	4.30
5032-648-020-114	CAT50 x SBL20 - 4.5"	8.5	4.5	2.75	1.38	1.62	M12 x 1.75P	60	44	0.125 ~ 0.75	4.60
5032-648-020-152	CAT50 x SBL20 - 6"	10	6	4.12	1.38	1.74	M12 x 1.75P	60	44	0.125 ~ 0.75	4.70
5032-648-025-070	CAT50 x SBL25 - 2.75"	6.75	2.75	1.18	1.58	1.69	M16 x 2.0P	90	66	0.125 ~ 1	4.40
5032-648-025-114	CAT50 x SBL25 - 4.5"	8.5	4.5	2.93	1.58	1.84	M16 x 2.0P	90	66	0.125 ~ 1	4.60

Features:

- ▶ The design of non-clamping nut and slim front ends reduces interference, ideal for deep hole machining.
- ▶ Taper angle 4° increases the stability of clamping precision.
- ▶ T.I.R. is within 5µm at 4D distance.

Product information:

- ▶ Higher balancing grade and revolution can be done upon request but additional charge is needed.

Collet	Pull Stud	Torque Wrench Adapter (Pull Stud)	Spanner (Pull Stud)	Spanner	Screw
P.X-42	P.X-66	P.X-73、77	P.X-78	P.X-80	P.X-114



CAT / SBLC SLIM-FIT COLLET CHUCK



CAT / SBLC 後拉式立銑刀夾頭

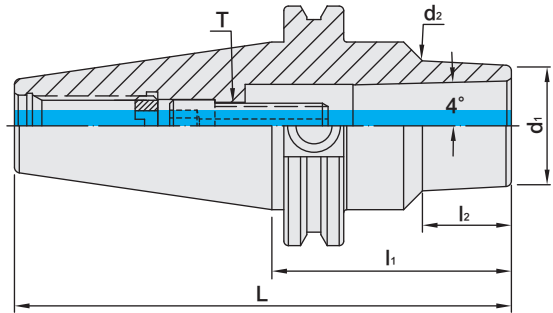

INCHES

MODEL NO.	TYPE	L	l ₁	l ₂	d ₁	d ₂	T	RECOMMENDED TORQUE		SIZE RANGE	WEIGHT (KGS)
								N.m	lbf-ft		
5031-623-006-076	CAT40 x SBLC6 - 3"	5.687	3	1.09	0.55	0.65	M6 x 1.0P	12	9	0.125 ~ 0.25	1.00
5031-623-006-102	CAT40 x SBLC6 - 4"	6.687	4	2.12	0.55	0.74	M6 x 1.0P	12	9	0.125 ~ 0.25	1.25
5031-623-006-152	CAT40 x SBLC6 - 6"	8.687	6	4.17	0.55	0.92	M6 x 1.0P	12	9	0.125 ~ 0.25	1.20
5031-623-008-102	CAT40 x SBLC8 - 4"	6.687	4	2.18	0.787	1.02	M8 x 1.25P	29	21	0.125 ~ 0.3125	1.13
5031-623-008-127	CAT40 x SBLC8 - 5"	7.687	5	3.43	0.787	1.15	M8 x 1.25P	29	21	0.125 ~ 0.3125	1.24
5031-623-008-152	CAT40 x SBLC8 - 6"	8.687	6	4.43	0.787	1.25	M8 x 1.25P	29	21	0.125 ~ 0.3125	1.39
5031-623-012-064	CAT40 x SBLC12 - 2.5"	5.187	2.5	0.82	1.02	1.15	M10 x 1.5P	45	33	0.125 ~ 0.5	1.45
5031-623-012-102	CAT40 x SBLC12 - 4"	6.687	4	2.23	1.02	1.26	M10 x 1.5P	45	33	0.125 ~ 0.5	1.20
5031-623-012-152	CAT40 x SBLC12 - 6"	8.687	6	4.49	1.02	1.5	M10 x 1.5P	45	33	0.125 ~ 0.5	1.45
5031-623-020-064	CAT40 x SBLC20 - 2.5"	5.187	2.5	0.98	1.38	1.46	M12 x 1.75P	60	44	0.125 ~ 0.75	1.20
5031-623-020-102	CAT40 x SBLC20 - 4"	6.687	4	2.55	1.38	1.6	M12 x 1.75P	60	44	0.125 ~ 0.75	1.60
5031-623-020-152	CAT40 x SBLC20 - 6"	8.687	6	4.26	1.38	-	M12 x 1.75P	60	44	0.125 ~ 0.75	1.50
5031-623-025-083	CAT40 x SBLC25 - 3.25"	5.937	3.25	1.86	1.58	1.74	M16 x 2.0P	90	66	0.125 ~ 1	1.40
5031-623-025-102	CAT40 x SBLC25 - 4"	6.687	4	2.01	1.58	-	M16 x 2.0P	90	66	0.125 ~ 1	1.60
5032-623-006-089	CAT50 x SBLC6 - 3.5"	7.5	3.5	1.56	0.55	0.71	M6 x 1.0P	12	9	0.125 ~ 0.25	1.70
5032-623-006-114	CAT50 x SBLC6 - 4.5"	8.5	4.5	2.38	0.55	0.8	M6 x 1.0P	12	9	0.125 ~ 0.25	1.50
5032-623-006-152	CAT50 x SBLC6 - 6"	10	6	3.96	0.55	0.97	M6 x 1.0P	12	9	0.125 ~ 0.25	1.70
5032-623-008-102	CAT50 x SBLC8 - 4"	8	4	2.25	0.787	1.02	M8 x 1.25P	29	21	0.125 ~ 0.3125	3.23
5032-623-008-127	CAT50 x SBLC8 - 5"	9	5	3.25	0.787	1.13	M8 x 1.25P	29	21	0.125 ~ 0.3125	3.36
5032-623-008-152	CAT50 x SBLC8 - 6"	10	6	4.25	0.787	1.23	M8 x 1.25P	29	21	0.125 ~ 0.3125	3.51
5032-623-012-064	CAT50 x SBLC12 - 2.5"	6.5	2.5	0.93	1.02	1.11	M10 x 1.5P	45	33	0.125 ~ 0.5	4.00
5032-623-012-114	CAT50 x SBLC12 - 4.5"	8.5	4.5	2.75	1.02	1.27	M10 x 1.5P	45	33	0.125 ~ 0.5	4.10
5032-623-012-152	CAT50 x SBLC12 - 6"	10	6	4.25	1.02	1.4	M10 x 1.5P	45	33	0.125 ~ 0.5	4.20
5032-623-020-064	CAT50 x SBLC20 - 2.5"	6.5	2.5	0.75	1.38	1.44	M12 x 1.75P	60	44	0.125 ~ 0.75	4.30
5032-623-020-114	CAT50 x SBLC20 - 4.5"	8.5	4.5	2.75	1.38	1.62	M12 x 1.75P	60	44	0.125 ~ 0.75	4.60
5032-623-020-152	CAT50 x SBLC20 - 6"	10	6	4.12	1.38	1.74	M12 x 1.75P	60	44	0.125 ~ 0.75	4.70
5032-623-025-070	CAT50 x SBLC25 - 2.75"	6.75	2.75	1.18	1.58	1.69	M16 x 2.0P	90	66	0.125 ~ 1	4.40
5032-623-025-114	CAT50 x SBLC25 - 4.5"	8.5	4.5	2.93	1.58	1.84	M16 x 2.0P	90	66	0.125 ~ 1	4.60

Features:

- ▶ SBLC collet chuck used for center coolant improves the metal chip removal capability and the surface finish of the workpiece.
- ▶ The design of non-clamping nut and slim front ends reduces interference, ideal for deep hole machining.
- ▶ T.I.R. is within 5µm at 4D distance.

Product information:

- ▶ Higher balancing grade and revolution can be done upon request but additional charge is needed.
- ▶ AD+B type is available, please inform us when making an order.
- ▶ Used with SLC sealed collet and coolant through cutters.

Standard Accessory: • SPANNER

Collet	Pull Stud	Torque Wrench Adapter (Pull Stud)	Spanner (Pull Stud)	Spanner	Screw
P.X-43	P.X-66	P.X-73、77	P.X-78	P.X-80	P.X-114

CAT / EBL SLIM-FIT COLLET CHUCK

5 μ m
BALANCE
G2.5
25,000 RPM

CAT / EBL 後拉式刀桿

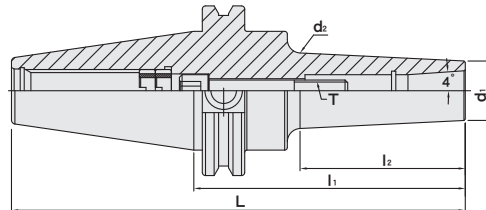

INCHES

MODEL NO.	TYPE	L	l ₁	l ₂	d ₁	d ₂	T	RECOMMENDED TORQUE		SIZE RANGE	WEIGHT (KGS)
								N.m	lbf-ft		
5031-277-006-076	CAT40 x EBL6 - 3"	5.687	3	1.43	0.75	0.89	M6 x 1.0P	12	9	0.125 ~ 0.25	1.10
5031-277-006-102	CAT40 x EBL6 - 4"	6.687	4	2.43	0.75	0.98	M6 x 1.0P	12	9	0.125 ~ 0.25	1.19
5031-277-006-152	CAT40 x EBL6 - 6"	8.687	6	4.43	0.75	1.18	M6 x 1.0P	12	9	0.125 ~ 0.25	1.42
5031-277-008-076	CAT40 x EBL8 - 3"	5.687	3	1.43	0.875	1.01	M8 x 1.25P	29	21	0.125 ~ 0.3125	1.08
5031-277-008-102	CAT40 x EBL8 - 4"	6.687	4	2.43	0.875	1.11	M8 x 1.25P	29	21	0.125 ~ 0.3125	1.23
5031-277-008-152	CAT40 x EBL8 - 6"	8.687	6	4.50	0.875	1.31	M8 x 1.25P	29	21	0.125 ~ 0.3125	1.46
5032-277-006-076	CAT50 x EBL6 - 3"	7	3	1.24	0.75	0.87	M6 x 1.0P	12	9	0.125 ~ 0.25	3.19
5032-277-006-102	CAT50 x EBL6 - 4"	8	4	2.24	0.75	0.9	M6 x 1.0P	12	9	0.125 ~ 0.25	3.21
5032-277-006-152	CAT50 x EBL6 - 6"	10	6	4.24	0.75	1.16	M6 x 1.0P	12	9	0.125 ~ 0.25	3.49
5032-277-008-076	CAT50 x EBL8 - 3"	7	3	1.24	0.875	0.96	M8 x 1.25P	29	21	0.125 ~ 0.3125	3.16
5032-277-008-102	CAT50 x EBL8 - 4"	8	4	2.24	0.875	1.092	M8 x 1.25P	29	21	0.125 ~ 0.3125	3.23
5032-277-008-152	CAT50 x EBL8 - 6"	10	6	4.24	0.875	1.29	M8 x 1.25P	29	21	0.125 ~ 0.3125	3.49



▶ SBL



▶ EBL

Features:

- ▶ EBL collet with extended length shortens tool overhanging length and improves the machining stability.
- ▶ The optimized design of thicker neck improves the machining rigidity and eliminates vibration, resulting in excellent surface finish of workpiece.

Standard Accessory: ● SPANNER

Collet	Pull Stud	Torque Wrench Adapter (Pull Stud)	Spanner (Pull Stud)	Spanner	Screw
P.X-44	P.X-66	P.X-73、77	P.X-78	P.X-80	P.X-114



CAT / EBLC SLIM-FIT COLLET CHUCK

5 μ m
BALANCE
G2.5
25,000 RPM

CAT / EBLC 後拉式刀桿

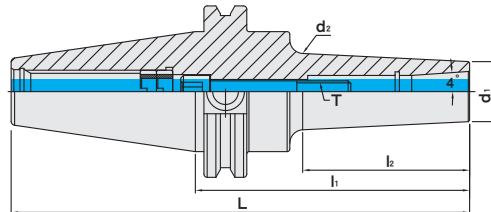

INCHES

MODEL NO.	TYPE	L	l ₁	l ₂	d ₁	d ₂	T	RECOMMENDED TORQUE		SIZE RANGE	WEIGHT (KGS)
								N.m	lbf-ft		
5031-195-006-076	CAT40 x EBLC6 - 3"	5.687	3	1.43	0.75	0.89	M6 x 1.0P	12	9	0.125 ~ 0.25	1.1
5031-195-006-102	CAT40 x EBLC6 - 4"	6.687	4	2.43	0.75	0.98	M6 x 1.0P	12	9	0.125 ~ 0.25	1.19
5031-195-006-152	CAT40 x EBLC6 - 6"	8.687	6	4.43	0.75	1.18	M6 x 1.0P	12	9	0.125 ~ 0.25	1.42
5031-195-008-076	CAT40 x EBLC8 - 3"	5.687	3	1.43	0.875	1.01	M8 x 1.25P	29	21	0.125 ~ 0.3125	1.08
5031-195-008-102	CAT40 x EBLC8 - 4"	6.687	4	2.43	0.875	1.11	M8 x 1.25P	29	21	0.125 ~ 0.3125	1.23
5031-195-008-152	CAT40 x EBLC8 - 6"	8.687	6	4.5	0.875	1.31	M8 x 1.25P	29	21	0.125 ~ 0.3125	1.46
5032-195-006-076	CAT50 x EBLC6 - 3"	7	3	1.24	0.75	0.87	M6 x 1.0P	12	9	0.125 ~ 0.25	3.19
5032-195-006-102	CAT50 x EBLC6 - 4"	8	4	2.24	0.75	0.9	M6 x 1.0P	12	9	0.125 ~ 0.25	3.21
5032-195-006-152	CAT50 x EBLC6 - 6"	10	6	4.24	0.75	1.16	M6 x 1.0P	12	9	0.125 ~ 0.25	3.49
5032-195-008-076	CAT50 x EBLC8 - 3"	7	3	1.24	0.875	0.96	M8 x 1.25P	29	21	0.125 ~ 0.3125	3.16
5032-195-008-102	CAT50 x EBLC8 - 4"	8	4	2.24	0.875	1.092	M8 x 1.25P	29	21	0.125 ~ 0.3125	3.23
5032-195-008-152	CAT50 x EBLC8 - 6"	10	6	4.24	0.875	1.29	M8 x 1.25P	29	21	0.125 ~ 0.3125	3.49



▶ SBLC



▶ EBLC

Features:

- ▶ EBLC collet chuck used for center coolant improves the metal chip removal capability and the surface finish of the workpiece.
- ▶ EBL sealed collet with extended length shortens tool overhanging length and improves the machining stability.
- ▶ The optimized design of thicker neck improves the machining rigidity and eliminates vibration, resulting in excellent surface finish of workpiece.
- ▶ EBL sealed collet is capable of coolant pressure up to 25bar.

Standard Accessory: •SPANNER

Collet	Pull Stud	Torque Wrench Adapter (Pull Stud)	Spanner (Pull Stud)	Spanner	Screw
P.X-44	P.X-66	P.X-73、77	P.X-78	P.X-80	P.X-114



CAT / HBL SLIM-FIT COLLET CHUCK



CAT / HBL 後拉式立銑刀夾頭

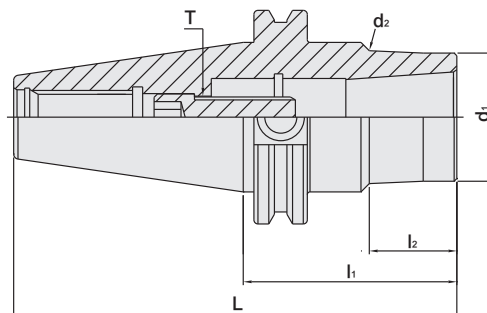

INCHES

MODEL NO.	TYPE	L	l ₁	l ₂	d ₁	d ₂	T	WEIGHT (KGS)
5031-275-012-064	CAT40 x HBL12 - 2.5"	5.187	2.5	0.89	1.25	1.29	M10 x 1.5P	1.65
5031-275-012-102	CAT40 x HBL12 - 4"	6.687	4	2.46	1.25	1.43	M10 x 1.5P	1.40
5031-275-020-064	CAT40 x HBL20 - 2.5"	5.187	2.5	1.02	1.5	1.56	M12 x 1.75P	1.40
5031-275-020-102	CAT40 x HBL20 - 4"	6.687	4	2.59	1.5	1.69	M12 x 1.75P	1.80
5031-275-025-083	CAT40 x HBL25 - 3.25"	5.937	3.25	1.81	1.75	1.874	M16 x 1.5P	1.60
5031-275-025-102	CAT40 x HBL25 - 4"	6.687	4	2.529	1.75	1.936	M16 x 1.5P	1.80
5032-275-012-064	CAT50 x HBL12 - 2.5"	6.5	2.5	1.12	1.25	1.30	M10 x 1.5P	4.20
5032-275-012-114	CAT50 x HBL12 - 4.5"	8.5	4.5	2.75	1.25	1.46	M10 x 1.5P	4.30
5032-275-020-064	CAT50 x HBL20 - 2.5"	6.5	2.5	0.93	1.5	1.55	M12 x 1.75P	4.50
5032-275-020-114	CAT50 x HBL20 - 4.5"	8.5	4.5	2.93	1.5	1.72	M12 x 1.75P	4.80
5032-275-025-070	CAT50 x HBL25 - 2.75"	6.75	2.75	1.316	1.75	1.831	M16 x 1.5P	4.60
5032-275-025-114	CAT50 x HBL25 - 4.5"	8.5	4.5	3.066	1.75	1.983	M16 x 1.5P	4.80

HLB Cutter for HBL Slim-Fit Collet Chuck

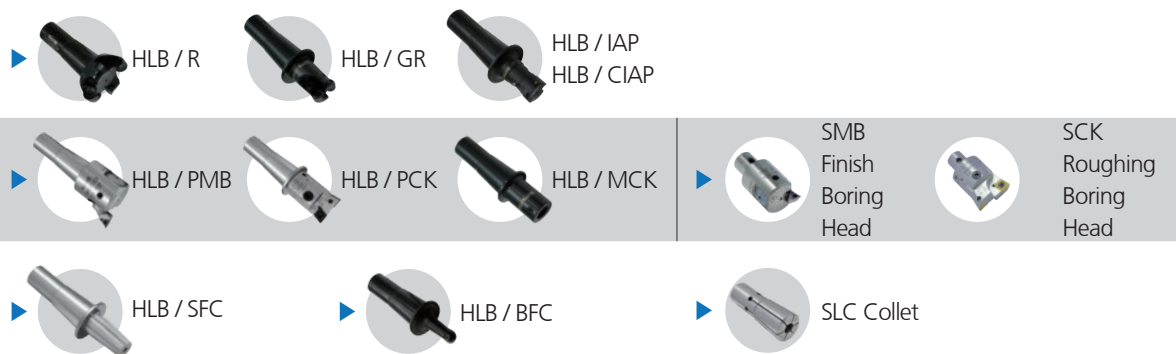

Features:

- ▶ Two-face contact between collet taper, collet flange and the end of HBL tool holder, increases the rigidity of machining.
- ▶ Modular system, assembled with HLB tools.
- ▶ HBL drawbar clamping design strengthens the axial clamping force.

Product information:

- ▶ When assembling with coolant through HLB cutter SLC sealed collet, please change the screw into coolant screw, which is available to order separately.
- ▶ Higher balancing grade and revolution can be done upon request but additional charge is needed.
- ▶ AD+B type is available, please inform us when making an order.

SLC Collet	Pull Stud	Torque Wrench Adapter (Pull Stud)	Spanner (Pull Stud)	Spanner	HLB Cutter	Screw
P.X-42~43	P.X-66	P.X-73、77	P.X-78	P.X-80	P.X-83~97	P.X-114



CAT / MLD MULTI - LOCK MILLING CHUCK

CAT / MLD 直式筒夾 銑床夾頭



台灣精品 2007
TAIWAN EXCELLENCE

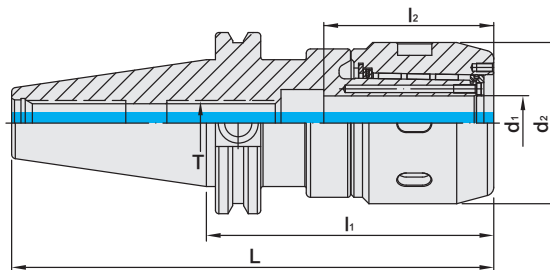

INCHES

MODEL NO.	TYPE	L	l ₁	l ₂	d ₁	d ₂	T	WEIGHT (KGS)
5031-460-A32-335	CAT40 x MLD1/2" - 3.35"	6.03	3.35	1.84	0.5	1.654	M12 x 1.75P	1.80
5031-460-A40-350	CAT40 x MLD5/8" - 3.5"	6.187	3.5	2.23	0.625	1.889	M12 x 1.75P	1.90
5031-460-A48-400	CAT40 x MLD3/4" - 4"	6.687	4	2.34	0.75	2.224	5/8" - 11	1.90
5031-460-A48-600	CAT40 x MLD3/4" - 6"	8.687	6	2.34	0.75	2.224	5/8" - 11	2.10
5031-460-A64-400	CAT40 x MLD1" - 4"	6.687	4	2.49	1	2.362	5/8" - 11	2.00
5031-460-A72-420	CAT40 x MLD1-1/4" - 4.2"	6.887	4.2	2.8	1.25	2.795	5/8" - 11	2.50
5031-460-A72-600	CAT40 x MLD1-1/4" - 6"	8.687	6	2.8	1.25	2.795	5/8" - 11	2.70
5032-460-A32-350	CAT50 x MLD1/2" - 3.5"	7.5	3.5	1.84	0.5	1.654	M12 x 1.75P	2.50
5032-460-A40-350	CAT50 x MLD5/8" - 3.5"	7.5	3.5	2.23	0.625	1.889	M12 x 1.75P	2.70
5032-460-A48-400	CAT50 x MLD3/4" - 4"	8	4	2.34	0.75	2.224	5/8" - 11	2.50
5032-460-A48-600	CAT50 x MLD3/4" - 6"	10	6	2.34	0.75	2.224	5/8" - 11	2.80
5032-460-A64-400	CAT50 x MLD1" - 4"	8	4	2.49	1	2.362	5/8" - 11	2.90
5032-460-A72-413	CAT50 x MLD1-1/4" - 4.13"	8.13	4.13	2.8	1.25	2.795	1" - 8	2.70
5032-460-A72-600	CAT50 x MLD1-1/4" - 6"	10	6	2.8	1.25	2.795	5/8" - 11	3.00

Features:

- ▶ The special slotted design of the internal hole increases the clamping force and decreases vibration, making this milling chuck set suitable for heavy-duty machining.
- ▶ Collet runout accuracy: HSC collet 5μm and SSC collet 20μm two options to choose from.
- ▶ After fastening, the nuts and tool holders contact tight to enhance the cutting rigidity and achieve dustproof purposes.
- ▶ Coolant options: through the center of the holder or cutter. Use a sealed cap and SR ring for coolant through the cutter.

Product information:

- ▶ The pre-balance reaches G6.3 8,000 rpm. Higher balancing grade and revolution can be done upon request but additional charge is needed.
- ▶ AD+B type is available, please inform us when making an order.

Standard Accessory: • NUT

Collet	Sealed Cap	SR Sealed Ring	Pull Stud	Torque Wrench Adapter (Pull Stud)	Spanner (Pull Stud)	Spanner	Spanner	Set Screw
P.X-46~47	P.X-62	P.X-63	P.X-66	P.X-73、77	P.X-78	P.X-79~80	P.X-82	P.X-111

CAT / EOC COLLET CHUCK



CAT / EOC 立銑刀夾頭

(DIN ISO 10897)

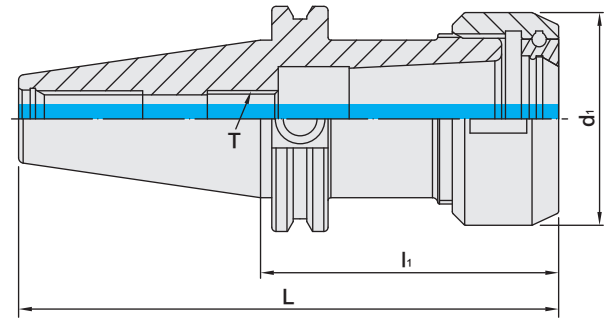

INCHES

MODEL NO.	TYPE	L	l ₁	d ₁	T	SIZE RANGE	WEIGHT (KGS)
5031-121-025-080	CAT40 x EOC25 - 3.15"	5.837	3.15	2.362	M16 x 2.0P	0.125 ~ 1	1.55
5031-121-025-102	CAT40 x EOC25 - 4"	6.687	4	2.362	M16 x 2.0P	0.125 ~ 1	2.55
5031-121-032-080	CAT40 x EOC32 - 3.15"	5.837	3.15	2.835	M16 x 2.0P	0.125 ~ 1.25	1.95
5031-121-032-102	CAT40 x EOC32 - 4"	6.687	4	2.835	M16 x 2.0P	0.125 ~ 1.25	2.35
5032-121-025-080	CAT50 x EOC25 - 3.15"	7.15	3.15	2.362	M16 x 2.0P	0.125 ~ 1	3.25
5032-121-025-102	CAT50 x EOC25 - 4"	8	4	2.362	M16 x 2.0P	0.125 ~ 1	5.30
5032-121-025-152	CAT50 x EOC25 - 6"	10	6	2.362	M16 x 2.0P	0.125 ~ 1	4.40
5032-121-032-080	CAT50 x EOC32 - 3.15"	7.15	3.15	2.835	M24 x 2.0P	0.125 ~ 1.25	5.70
5032-121-032-119	CAT50 x EOC32 - 4.7"	8.7	4.7	2.835	M24 x 2.0P	0.125 ~ 1.25	6.10

Features:

- ▶ Attached with POWER GOOD EOC clamping nuts, good clamping force, and suitable for heavy-duty machining.
- ▶ Used with DIN 6388 EOC and SYOZ collets.
- ▶ Standard tool kits of 7PC and 15PC are available.

Product information:

- ▶ The pre-balance reaches G6.3 10,000 rpm. Higher balancing grade and revolution can be done upon request but additional charge is needed.

Standard Accessory: • NUT

Collet	Nut	Pull Stud	Spanner	Torque Wrench Adapter (Pull Stud)	Spanner (Pull Stud)	Preset Screw
P.X-49	P.X-61	P.X-66	P.X-73-74、80	P.X-77	P.X-78	P.X-111



CAT / TG COLLET CHUCK



CAT / TG 立銑刀夾頭

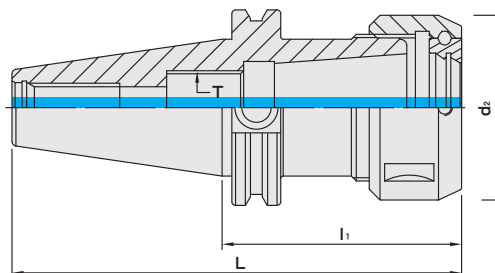

INCHES

MODEL NO.	TYPE	L	l ₁	d ₂	T	SIZE RANGE	WEIGHT (KGS)
5031-691-075-070	CAT40 x TG75 - 2.75"	5.437	2.75	1.968	M16 x 2.0P	0.094 ~ 0.75	1.20
5031-691-075-102	CAT40 x TG75 - 4"	6.687	4	1.968	M16 x 2.0P	0.094 ~ 0.75	1.40
5031-691-075-127	CAT40 x TG75 - 5"	7.687	5	1.968	M16 x 2.0P	0.094 ~ 0.75	1.60
5031-691-100-076	CAT40 x TG100 - 3"	5.687	3	2.362	M24 x 2.0P	0.094 ~ 1	1.20
5031-691-100-102	CAT40 x TG100 - 4"	6.687	4	2.362	M24 x 2.0P	0.094 ~ 1	1.40
5031-691-100-152	CAT40 x TG100 - 6"	8.687	6	2.362	M24 x 2.0P	0.094 ~ 1	2.55
5031-691-150-127	CAT40 x TG150 - 5"	7.687	5	3.228	M24 x 2.0P	0.156 ~ 1.5	2.90
5031-691-150-152	CAT40 x TG150 - 6"	8.687	6	3.228	M24 x 2.0P	0.156 ~ 1.5	3.70
5032-691-100-076	CAT50 x TG100 - 3"	7	3	2.362	M24 x 2.0P	0.094 ~ 1	3.25
5032-691-100-102	CAT50 x TG100 - 4"	8	4	2.362	M24 x 2.0P	0.094 ~ 1	4.40
5032-691-100-152	CAT50 x TG100 - 6"	10	6	2.362	M24 x 2.0P	0.094 ~ 1	5.30
5032-691-150-127	CAT50 x TG150 - 5"	9	5	3.228	M24 x 2.0P	0.156 ~ 1.5	5.70
5032-691-150-152	CAT50 x TG150 - 6"	10	6	3.228	M24 x 2.0P	0.156 ~ 1.5	6.10
5032-691-150-178	CAT50 x TG150 - 7"	11	7	3.228	M24 x 2.0P	0.156 ~ 1.5	6.50

Features:

- ▶ Using with 4.1751° taper angle TG collets enables better clamping force than 8° ER collets.
- ▶ Design of square threads for POWER GOOD nuts allows high clamping torque, suitable for heavy-duty machining.
- ▶ TG sealed collets are available for coolant through tools.

Product information:

- ▶ The pre-balance reaches G6.3 10,000 rpm. Higher balancing grade and revolution can be done upon request but additional charge is needed.

Standard Accessory: • NUT

Collet	Nut	Pull Stud	Spanner	Torque Wrench Adapter (Pull Stud)	Spanner (Pull Stud)	Preset Screw
P.X-50~52	P.X-61	P.X-66	P.X-80	P.X-73、77	P.X-78	P.X-111

CAT / SAF RUNOUT ADJUSTABLE HOLDER

4.5°

CAT / SAF 可調式刀桿

[SFC TYPE]

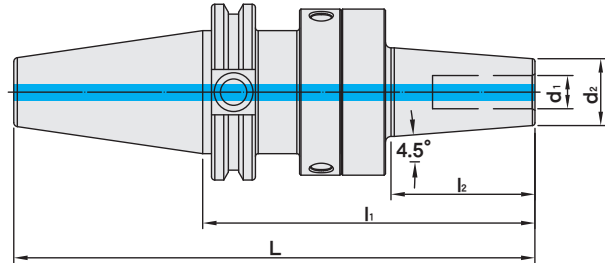

J P PAT NO. 3237773
DE PAT NO. 202022102696
CN PAT NO. ZL202221891039.3

MODEL NO.	TYPE	L	l ₁	l ₂	d ₁	d ₂	COMBINATION		WEIGHT (KGS)
							BODY	FLANGE ADAPTER	
5031-S27-006-120	CAT40 x SAF6C - 120	188.249	120	52	6	21	CAT40 x SAF25	SFC6 - 70	1.71
5031-S27-008-120	CAT40 x SAF8C - 120	188.249	120	52	8	21	CAT40 x SAF25	SFC8 - 70	1.70
5031-S27-010-120	CAT40 x SAF10C - 120	188.249	120	52	10	24	CAT40 x SAF25	SFC10 - 70	1.75
5031-S27-012-120	CAT40 x SAF12C - 120	188.249	120	52	12	24	CAT40 x SAF25	SFC12 - 70	1.73
5031-S27-016-125	CAT40 x SAF16C - 125	193.249	125	57	16	27	CAT40 x SAF25	SFC16 - 75	1.78
5031-S27-020-140	CAT40 x SAF20C - 140	208.249	140	60	20	33	CAT40 x SAF40	SFC20 - 80	2.90
5031-S27-025-160	CAT40 x SAF25C - 160	228.249	160	81	25	44	CAT40 x SAF40	SFC25 - 100	3.43
5031-S27-032-160	CAT40 x SAF32C - 160	228.249	160	81	32	44	CAT40 x SAF40	SFC32 - 100	3.29
5032-S27-006-130	CAT50 x SAF6C - 130	231.6	130	52	6	21	CAT50 x SAF25	SFC6 - 70	3.98
5032-S27-008-130	CAT50 x SAF8C - 130	231.6	130	52	8	21	CAT50 x SAF25	SFC8 - 70	3.97
5032-S27-010-130	CAT50 x SAF10C - 130	231.6	130	52	10	24	CAT50 x SAF25	SFC10 - 70	4.02
5032-S27-012-130	CAT50 x SAF12C - 130	231.6	130	52	12	24	CAT50 x SAF25	SFC12 - 70	4.00
5032-S27-016-135	CAT50 x SAF16C - 135	236.6	135	57	16	27	CAT50 x SAF25	SFC16 - 75	4.05
5032-S27-020-140	CAT50 x SAF20C - 140	241.6	140	60	20	33	CAT50 x SAF40	SFC20 - 80	4.96
5032-S27-025-160	CAT50 x SAF25C - 160	261.6	160	81	25	44	CAT50 x SAF40	SFC25 - 100	5.49
5032-S27-032-160	CAT50 x SAF32C - 160	261.6	160	81	32	44	CAT50 x SAF40	SFC32 - 100	5.35

Features:

- ▶ The runout accuracy of tool edges can be adjusted within 5µm.
- ▶ Different output options to meet customer machining requirements.
- ▶ Suitable for reaming, drilling and milling.

Standard Accessory: • WRENCH (FOR ADJUSTMENT SCREW) • PIN

Pull Stud	Torque Wrench Adapter (Pull Stud)	Spanner (Pull Stud)	Shrink Fit Chuck Flange	Preset Screw
P.X-66	P.X-73、77	P.X-78	P.X-98	P.X-111



CAT / SAF RUNOUT ADJUSTABLE HOLDER

CAT / SAF 可調式刀桿

[SK3 TYPE]



J P PAT NO. 3237773
DE PAT NO. 202022102696
CN PAT NO. ZL202221891039.3

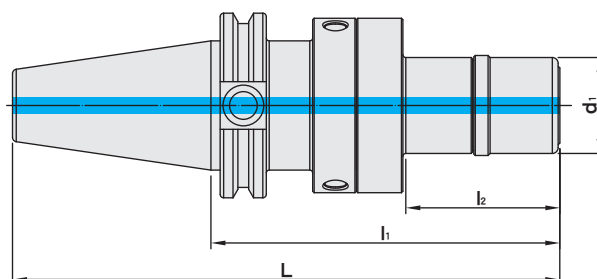

MODEL NO.	TYPE	L	l ₁	l ₂	d ₁	COMBINATION		COLLET	WEIGHT (KGS)
						BODY	FLANGE ADAPTER		
5031-S28-006-100	CAT40 x SAF6K - 100	168.249	100	29	19.5	CAT40 x SAF25	SK306 - 50	SKX6	1.58
5031-S28-006-150	CAT40 x SAF6K - 150	218.249	150	79	19.5	CAT40 x SAF25	SK306 - 100	SKX6	1.67
5031-S28-010-100	CAT40 x SAF10K - 100	168.249	100	32.5	27.5	CAT40 x SAF25	SK310 - 50	SKX10	1.61
5031-S28-010-150	CAT40 x SAF10K - 150	218.249	150	82.5	27.5	CAT40 x SAF25	SK310 - 100	SKX10	1.80
5031-S28-013-120	CAT40 x SAF13K - 120	188.249	120	53	33	CAT40 x SAF25	SK313 - 70	SKX13	1.74
5031-S28-013-150	CAT40 x SAF13K - 150	218.249	150	83	33	CAT40 x SAF25	SK313 - 100	SKX13	1.92
5031-S28-016-130	CAT40 x SAF16K - 130	198.249	130	49.9	40	CAT40 x SAF40	SK316 - 70	SKX16	2.79
5031-S28-016-160	CAT40 x SAF16K - 160	228.249	160	79.9	40	CAT40 x SAF40	SK316 - 100	SKX16	3.05
5032-S28-006-110	CAT50 x SAF6K - 110	211.6	110	29	19.5	CAT50 x SAF25	SK306 - 50	SKX6	3.85
5032-S28-006-160	CAT50 x SAF6K - 160	261.6	160	79	19.5	CAT50 x SAF25	SK306 - 100	SKX6	3.94
5032-S28-010-110	CAT50 x SAF10K - 110	211.6	110	32.5	27.5	CAT50 x SAF25	SK310 - 50	SKX10	3.88
5032-S28-010-160	CAT50 x SAF10K - 160	261.6	160	82.5	27.5	CAT50 x SAF25	SK310 - 100	SKX10	4.07
5032-S28-013-130	CAT50 x SAF13K - 130	231.6	130	53	33	CAT50 x SAF25	SK313 - 70	SKX13	4.01
5032-S28-013-160	CAT50 x SAF13K - 160	261.6	160	83	33	CAT50 x SAF25	SK313 - 100	SKX13	4.19
5032-S28-016-130	CAT50 x SAF16K - 130	231.6	130	49.9	40	CAT50 x SAF40	SK316 - 70	SKX16	4.85
5032-S28-016-160	CAT50 x SAF16K - 160	261.6	160	79.9	40	CAT50 x SAF40	SK316 - 100	SKX16	5.11

Features:

- ▶ The runout accuracy of tool edges can be adjusted within 5 μ m.
- ▶ Different output options to meet customer machining requirements.
- ▶ Suitable for reaming, drilling and milling.

Standard Accessory: • NUT • WRENCH (FOR ADJUSTMENT SCREW) • PIN

Collet	Nut	Pull Stud	Spanner	Torque Wrench Adapter (Pull Stud)	Spanner (Pull Stud)	SK3 Collet Chuck Flange	Preset Screw
P.X-39~41	P.X-58	P.X-66	P.X-73、75、76、82	P.X-77	P.X-78	P.X-99	P.X-111

CAT / SAF RUNOUT ADJUSTABLE HOLDER



CAT / SAF 可調式刀桿

(UT TYPE)

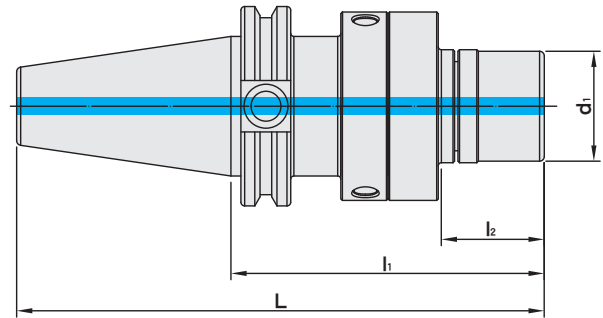

J P PAT NO. 3237773
 DE PAT NO. 202022102696
 CN PAT NO. ZL202221891039.3

MODEL NO.	TYPE	L	l ₁	l ₂	d ₁	COMBINATION		COLLET	WEIGHT (KGS)
						BODY	FLANGE ADAPTER		
5031-S30-016-100	CAT40 x SAF16U - 100	168.249	100	32	30	CAT40 x SAF25	UT16 - 50	ER16	1.66
5031-S30-020-100	CAT40 x SAF20U - 100	168.249	100	33	35	CAT40 x SAF25	UT20 - 50	ER20	1.68
5031-S30-025-120	CAT40 x SAF25U - 120	188.249	120	38.9	42	CAT40 x SAF40	UT25 - 60	ER25	2.80
5031-S30-032-120	CAT40 x SAF32U - 120	188.249	120	40.9	48	CAT40 x SAF40	UT32 - 60	ER32	2.83
5032-S30-016-110	CAT50 x SAF16U - 110	211.6	110	32	30	CAT50 x SAF25	UT16 - 50	ER16	3.93
5032-S30-020-110	CAT50 x SAF20U - 110	211.6	110	33	35	CAT50 x SAF25	UT20 - 50	ER20	3.95
5032-S30-025-120	CAT50 x SAF25U - 120	221.6	120	38.9	42	CAT50 x SAF40	UT25 - 60	ER25	4.86
5032-S30-032-120	CAT50 x SAF32U - 120	221.6	120	40.9	48	CAT50 x SAF40	UT32 - 60	ER32	4.89

Features:

- ▶ The runout accuracy of tool edges can be adjusted within 5µm.
- ▶ Different output options to meet customer machining requirements.
- ▶ Suitable for reaming, drilling and milling.

Product information:

- ▶ Flange adapter: UT.

Standard Accessory: • NUT • WRENCH (FOR ADJUSTMENT SCREW) • PIN

Collet	Nut	Pull Stud	Spanner	Torque Wrench Adapter (Pull Stud)	Spanner (Pull Stud)	SK3 Collet Chuck Flange	Preset Screw
P.X-18~21	P.X-54	P.X-66	P.X-73、75、76、82	P.X-77	P.X-78	P.X-99	P.X-111



SAF RUNOUT ADJUSTABLE HOLDER BODY

SAF 可調式刀桿本體

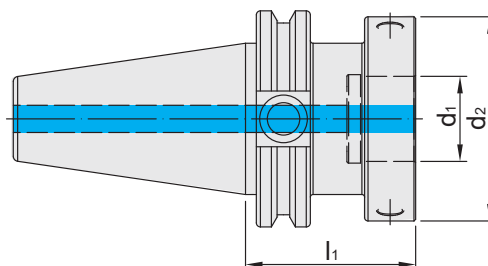

J P PAT NO. 3237773
 DE PAT NO. 202022102696
 CN PAT NO. ZL202221891039.3

MODEL NO.	TYPE	l_1	d_2	SAF NO.	WEIGHT (KGS)
5031-783-025-050	CAT40 x SAF25 - 50	50	60	1	1.19
5031-783-040-060	CAT40 x SAF40 - 60	60	80	2	1.71
5032-783-025-060	CAT50 x SAF25 - 60	60	60	1	3.46
5032-783-040-060	CAT50 x SAF40 - 60	60	80	2	3.77

CAT / SLN SIDE LOCK END MILL HOLDER

CAT / SLN 側固式立銑刀桿

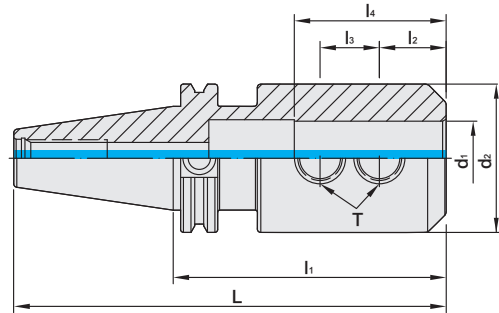

INCHES

MODEL NO.	TYPE	L	l ₁	l ₂	l ₃	l ₄	d ₁	d ₂	T	WEIGHT (KGS)
5031-653-A08-238	CAT40 x SLN1/8" - 2.375"	5.062	2.375	0.37	-	0.787	0.125	0.69	6# - 32	1.15
5031-653-A12-250	CAT40 x SLN3/16" - 2.5"	5.187	2.5	0.562	-	0.984	0.1875	0.69	8# - 32	1.20
5031-653-A16-300	CAT40 x SLN1/4" - 3"	5.687	3	0.63	-	1.38	0.25	0.78	1/4 - 28	1.15
5031-653-A20-300	CAT40 x SLN5/16" - 3"	5.687	3	0.6	-	1.38	0.3125	0.88	5/16 - 24	1.20
5031-653-A24-300	CAT40 x SLN3/8" - 3"	5.687	3	0.75	-	1.535	0.375	1	3/8 - 24	1.18
5031-653-A32-300	CAT40 x SLN1/2" - 3"	5.687	3	0.875	-	1.732	0.5	1.25	7/16 - 20	1.40
5031-653-A40-300	CAT40 x SLN5/8" - 3"	5.687	3	0.937	-	1.85	0.625	1.5	1/2 - 20	1.50
5031-653-A48-300	CAT40 x SLN3/4" - 3"	5.687	3	1	-	1.929	0.75	1.75	5/8 - 18	1.65
5031-653-A48-350	CAT40 x SLN3/4" - 3.5"	6.187	3.5	1	-	1.929	0.75	1.75	5/8 - 18	1.70
5031-653-A56-350	CAT40 x SLN7/8" - 3.5"	6.187	3.5	1.063	0.875	2.36	0.875	1.88	5/8 - 18	2.55
5031-653-A64-400	CAT40 x SLN1" - 4"	6.687	4	1.125	1	2.56	1	2	3/4 - 16	2.80
5031-653-A72-460	CAT40 x SLN1-1/4" - 4.6"	7.287	4.6	1.125	1	2.56	1.25	2.5	3/4 - 16	2.90
5031-653-A80-450	CAT40 x SLN1-1/2" - 4.5"	7.187	4.5	1.125	1	2.56	1.5	2.5	3/4 - 16	3.20
5032-653-A16-400	CAT50 x SLN1/4" - 4"	8	4	0.63	-	1.378	0.25	0.78	1/4 - 28	3.95
5032-653-A20-400	CAT50 x SLN5/16" - 4"	8	4	0.6	-	1.378	0.3125	0.88	5/16 - 24	3.95
5032-653-A24-400	CAT50 x SLN3/8" - 4"	8	4	0.75	-	1.535	0.375	1	3/8 - 24	4.00
5032-653-A32-400	CAT50 x SLN1/2" - 4"	8	4	0.875	-	1.732	0.5	1.25	7/16 - 20	4.15
5032-653-A40-400	CAT50 x SLN5/8" - 4"	8	4	0.937	-	1.85	0.625	1.5	1/2 - 20	4.30
5032-653-A48-400	CAT50 x SLN3/4" - 4"	8	4	1	-	1.929	0.75	1.75	5/8 - 18	4.35
5032-653-A56-400	CAT50 x SLN7/8" - 4"	8	4	1.063	0.875	2.362	0.875	1.88	5/8 - 18	5.30
5032-653-A64-400	CAT50 x SLN1" - 4"	8	4	1.125	1	2.56	1	2	3/4 - 16	5.50
5032-653-A72-400	CAT50 x SLN1-1/4" - 4"	8	4	1.125	1	2.756	1.25	2.5	3/4 - 16	5.65
5032-653-A72-460	CAT50 x SLN1-1/4" - 4.6"	8.6	4.6	1.125	1	2.756	1.25	2.5	3/4 - 16	5.70
5032-653-A80-460	CAT50 x SLN1-1/2" - 4.6"	8.6	4.6	1.125	1	2.756	1.5	2.5	3/4 - 16	5.70
5032-653-A96-600	CAT50 x SLN2" - 6"	10	6	1.41	1.5	3.347	2	3.75	1 - 14	5.90

Features:

- ▶ Internal hole tolerance: H5 (DIN-1835-B standard).
- ▶ The tolerance requirement of tool shank diameter is h6.
- ▶ Taking use of side lock screws to clamp tools with lateral flat surfaces. Good at heavy-duty machining.

Product information:

- ▶ The pre-balance reaches G6.3 8,000 rpm. Higher balancing grade and revolution can be done upon request but additional charge is needed.
- ▶ AD+B type is available, please inform us when making an order.

Pull Stud	Torque Wrench Adapter (Pull Stud)	Spanner (Pull Stud)	Lock Screw
P.X-66	P.X-73、77	P.X-78	P.X-113



CAT FACE MILL ARBOR

CAT / FMA 平面銑刀桿

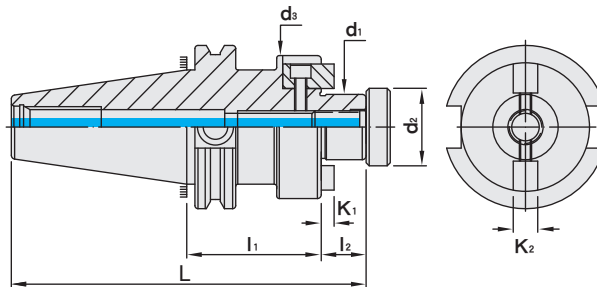

INCHES





MODEL NO.	TYPE	L	l ₁	l ₂	d ₁	d ₂	d ₃	K ₁	K ₂	WEIGHT (KGS)
5031-151-A48-137	CAT40 x FMA3/4" - 1.37"	4.744	1.37	0.687	0.75	0.875	1.69	0.16	0.3125	1.50
5031-151-A48-400	CAT40 x FMA3/4" - 4"	7.374	4	0.687	0.75	0.875	1.69	0.16	0.3125	1.70
5031-151-A48-600	CAT40 x FMA3/4" - 6"	9.374	6	0.687	0.75	0.875	1.69	0.16	0.3125	1.90
5031-151-A64-206	CAT40 x FMA1" - 2.06"	5.434	2.06	0.687	1	1.1875	2.19	0.2	0.375	1.45
5031-151-A64-400	CAT40 x FMA1" - 4"	7.374	4	0.687	1	1.1875	2.19	0.2	0.375	2.00
5031-151-A64-600	CAT40 x FMA1" - 6"	9.374	6	0.687	1	1.1875	2.19	0.2	0.375	2.75
5031-151-A72-221	CAT40 x FMA1-1/4" - 2.21"	5.584	2.21	0.687	1.25	1.5	2.75	0.24	0.5	2.60
5031-151-A72-400	CAT40 x FMA1-1/4" - 4"	7.374	4	0.687	1.25	1.5	2.75	0.24	0.5	2.75
5031-151-A72-600	CAT40 x FMA1-1/4" - 6"	9.374	6	0.687	1.25	1.5	2.75	0.24	0.5	2.95
5031-151-A80-221	CAT40 x FMA1-1/2" - 2.21"	5.837	2.21	0.940	1.5	1.875	3.81	0.31	0.625	2.70
5031-151-A80-400	CAT40 x FMA1-1/2" - 4"	7.627	4	0.940	1.5	1.875	3.81	0.31	0.625	2.95
5032-151-A48-150	CAT50 x FMA3/4" - 1.5"	6.187	1.5	0.687	0.75	0.875	-	0.12	0.3125	4.20
5032-151-A48-350	CAT50 x FMA3/4" - 3.5"	8.187	3.5	0.687	0.75	0.875	1.69	0.16	0.3125	4.40
5032-151-A48-550	CAT50 x FMA3/4" - 5.5"	10.187	5.5	0.687	0.75	0.875	1.69	0.16	0.3125	4.60
5032-151-A64-200	CAT50 x FMA1" - 2"	6.687	2	0.687	1	1.1875	2.19	0.2	0.375	4.50
5032-151-A64-400	CAT50 x FMA1" - 4"	8.687	4	0.687	1	1.1875	2.19	0.2	0.375	4.70
5032-151-A64-600	CAT50 x FMA1" - 6"	10.687	6	0.687	1	1.1875	2.19	0.2	0.375	4.90
5032-151-A72-150	CAT50 x FMA1-1/4" - 1.5"	6.187	1.5	0.687	1.25	1.5	2.75	0.24	0.5	4.70
5032-151-A72-350	CAT50 x FMA1-1/4" - 3.5"	8.187	3.5	0.687	1.25	1.5	2.75	0.24	0.5	4.80
5032-151-A72-500	CAT50 x FMA1-1/4" - 5"	9.687	5	0.687	1.25	1.5	2.75	0.24	0.5	5.00
5032-151-A72-600	CAT50 x FMA1-1/4" - 6"	10.687	6	0.687	1.25	1.5	2.75	0.24	0.5	5.10
5032-151-A80-240	CAT50 x FMA1-1/2" - 2.4"	7.338	2.4	0.938	1.5	1.875	3.81	0.31	0.625	5.00
5032-151-A80-400	CAT50 x FMA1-1/2" - 4"	8.938	4	0.938	1.5	1.875	3.81	0.31	0.625	5.20
5032-151-A80-600	CAT50 x FMA1-1/2" - 6"	10.938	6	0.938	1.5	1.875	3.81	0.31	0.625	5.40
5032-151-A96-240	CAT50 x FMA2" - 2.4"	7.338	2.4	0.938	2	2.5	4.88	0.39	0.75	5.40
5032-151-A96-400	CAT50 x FMA2" - 4"	8.938	4	0.938	2	2.5	4.88	0.39	0.75	5.60

Features:

- ▶ Tolerance of d1 the connection part with cutter: h6, which is good for less chatter and longer cutter life.
- ▶ Standard screw attached is w/o coolant hole.
- ▶ To use with face mill cutters with coolant holes, the standard screw has to be changed into the screw with coolant flute, which is available to order separately.

Product information:

- ▶ The pre-balance reaches G6.3 3,000 rpm. Higher balancing grade and revolution can be done upon request but additional charge is needed.
- ▶ AD+B type is available, please inform us when making an order.

Pull Stud	Torque Wrench Adapter (Pull Stud)	Spanner (Pull Stud)	Screw
			
P.X-66	P.X-73、77	P.X-78	P.X-112

CAT / STA SYNCHRONIZED TAPPING HOLDER



CAT / STA 同步補償攻牙刀桿

[ER TYPE]

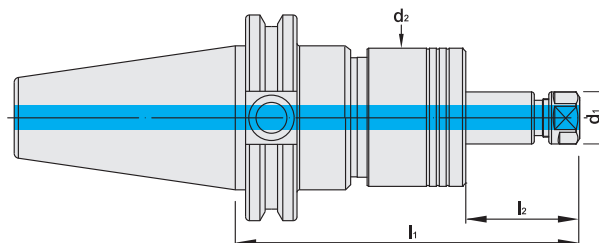

TW PAT NO. I615223
 J P PAT NO. 3203456
 D E PAT NO. 202016100106
 U S PAT NO. 9796059
 C N PAT NO. ZL201620889099.X

MODEL NO.	TYPE	l ₁	l ₂	d ₁	d ₂	COMBINATION		WEIGHT (KGS)
						BODY	TAP ADAPTER	
5031-S22-011-140	CAT40 x STA11E - 140	140	70	19	42	CAT40 x STA1	STA1 - ER11A - 70	1.48
5031-S22-016-095	CAT40 x STA16E - 95	95	25	28	42	CAT40 x STA1	STA1 - ER16A - 25	1.22
5031-S22-016-140	CAT40 x STA16E - 140	140	70	28	42	CAT40 x STA1	STA1 - ER16A - 70	1.42
5031-S22-016-220	CAT40 x STA16E - 220	220	150	28	42	CAT40 x STA1	STA1 - ER16A - 150	1.75
5031-S22-020-104	CAT40 x STA20E - 104	104	34	34	42	CAT40 x STA1	STA1 - ER20A - 34	1.26
5031-S22-020-140	CAT40 x STA20E - 140	140	70	34	42	CAT40 x STA1	STA1 - ER20A - 70	1.42
5031-S22-032-130	CAT40 x STA32E - 130	130	40	50	58	CAT40 x STA2	STA2 - ER32 - 40	1.89
5031-S22-032-160	CAT40 x STA32E - 160	160	70	50	58	CAT40 x STA2	STA2 - ER32 - 70	2.12
5032-S22-011-140	CAT50 x STA11E - 140	140	70	19	42	CAT50 x STA1	STA1 - ER11A - 70	3.48
5032-S22-016-095	CAT50 x STA16E - 95	95	25	28	42	CAT50 x STA1	STA1 - ER16A - 25	3.22
5032-S22-016-140	CAT50 x STA16E - 140	140	70	28	42	CAT50 x STA1	STA1 - ER16A - 70	3.42
5032-S22-016-220	CAT50 x STA16E - 220	220	150	28	42	CAT50 x STA1	STA1 - ER16A - 150	3.75
5032-S22-020-104	CAT50 x STA20E - 104	104	34	34	42	CAT50 x STA1	STA1 - ER20A - 34	3.26
5032-S22-020-140	CAT50 x STA20E - 140	140	70	34	42	CAT50 x STA1	STA1 - ER20A - 70	3.42
5032-S22-032-135	CAT50 x STA32E - 135	135	40	50	58	CAT50 x STA2	STA2 - ER32 - 40	3.97
5032-S22-032-165	CAT50 x STA32E - 165	165	70	50	58	CAT50 x STA2	STA2 - ER32 - 70	4.20

Features:

- ▶ Internal steel component allows the micro-compensation for the misfeed of spindle ballscrew and overload. Improve tapping quality and tap life. Optimum male and female threaded fitting is achieved due to the premium design!
- ▶ To prevent from interfering, the longer adapter can be custom-made.
- ▶ Coolant-through is available with coolant pressure up to 70 bar. STA has long use life even the synchronized micro-compensation mechanism is used at high coolant pressure..
- ▶ Modular design to meet more diverse demand.
- ▶ One of SYIC products patented by US invention.

Product information:

- ▶ AD+B type is available, please inform us when making an order.

Application:

- ▶ Ideal for everyday tapping, high speed and high production tapping for modern CNC machines capable of rigid tapping.
- ▶ Also ideal for high-end tapping applications in modern CNC machines (small taps or difficult materials resulting in high torque loads).

Standard Accessory: • NUT

Collet	Nut	Pull Stud	Spanner	Torque Wrench Adapter (Pull Stud)	Spanner (Pull Stud)	TAP ADAPTER
P.X-18~37	P.X-54~58	P.X-66	P.X-73~76、79、82	P.X-77	P.X-78	P.X-101



CAT / STA SYNCHRONIZED TAPPING HOLDER BODY

STA 同步補償攻牙刀桿本體

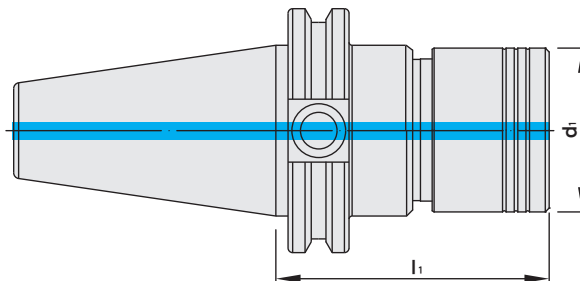

TW PAT NO. I615223
 J P PAT NO. 3203456
 D E PAT NO. 202016100106
 U S PAT NO. 9796059
 C N PAT NO. ZL201620889099.X

MODEL NO.	TYPE	l_1	d_1	STA NO.	WEIGHT (KGS)
5031-795-001-070	CAT40 x STA1 - 70	70	42	1	1.12
5031-795-002-090	CAT40 x STA2 - 90	90	58	2	1.45
5032-795-001-070	CAT50 x STA1 - 70	70	42	1	3.12
5032-795-002-095	CAT50 x STA2 - 95	95	58	2	3.53

CAT / SPH DRILL CHUCK ADAPTER

INTEGRATED TYPE

CAT

CAT / SPH 直結式鑽夾頭

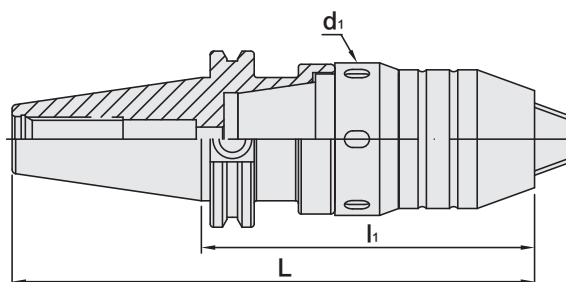

INCHES

MODEL NO.	TYPE	L	l ₁	d ₁	CLAMPING CAPACITY	WEIGHT (KGS)
5031-680-A20-400	CAT40 x SPH5/16" - 4"	6.69	4	1.65	1/16" ~ 5/16"	1.85
5031-680-A32-475	CAT40 x SPH1/2" - 4.75"	7.44	4.75	2.13	1/16" ~ 1/2"	2.10
5031-680-A40-600	CAT40 x SPH5/8" - 6"	8.69	6	2.44	1/8" ~ 5/8"	2.95
5032-680-A20-400	CAT50 x SPH5/16" - 4"	8	4	1.65	1/16" ~ 5/16"	2.10
5032-680-A32-425	CAT50 x SPH1/2" - 4.25"	8.25	4.25	2.13	1/16" ~ 1/2"	2.85
5032-680-A40-450	CAT50 x SPH5/8" - 4.5"	8.5	4.5	2.44	1/8" ~ 5/8"	3.45

Features:

- ▶ The adapter has a taper design to assemble with drill chuck and then lock with a screw, ensuring to have better stability and drill chuck would not fall off.
- ▶ Used for drilling & tapping.

Product information:

- ▶ The pre-balance reaches G6.3 8,000 rpm. Higher balancing grade and revolution can be done upon request but additional charge is needed.

Standard Accessory: ● SPANNER

Pull Stud	Torque Wrench Adapter (Pull Stud)	Spanner (Pull Stud)
		
P.X-66	P.X-73、77	P.X-78



CAT / SPU DRILL CHUCK ADAPTER

CAT / SPU 直結式鑽夾頭

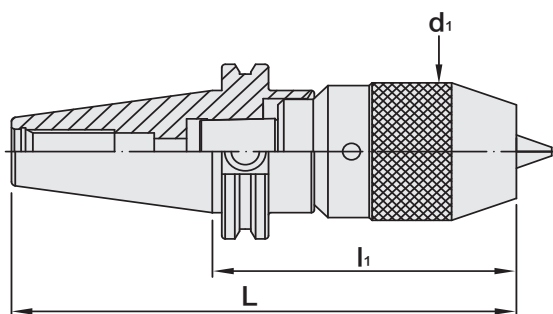

INCHES

MODEL NO.	TYPE	L	l ₁	d ₁	CLAMPING CAPACITY	WEIGHT (KGS)
5031-669-A32-400	CAT40 x SPU1/2" - 4"	6.687	4	1.969	1/16" ~ 1/2"	1.95
5031-669-A40-460	CAT40 x SPU5/8" - 4.6"	7.287	4.6	2.244	1/8" ~ 5/8"	2.25
5032-669-A32-400	CAT50 x SPU1/2" - 4"	8	4	1.969	1/16" ~ 1/2"	4.35





Features:

- ▶ The adapter has a taper design to assemble with drill chuck and then lock with a screw, ensuring to have better stability and drill chuck would not fall off.
- ▶ Used for drilling.

Product information:

- ▶ The pre-balance reaches G6.3 8,000 rpm. Higher balancing grade and revolution can be done upon request but additional charge is needed.

Standard Accessory: ● SPANNER

Pull Stud	Torque Wrench Adapter (Pull Stud)	Spanner (Pull Stud)	Spanner
			
P.X-66	P.X-73、77	P.X-78	P.X-80

CAT / ETP EXPANSION ER TAPPER



CAT / ETP 伸縮 ER 攻牙器

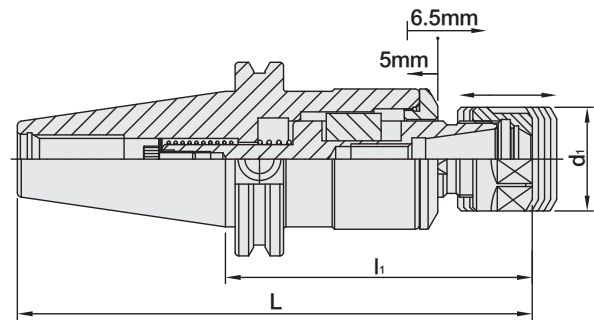

INCHES

MODEL NO.	TYPE	L	l ₁	d ₁	COLLET	CAPACITY	WEIGHT (KGS)
5031-124-016-121	CAT40 x ETP16 - 4.75"	7.437	4.75	1.102	ER16	0.125 ~ 0.394	1.65
5031-124-016-152	CAT40 x ETP16 - 6"	8.687	6	1.102	ER16	0.125 ~ 0.394	1.85
5031-124-020-102	CAT40 x ETP20 - 4"	6.687	4	1.339	ER20	0.125 ~ 0.625	1.65
5031-124-020-152	CAT40 x ETP20 - 6"	8.687	6	1.339	ER20	0.125 ~ 0.625	1.90
5031-124-032-126	CAT40 x ETP32 - 4.95"	7.637"	4.95"	1.969	ER32	0.125 ~ 1.0625	1.76
5032-124-020-102	CAT50 x ETP20 - 4"	8	4	1.339	ER20	0.125 ~ 0.625	4.30
5032-124-020-152	CAT50 x ETP20 - 6"	10	6	1.339	ER20	0.125 ~ 0.625	4.60
5032-124-032-126	CAT50 x ETP32 - 4.95"	8.95"	4.95"	1.969	ER32	0.125 ~ 1.0625	4.65

Features:

- ▶ Tension: 6.5mm, compression: 5mm.
- ▶ Suitable for traditional CNC machines without rigid tapping program.
- ▶ Using with rigid tap collets increases the clamping force, prevents taps from falling off and improves the machining efficiency.

Standard Accessory: • NUT

Collet	Nut	Pull Stud	Spanner	Torque Wrench Adapter (Pull Stud)	Spanner (Pull Stud)	Preset Screw
PX-18~21,33~34	P.X-54~55	P.X-66	PX-73、74、79	P.X-77	P.X-78	P.X-111



CAT SIDE LOCK OIL HOLE HOLDER

CAT / OSL 側固式油路刀把

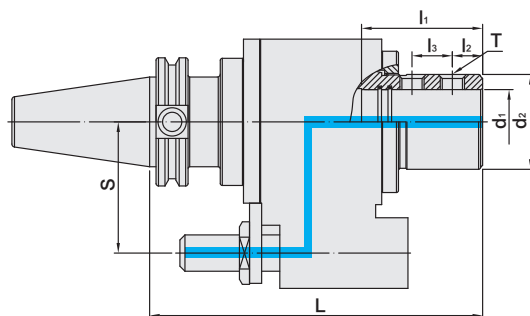

INCHES

MODEL NO.	TYPE	L	l ₁	l ₂	l ₃	d ₁	d ₂	S	T	WEIGHT (KGS)
5031-604-161-165	CAT40 x OSL16 - 6.5"	6.5	1.89	0.98	-	0.629	1.83	2.56	M12 x 1.75P	3.50
5031-604-201-165	CAT40 x OSL20 - 6.5"	6.5	1.97	0.98	-	0.787	1.83	2.56	M12 x 1.75P	3.50
5031-604-251-165	CAT40 x OSL25 - 6.5"	6.5	2.2	0.59	0.79	0.984	1.83	2.56	M12 x 1.75P	3.50
5031-604-321-165	CAT40 x OSL32 - 6.5"	6.5	2.36	0.59	0.79	1.259	1.85	2.56	M12 x 1.75P	3.50
5031-604-162-165	CAT40 x OSL16 - 6.5"S	6.5	1.89	0.98	-	0.629	1.83	2.36	M12 x 1.75P	3.50
5031-604-202-165	CAT40 x OSL20 - 6.5"S	6.5	1.97	0.98	-	0.787	1.83	2.36	M12 x 1.75P	3.50
5031-604-252-165	CAT40 x OSL25 - 6.5"S	6.5	2.2	0.59	0.79	0.984	1.83	2.36	M12 x 1.75P	3.50
5031-604-322-165	CAT40 x OSL32 - 6.5"S	6.5	2.36	0.59	0.79	1.259	1.85	2.36	M12 x 1.75P	3.80
5032-604-163-165	CAT50 x OSL16 - 6.5"	6.5	1.89	0.98	-	0.629	2.2	3.15	M14 x 2.0P	7.00
5032-604-203-165	CAT50 x OSL20 - 6.5"	6.5	1.97	0.98	-	0.787	2.2	3.15	M12 x 1.75P	7.50
5032-604-253-165	CAT50 x OSL25 - 6.5"	6.5	2.2	0.59	0.79	0.984	2.2	3.15	M16 x 2.0P	7.50
5032-604-323-170	CAT50 x OSL32 - 6.69"	6.69	2.36	0.59	0.79	1.259	2.2	3.15	M16 x 2.0P	7.80
5032-604-403-170	CAT50 x OSL40 - 6.69"	6.69	2.44	0.59	0.98	1.575	2.2	3.15	M14 x 2.0P	8.50
5032-604-164-165	CAT50 x OSL16 - 6.5"M	6.5	1.89	0.98	-	0.629	2.2	3.23	M14 x 2.0P	7.10
5032-604-204-165	CAT50 x OSL20 - 6.5"M	6.5	1.97	0.98	-	0.787	2.2	3.23	M12 x 1.75P	7.60
5032-604-254-165	CAT50 x OSL25 - 6.5"M	6.5	2.2	0.59	0.79	0.984	2.2	3.23	M16 x 2.0P	7.70
5032-604-324-170	CAT50 x OSL32 - 6.69"M	6.69	2.36	0.59	0.79	1.259	2.2	3.23	M16 x 2.0P	7.80
5032-604-404-170	CAT50 x OSL40 - 6.69"M	6.69	2.44	0.59	0.98	1.575	2.2	3.23	M14 x 2.0P	8.50
5032-604-165-165	CAT50 x OSL16 - 6.5"L	6.5	1.89	0.98	-	0.629	2.2	3.35	M14 x 2.0P	7.20
5032-604-205-165	CAT50 x OSL20 - 6.5"L	6.5	1.97	0.98	-	0.787	2.2	3.35	M12 x 1.75P	7.80
5032-604-255-165	CAT50 x OSL25 - 6.5"L	6.5	2.2	0.59	0.79	0.984	2.2	3.35	M16 x 2.0P	7.80
5032-604-325-170	CAT50 x OSL32 - 6.69"L	6.69	2.36	0.59	0.79	1.259	2.2	3.35	M16 x 2.0P	8.00
5032-604-405-170	CAT50 x OSL40 - 6.69"L	6.69	2.44	0.59	0.98	1.575	2.2	3.35	M14 x 2.0P	8.70

Features:

- ▶ Internal hole tolerance is H5.
- ▶ The tolerance requirement of tool shank diameter is h6.
- ▶ Used for machines w/o center or side coolant and achieve coolant through tools.

Product information:

- ▶ Water pressure up to 7 kgf/cm².
- ▶ Max. revolution: 3,000 rpm.

Pull Stud	Torque Wrench Adapter (Pull Stud)	Spanner (Pull Stud)	Straight Sleeve	Lock Screw	Fixed Block
P.X-66	P.X-73、77	P.X-78	P.X-106	P.X-113	P.X-118

CAT / OHER OIL HOLE COLLET CHUCK



CAT / OHER 油路刀把

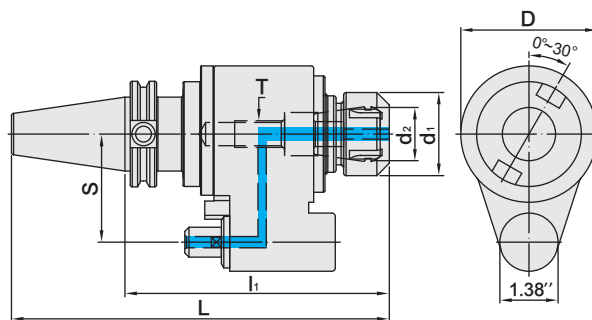

INCHES

MODEL NO.	TYPE	L	l ₁	D	d ₂ ER	S	T	SIZE RANGE	WEIGHT (KGS)
5031-601-161-160	CAT40 x OHER16 - 6.3"	8.987	6.3	3.228	16	2.56	M10	0.062 ~ 0.406	3.80
5031-601-201-160	CAT40 x OHER20 - 6.3"	8.987	6.3	3.228	20	2.56	M12	0.062 ~ 0.5	4.10
5031-601-251-160	CAT40 x OHER25 - 6.3"	8.987	6.3	3.228	25	2.56	M16	0.093 ~ 0.625	4.30
5031-601-321-160	CAT40 x OHER32 - 6.3"	8.987	6.3	3.228	32	2.56	M16	0.062 ~ 0.75	4.50
5032-601-163-160	CAT50 x OHER16 - 6.3"	10.3	6.3	3.858	16	3.15	M10	0.062 ~ 0.406	7.00
5032-601-203-160	CAT50 x OHER20 - 6.3"	10.3	6.3	3.858	20	3.15	M12	0.062 ~ 0.5	7.10
5032-601-253-160	CAT50 x OHER25 - 6.3"	10.3	6.3	3.858	25	3.15	M16	0.093 ~ 0.625	7.20
5032-601-323-160	CAT50 x OHER32 - 6.3"	10.3	6.3	3.858	32	3.15	M16	0.062 ~ 0.75	7.30
5032-601-403-160	CAT50 x OHER40 - 6.3"	10.3	6.3	3.858	40	3.15	M20	0.125 ~ 1	7.50

Features:

▶ Used for machines w/o center or side coolant and achieve coolant through tools.

Product information:

- ▶ Water pressure up to 7 kgf/cm².
- ▶ Max. revolution: 3,000 rpm.

Standard Accessory: • NUT

Collet	Nut	Pull Stud	Spanner	Torque Wrench Adapter (Pull Stud)	Spanner (Pull Stud)	Preset Screw	Fixed Block
P.X-18~38	P.X-54~55,57	P.X-66	P.X-73~76、79	P.X-77	P.X-78	P.X-111	P.X-118



CAT / SOM SCREWED END MILL HOLDER

CAT / SOM 螺紋鎖固式刀桿

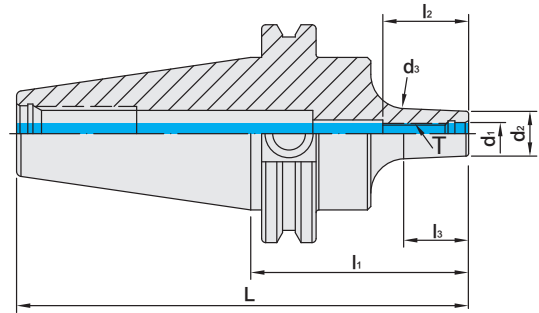



INCHES

MODEL NO.	TYPE	L	l ₁	l ₂	l ₃	d ₁	d ₂	d ₃	T	WEIGHT (KGS)
5031-670-006-064	CAT40 x SOM6 - 2.5"	5.187	2.5	0.984	0.933	0.256	0.512	0.593	M6	1.20
5031-670-008-064	CAT40 x SOM8 - 2.5"	5.187	2.5	0.984	0.933	0.335	0.591	0.672	M8	1.20
5031-670-010-064	CAT40 x SOM10 - 2.5"	5.187	2.5	0.984	0.933	0.413	0.748	0.829	M10	1.20
5031-670-012-076	CAT40 x SOM12 - 3"	5.687	3	1.22	1.042	0.492	0.827	0.883	M12	1.30
5031-670-016-076	CAT40 x SOM16 - 3"	5.687	3	1.22	1.433	0.669	0.984	1.106	M16	1.40
5032-670-006-064	CAT50 x SOM6 - 2.5"	6.5	2.5	0.984	0.933	0.256	0.512	0.593	M6	3.00
5032-670-008-064	CAT50 x SOM8 - 2.5"	6.5	2.5	0.984	0.933	0.335	0.591	0.672	M8	3.00
5032-670-010-064	CAT50 x SOM10 - 2.5"	6.5	2.5	0.984	0.933	0.413	0.748	0.829	M10	3.00
5032-670-012-076	CAT50 x SOM12 - 3"	7	3	1.22	1.433	0.492	0.827	0.917	M12	3.10
5032-670-016-076	CAT50 x SOM16 - 3"	7	3	1.22	1.433	0.669	0.984	1.173	M16	3.20

Product information:

- ▶ The pre-balance reaches G6.3 10,000 rpm. Higher balancing grade and revolution can be done upon request but additional charge is needed.
- ▶ AD+B type is available, please inform us when making an order.

Pull Stud	Torque Wrench Adapter (Pull Stud)	Spanner (Pull Stud)
		
P.X-66	P.X-73、77	P.X-78

CAT MORSE TAPER ADAPTER

TANG TYPE

CAT 斜柄鑽頭套筒

(DIN 228-2)

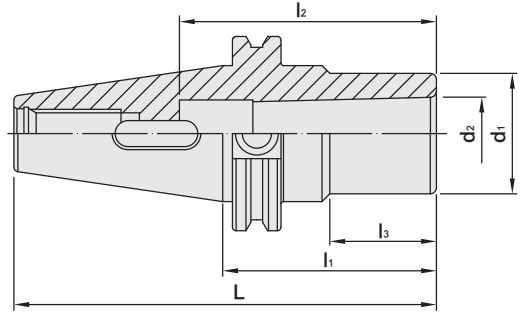

INCHES

MODEL NO.	TYPE	L	l ₁	l ₂	l ₃	d ₁	d ₂	WEIGHT (KGS)
5031-465-001-041	CAT40 x MTA1 - 1.6"	4.287	1.6	2.205	0.124	1	0.475	1.30
5031-465-002-051	CAT40 x MTA2 - 2"	4.687	2	2.638	0.323	1.25	0.7	1.50
5031-465-003-070	CAT40 x MTA3 - 2.75"	5.437	2.75	3.307	1.287	1.575	0.938	1.15
5031-465-004-095	CAT40 x MTA4 - 3.75"	6.437	3.75	4.213	2.372	1.75	1.23	1.20
5032-465-001-051	CAT50 x MTA1 - 2"	6	2	2.205	0.622	1	0.475	4.05
5032-465-002-051	CAT50 x MTA2 - 2"	6	2	2.638	0.504	1.25	0.7	4.40
5032-465-003-064	CAT50 x MTA3 - 2.5"	6.5	2.5	3.307	1.004	1.55	0.938	4.50
5032-465-004-084	CAT50 x MTA4 - 3.3"	7.3	3.3	4.213	1.804	1.75	1.23	4.90
5032-465-005-104	CAT50 x MTA5 - 4.1"	8.1	4.1	5.315	2.587	2.48	1.748	5.15

Features:

► The tools used are consistent with Morse Taper DIN228 FROM B (with Tang).

Product information:

► The pre-balance reaches G6.3 8,000 rpm. Higher balancing grade and revolution can be done upon request but additional charge is needed.

Pull Stud	Torque Wrench Adapter (Pull Stud)	Spanner (Pull Stud)
		
P.X-66	P.X-73、77	P.X-78



CAT / PSC ADAPTER

CAT 套筒

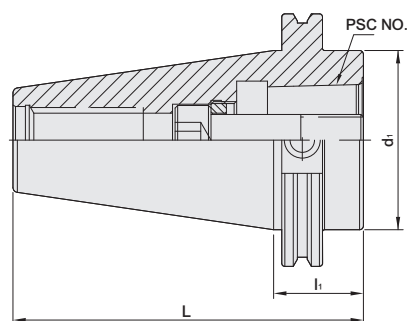

MODEL NO.	TYPE	NO.	L	l ₁	d ₁	T	MAX. TORQUE		WEIGHT (KGS)
							Nm	ft-lbs	
5031-013-140-035	CAT40 x PSC32 - 35	PSC32	103.249	35	44.45	M12 x 1.5P	45	33	0.99
5031-013-141-035	CAT40 x PSC40 - 35	PSC40	103.249	35	44.45	M14 x 1.5P	55	40	0.90
5031-013-142-035	CAT40 x PSC50 - 35	PSC50	103.249	35	44.45	M16 x 1.5P	95	70	0.82
5031-013-143-090	CAT40 x PSC63 - 90	PSC63	158.249	90	63	M20 x 2.0P	170	125	1.83
5032-013-140-035	CAT50 x PSC32 - 35	PSC32	136.6	35	69.85	M12 x 1.5P	45	33	3.00
5032-013-141-035	CAT50 x PSC40 - 35	PSC40	136.6	35	69.85	M14 x 1.5P	55	40	2.95
5032-013-142-035	CAT50 x PSC50 - 35	PSC50	136.6	35	69.85	M16 x 1.5P	95	70	2.85
5032-013-143-035	CAT50 x PSC63 - 35	PSC63	136.6	35	69.85	M20 x 2.0P	170	125	2.63

INCHES

5032-013-143-102	CAT50 x PSC63 - 4"	PSC63	203.2	101.6	63	M20 x 2.0P	170	125	4.05
5032-013-143-152	CAT50 x PSC63 - 6"	PSC63	254	152.4	63	M20 x 2.0P	170	125	5.14
5032-013-143-203	CAT50 x PSC63 - 8"	PSC63	304.8	203.2	63	M20 x 2.0P	170	125	6.23
5032-013-143-254	CAT50 x PSC63 - 10"	PSC63	355.6	254	63	M20 x 2.0P	170	125	7.31
5032-013-143-305	CAT50 x PSC63 - 12"	PSC63	406.4	304.8	63	M20 x 2.0P	170	125	8.40
5032-013-144-095	CAT50 x PSC80 - 3.74"	PSC80	196.6	95	80	M20 x 2.0P	170	125	3.05

Features:

- Convert the machine taper for use with different taper types or taper sizes of tool holders.

Pull Stud	Torque Wrench Adapter (Pull Stud)	Spanner (Pull Stud)
		
P.X-66	P.X-73、77	P.X-78

CAT BLANK

CAT 素材

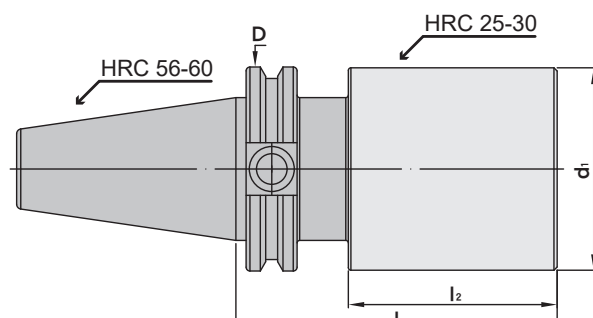

INCHES

MODEL NO.	TYPE	D	d ₁	l ₁	l ₂	WEIGHT (KGS)
5031-001-A96-800	CAT40 x Ø2" - 8"	2.5	2	8	6.625	3.64
5031-001-B02-600	CAT40 x Ø2.5" - 6"	2.5	2.5	6	4.625	3.88
5031-001-B02-787	CAT40 x Ø2.5" - 7.87"	2.5	2.5	7.87	6.495	5.04
5032-001-B06-1000	CAT50 x Ø3" - 10"	3.875	3	10	8.625	10.8
5032-001-B16-800	CAT50 x Ø4" - 8"	3.875	4	8	6.625	13.6
5032-001-B16-1000	CAT50 x Ø4" - 10"	3.875	4	10	8.625	16.8

Features:

- Blanks can be machined according to customer demands. It is not recommended to do heat treatment after machining.

Pull Stud	Torque Wrench Adapter (Pull Stud)	Spanner (Pull Stud)
		
P.X-66	P.X-73、77	P.X-78



MEMO

Blank lined area for writing a memo.

