



SFS SERIES

NO.2022-06



www.syic.com



COMPANY INTRODUCTION

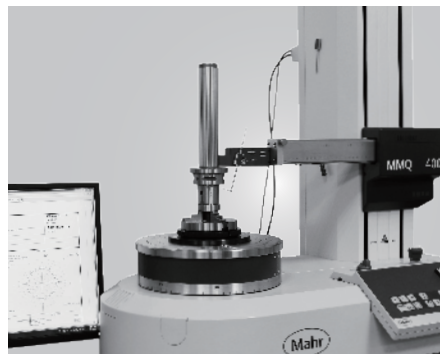



品質創造信譽 信譽保證品質

Quality creates reputation; reputation ensures quality.

About SYIC

Established in 1979, SYIC is a professional manufacturer of precise tool holders, cutting tools, angel heads, boring series and collets with more than 500 employees. The taper types of tool holders we manufacture include BT (MAS403), CAT (ANSI B5.50), DAT (DIN69871-A), HSK (DIN69893), PSC (ISO26623-1), VDI (DIN ISO10889) and straight shank holders.

SYIC is certified to ISO9001 and ISO14001. With contribution to the design, production and sale of high accuracy and inventive products, SYIC has over 300 pieces of patents worldwide. SYIC keeps investing in high-end equipment and measuring instruments from Japan and Europe to implement excellent quality control and manufacturing capability.

SYIC keeps the core value "Quality creates reputation; reputation ensures quality" to impress our customers, possessing professional technical skills to provide comprehensive solutions for customers, improving customers' machining efficiency, and enhancing the mutual competitiveness with customers. Based on the mission of "Excellent service, supreme quality," SYIC will continue to launch more high precision products to customers.

N

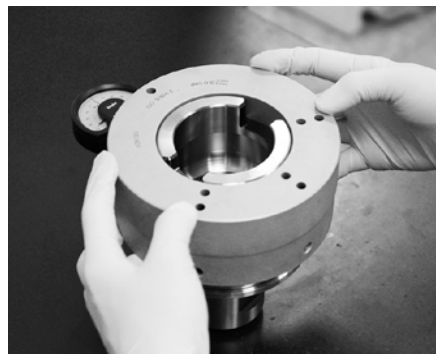

Tool Holders

Your reliable partner!

————— CNC turning, milling and grinding —————



www.syic.com

供需平衡 共榮共存

Maintain the balance of suppliers and customers and grow together.

未來之路 無限寬廣

Create a great future with infinite opportunities.

營運獲利 永續經營

Run a profitable company with sustainable development.

合作到底 共創通贏

Keep everlasting cooperation and together create a win-win situation.

成就彼此 榮耀一切

Support each other and accomplish mutual success.

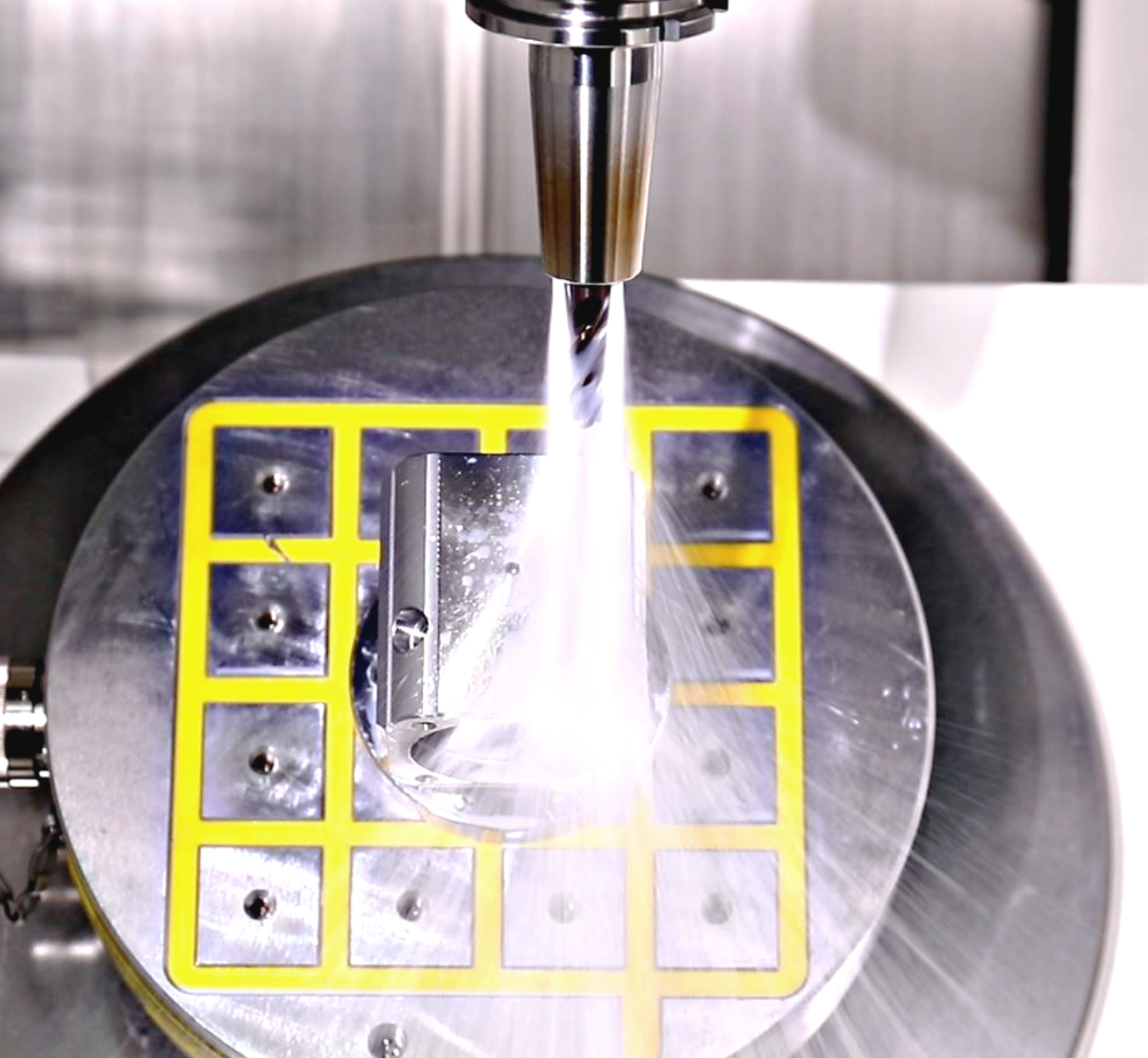

Innovation is our mission!

SYIC is committed to developing high precision products to optimize the machining process and offering professional technical service. With experienced technical professionals, our products are developed in response to different types of industries. We aim to achieve customers' demands from different industries including machining industry, mold and die industry, aerospace industry, automotive industry, and energy industry. We offer the most professional and technical service, effectively resolve your machining problems to create maximum production efficiency.



SFS CATEGORY

SFS SLIM-FIT COLLET CHUCK	8~11
SFS SLIM-FIT SHRINK EXTENSION	12
MFS SLIM-FIT SHRINK EXTENSION	13~14
ACCESSORIES	15

SFS SLIM-FIT COLLET CHUCK

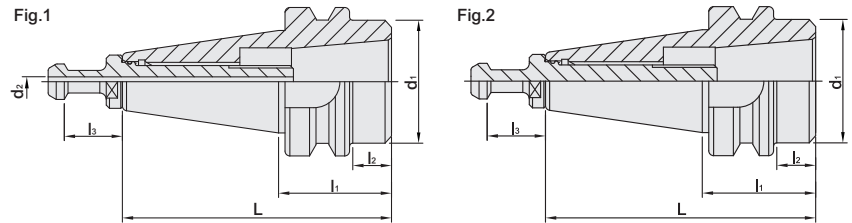
SFS 後拉式刀桿

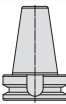

SHANK	MODEL NO.	TYPE	L	l ₁	l ₂	l ₃	d ₁	d ₂	θ	Fig.	WEIGHT (KGS)
 MAS 403	5010-780-12A-035	BT30 x SFS12 - 35	83.4	35	12	18	38.1	3	45°	1	0.4
	5010-780-12B-035	BT30 x SFS12 - 35	83.4	35	12	18	38.1	3	60°	1	0.4
	5010-780-12C-035	BT30 x SFS12 - 35	83.4	35	12	18	38.1	-	45°	2	0.4
	5010-780-12D-035	BT30 x SFS12 - 35	83.4	35	12	18	38.1	-	60°	2	0.4
 DualDRIVE+	5025-780-12A-035	SBT30 x SFS12 - 35	83.4	35	12	18	38.1	3	45°	1	0.4
	5025-780-12B-035	SBT30 x SFS12 - 35	83.4	35	12	18	38.1	3	60°	1	0.4
	5025-780-12C-035	SBT30 x SFS12 - 35	83.4	35	12	18	38.1	-	45°	2	0.4
	5025-780-12D-035	SBT30 x SFS12 - 35	83.4	35	12	18	38.1	-	60°	2	0.4

ONE PIECE PULL STUD WITH DRAW BOLT 一體式後拉螺絲拉頭



- ▶ Standard accessory of BT30 / SBT30 SFS slim-fit collet chuck.

Feature:

- ▶ The pull stud of BT30 and SBT30 SFS slim-fit collet chuck is special one piece design with draw bolt.
- ▶ There are two types of pull studs for BT30 and SBT30 SFS slim-fit collet chuck. Please confirm the size of θ and l_3 before making an order.
- ▶ Custom-made order for pull studs of BT30 and SBT30 SFS slim-fit collet chuck is acceptable.

Product information:

- ▶ Balance: G2.5 25000rpm.



Standard Accessory: • ONE PIECE PULL STUD WITH DRAW BOLT

SFS Extension	MFS Extension	Pull Stud
		
P.12	P.13~14	P.15

SFS SLIM-FIT COLLET CHUCK

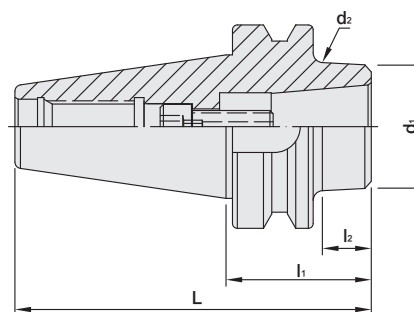
SFS 後拉式刀桿

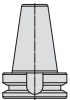

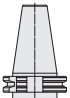
SHANK	MODEL NO.	TYPE	L	l ₁	l ₂	d ₁	d ₂	WEIGHT (KGS)
 MAS 403	5011-780-012-045	BT40 x SFS12 - 45	110.4	45	15.1	38.1	39.6	1.1
	5011-780-012-075	BT40 x SFS12 - 75	140.4	75	60.1	38.1	42.8	1.4
	5011-780-012-090	BT40 x SFS12 - 90	155.4	90	45.1	38.1	44.4	1.6
	5011-780-012-135	BT40 x SFS12 - 135	200.4	135	105.1	38.1	49.1	2.2
	5012-780-012-075	BT50 x SFS12 - 75	176.8	75	34.1	38.1	41.6	4.0
	5012-780-012-105	BT50 x SFS12 - 105	206.8	105	64.1	38.1	44.8	4.4
	5012-780-012-135	BT50 x SFS12 - 135	236.8	135	94.1	38.1	47.9	4.7
	5012-780-012-225	BT50 x SFS12 - 225	326.8	225	184.1	38.1	57.4	6.4
 ANSI B5.50	5031-780-012-045	CAT40 x SFS12 - 1.77"	113.249	45	8.73	38.1	41.9	1.1
	5031-780-012-075	CAT40 x SFS12 - 2.95"	143.249	75	37.28	38.1	41.9	1.4
	5032-780-012-075	CAT50 x SFS12 - 2.95"	176.6	75	37.15	38.1	41.9	4.0
	5032-780-012-203	CAT50 x SFS12 - 8"	304.8	203.2	165.35	38.1	55.4	6.1
	5032-780-012-305	CAT50 x SFS12 - 12"	406.4	304.8	267.9	38.1	66.1	10.8
 DIN 69871-A	5051-780-012-045	DAT40 x SFS12 - 45	113.4	45	23.05	38.1	20.2	1.0
	5051-780-012-075	DAT40 x SFS12 - 75	143.4	75	53.05	38.1	43.6	1.3
	5052-780-012-075	DAT50 x SFS12 - 75	176.75	75	53.05	38.1	43.6	3.4
	5052-780-012-135	DAT50 x SFS12 - 135	236.75	135	113.05	38.1	49.9	4.3

Product information: ▶ Drawbar clamping design. ▶ Balance: G2.5 25,000rpm.

Standard Accessory: • ALLEN WRENCH • TORX WRENCH



SFS Extension	MFS Extension	Spanner
		
P.12	P.13~14	P.16

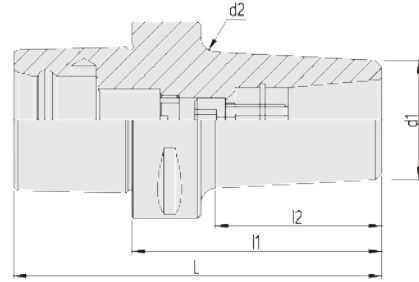

SFS SLIM-FIT COLLET CHUCK

SFS 後拉式刀桿

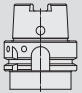
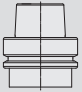
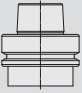

SHANK	MODEL NO.	TYPE	L	l ₁	l ₂	d ₁	d ₂	WEIGHT (KGS)
 DIN 69893 A	5072-780-012-075	HSK50A x SFS12 - 75	100	75	48.6	38.1	42	0.8
	5073-780-012-075	HSK63A x SFS12 - 75	107	75	47.105	38.1	43	1.0
	5073-780-012-135	HSK63A x SFS12 - 135	167	135	107.5	38.1	49.3	1.7
	5073-780-012-165	HSK63A x SFS12 - 165	197	165	138.6	38.1	52.6	2.1
	5073-780-012-225	HSK63A x SFS12 - 225	257	225	199	38.1	52	2.9
 DIN 69893 E	5073-780-012-240	HSK63A x SFS12 - 240	272	240	132.6	38.1	52	3.1
	5075-780-012-105	HSK100A x SFS12 - 105	155	105	66.5	38.1	45	3.4
	5075-780-012-135	HSK100A x SFS12 - 135	185	135	101.26	38.1	48.7	3.8
	5075-780-012-225	HSK100A x SFS12 - 225	275	225	191.2	38.1	58.1	5.4
 DIN 69893 F	5075-780-012-315	HSK100A x SFS12 - 315	365	315	281.2	38.1	67.5	6.4
	5099-780-012-075	HSK40E x SFS12 - 75	95	75	55	38.1	40	0.7
	5100-780-012-075	HSK50E x SFS12 - 75	110	75	48.6	38.1	42	0.8
	5103-780-012-075	HSK63F x SFS12 - 75	100	75	47.1	38.1	43	1.0
	5103-780-012-100	HSK63F x SFS12 - 100	125	75	72.1	38.1	45.6	1.3
 DIN ISO 26623-1	5103-780-012-125	HSK63F x SFS12 - 125	150	125	97.0	38.1	48.2	1.6
	5143-780-012-080	PSC63 x SFS12 - 80	118	80	53	38.1	43.6	1.21

Product information: ▶ Drawbar clamping design. ▶ Balance: G2.5 25,000rpm.

Standard Accessory: • ALLEN WRENCH • TORX WRENCH



SFS Extension	MFS Extension	Spanner
		
P.12	P.13~14	P.16

SFS SLIM-FIT COLLET CHUCK

Dual
DRIVE+

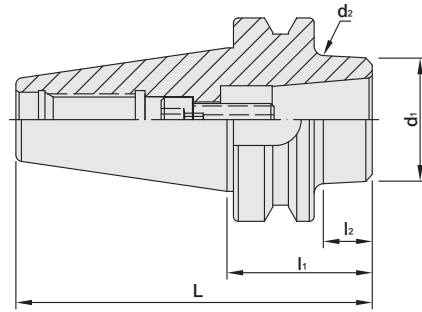
SFS 後拉式刀桿

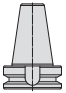

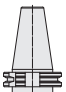
SHANK	MODEL NO.	TYPE	L	l ₁	l ₂	d ₁	d ₂	WEIGHT (KGS)
 DualDRIVE+	5026-780-012-045	SBT40 x SFS12 - 45	110.4	45	15.1	38.1	39.6	1.1
	5026-780-012-075	SBT40 x SFS12 - 75	140.4	75	60.1	38.1	42.8	1.4
	5026-780-012-090	SBT40 x SFS12 - 90	155.4	90	45.1	38.1	44.4	1.6
	5026-780-012-135	SBT40 x SFS12 - 135	200.4	135	105.1	38.1	49.1	2.2
	5027-780-012-075	SBT50 x SFS12 - 75	176.8	75	34.1	38.1	41.6	4.0
	5027-780-012-105	SBT50 x SFS12 - 105	206.8	105	64.1	38.1	44.8	4.4
	5027-780-012-135	SBT50 x SFS12 - 135	236.8	135	94.1	38.1	47.9	4.7
	5027-780-012-225	SBT50 x SFS12 - 225	326.8	225	184.1	38.1	57.4	6.4
 DualDRIVE+	5043-780-012-045	SCAT40 x SFS12 - 1.77"	113.249	45	8.73	38.1	41.9	1.1
	5043-780-012-075	SCAT40 x SFS12 - 2.95"	143.249	75	37.28	38.1	41.9	1.4
	5044-780-012-075	SCAT50 x SFS12 - 2.95"	176.6	75	37.15	38.1	41.9	4.0
	5044-780-012-203	SCAT50 x SFS12 - 8"	304.8	203.2	165.35	38.1	55.4	6.1
	5044-780-012-305	SCAT50 x SFS12 - 12"	406.4	304.8	267.9	38.1	66.1	10.8
 DualDRIVE+	5066-780-012-045	SDAT40 x SFS12 - 45	113.4	45	23.05	38.1	20.2	1.0
	5066-780-012-075	SDAT40 x SFS12 - 75	143.4	75	53.05	38.1	43.6	1.3
	5067-780-012-075	SDAT50 x SFS12 - 75	176.75	75	53.05	38.1	43.6	3.4
	5067-780-012-135	SDAT50 x SFS12 - 135	236.75	135	113.05	38.1	49.9	4.3

Product information:

- ▶ Drawbar clamping design.
- ▶ Balance: G2.5 25,000rpm.

Standard Accessory: • ALLEN WRENCH • TORX WRENCH

SFS Extension	MFS Extension	Spanner
		
P.12	P.13~14	P.16



SFS SLIM-FIT SHRINK EXTENSION

SFS 熱膨脹延長桿

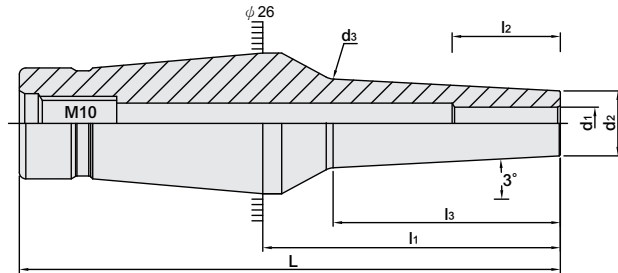

MODEL NO.	TYPE	L	l ₁	l ₂	l ₃	d ₁	d ₂	d ₃	WEIGHT (KGS)
5272-780-01203-035	SFS12 x 3mm - 35mm	80	35	10	22	3	6	8.3	0.16
5272-780-01203-055	SFS12 x 3mm - 55mm	100	55	10	42	3	6	10.4	0.17
5272-780-01203-080	SFS12 x 3mm - 80mm	125	80	10	67	3	6	13.0	0.20
5272-780-01203-110	SFS12 x 3mm - 110mm	155	110	10	97	3	6	16.2	0.23
5272-780-01204-035	SFS12 x 4mm - 35mm	80	35	10	22	4	7	9.3	0.16
5272-780-01204-055	SFS12 x 4mm - 55mm	100	55	10	42	4	7	11.4	0.18
5272-780-01204-080	SFS12 x 4mm - 80mm	125	80	10	67	4	7	14.0	0.20
5272-780-01204-110	SFS12 x 4mm - 110mm	155	110	10	97	4	7	17.2	0.24
5272-780-01206-035	SFS12 x 6mm - 35mm	80	35	20	22	6	9	11.3	0.17
5272-780-01206-055	SFS12 x 6mm - 55mm	100	55	20	42	6	9	13.4	0.18
5272-780-01206-080	SFS12 x 6mm - 80mm	125	80	20	67	6	9	16.2	0.21
5272-780-01206-110	SFS12 x 6mm - 110mm	155	110	20	97	6	9	19.2	0.26
5272-780-01208-035	SFS12 x 8mm - 35mm	80	35	26	22	8	11	13.3	0.17
5272-780-01208-055	SFS12 x 8mm - 55mm	100	55	26	42	8	11	15.4	0.19
5272-780-01208-080	SFS12 x 8mm - 80mm	125	80	26	67	8	11	18.0	0.23
5272-780-01208-110	SFS12 x 8mm - 110mm	155	110	26	97	8	11	21.2	0.29
5272-780-01210-035	SFS12 x 10mm - 35mm	80	35	32	22	10	13	15.3	0.17
5272-780-01210-055	SFS12 x 10mm - 55mm	100	55	32	42	10	13	17.4	0.20
5272-780-01210-080	SFS12 x 10mm - 80mm	125	80	32	67	10	13	20.0	0.24
5272-780-01210-110	SFS12 x 10mm - 110mm	155	110	32	97	10	13	23.2	0.32
5272-780-01212-035	SFS12 x 12mm - 35mm	80	35	37	22	12	15	17.3	0.17
5272-780-01212-055	SFS12 x 12mm - 55mm	100	55	37	42	12	15	19.4	0.20
5272-780-01212-080	SFS12 x 12mm - 80mm	125	80	37	67	12	15	22.0	0.26
5272-780-01212-110	SFS12 x 12mm - 110mm	155	110	37	97	12	15	25.2	0.35

Product information:

- ▶ Used with SFS slim-fit collet chuck [Page P.8~11].
- ▶ Material: hot work die steel.

MFS SLIM-FIT SHRINK EXTENSION

MFS 熱膨脹延長桿

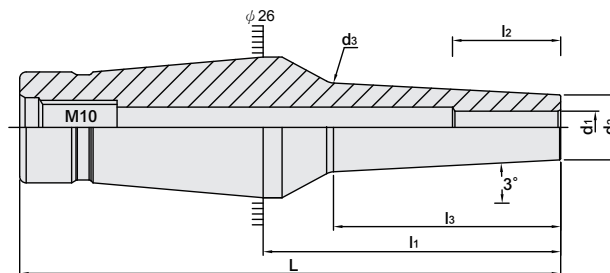

MODEL NO.	TYPE	L	l ₁	l ₂	l ₃	d ₁	d ₂	d ₃	WEIGHT (KGS)
5272-474-01203-035	MFS12R x 3mm - 35	80	35	10	22	3	7.5	9.8	0.2
5272-474-01203-055	MFS12R x 3mm - 55	100	55	10	42	3	7.5	11.9	0.2
5272-474-01203-080	MFS12R x 3mm - 80	125	80	10	67	3	7.5	14.5	0.2
5272-474-01204-035	MFS12R x 4mm - 35	80	35	10	22	4	10	12.3	0.2
5272-474-01204-055	MFS12R x 4mm - 55	100	55	10	42	4	10	14.4	0.2
5272-474-01204-080	MFS12R x 4mm - 80	125	80	10	67	4	10	17	0.2
5272-474-01206-035	MFS12R x 6mm - 35	80	35	20	22	6	12	14.3	0.2
5272-474-01206-055	MFS12R x 6mm - 55	100	55	20	42	6	12	16.4	0.2
5272-474-01206-080	MFS12R x 6mm - 80	125	80	20	67	6	12	19	0.2
5272-474-01208-035	MFS12R x 8mm - 35	80	35	26	22	8	14	16.3	0.2
5272-474-01208-055	MFS12R x 8mm - 55	100	55	26	42	8	14	18.4	0.2
5272-474-01208-080	MFS12R x 8mm - 80	125	80	26	67	8	14	21	0.3
5272-474-01210-035	MFS12R x 10mm - 35	80	35	32	22	10	16	18.3	0.2
5272-474-01210-055	MFS12R x 10mm - 55	100	55	32	42	10	16	20.4	0.2
5272-474-01210-080	MFS12R x 10mm - 80	125	80	32	67	10	16	23	0.3
5272-474-01212-035	MFS12R x 12mm - 35	80	35	37	22	12	20	22.3	0.2
5272-474-01212-055	MFS12R x 12mm - 55	100	55	37	42	12	20	24.4	0.2
5272-474-01212-080	MFS12R x 12mm - 80	125	80	37	67	12	20	25.4	0.3

Product information:

- ▶ Used with SFS slim-fit collet chuck [Page P.8~11].
- ▶ Material: heat resistant steel.



MFS SLIM-FIT SHRINK EXTENSION

MFS 熱膨脹延長桿

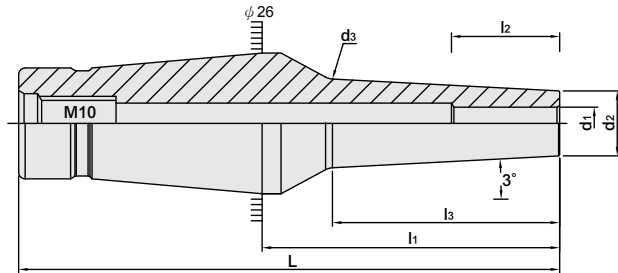

MODEL NO.	TYPE	L	l ₁	l ₂	l ₃	d ₁	d ₂	d ₃	WEIGHT (KGS)
5272-473-01203-035	MFS12S x 3mm - 35	80	35	10	22	3	6	8.3	0.16
5272-473-01203-055	MFS12S x 3mm - 55	100	55	10	42	3	6	10.4	0.17
5272-473-01203-080	MFS12S x 3mm - 80	125	80	10	67	3	6	13.0	0.20
5272-473-01203-110	MFS12S x 3mm - 110	155	110	10	97	3	6	16.2	0.23
5272-473-012A08-035	MFS12S x 3.175mm - 35	80	35	10	22	3.175	6.175	8.5	0.16
5272-473-012A08-055	MFS12S x 3.175mm - 55	100	55	10	42	3.175	6.175	10.6	0.17
5272-473-012A08-080	MFS12S x 3.175mm - 80	125	80	10	67	3.175	6.175	13.2	0.19
5272-473-012A08-110	MFS12S x 3.175mm - 110	155	110	10	97	3.175	6.175	16.3	0.23
5272-473-01204-035	MFS12S x 4mm - 35	80	35	10	22	4	7	9.3	0.16
5272-473-01204-055	MFS12S x 4mm - 55	100	55	10	42	4	7	11.4	0.18
5272-473-01204-080	MFS12S x 4mm - 80	125	80	10	67	4	7	14.0	0.20
5272-473-01204-110	MFS12S x 4mm - 110	155	110	10	97	4	7	17.2	0.24
5272-473-01206-035	MFS12S x 6mm - 35	80	35	20	22	6	9	11.3	0.17
5272-473-01206-055	MFS12S x 6mm - 55	100	55	20	42	6	9	13.4	0.18
5272-473-01206-080	MFS12S x 6mm - 80	125	80	20	67	6	9	16.2	0.21
5272-473-01206-110	MFS12S x 6mm - 110	155	110	20	97	6	9	19.2	0.26
5272-473-01208-035	MFS12S x 8mm - 35	80	35	26	22	8	11	13.3	0.17
5272-473-01208-055	MFS12S x 8mm - 55	100	55	26	42	8	11	15.4	0.19
5272-473-01208-080	MFS12S x 8mm - 80	125	80	26	67	8	11	18.0	0.23
5272-473-01208-110	MFS12S x 8mm - 110	155	110	26	97	8	11	21.2	0.29
5272-473-01210-035	MFS12S x 10mm - 35	80	35	32	22	10	13	15.3	0.17
5272-473-01210-055	MFS12S x 10mm - 55	100	55	32	42	10	13	17.4	0.20
5272-473-01210-080	MFS12S x 10mm - 80	125	80	32	67	10	13	20.0	0.24
5272-473-01210-110	MFS12S x 10mm - 110	155	110	32	97	10	13	23.2	0.32
5272-473-01212-035	MFS12S x 12mm - 35	80	35	37	22	12	15	17.3	0.17
5272-473-01212-055	MFS12S x 12mm - 55	100	55	37	42	12	15	19.4	0.20
5272-473-01212-080	MFS12S x 12mm - 80	125	80	37	67	12	15	22.0	0.26
5272-473-01212-110	MFS12S x 12mm - 110	155	110	37	97	12	15	25.2	0.35

Product information:

- ▶ Used with SFS slim-fit collet chuck [Page P.8~11].
- ▶ Material: heat resistant steel.

ONE PIECE PULL STUD WITH DRAW BOLT

一體式後拉螺絲拉頭

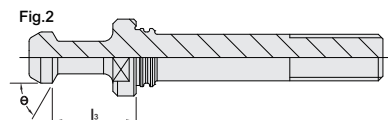
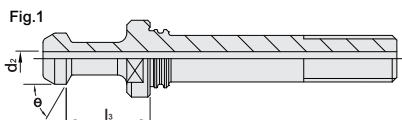

Coolant Thru

MODEL NO.	TYPE	l_3	d_2	Θ	Fig.
5231-010-45-01	BT30 - 45° - MAS	18	3	45°	1
5231-010-60-01	BT30 - 60° - MAS	18	3	60°	1

W/O Coolant

5230-010-45-01	BT30 - 45° - MAS	18	-	45°	2
5230-010-60-01	BT30 - 60° - MAS	18	-	60°	2



SPANNER

T型扳手 / Allen Wrench



Fig.1 Torx wrench

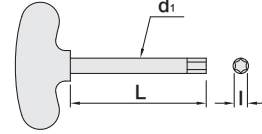
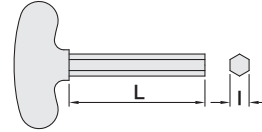

Fig.2 Allen wrench



MODEL NO.	TYPE	d ₁	L	I	Fig	WEIGHT (KGS)
5296-49-020-00	T20 - 100	3.9	100	T20	1	0.04
5296-49-020-01	T20 - 200	3.9	200	T20	1	0.04
210-003-200-004	T20 - 200	6	200	T20	1	0.04
210-003-050-005	T5 - 150	-	150	5	2	0.06
210-003-050-004	T5 - 200	-	200	5	2	0.06
210-003-060-003	T6 - 150	-	150	6	2	0.08
210-003-060-004	T6 - 200	-	200	6	2	0.10
210-003-080-002	T8 - 200	-	200	8	2	0.14
210-003-100-003	T10 - 200	-	200	10	2	0.16

MEMO

Blank lined area for writing the memo content.





www.syic.com



智能侯



戰鼓侯



學識侯



俠客侯



勝侯王



登山侯



慢跑侯



咖啡侯



鐵馬侯

MEMO

Blank memo area consisting of 18 horizontal grey lines for writing.



MEMO

Blank memo area consisting of 20 horizontal grey lines for writing.





SHIN-YAIN INDUSTRIAL CO., LTD.
No.198, Jingpu Rd., Qingshui Dist., Taichung City 436, Taiwan
Tel: +886-4-26237575 | Fax: +886-4-26237676 | E-mail: sales@syic.com

