



GDDC GEAR DRIVING DRILL CHUCK

Quick tool change! **Time-saving & labor-saving**

▶ Runout accuracy $\leq 0.04\text{mm}$

▶ The inside bevel gear and hexagonal hole for driving gear make the clamping power achieve 40~75N·m. Easy to tighten drills, taps and reamers.

▶ Clockwise and anticlockwise rotations are workable.

▶ Titanium-coating jaws improve abrasion resistance

▶ The design of fastening from side hexagonal hole allows quick tool change, no need to dismount the chuck from the machine.

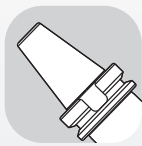

SBT

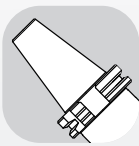

SDAT

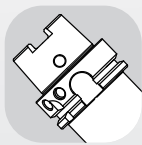

HSK

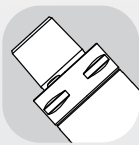

PSC

