



USC ULTIMATE SIDE CLAMPING CHUCK

1

Quick tool change

- **Clamp/Unclamp** from the side.
Quick tool change!
- Internal **gear** design, which drives the collet to change the tool.

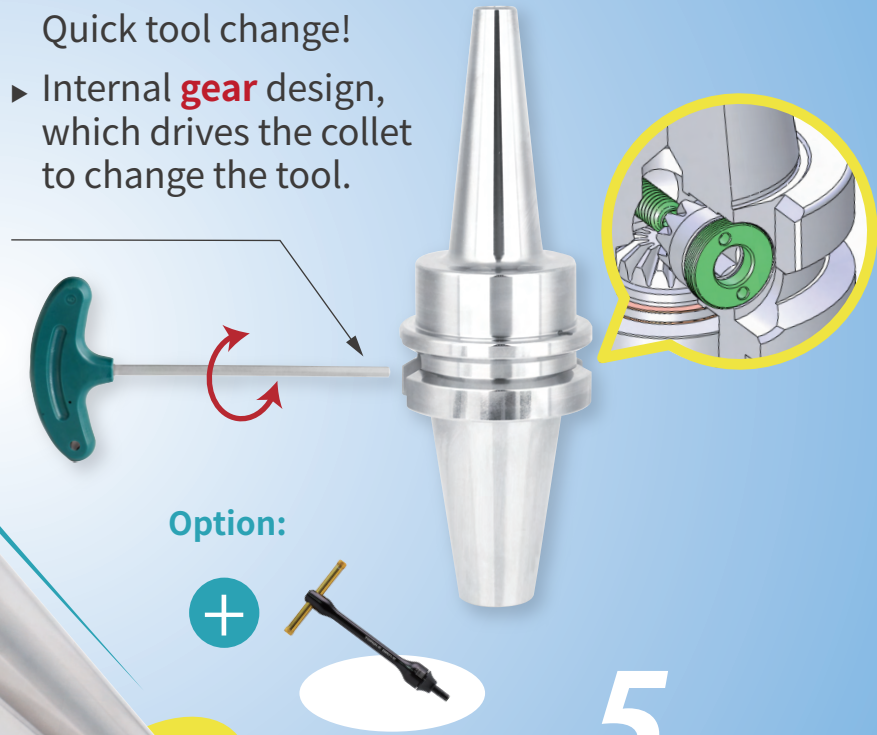

2

Machining Rigidity ↑

The **enlarged neck** of the tool holder improves machining rigidity.

3

Reducing Interference

The USC design **w/o nut** is good for interference reduction.

4

Center Coolant Available

Effectively removes metal chips, extends tool life and improves surface finish of workpiece.



5

Balance

G2.5 25,000RPM



心源工業股份有限公司
SHIN-YAIN INDUSTRIAL CO., LTD.

43644 台中市清水區菁埔路198號
NO.198, Jingpu Rd., Qingshui Dist,
Taichung City 436, Taiwan

Tel: +886-4-26237575
Fax: +886-4-26237676
E-mail: sales@syic.com

